

Recessed Riser Light

Pre - Installation Notes

- Do not cut any wires. Extra wire length can be coiled up.
- If using insulated wire staples to hold the wires in place, be sure not to pierce or crush the wires.
- Wiring harness should have enough slack so light fixture can be removed if future replacement is needed.

Components



7/8" Diameter
Forstner Bit or Bi-
Metal Hole Saw



Power
Drill



Recessed Riser
Light With Cover

Step 1

Prepare the Transformer and Wiring Harness

- 1.1 Follow instructions provided with the transformer.
- 1.2 Follow instructions for the wiring harnesses so there is a male connector located at each location that will have a light installed.

Step 2

Drill Holes and Install Light

- 2.1 Layout the location of the light(s). To prevent splitting, do not install within 1/2" of the edge of the light and the edge the deck board.
- 2.2 Use a 7/8" Diameter Bi-Metal Hole Saw for aluminum posts, or a 7/8" Forstner Bit on nonmetal posts to bore a hole through the deck board. NOTE: Ensure the diameter is no larger than 7/8", as the light requires a tight fit for ideal function. It is recommended to ensure the bit will provide a tight enough hole on a scrap piece of post or deck board before drilling. Run the male end of the harness from Step 1.2 through the back of the hole.
- 2.3 Plug the male connector of the harness from Step 2.2 into the female connector attached to the light. Press firmly until the connection is fully engaged.
- 2.4 Connection is fully engaged when there is minimal gap between the male and female connector.
- 2.5 Place the Recessed Riser Light into the hole drilled in Step 2.2, inserting the connected harnesses and wire first. Firmly press the Riser Light and cover into the deck board until the assembly is fully seated.
- 2.6 The Recessed Riser light will now be illuminated if the transformer is on and providing power.

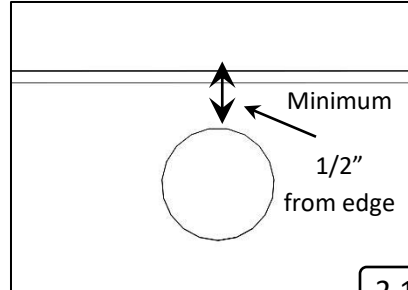

2.1

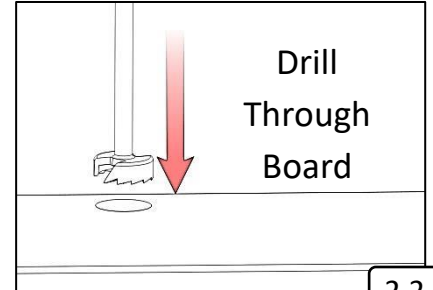

2.2

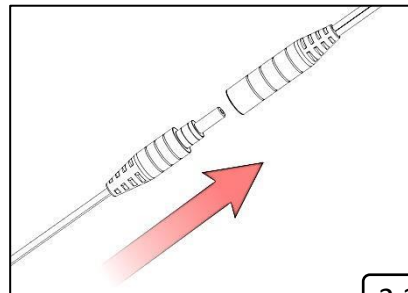

2.3

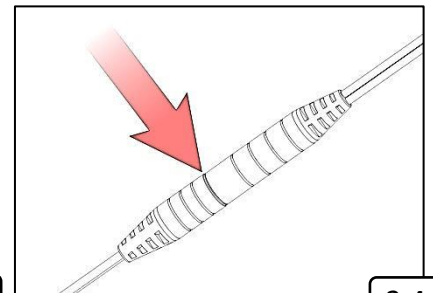

2.4

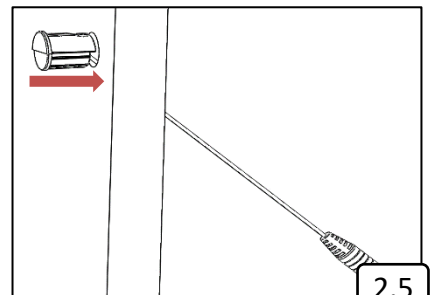

2.5

*If the drilled hole is too loose to hold the light snugly, a small amount of silicone caulk on the inside of the hole is recommended to hold the light in place.