

DESIGN

PURCHASE

CONSTRUCT

ENJOY

Installation Instructions,
4x4 Twin Rail Saddle (56630)
4x4 Single Rail Saddle (56631)
2x4 Top Rail Saddle (56641)

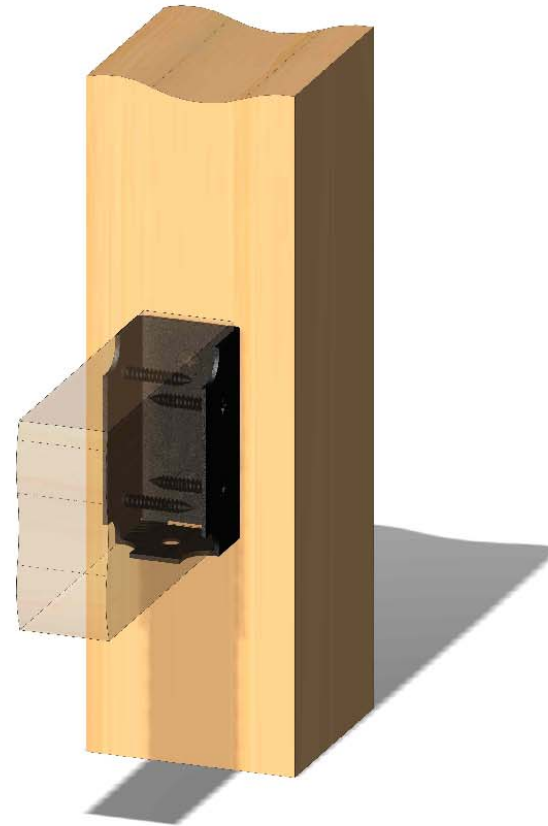
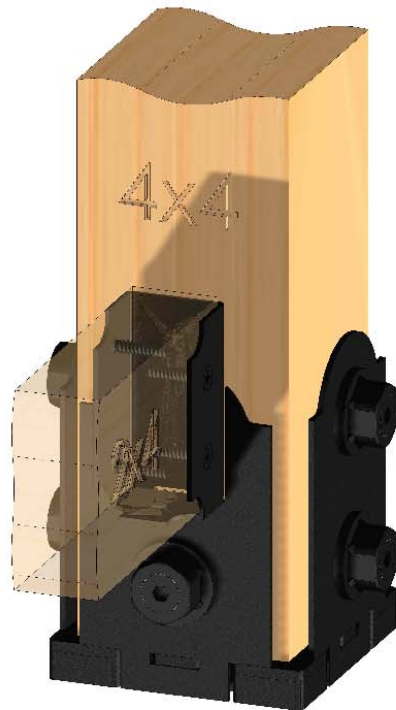
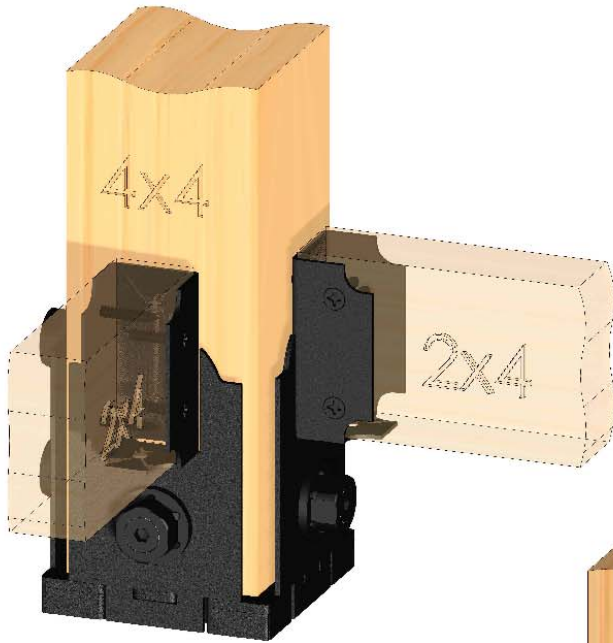

OZCO BUILDING PRODUCTS

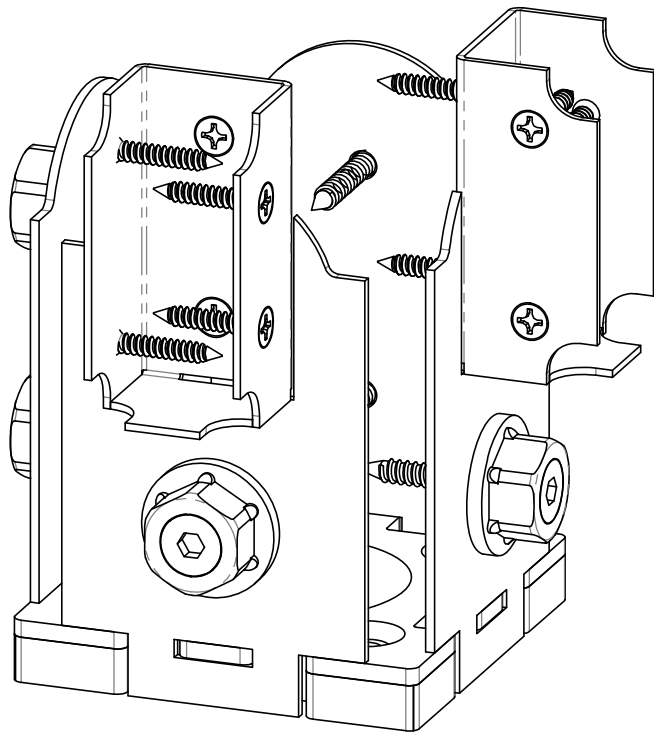

56630

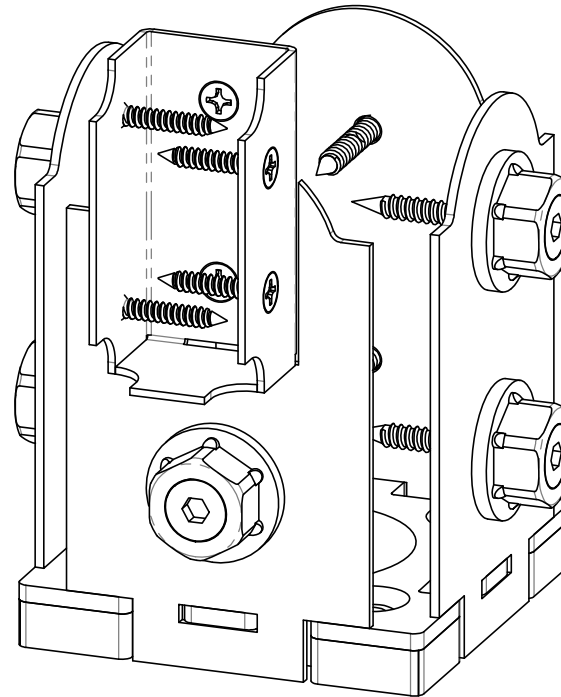

56631

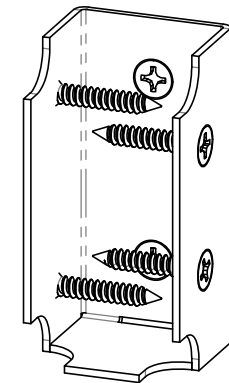

56641



V2.00 - Installation Instructions, Specifications and Project Plans are effective May 1, 2015 and reflects information that available as of April 10, 2014. This information is updated periodically and should not be relied upon after October 15, 2016. Please visit www.OZCOBP.com to get current information.

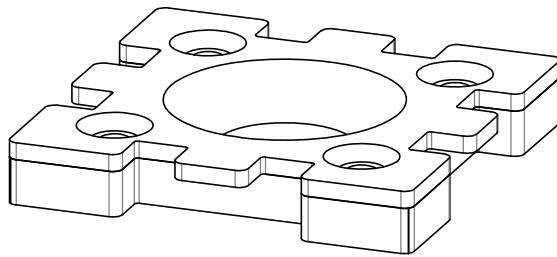

Mount Base to Surface

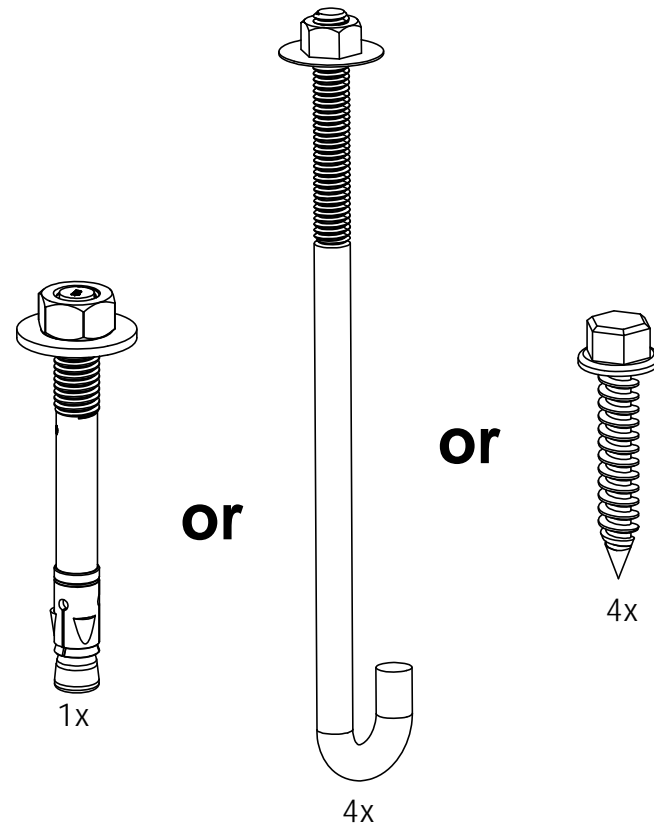
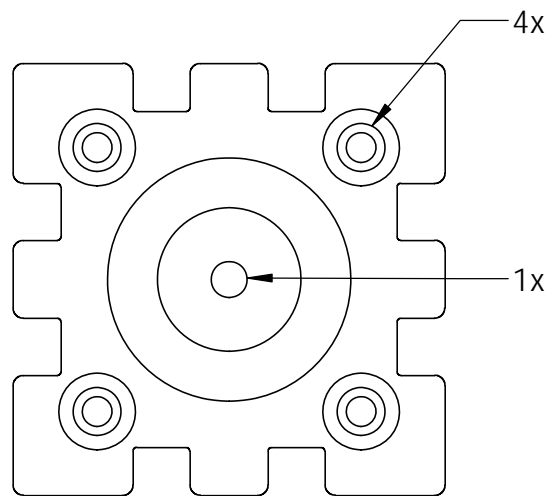

Base Mounting-56630 & 56631

(select fastener that suits your installation)

Installation Instructions, Rail Saddles

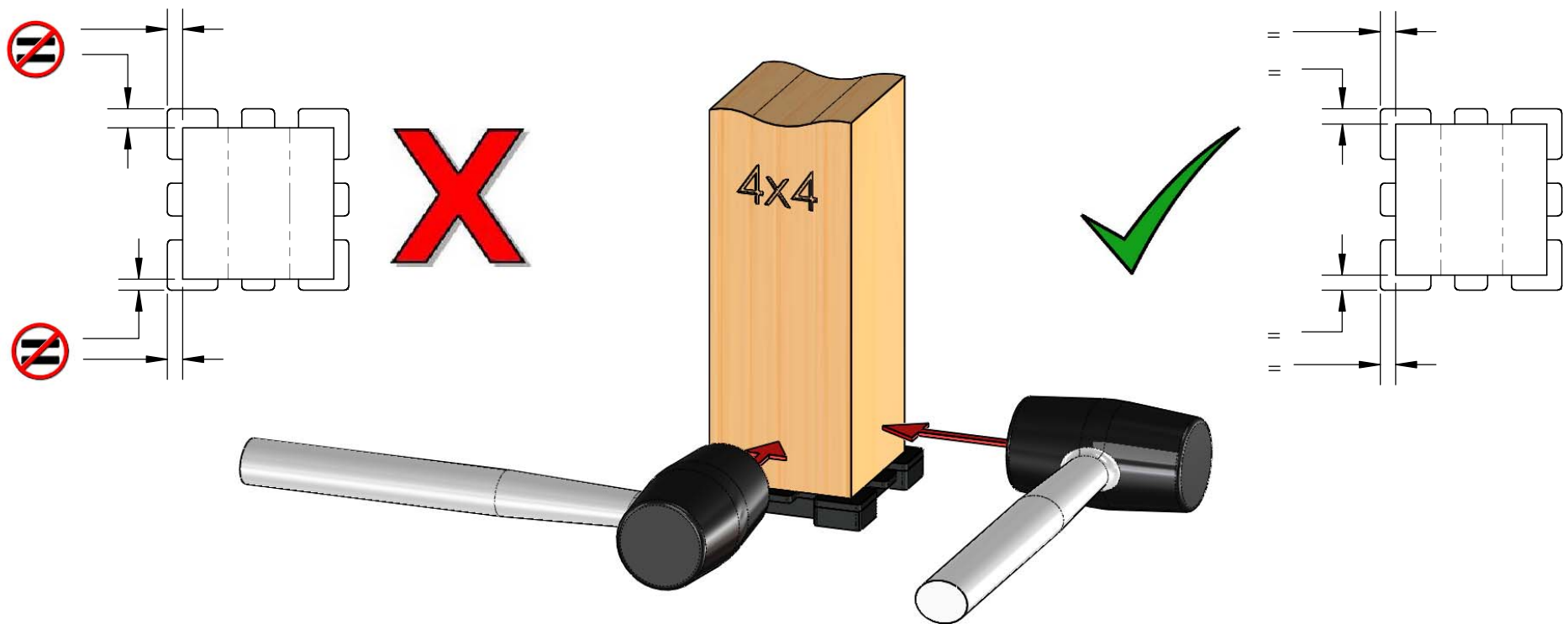

step 1 -56630 & 56631

Installation Instructions, Rail Saddles

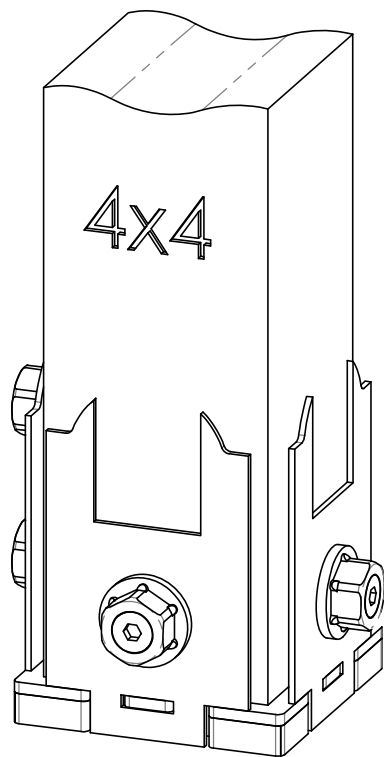

corner configuration

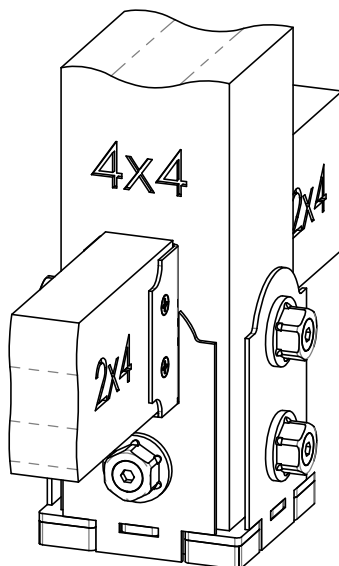

inline configuration

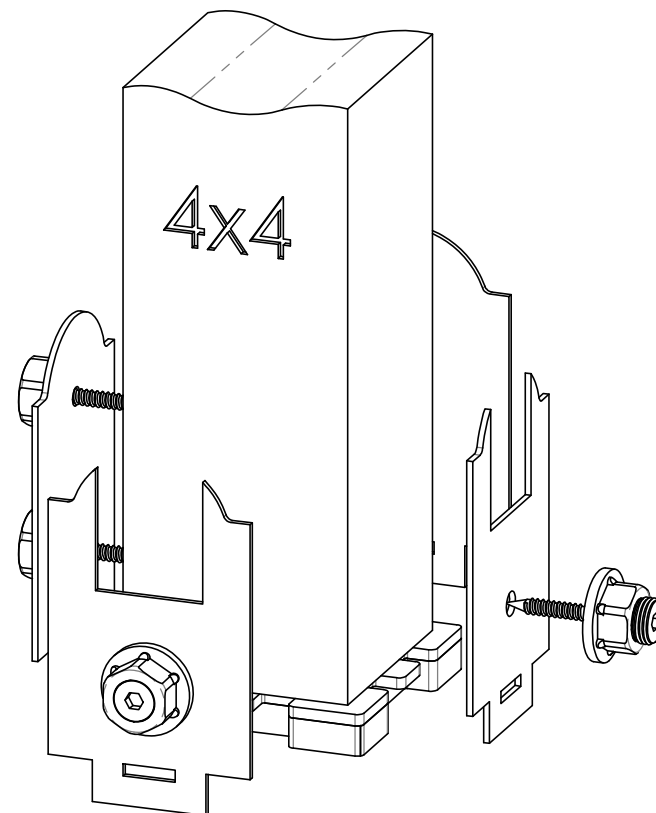
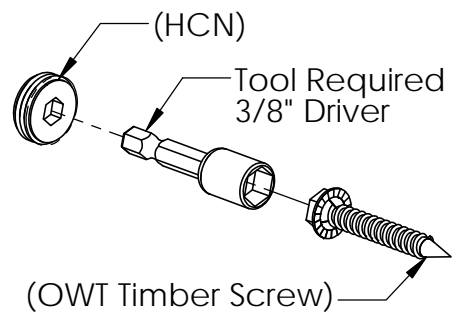

step 2 56630

Installation Instructions, Rail Saddles

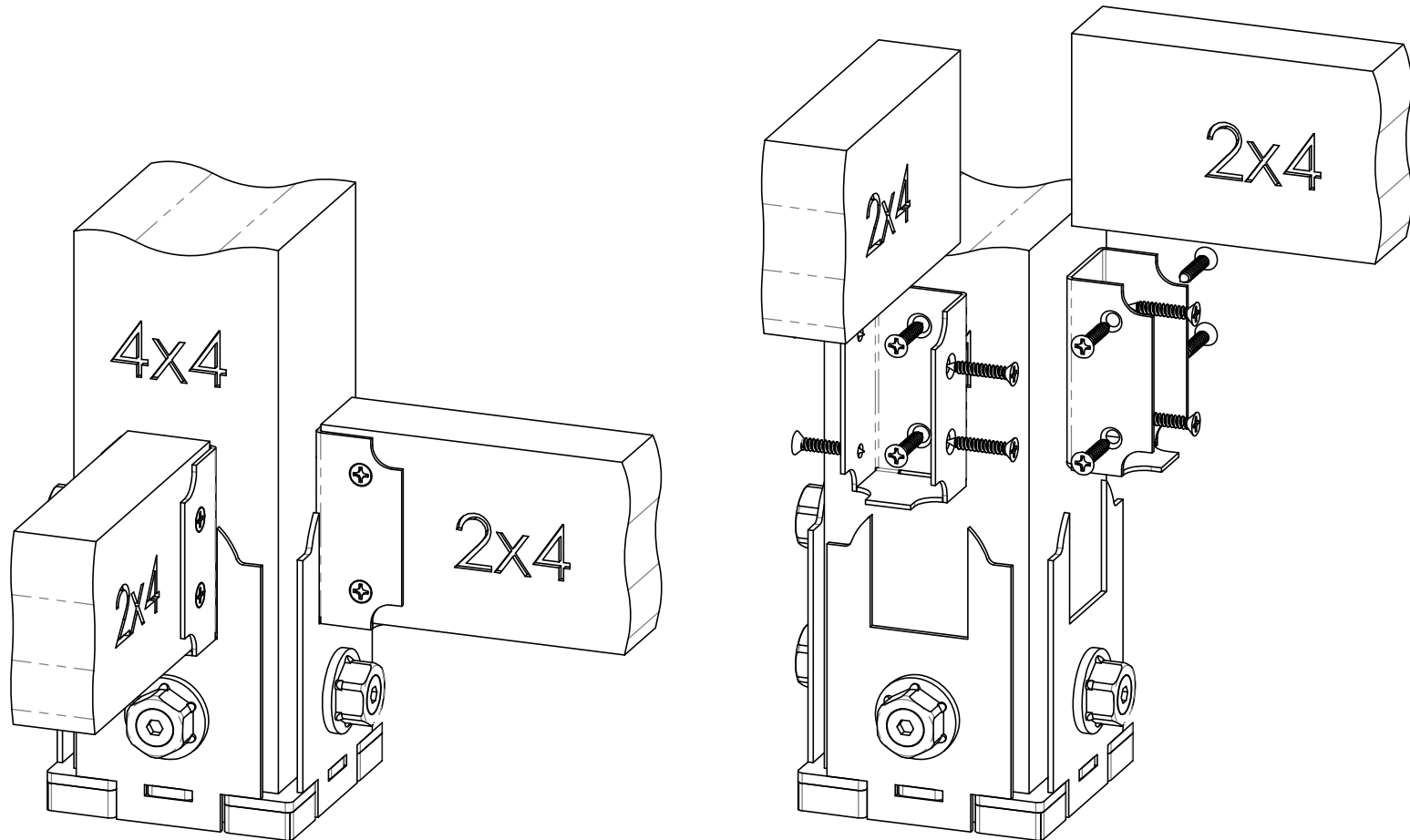

step 3 56630

Installation Instructions, Rail Saddles

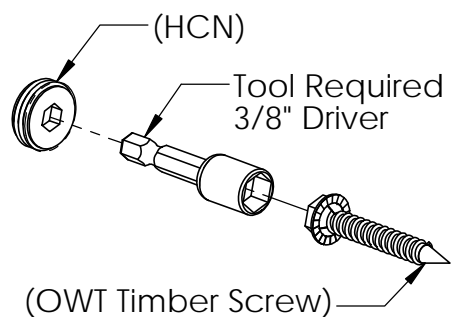
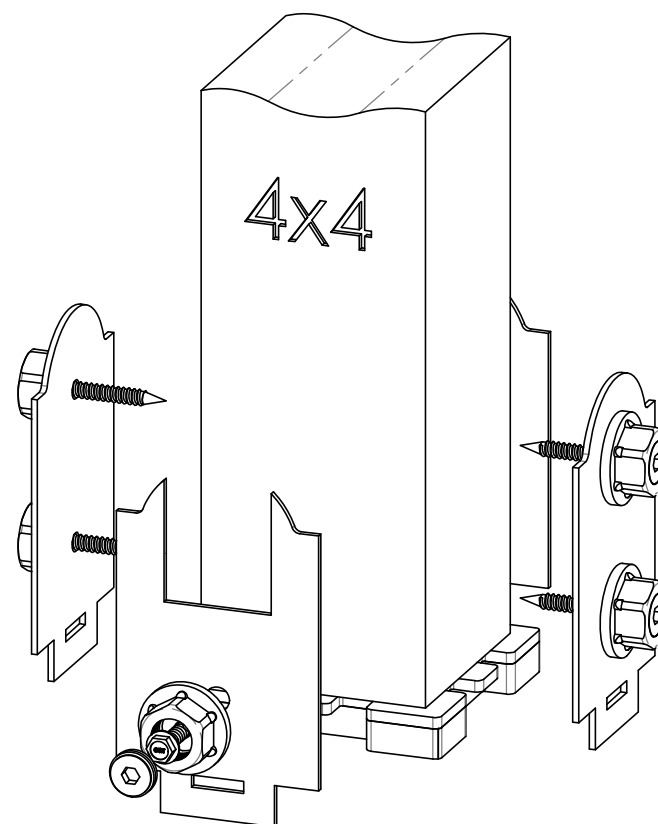
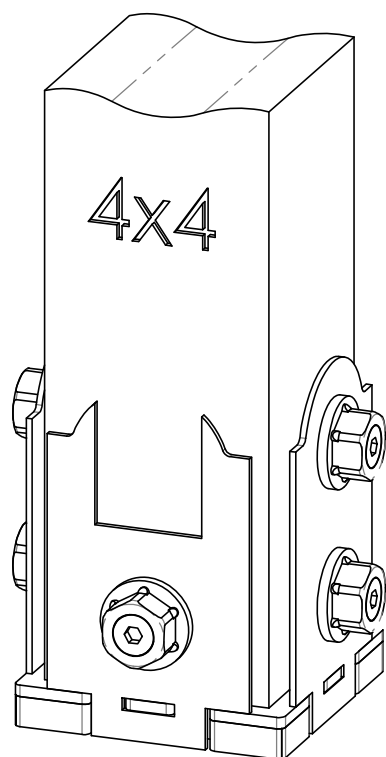

step 2 56631

Installation Instructions, Rail Saddles

V2.00 - Installation Instructions, Specifications and Project Plans are effective May 1, 2015 and reflects information that available as of April 10, 2014. This information is updated periodically and should not be relied upon after October 15, 2016. Please visit www.OZCOBP.com to get current information.

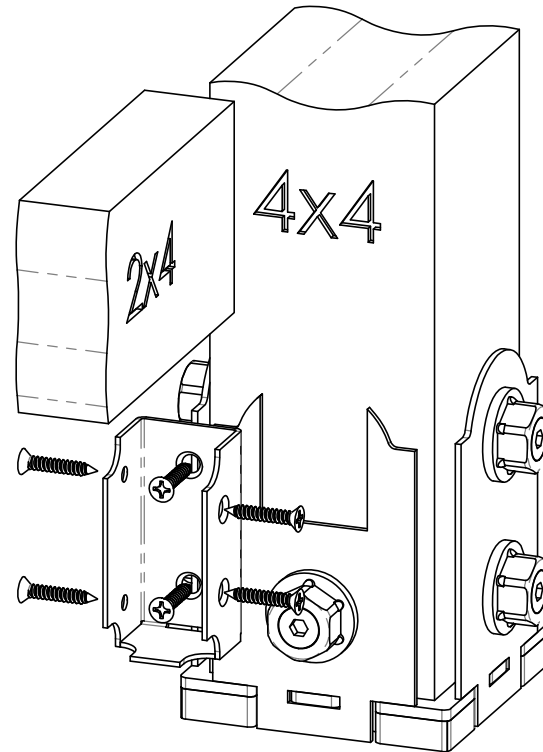
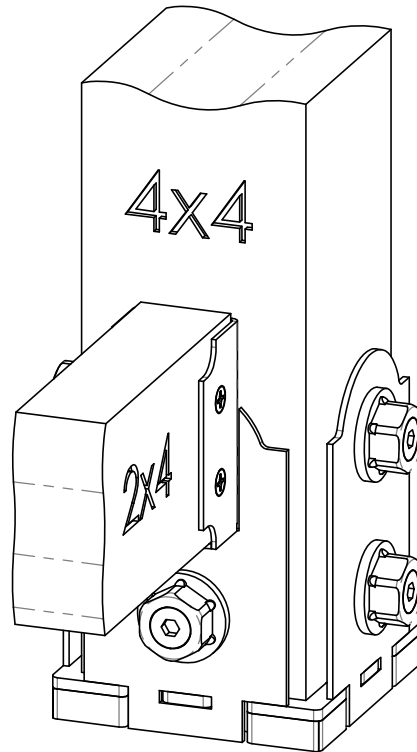

step 3 56631

Installation Instructions, Rail Saddles

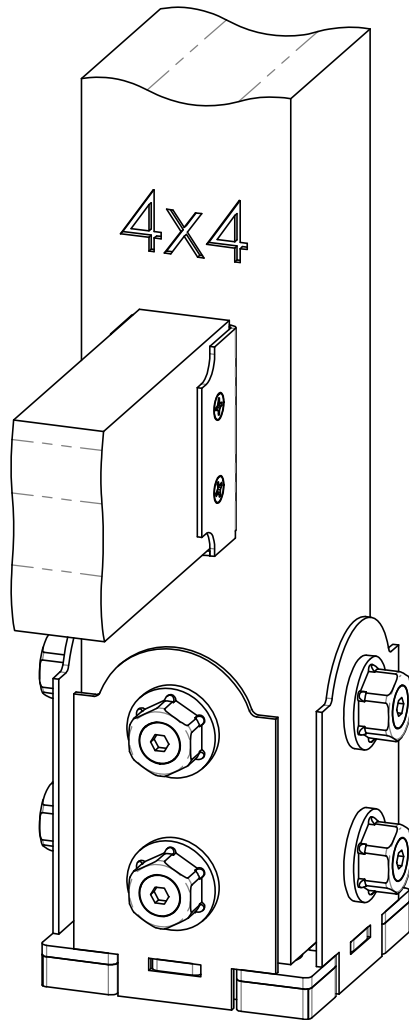

shown with 56607
(sold separately)

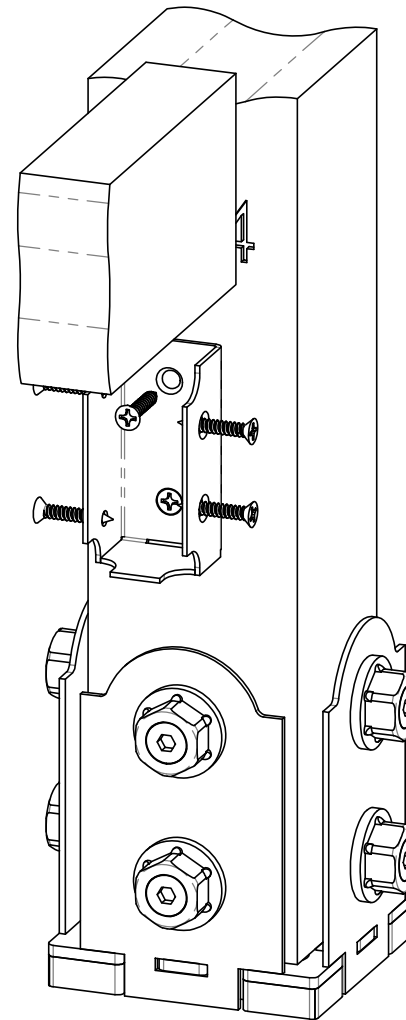

56641 installation

Installation Instructions, Rail Saddles

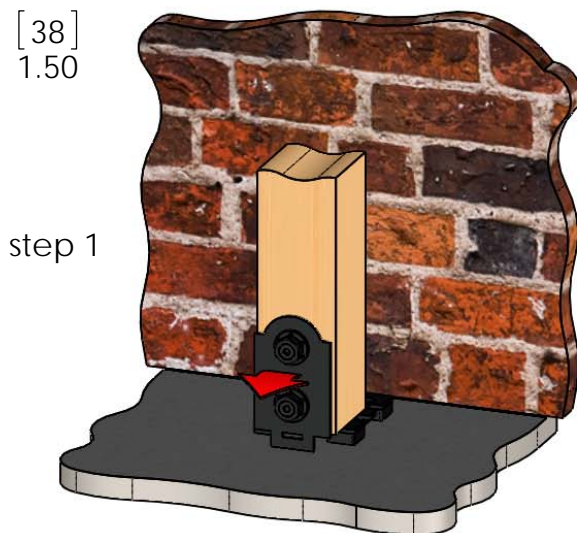
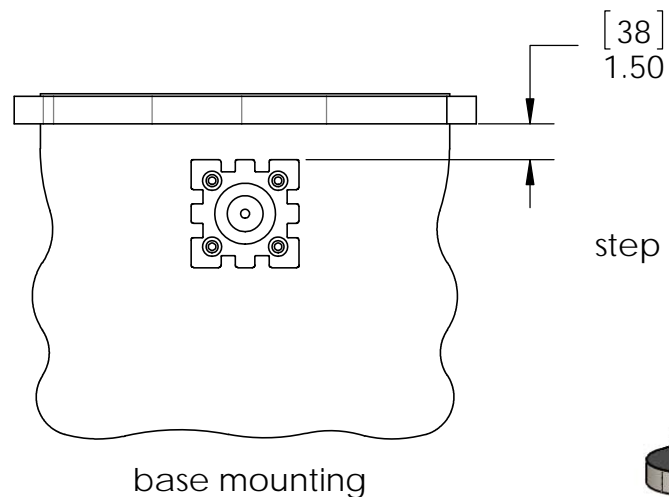

additional instructions

- center post as shown in previous steps
- install 1 compression plate with fasteners
- remove, reposition & reinstall post/compression plate as shown with **plate facing wall**
- complete assembly as shown

this procedure applies to all OZCO Post Bases & Post Anchors utilizing compression plates (56607 shown)

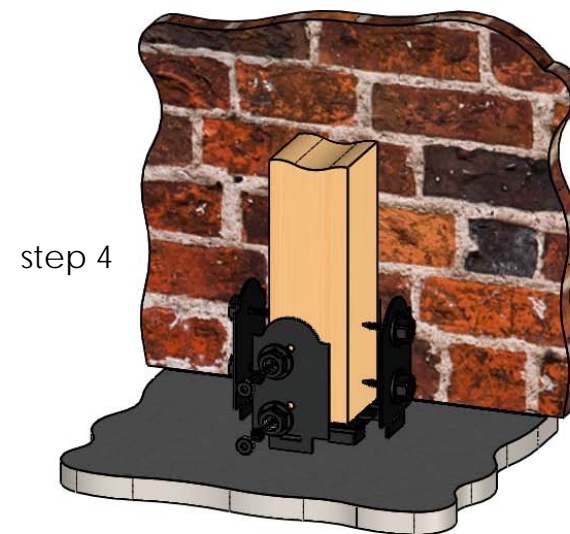
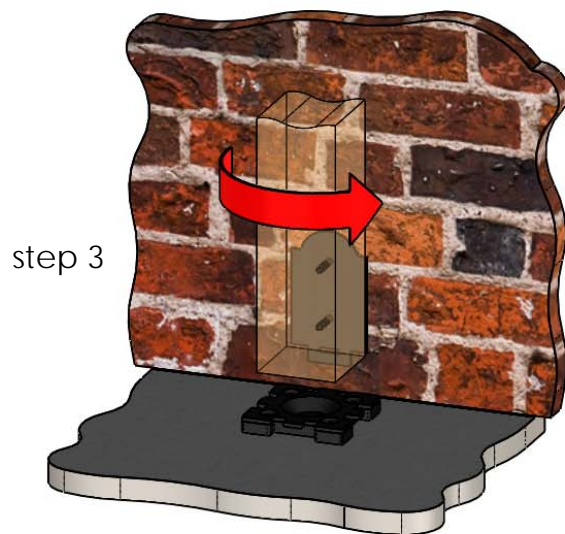
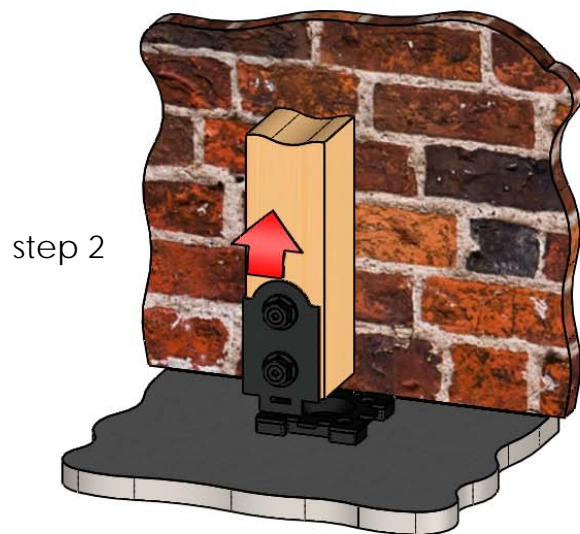

Special Instructions-mounting next to wall

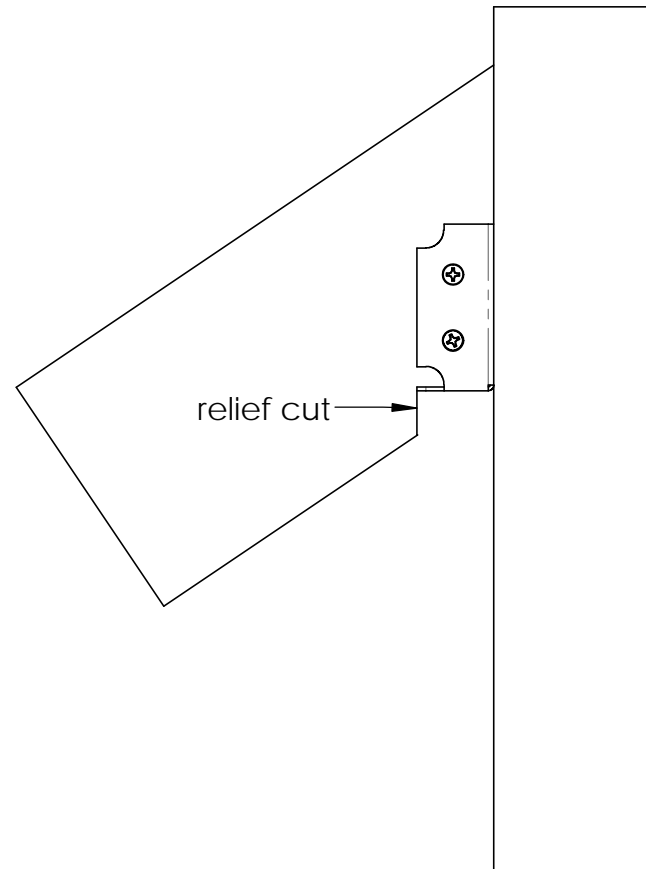
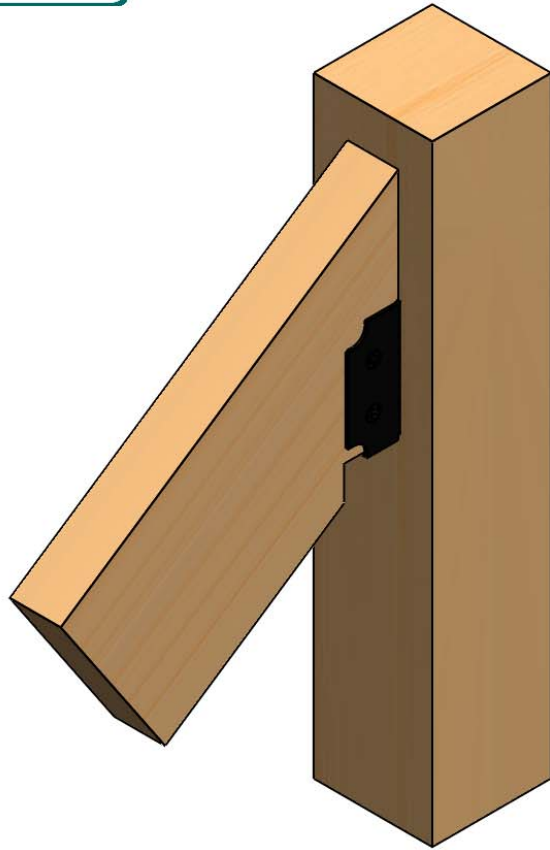

Installation Idea's-56641

Installation Instructions, Rail Saddles

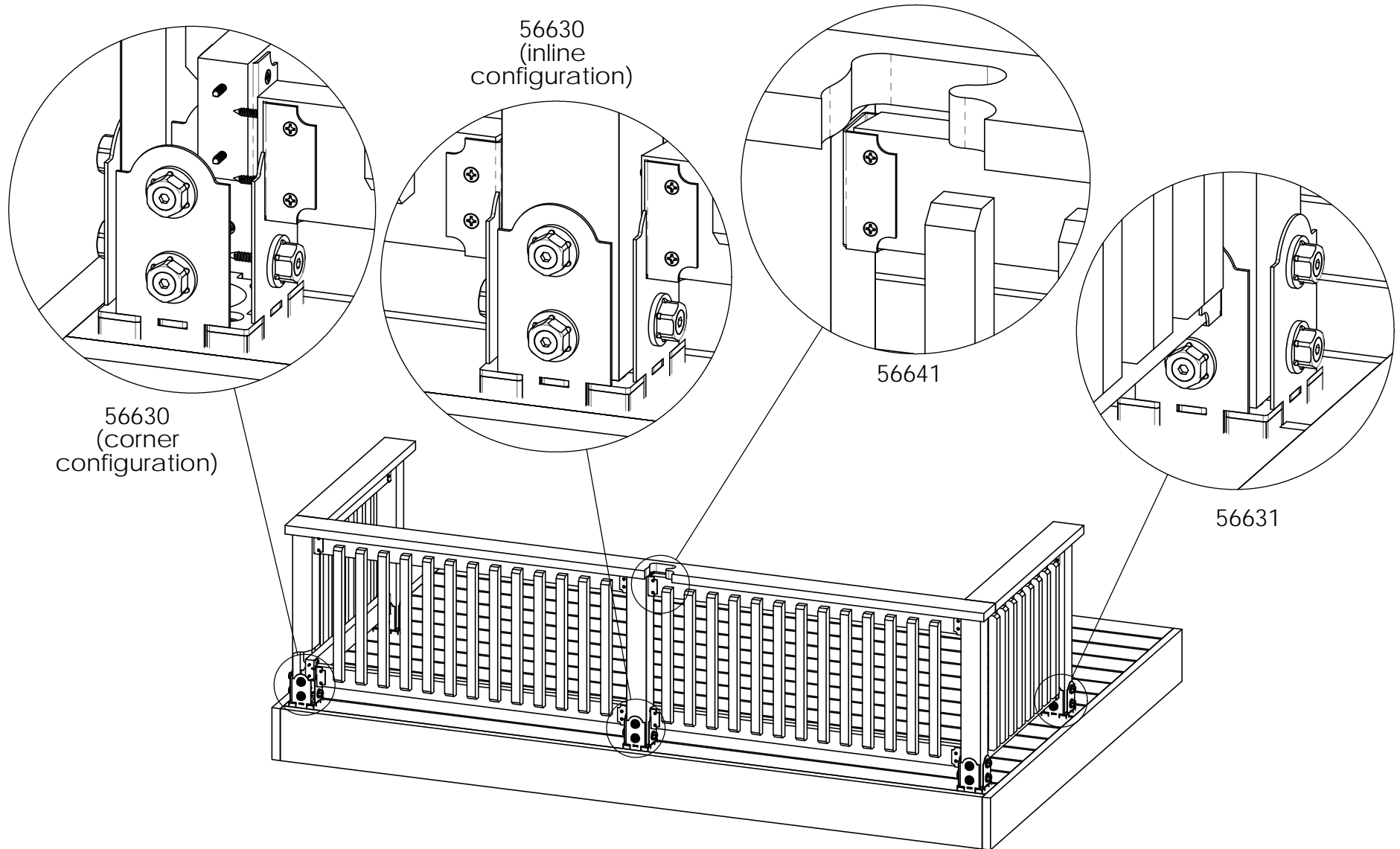

Porch standalone

Installation Instructions, Rail Saddles

V2.00 - Installation Instructions, Specifications and Project Plans are effective May 1, 2015 and reflects information that available as of April 10, 2014. This information is updated periodically and should not be relied upon after October 15, 2016. Please visit www.OZCOBP.com to get current information.

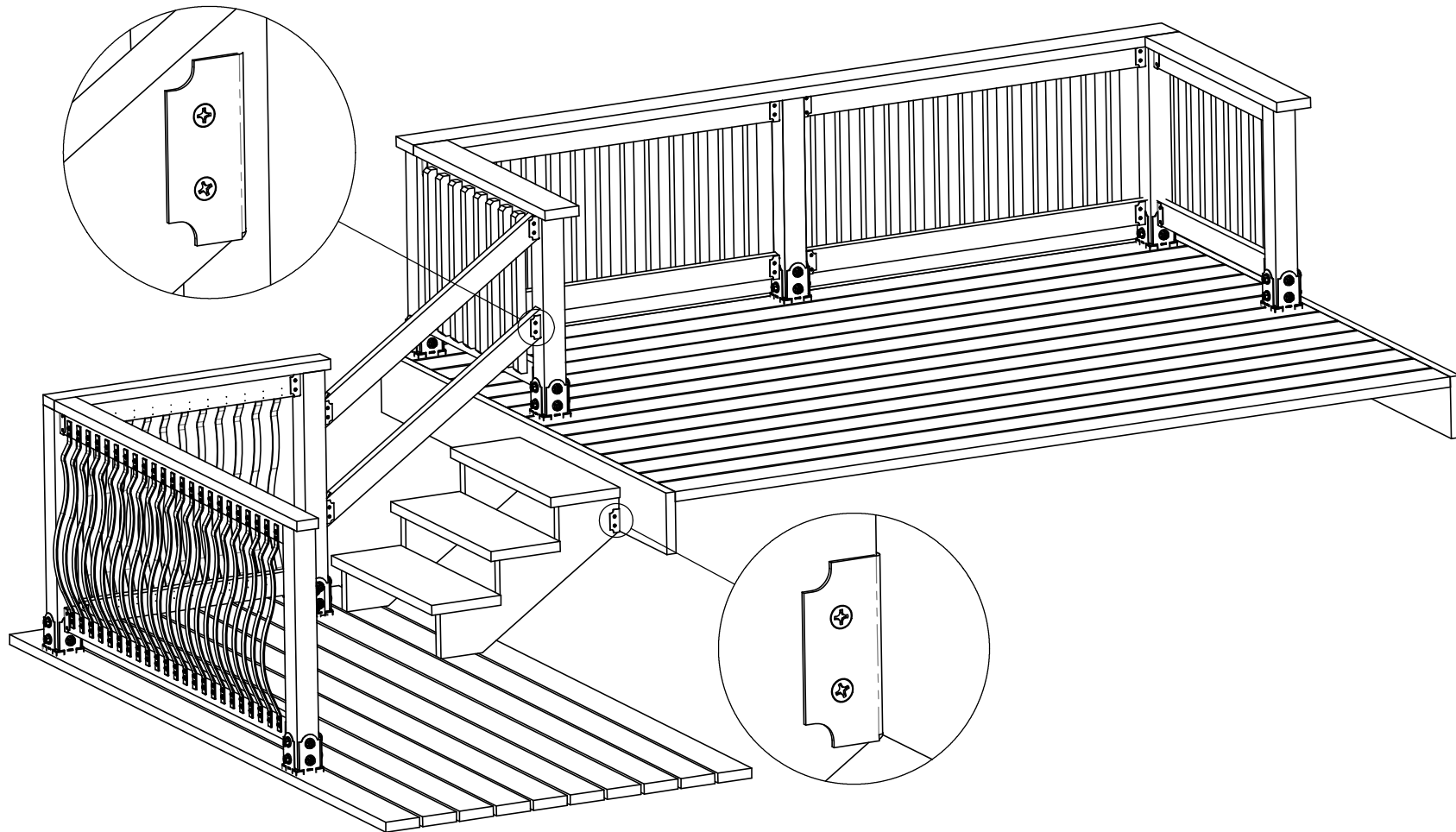

Multi-level

Installation Instructions, Rail Saddles

V2.00 - Installation Instructions, Specifications and Project Plans are effective May 1, 2015 and reflects information that available as of April 10, 2014. This information is updated periodically and should not be relied upon after October 15, 2016. Please visit www.OZCOBP.com to get current information.

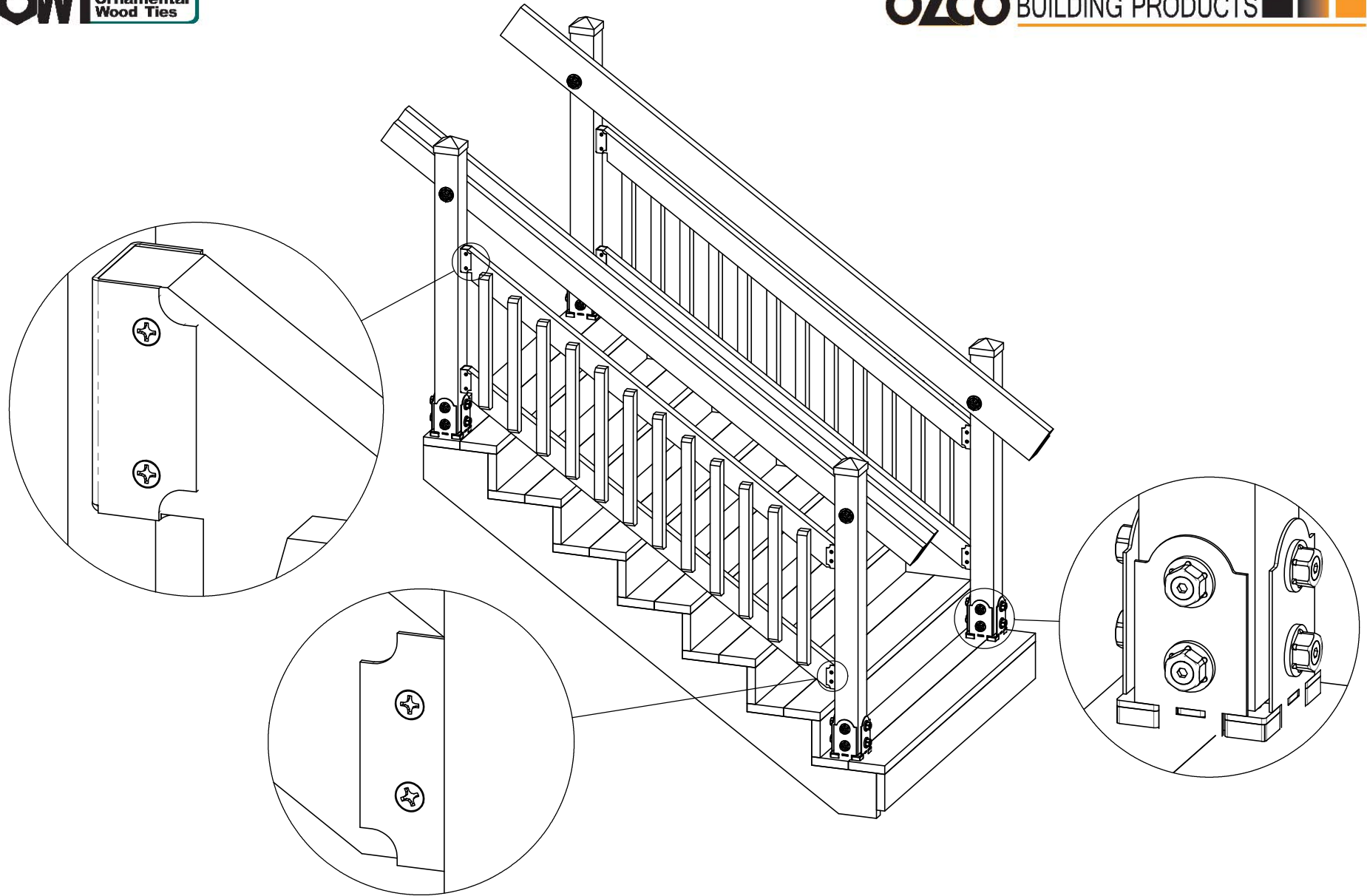

Stairs

Installation Instructions, Rail Saddles

V2.00 - Installation Instructions, Specifications and Project Plans are effective May 1, 2015 and reflects information that available as of April 10, 2014. This information is updated periodically and should not be relied upon after October 15, 2016. Please visit www.OZCOBP.com to get current information.