

DESIGN

PURCHASE

CONSTRUCT

ENJOY

OZCO Project #337 - Railed in Pavilion



OZCO BUILDING PRODUCTS



Printing Documents from ISSUU

Unfortunately, there is currently no way to print content directly through issuu. To print a publication, you will need to download it and print it from your computer.

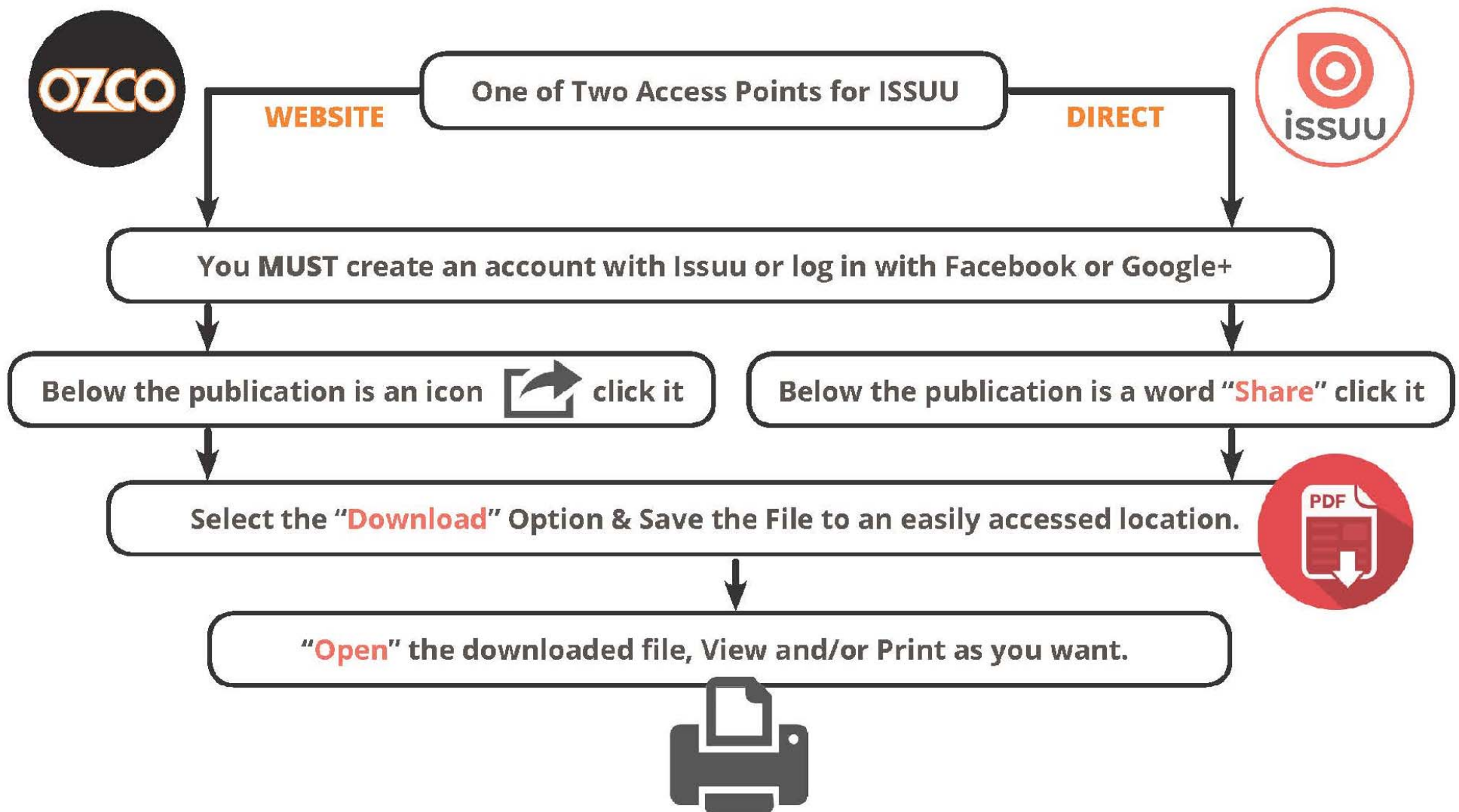

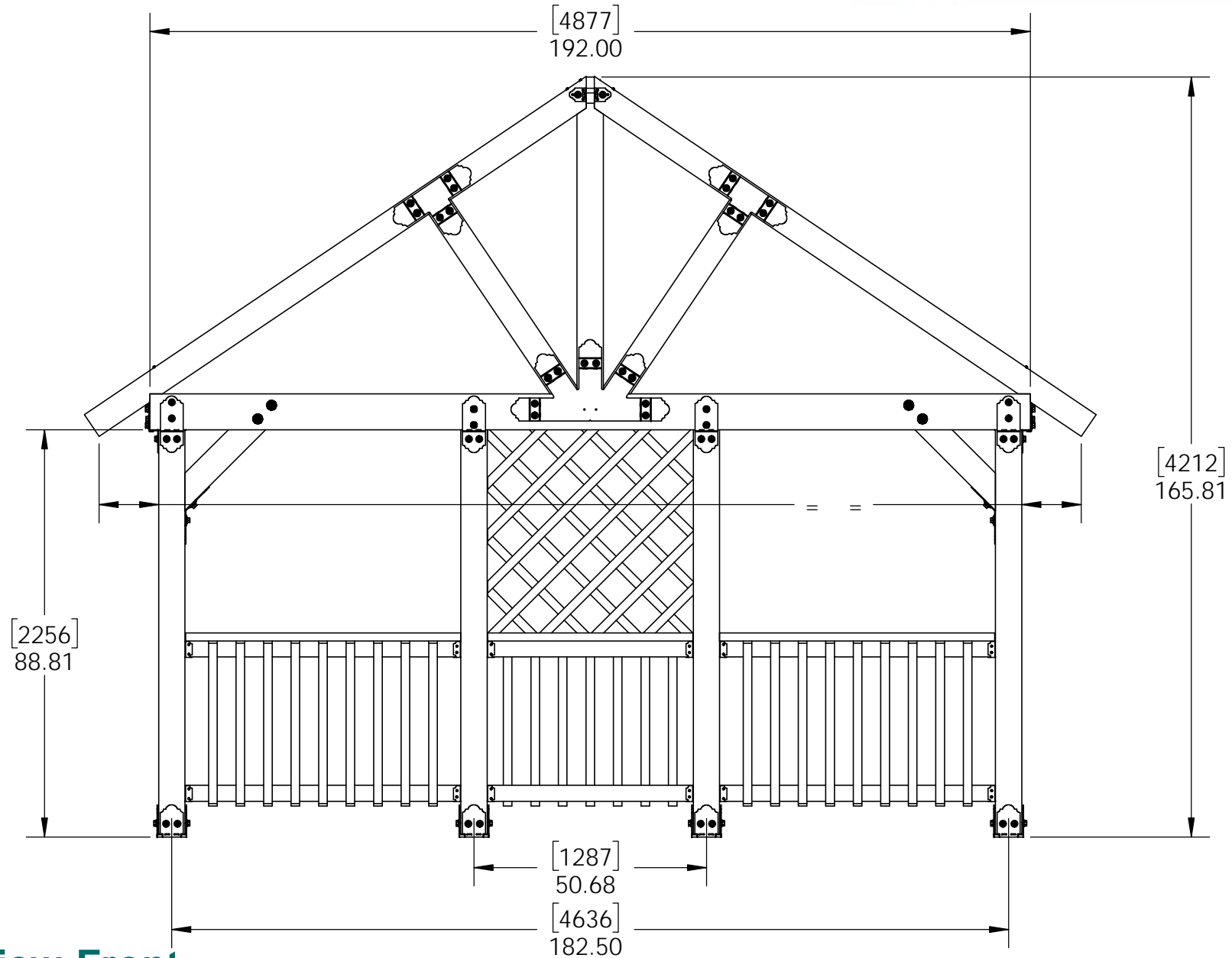

Overview-Front

OZCO Project #337 - Railed in Pavilion

V2.00 - Installation Instructions, Specifications and Project Plans are effective 3/16/2016 . This information is updated periodically and should not be relied upon after 2 years from 3/16/2016 . Please visit OZCOBP.com to get current information.

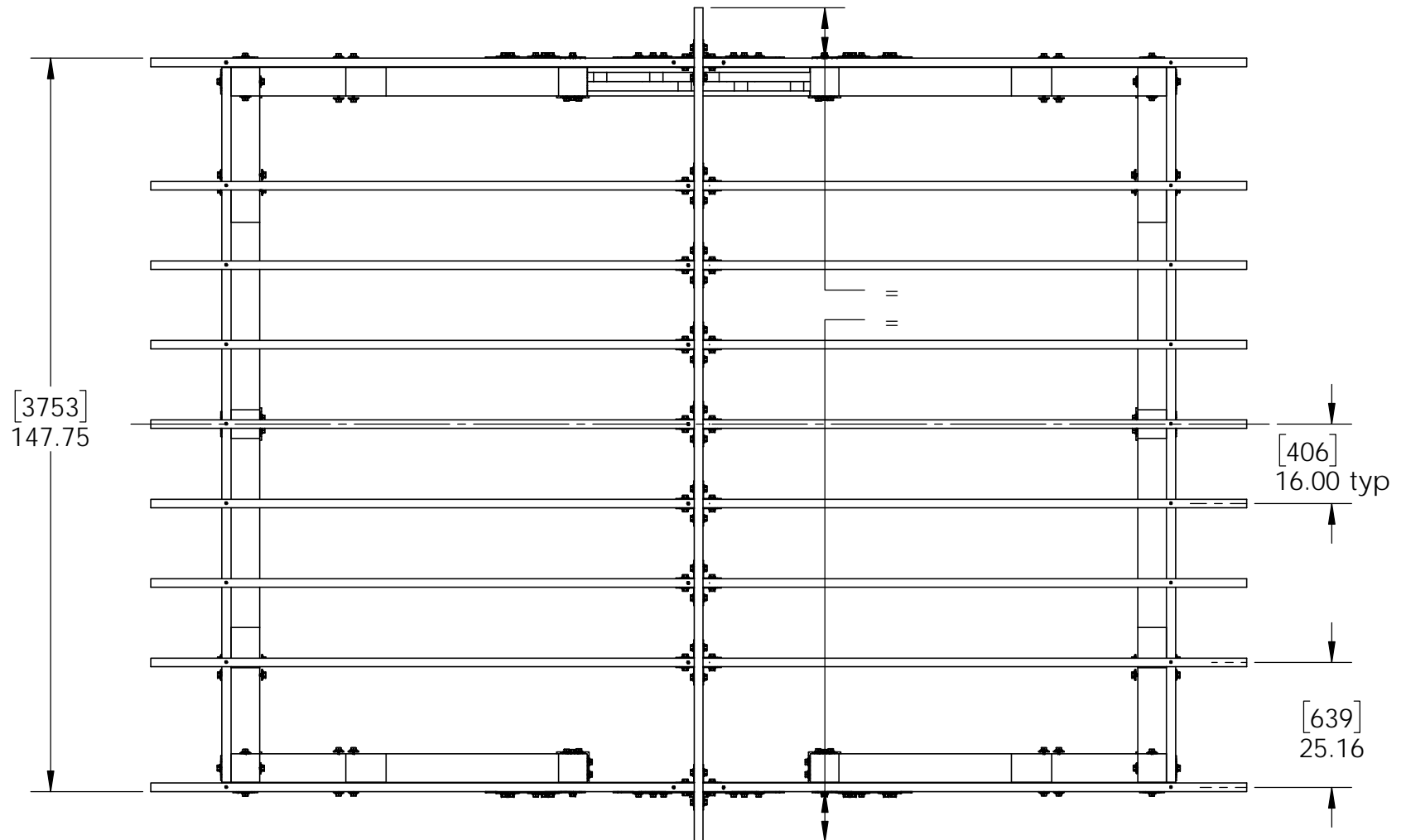

Overview-Top

OZCO Project #337 - Railed in Pavilion

V2.00 - Installation Instructions, Specifications and Project Plans are effective 3/16/2016 . This information is updated periodically and should not be relied upon after 2 years from 3/16/2016 . Please visit OZCOBP.com to get current information.

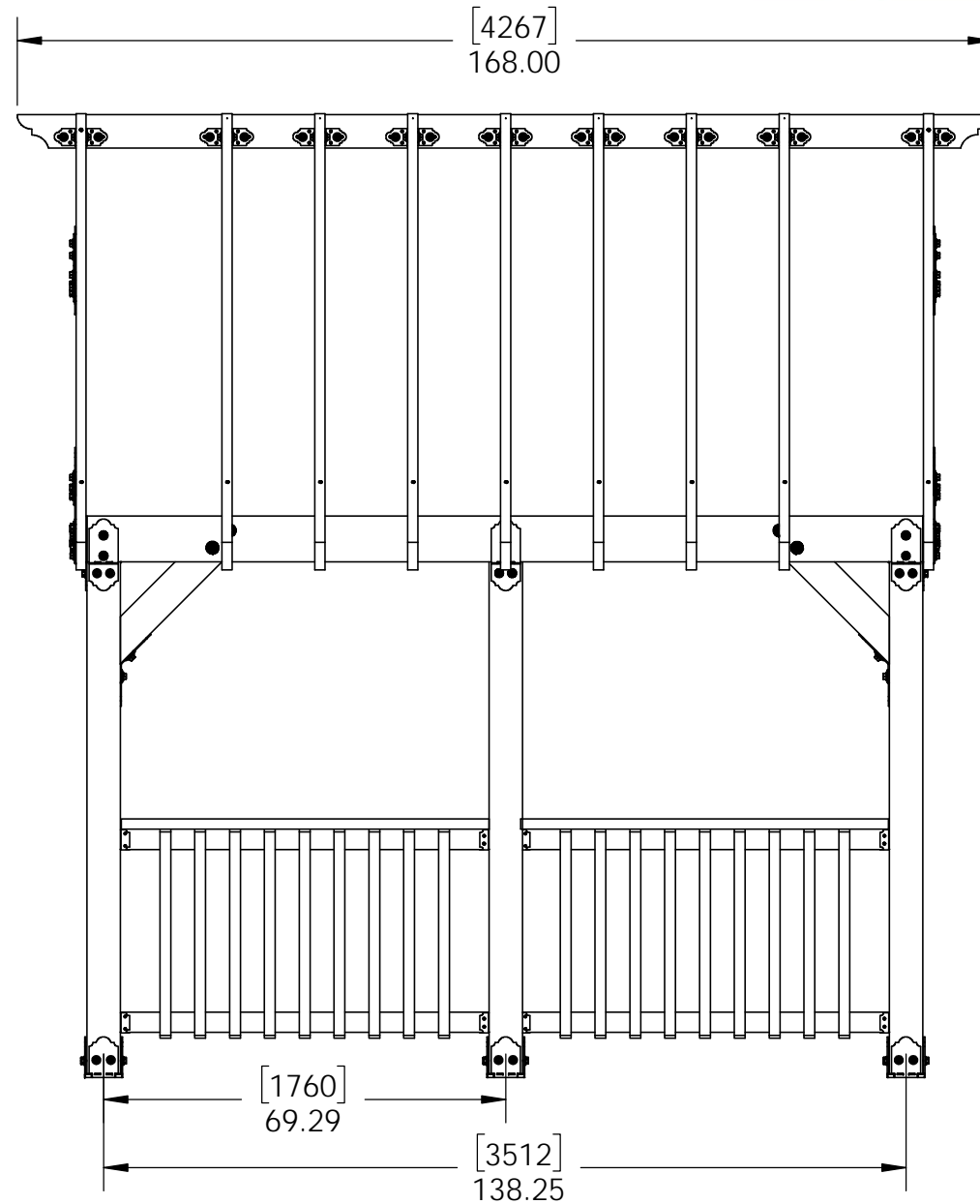

Overview-Right

OZCO Project #337 - Railed in Pavilion

V2.00 - Installation Instructions, Specifications and Project Plans are effective 3/16/2016 . This information is updated periodically and should not be relied upon after 2 years from 3/16/2016 . Please visit OZCOBP.com to get current information.

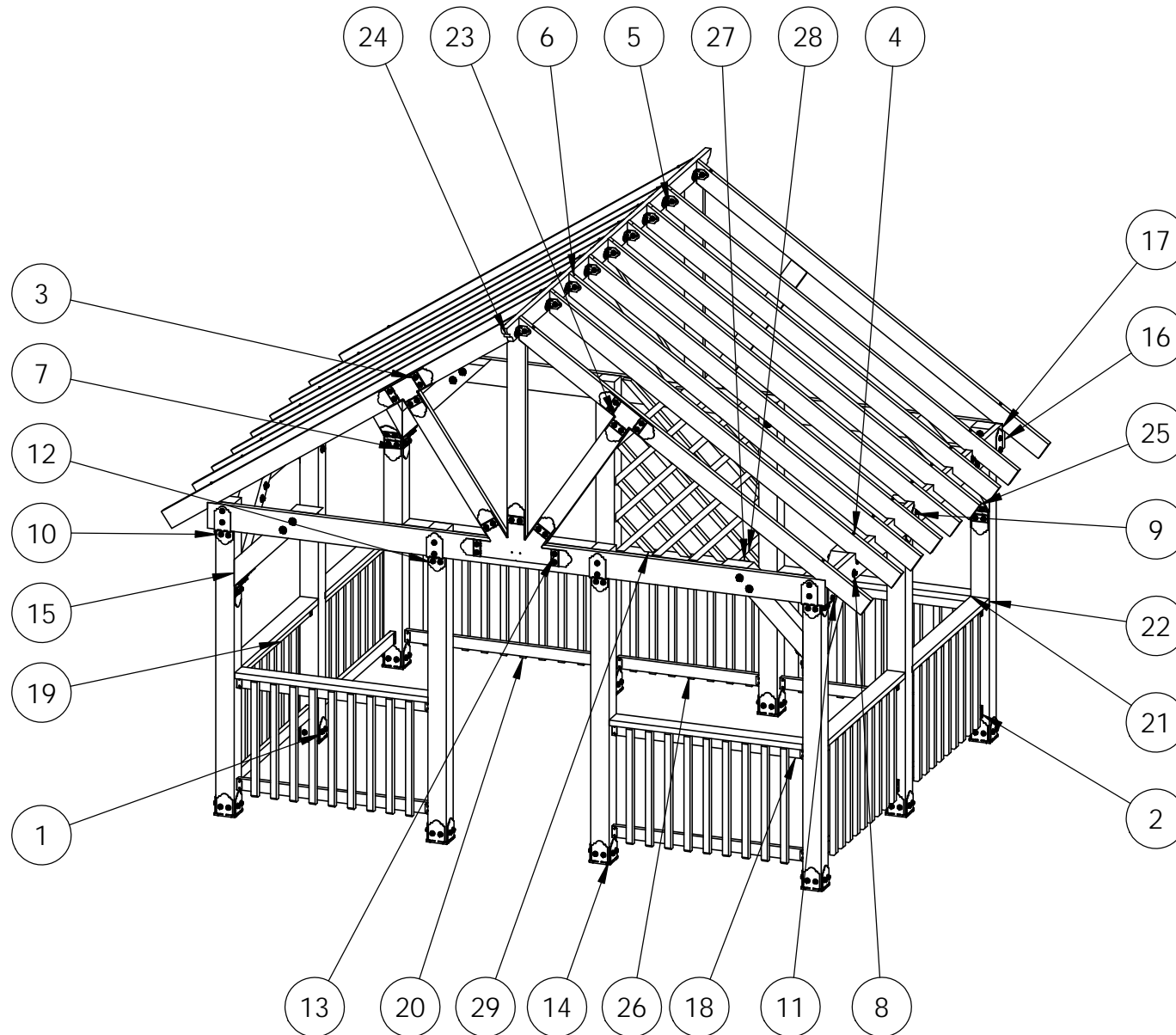

Bill of Material

OZCO Project #337 - Railed in Pavilion

V2.00 - Installation Instructions, Specifications and Project Plans are effective 3/16/2016 . This information is updated periodically and should not be relied upon after 2 years from 3/16/2016 . Please visit OZCOBP.com to get current information.

ITEM NO.	QTY.	PART NUMBER	DESCRIPTION
1	10	56608	6x6 Post Base Kit (6X6-PB-LS)
2	18	56641	2x4 Top Rail Saddle (2x4-TR)
3	2	56612	"T" Tie Plate (TTP)
	1.5	56611	Truss Accent (TA-LS)
	0.08	56625	OWT Timber Screw 1-3/4"
4	0.88	56629	OWT Timber Screw 7-1/2"
5	3.6	56618	4" Standard Rafter Clip (RC-LS-4)
6	0.56	56627	OWT Timber Screw 3-3/4"
7	4	56616	Flush Inside 45 (FI-45)
	1	56611	Truss Accent (TA-LS)
	0.08	56625	OWT Timber Screw 1-3/4"
8	16	56650	OWT Timber Bolt 6-8"
	0.5	56680	2" Timber Bolt Heavy Duty Washer (OWT-TBW-2)
9	14	56650	OWT Timber Bolt 6-8"
	0.25	56680	2" Timber Bolt Heavy Duty Washer (OWT-TBW-2)
10	2	56636	Post to Beam Bolt Offset (P2B-BO-LS)
11	2	56636	Post to Beam Bolt Offset (P2B-BO-LS)
12	3	56637	Post to Beam Bolt Inline (P2B-BI-LS)
13	2	56619	Truss Base Fan 8:12
	2.5	56611	Truss Accent (TA-LS)
	0.08	56625	OWT Timber Screw 1-3/4"
14	10	6x6 Cedar Post	6x6x96.00
15	8	6x6 Cedar Support	6x6x36.00
16	2	2x8 Cedar Board	2x8x192.00
17	2	2x8 Cedar Board	2x8x144.00
18	8	2x4 Cedar Board	2x4x60.00
19	8	2x4 Cedar Board	2x4x63.38
20	79	2x2 Cedar Board	2x2x36.00
21	4	2x6 Cedar Board	2x6x60.00
22	6	2x6 Cedar Board	2x6x63.38
23	4	2x6 Cedar Board	2x6x50.56
24	1	2x6 Cedar Board	2x6x168.00
25	18	2x6 Cedar Board	2x6x132.00
26	2	2x4 Cedar Board	2x4x44.75
27	1	2x6 Cedar Board	2x6x44.75
28	13	2x2 Cedar Board	2x2x72.00
29	1	2x2 Cedar Board	2x2x48.00

Bill of Material

OZCO Project #337 - Railed in Pavilion

V2.00 - Installation Instructions, Specifications and Project Plans are effective 3/16/2016 . This information is updated periodically and should not be relied upon after 2 years from 3/16/2016 . Please visit OZCOBP.com to get current information.

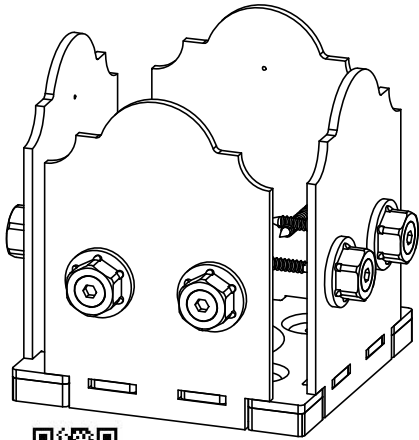

56608

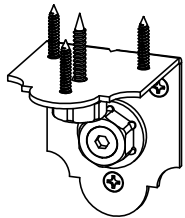

56618

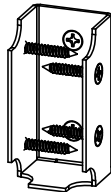

56641



56650



56680

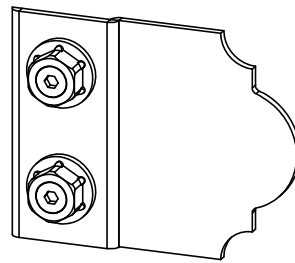

56611

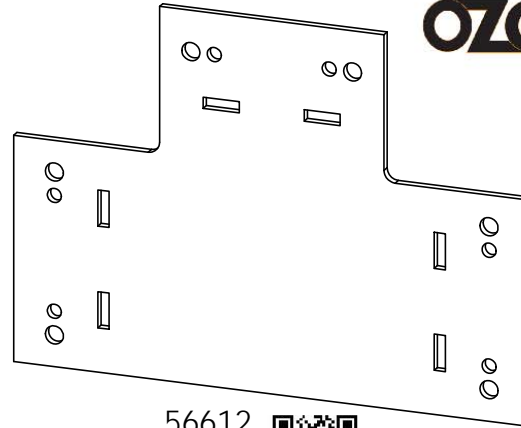

56612

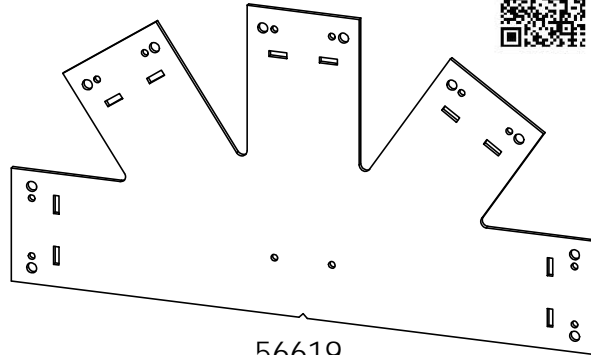

56619

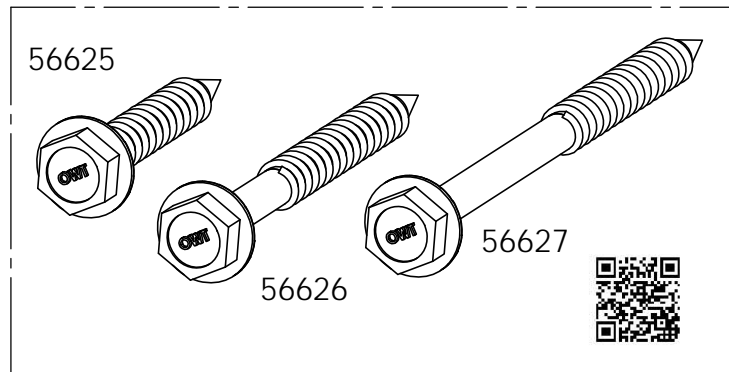

56625

56626

56627



56616

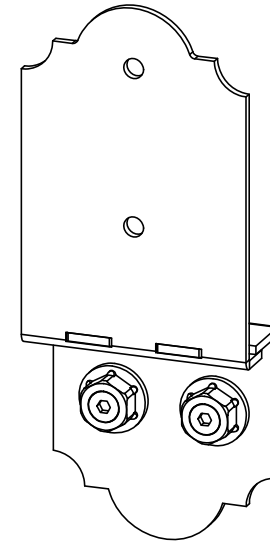
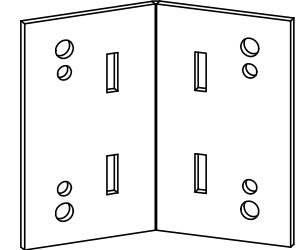

56636

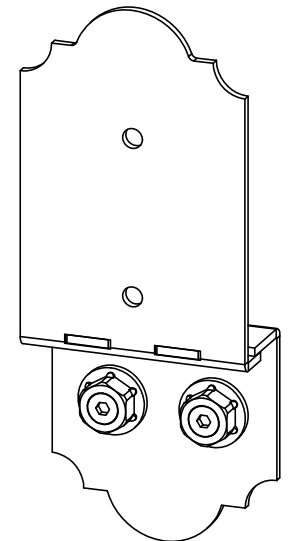

56637



