

DESIGN

PURCHASE

CONSTRUCT

ENJOY

**OZCO Project
#334 - 10x10x16
Corner Pergola**

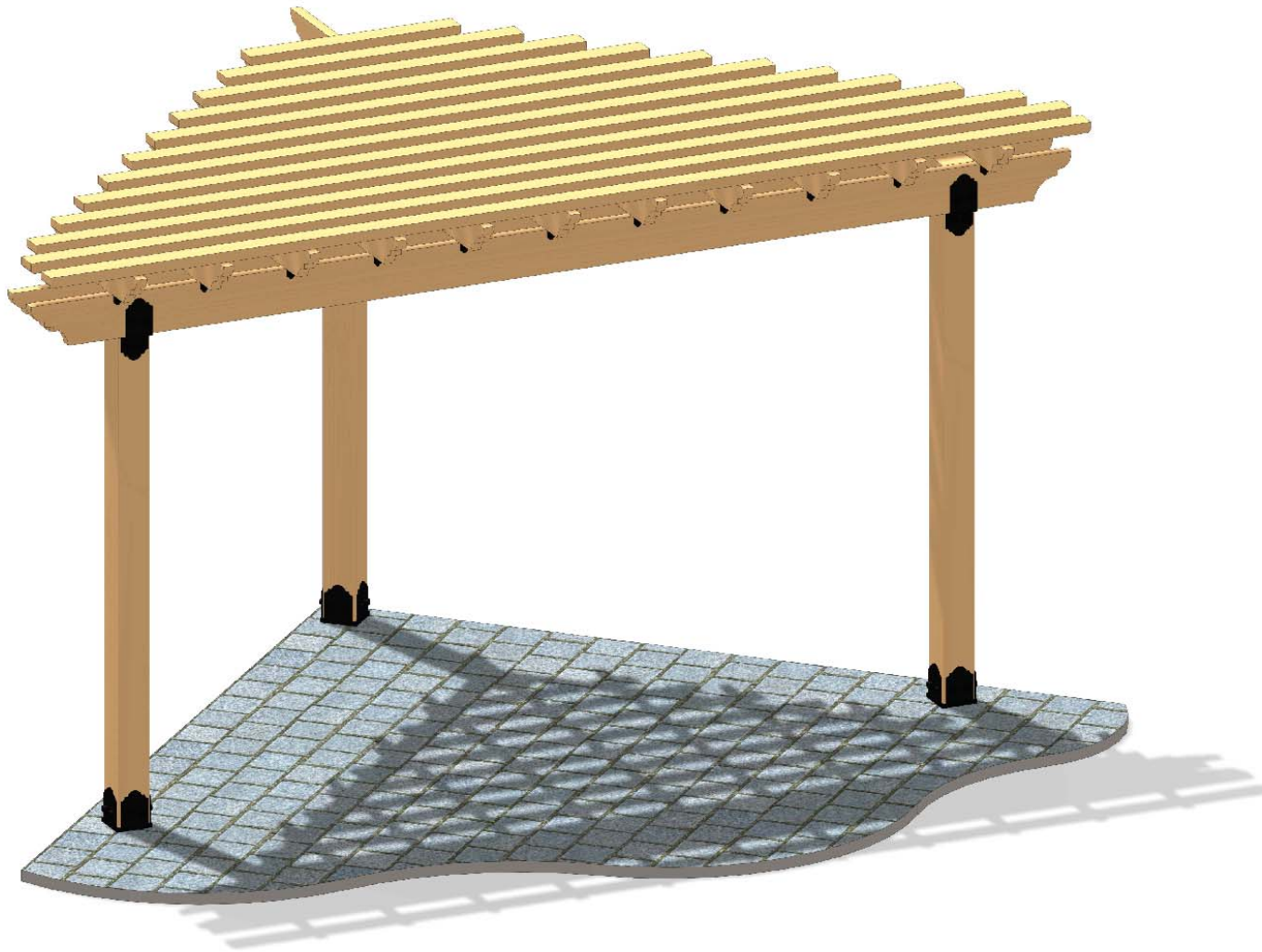

**OZCO Project #334 - 10x10x16 Corner
Pergola**



OZCO BUILDING PRODUCTS

V2.00 - Installation Instructions, Specifications and Project Plans are effective May 1, 2015 and reflects information that available as of April 10, 2014. This information is updated periodically and should not be relied upon after October 15, 2016. Please visit www.OZCOBP.com to get current information.

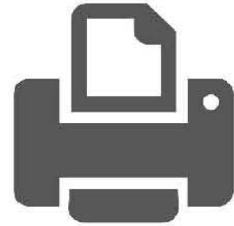

Printing Documents from ISSUU

Unfortunately, there is currently no way to print content directly through issuu. To print a publication, you will need to download it and print it from your computer.

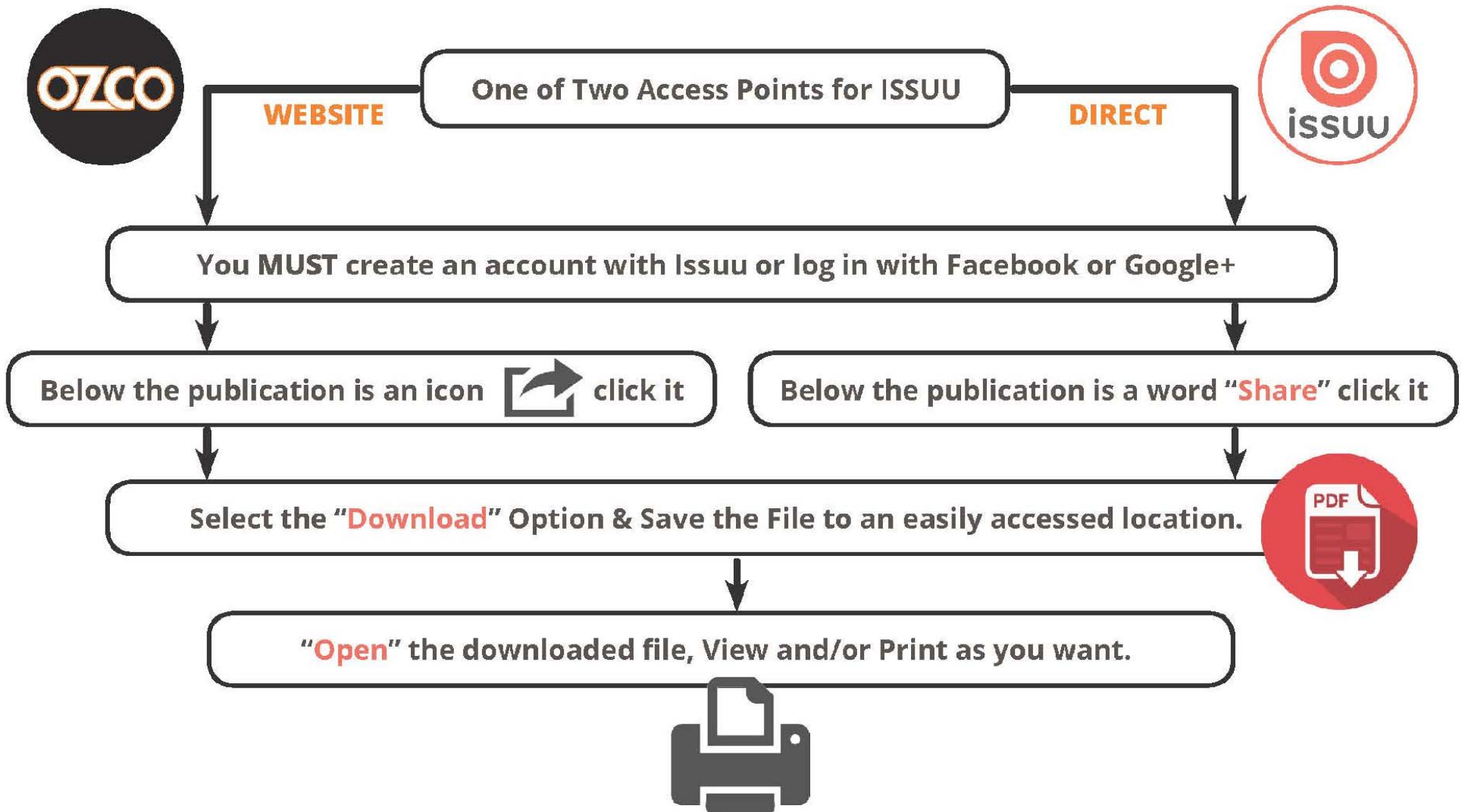

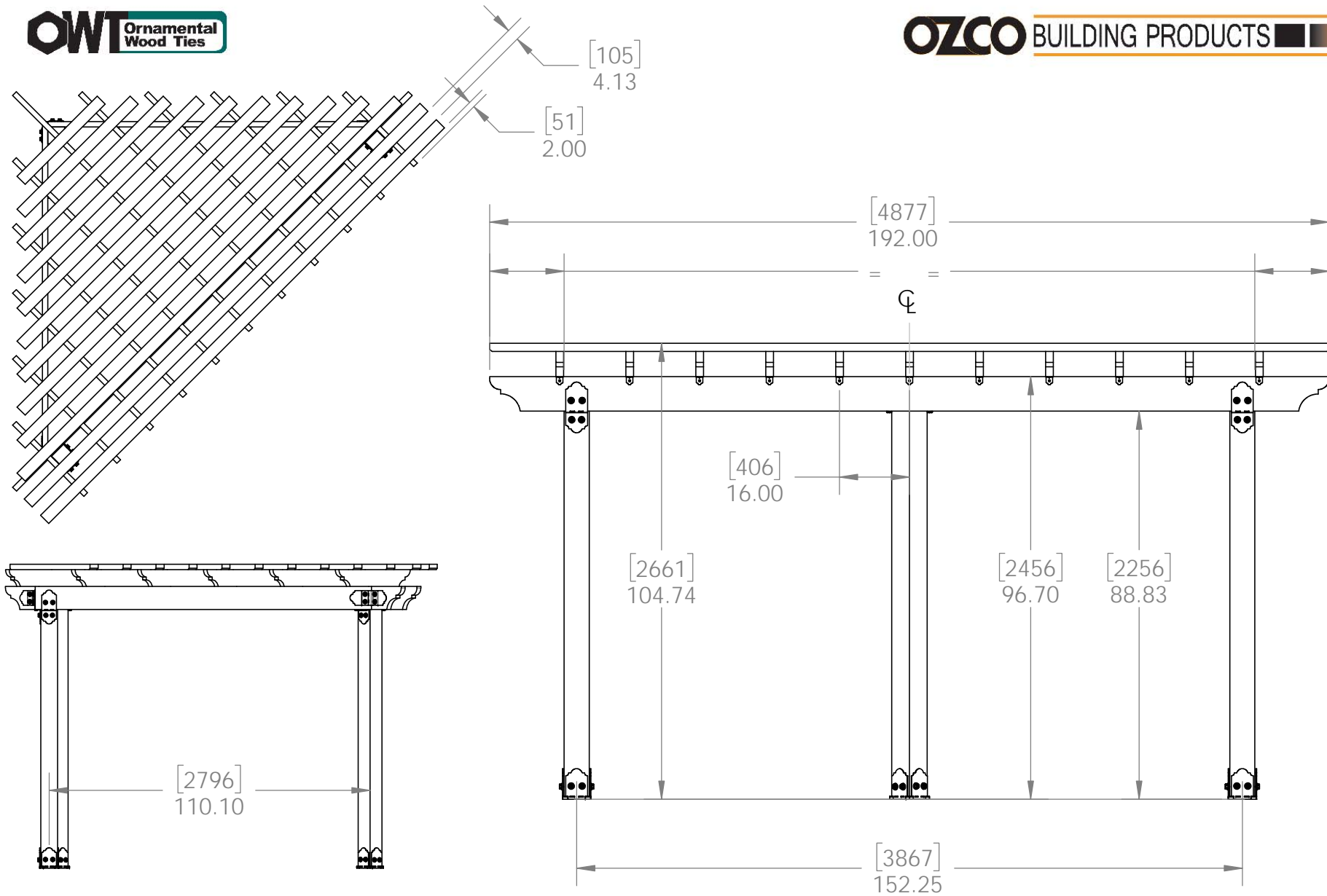

Overview

OZCO Project #334 - 10x10x16 Corner Pergola

V2.00 - Installation Instructions, Specifications and Project Plans are effective May 1, 2015 and reflects information that available as of April 10, 2014. This information is updated periodically and should not be relied upon after October 15, 2016. Please visit www.OZCOBP.com to get current information.

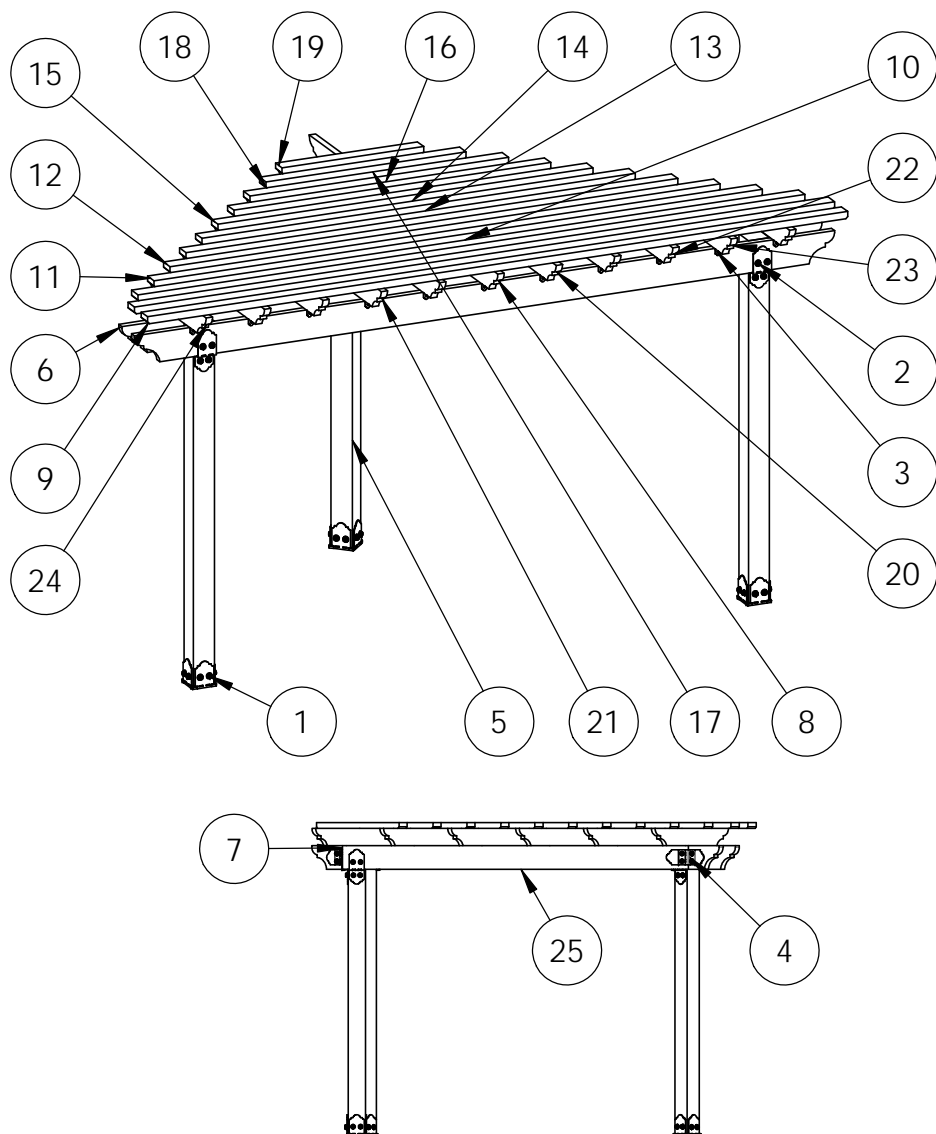

ITEM NO.	QTY.	PART NUMBER	DESCRIPTION
1	3	56608	6x6 Post Base (6x6-PB-LS)
2	3	56610	8" Post to Beam (P2B-LS-8)
3	1.9	56617	2" Standard Rafter Clip (RC-LS-2)
4	1	56616	Flush Inside 45 (FI-45)
	1	56611	Truss Accent (TA-LS)
	0.08	56625	OWT Timber Screw 1-3/4"
5	3	6x6 Cedar Post	6x6x96.00
6	2	2x8 Cedar Board	2x8x192.00
7	1	2x8 Cedar Board	2x8x113.45
8	1	2x6 Cedar Board	2x6x114.56
9	2	2x4 Cedar Board	2x4x192.00
10	1	2x4 Cedar Board	2x4x182.88
11	1	2x4 Cedar Board	2x4x166.88
12	1	2x4 Cedar Board	2x4x150.88
13	1	2x4 Cedar Board	2x4x134.88
14	1	2x4 Cedar Board	2x4x118.88
15	1	2x4 Cedar Board	2x4x102.88
16	1	2x4 Cedar Board	2x4x86.88
17	1	2x4 Cedar Board	2x4x70.88
18	1	2x4 Cedar Board	2x4x54.88
19	1	2x4 Cedar Board	2x4x38.88
20	2	2x6 Cedar Board	2x6x98.56
21	2	2x6 Cedar Board	2x6x82.56
22	2	2x6 Cedar Board	2x6x66.56
23	2	2x6 Cedar Board	2x6x50.56
24	2	2x6 Cedar Board	2x6x34.56
25	1	2x8 Cedar Board	2x8x115.32

Overview

OZCO Project #334 - 10x10x16 Corner Pergola

V2.00 - Installation Instructions, Specifications and Project Plans are effective May 1, 2015 and reflects information that available as of April 10, 2014. This information is updated periodically and should not be relied upon after October 15, 2016. Please visit www.OZCOBP.com to get current information.



56608

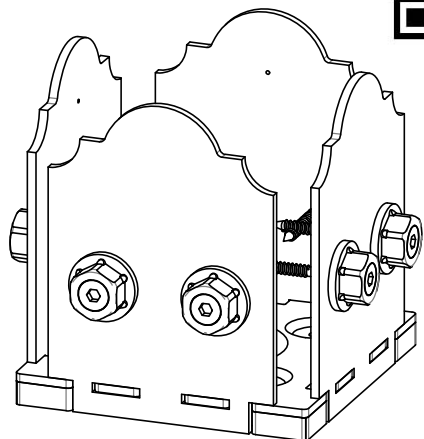

56610

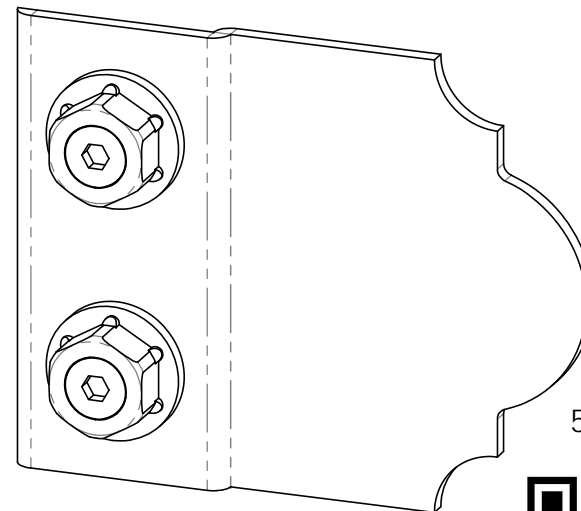
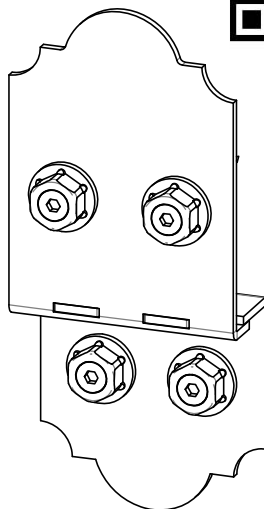

56611

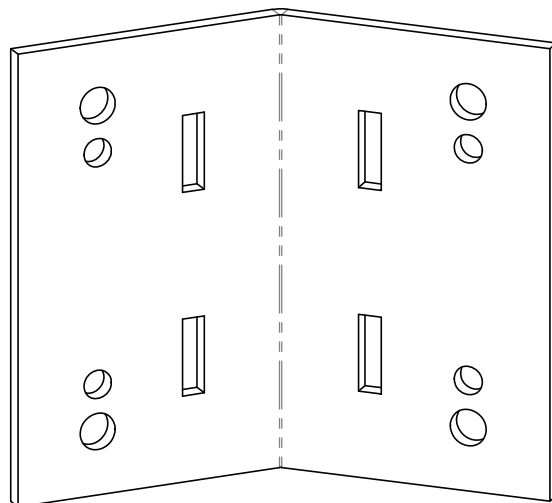

56616

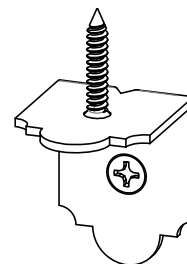

56617

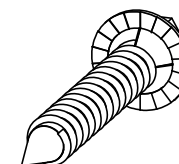

56625



OZCO

**OZCO Project #334 - 10x10x16 Corner
Pergola**

V2.00 - Installation Instructions, Specifications and Project Plans are effective May 1, 2015 and reflects information that available as of April 10, 2014. This information is updated periodically and should not be relied upon after October 15, 2016. Please visit www.OZCOBP.com to get current information.

DESIGN

PURCHASE

CONSTRUCT

ENJOY

Laredo Sunset vs. Ironwood

2 great styles
same functionality

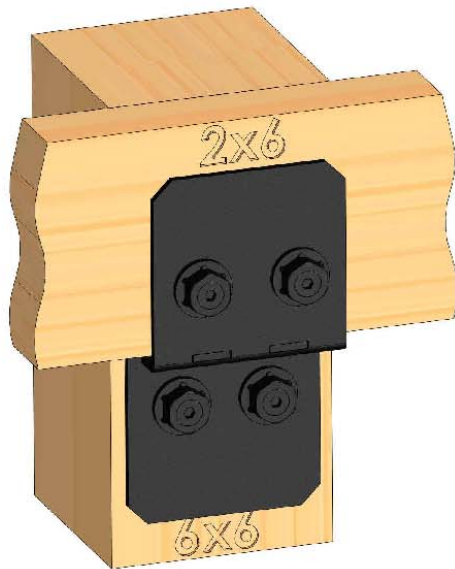

Ironwood
(517XX series)

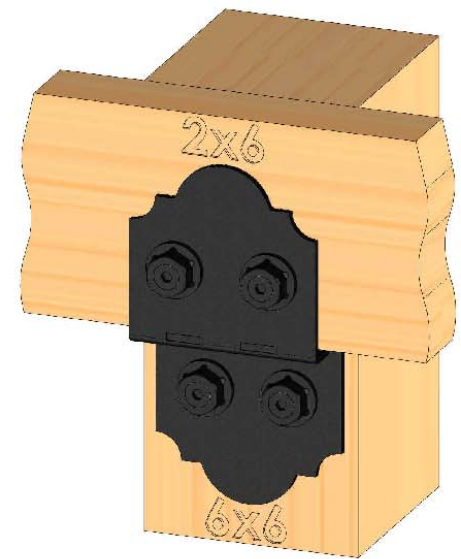

Laredo Sunset
(566XX series)

choose your connection lifestyle
both styles available for most products



OZCO BUILDING PRODUCTS

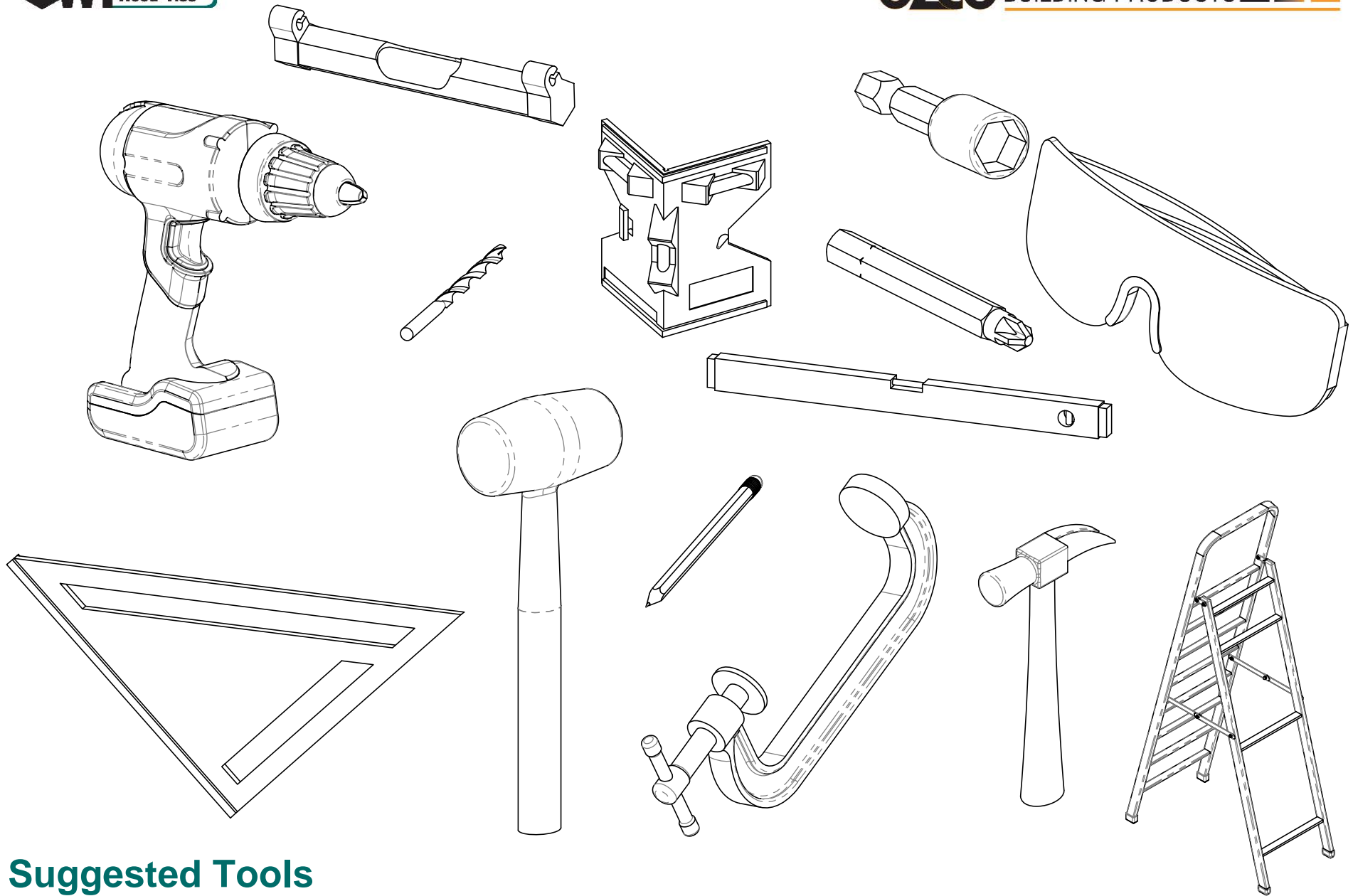

Suggested Tools

(others may be required)

**OZCO Project #334 - 10x10x16 Corner
Pergola**

V2.00 - Installation Instructions, Specifications and Project Plans are effective May 1, 2015 and reflects information that available as of April 10, 2014. This information is updated periodically and should not be relied upon after October 15, 2016. Please visit www.OZCOBP.com to get current information.

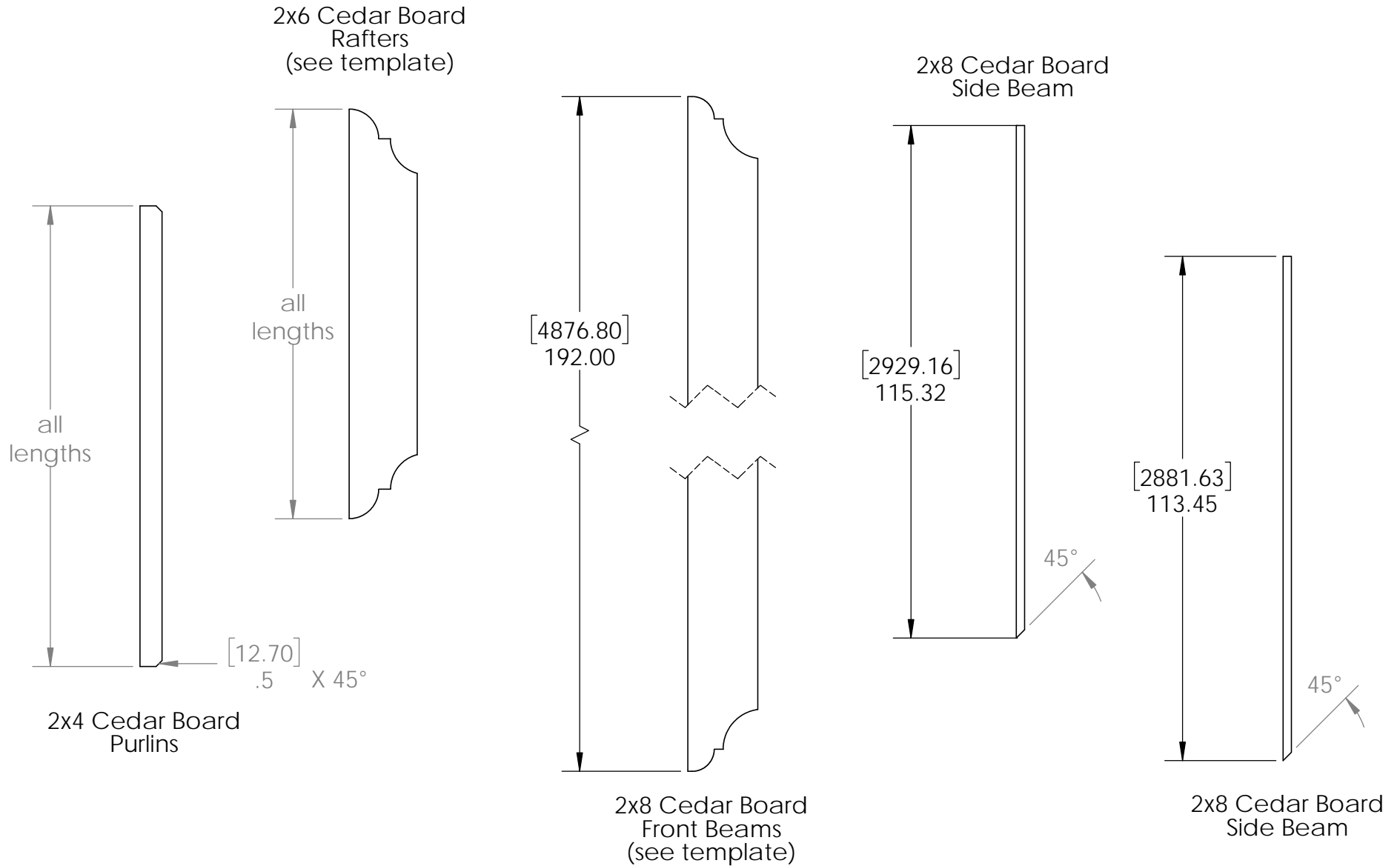

Cutlist

OZCO Project #334 - 10x10x16 Corner
Pergola

V2.00 - Installation Instructions, Specifications and Project Plans are effective May 1, 2015 and reflects information that available as of April 10, 2014. This information is updated periodically and should not be relied upon after October 15, 2016. Please visit www.OZCOBP.com to get current information.

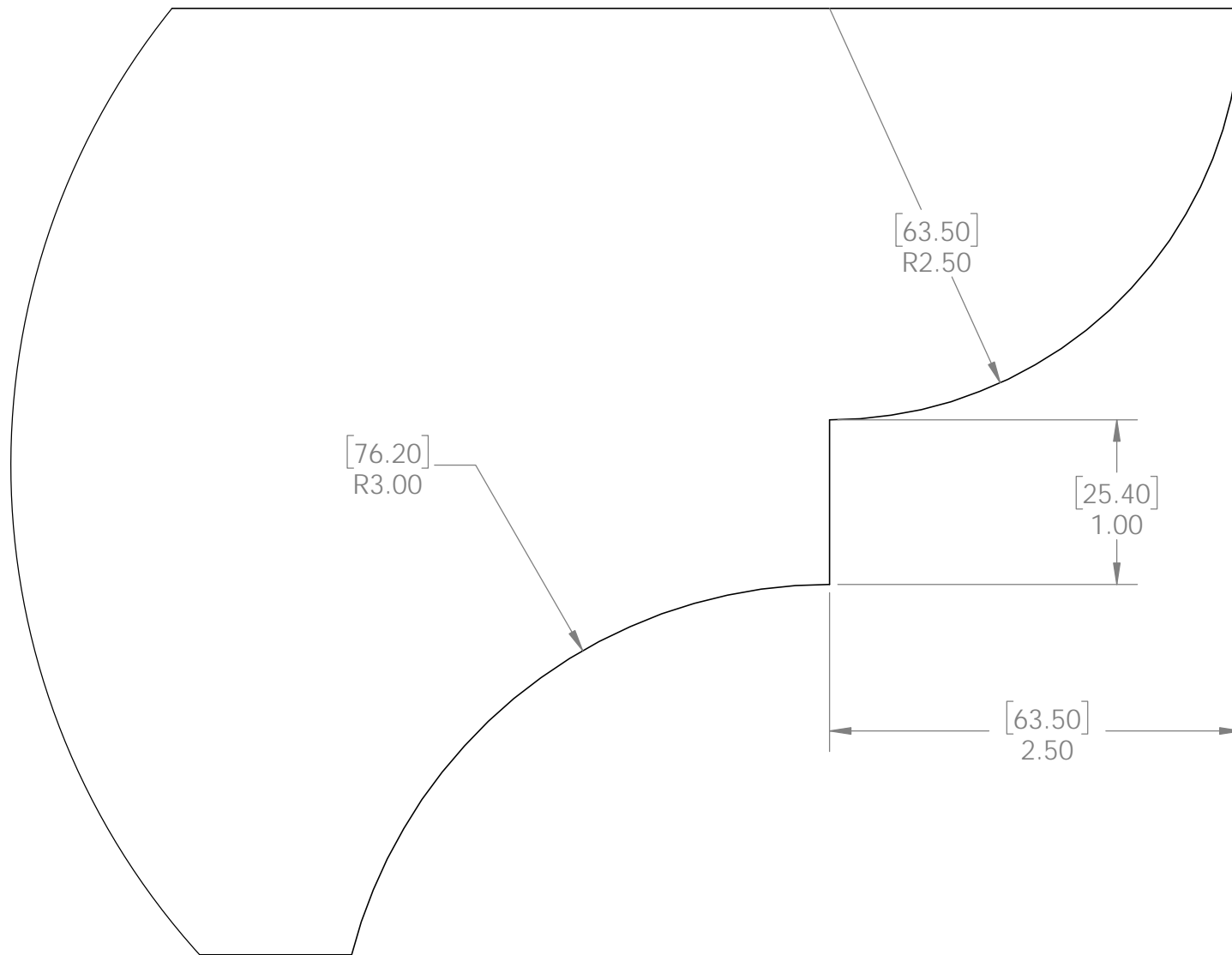

Template 2x6

1:1 scale

OZCO Project #334 - 10x10x16 Corner
Pergola

V2.00 - Installation Instructions, Specifications and Project Plans are effective May 1, 2015 and reflects information that available as of April 10, 2014. This information is updated periodically and should not be relied upon after October 15, 2016. Please visit www.OZCOBP.com to get current information.

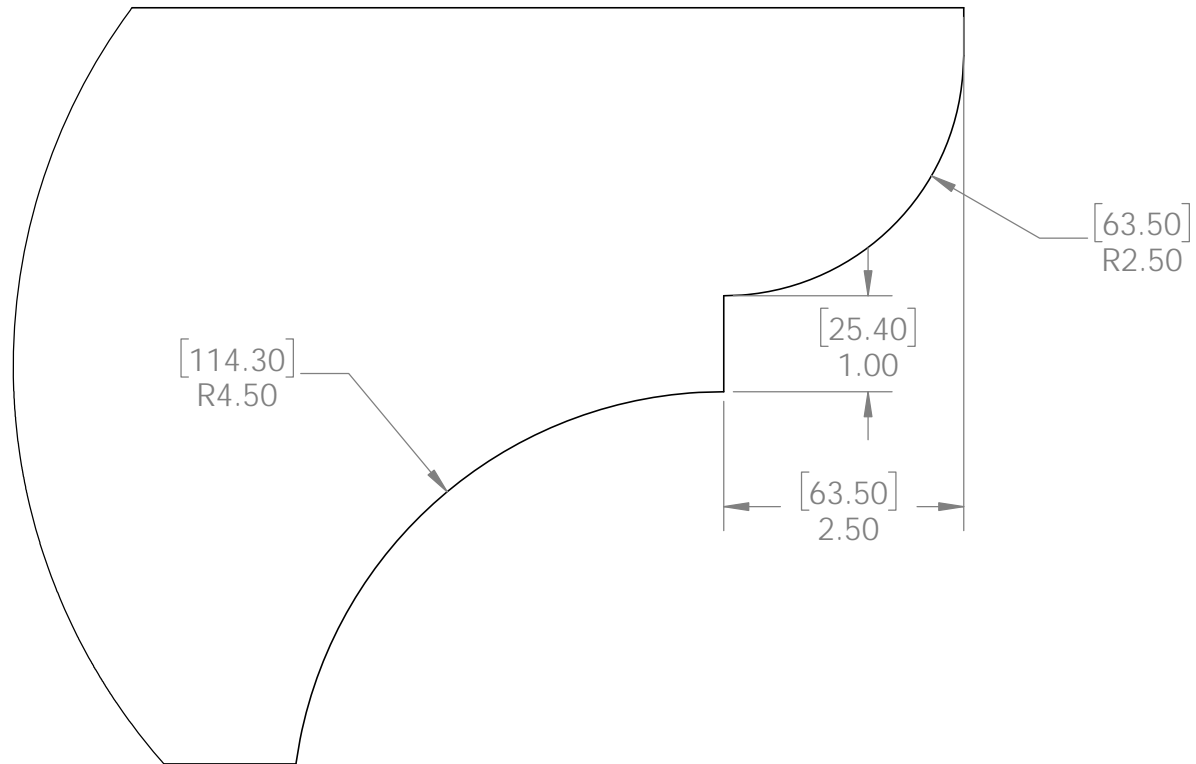

Template 2x8

1:2 scale

OZCO Project #334 - 10x10x16 Corner
Pergola

V2.00 - Installation Instructions, Specifications and Project Plans are effective May 1, 2015 and reflects information that available as of April 10, 2014. This information is updated periodically and should not be relied upon after October 15, 2016. Please visit www.OZCOBP.com to get current information.

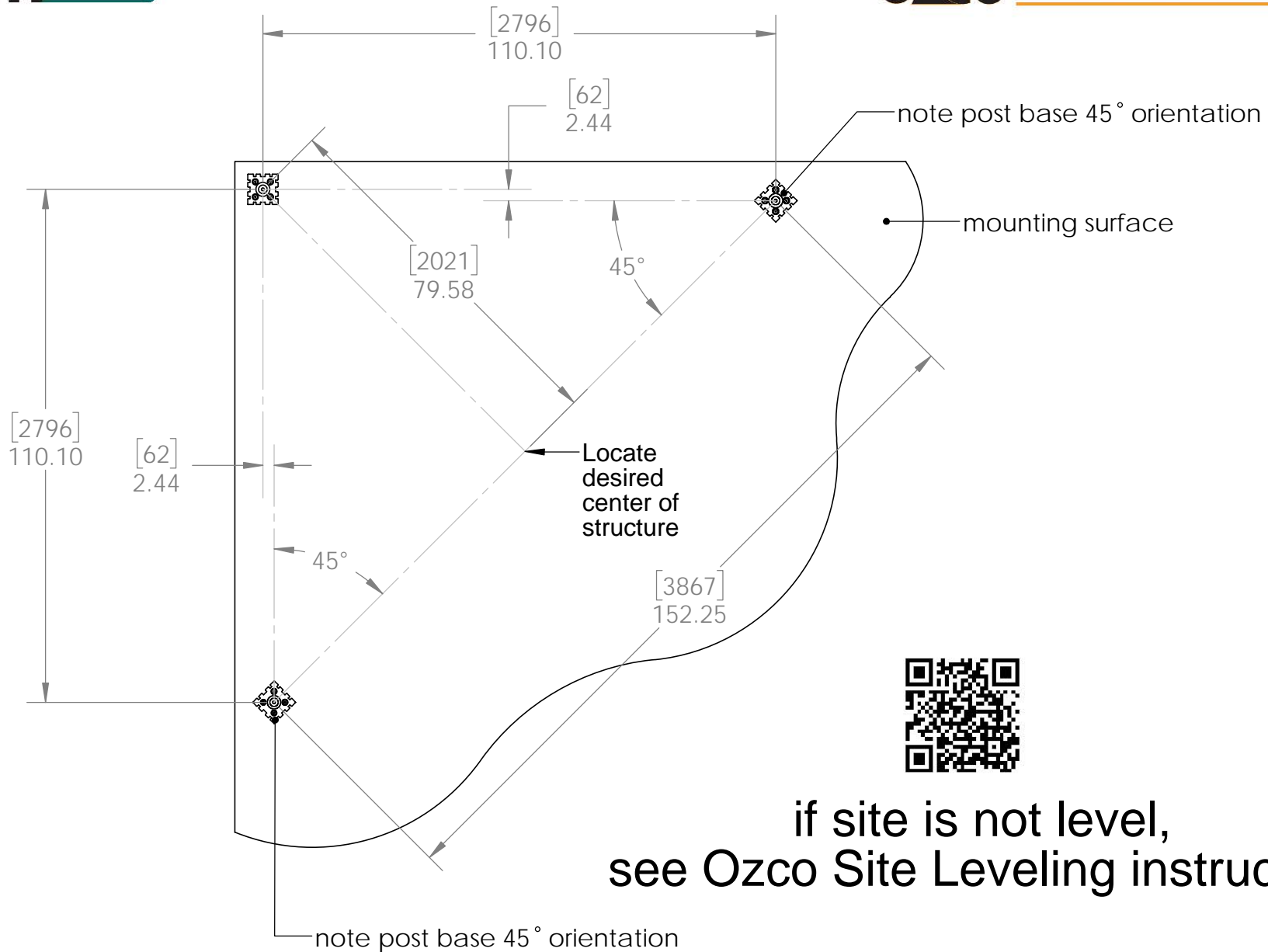

if site is not level,
see Ozco Site Leveling instruction

site

OZCO Project #334 - 10x10x16 Corner Pergola

V2.00 - Installation Instructions, Specifications and Project Plans are effective May 1, 2015 and reflects information that available as of April 10, 2014. This information is updated periodically and should not be relied upon after October 15, 2016. Please visit www.OZCOBP.com to get current information.

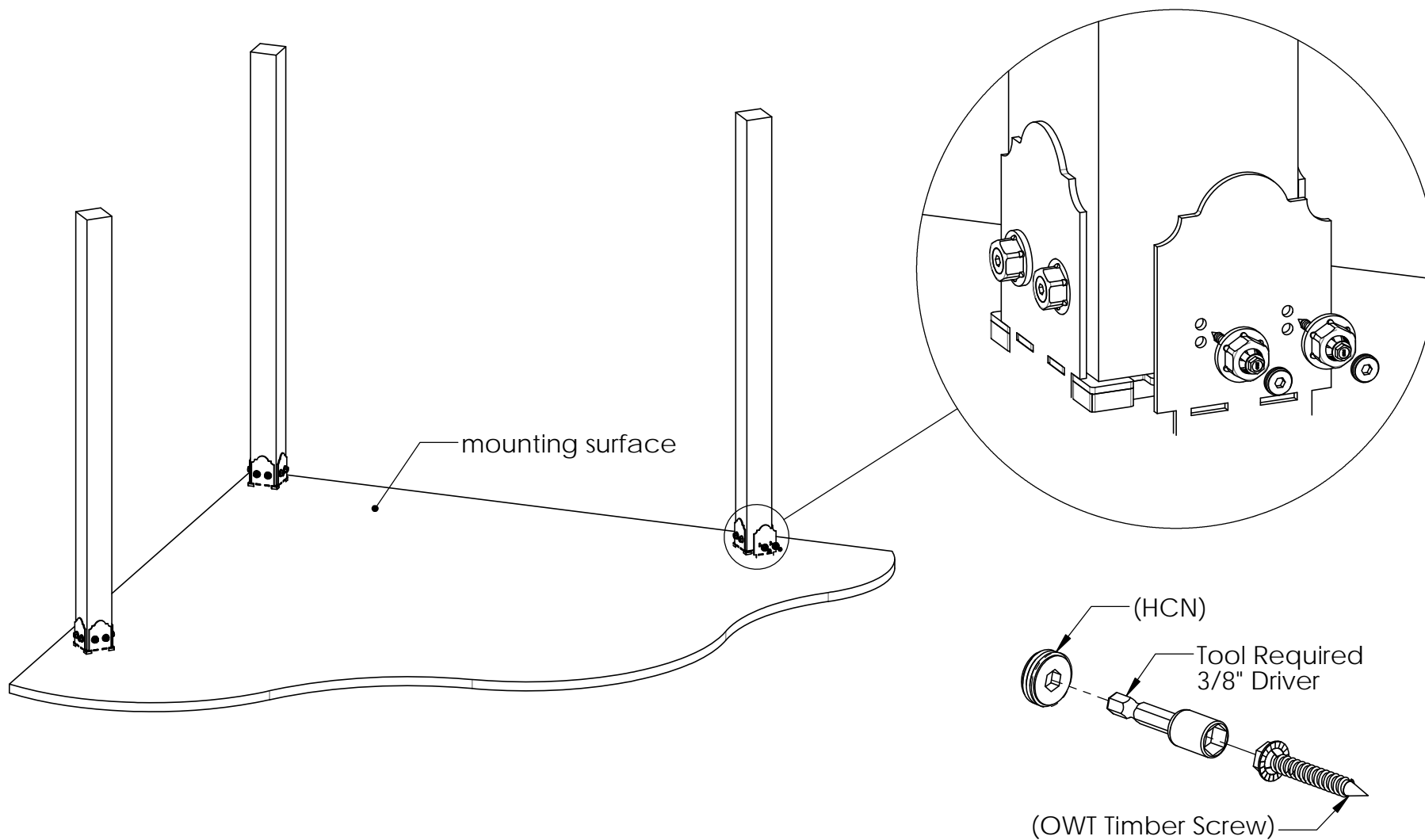

step 1

**OZCO Project #334 - 10x10x16 Corner
Pergola**

reference Overview page for dimensions (if needed)

V2.00 - Installation Instructions, Specifications and Project Plans are effective May 1, 2015 and reflects information that available as of April 10, 2014. This information is updated periodically and should not be relied upon after October 15, 2016. Please visit www.OZCOBP.com to get current information.

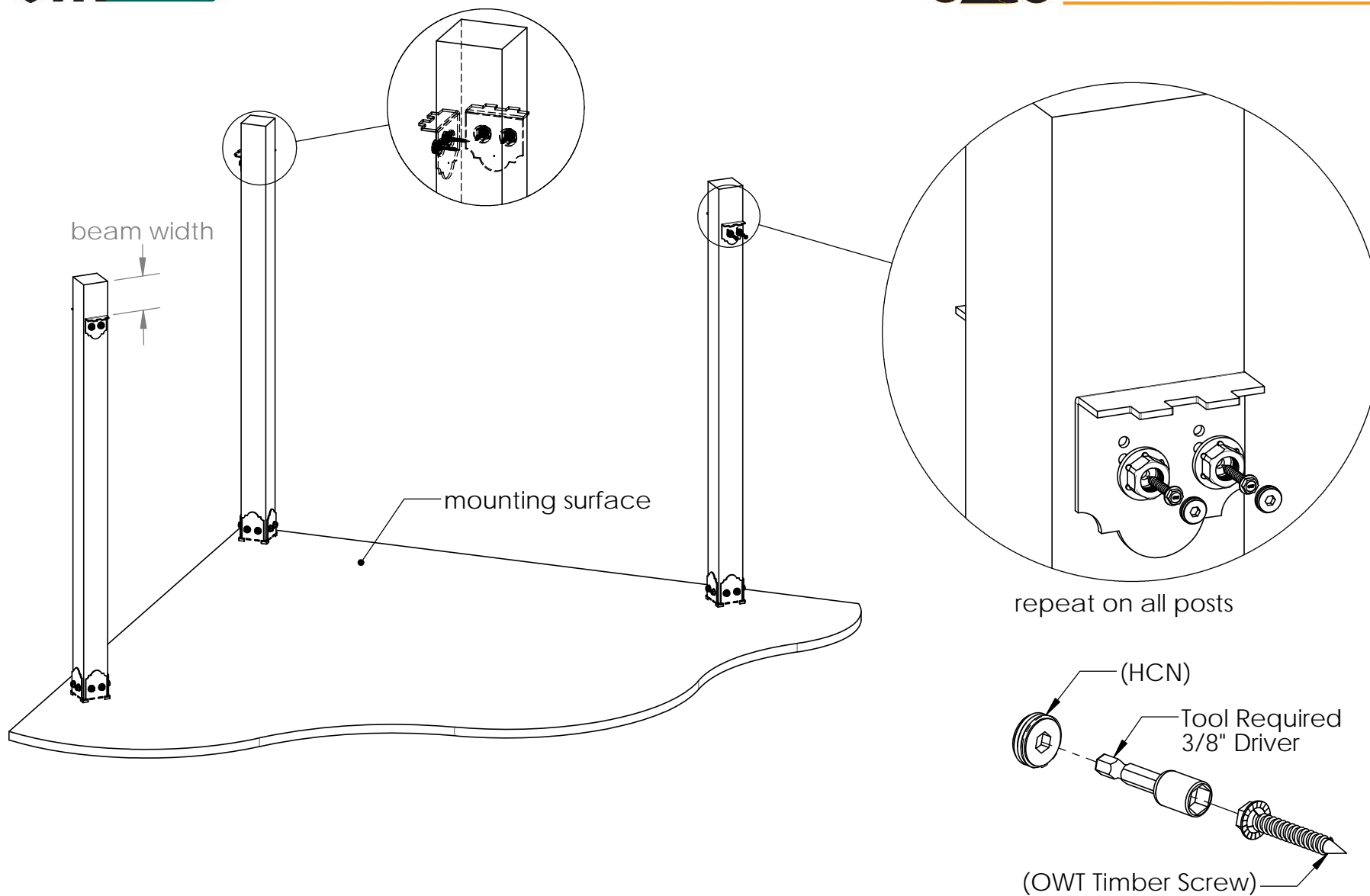

step 2

**OZCO Project #334 - 10x10x16 Corner
Pergola**

reference Overview page for dimensions (if needed)

V2.00 - Installation Instructions, Specifications and Project Plans are effective May 1, 2015 and reflects information that available as of April 10, 2014. This information is updated periodically and should not be relied upon after October 15, 2016. Please visit www.OZCOBP.com to get current information.

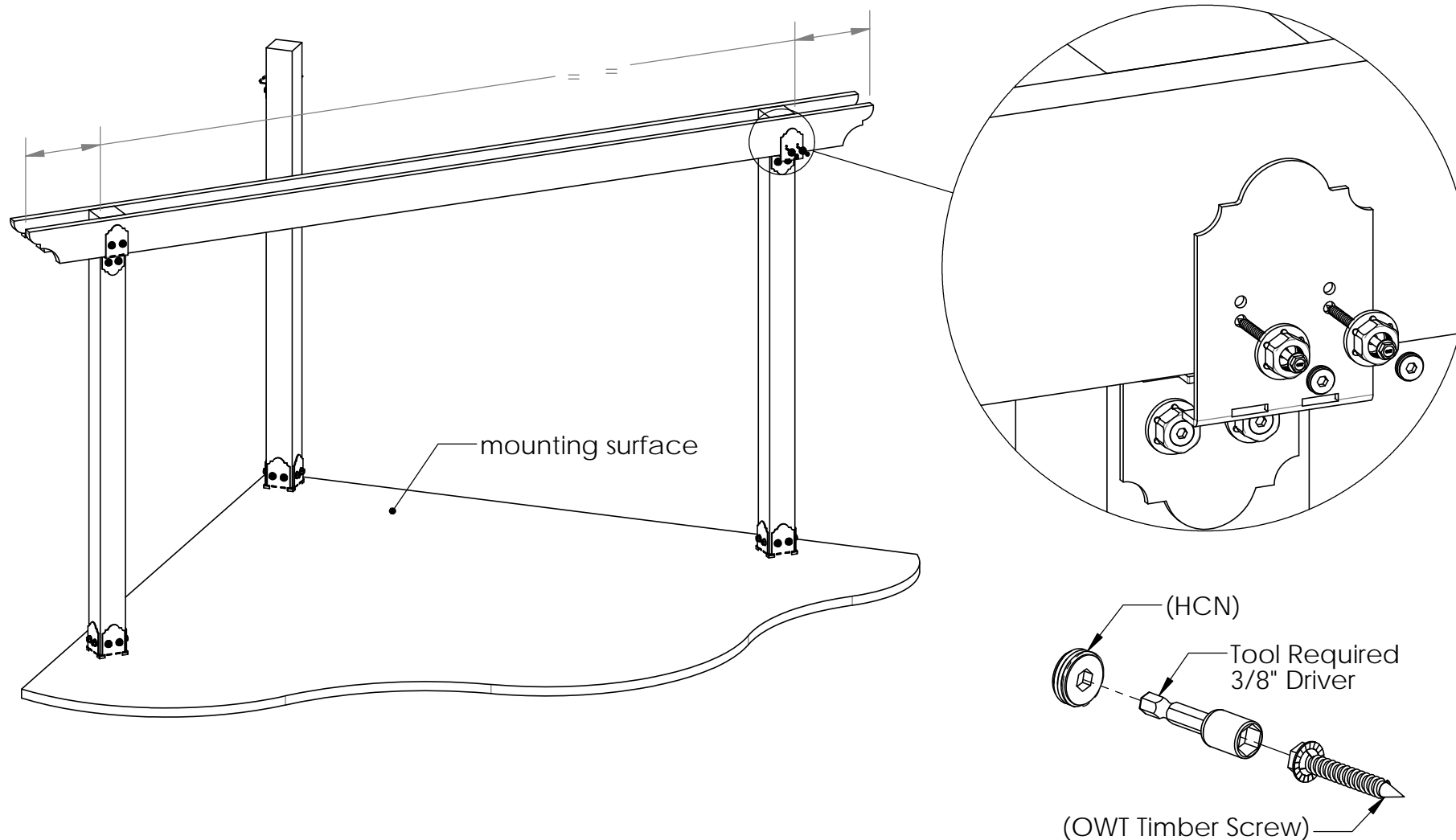

step 3

OZCO Project #334 - 10x10x16 Corner
Pergola

reference Overview page for dimensions (if needed)

V2.00 - Installation Instructions, Specifications and Project Plans are effective May 1, 2015 and reflects information that available as of April 10, 2014. This information is updated periodically and should not be relied upon after October 15, 2016. Please visit www.OZCOBP.com to get current information.

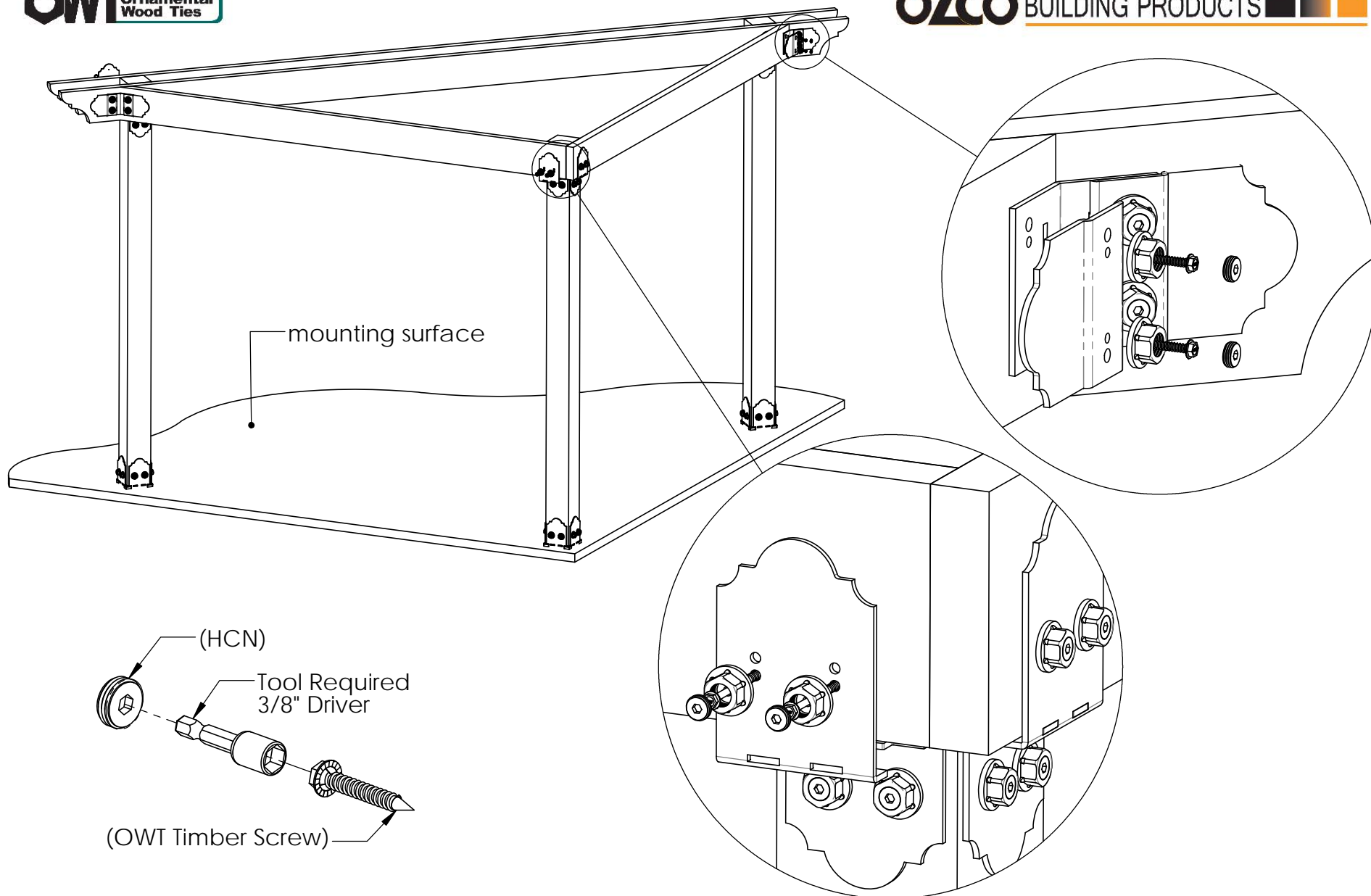

step 4

**OZCO Project #334 - 10x10x16 Corner
Pergola**

reference Overview page for dimensions (if needed)

V2.00 - Installation Instructions, Specifications and Project Plans are effective May 1, 2015 and reflects information that available as of April 10, 2014. This information is updated periodically and should not be relied upon after October 15, 2016. Please visit www.OZCOBP.com to get current information.

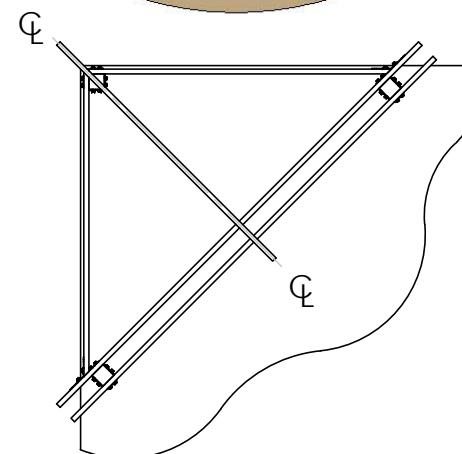
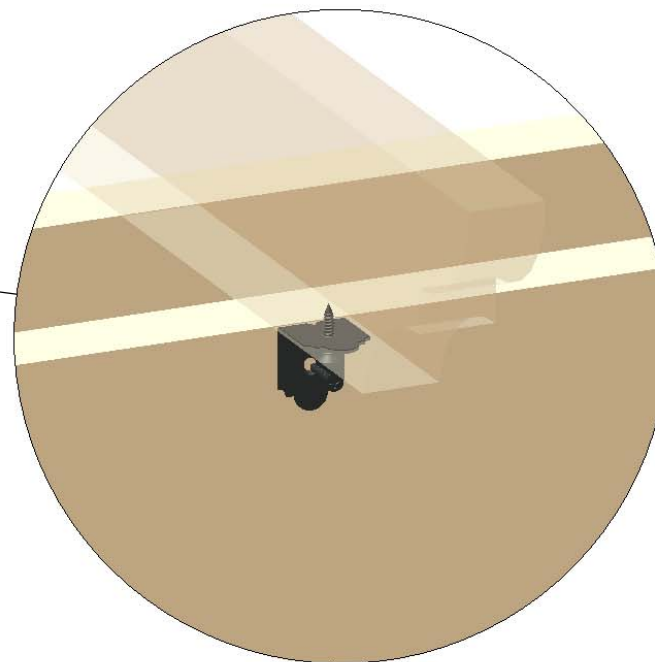
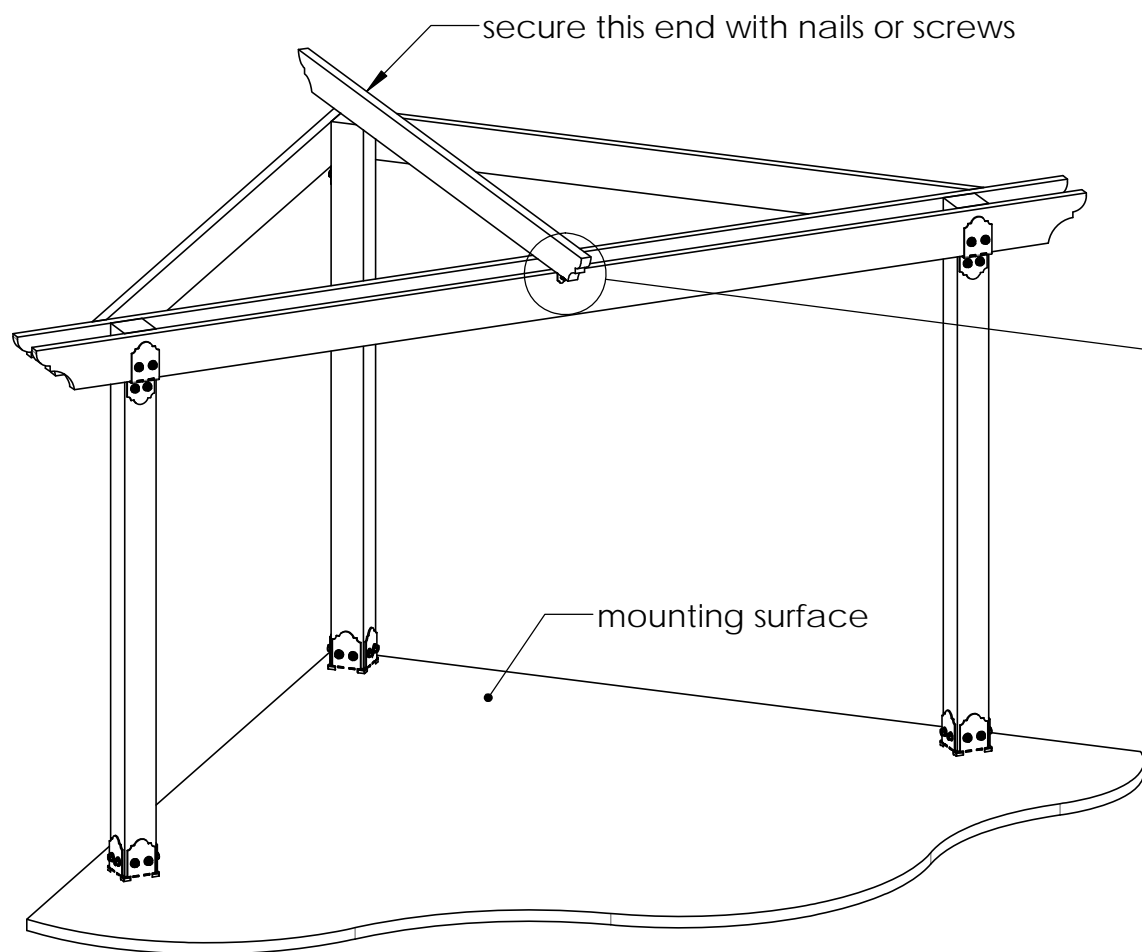

step 5

OZCO Project #334 - 10x10x16 Corner
Pergola

reference Overview page for dimensions (if needed)

V2.00 - Installation Instructions, Specifications and Project Plans are effective May 1, 2015 and reflects information that available as of April 10, 2014. This information is updated periodically and should not be relied upon after October 15, 2016. Please visit www.OZCOBP.com to get current information.

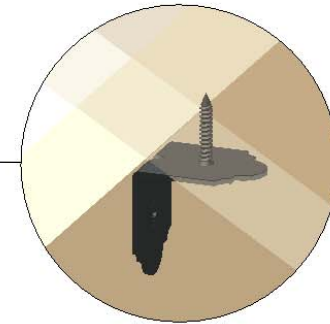
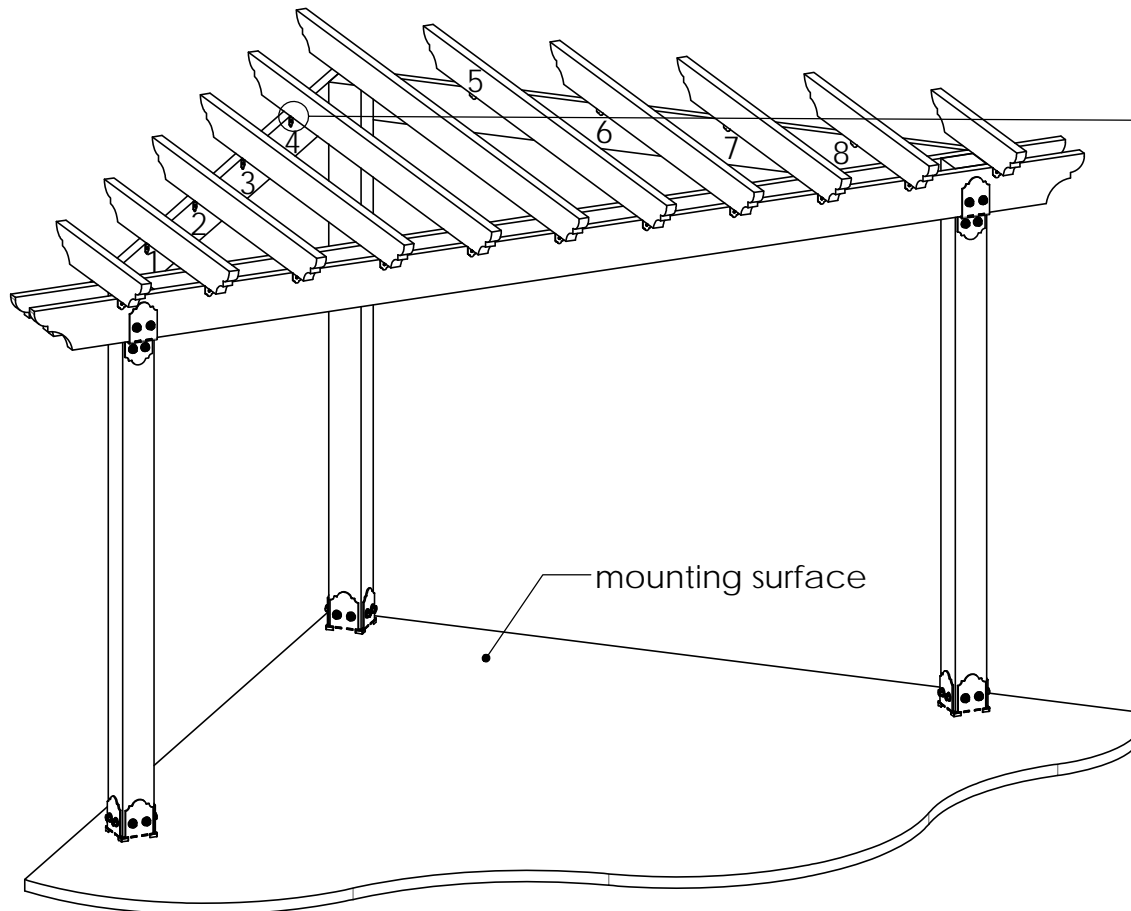

repeat 8x

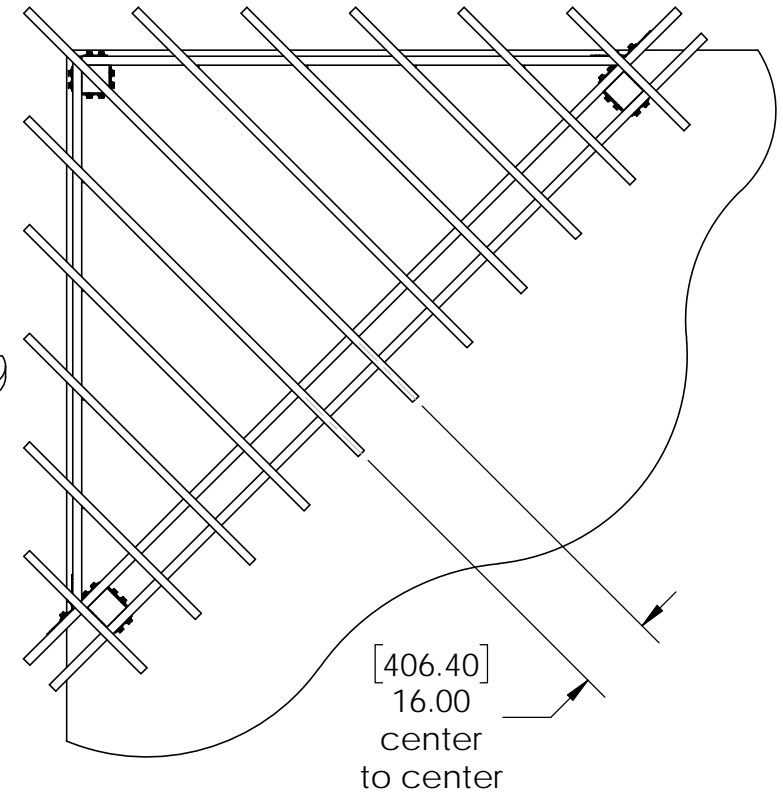

step 5 (con't)

OZCO Project #334 - 10x10x16 Corner
Pergola

reference Overview page for dimensions (if needed)

V2.00 - Installation Instructions, Specifications and Project Plans are effective May 1, 2015 and reflects information that available as of April 10, 2014. This information is updated periodically and should not be relied upon after October 15, 2016. Please visit www.OZCOBP.com to get current information.

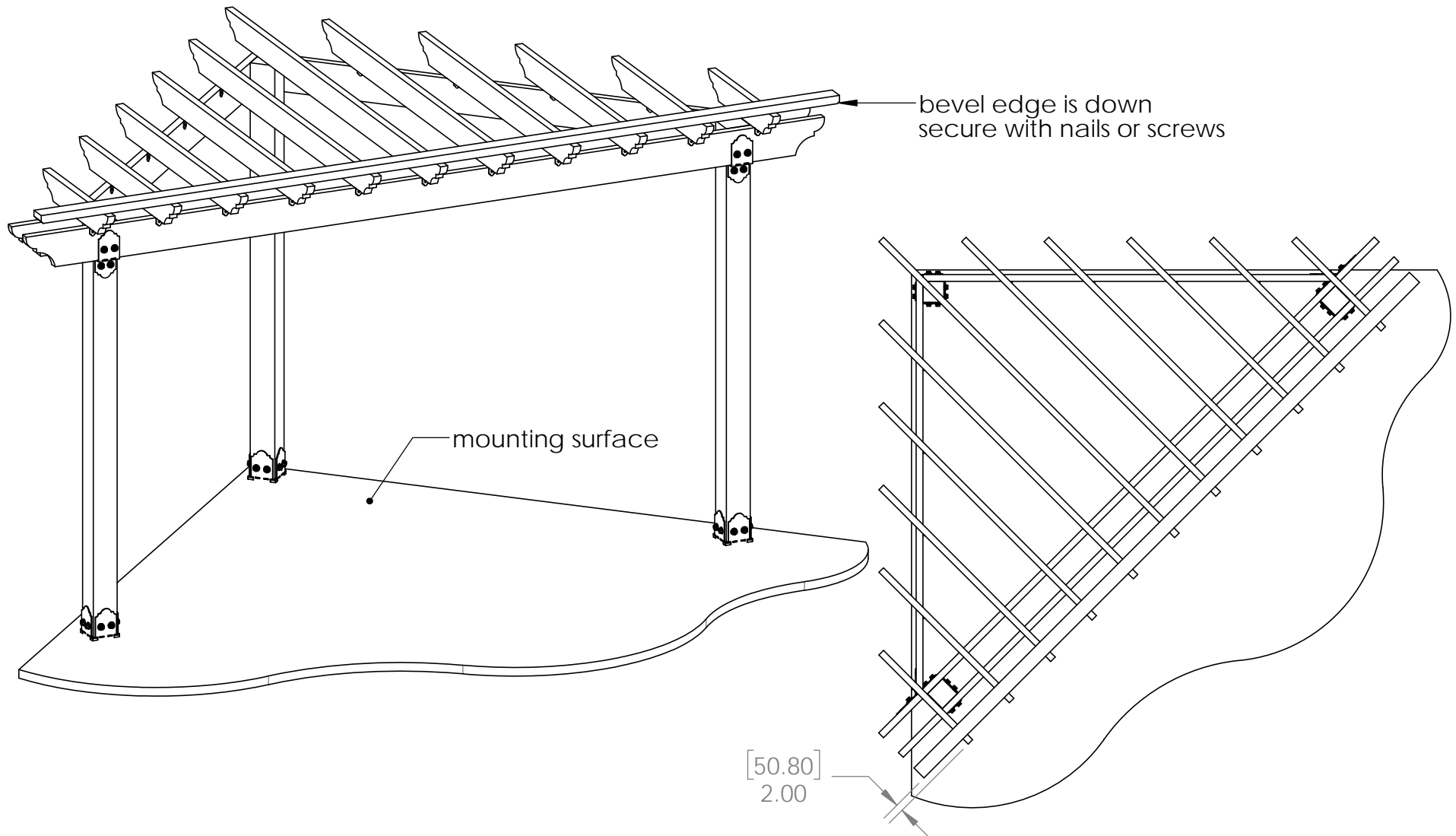

step 6

OZCO Project #334 - 10x10x16 Corner
Pergola

reference Overview page for dimensions (if needed)

V2.00 - Installation Instructions, Specifications and Project Plans are effective May 1, 2015 and reflects information that available as of April 10, 2014. This information is updated periodically and should not be relied upon after October 15, 2016. Please visit www.OZCOBP.com to get current information.

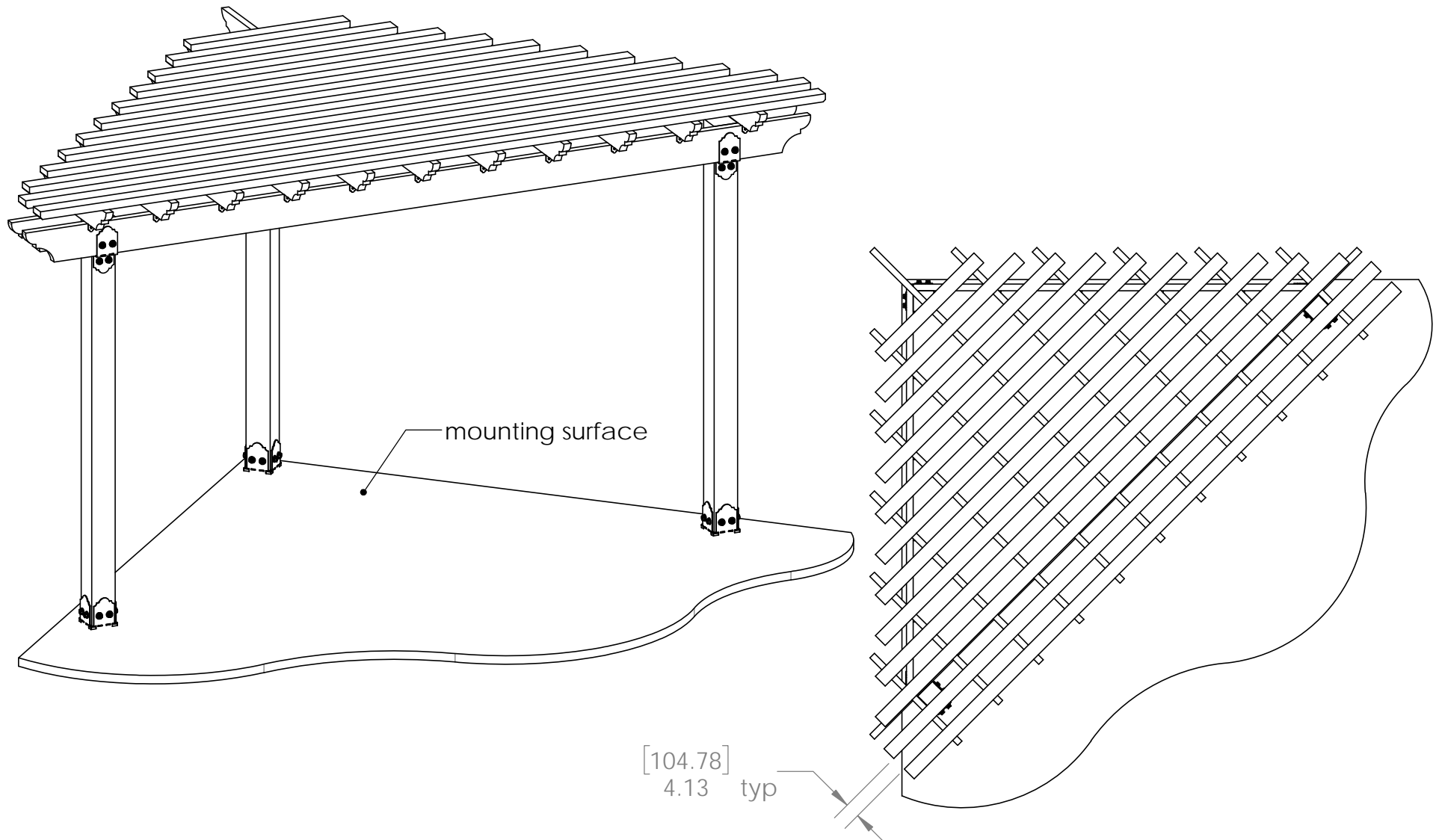

step 6 (con't)

OZCO Project #334 - 10x10x16 Corner
Pergola

reference Overview page for dimensions (if needed)

V2.00 - Installation Instructions, Specifications and Project Plans are effective May 1, 2015 and reflects information that available as of April 10, 2014. This information is updated periodically and should not be relied upon after October 15, 2016. Please visit www.OZCOBP.com to get current information.