

DESIGN

PURCHASE

CONSTRUCT

ENJOY

**OZCO Project #331
- 10x10 Pergola with
6x6 Posts**

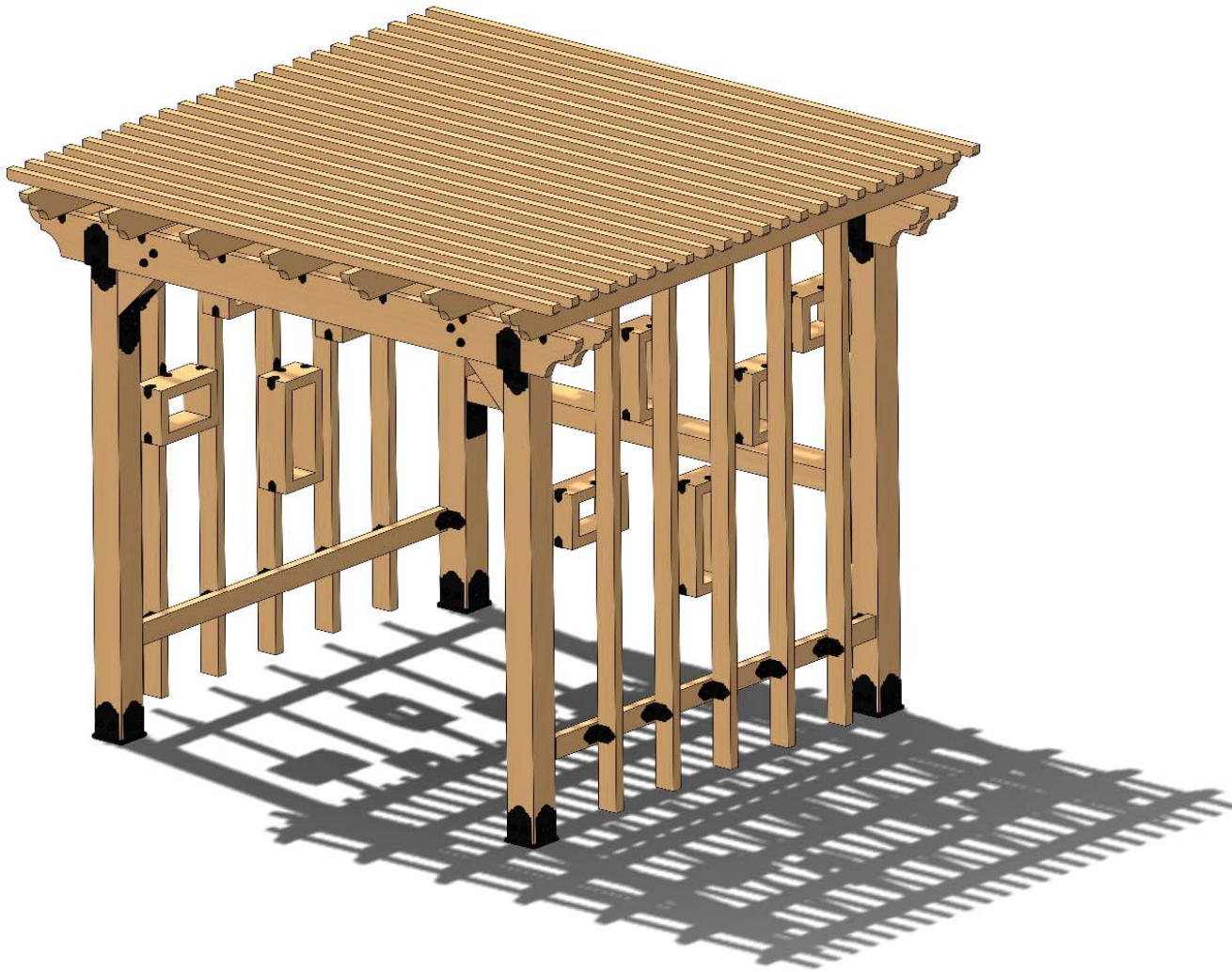

shown with optional Shadow Boxes



OZCO BUILDING PRODUCTS

OZCO Project #331 - 10x10 Pergola with 6x6 Posts

V1.00 - Installation Instructions effective May 1, 2015 and reflects information that available as of April 10, 2014. This information is updated periodically and should not be relied upon after May 1, 2015. Please visit www.OZCOBP.com to get current information



Printing Documents from ISSUU

Unfortunately, there is currently no way to print content directly through issuu. To print a publication, you will need to download it and print it from your computer.

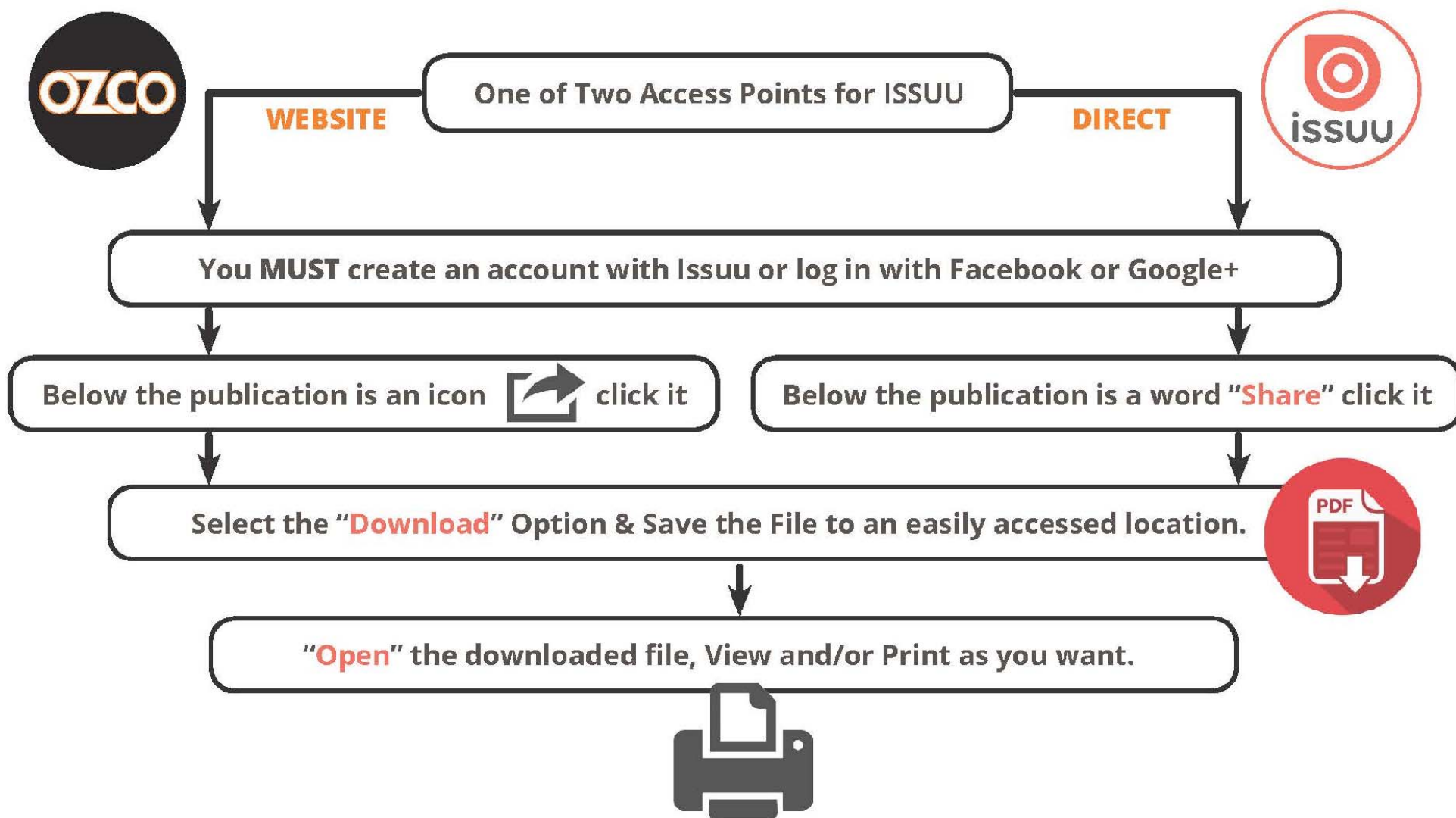

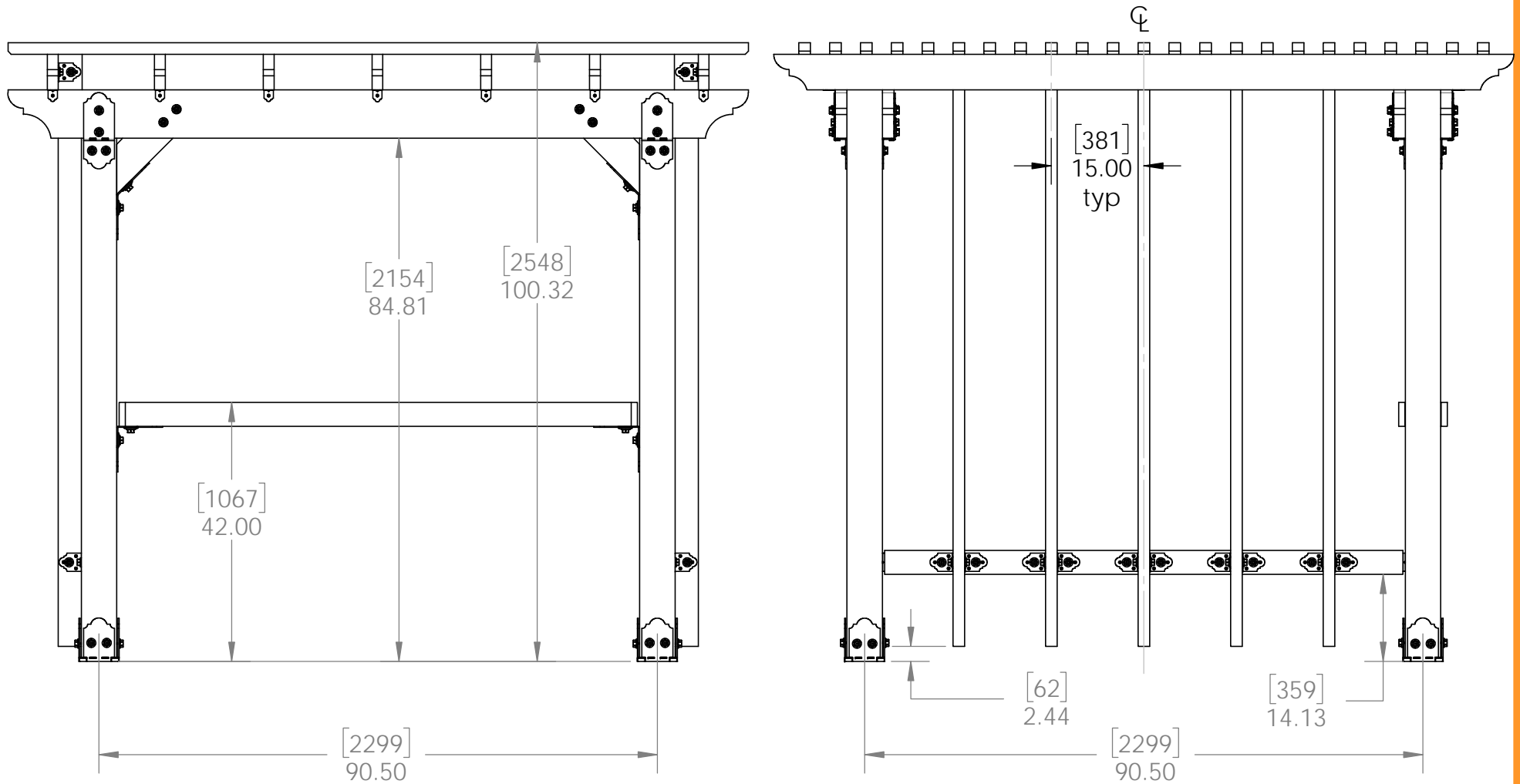

Overview-Front & Right

OZCO Project #331 - 10x10 Pergola with 6x6 Posts

V1.00 - Installation Instructions effective May 1, 2015 and reflects information that available as of April 10, 2014. This information is updated periodically and should not be relied upon after May 1, 2015. Please visit www.OZCOBP.com to get current information

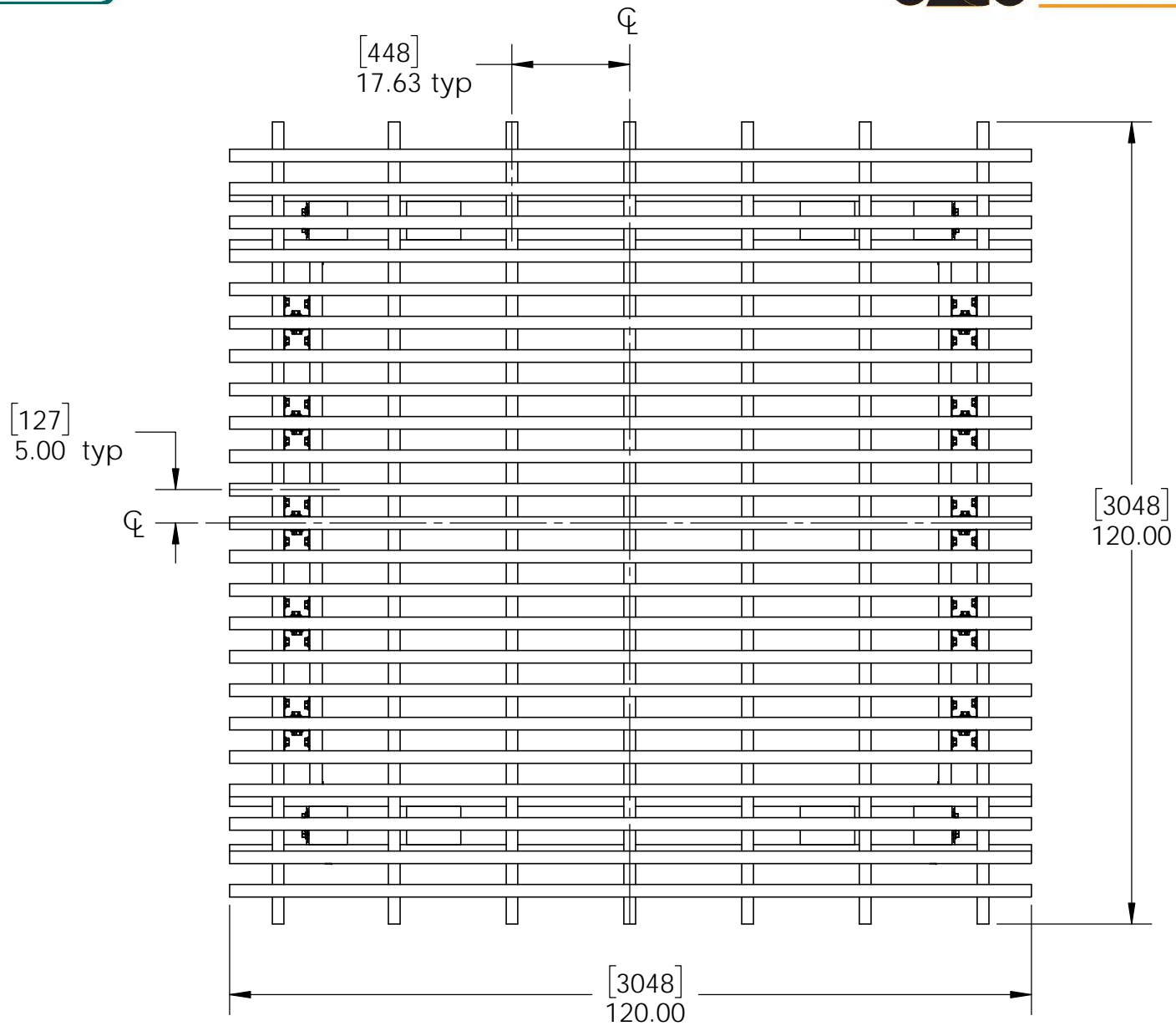

Overview-Top

OZCO Project #331 - 10x10 Pergola with 6x6 Posts

V1.00 - Installation Instructions effective May 1, 2015 and reflects information that available as of April 10, 2014. This information is updated periodically and should not be relied upon after May 1, 2015. Please visit www.OZCOBP.com to get current information

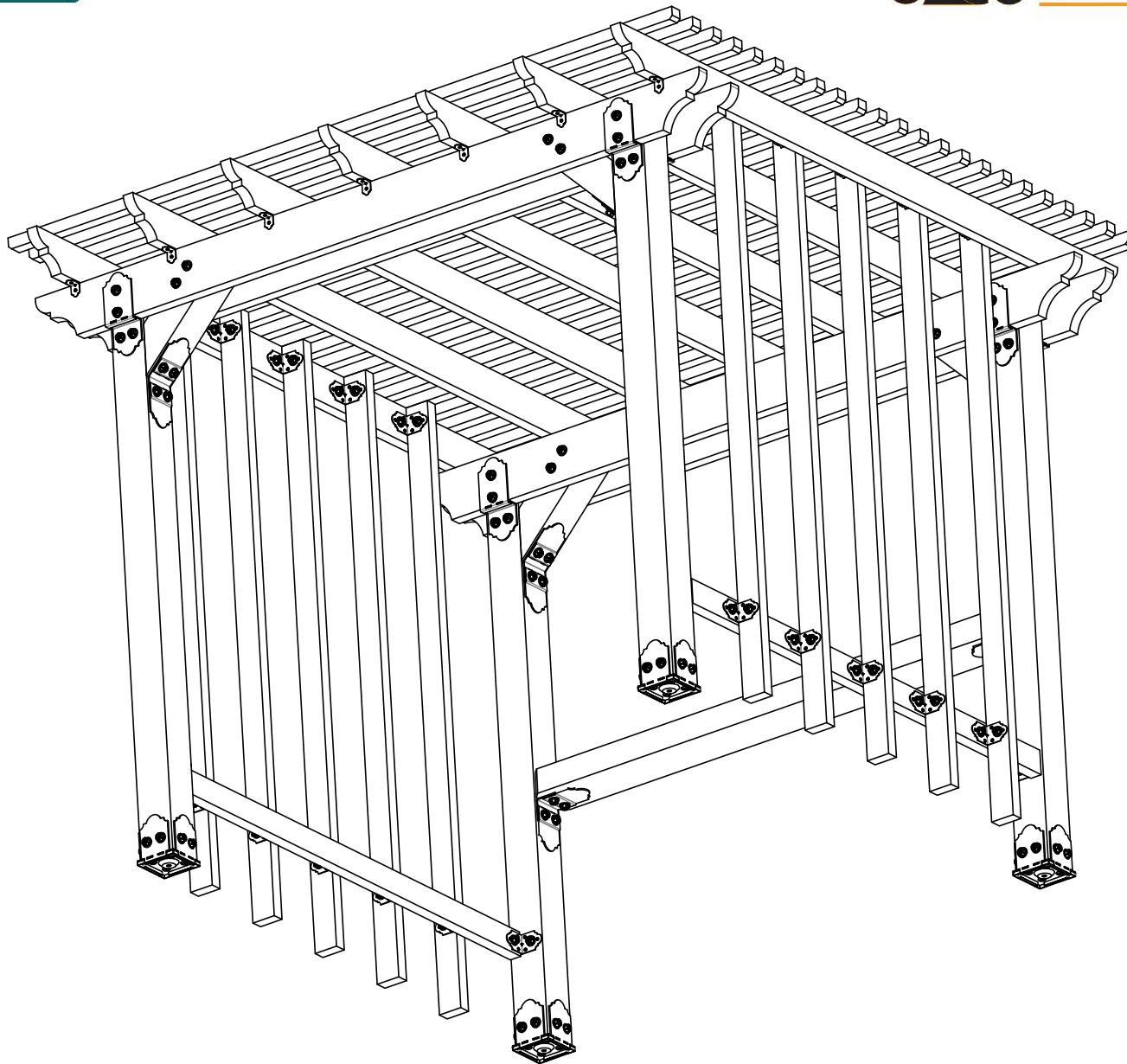

Overview

OZCO Project #331 - 10x10 Pergola with 6x6 Posts

V1.00 - Installation Instructions effective May 1, 2015 and reflects information that available as of April 10, 2014. This information is updated periodically and should not be relied upon after May 1, 2015. Please visit www.OZCOBP.com to get current information

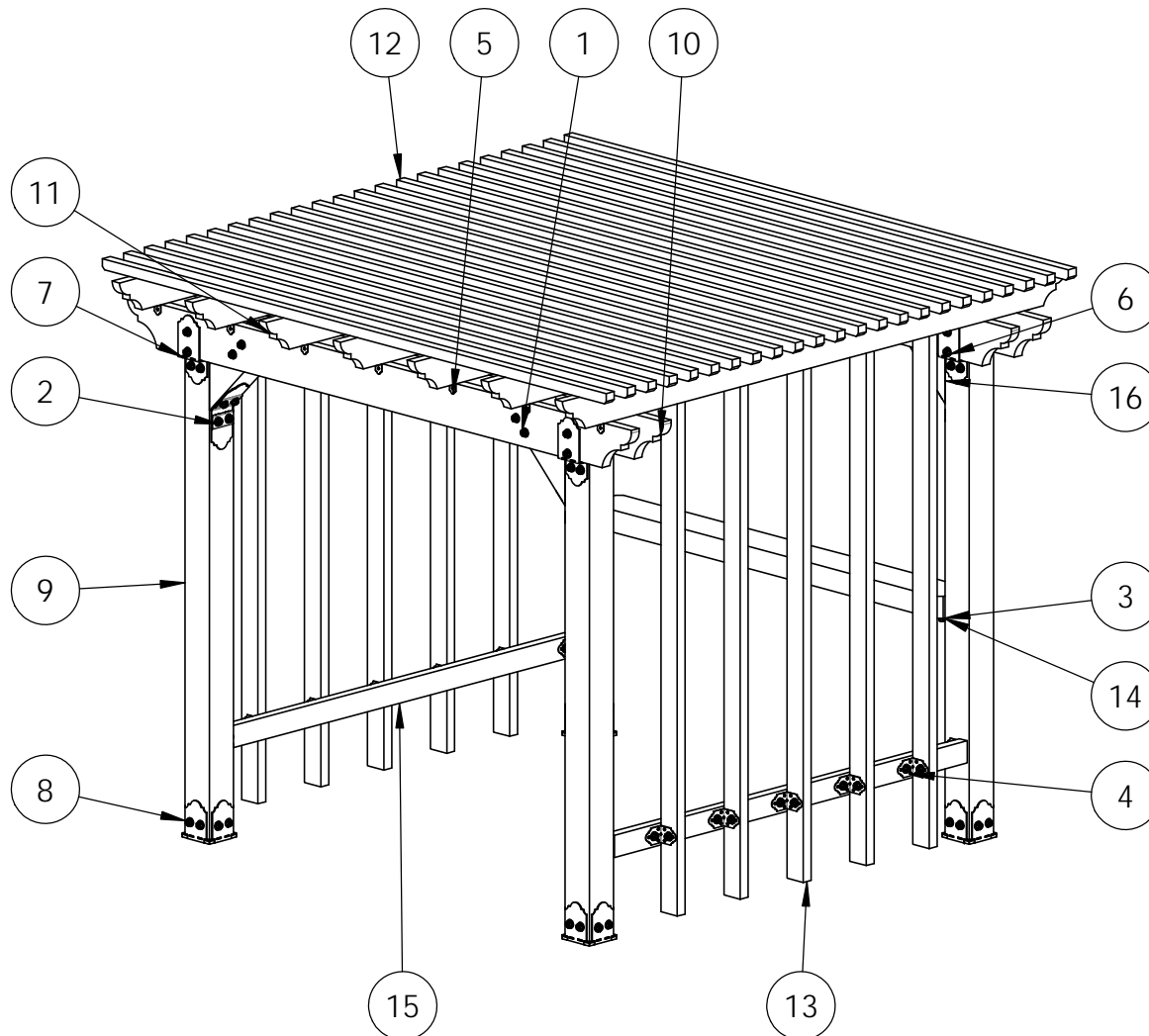

Bill of Material

OZCO Project #331 - 10x10 Pergola with 6x6 Posts

ITEM NO.	QTY.	PART NUMBER	DESCRIPTION
1	4	56651	OWT Timber Bolt 8-10"
2	2	56616	Flush Inside 45 (FI-45)
	1	56611	Truss Accent (TA-LS)
	0.08	56625	OWT Timber Screw 1-3/4"
3	1	56615	Flush Inside 90
	1	56611	Truss Accent (TA-LS)
	0.08	56625	OWT Timber Screw 1-3/4"
4	4.4	56618	4" Standard Rafter Clip (RC-LS-4)
5	1.4	56617	2" Standard Rafter Clip (RC-LS-2)
	2	80014	Screw, FHP #12 X 1.25", Black
6	4	56651	OWT Timber Bolt 8-10"
7	4	56637	Post to Beam Bolt Inline (P2B-BI-LS)
8	4	56608	6x6 Post Base (6x6-PB-LS)
9	4	6x6 Cedar Post	6x6x92.00
10	4	2x8 Cedar Board	2x8x120.00
11	7	2x6 Cedar Board	2x6x120.00
12	23	2x2 Cedar Board	2x2x120.00
13	10	2x4 Cedar Board	2x4x96.00
14	1	4x8 Cedar Board	4x8x84.00
15	2	2x4 Cedar Board	2x4x84.00
16	4	6x6 Cedar Post	6x6x24.00

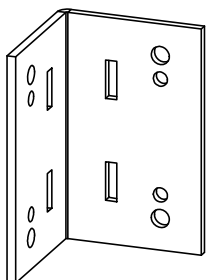

56615-10

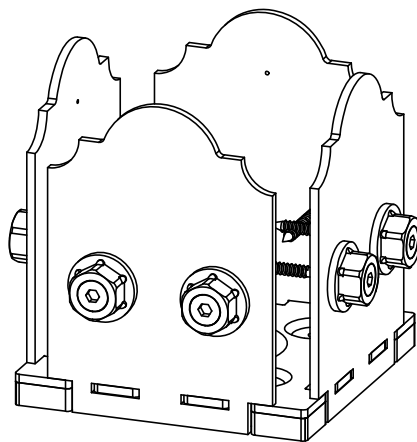

56608

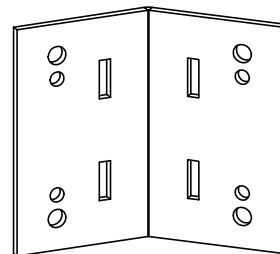

56616

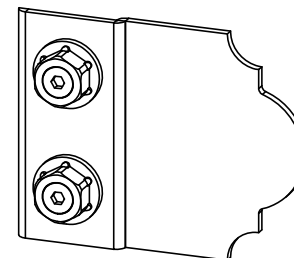

56611

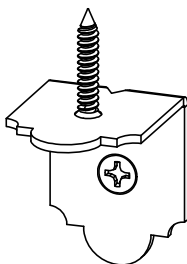

56617

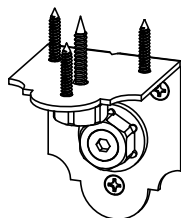

56618

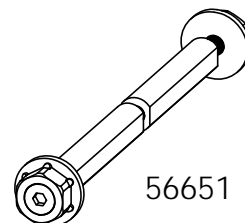

56651

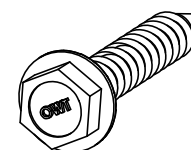

56625



DESIGN

PURCHASE

CONSTRUCT

ENJOY

Laredo Sunset vs. Ironwood

2 great styles
same functionality

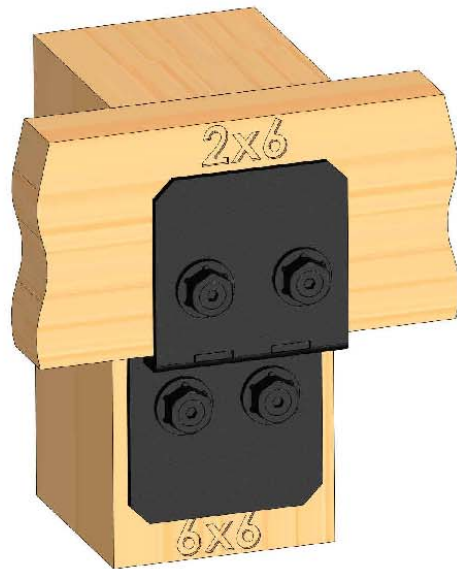

Ironwood
(517XX series)



Laredo Sunset
(566XX series)

choose your connection lifestyle
both styles available for most products



OZCO BUILDING PRODUCTS

Optional (add to vertical columns)

- typical shadow box utilizing 2x6 cedar
- mitered corners to utilize #56617/51717 rafter clips

ITEM NO.	QTY.	PART NUMBER	DESCRIPTION
1	1	2x6	2x6 Cedar
2	0.6	56617	2" Standard Rafter Clip (RC-LS-2)

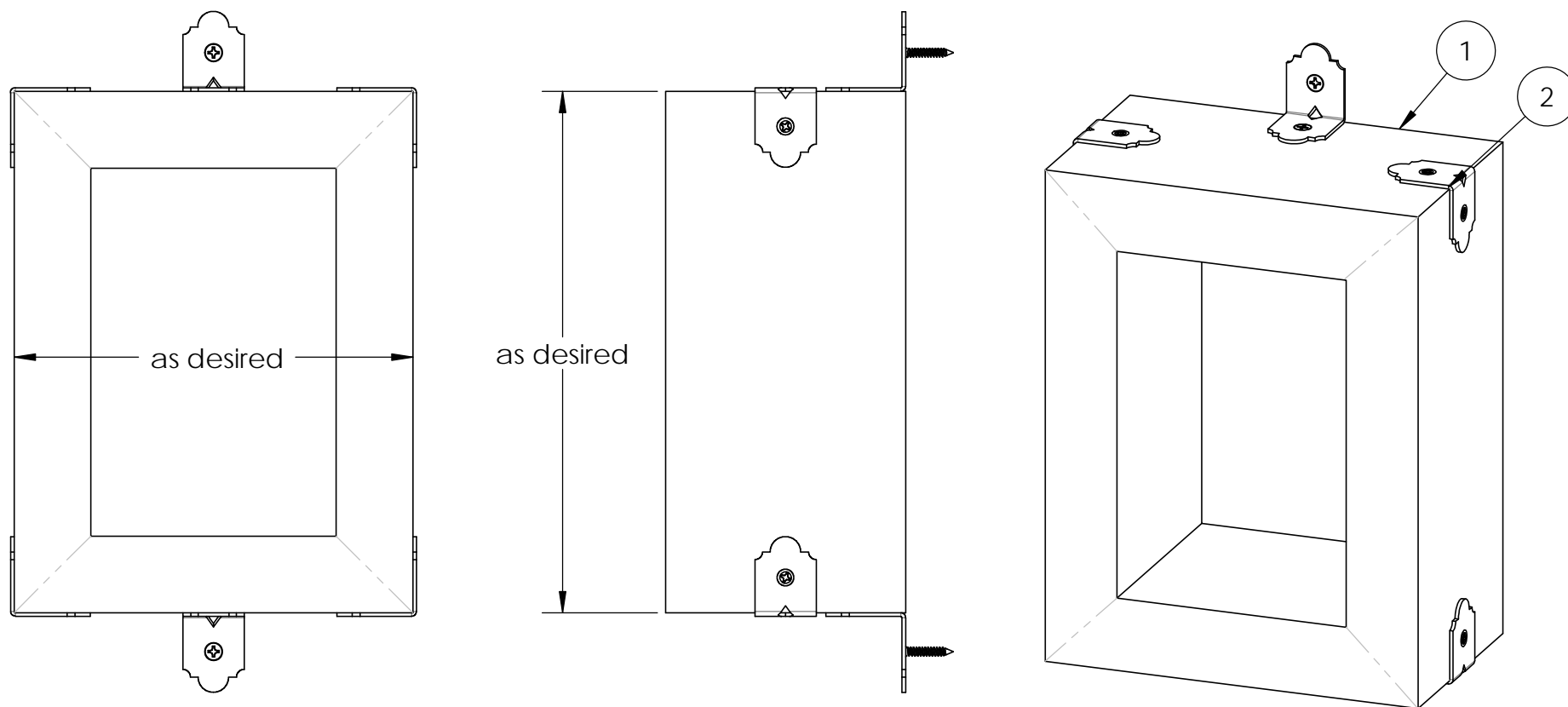

Shadow Box option

OZCO Project #331 - 10x10 Pergola with 6x6 Posts

V1.00 - Installation Instructions effective May 1, 2015 and reflects information that available as of April 10, 2014. This information is updated periodically and should not be relied upon after May 1, 2015. Please visit www.OZCOBP.com to get current information