

DESIGN

PURCHASE

CONSTRUCT

ENJOY

OZCO Project #312 - 12x12 Pergola Patio Shade Structure

this project utilizes Project
#311 as base structure.

see OZCO website for
further information

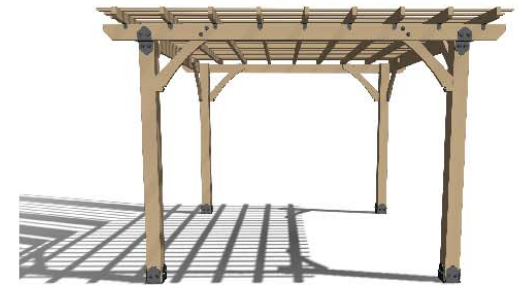
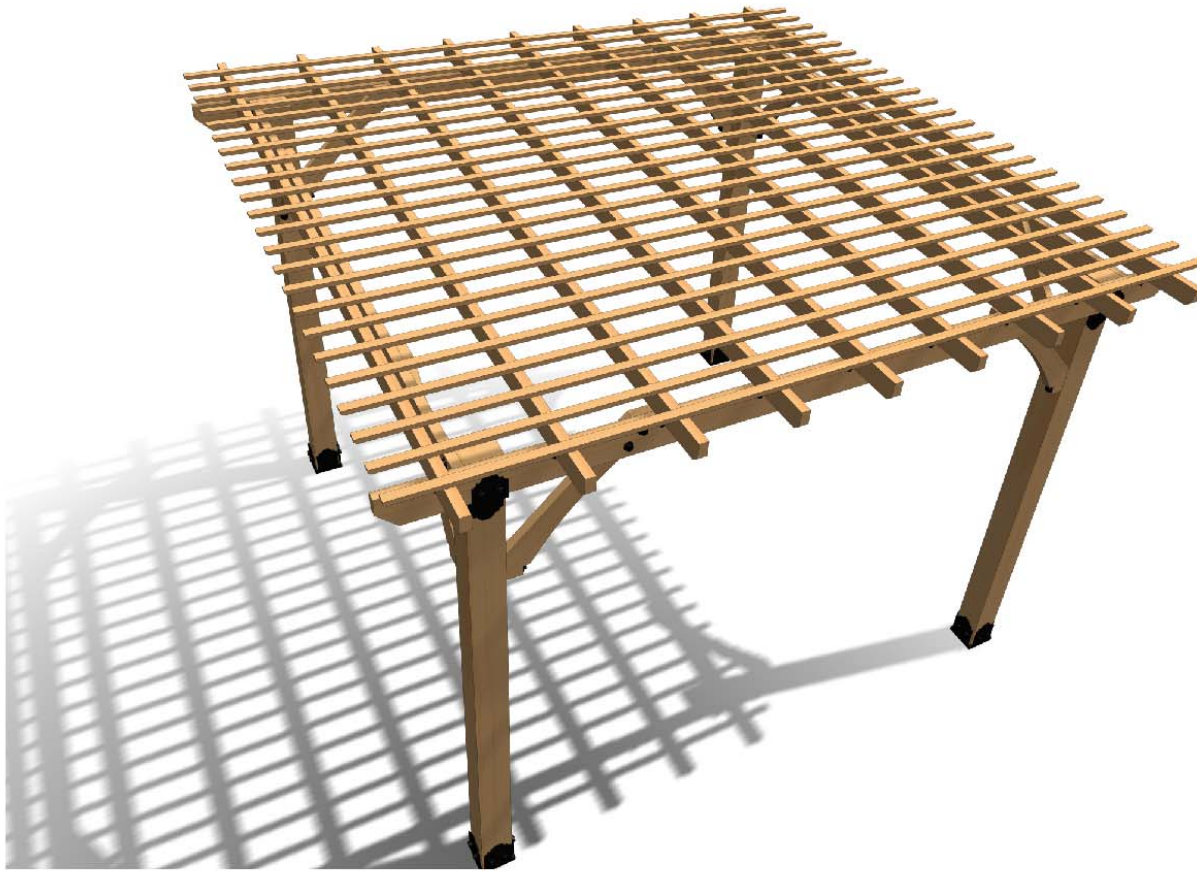

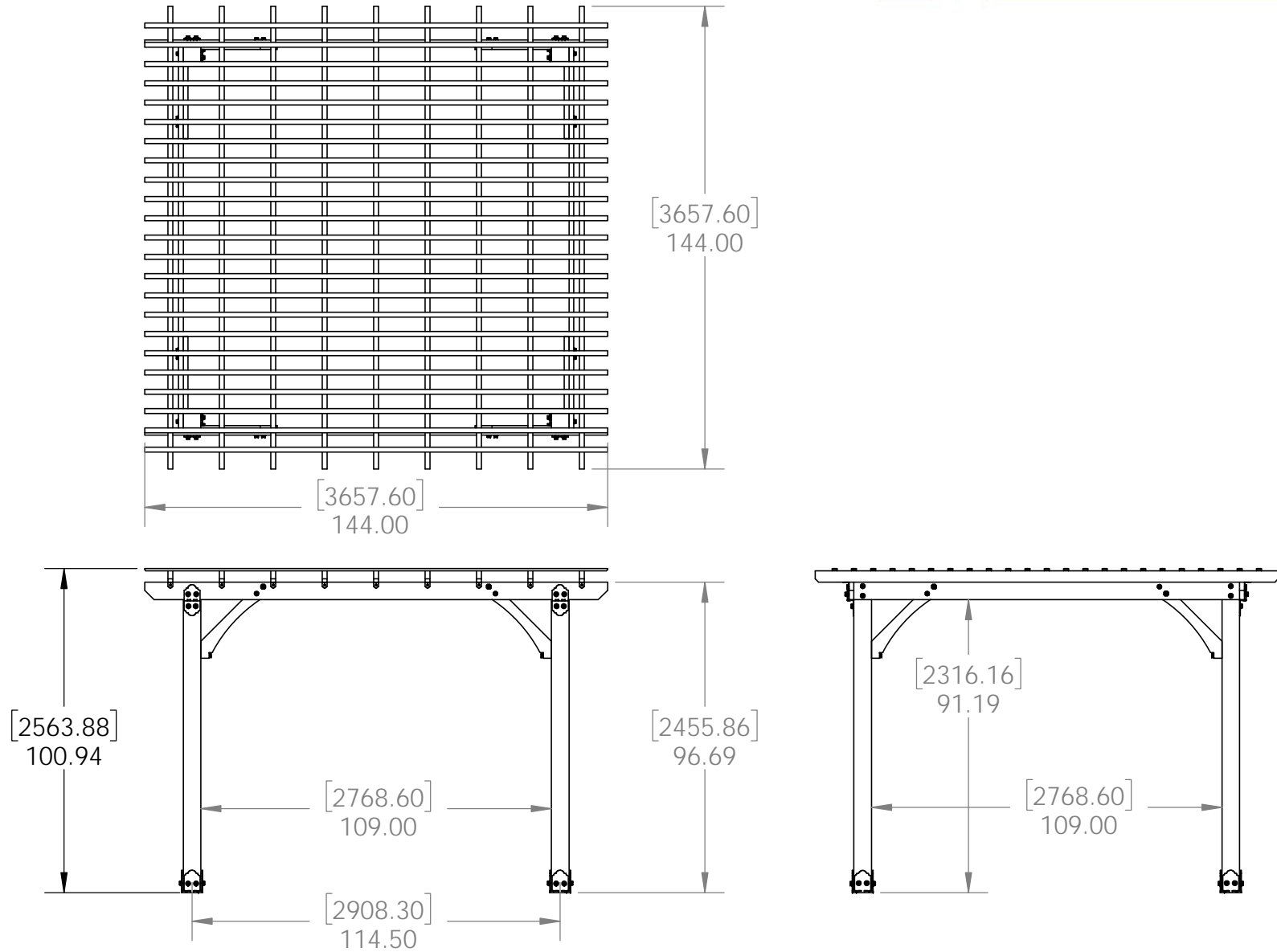

OZCO Project #312 - 12x12 Pergola Patio Shade Structure B

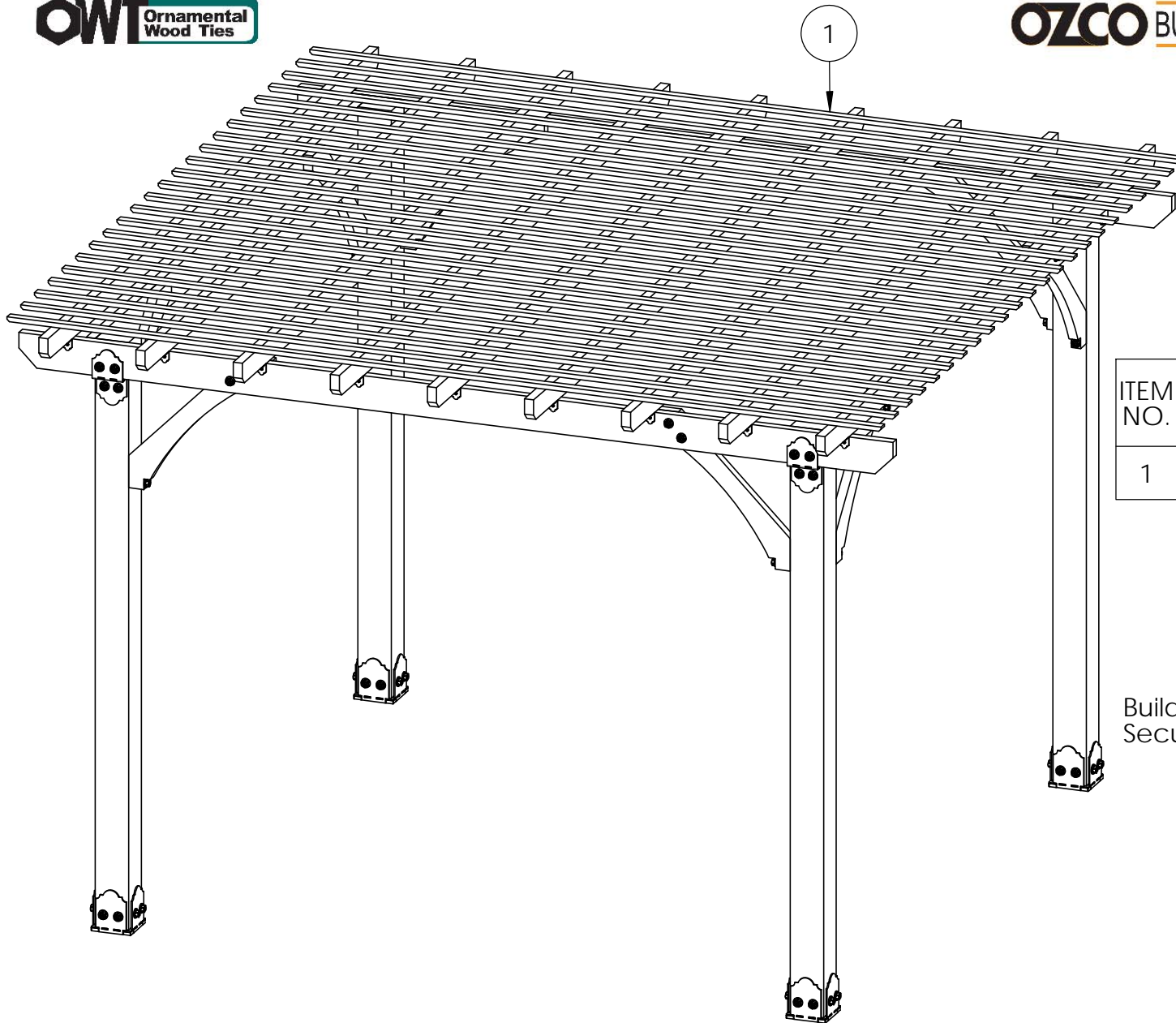

ITEM NO.	QTY.	PART NUMBER	DESCRIPTION
1	23	1x2 Board	1x2x144.0 0

Build Project #311, then add Purlins
Secure with nails or screws

OZCO Project #312 - 12x12 Pergola Patio Shade Structure B

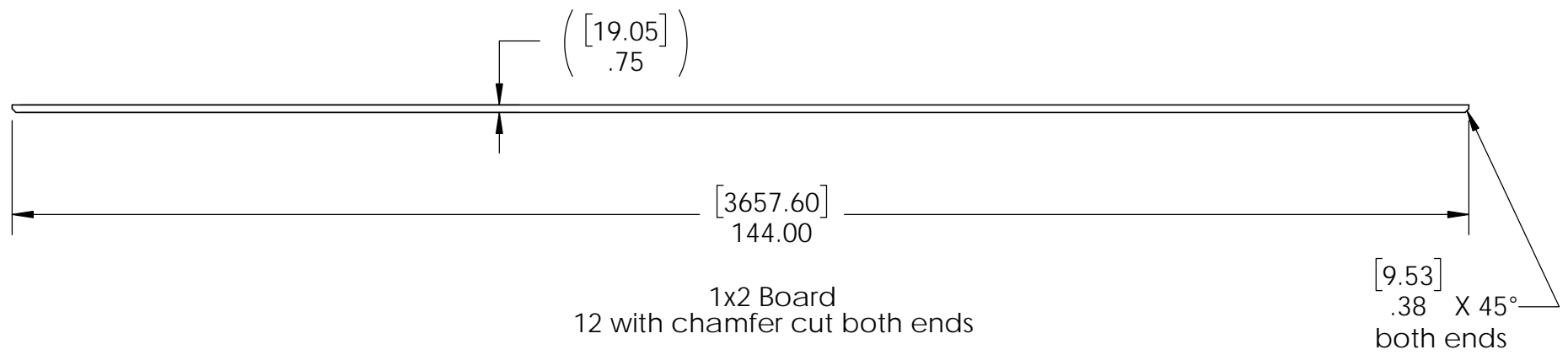

cutlist

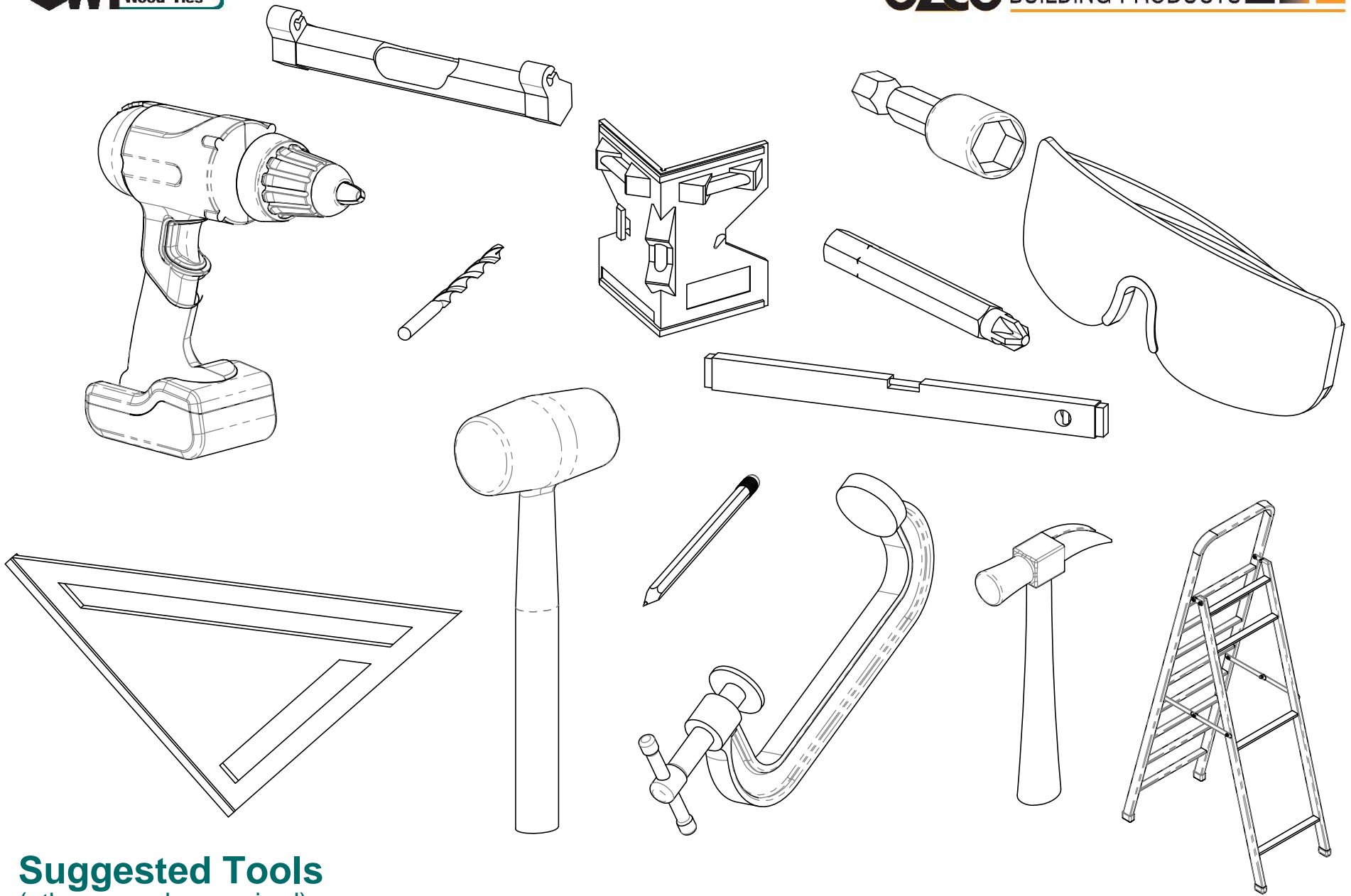

Suggested Tools
(others may be required)

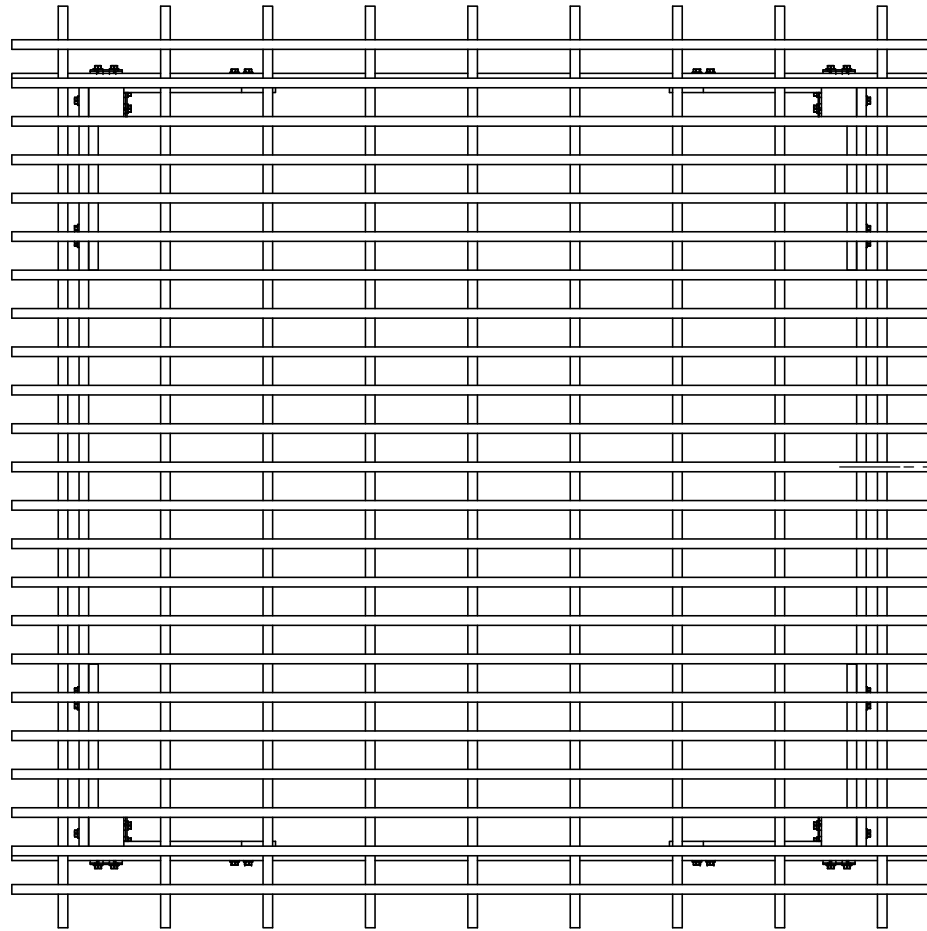

[152.40]
6.00
spacing
℄

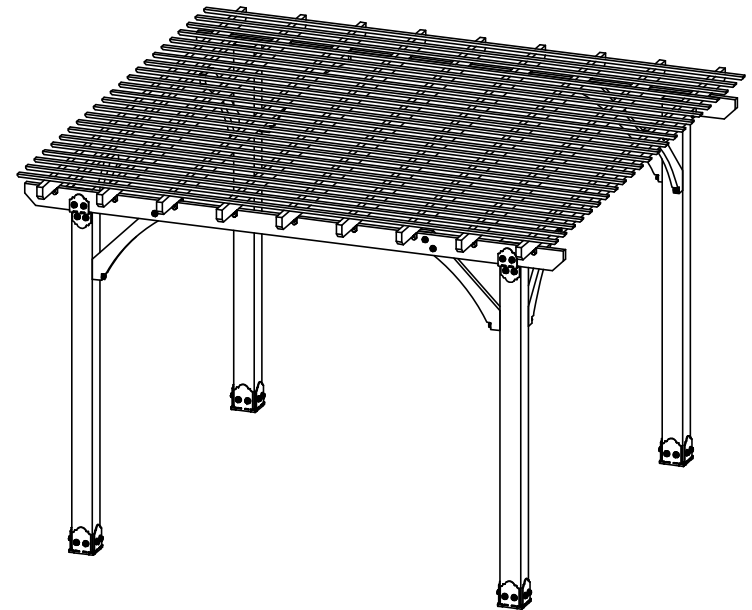

OZCO Project #312 - 12x12 Pergola Patio Shade Structure B

OZCO Project #312 - 12x12 Pergola Patio Shade Structure B

V1.00 - Installation Instructions effective May 1, 2015 and reflects information that available as of April 10, 2014. This information is updated periodically and should not be relied upon after May 1, 2015. Please visit www.OZCOBP.com to get current information