

DESIGN

PURCHASE

CONSTRUCT

ENJOY

OZCO Project #311 - 12x12 Pergola Patio Shade Structure A

this project is the foundation
of project #312 & #313
see OZCO website for
further information

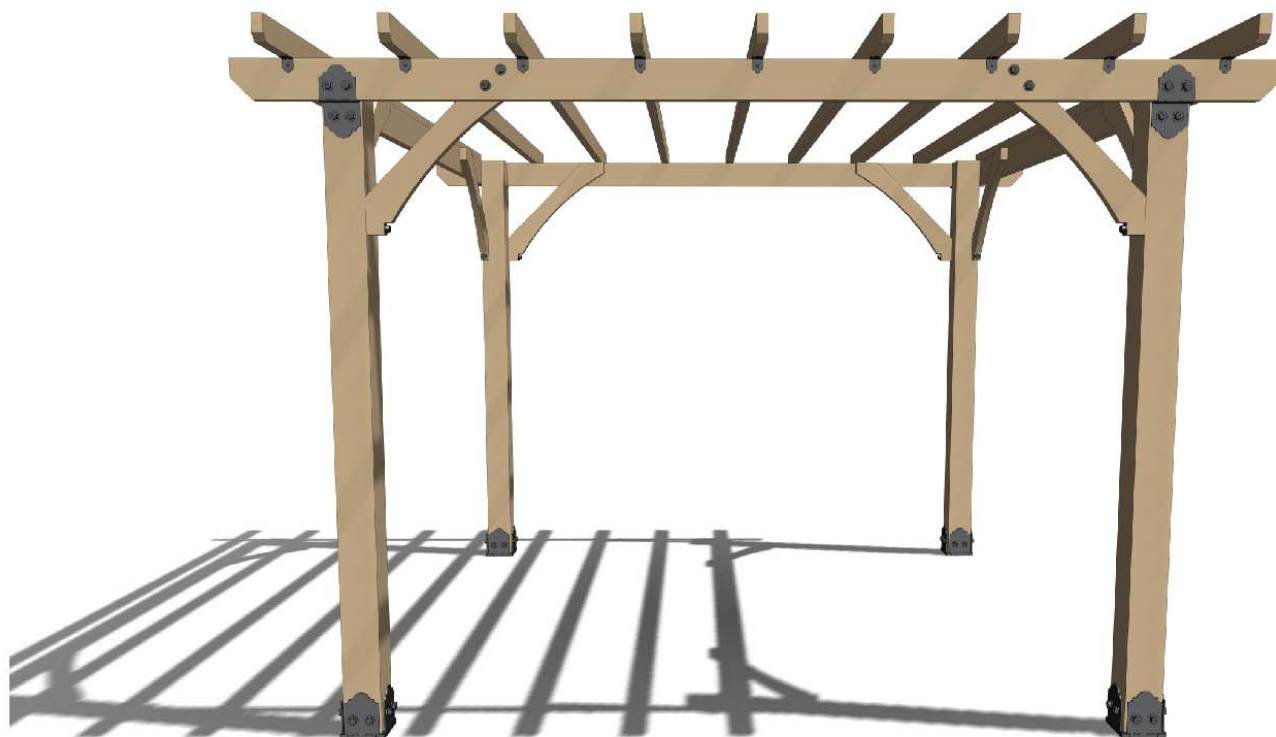

OZCO BUILDING PRODUCTS



Printing Documents from ISSUU

Unfortunately, there is currently no way to print content directly through issuu. To print a publication, you will need to download it and print it from your computer.

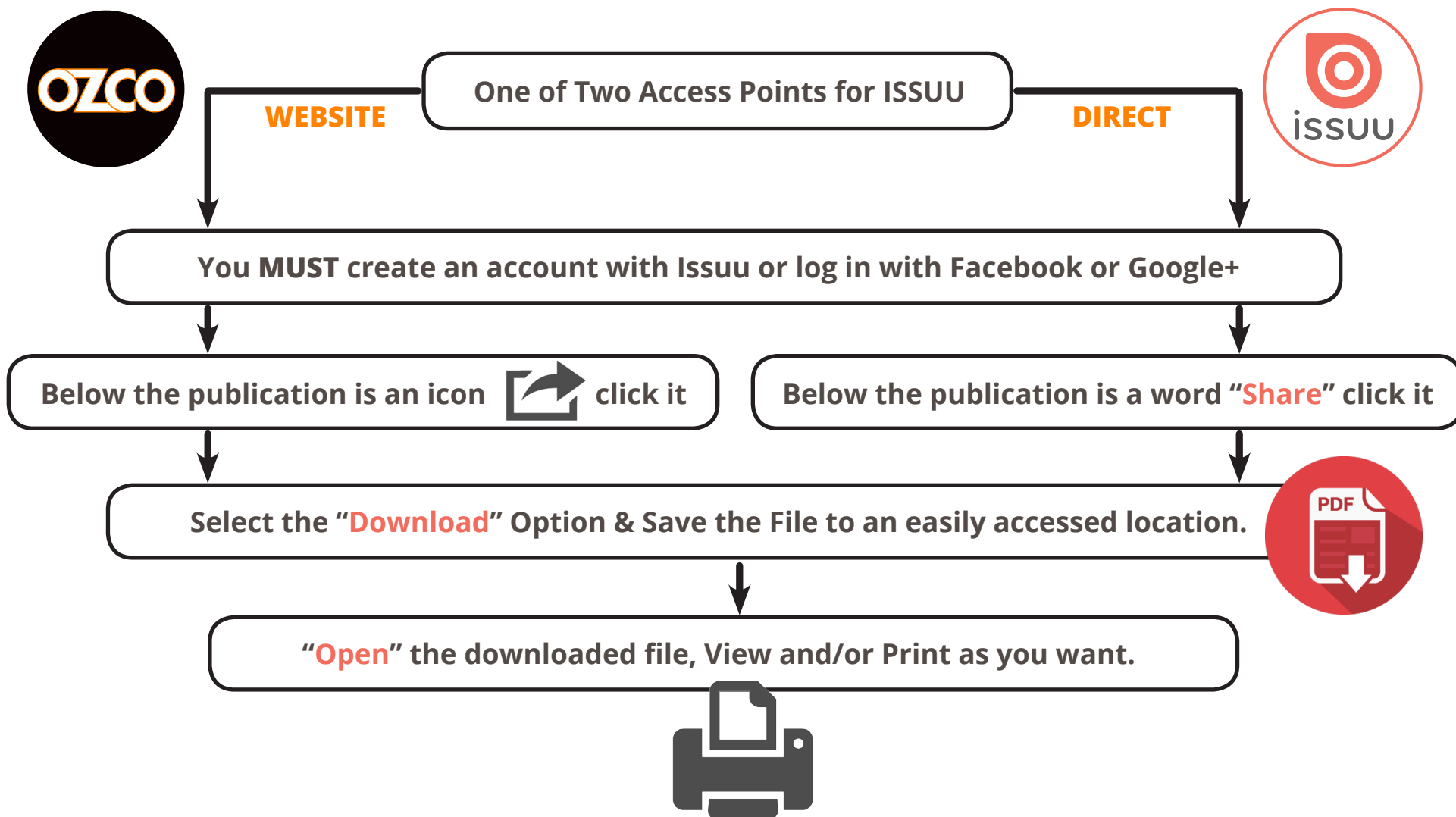

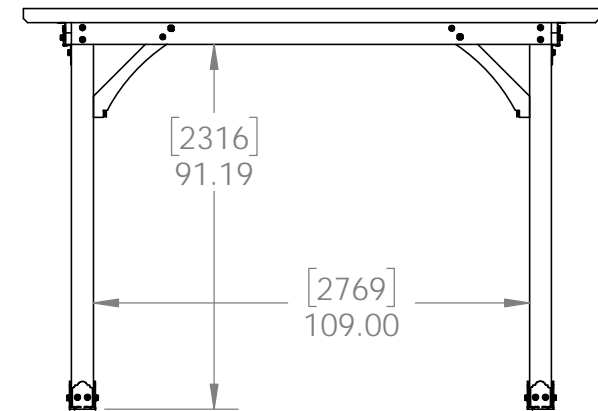
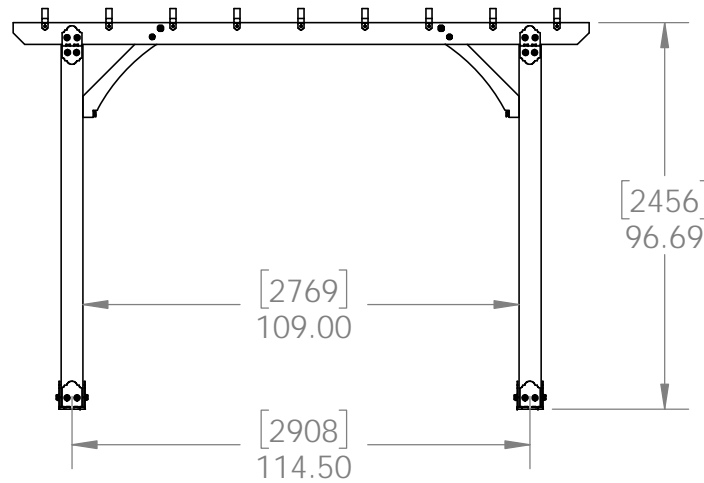
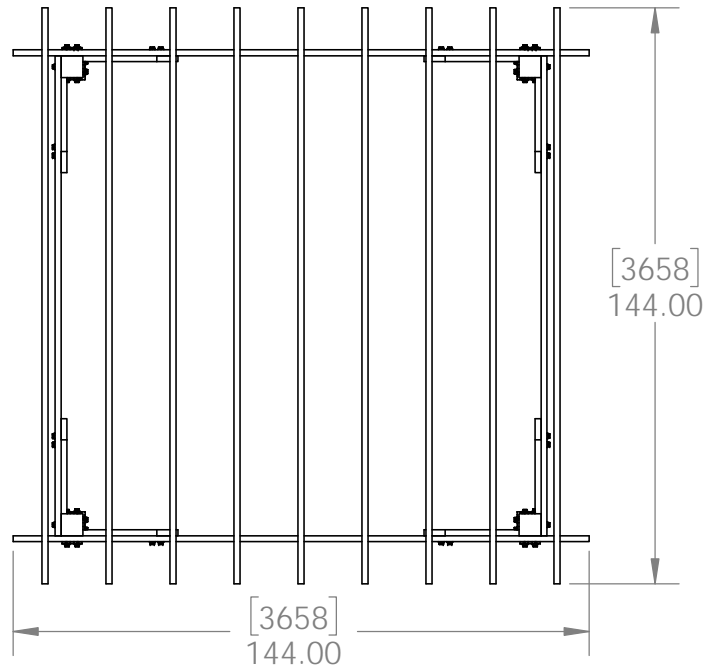

OZCO Project #311 - 12x12 Pergola Patio Shade Structure A

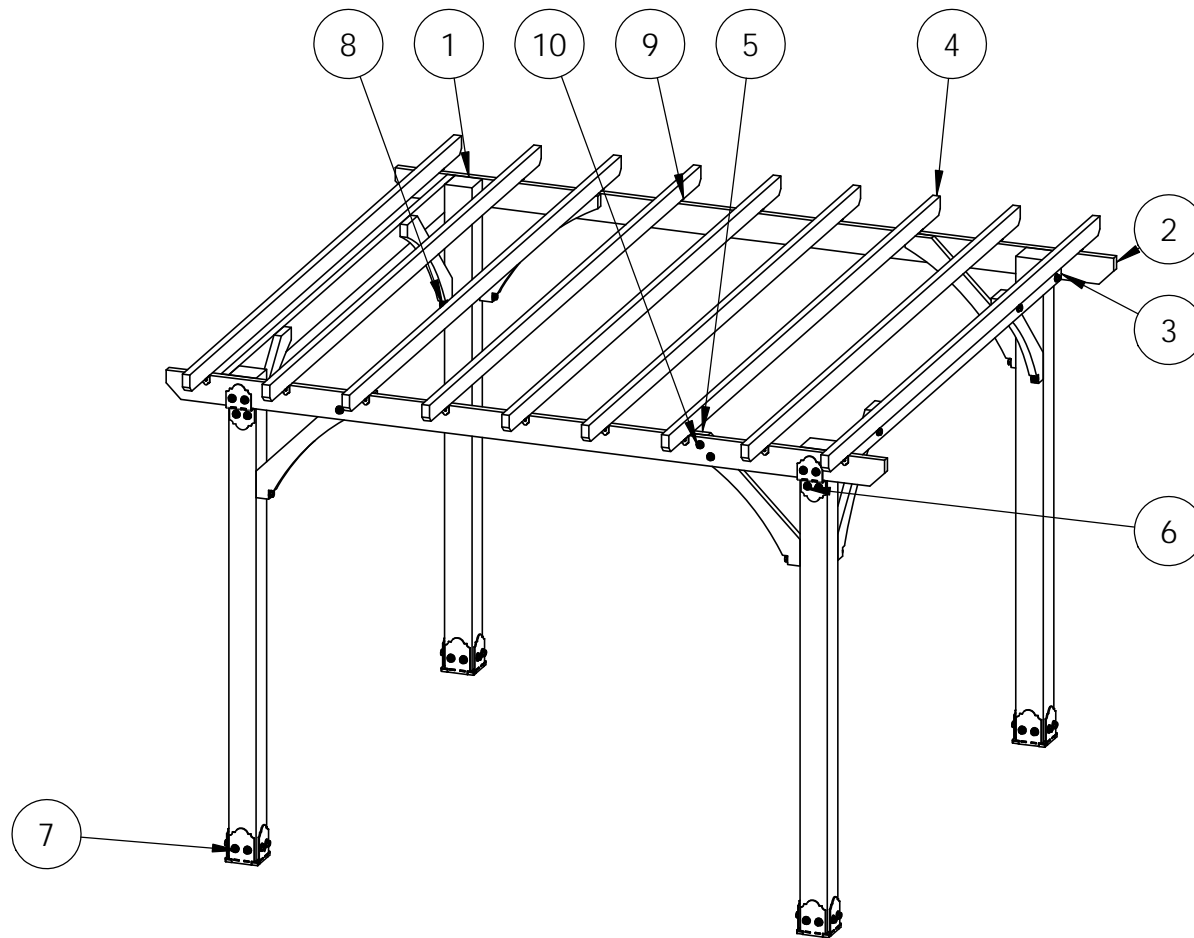

ITEM NO.	QTY.	PART NUMBER	DESCRIPTION
1	4	6x6 Post	6x6x96.00
2	2	2x6 Board	2x6x144.00
3	2	2x6 Board	2x6x120.00
4	9	2x4 Board	2x4x144.00
5	8	2x6 Board	2x6x36.00
6	2	56635	6" Post to Beam (P2B-LS-6)
7	4	56608	6x6 Post Base (6x6-PB-LS)
8	0.64	56628	Screw, OWT 5-3/4" (145mm) Timber with HCN
	0.1	56621	1 1/2" Hex Cap Nut (HCN)
9	1.8	56617	2" Standard Rafter Clip (RC-LS-2)
10	0.64	56626	Screw, OWT 2-3/4" (70mm) Timber with HCN
	0.1	56621	1 1/2" Hex Cap Nut (HCN)

OZCO Project #311 - 12x12 Pergola Patio Shade Structure A

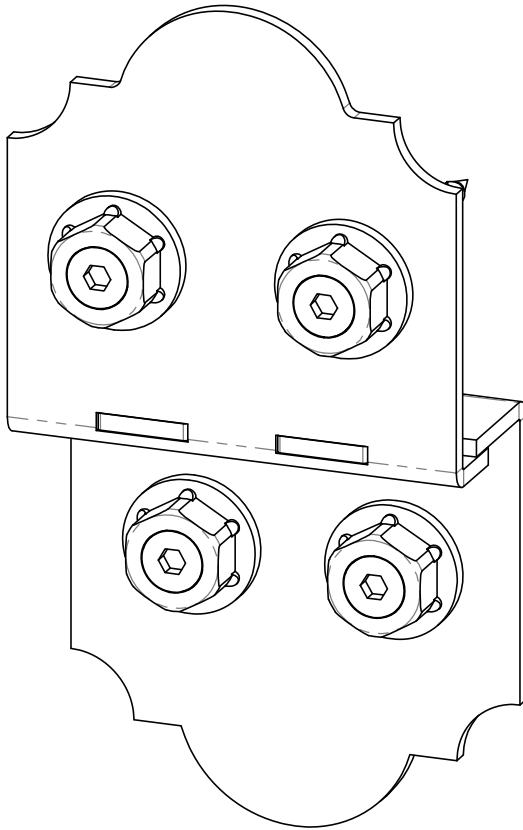

56635

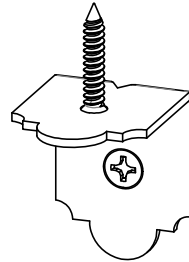

56617

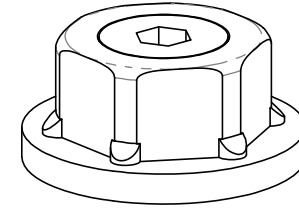

56621

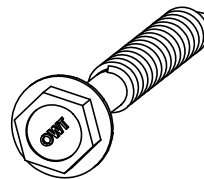

56626

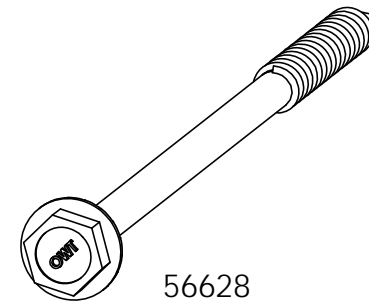

56628



DESIGN

PURCHASE

CONSTRUCT

ENJOY

Laredo Sunset vs. Ironwood

2 great styles
same functionality

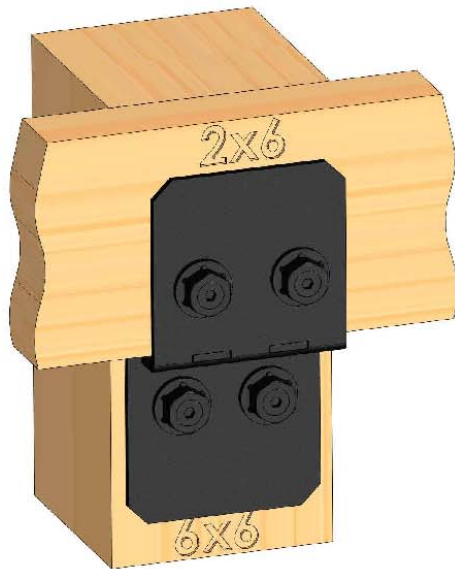

Ironwood
(517XX series)



Laredo Sunset
(566XX series)

choose your connection lifestyle
both styles available for most products



OZCO BUILDING PRODUCTS

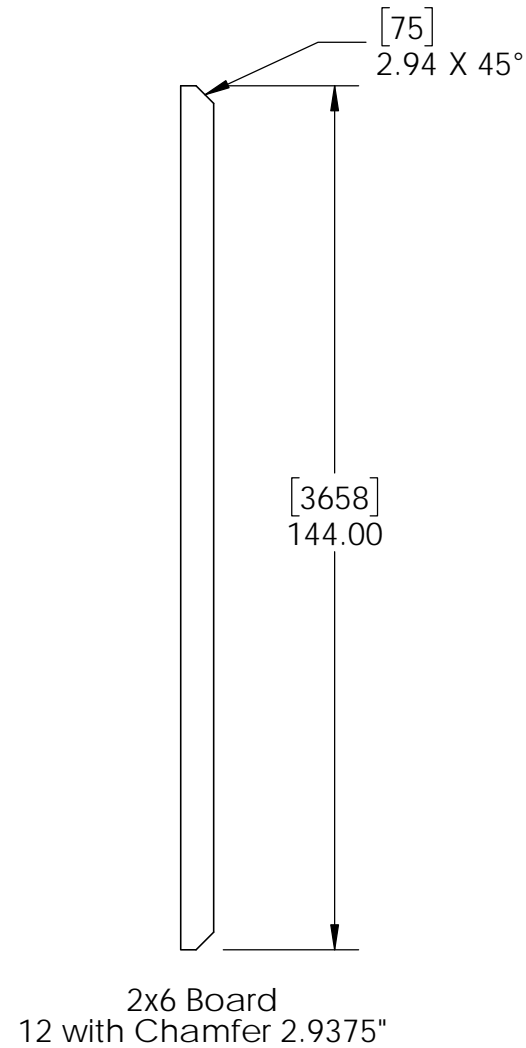
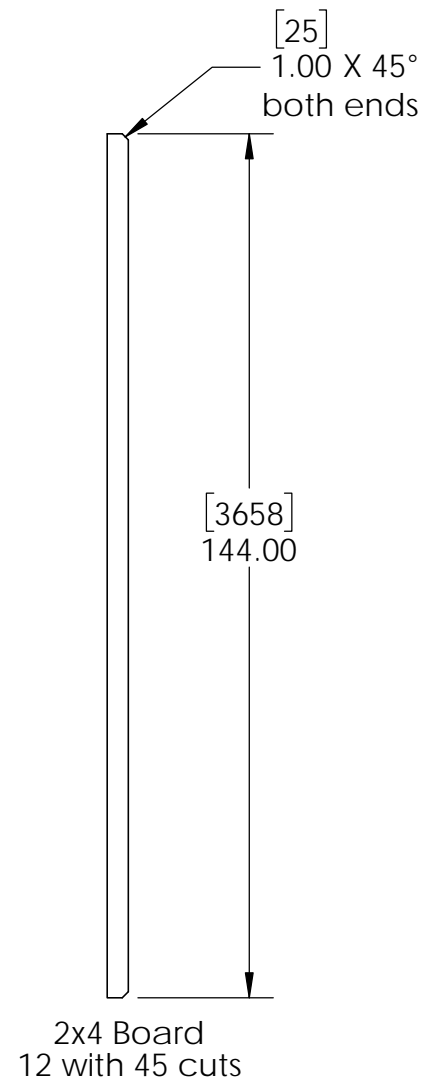

cutlist

for convenience...
template on next page

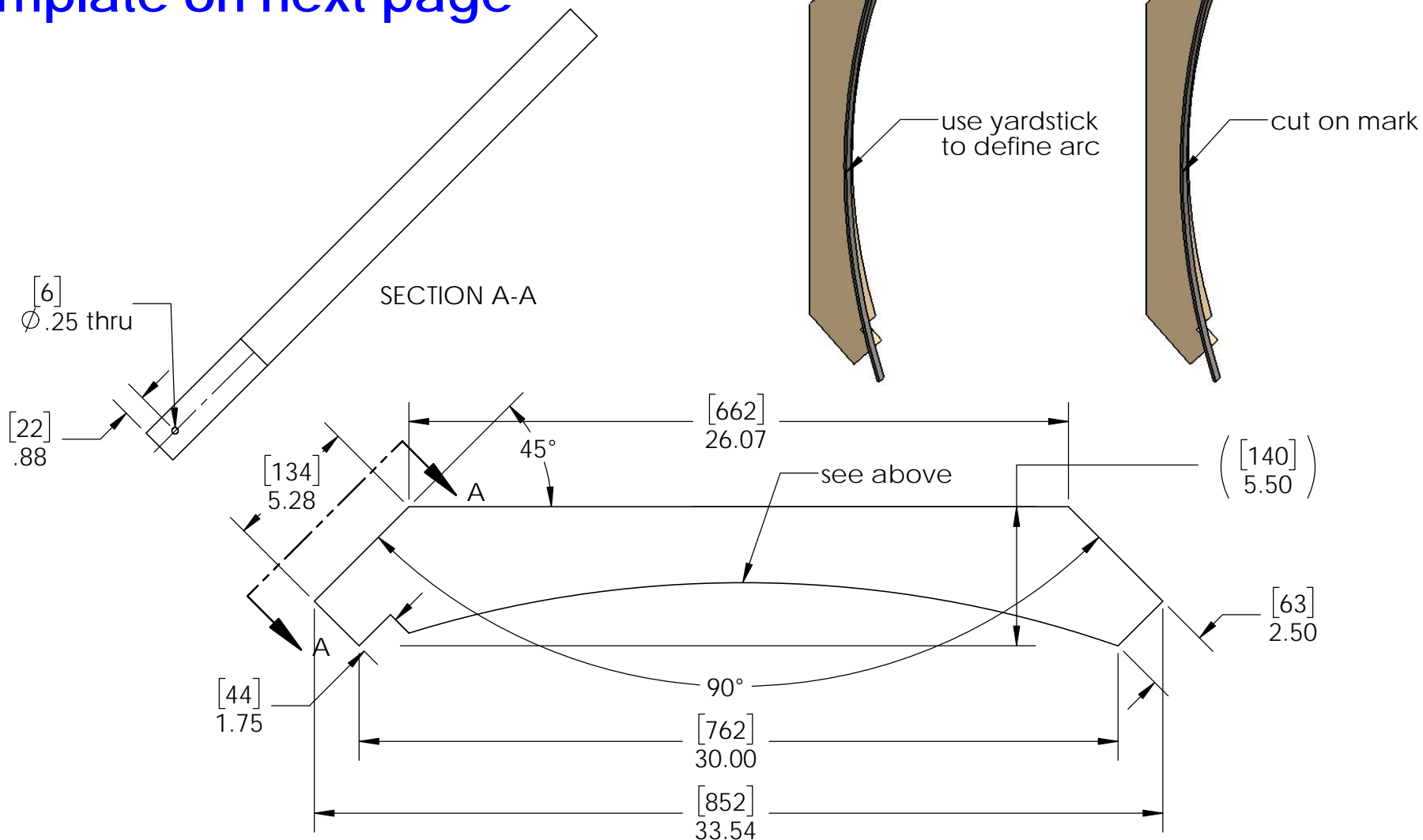

3 knee brace

OZCO Project #311 - 12x12 Pergola Patio Shade Structure A

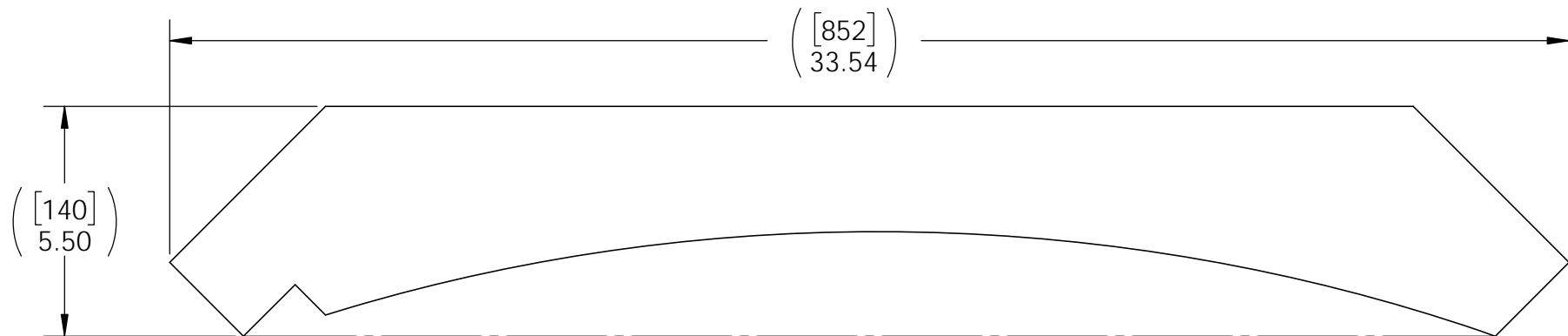

print 4x
make from 2x6

3 knee brace Template

(scale 1:4)

OZCO Project #311 - 12x12 Pergola Patio Shade Structure A

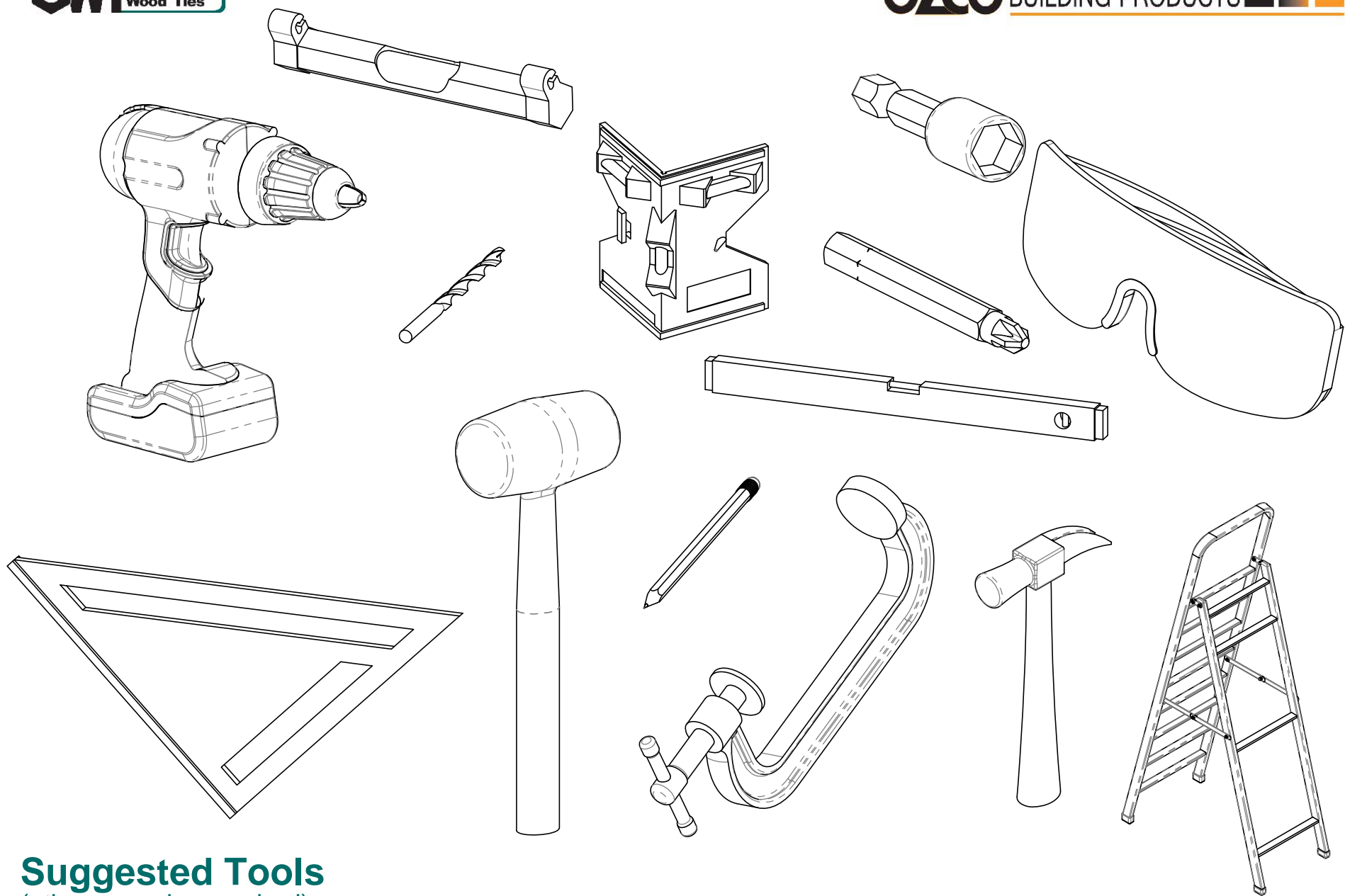

Suggested Tools

(others may be required)

**OZCO Project #311 - 12x12 Pergola Patio
Shade Structure A**

V1.00 - Installation Instructions effective May 1, 2015 and reflects information that available as of April 10, 2014. This information is updated periodically and should not be relied upon after May 1, 2015. Please visit www.OZCOBP.com to get current information

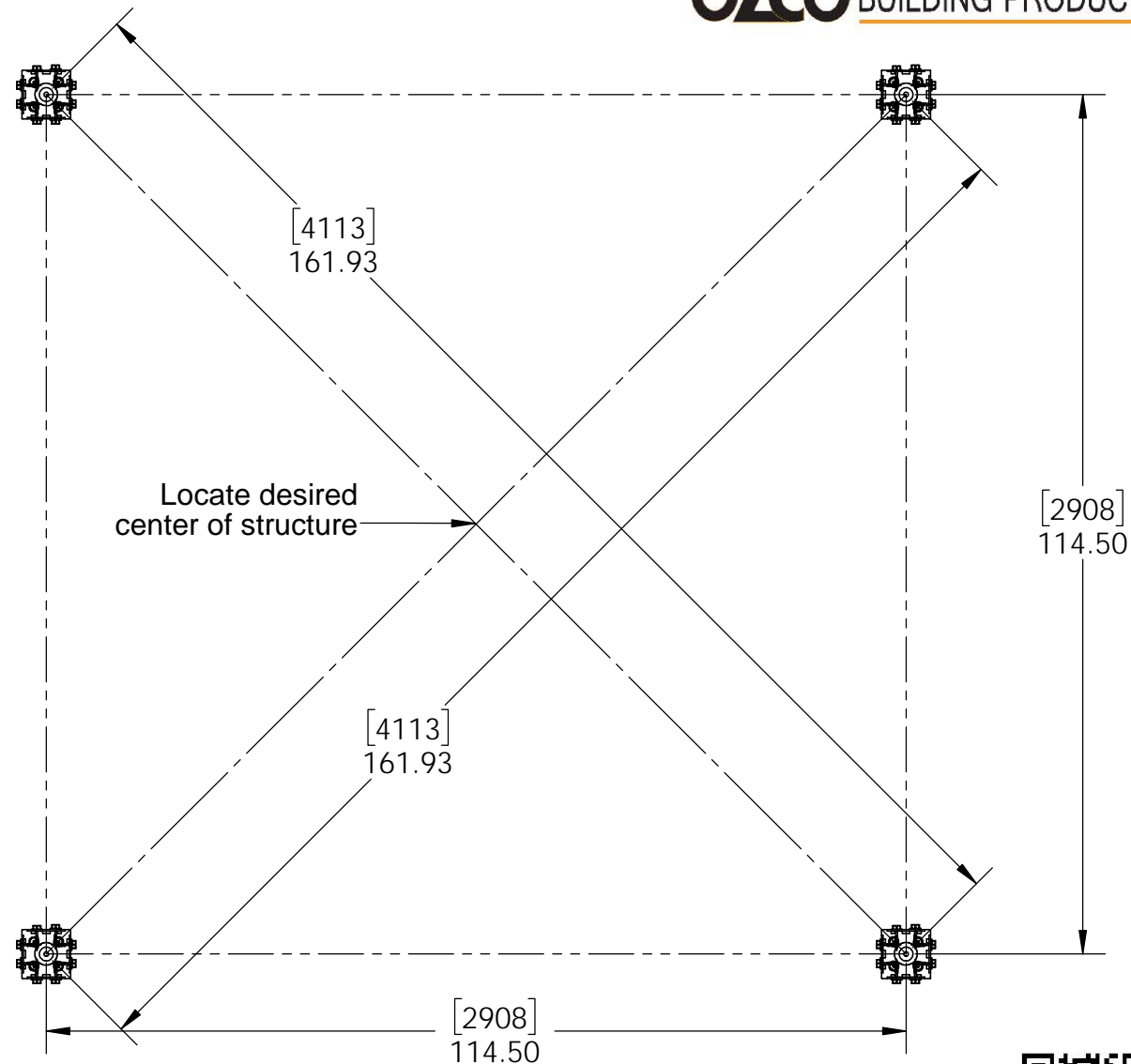

if site is not level,
see Ozco Site Leveling instruction



site

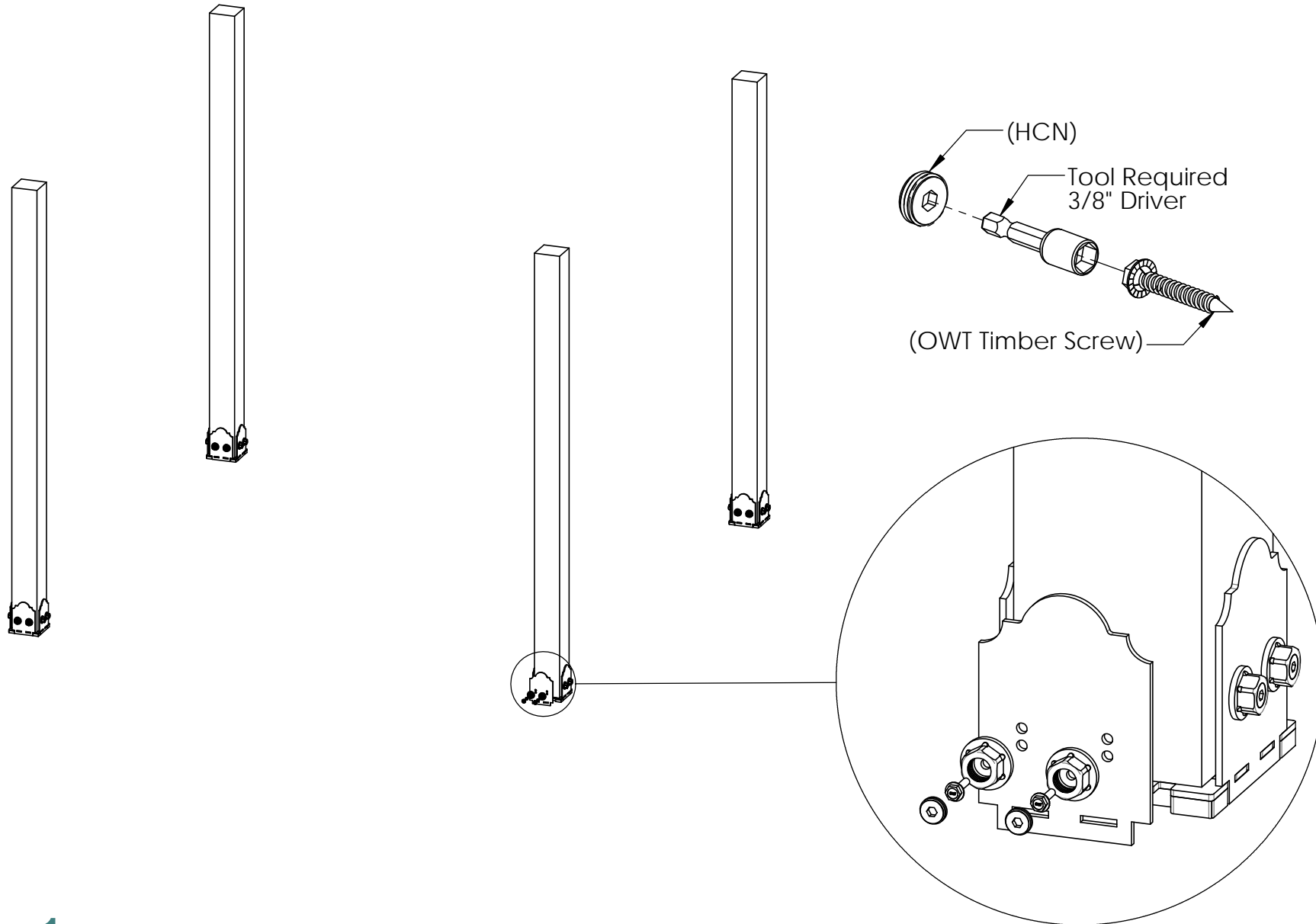

step 1

OZCO Project #311 - 12x12 Pergola Patio Shade Structure A

V1.00 - Installation Instructions effective May 1, 2015 and reflects information that available as of April 10, 2014. This information is updated periodically and should not be relied upon after May 1, 2015. Please visit www.OZCOBP.com to get current information

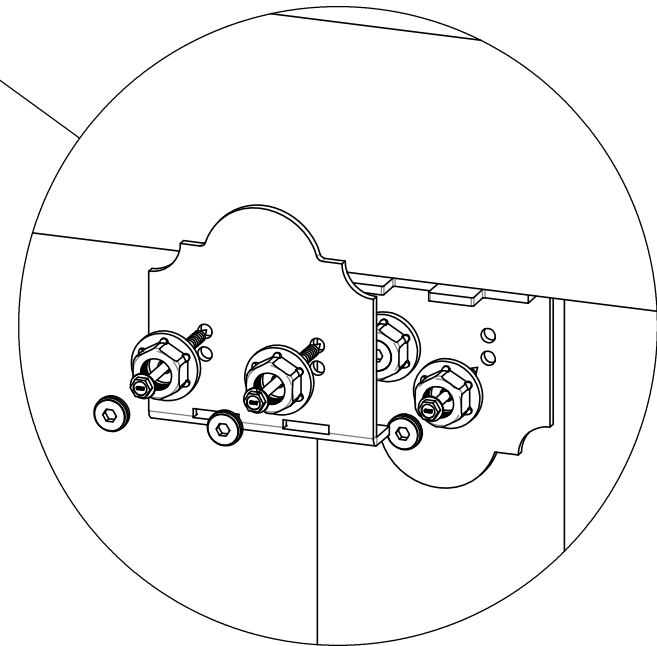
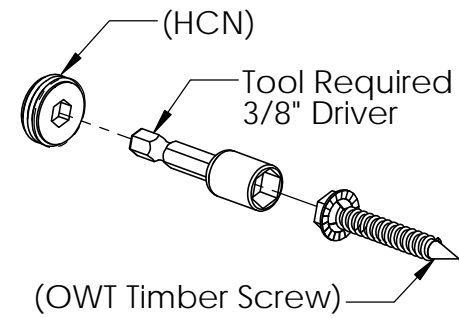
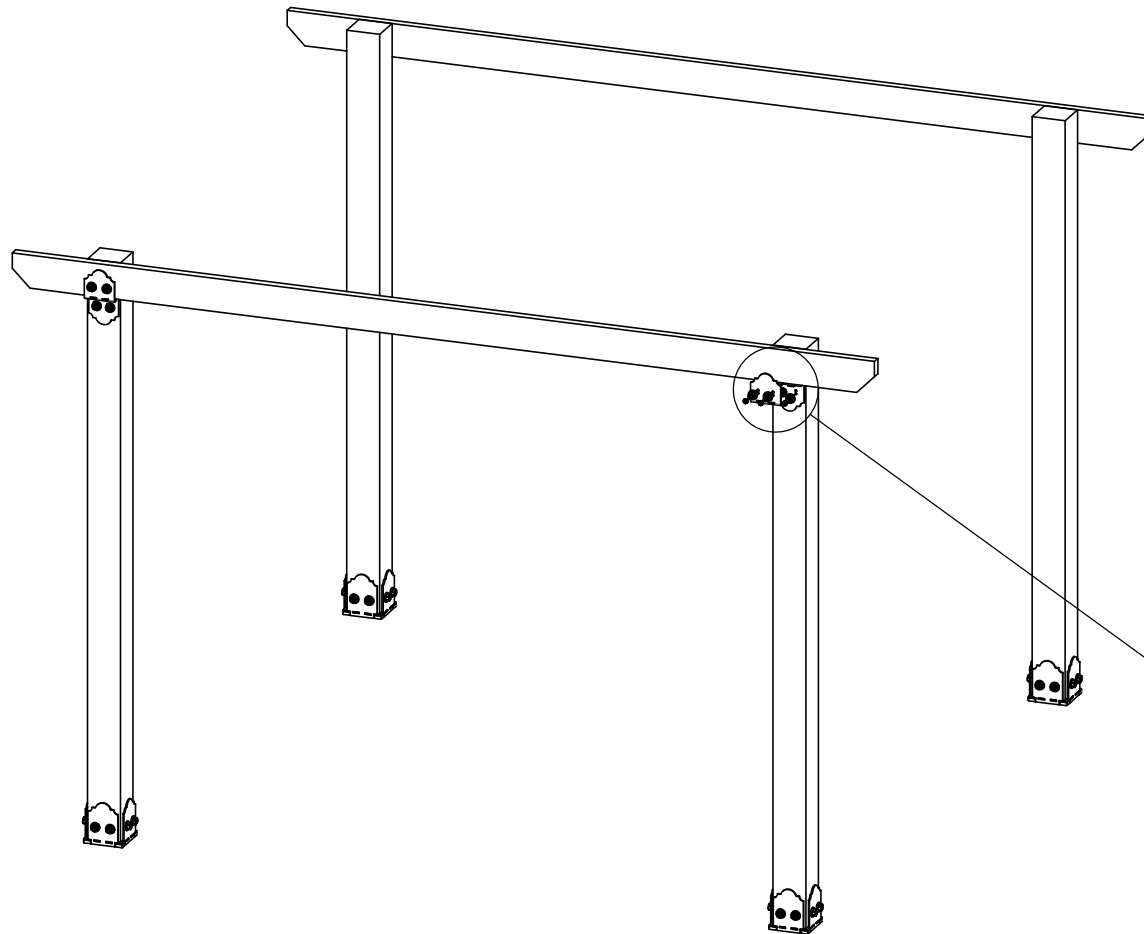

step 2

OZCO Project #311 - 12x12 Pergola Patio Shade Structure A

V1.00 - Installation Instructions effective May 1, 2015 and reflects information that available as of April 10, 2014. This information is updated periodically and should not be relied upon after May 1, 2015. Please visit www.OZCOBP.com to get current information

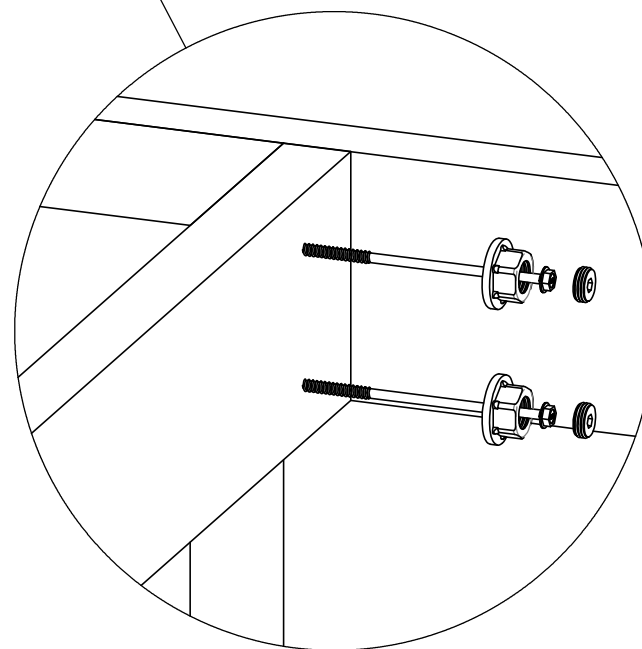
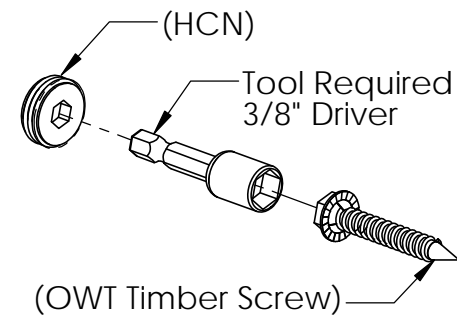
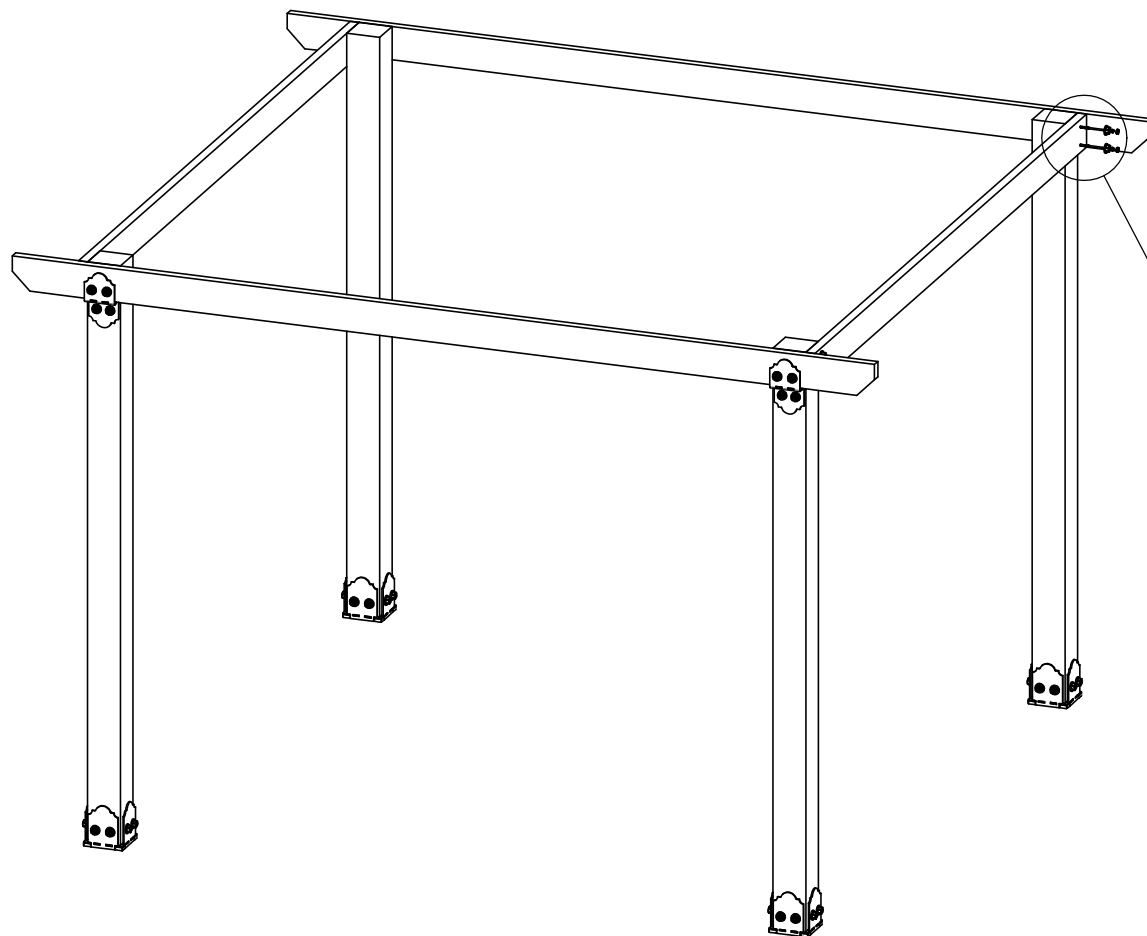

step 3

OZCO Project #311 - 12x12 Pergola Patio Shade Structure A

V1.00 - Installation Instructions effective May 1, 2015 and reflects information that available as of April 10, 2014. This information is updated periodically and should not be relied upon after May 1, 2015. Please visit www.OZCOBP.com to get current information

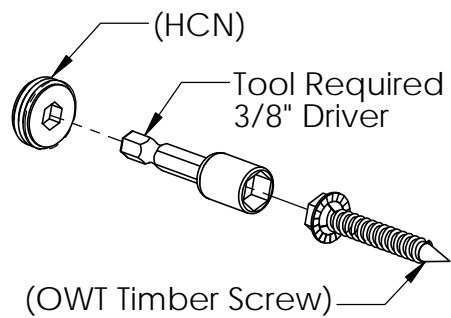
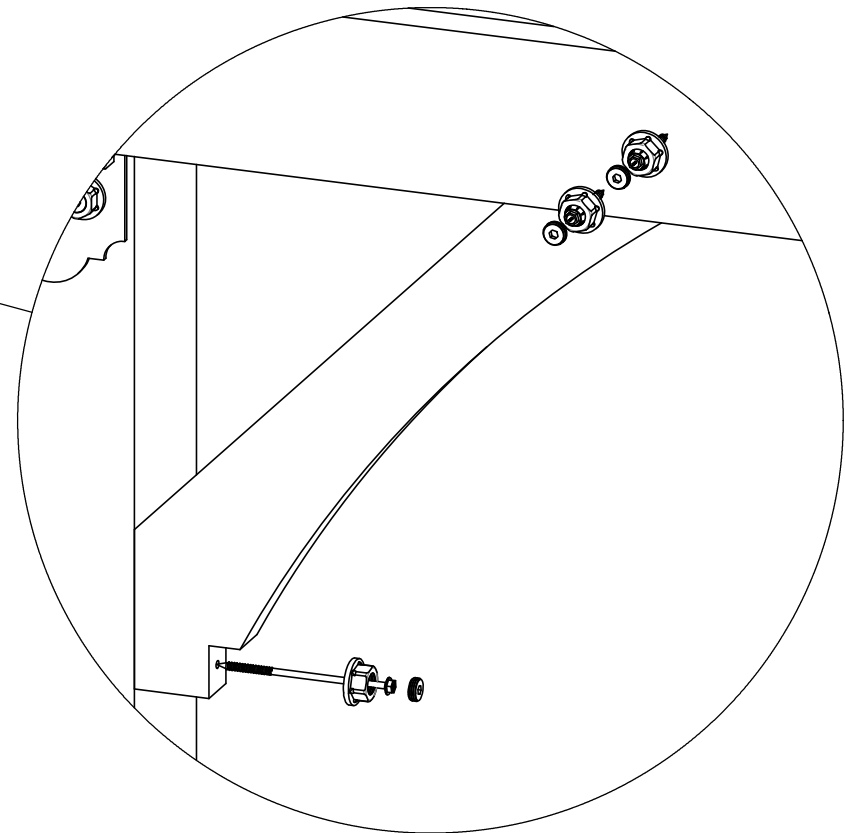
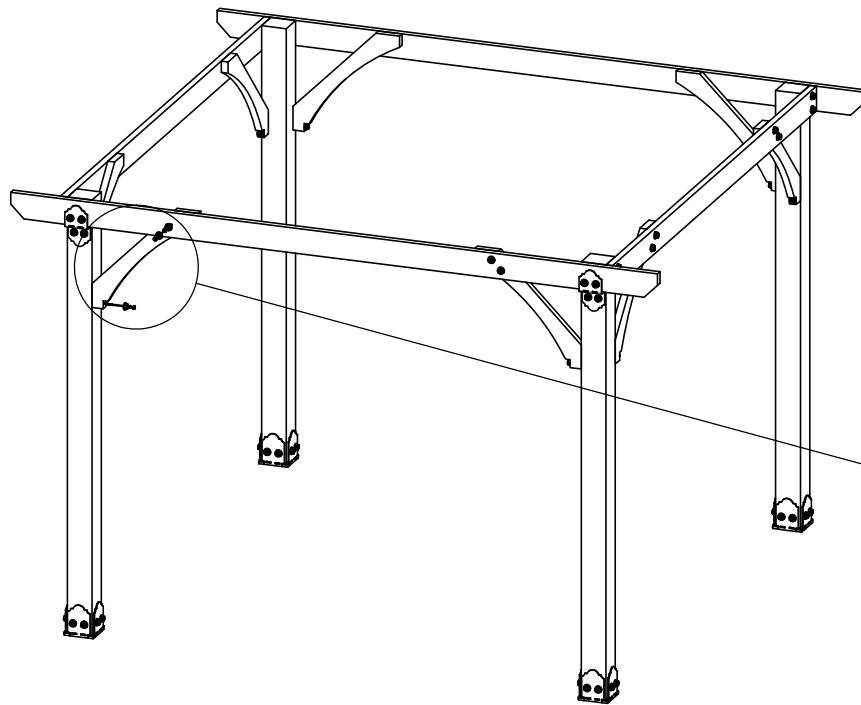

step 4

OZCO Project #311 - 12x12 Pergola Patio Shade Structure A

V1.00 - Installation Instructions effective May 1, 2015 and reflects information that available as of April 10, 2014. This information is updated periodically and should not be relied upon after May 1, 2015. Please visit www.OZCOBP.com to get current information

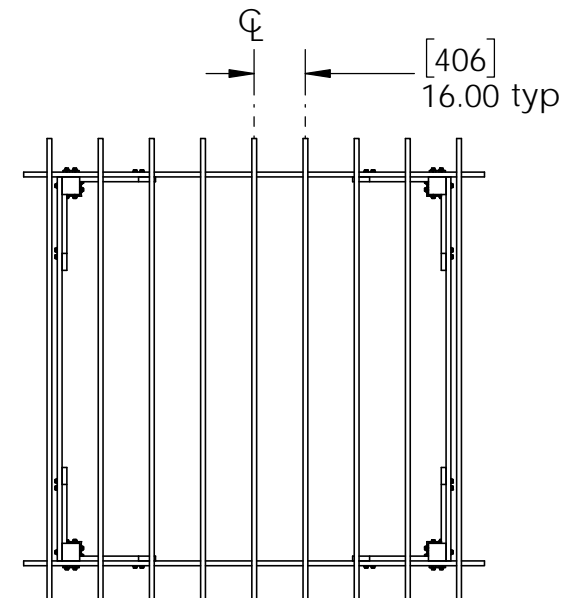
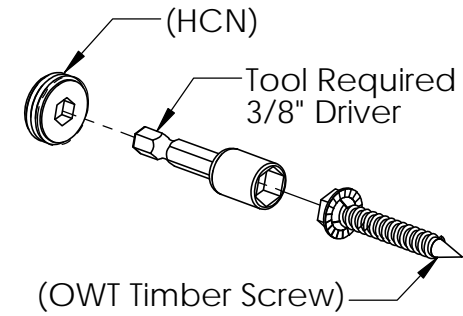
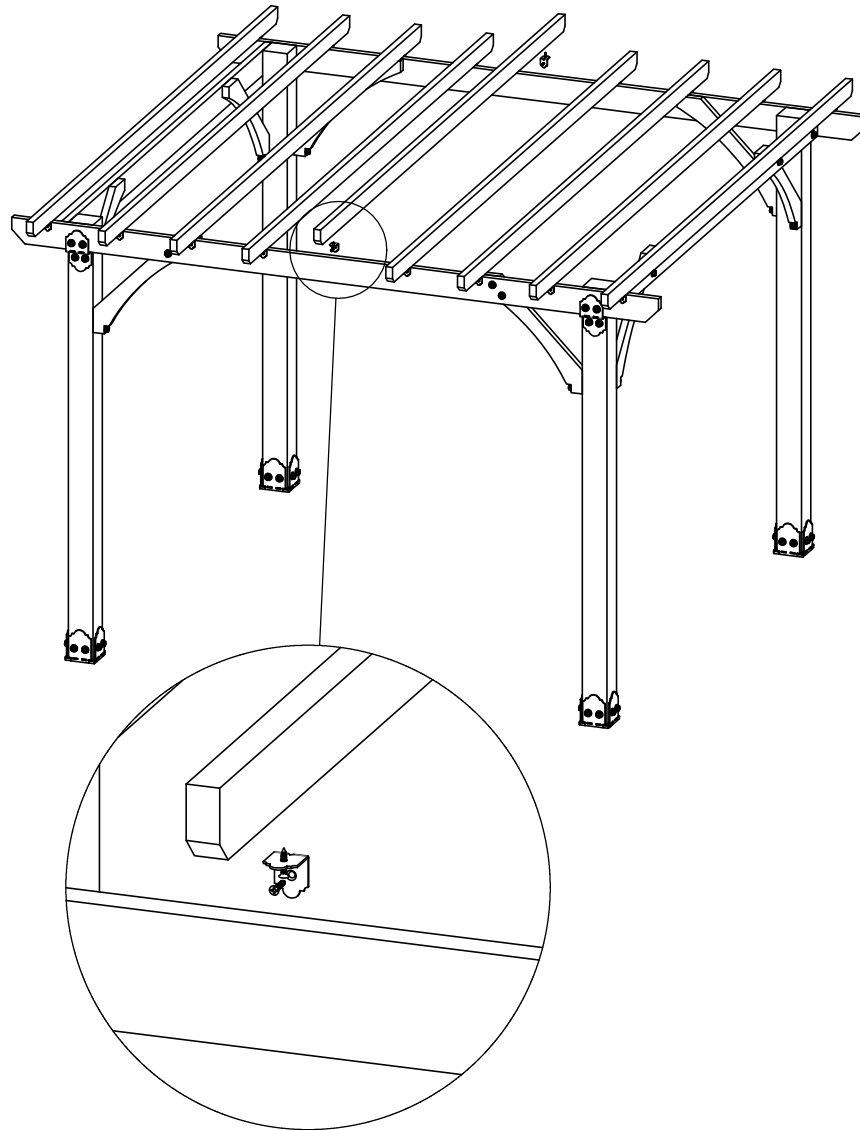

step 5

OZCO Project #311 - 12x12 Pergola Patio Shade Structure A

V1.00 - Installation Instructions effective May 1, 2015 and reflects information that available as of April 10, 2014. This information is updated periodically and should not be relied upon after May 1, 2015. Please visit www.OZCOBP.com to get current information