

**DESIGN**

**PURCHASE**

**CONSTRUCT**

**ENJOY**

## Project 226 Wood Post & Beam Pavilion (16x16) - Free Standing



shown with 1x6 roof option



**OZCO** BUILDING PRODUCTS

**OZCO Project #226 - Wood Post & Beam  
Pavilion (16x16) - Free Standing**

V2.00 - Installation Instructions, Specifications and Project Plans are effective May 1, 2015 and reflects information that available as of April 10, 2014. This information is updated periodically and should not be relied upon after October 15, 2016. Please visit [www.OZCOBP.com](http://www.OZCOBP.com) to get current information.



# Printing Documents from ISSUU

Unfortunately, there is currently no way to print content directly through issuu. To print a publication, you will need to download it and print it from your computer.

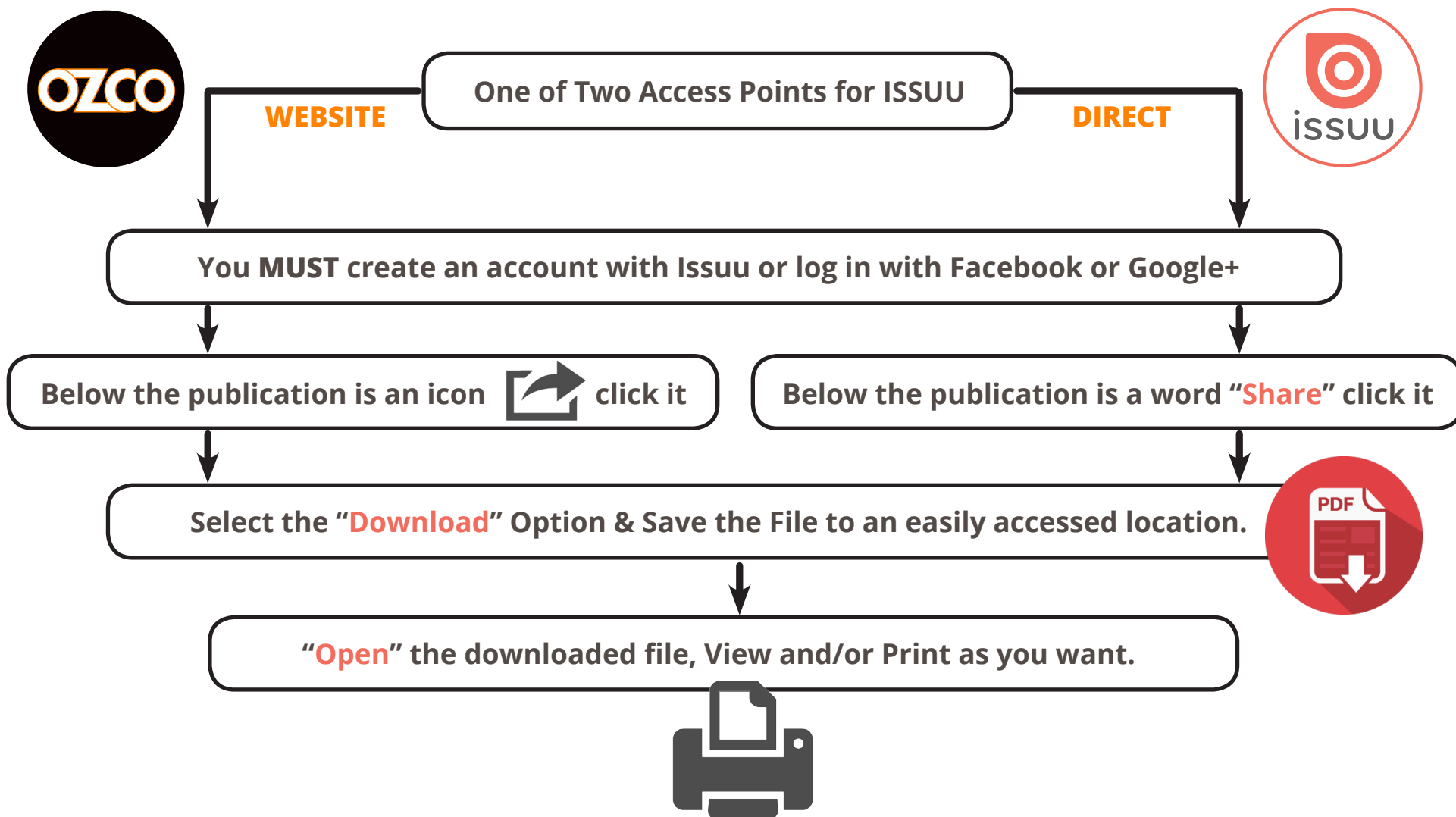

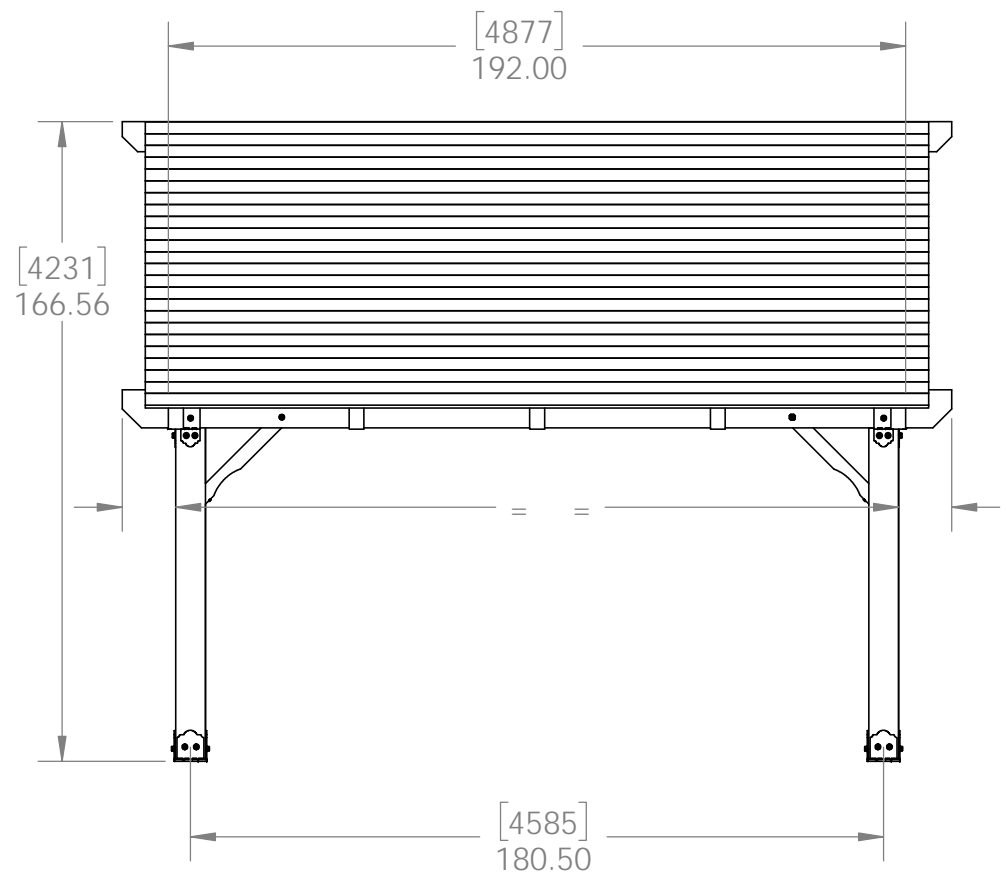
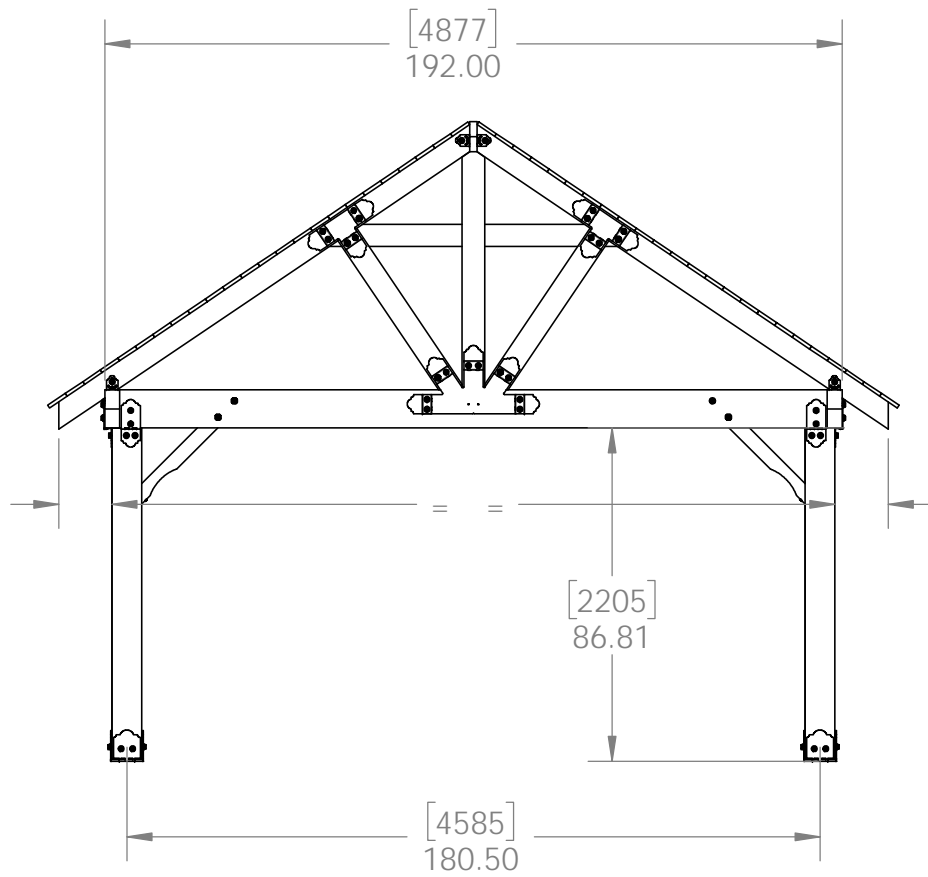

## Overview

**OZCO Project #226 - Wood Post & Beam  
Pavilion (16x16) - Free Standing**

V2.00 - Installation Instructions, Specifications and Project Plans are effective May 1, 2015 and reflects information that available as of April 10, 2014. This information is updated periodically and should not be relied upon after October 15, 2016. Please visit [www.OZCOBP.com](http://www.OZCOBP.com) to get current information.

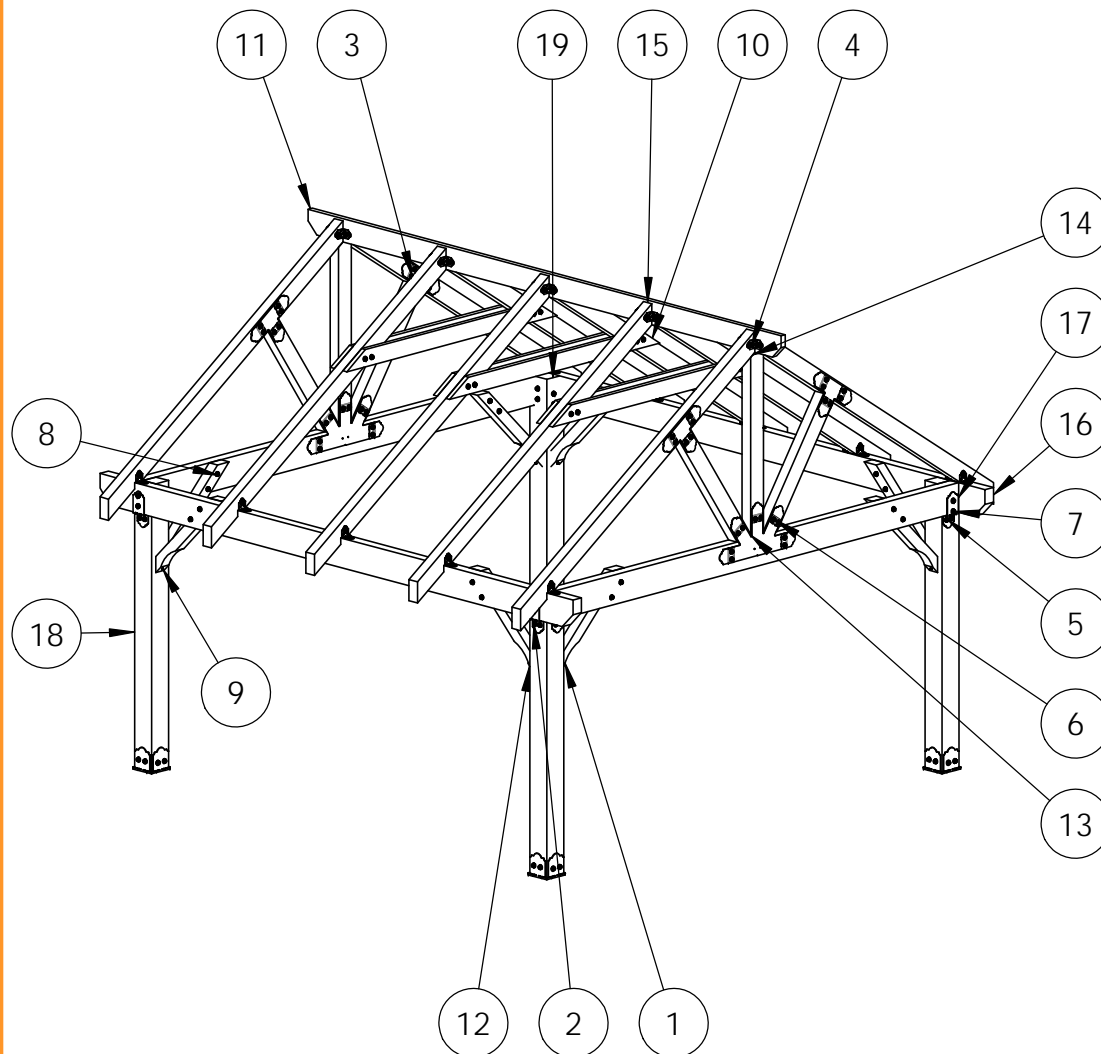

ITEM NO.	QTY.	PART NUMBER	DESCRIPTION
1	4	56609	8x8 Post Base (8x8-PB-LS)
2	2	56636	Post to Beam Bolt Offset (P2B-BO-LS)
3	4	56612	"I" Tie Plate (TIP)
	1.5	56611	Truss Accent (TA-LS)
	0.08	56625	OWT Timber Screw 1-3/4"
4	4	56618	4" Standard Rafter Clip (RC-LS-4)
5	2	56636	Post to Beam Bolt Offset (P2B-BO-LS)
6	4	56619	Truss Base Fan 8:12
	2.5	56611	Truss Accent (TA-LS)
	0.08	56625	OWT Timber Screw 1-3/4"
7	8	56651	OWT Timber Bolt 8-10"
8	14	56650	OWT Timber Bolt 6-8"
9	0.32	56629	OWT Timber Screw 7-1/2"
10	6	2x6 Cedar Board	2x6x96.00
11	1	2x8 Cedar Board	2x8x216.00
12	8	4x4 Cedar Post	4x4x42
13	4	4x6 Cedar Board	4x6x60.00
14	2	4x6 Cedar Board	4x6x62.00
15	10	4x6 Cedar Board	4x6x168.00
16	2	4x10 Cedar Board	4x10x216.00
17	2	4x10 Cedar Board	4x10x184.25
18	2	8x8 Cedar Post	8x8x96.00
19	2	8x8 Cedar Post	8x8x96.00

## Bill of Material

OZCO Project #226 - Wood Post & Beam  
Pavilion (16x16) - Free Standing

V2.00 - Installation Instructions, Specifications and Project Plans are effective May 1, 2015 and reflects information that available as of April 10, 2014. This information is updated periodically and should not be relied upon after October 15, 2016. Please visit [www.OZCOBP.com](http://www.OZCOBP.com) to get current information.

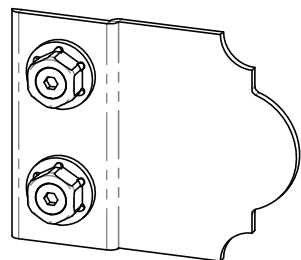

Truss Accent (TA-LS)  
56611

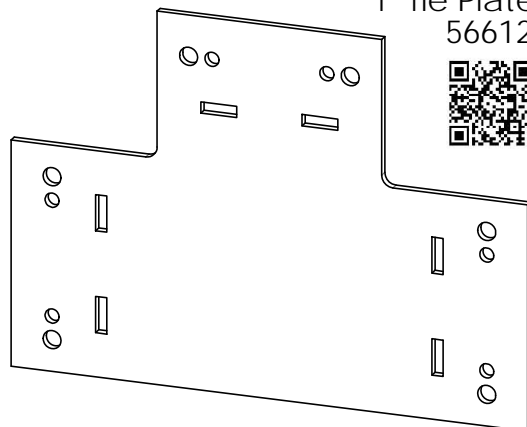

"T" Tie Plate (TTP)  
56612

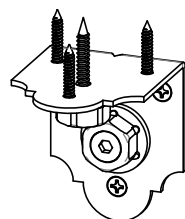

4" Standard Rafter  
Clip (RC-LS-4)  
56618

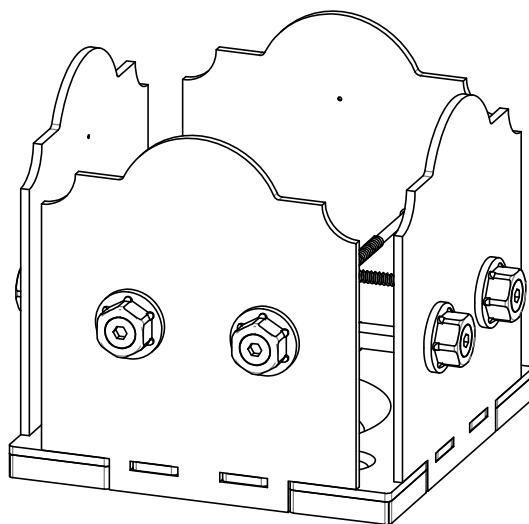

8x8 Post Base (8x8-PB-LS)  
56609

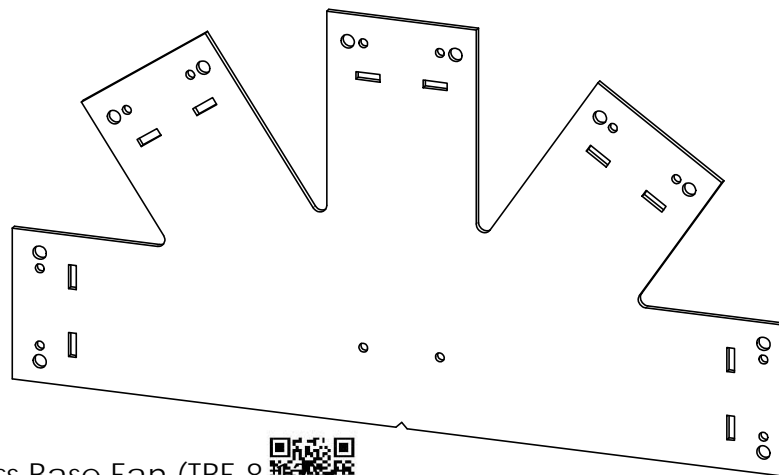

8:12 Truss Base Fan (TBF-8)  
56619



Screw, OWT 1-3/4"  
(45mm) Timber  
56625



Screw, OWT 7-1/2"  
(190mm) Timber  
56629



OWT Timber Bolt  
6-8"  
56650

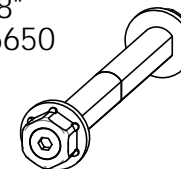

OWT Timber Bolt  
8-10"  
56651

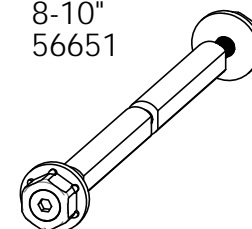

OWT Timber Bolt  
8-10"  
56651

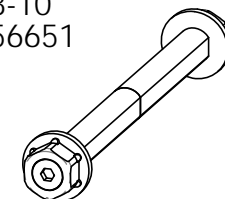

**OZCO**

OZCO Project #226 - Wood Post & Beam  
Pavilion (16x16) - Free Standing

install Ozco product with  
instructions provided in packaging

V2.00 - Installation Instructions, Specifications and Project Plans are effective May 1, 2015 and reflects information that available as of April 10, 2014. This information is updated periodically and should not be relied upon after October 15, 2016. Please visit [www.OZCOBP.com](http://www.OZCOBP.com) to get current information.

DESIGN

PURCHASE

CONSTRUCT

ENJOY

# Laredo Sunset vs. Ironwood

2 great styles  
same functionality

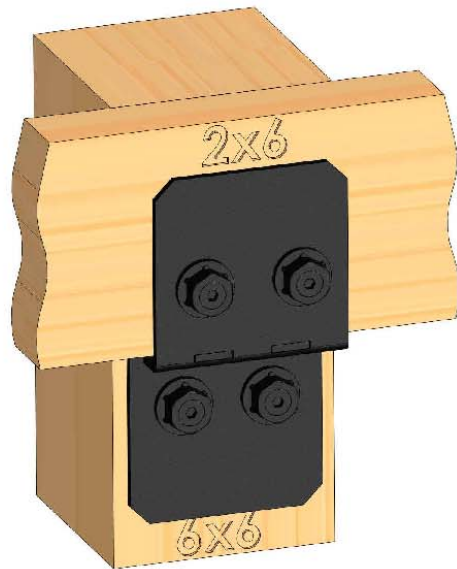

Ironwood  
(517XX series)



Laredo Sunset  
(566XX series)

choose your connection lifestyle  
both styles available for most products



OZCO BUILDING PRODUCTS

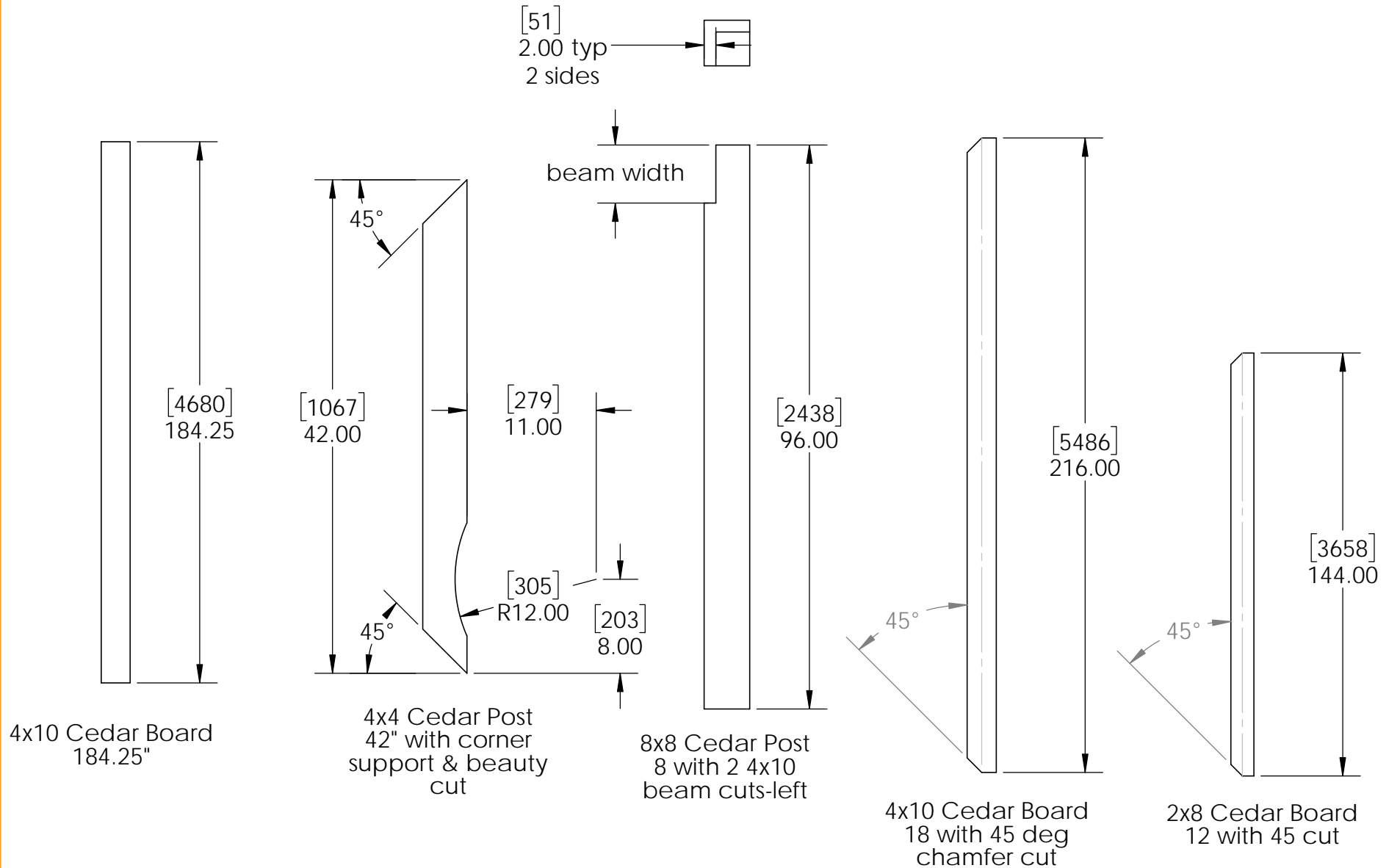

## cutlist

**OZCO Project #226 - Wood Post & Beam  
Pavilion (16x16) - Free Standing**

V2.00 - Installation Instructions, Specifications and Project Plans are effective May 1, 2015 and reflects information that available as of April 10, 2014. This information is updated periodically and should not be relied upon after October 15, 2016. Please visit [www.OZCOBP.com](http://www.OZCOBP.com) to get current information.



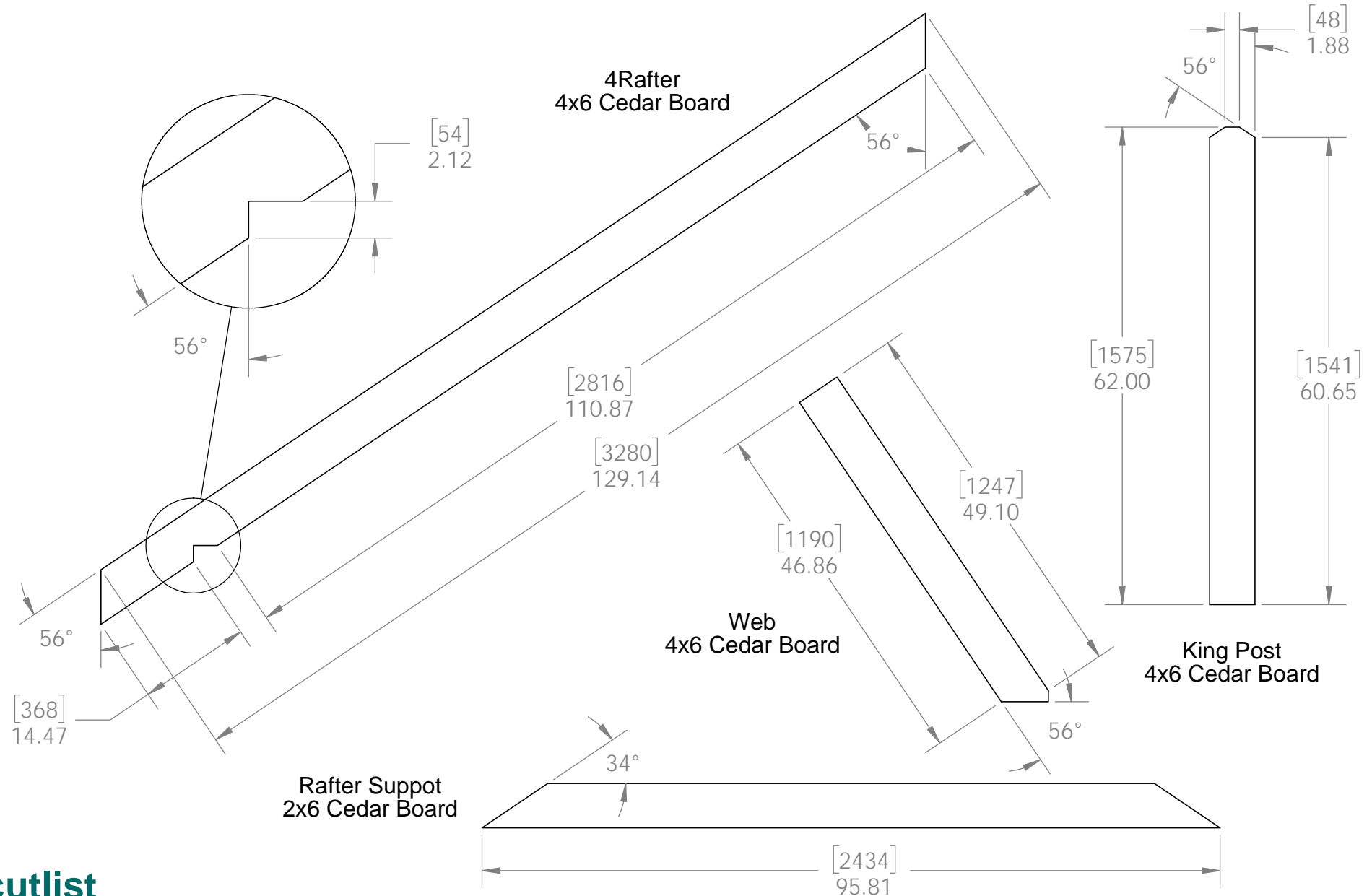

## cutlist

**OZCO Project #226 - Wood Post & Beam  
Pavilion (16x16) - Free Standing**

V2.00 - Installation Instructions, Specifications and Project Plans are effective May 1, 2015 and reflects information that available as of April 10, 2014. This information is updated periodically and should not be relied upon after October 15, 2016. Please visit [www.OZCOBP.com](http://www.OZCOBP.com) to get current information.



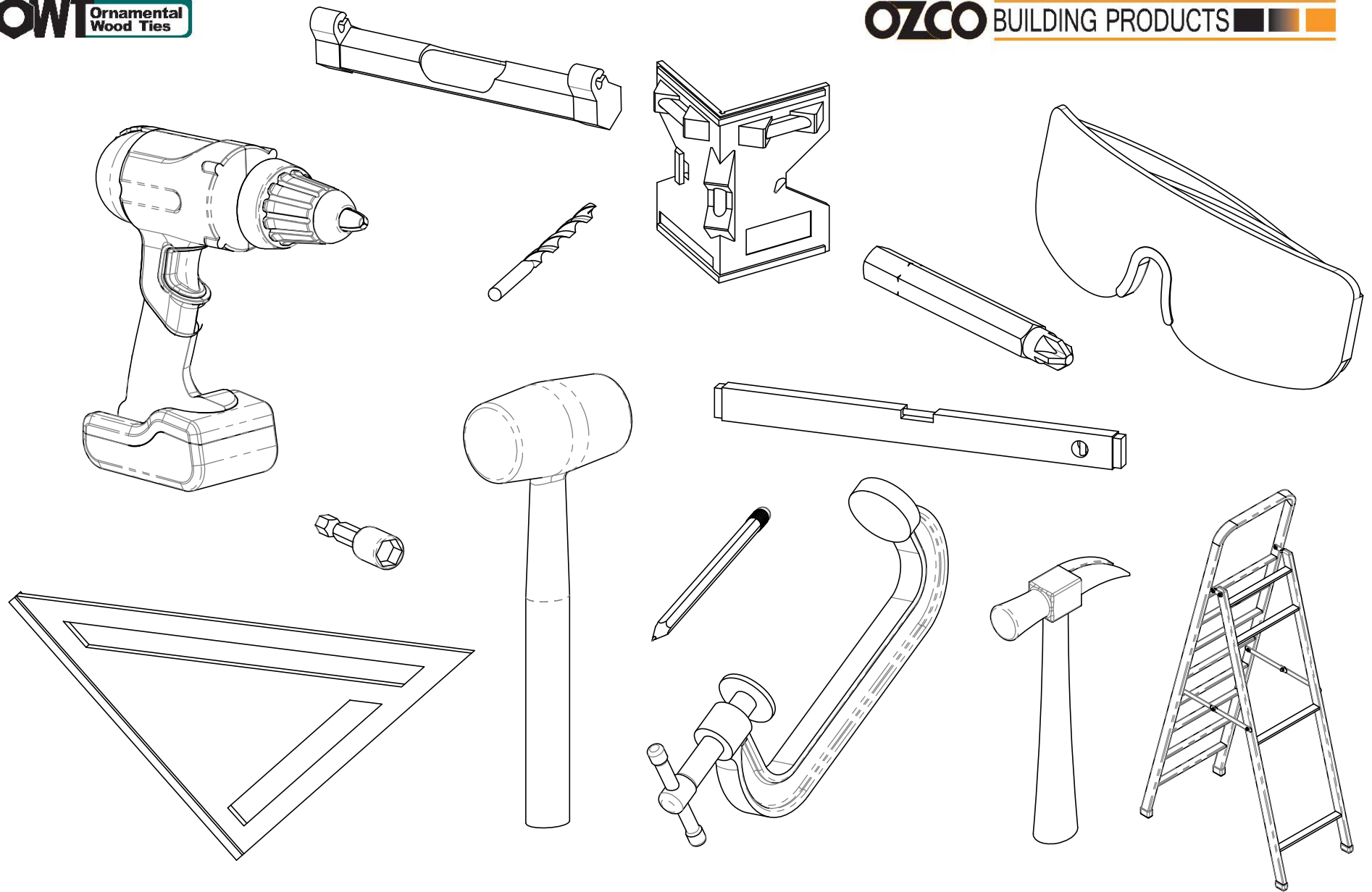

## Suggested Tools

(others may be required)

**OZCO Project #226 - Wood Post & Beam  
Pavilion (16x16) - Free Standing**

V2.00 - Installation Instructions, Specifications and Project Plans are effective May 1, 2015 and reflects information that available as of April 10, 2014. This information is updated periodically and should not be relied upon after October 15, 2016. Please visit [www.OZCOBP.com](http://www.OZCOBP.com) to get current information.

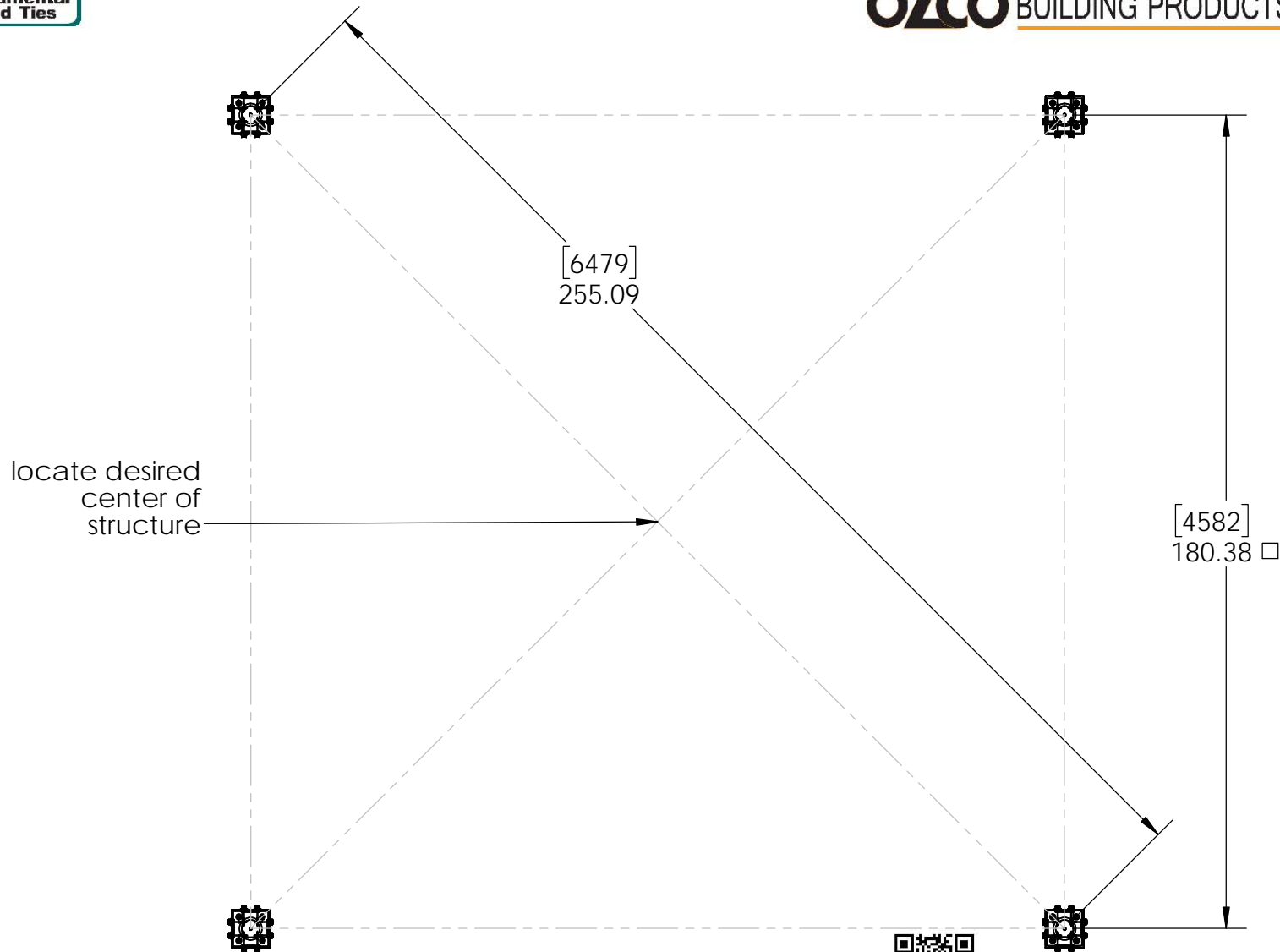

if site is not level,  
see Ozco Site Leveling instruction

## step 1

OZCO Project #226 - Wood Post & Beam  
Pavilion (16x16) - Free Standing

V2.00 - Installation Instructions, Specifications and Project Plans are effective May 1, 2015 and reflects information that available as of April 10, 2014. This information is updated periodically and should not be relied upon after October 15, 2016. Please visit [www.OZCOBP.com](http://www.OZCOBP.com) to get current information.

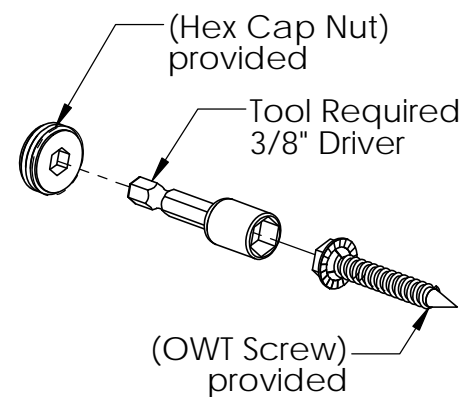
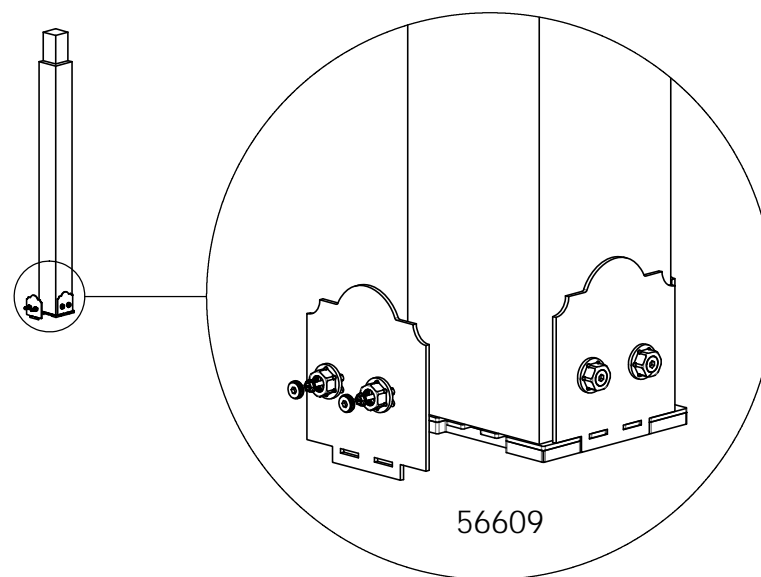
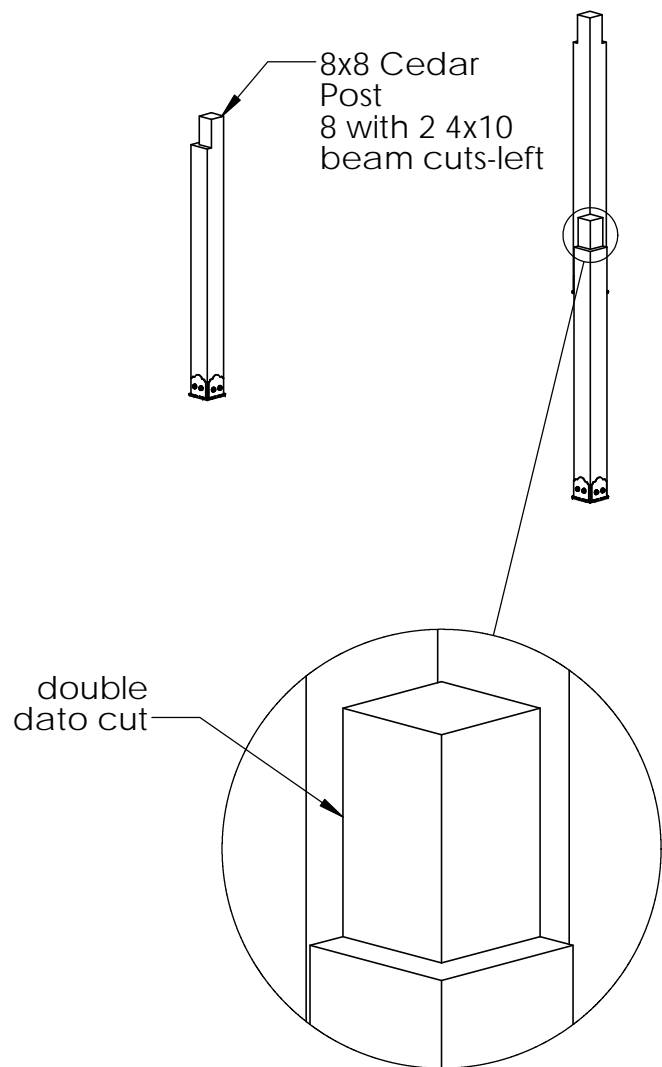

## step 1

**OZCO Project #226 - Wood Post & Beam  
Pavilion (16x16) - Free Standing**

V2.00 - Installation Instructions, Specifications and Project Plans are effective May 1, 2015 and reflects information that available as of April 10, 2014. This information is updated periodically and should not be relied upon after October 15, 2016. Please visit [www.OZCOBP.com](http://www.OZCOBP.com) to get current information.

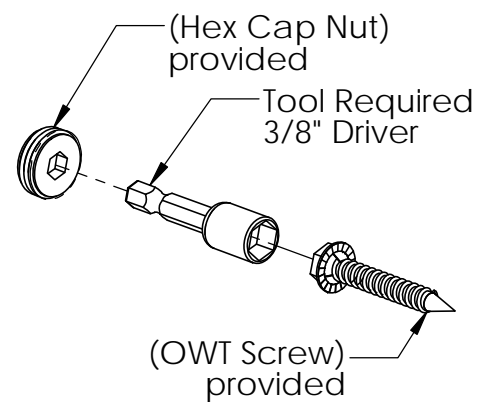
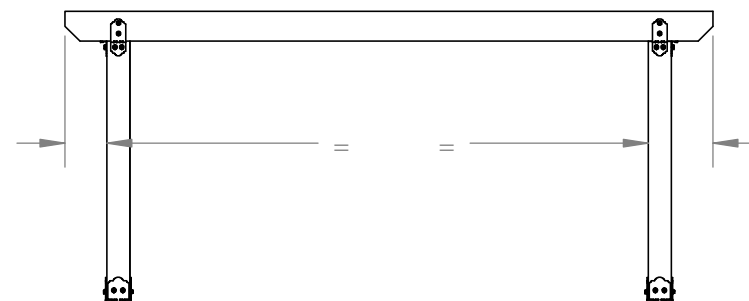
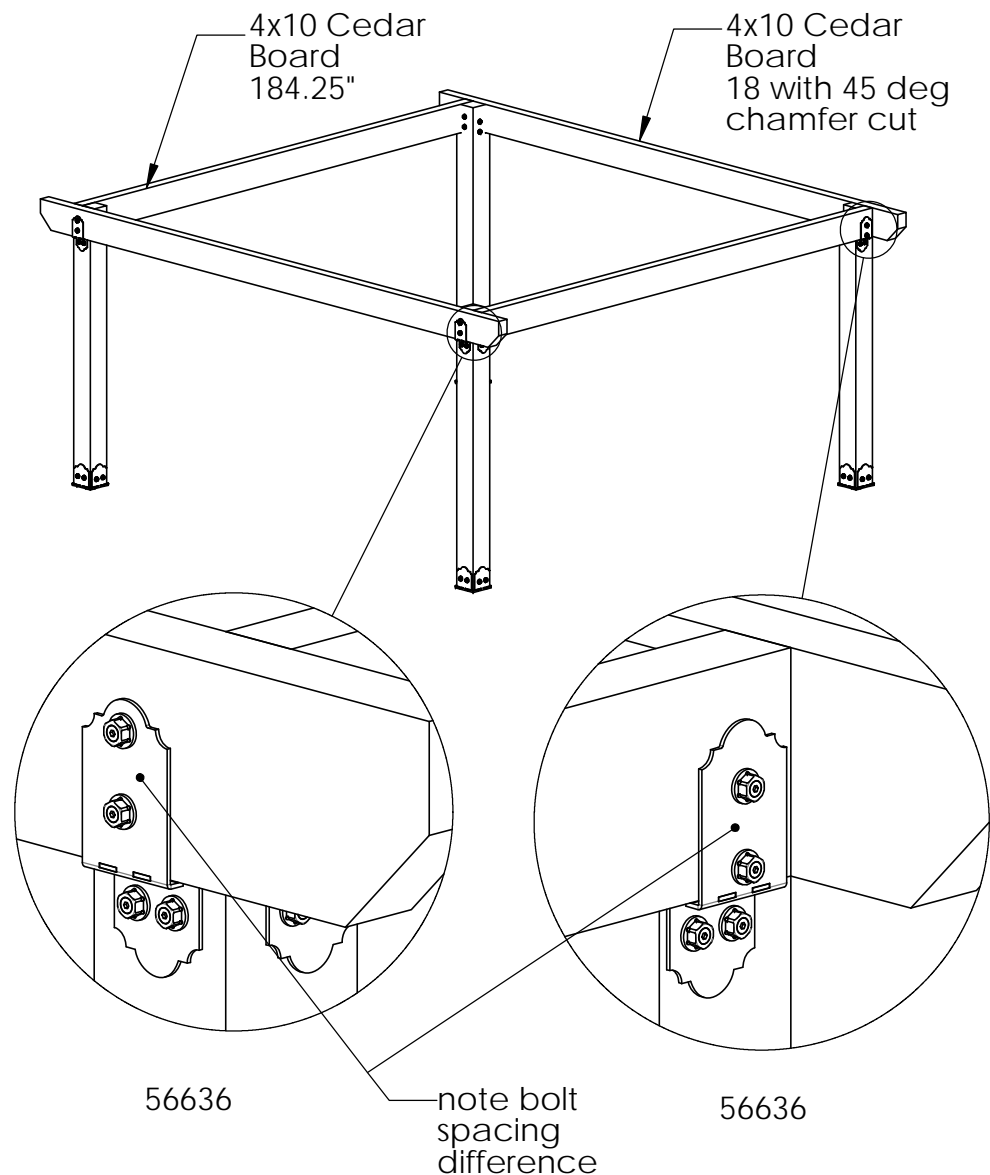

## step 2

**OZCO Project #226 - Wood Post & Beam  
Pavilion (16x16) - Free Standing**

V2.00 - Installation Instructions, Specifications and Project Plans are effective May 1, 2015 and reflects information that available as of April 10, 2014. This information is updated periodically and should not be relied upon after October 15, 2016. Please visit [www.OZCOBP.com](http://www.OZCOBP.com) to get current information.

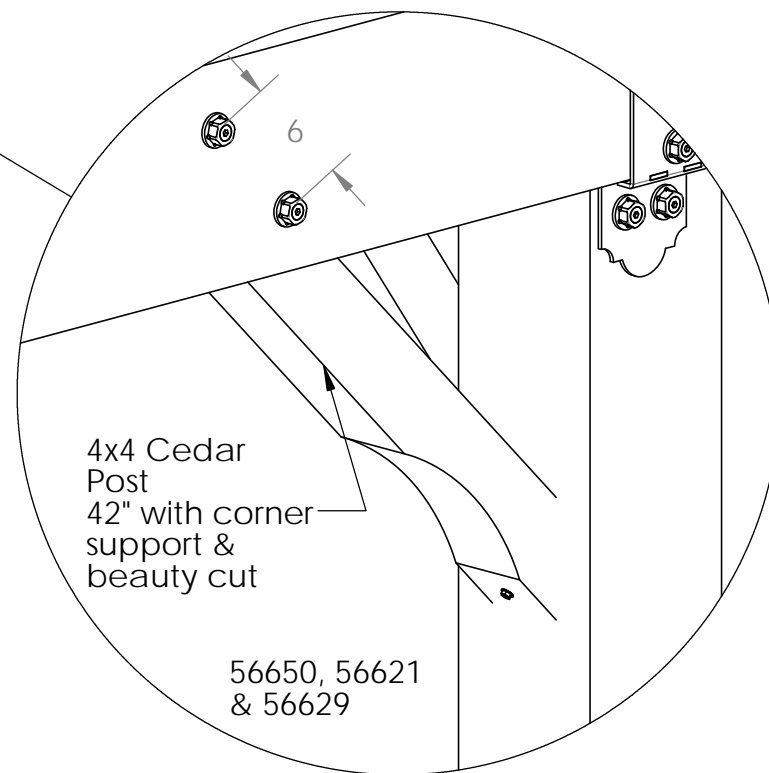
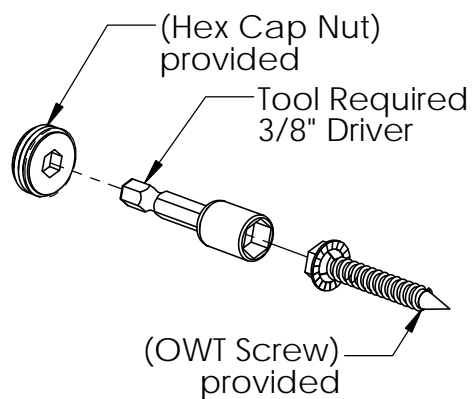
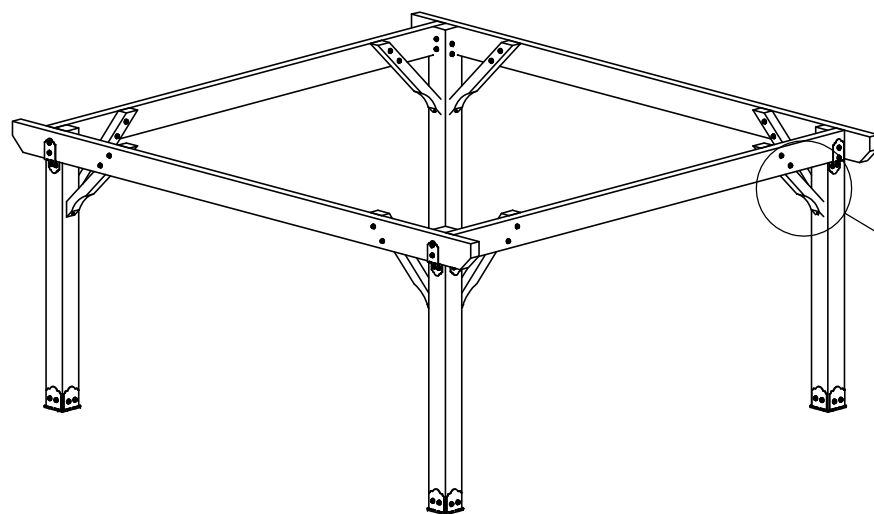

braces repeat 2x on each post  
8 total

## step 3

**OZCO Project #226 - Wood Post & Beam  
Pavilion (16x16) - Free Standing**

V2.00 - Installation Instructions, Specifications and Project Plans are effective May 1, 2015 and reflects information that available as of April 10, 2014. This information is updated periodically and should not be relied upon after October 15, 2016. Please visit [www.OZCOBP.com](http://www.OZCOBP.com) to get current information.

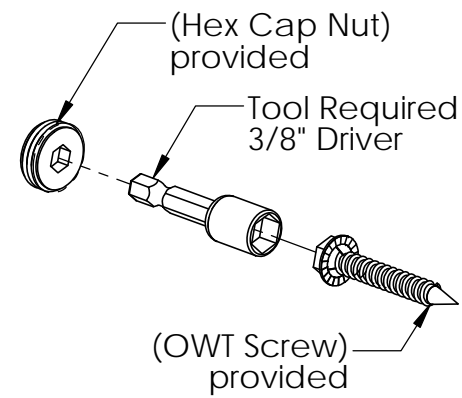
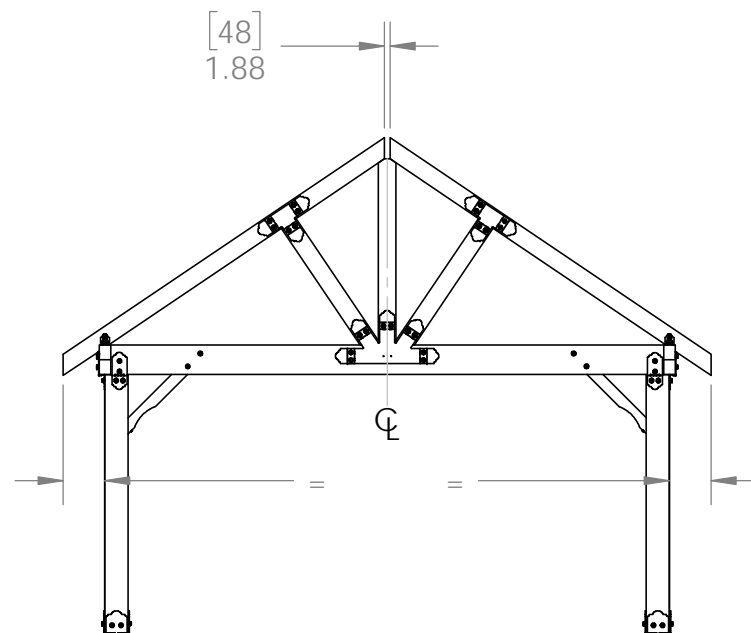
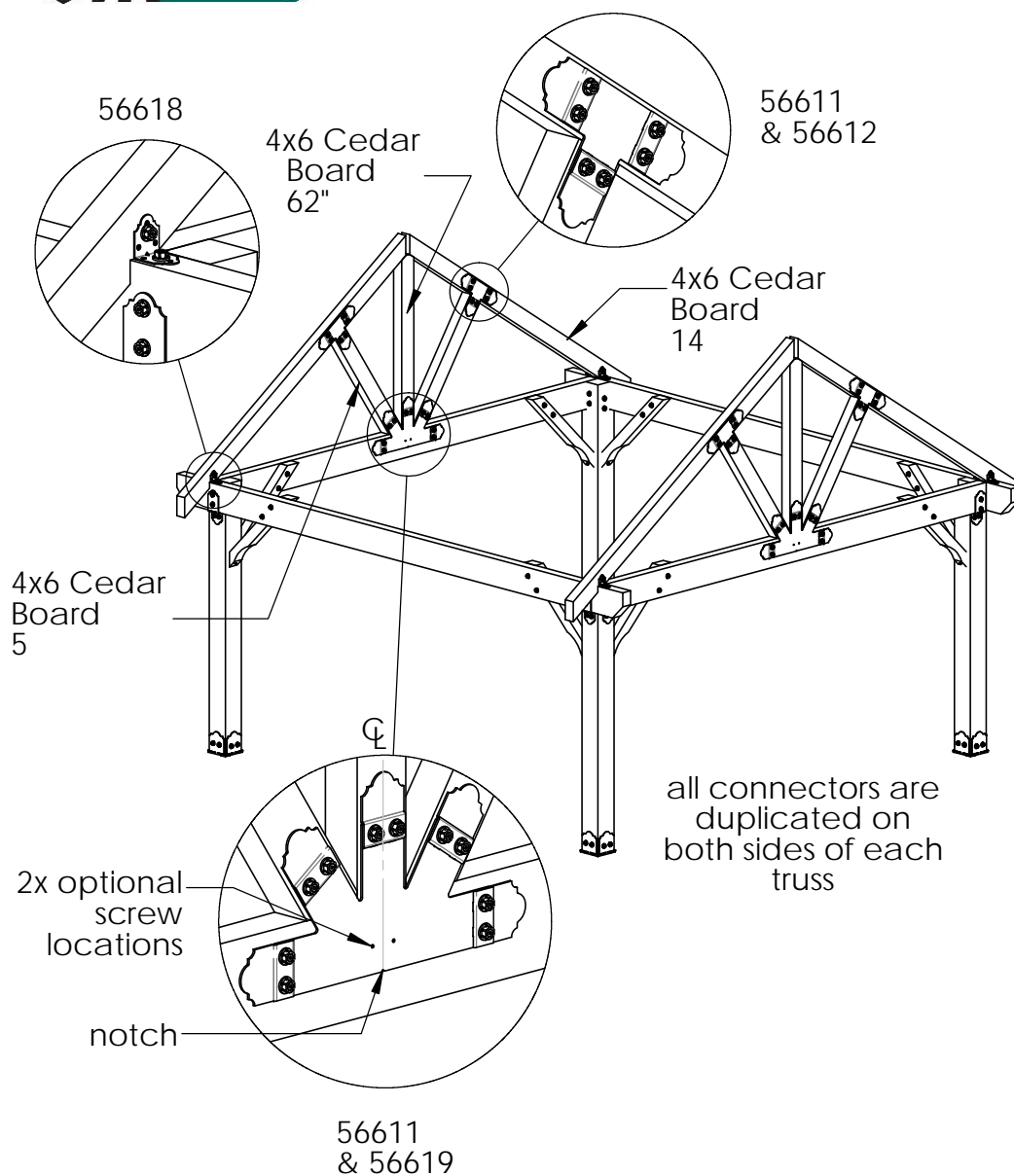

## step 4

**OZCO Project #226 - Wood Post & Beam  
Pavilion (16x16) - Free Standing**

V2.00 - Installation Instructions, Specifications and Project Plans are effective May 1, 2015 and reflects information that available as of April 10, 2014. This information is updated periodically and should not be relied upon after October 15, 2016. Please visit [www.OZCOBP.com](http://www.OZCOBP.com) to get current information.

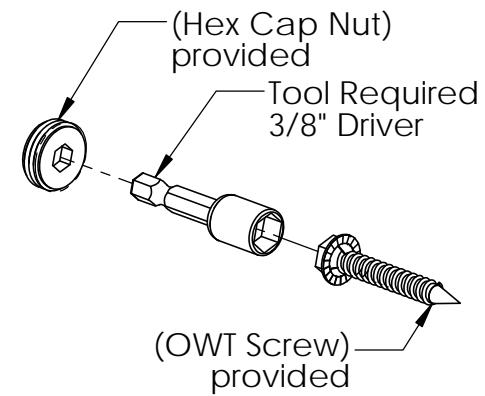
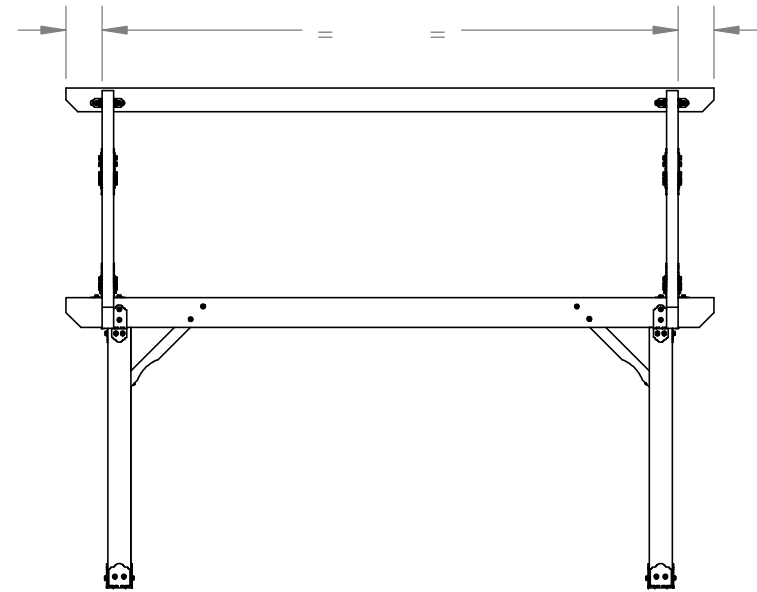
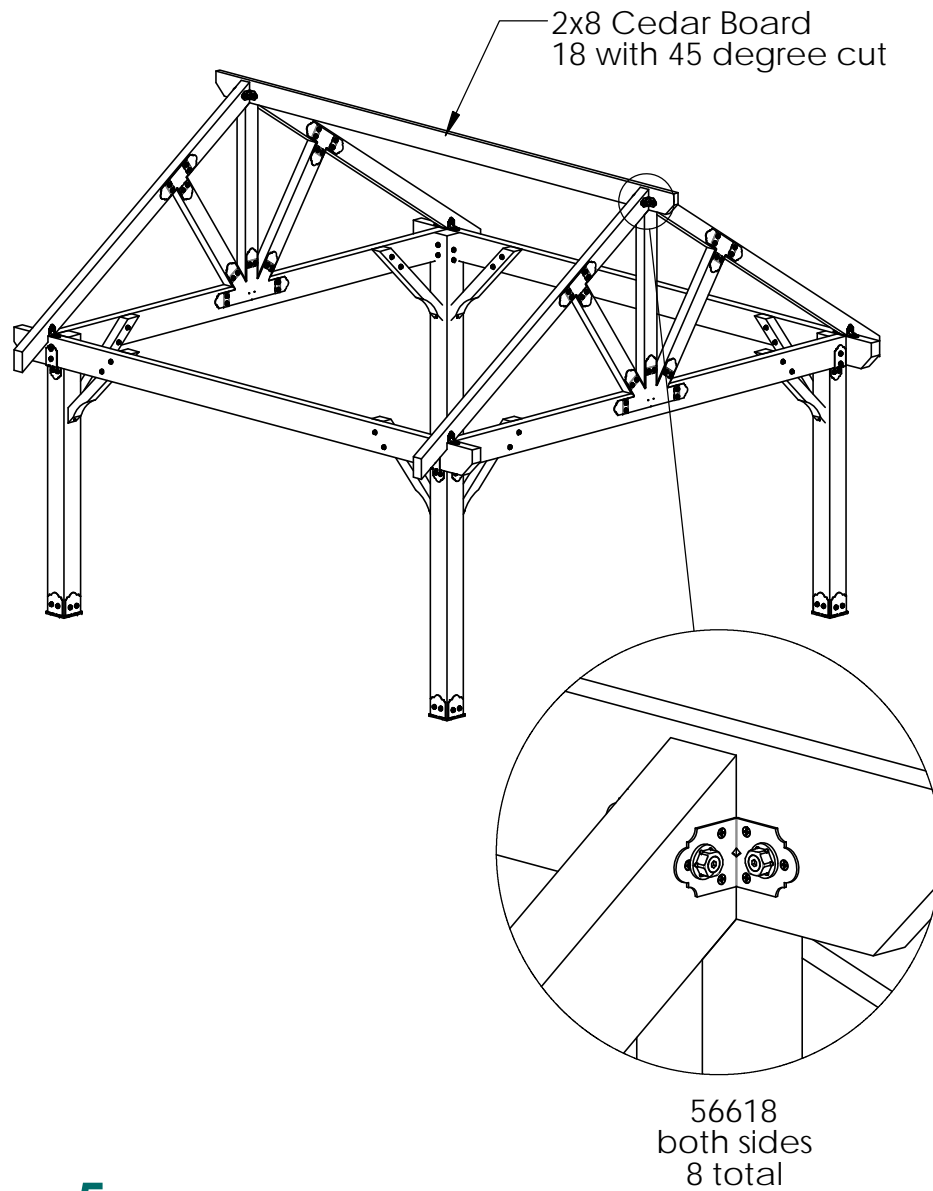

## step 5

**OZCO Project #226 - Wood Post & Beam  
Pavilion (16x16) - Free Standing**

V2.00 - Installation Instructions, Specifications and Project Plans are effective May 1, 2015 and reflects information that available as of April 10, 2014. This information is updated periodically and should not be relied upon after October 15, 2016. Please visit [www.OZCOBP.com](http://www.OZCOBP.com) to get current information.



4x6 Cedar  
Board  
14

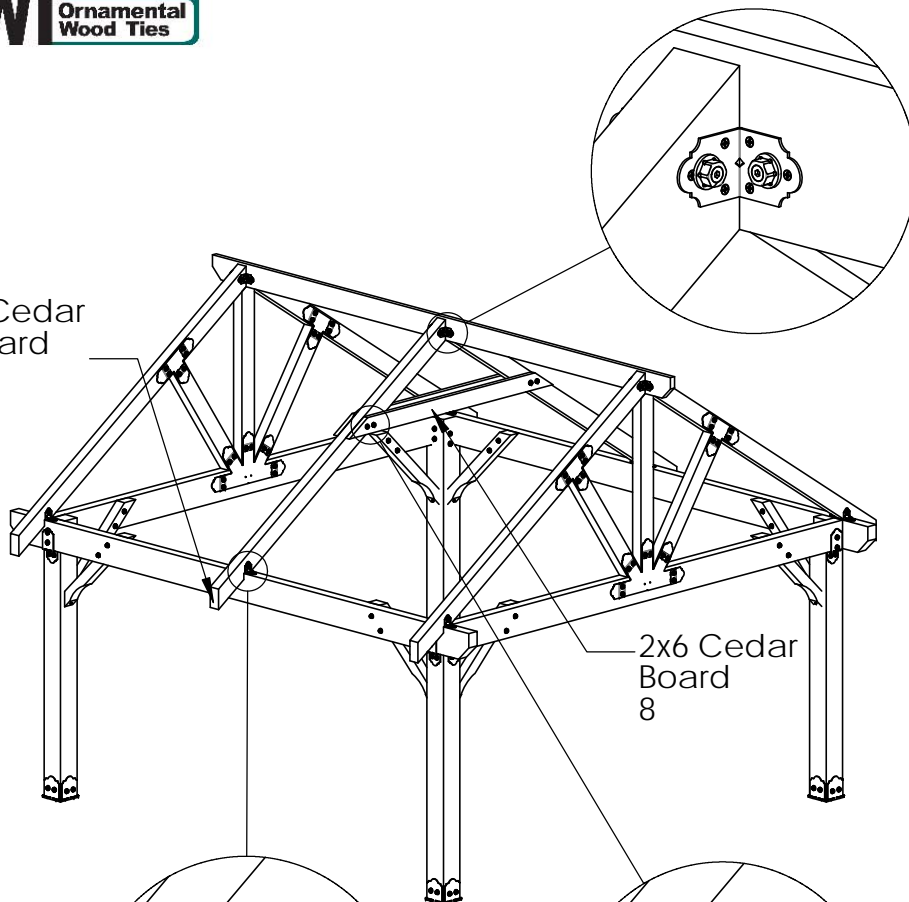

56618  
both sides

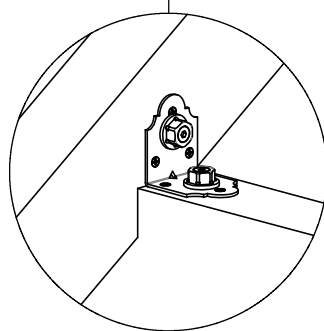

56618  
both sides

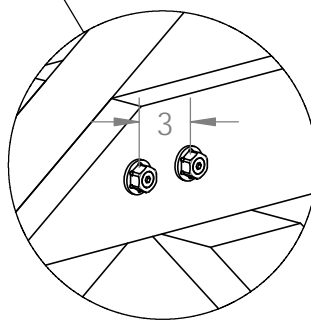

56650

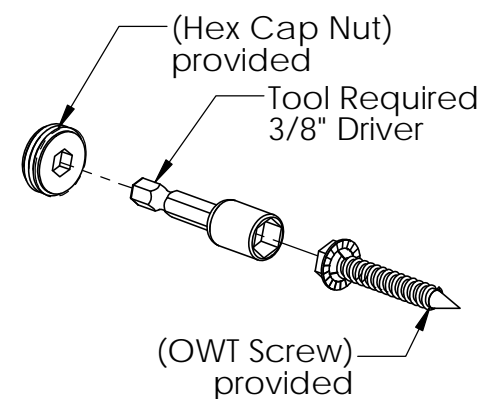
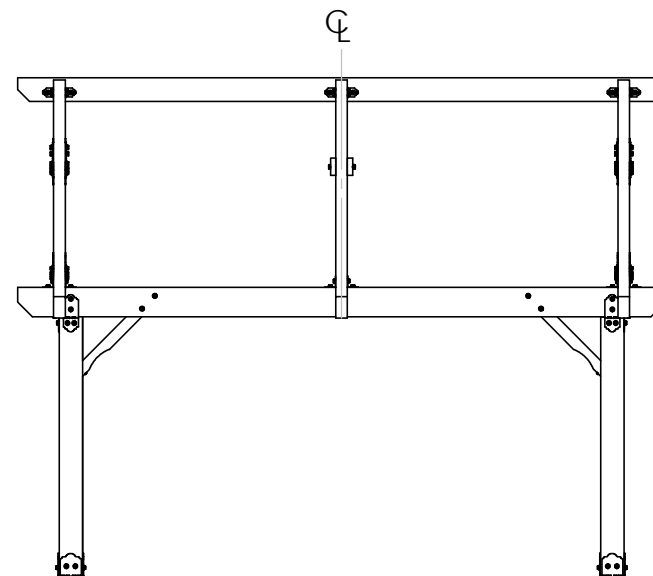

## step 6

**OZCO Project #226 - Wood Post & Beam  
Pavilion (16x16) - Free Standing**

V2.00 - Installation Instructions, Specifications and Project Plans are effective May 1, 2015 and reflects information that available as of April 10, 2014. This information is updated periodically and should not be relied upon after October 15, 2016. Please visit [www.OZCOBP.com](http://www.OZCOBP.com) to get current information.

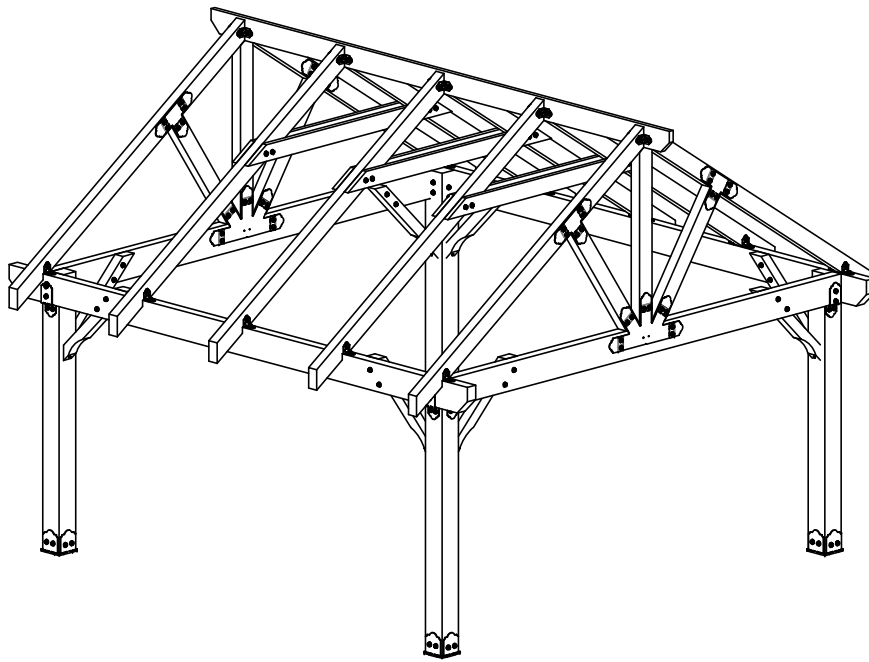

repeat previous step as shown

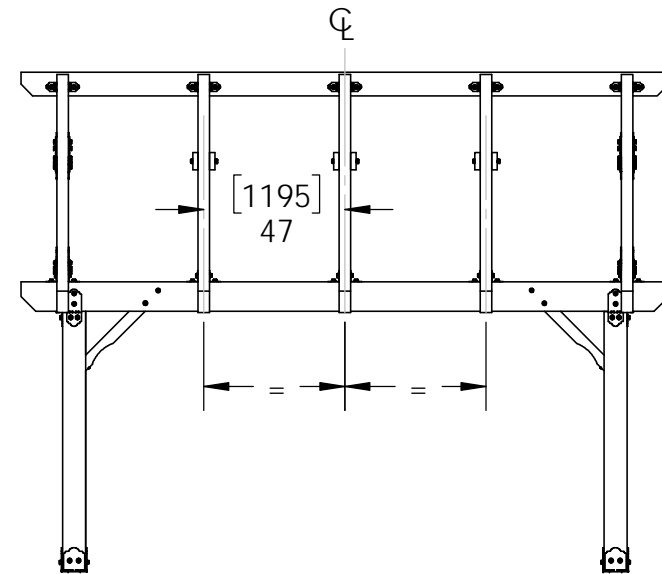

## step 7

**OZCO Project #226 - Wood Post & Beam  
Pavilion (16x16) - Free Standing**

V2.00 - Installation Instructions, Specifications and Project Plans are effective May 1, 2015 and reflects information that available as of April 10, 2014. This information is updated periodically and should not be relied upon after October 15, 2016. Please visit [www.OZCOBP.com](http://www.OZCOBP.com) to get current information.

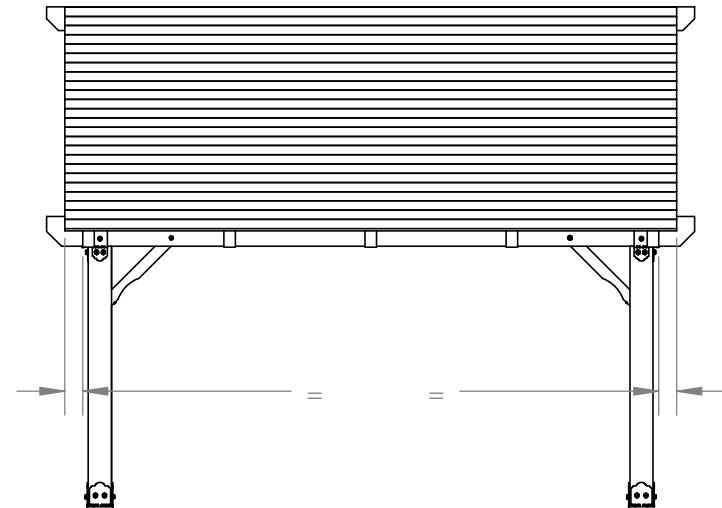
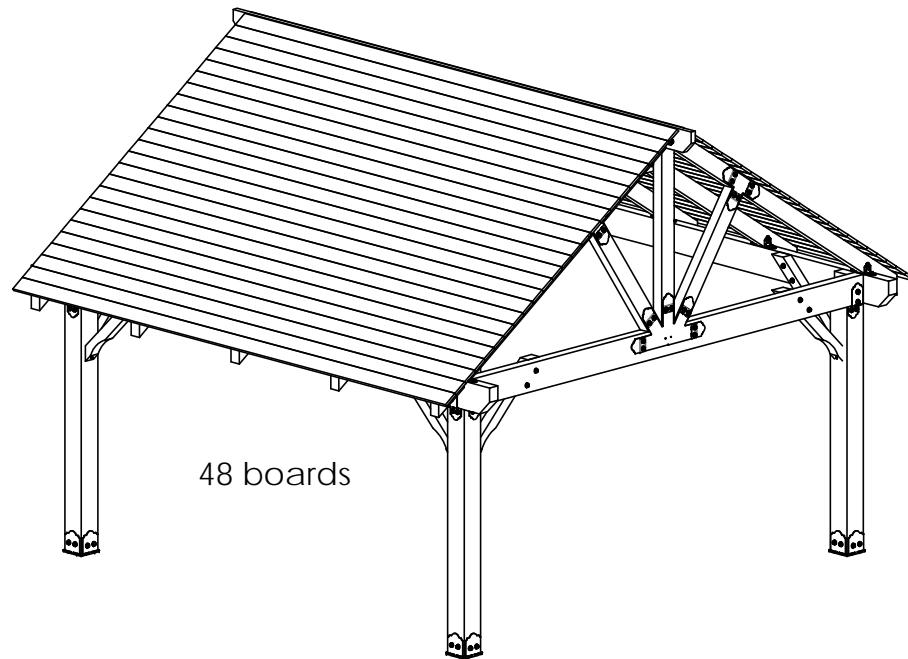

## roof option-1x6

**OZCO Project #226 - Wood Post & Beam  
Pavilion (16x16) - Free Standing**

V2.00 - Installation Instructions, Specifications and Project Plans are effective May 1, 2015 and reflects information that available as of April 10, 2014. This information is updated periodically and should not be relied upon after October 15, 2016. Please visit [www.OZCOBP.com](http://www.OZCOBP.com) to get current information.

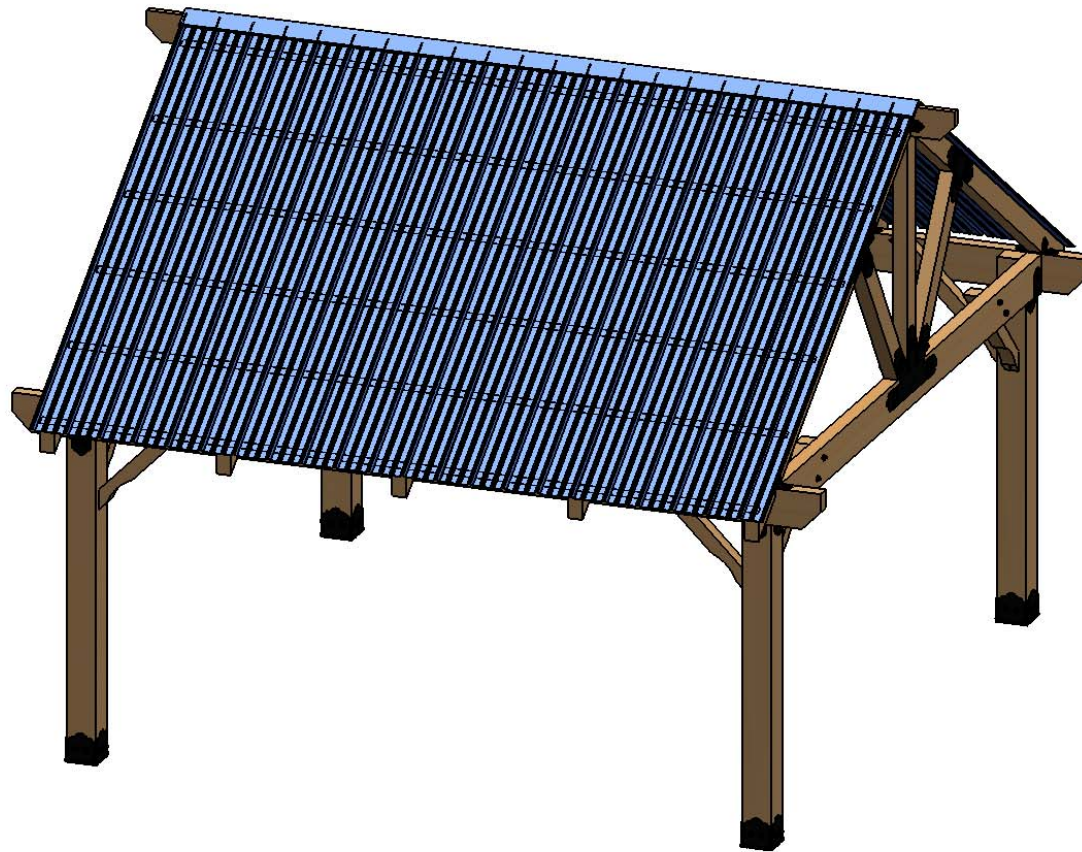

Metal Sales Classic Rib metal roof option

## Metal Roofing Option

**OZCO Project #226 - Wood Post & Beam  
Pavilion (16x16) - Free Standing**

V2.00 - Installation Instructions, Specifications and Project Plans are effective May 1, 2015 and reflects information that available as of April 10, 2014. This information is updated periodically and should not be relied upon after October 15, 2016. Please visit [www.OZCOBP.com](http://www.OZCOBP.com) to get current information.