

DESIGN

PURCHASE

CONSTRUCT

ENJOY

OZCO Project #223 - Wood Post & Beam Pavilion (20x32) - Free Standing

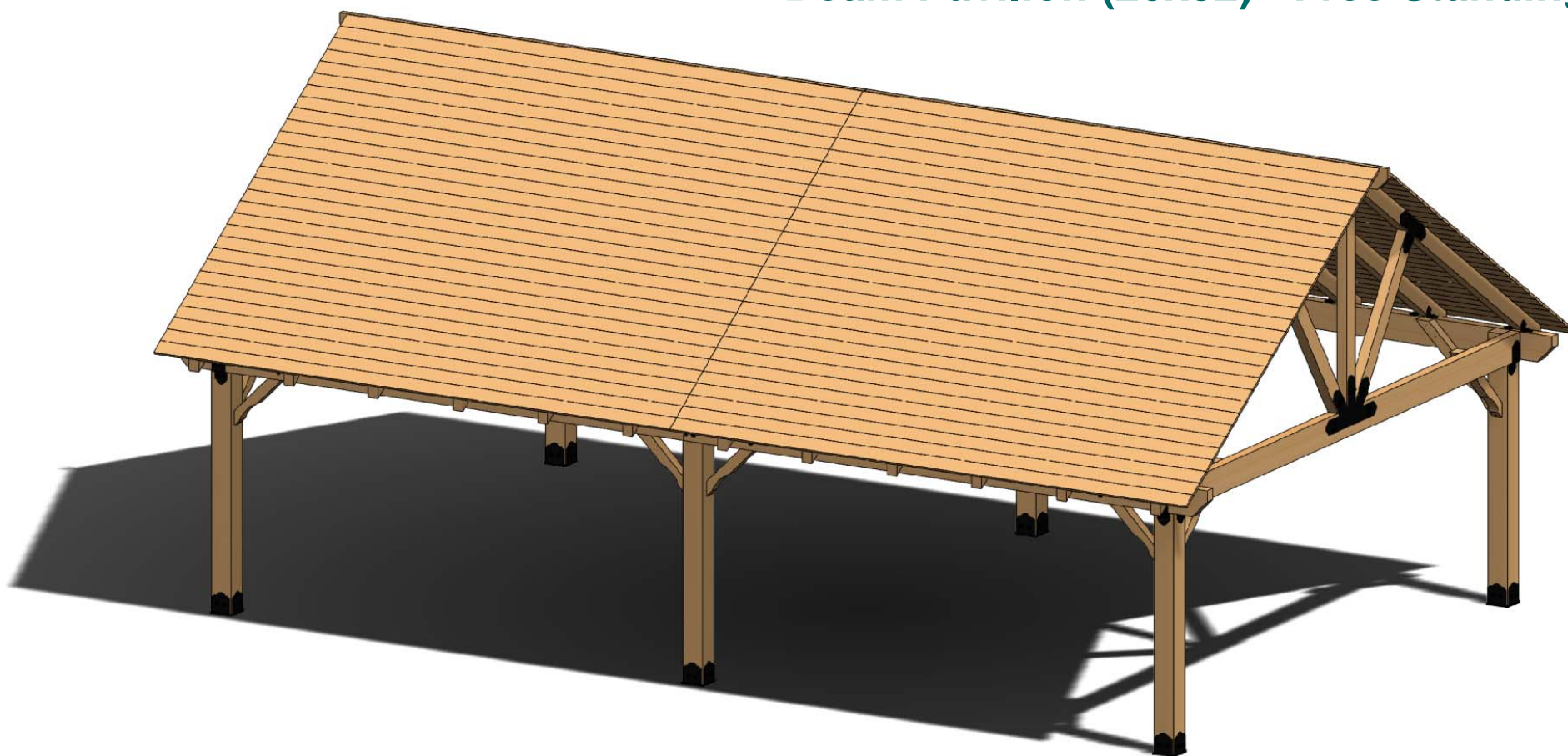

shown with 1x6 roof option



OZCO BUILDING PRODUCTS

OZCO Project #223 - Wood Post & Beam
Pavilion (20x32) - Free Standing

V1.00 - Installation Instructions effective May 1, 2015 and reflects information that available as of April 10, 2014. This information is updated periodically and should not be relied upon after May 1, 2015. Please visit www.OZCOBP.com to get current information



Printing Documents from ISSUU

Unfortunately, there is currently no way to print content directly through issuu. To print a publication, you will need to download it and print it from your computer.

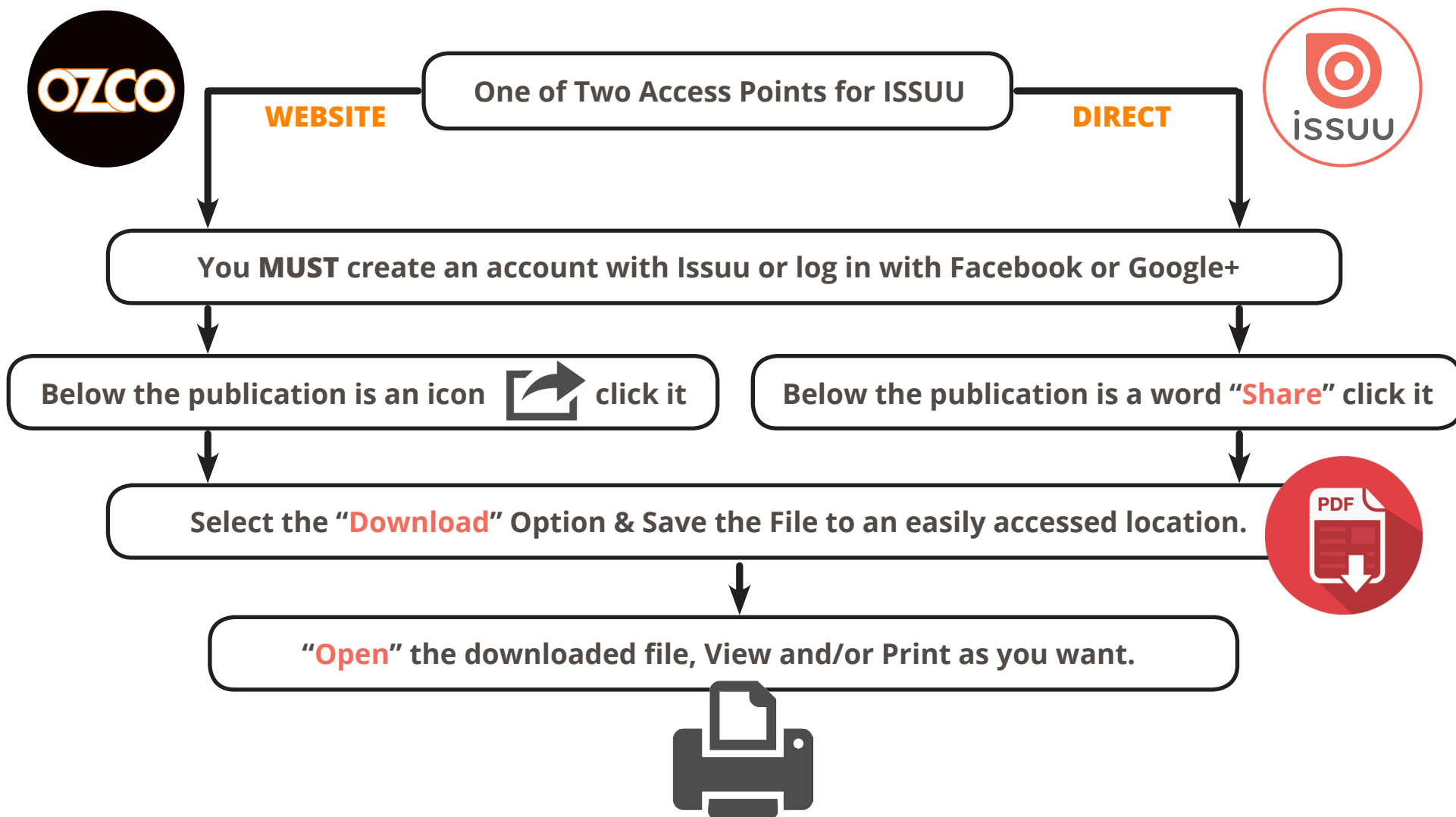

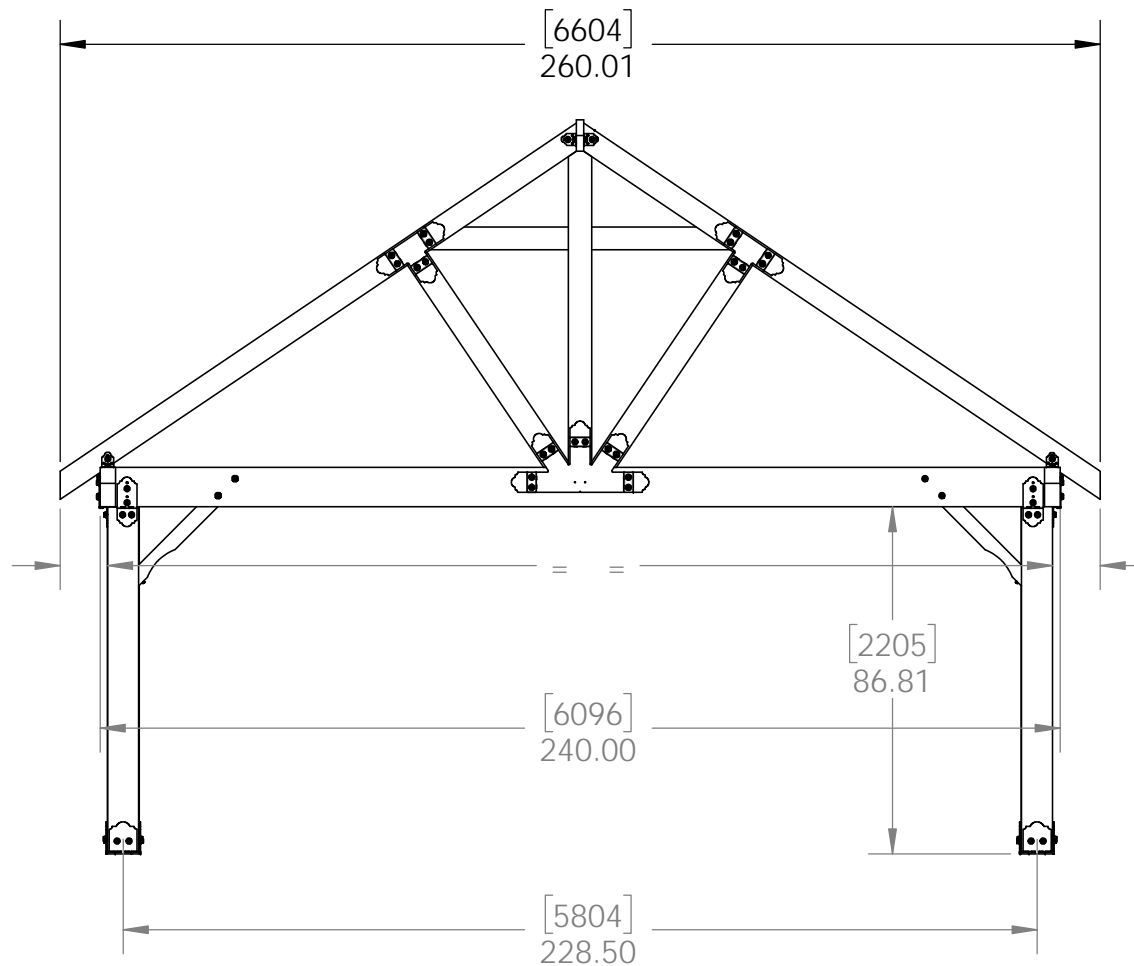

Overview-Front

OZCO Project #223 - Wood Post & Beam
Pavilion (20x32) - Free Standing

V1.00 - Installation Instructions effective May 1, 2015 and reflects information that available as of April 10, 2014. This information is updated periodically and should not be relied upon after May 1, 2015. Please visit www.OZCOBP.com to get current information

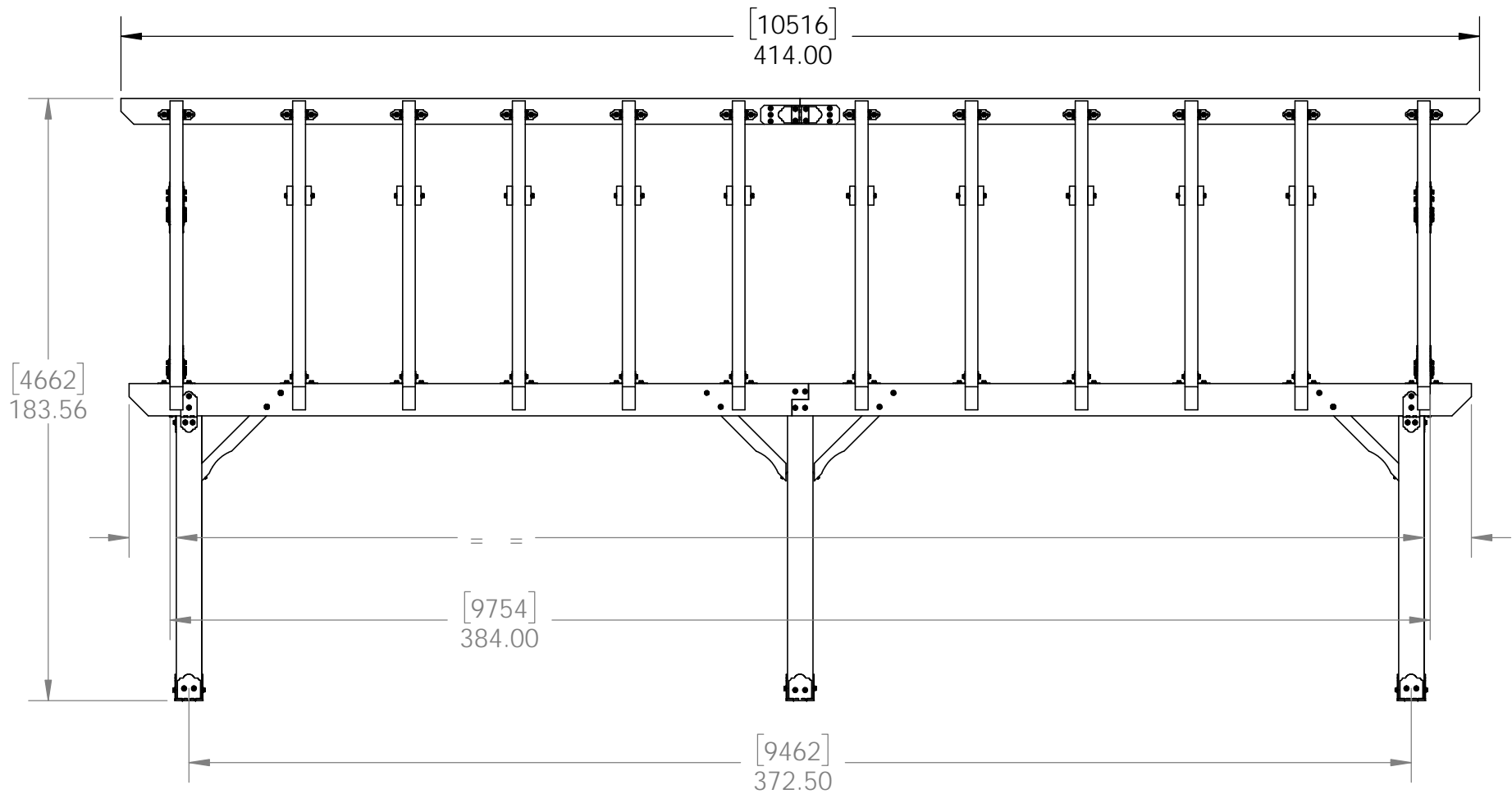

Overview-Side

**OZCO Project #223 - Wood Post & Beam
Pavilion (20x32) - Free Standing**

V2.00 - Installation Instructions, Specifications and Project Plans are effective May 1, 2015 and reflects information that available as of April 10, 2014. This information is updated periodically and should not be relied upon after October 15, 2016. Please visit www.OZCOBP.com to get current information.

ITEM NO.	QTY.	PART NUMBER	DESCRIPTION
1	6	56609	8x8 Post Base (8x8-PB-LS)
2	4	56612	"T" Tie Plate (TTP)
	1.5	56611	Truss Accent (TA-LS)
	0.08	56625	OWT Timber Screw 1-3/4"
3	2	56613	Butt Joint Flush (BJF)
	1	56611	Truss Accent (TA-LS)
	1	56611-10	Truss Accent
4	9.6	56618	4" Standard Rafter Clip (RC-LS-4)
5	4	56636	Post to Beam Bolt Offset (P2B-BO-LS)
6	6	56649	OWT Timber Bolt 4-6"
7	4	56650	OWT Timber Bolt 6-8"
8	12	56650	OWT Timber Bolt 6-8"
9	20	56650	OWT Timber Bolt 6-8"
10	12	56651	OWT Timber Bolt 8-10"
11	4	56619	Truss Base Fan 8:12
	2.5	56611	Truss Accent (TA-LS)
	0.08	56625	OWT Timber Screw 1-3/4"
12	0.48	56629	OWT Timber Screw 7-1/2"
13	20	2x6 Cedar Board	2x6x96.00
14	2	2x6 Cedar Board	2x6x24.00
15	2	2x8 Cedar Board	2x8x207.00
16	12	4x4 Cedar Post	4x4x42
17	4	4x6 Cedar Board	4x6x72.00
18	2	4x6 Cedar Board	4x6x79.00
19	24	4x6 Cedar Board	4x6x168.00
20	2	4x10 Cedar Board	4x10x207.00
21	2	4x10 Cedar Board	4x10x232.25
22	2	4x10 Cedar Board	4x10x207.00
23	2	8x8 Cedar Post	8x8x96.00
24	2	8x8 Cedar Post	8x8x96.00
25	2	8x8 Cedar Post	8x8x96.00

Bill of Material

OZCO Project #223 - Wood Post & Beam
Pavilion (20x32) - Free Standing

V1.00 - Installation Instructions effective May 1, 2015 and reflects information that available as of April 10, 2014. This information is updated periodically and should not be relied upon after May 1, 2015. Please visit www.OZCOBP.com to get current information

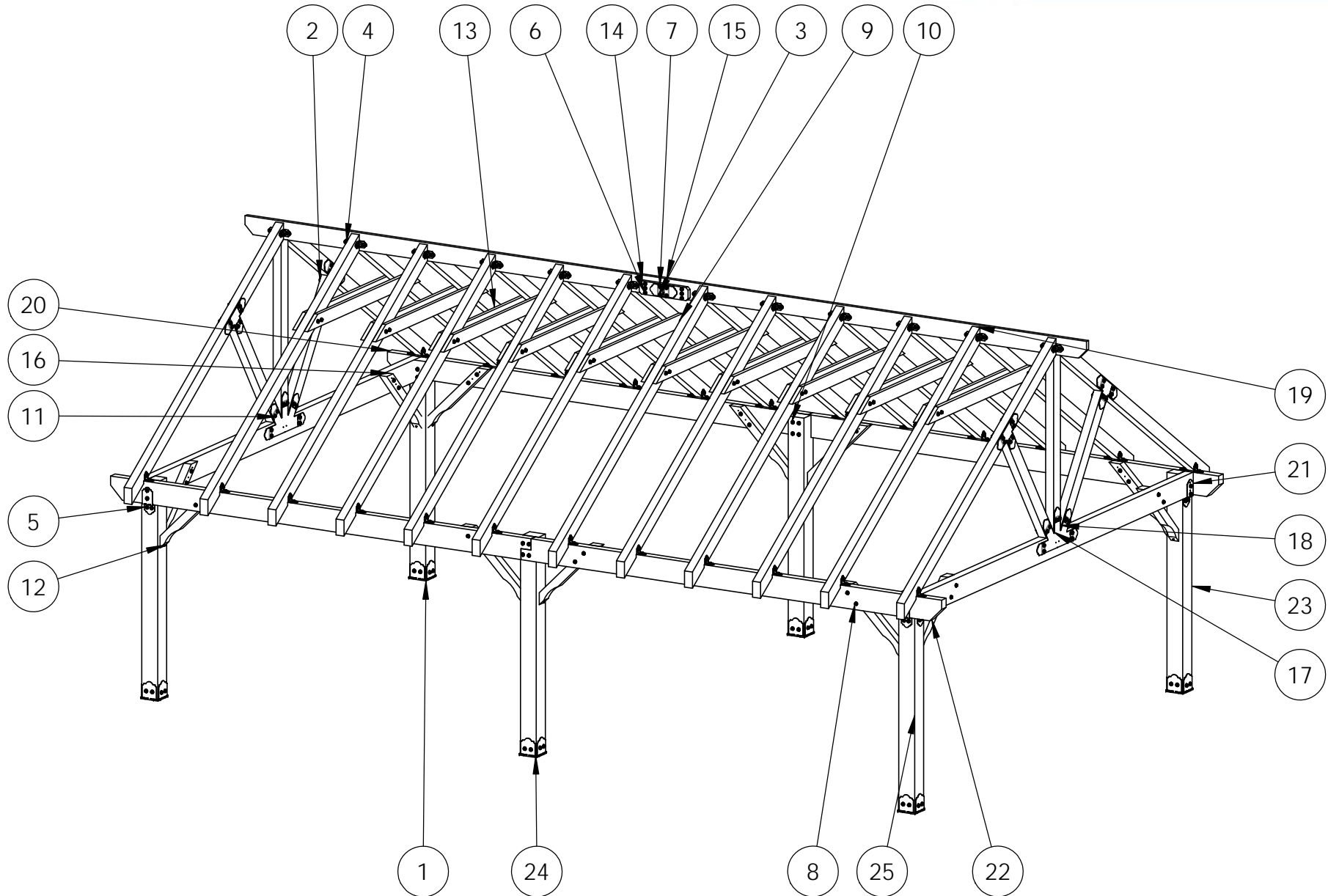

Bill of Material

**OZCO Project #223 - Wood Post & Beam
Pavilion (20x32) - Free Standing**

V1.00 - Installation Instructions effective May 1, 2015 and reflects information that available as of April 10, 2014. This information is updated periodically and should not be relied upon after May 1, 2015. Please visit www.OZCOBP.com to get current information

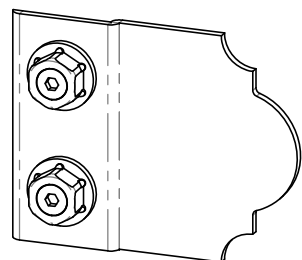

56611

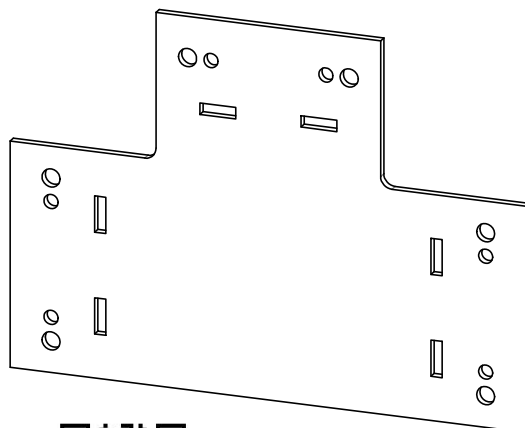

56612

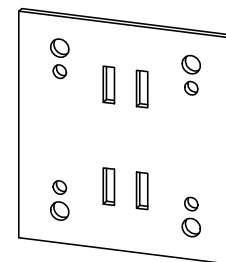

56613

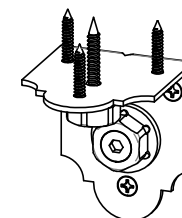

56618



56629

56625

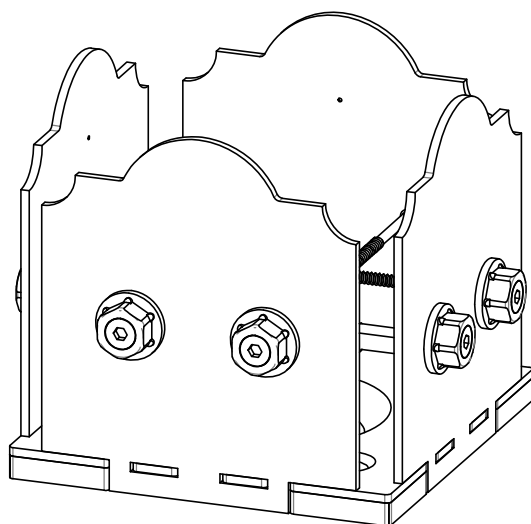

56609

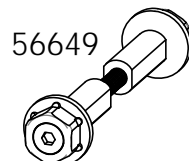

56649

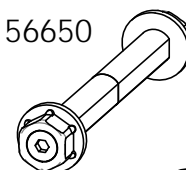

56650



56651

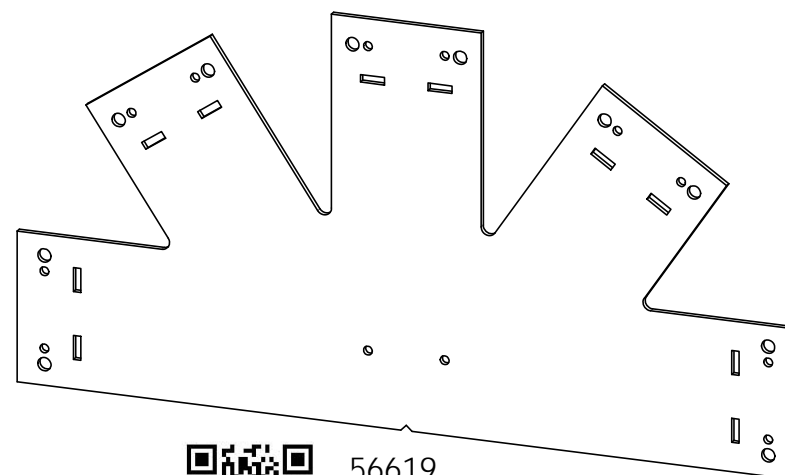

56619



OZCO

OZCO Project #223 - Wood Post & Beam
Pavilion (20x32) - Free Standing

V1.00 - Installation Instructions effective May 1, 2015 and reflects information that available as of April 10, 2014. This information is updated periodically and should not be relied upon after May 1, 2015. Please visit www.OZCOBP.com to get current information

DESIGN

PURCHASE

CONSTRUCT

ENJOY

Laredo Sunset vs. Ironwood

2 great styles
same functionality

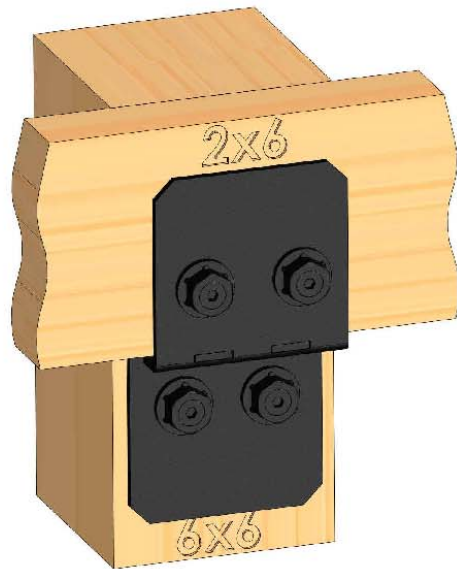

Ironwood
(517XX series)



Laredo Sunset
(566XX series)

choose your connection lifestyle
both styles available for most products



OZCO BUILDING PRODUCTS

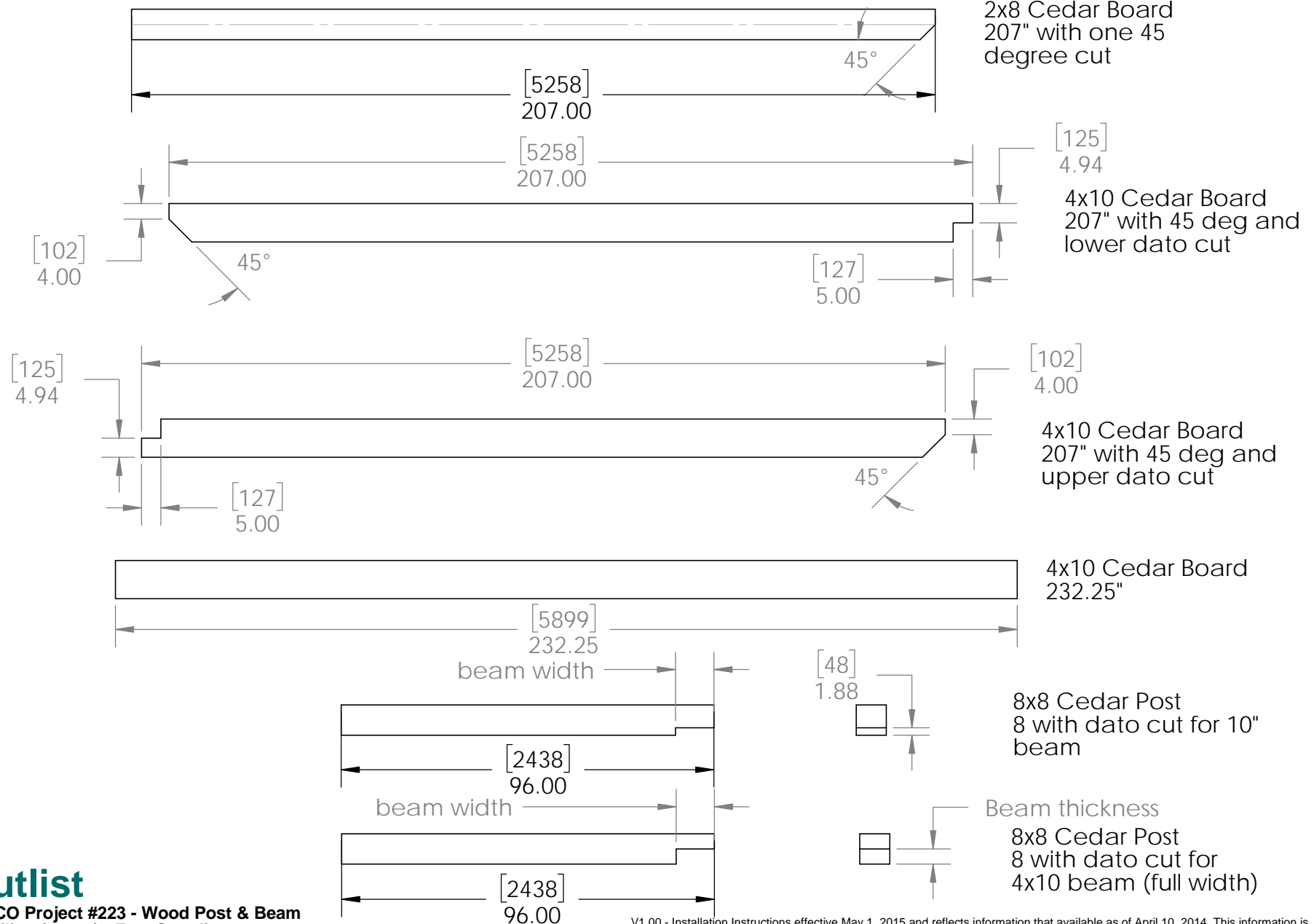

cutlist

**OZCO Project #223 - Wood Post & Beam
Pavilion (20x32) - Free Standing**

V1.00 - Installation Instructions effective May 1, 2015 and reflects information that available as of April 10, 2014. This information is updated periodically and should not be relied upon after May 1, 2015. Please visit www.OZCOBP.com to get current information

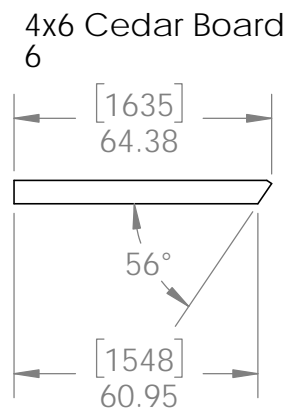
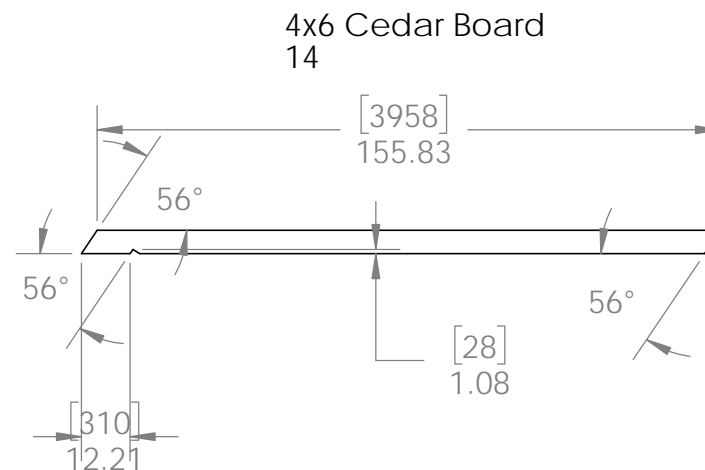
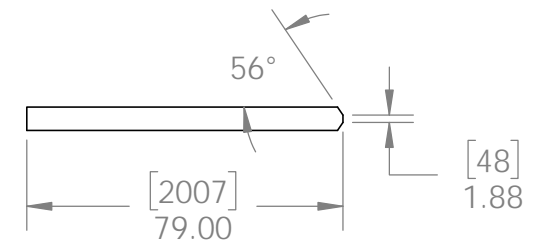
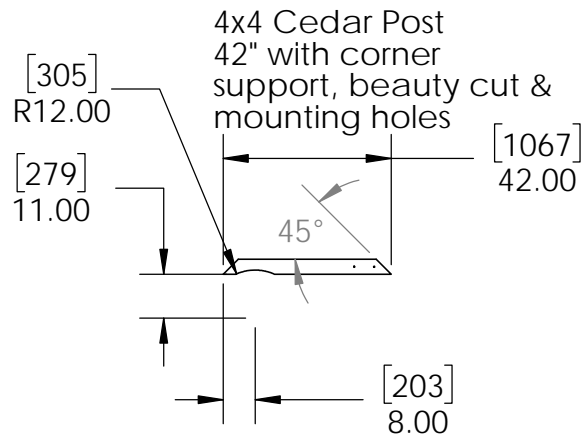

2x6 Cedar Board
8

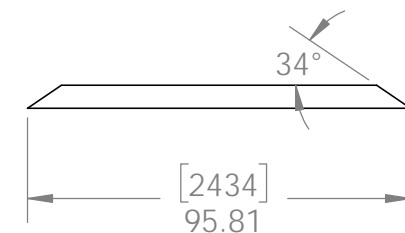

2x6 Cedar Board
2 scab support with
chamfers

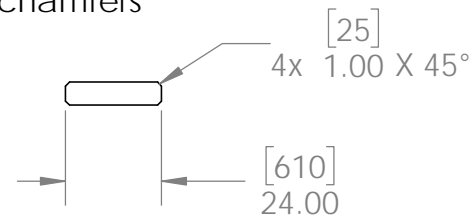

cutlist

OZCO Project #223 - Wood Post & Beam
Pavilion (20x32) - Free Standing

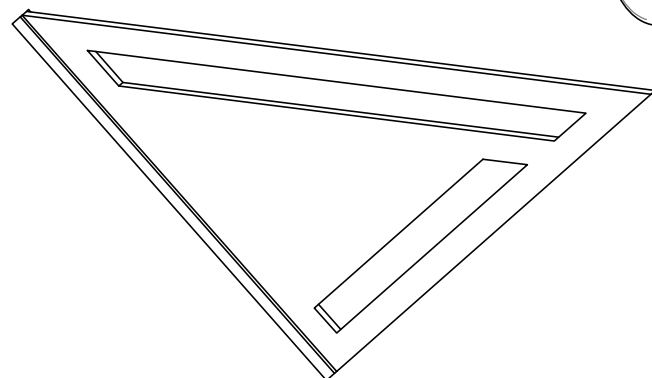
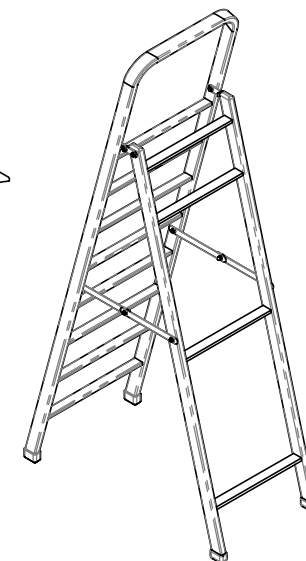
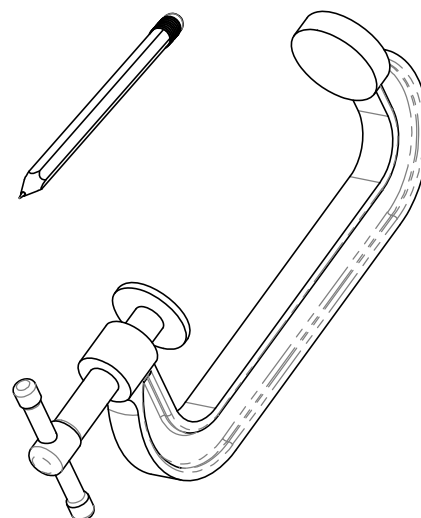
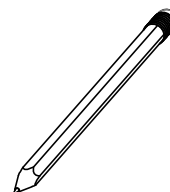
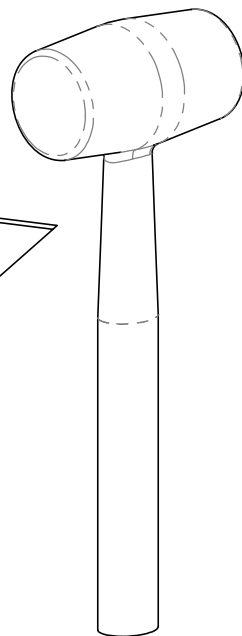
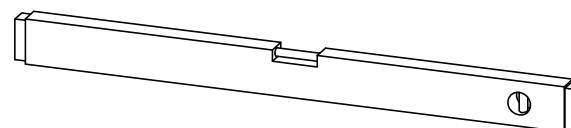
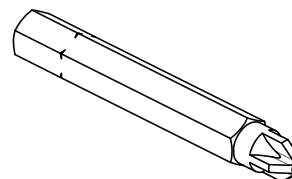
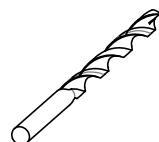
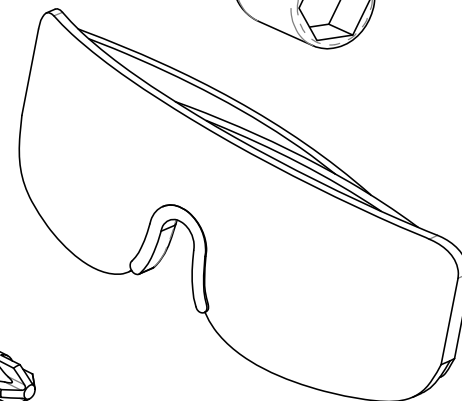
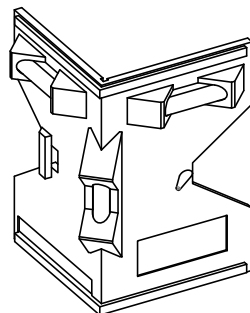
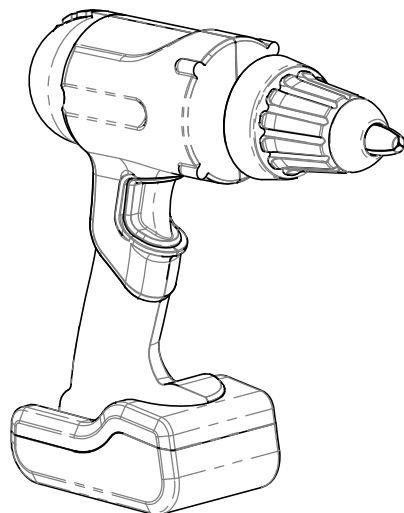
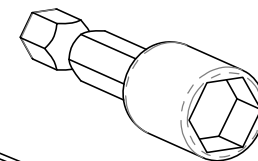
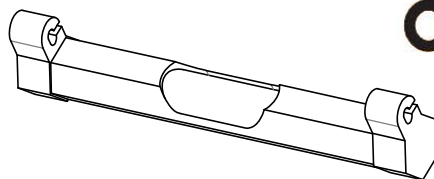

Suggested Tools

(others may be required)

**OZCO Project #223 - Wood Post & Beam
Pavilion (20x32) - Free Standing**

V1.00 - Installation Instructions effective May 1, 2015 and reflects information that available as of April 10, 2014. This information is updated periodically and should not be relied upon after May 1, 2015. Please visit www.OZCOBP.com to get current information

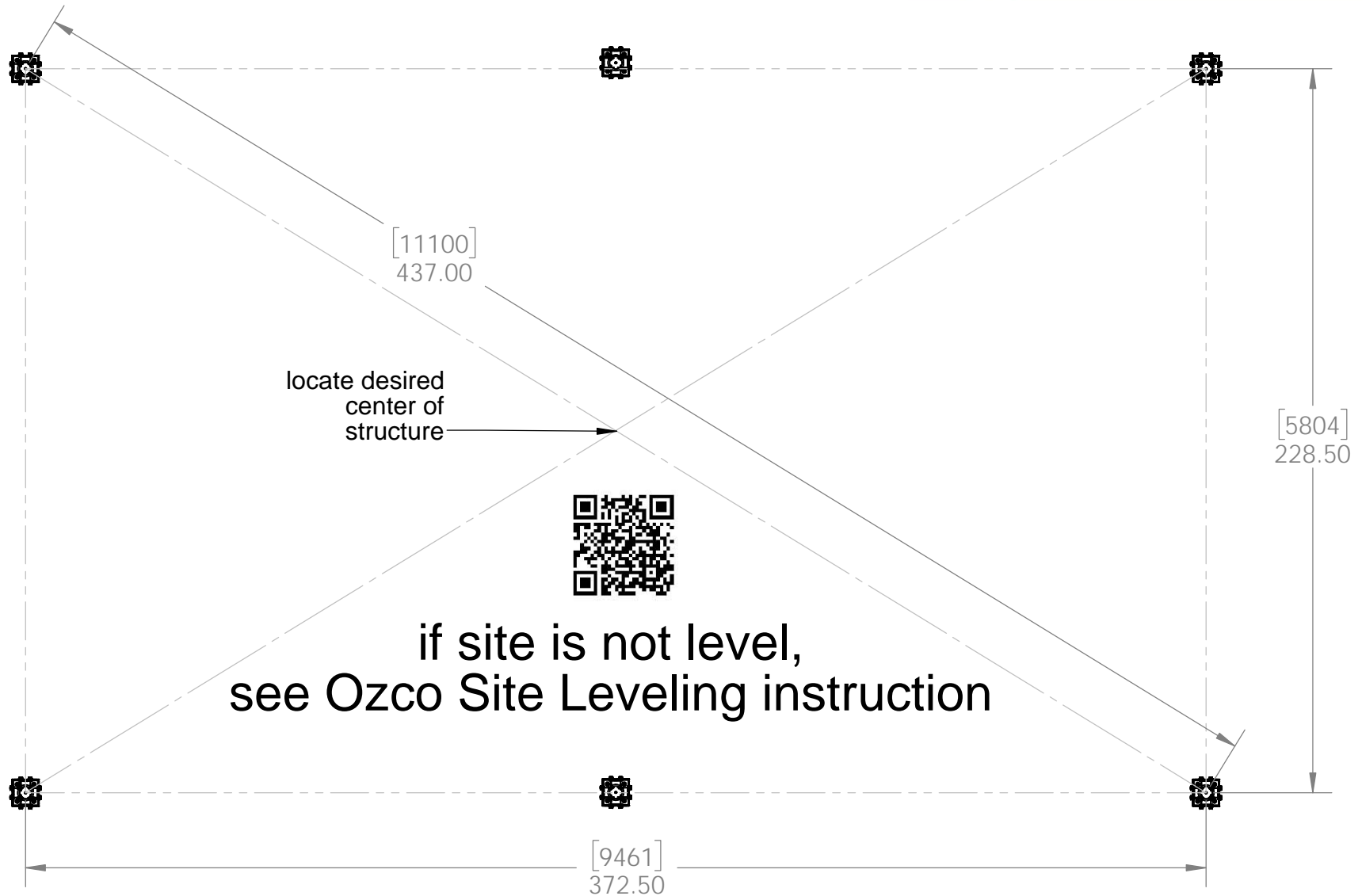

site

OZCO Project #223 - Wood Post & Beam
Pavilion (20x32) - Free Standing

V1.00 - Installation Instructions effective May 1, 2015 and reflects information that available as of April 10, 2014. This information is updated periodically and should not be relied upon after May 1, 2015. Please visit www.OZCOBP.com to get current information

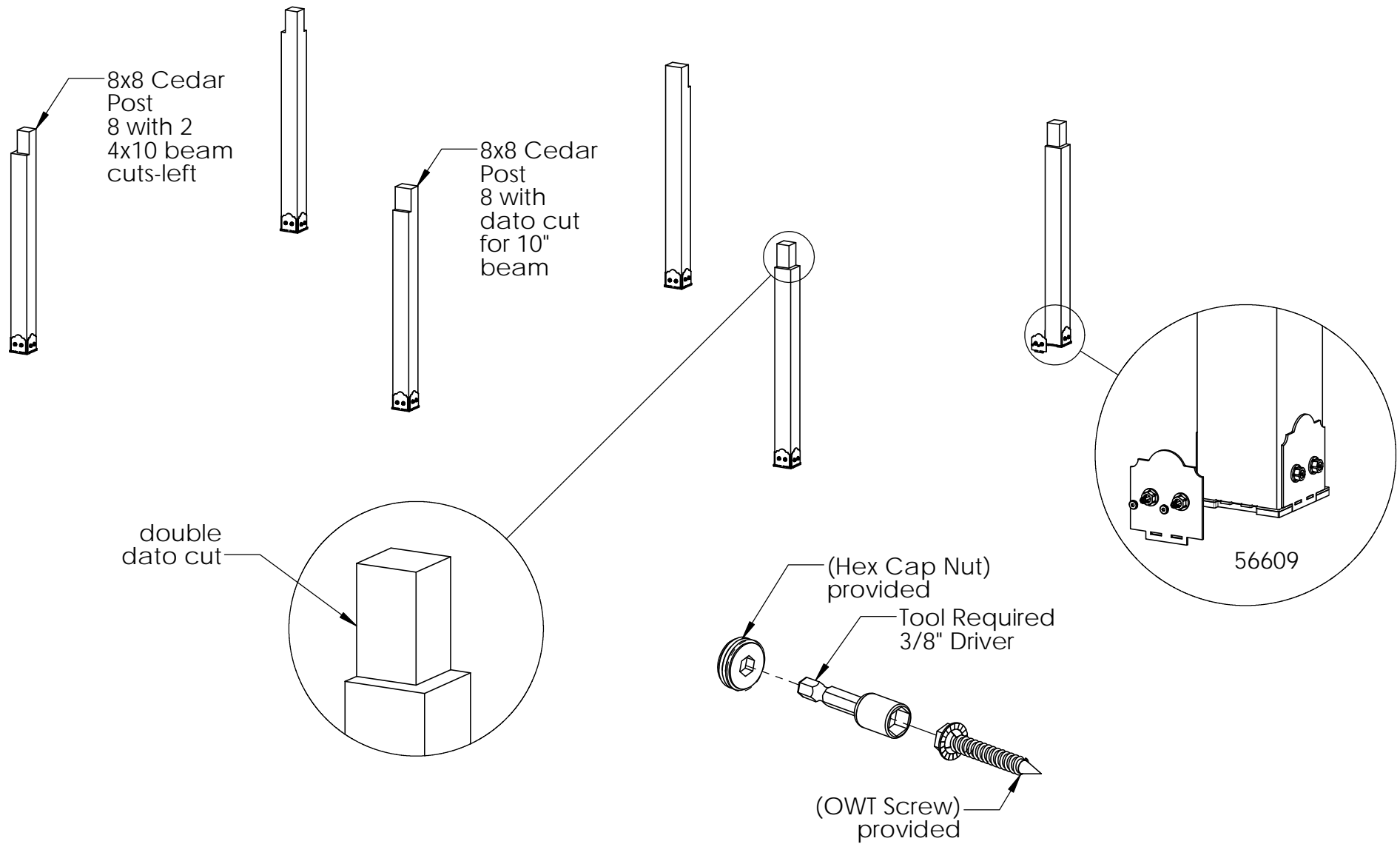

step 1

OZCO Project #223 - Wood Post & Beam
Pavilion (20x32) - Free Standing

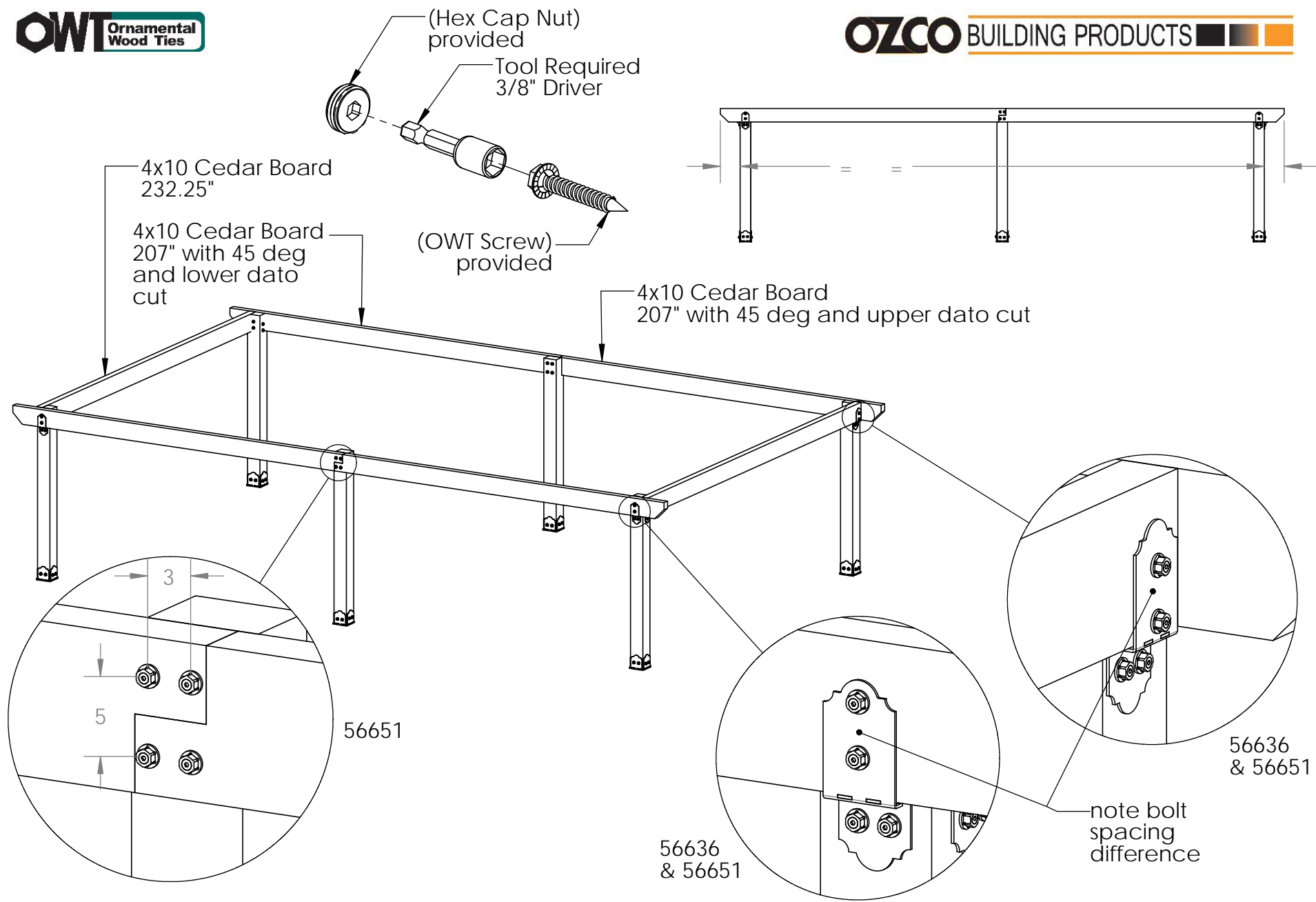

step 2

OZCO Project #223 - Wood Post & Beam
Pavilion (20x32) - Free Standing

V1.00 - Installation Instructions effective May 1, 2015 and reflects information that available as of April 10, 2014. This information is updated periodically and should not be relied upon after May 1, 2015. Please visit www.OZCOBP.com to get current information

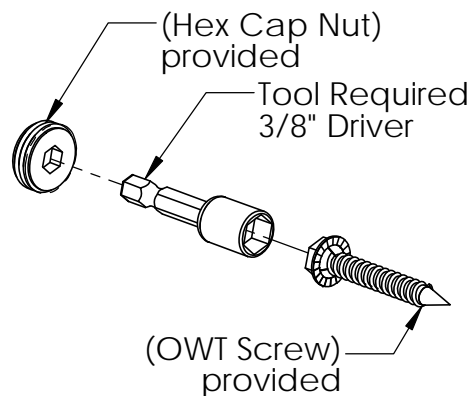
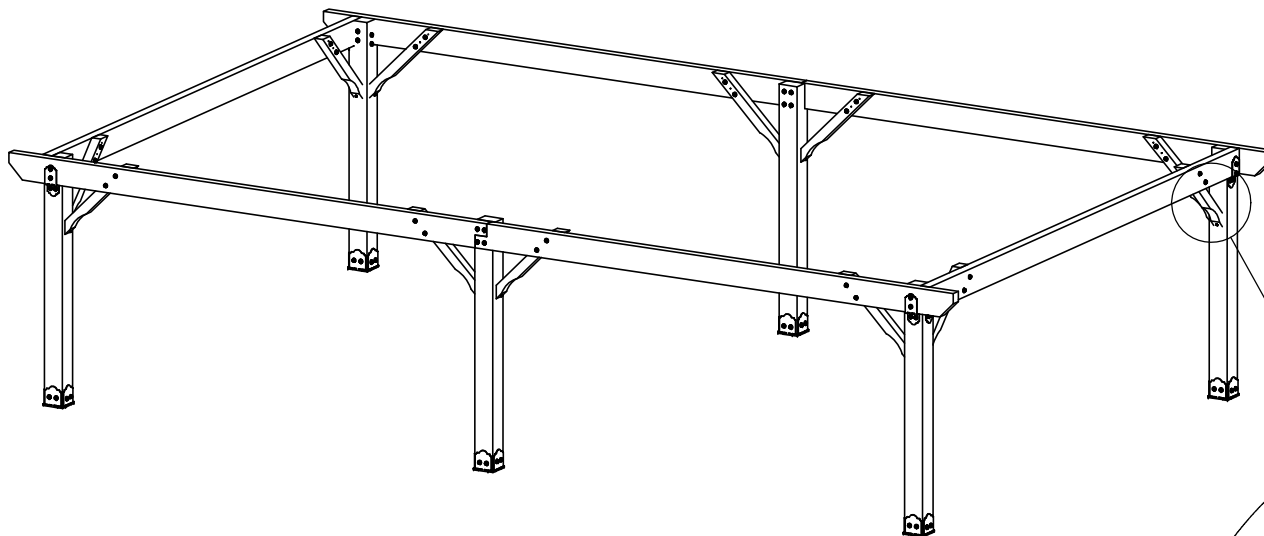

4x4 Cedar
Post
42 with corner
support &
beauty cut

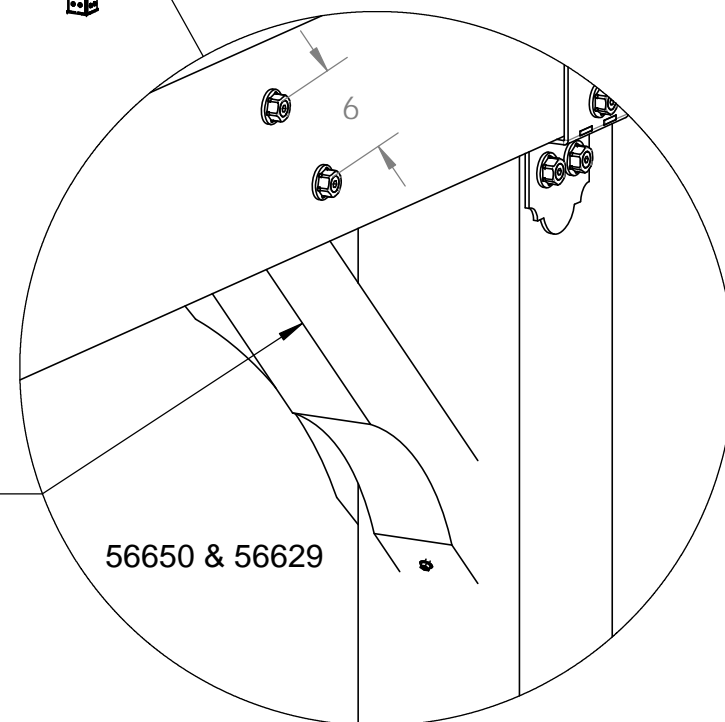

braces repeat 2x on each post
12 total

step 3

OZCO Project #223 - Wood Post & Beam
Pavilion (20x32) - Free Standing

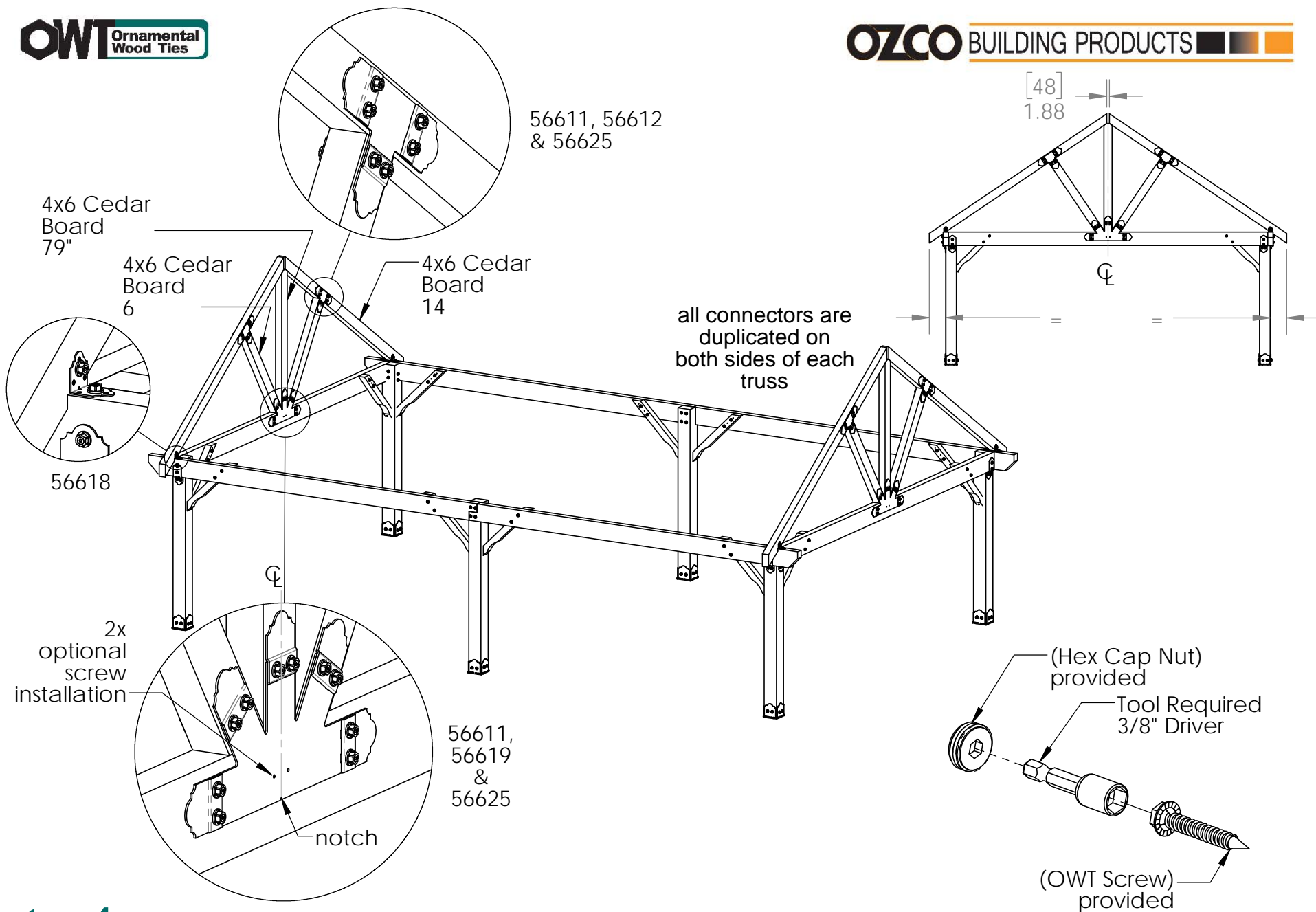

step 4

**OZCO Project #223 - Wood Post & Beam
Pavilion (20x32) - Free Standing**

V1.00 - Installation Instructions effective May 1, 2015 and reflects information that available as of April 10, 2014. This information is updated periodically and should not be relied upon after May 1, 2015. Please visit www.OZCOBP.com to get current information

2x6 Cedar Board
2 scab support
with chamfers

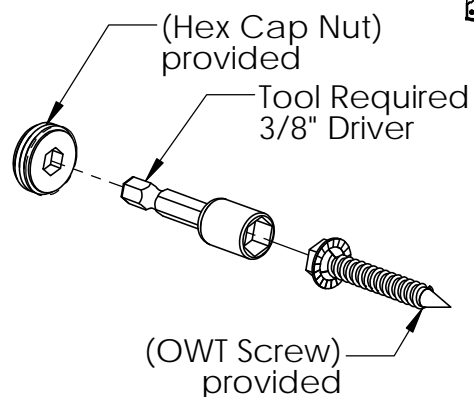
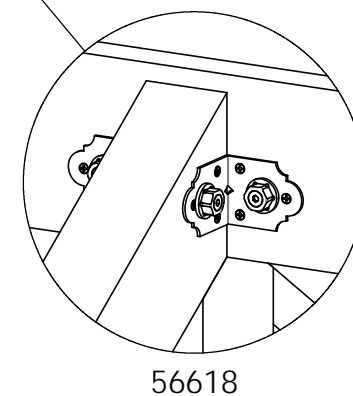
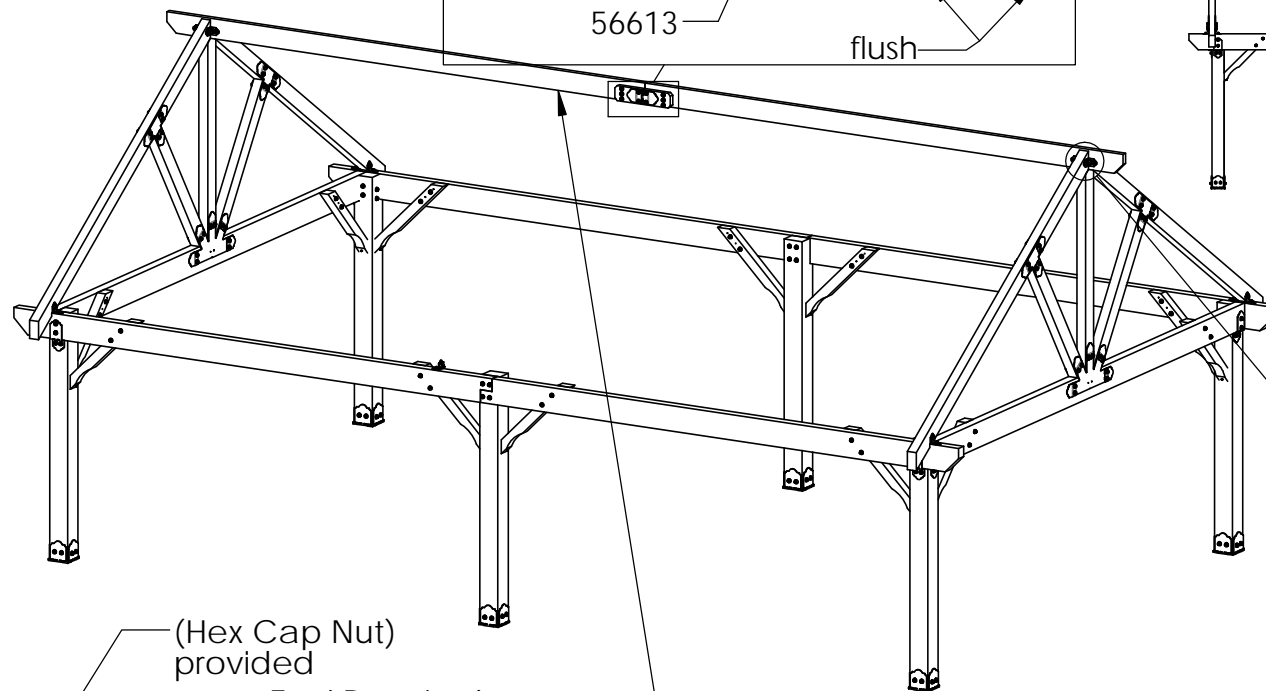
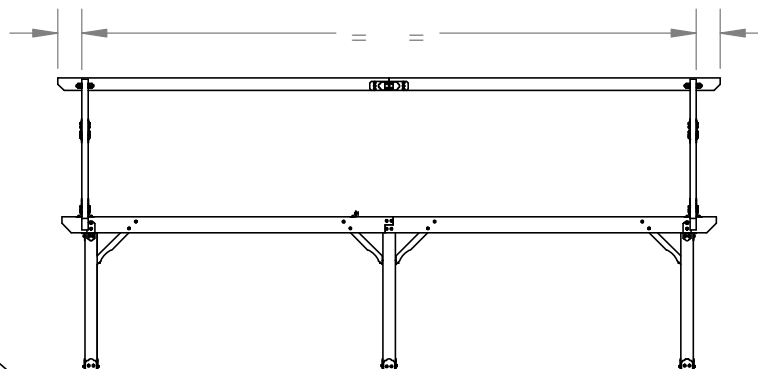
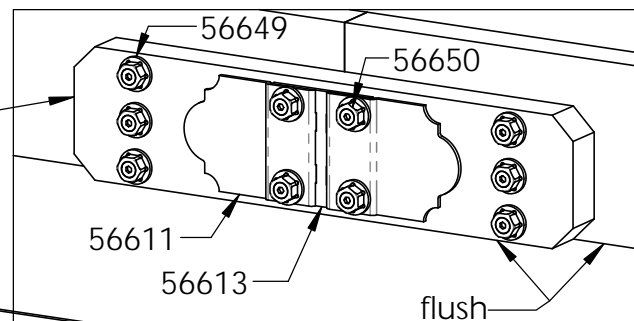

step 5

OZCO Project #223 - Wood Post & Beam
Pavilion (20x32) - Free Standing

V1.00 - Installation Instructions effective May 1, 2015 and reflects information that available as of April 10, 2014. This information is updated periodically and should not be relied upon after May 1, 2015. Please visit www.OZCOBP.com to get current information

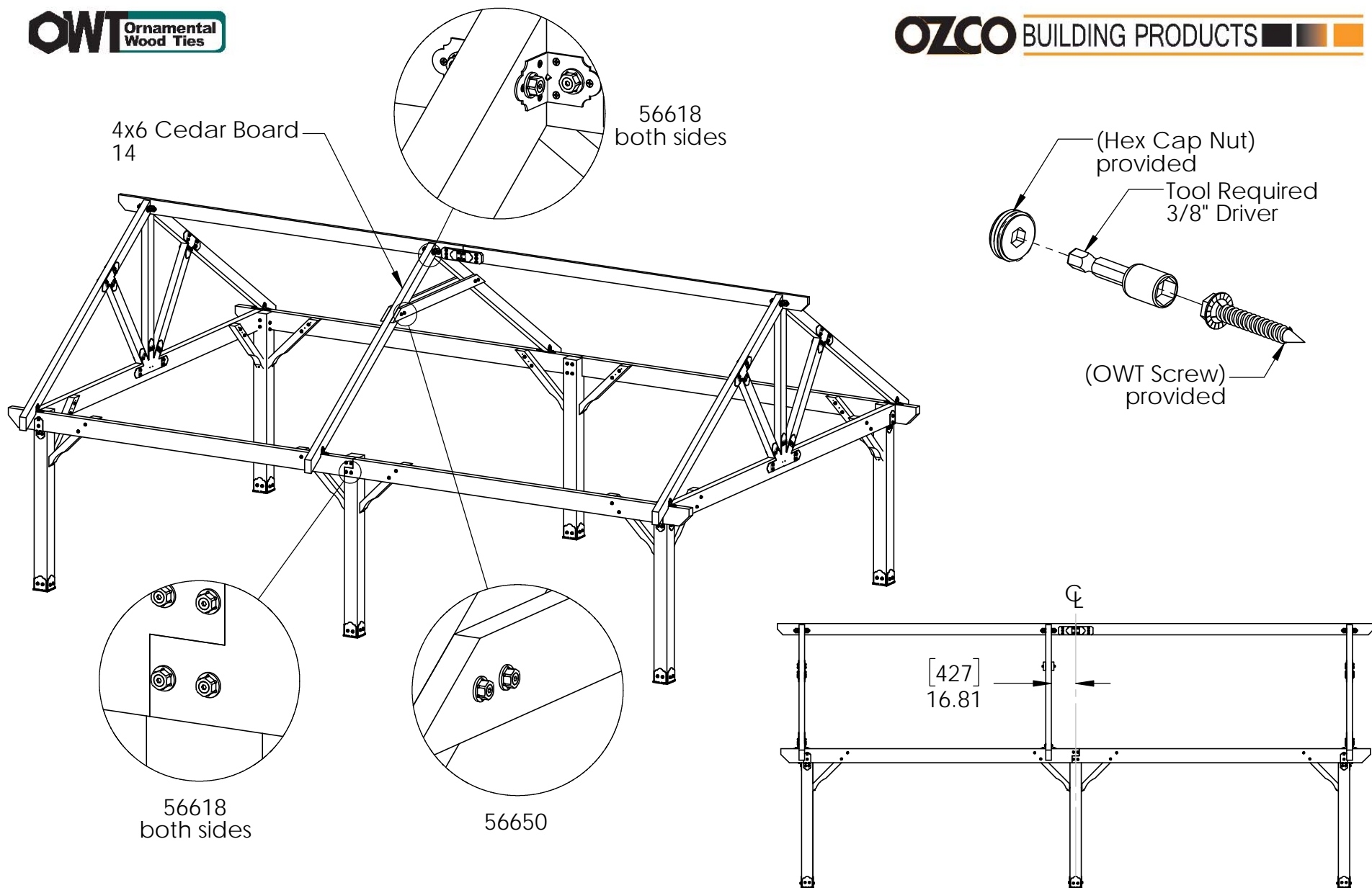

step 6

OZCO Project #223 - Wood Post & Beam
Pavilion (20x32) - Free Standing

V1.00 - Installation Instructions effective May 1, 2015 and reflects information that available as of April 10, 2014. This information is updated periodically and should not be relied upon after May 1, 2015. Please visit www.OZCOBP.com to get current information

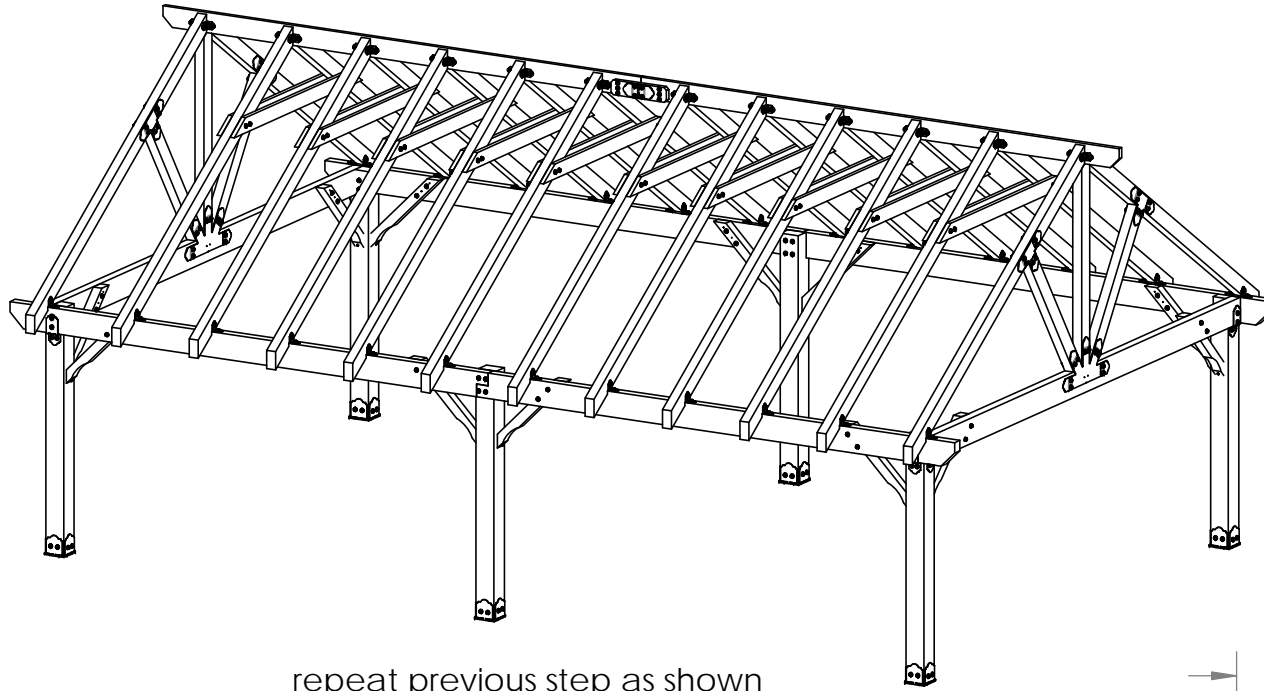

repeat previous step as shown

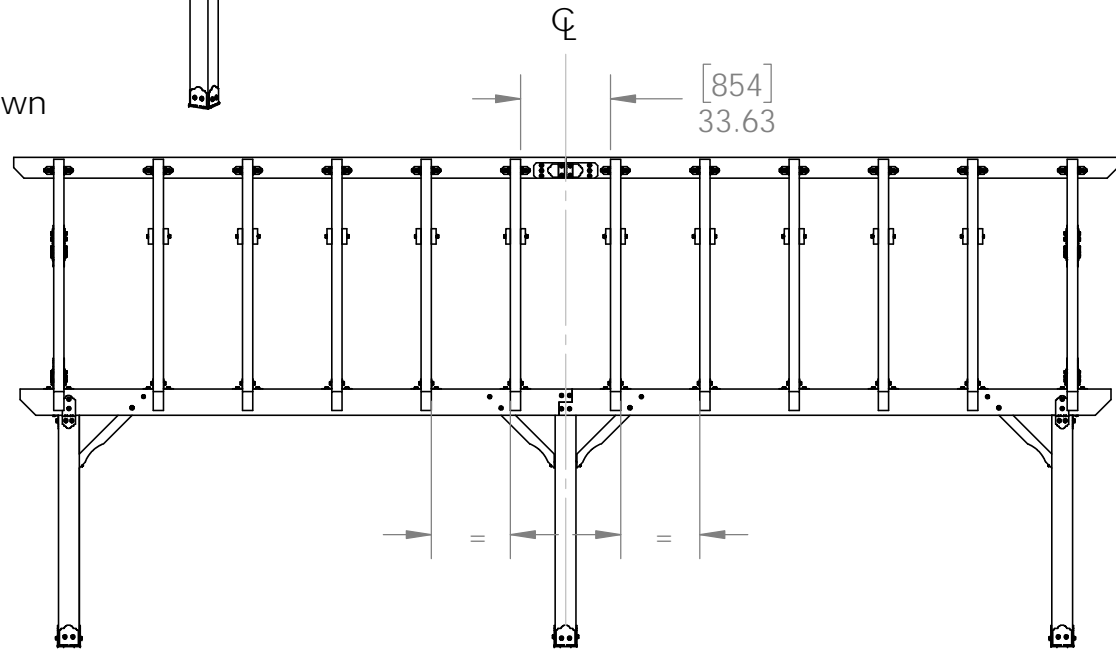

step 7

**OZCO Project #223 - Wood Post & Beam
Pavilion (20x32) - Free Standing**

V1.00 - Installation Instructions effective May 1, 2015 and reflects information that available as of April 10, 2014. This information is updated periodically and should not be relied upon after May 1, 2015. Please visit www.OZCOBP.com to get current information

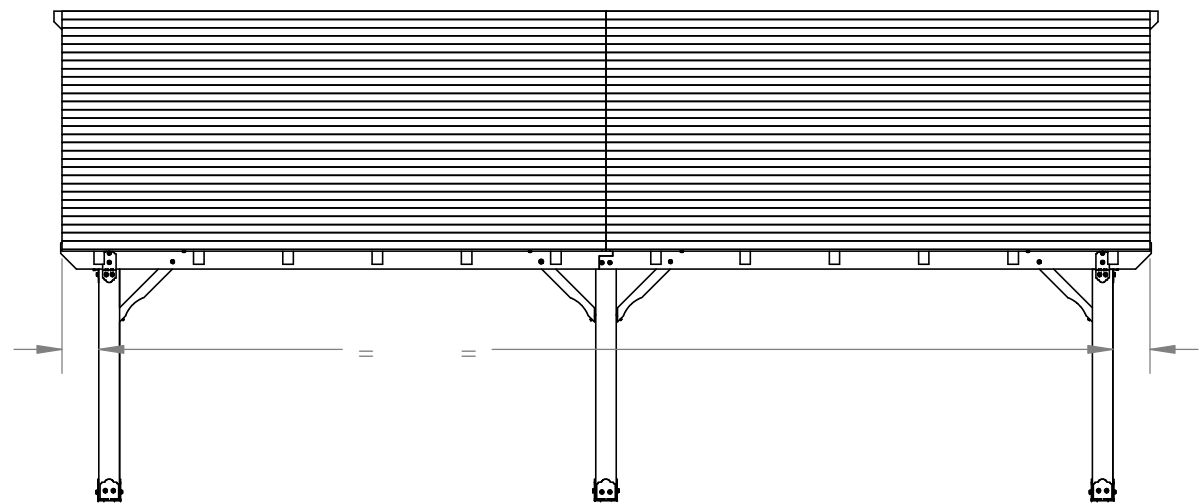
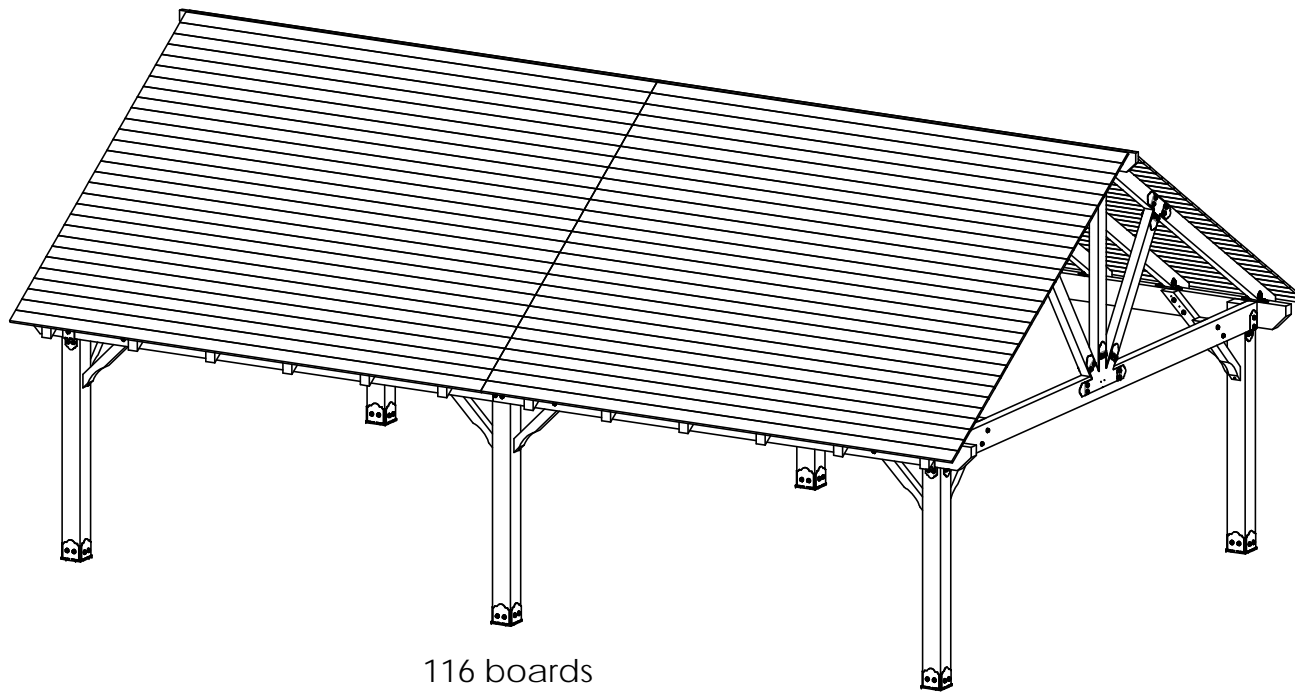

roof option-1x6

OZCO Project #223 - Wood Post & Beam
Pavilion (20x32) - Free Standing

V1.00 - Installation Instructions effective May 1, 2015 and reflects information that available as of April 10, 2014. This information is updated periodically and should not be relied upon after May 1, 2015. Please visit www.OZCOBP.com to get current information