

DESIGN

PURCHASE

CONSTRUCT

ENJOY

**OZCO Project #210
- Wood Post &
Beam Pavilion -
Free Standing**



OZCO Project #210 - Wood Post & Beam Pavilion - Free Standing

V1.00 - Installation Instructions effective May 1, 2015 and reflects information that available as of April 10, 2014. This information is updated periodically and should not be relied upon after May 1, 2015. Please visit www.OZCOBP.com to get current information



Printing Documents from ISSUU

Unfortunately, there is currently no way to print content directly through issuu. To print a publication, you will need to download it and print it from your computer.

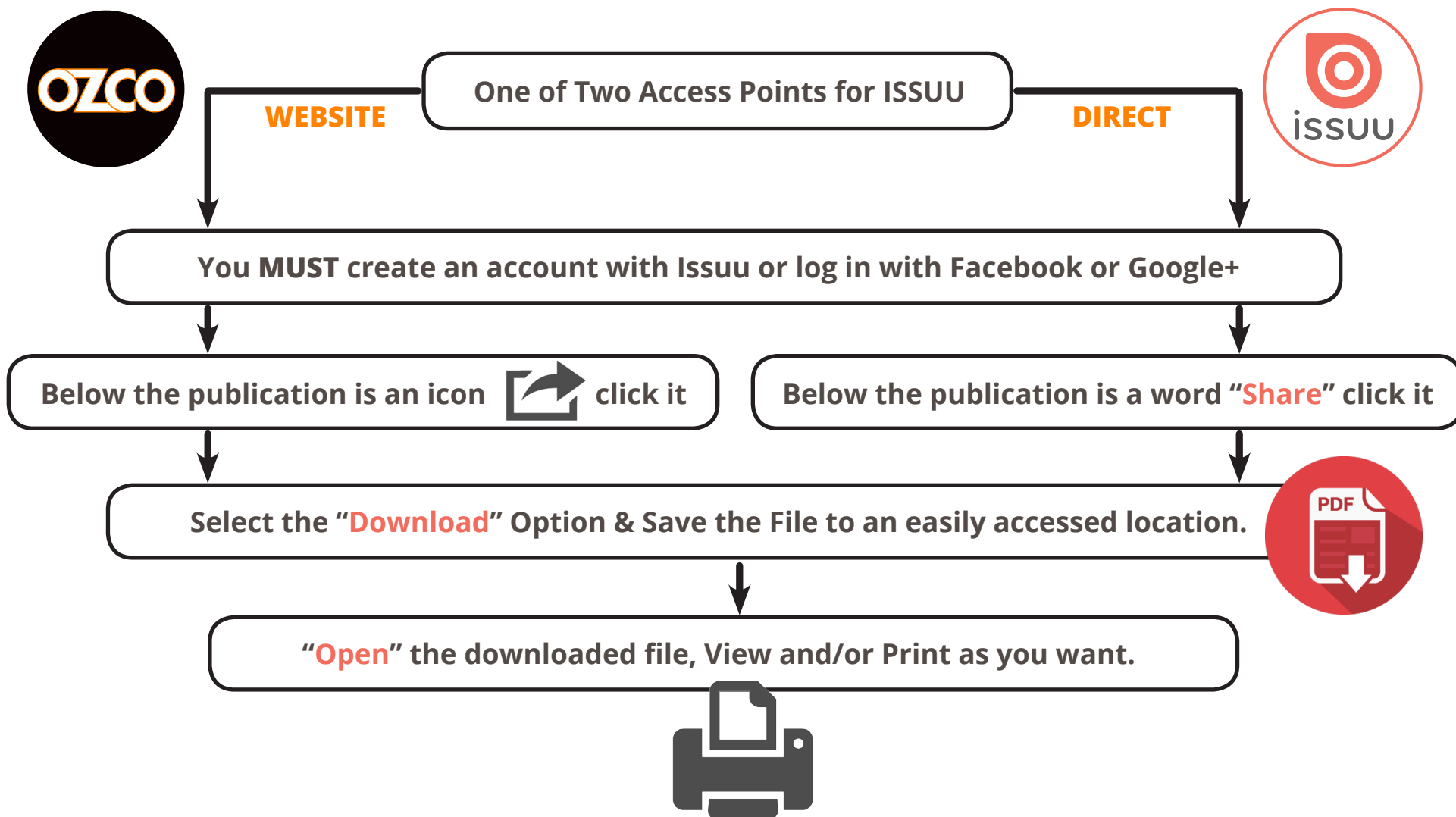

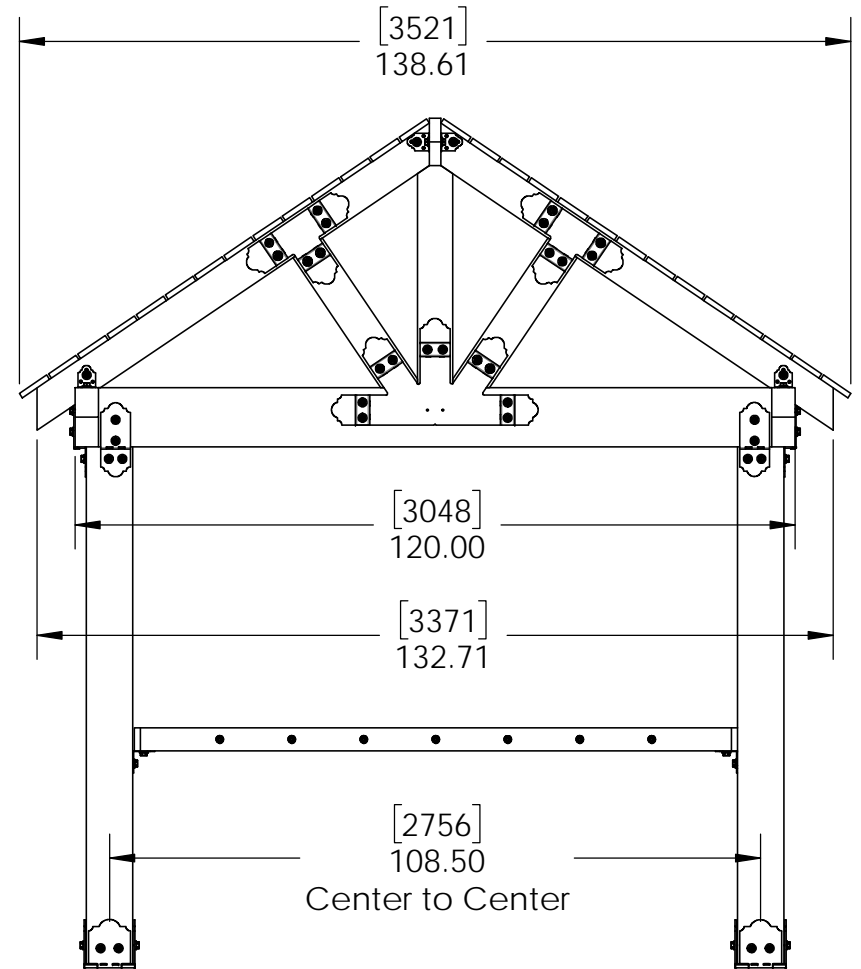
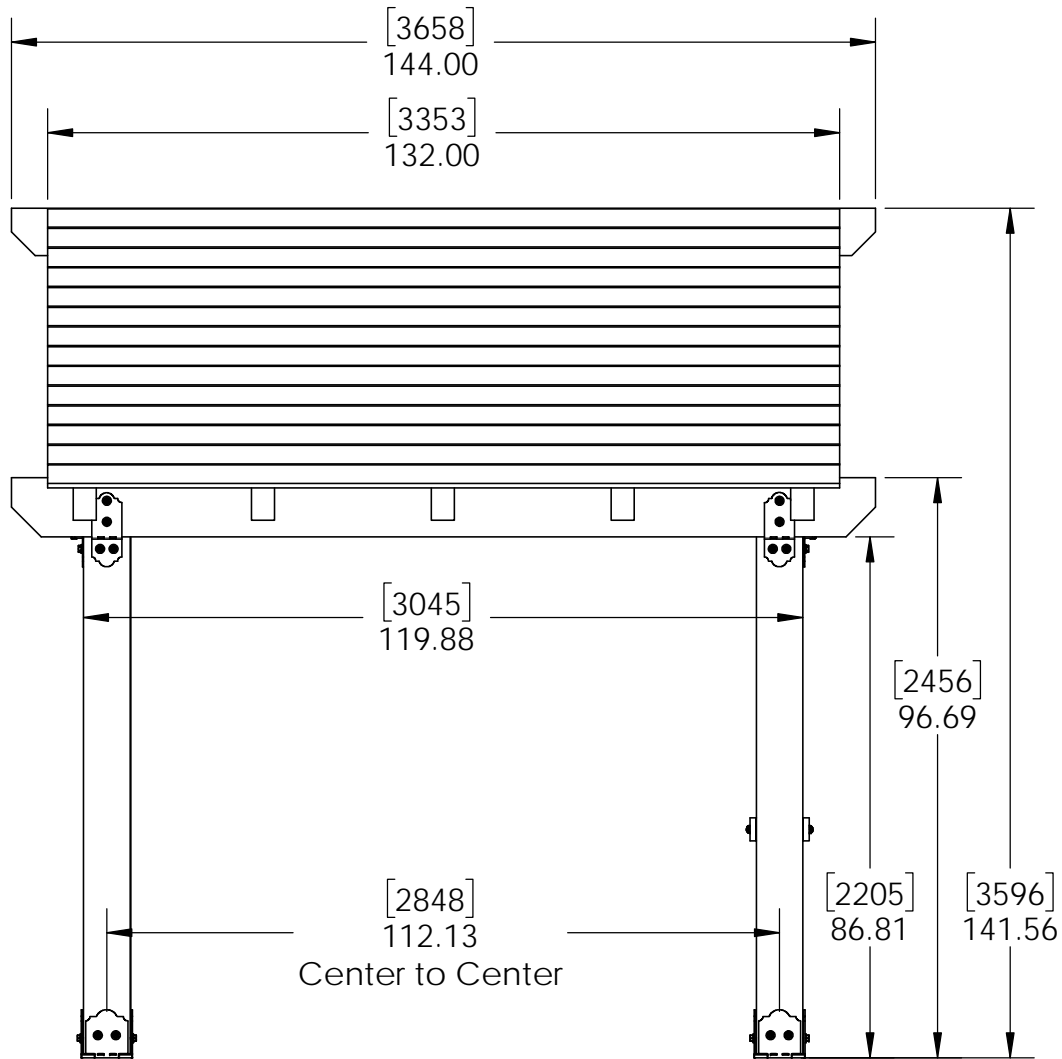

Overview

OZCO Project #210 - Wood Post & Beam Pavilion - Free Standing

V1.00 - Installation Instructions effective May 1, 2015 and reflects information that available as of April 10, 2014. This information is updated periodically and should not be relied upon after May 1, 2015. Please visit www.OZCOBP.com to get current information

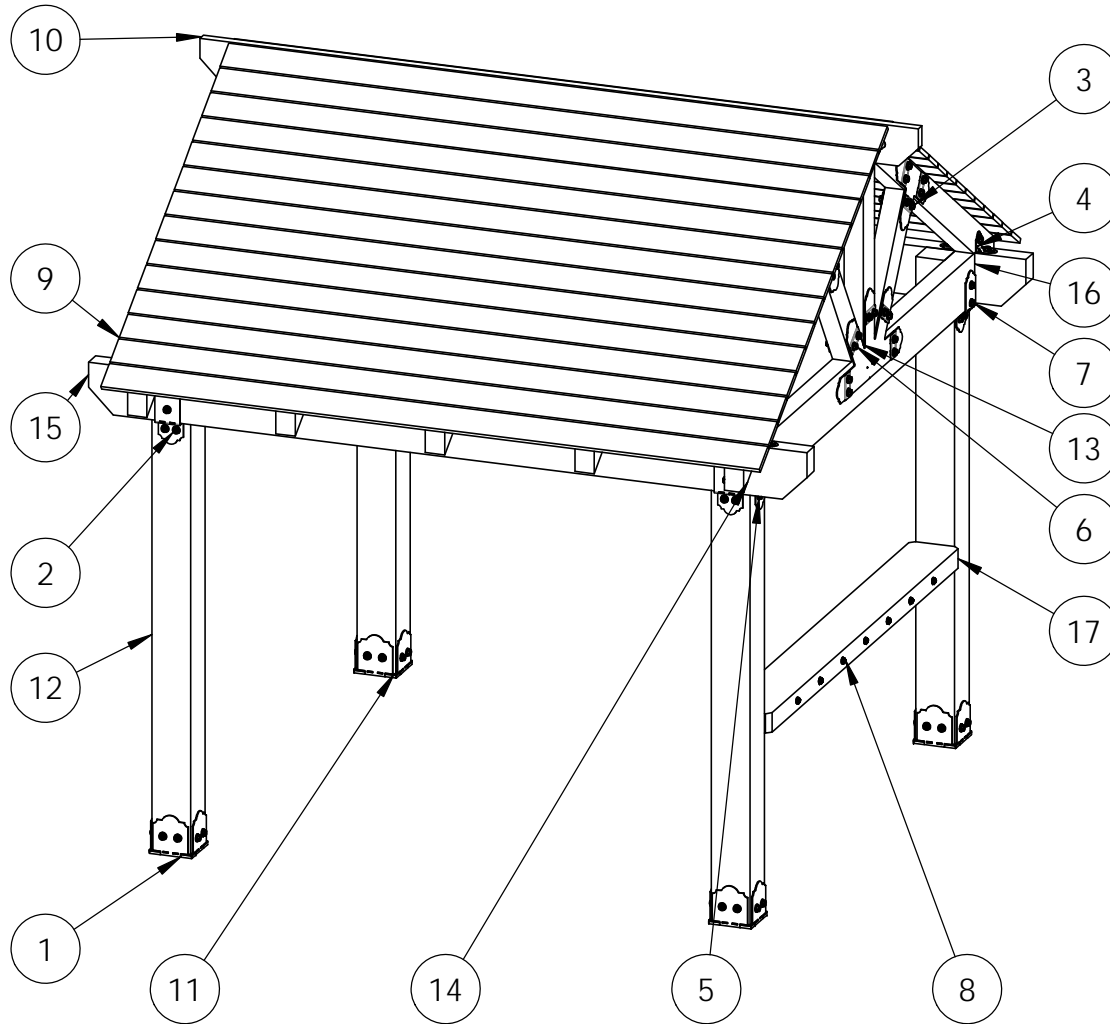

ITEM NO.	QTY.	PART NUMBER	DESCRIPTION
1	4	56609	8x8 Post Base (8x8-PB-LS)
2	2	56636	Post to Beam Bolt Offset (P2B-BO-LS)
3	4	56612	"T" Tie Plate (TTP)
	1.5	56611	Truss Accent (TA-LS)
	0.08	56625	OWT Timber Screw 1-3/4"
4	4.2	56618	4" Standard Rafter Clip (RC-LS-4)
5	2	56636	Post to Beam Bolt Offset (P2B-BO-LS)
6	4	56619	Truss Base Fan 8:12
	2.5	56611	Truss Accent (TA-LS)
	0.08	56625	OWT Timber Screw 1-3/4"
7	8	56651	OWT Timber Bolt 8-10"
8	1	56622	1-1/4" Hammered Dome Cap Nut
	0.04	56625	OWT Timber Screw 1-3/4"
9	28	1x6 Cedar Board	1x6x132.00
10	1	2x8 Cedar Board	2x8x144.00
11	3	8x8 Cedar Post	8x8x96.00
12	1	8x8 Cedar Post	8x8x96.00
13	6	4x6 Cedar Board	4x6x168.00
14	10	4x6 Cedar Board	4x6x168.00
15	2	4x10 Cedar Board	4x10x144.00
16	2	4x10 Cedar Board	4x10x112.25
17	1	4x10 Cedar Board	4x10x100.50

Bill of Material

OZCO Project #210 - Wood Post & Beam Pavilion - Free Standing

V1.00 - Installation Instructions effective May 1, 2015 and reflects information that available as of April 10, 2014. This information is updated periodically and should not be relied upon after May 1, 2015. Please visit www.OZCOBP.com to get current information

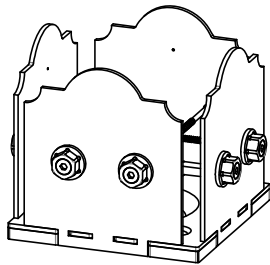

56609

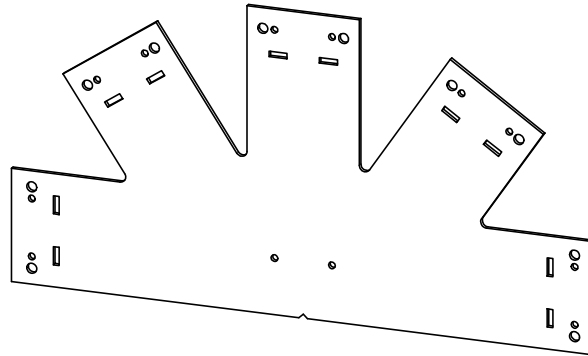

56619

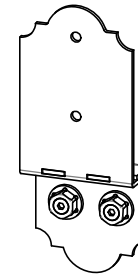

56636

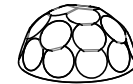

56622

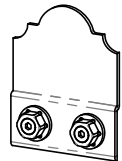

56611



56618



56625

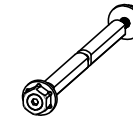

56651

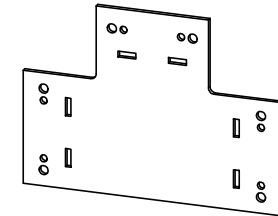

56612



DESIGN

PURCHASE

CONSTRUCT

ENJOY

Laredo Sunset vs. Ironwood

2 great styles
same functionality

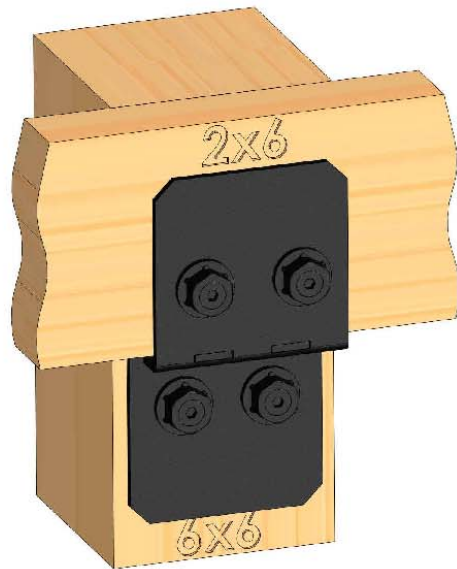

Ironwood
(517XX series)



Laredo Sunset
(566XX series)

choose your connection lifestyle
both styles available for most products



OZCO BUILDING PRODUCTS

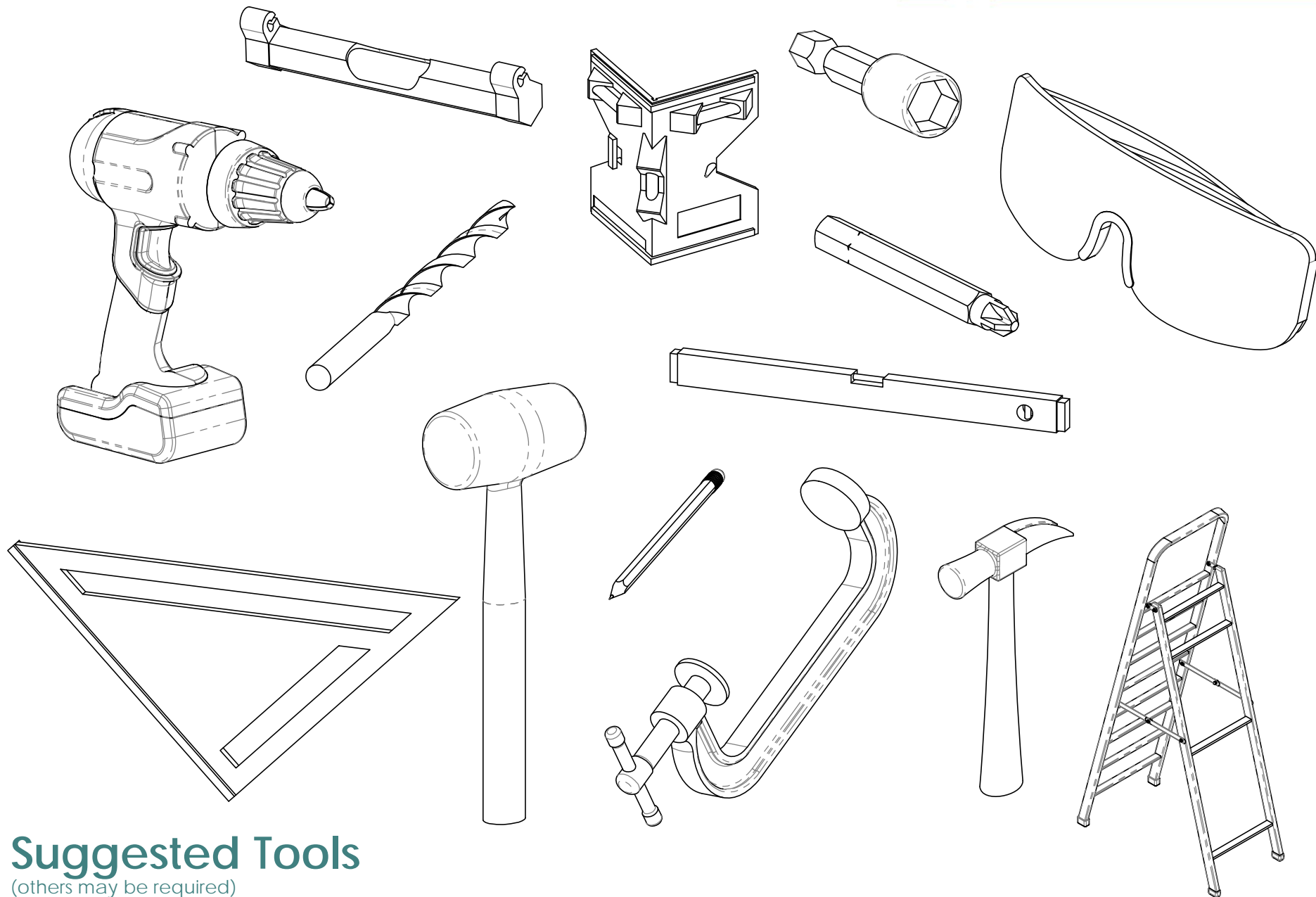

Suggested Tools

(others may be required)

OZCO Project #210 - Wood Post & Beam Pavilion - Free Standing

V1.00 - Installation Instructions effective May 1, 2015 and reflects information that available as of April 10, 2014. This information is updated periodically and should not be relied upon after May 1, 2015. Please visit www.OZCOBP.com to get current information

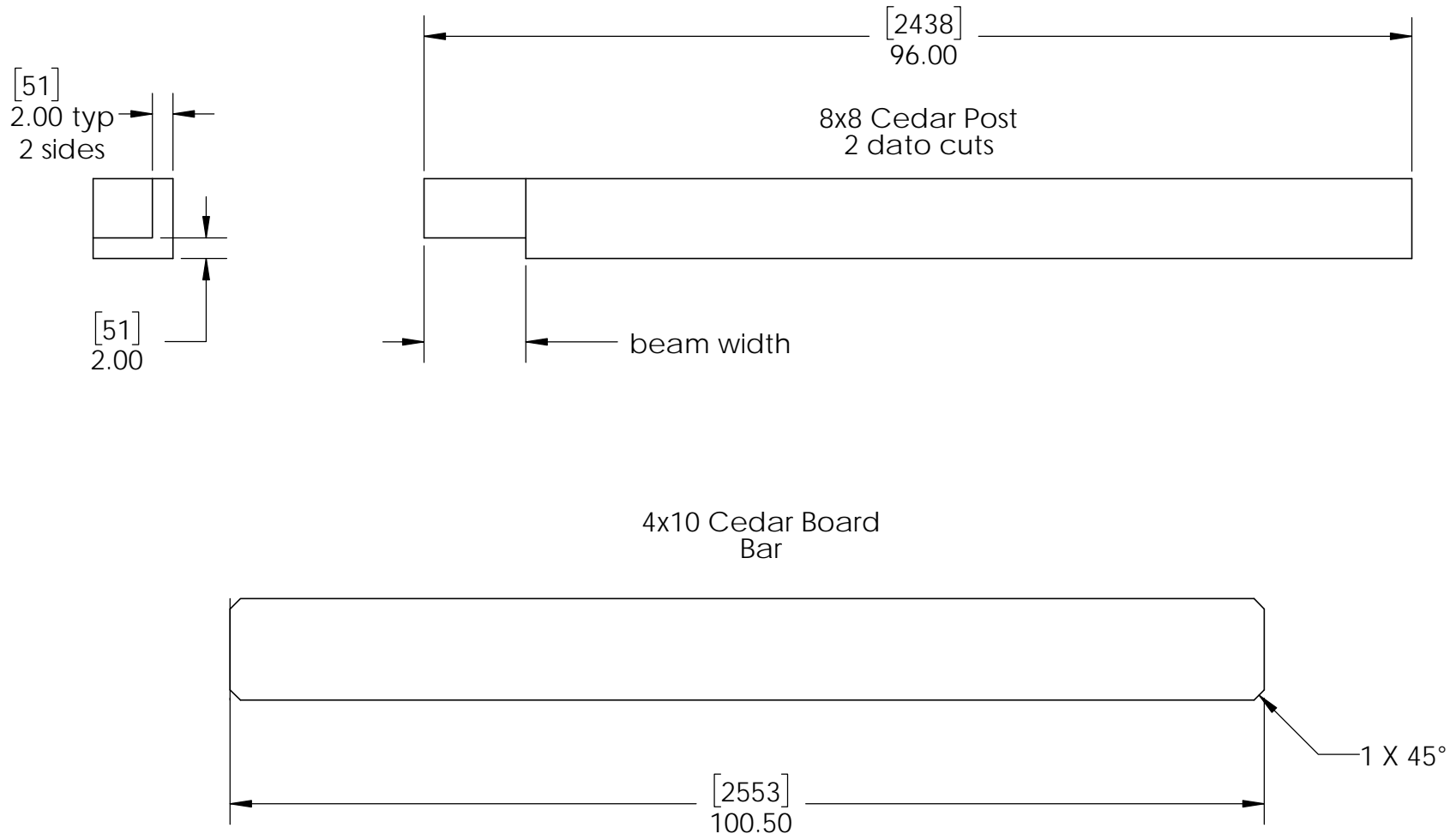

Cutlist1

OZCO Project #210 - Wood Post & Beam Pavilion - Free Standing

V1.00 - Installation Instructions effective May 1, 2015 and reflects information that available as of April 10, 2014. This information is updated periodically and should not be relied upon after May 1, 2015. Please visit www.OZCOBP.com to get current information

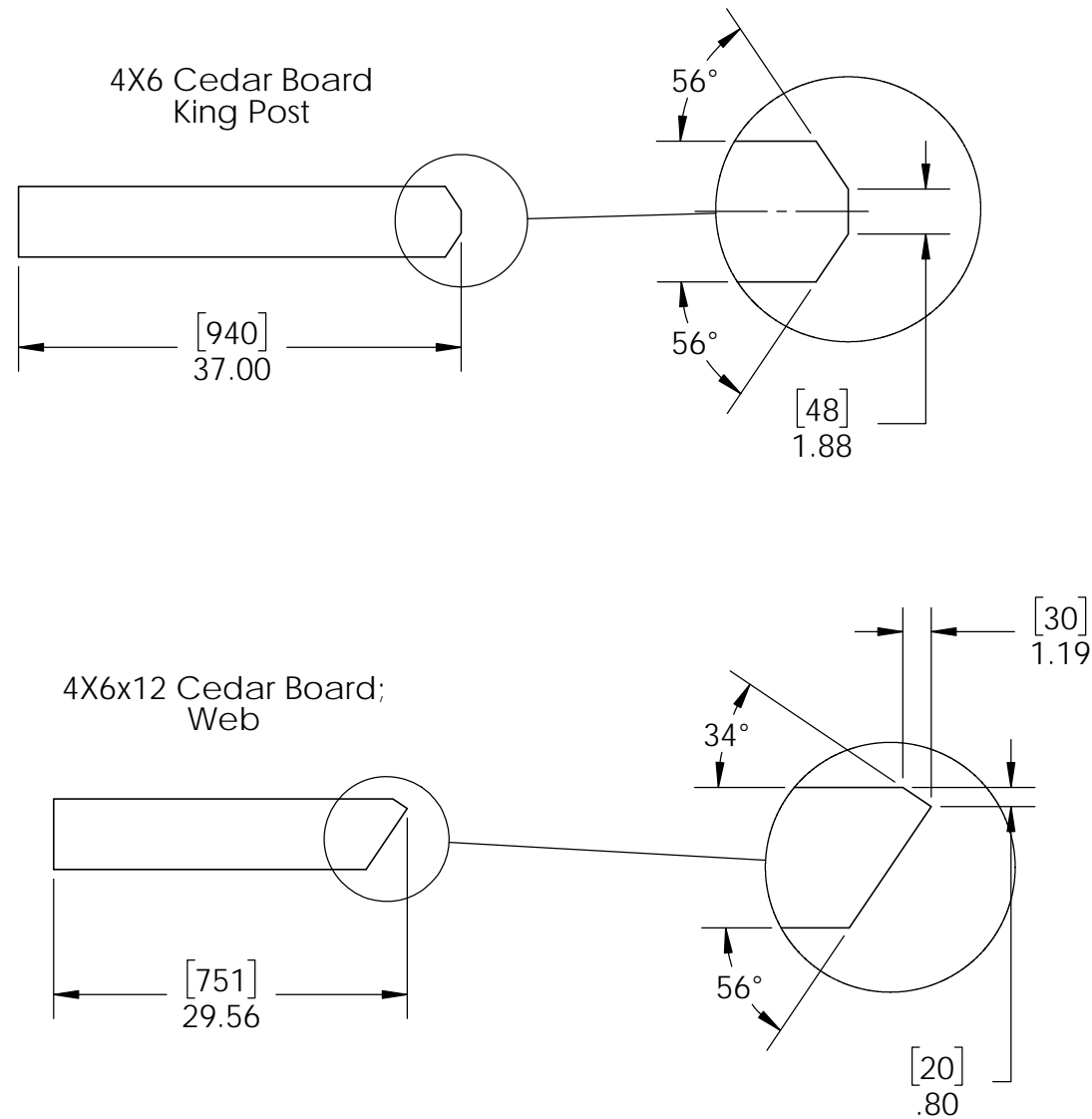

Cutlist2

OZCO Project #210 - Wood Post & Beam Pavilion - Free Standing

V1.00 - Installation Instructions effective May 1, 2015 and reflects information that available as of April 10, 2014. This information is updated periodically and should not be relied upon after May 1, 2015. Please visit www.OZCOBP.com to get current information

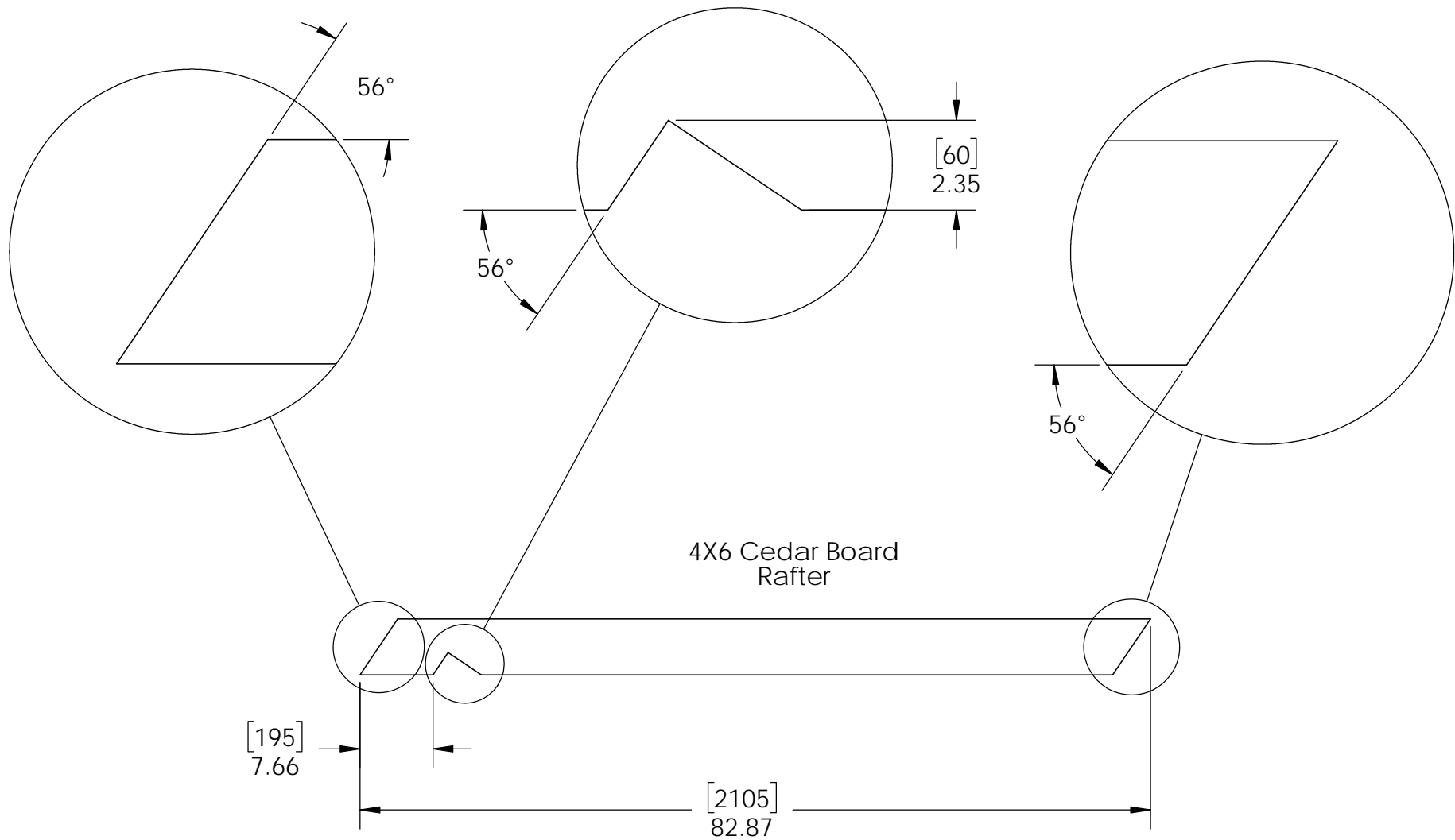

Cutlist3

OZCO Project #210 - Wood Post & Beam Pavilion - Free Standing

V1.00 - Installation Instructions effective May 1, 2015 and reflects information that available as of April 10, 2014. This information is updated periodically and should not be relied upon after May 1, 2015. Please visit www.OZCOBP.com to get current information

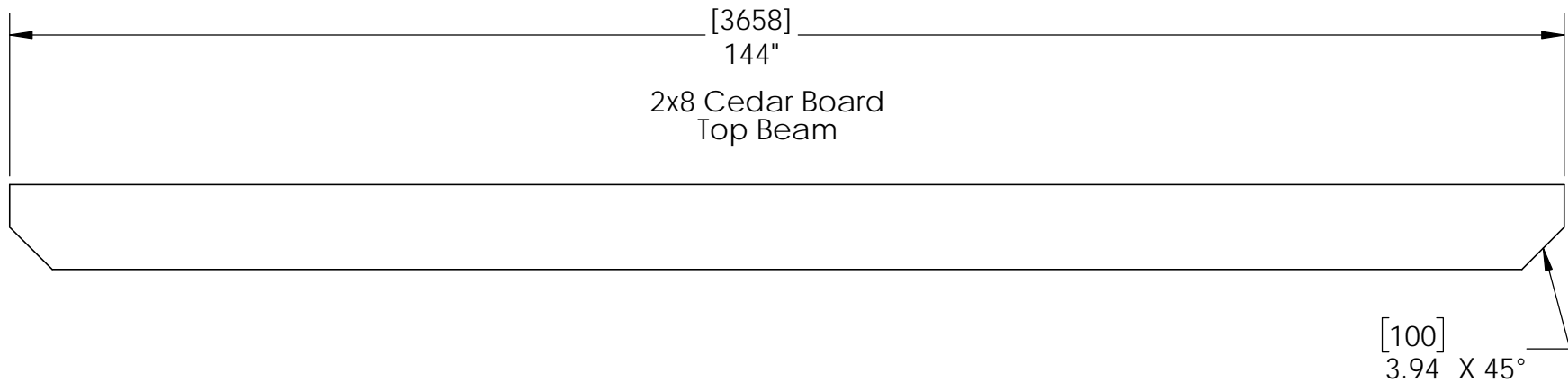
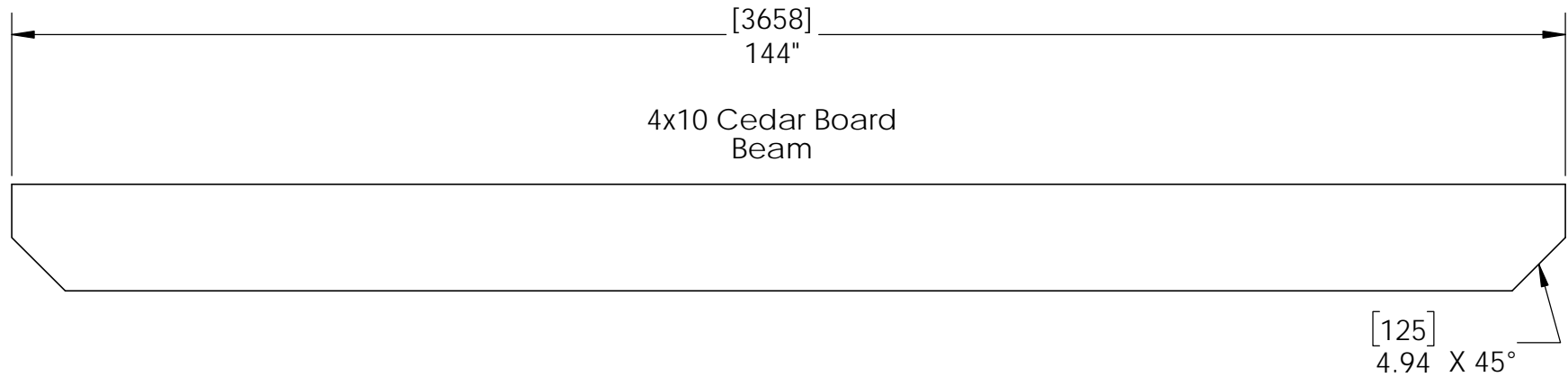

Cutlist4

OZCO Project #210 - Wood Post & Beam Pavilion - Free Standing

V1.00 - Installation Instructions effective May 1, 2015 and reflects information that available as of April 10, 2014. This information is updated periodically and should not be relied upon after May 1, 2015. Please visit www.OZCOBP.com to get current information

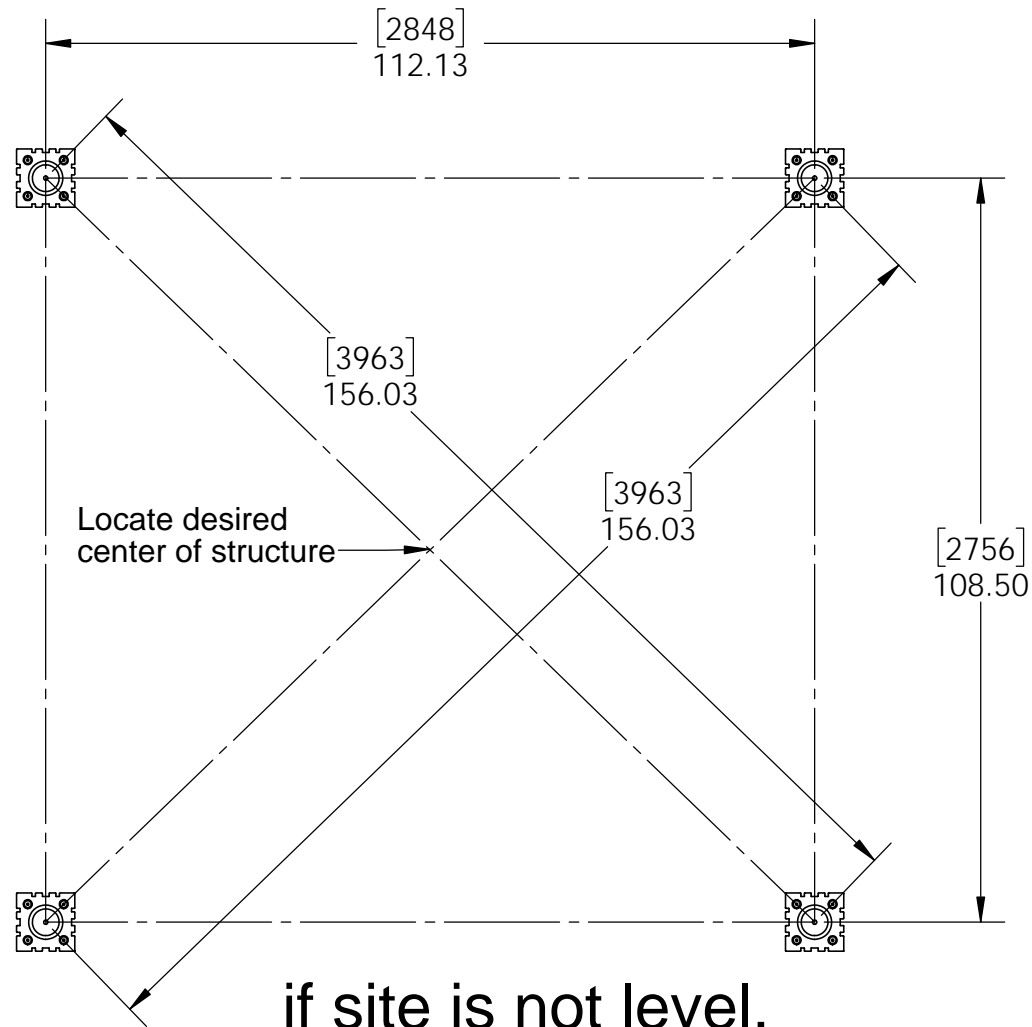

if site is not level,
see Ozco Site Leveling instruction



site plan

OZCO Project #210 - Wood Post & Beam Pavilion - Free Standing

V1.00 - Installation Instructions effective May 1, 2015 and reflects information that available as of April 10, 2014. This information is updated periodically and should not be relied upon after May 1, 2015. Please visit www.OZCOBP.com to get current information

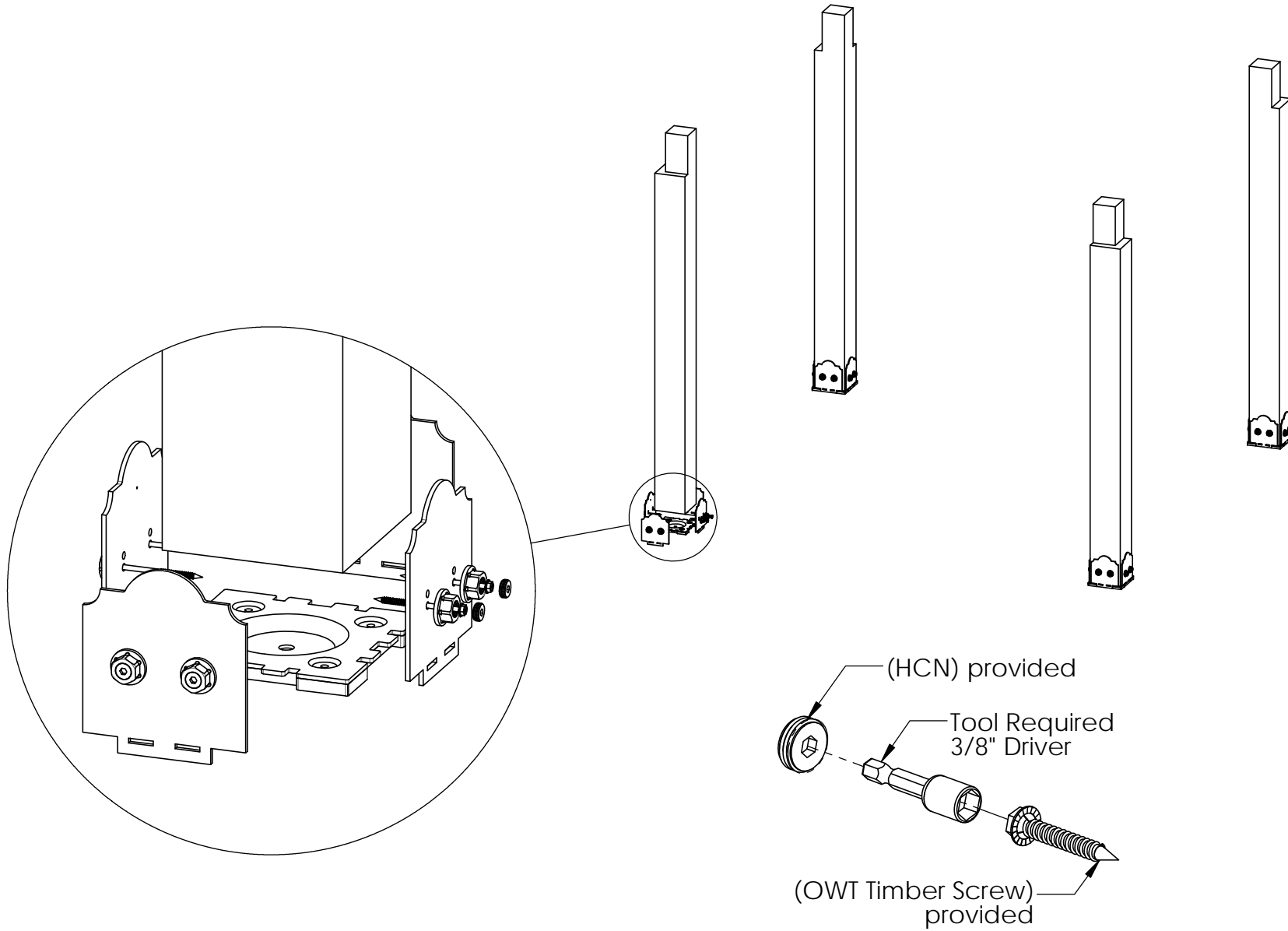

step 1

OZCO Project #210 - Wood Post & Beam Pavilion - Free Standing

V1.00 - Installation Instructions effective May 1, 2015 and reflects information that available as of April 10, 2014. This information is updated periodically and should not be relied upon after May 1, 2015. Please visit www.OZCOBP.com to get current information

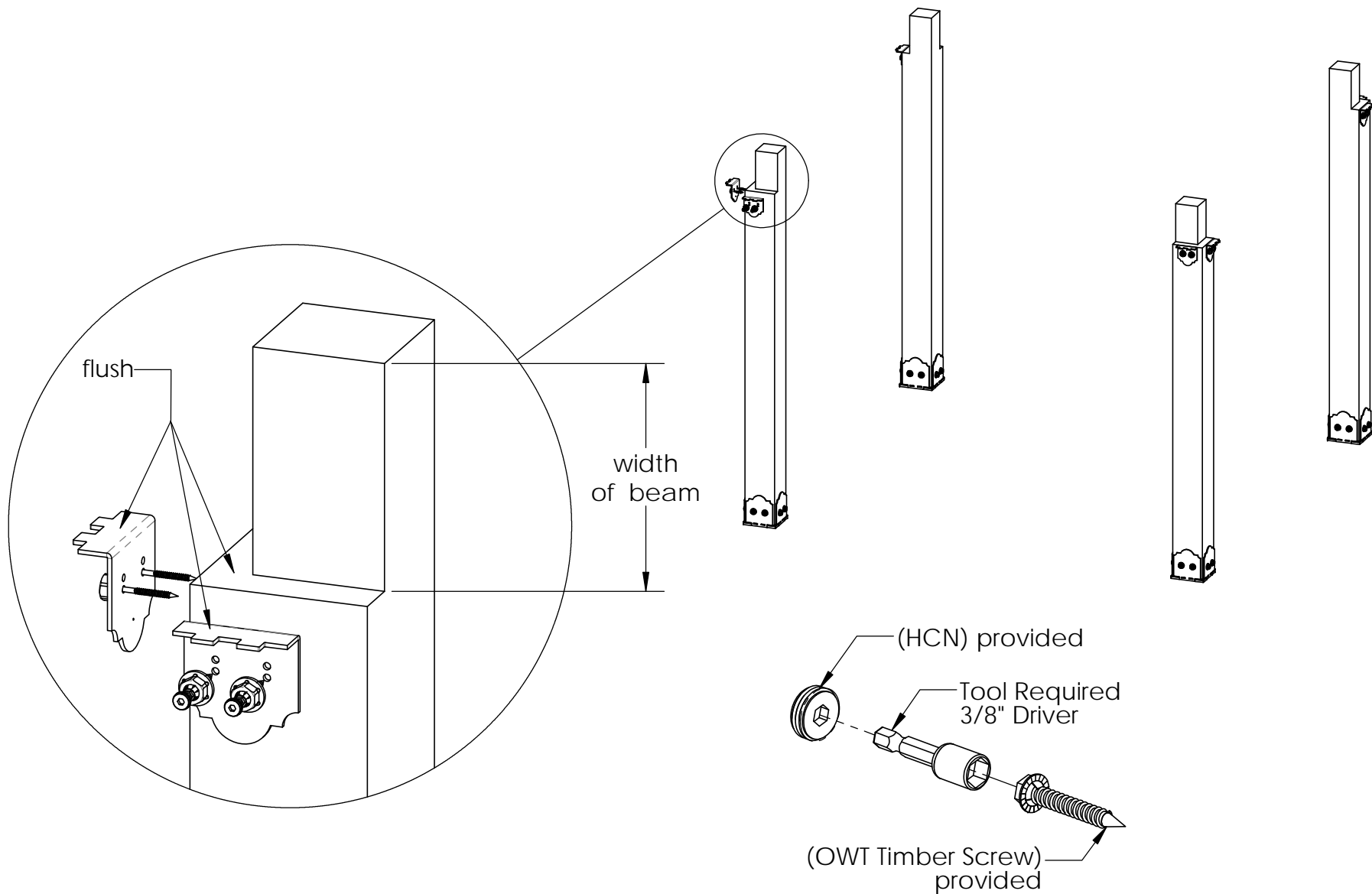

step 2

OZCO Project #210 - Wood Post & Beam Pavilion - Free Standing

V1.00 - Installation Instructions effective May 1, 2015 and reflects information that available as of April 10, 2014. This information is updated periodically and should not be relied upon after May 1, 2015. Please visit www.OZCOBP.com to get current information

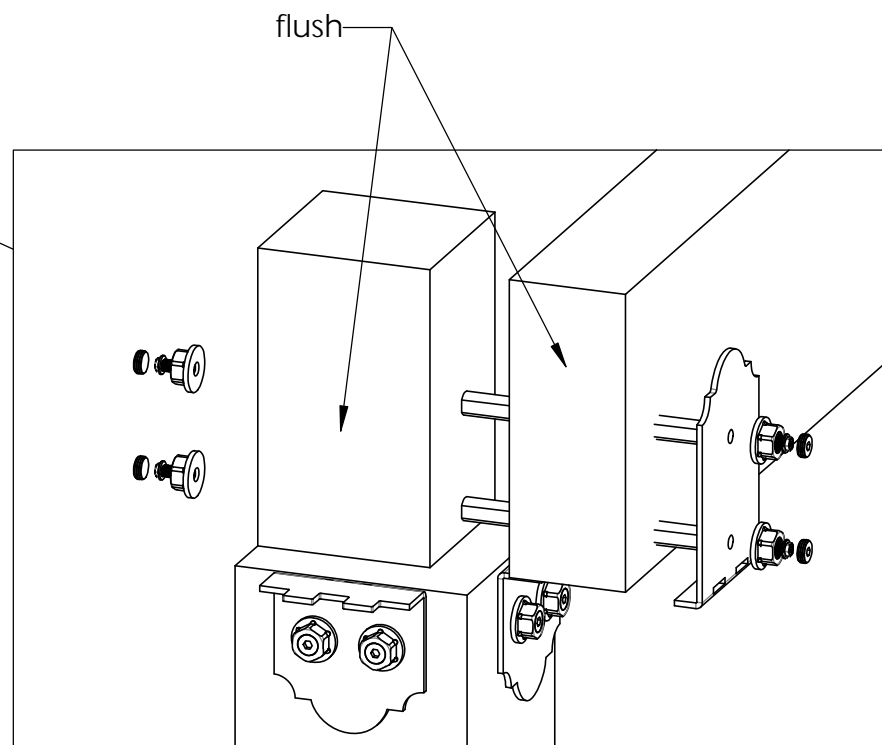
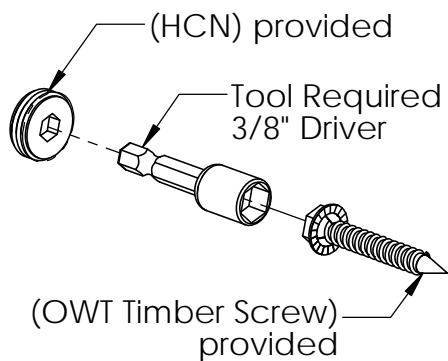
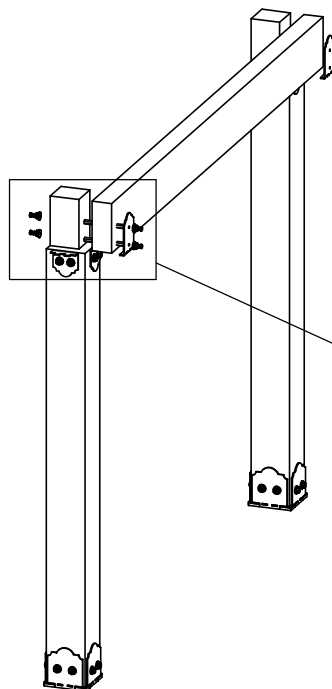
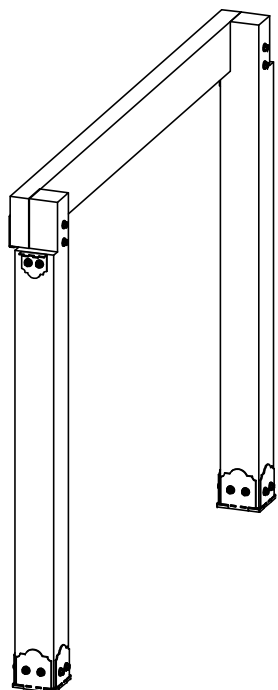

step 3

OZCO Project #210 - Wood Post & Beam Pavilion - Free Standing

V1.00 - Installation Instructions effective May 1, 2015 and reflects information that available as of April 10, 2014. This information is updated periodically and should not be relied upon after May 1, 2015. Please visit www.OZCOBP.com to get current information

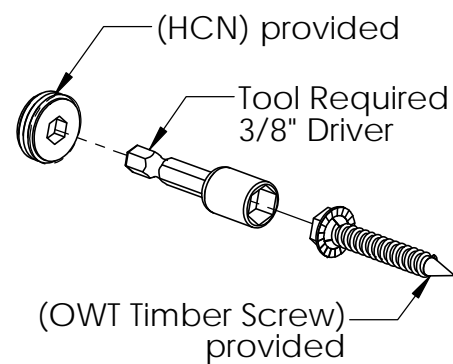
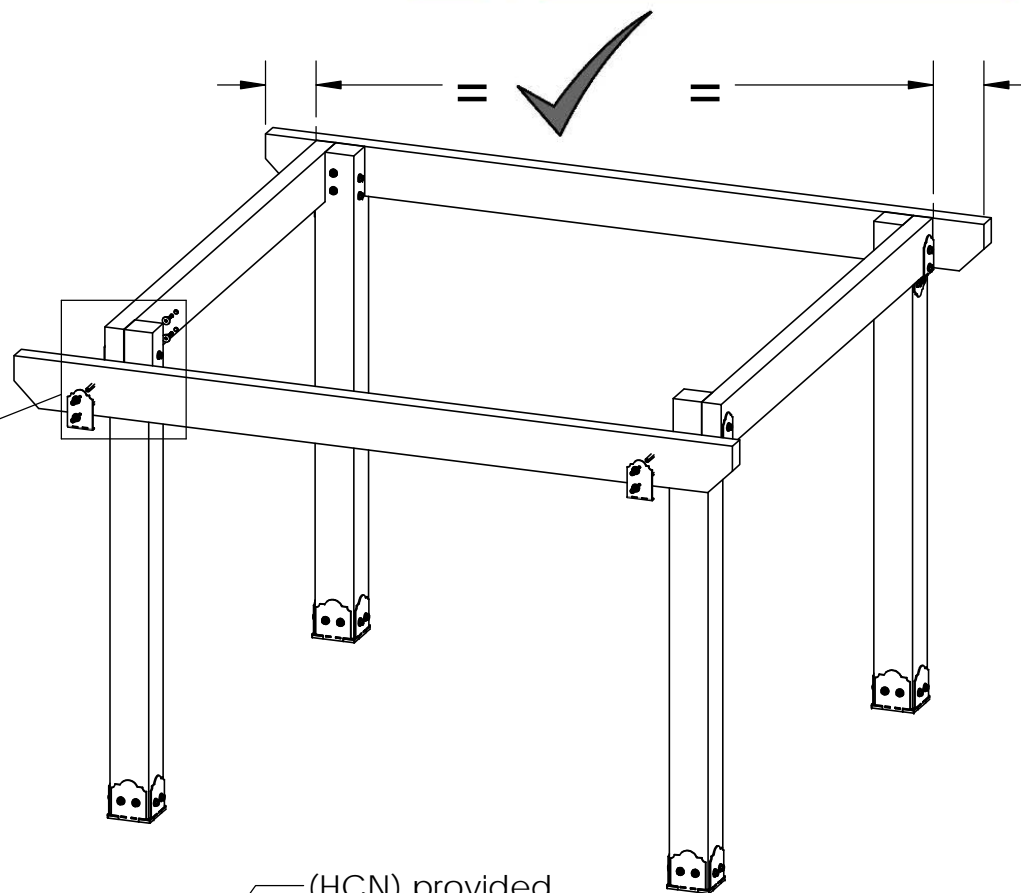
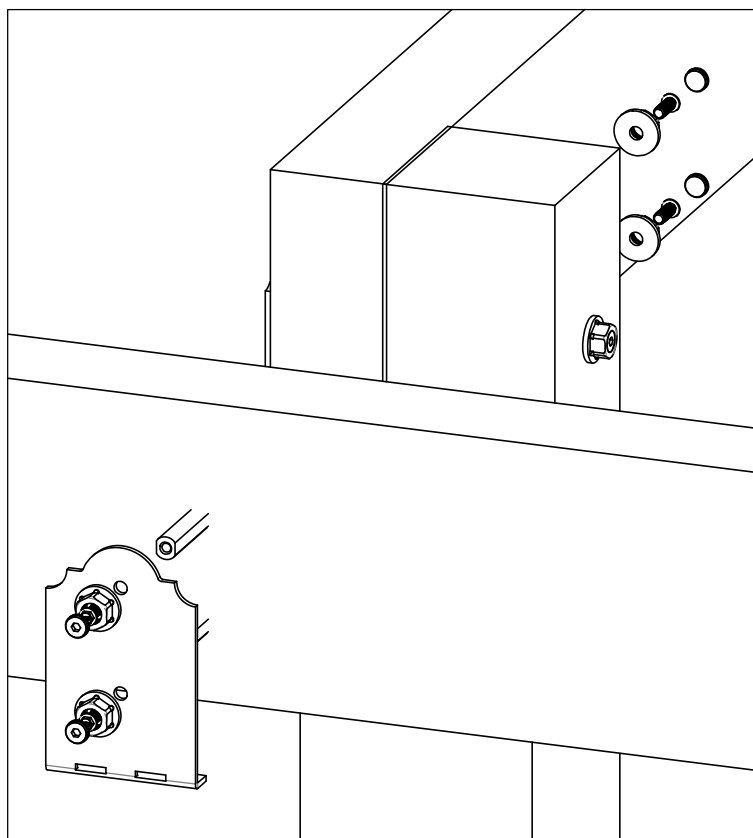

step 4

OZCO Project #210 - Wood Post & Beam Pavilion - Free Standing

V1.00 - Installation Instructions effective May 1, 2015 and reflects information that available as of April 10, 2014. This information is updated periodically and should not be relied upon after May 1, 2015. Please visit www.OZCOBP.com to get current information

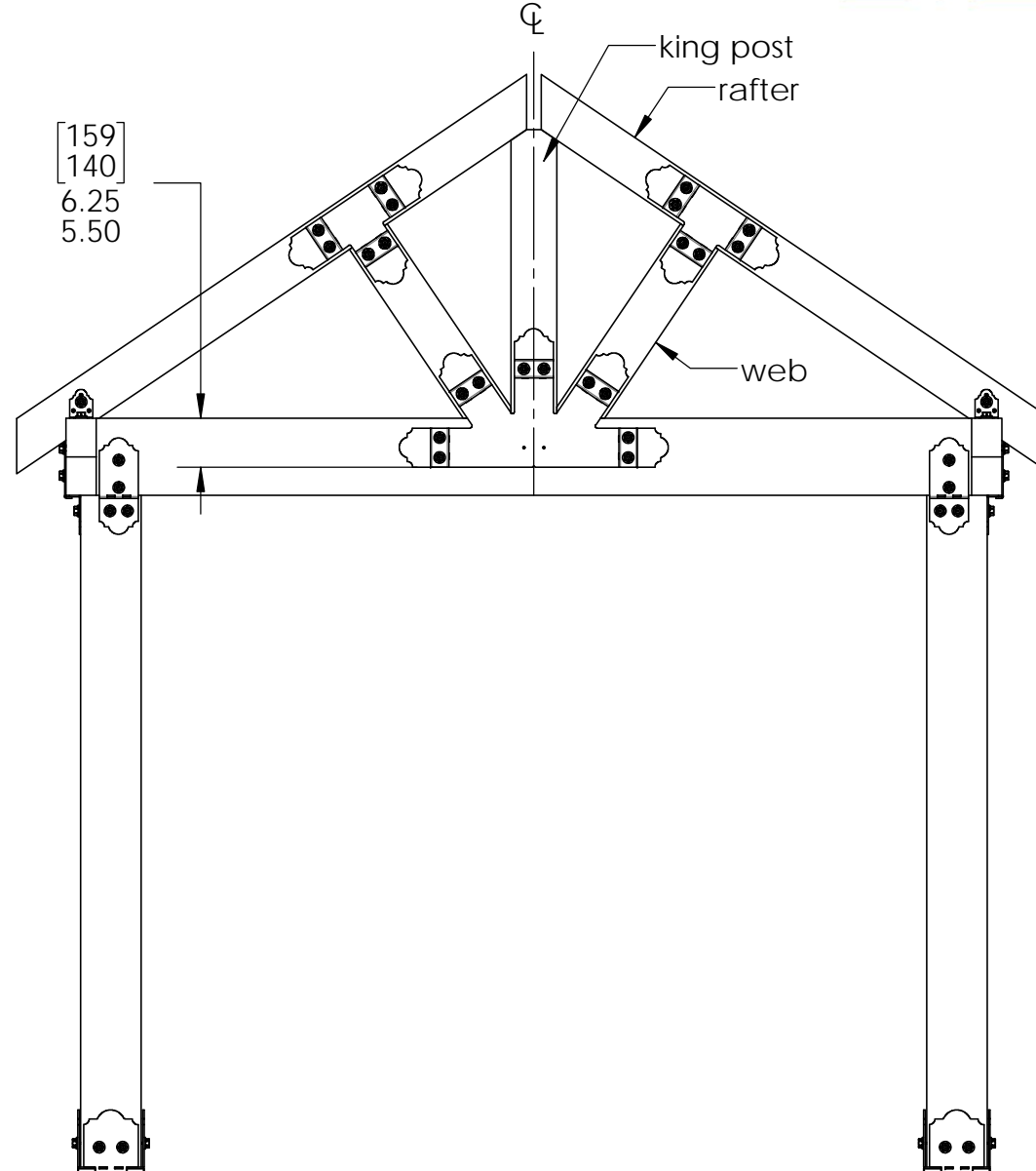

step 5 Truss Overview

**OZCO Project #210 - Wood Post & Beam
Pavilion - Free Standing**

V1.00 - Installation Instructions effective May 1, 2015 and reflects information that available as of April 10, 2014. This information is updated periodically and should not be relied upon after May 1, 2015. Please visit www.OZCOBP.com to get current information

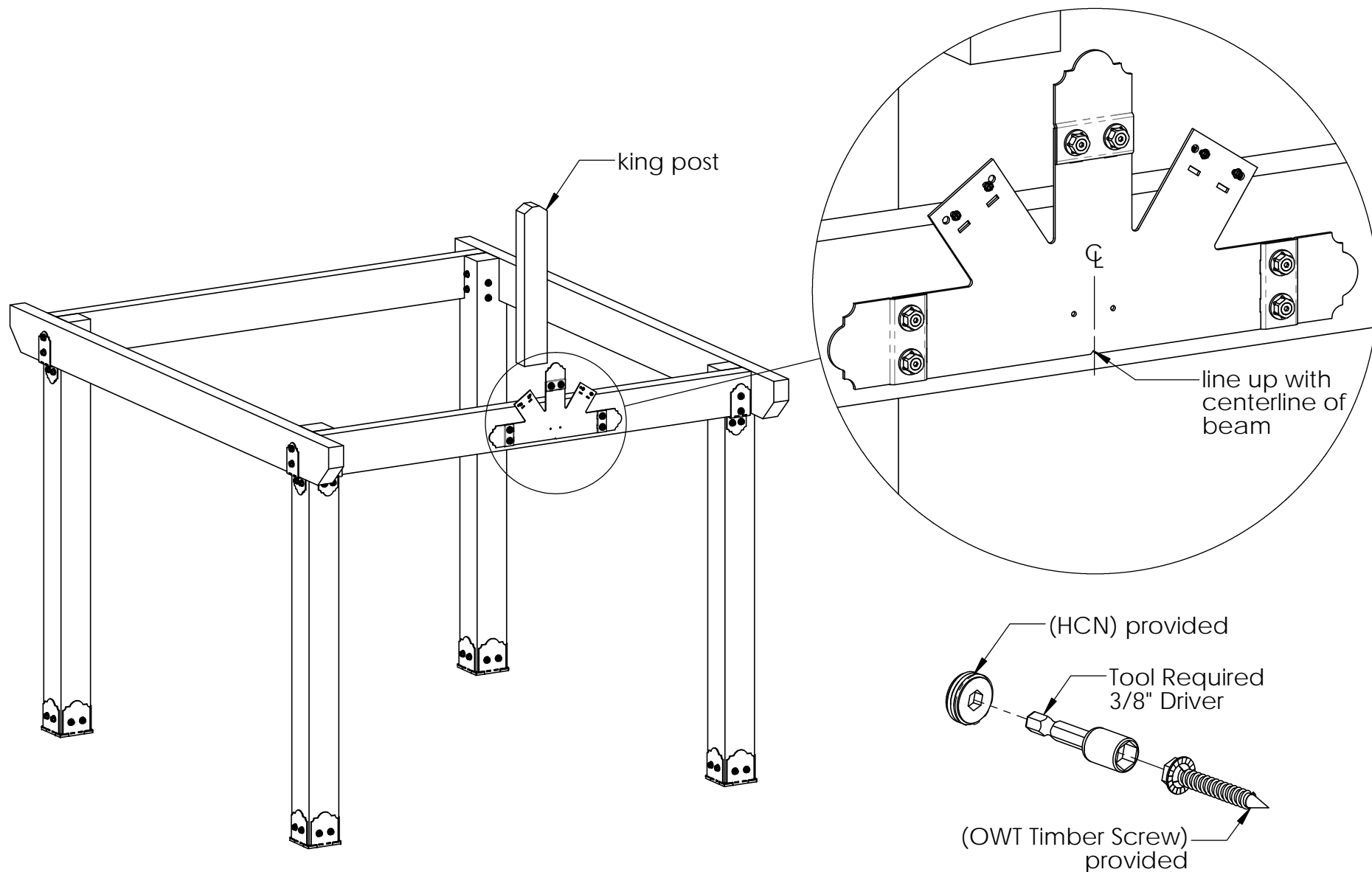

step 6

OZCO Project #210 - Wood Post & Beam Pavilion - Free Standing

V1.00 - Installation Instructions effective May 1, 2015 and reflects information that available as of April 10, 2014. This information is updated periodically and should not be relied upon after May 1, 2015. Please visit www.OZCOBP.com to get current information

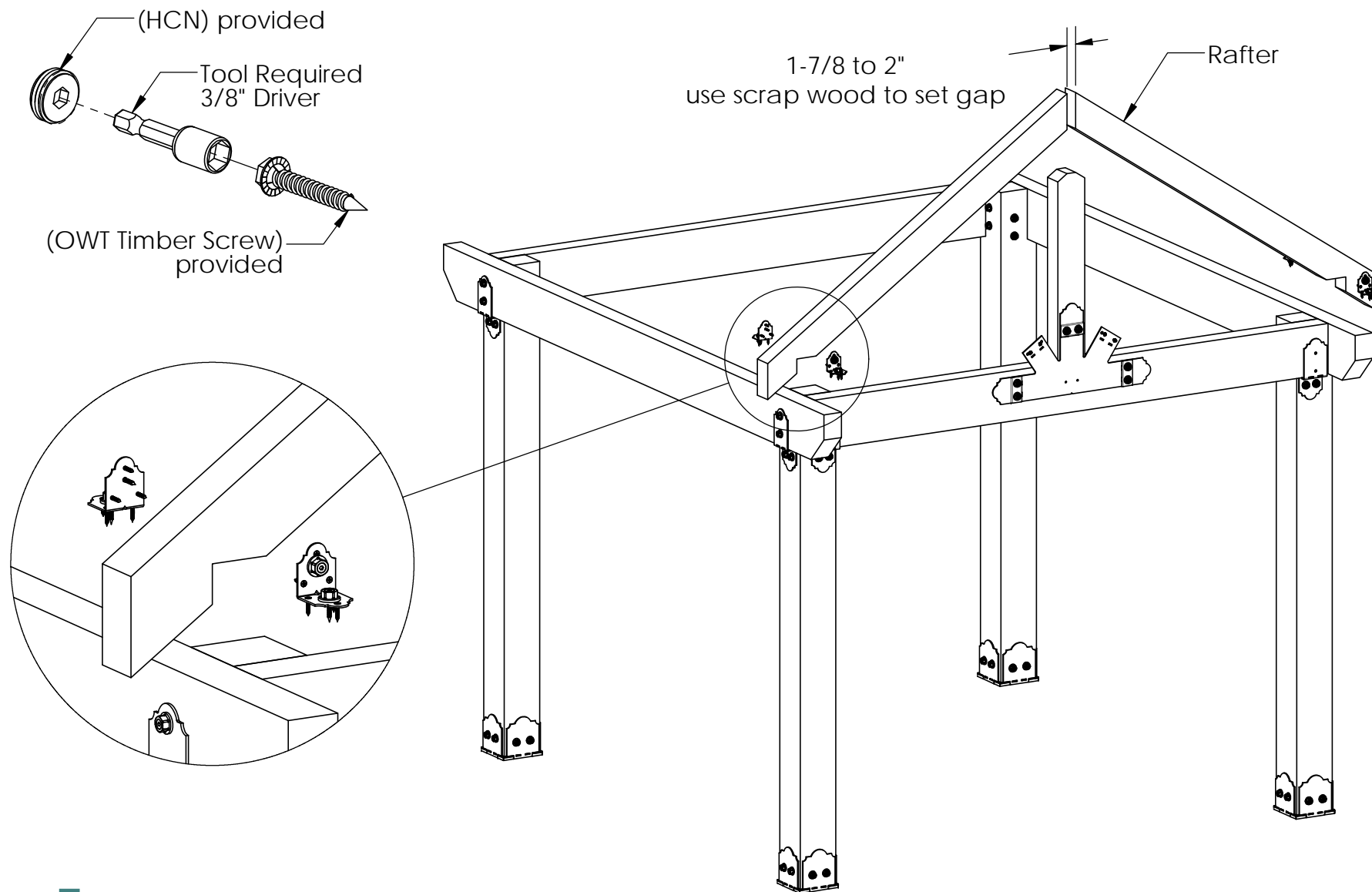

step 7

OZCO Project #210 - Wood Post & Beam Pavilion - Free Standing

V1.00 - Installation Instructions effective May 1, 2015 and reflects information that available as of April 10, 2014. This information is updated periodically and should not be relied upon after May 1, 2015. Please visit www.OZCOBP.com to get current information

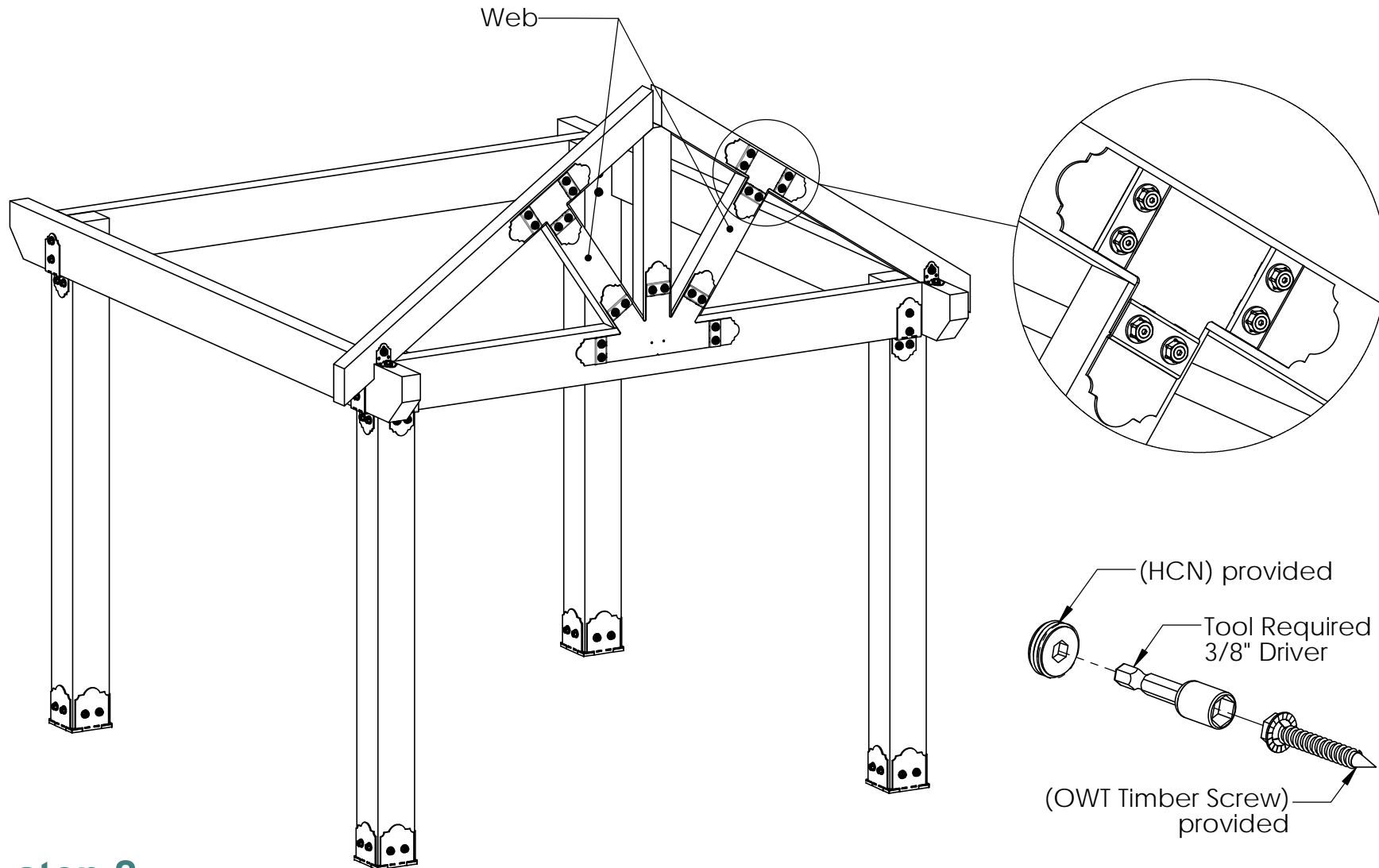

step 8

OZCO Project #210 - Wood Post & Beam Pavilion - Free Standing

V1.00 - Installation Instructions effective May 1, 2015 and reflects information that available as of April 10, 2014. This information is updated periodically and should not be relied upon after May 1, 2015. Please visit www.OZCOBP.com to get current information

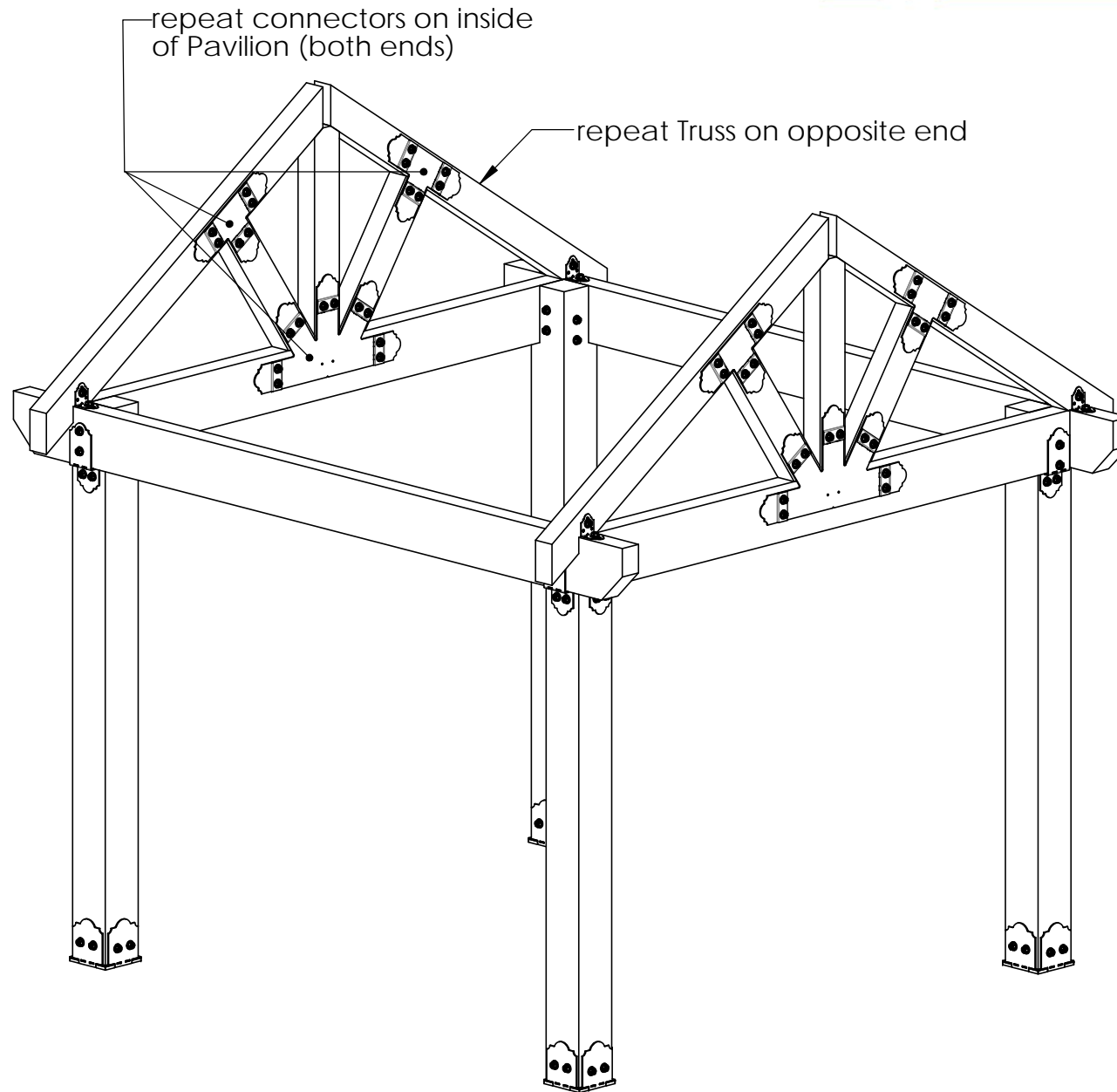

step 9

**OZCO Project #210 - Wood Post & Beam
Pavilion - Free Standing**

V1.00 - Installation Instructions effective May 1, 2015 and reflects information that available as of April 10, 2014. This information is updated periodically and should not be relied upon after May 1, 2015. Please visit www.OZCOBP.com to get current information

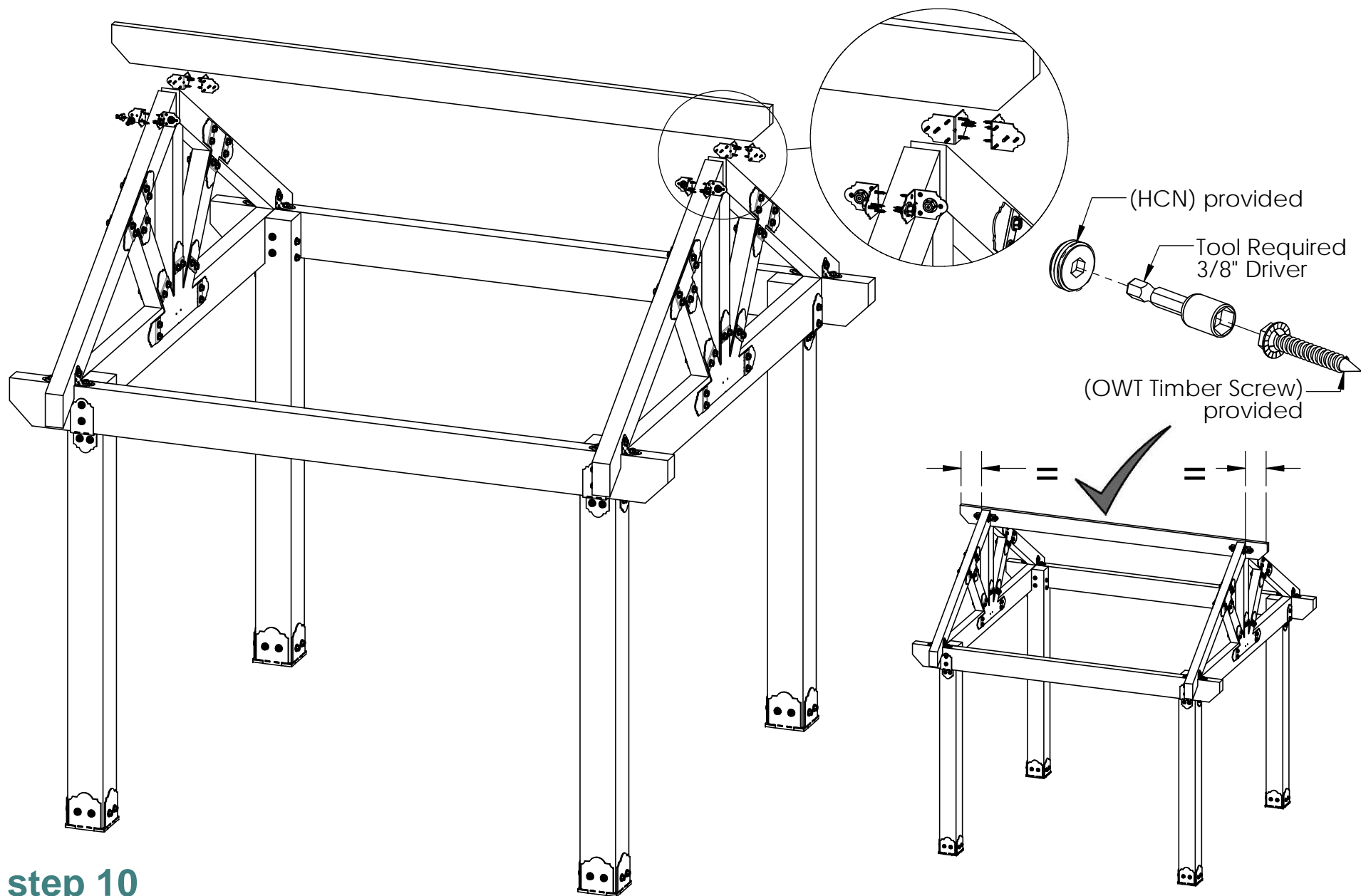

step 10

OZCO Project #210 - Wood Post & Beam Pavilion - Free Standing

V1.00 - Installation Instructions effective May 1, 2015 and reflects information that available as of April 10, 2014. This information is updated periodically and should not be relied upon after May 1, 2015. Please visit www.OZCOBP.com to get current information

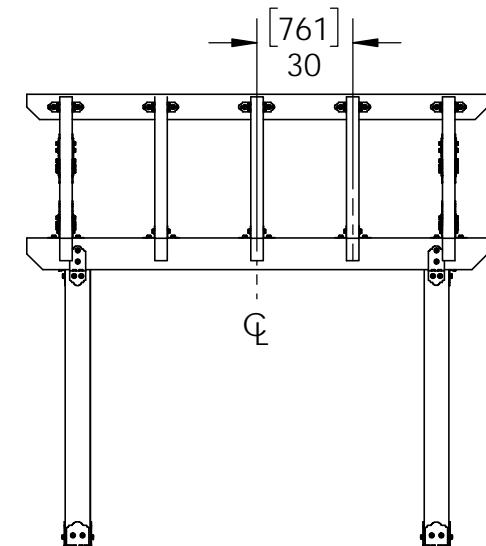
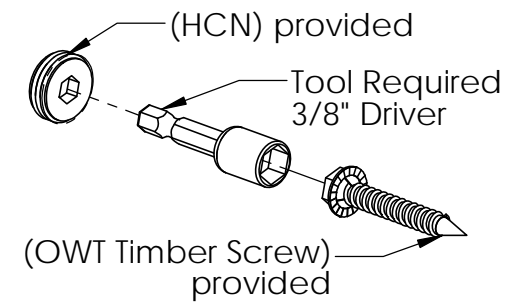
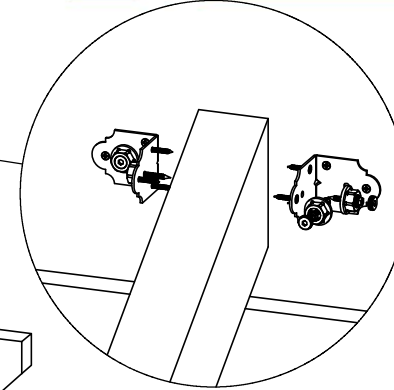
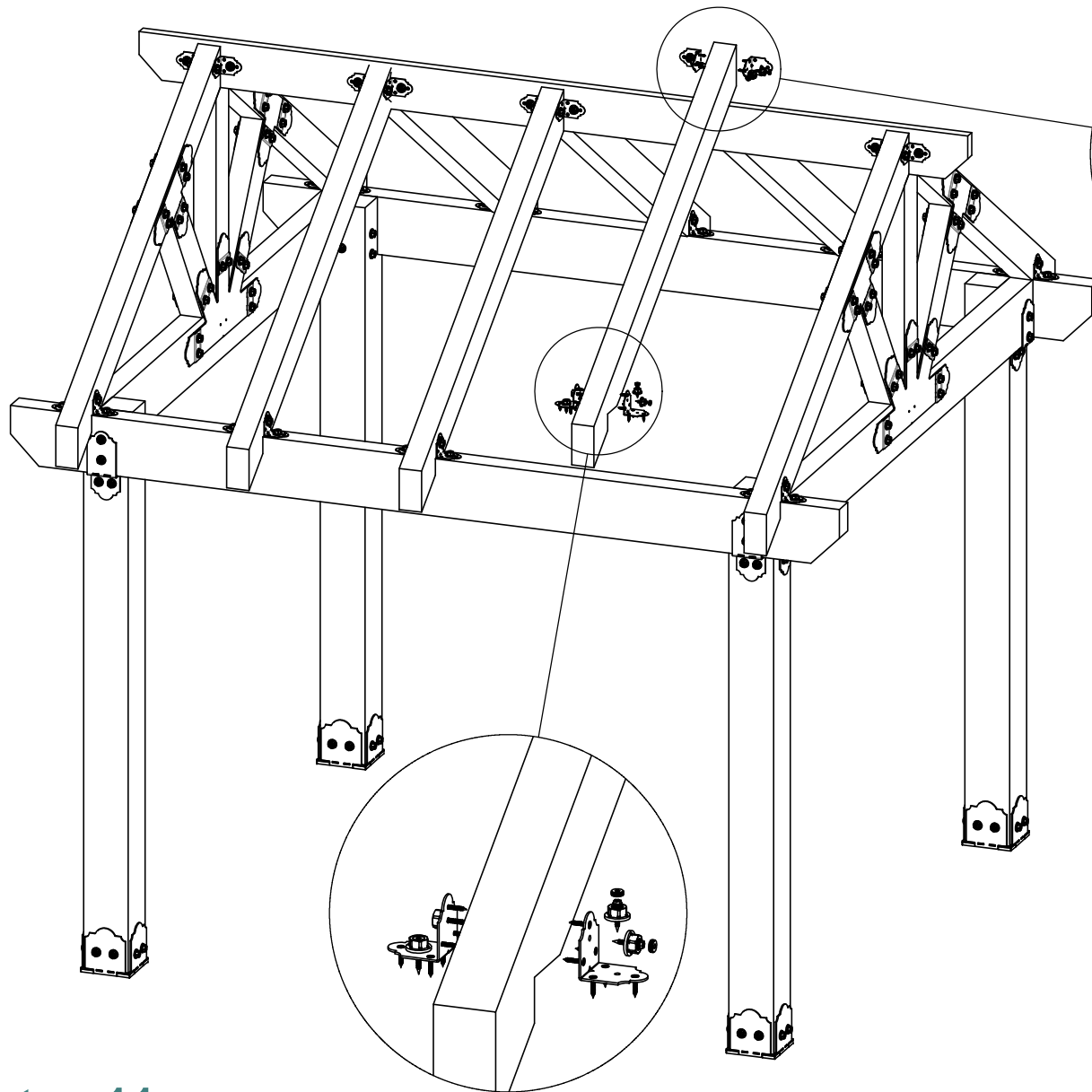

step 11

OZCO Project #210 - Wood Post & Beam Pavilion - Free Standing

V1.00 - Installation Instructions effective May 1, 2015 and reflects information that available as of April 10, 2014. This information is updated periodically and should not be relied upon after May 1, 2015. Please visit www.OZCOBP.com to get current information

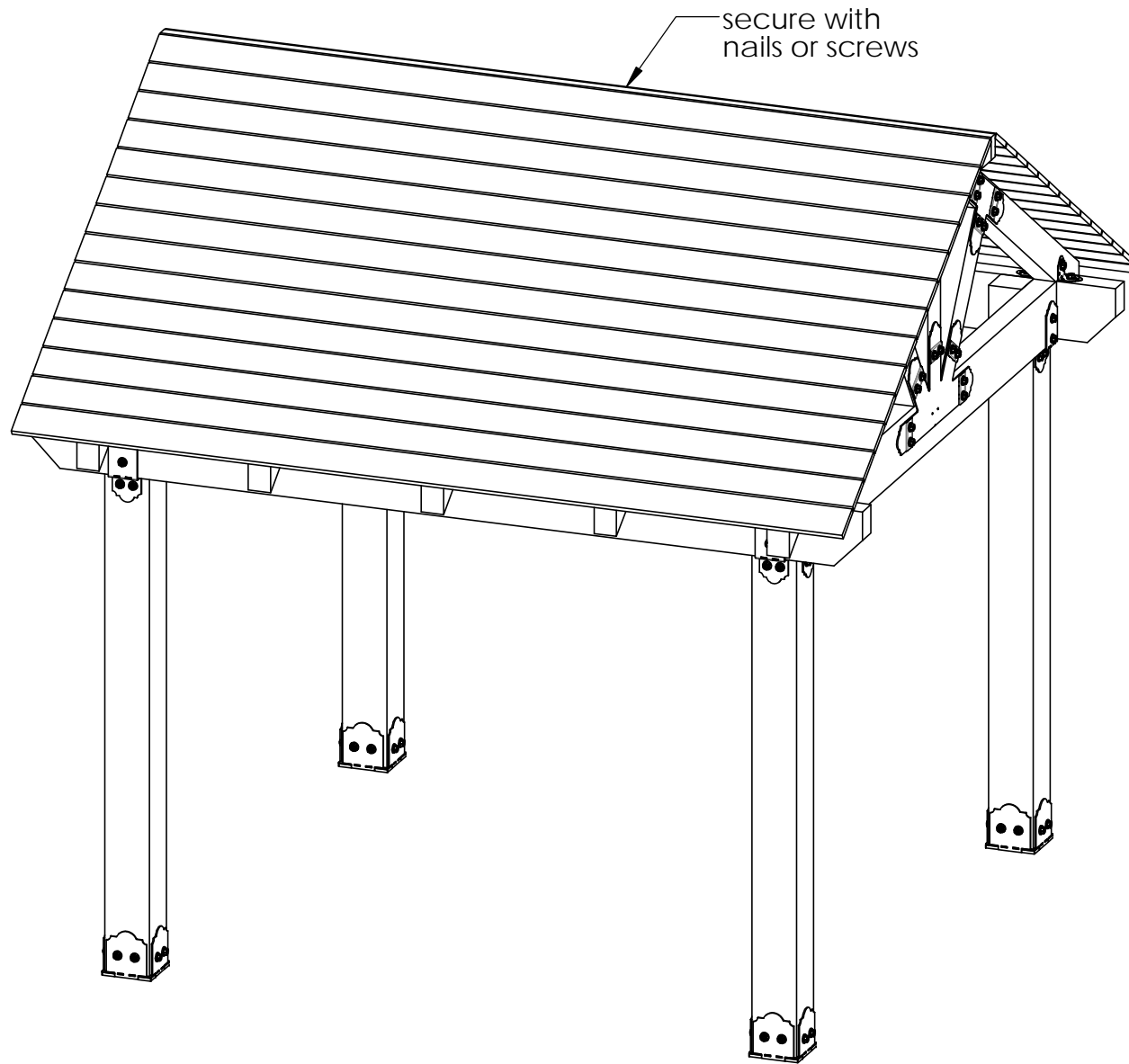

step 12

OZCO Project #210 - Wood Post & Beam Pavilion - Free Standing

V1.00 - Installation Instructions effective May 1, 2015 and reflects information that available as of April 10, 2014. This information is updated periodically and should not be relied upon after May 1, 2015. Please visit www.OZCOBP.com to get current information

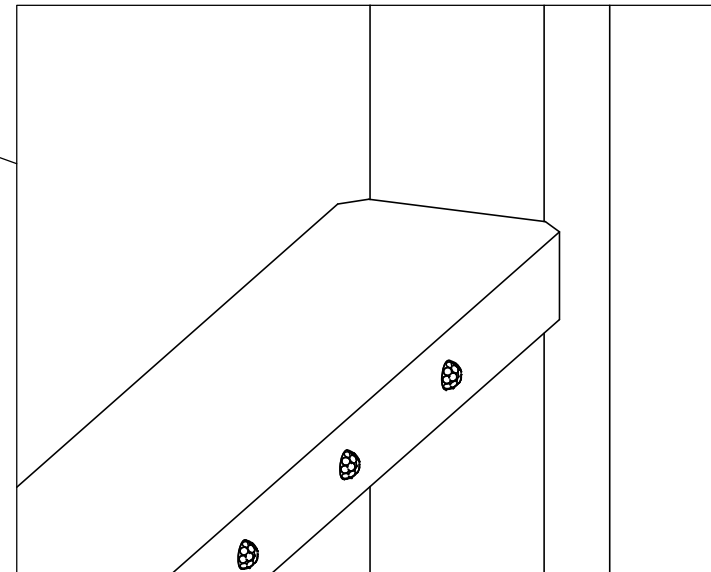
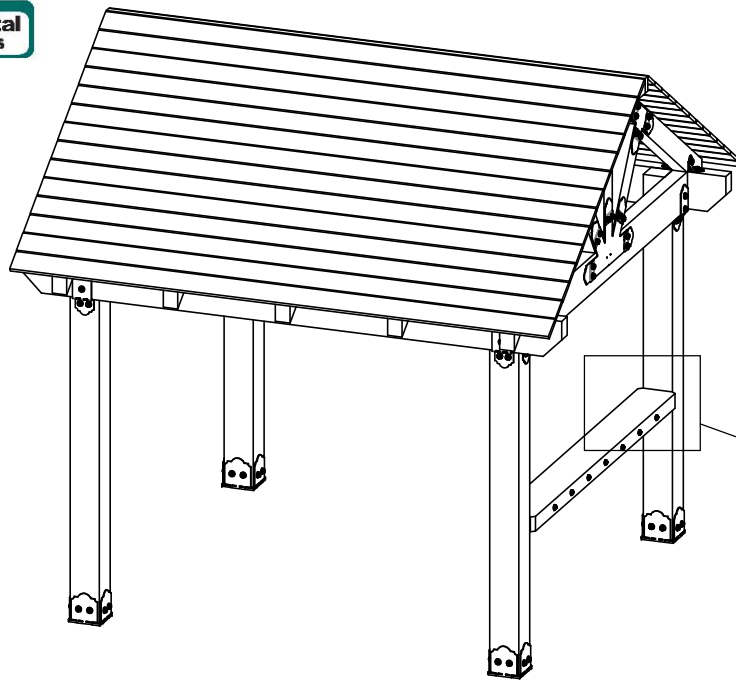

inside view
3 remaining
Dome Cap
Nuts

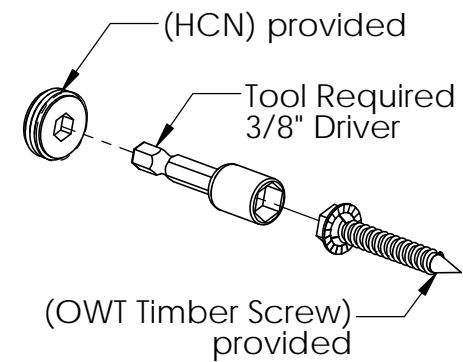
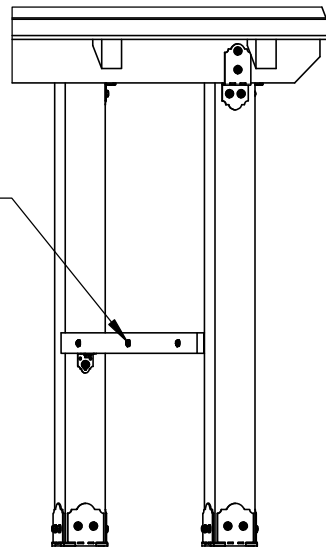

step 13

OZCO Project #210 - Wood Post & Beam Pavilion - Free Standing

V1.00 - Installation Instructions effective May 1, 2015 and reflects information that available as of April 10, 2014. This information is updated periodically and should not be relied upon after May 1, 2015. Please visit www.OZCOBP.com to get current information