

**DESIGN**

**PURCHASE**

**CONSTRUCT**

**ENJOY**

## OZCO Project #110 - Estate Wooden Mailbox Post Assembly



OZCO Project #110 - Estate Wooden Mailbox Post Assembly

V1.00 - Installation Instructions effective May 1, 2015 and reflects information that available as of April 10, 2014. This information is updated periodically and should not be relied upon after May 1, 2015. Please visit [www.OZCOBP.com](http://www.OZCOBP.com) to get current information



# Printing Documents from ISSUU

Unfortunately, there is currently no way to print content directly through issuu. To print a publication, you will need to download it and print it from your computer.

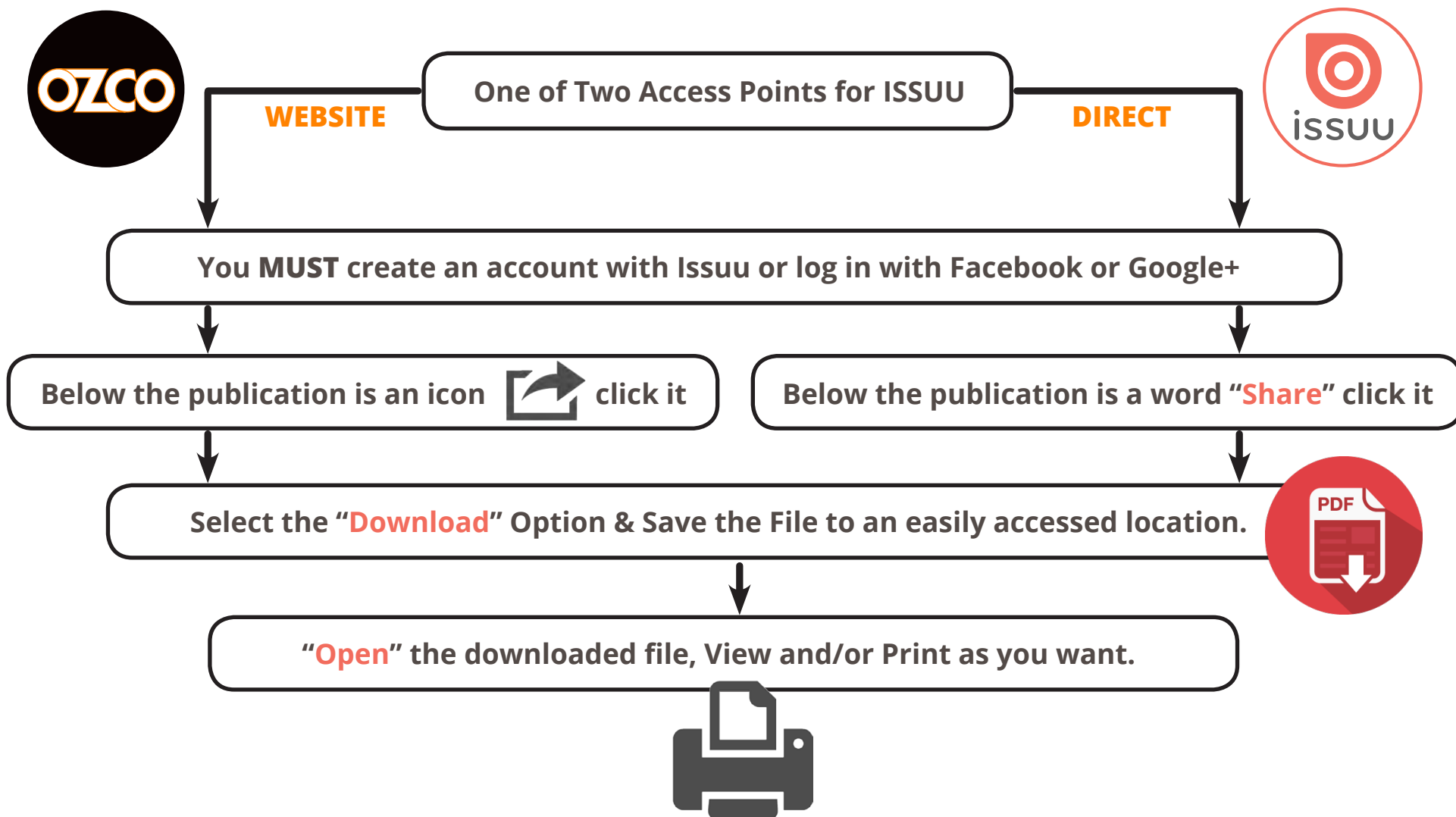

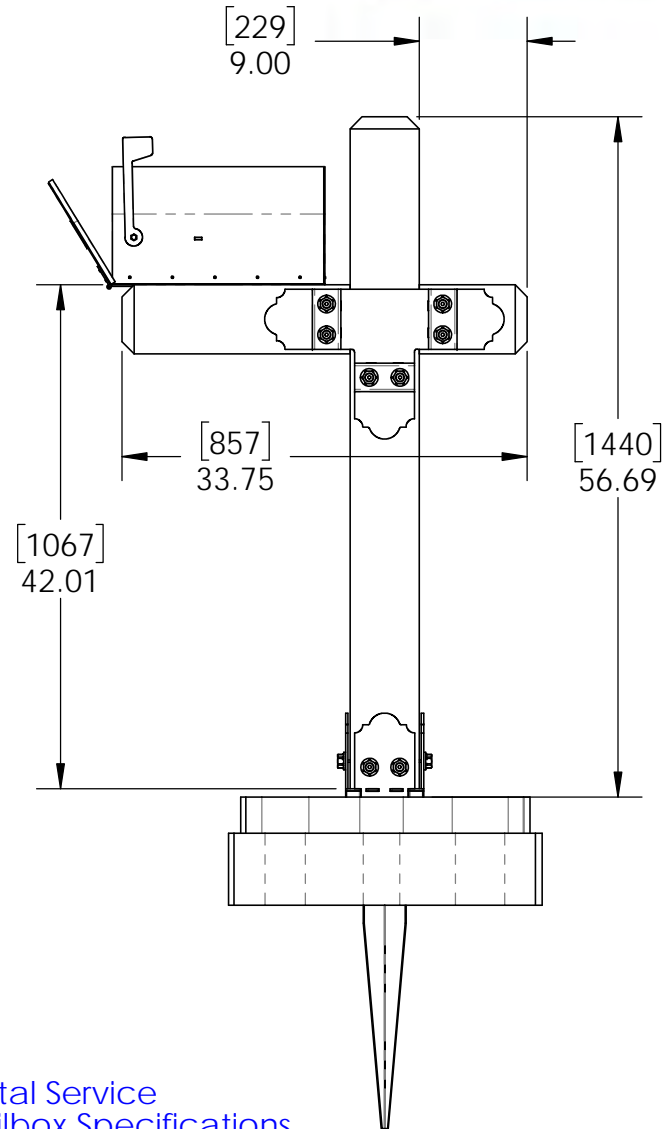
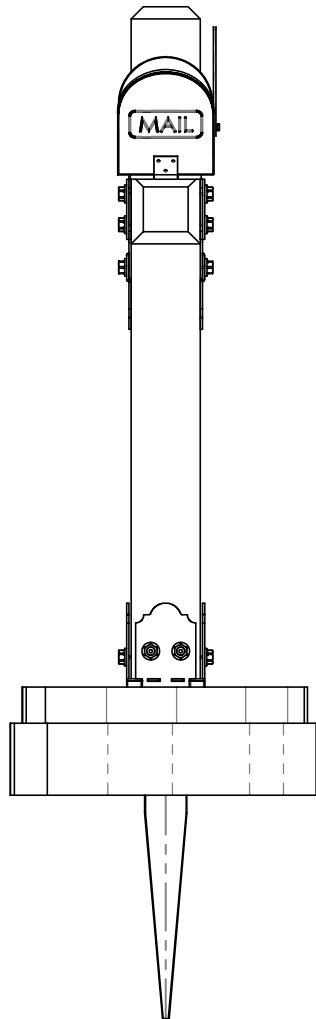

Postal Service  
Mailbox Specifications

## Overview

OZCO Project #110 - Estate Wooden Mailbox Post Assembly

V1.00 - Installation Instructions effective May 1, 2015 and reflects information that available as of April 10, 2014. This information is updated periodically and should not be relied upon after May 1, 2015. Please visit [www.OZCOBP.com](http://www.OZCOBP.com) to get current information

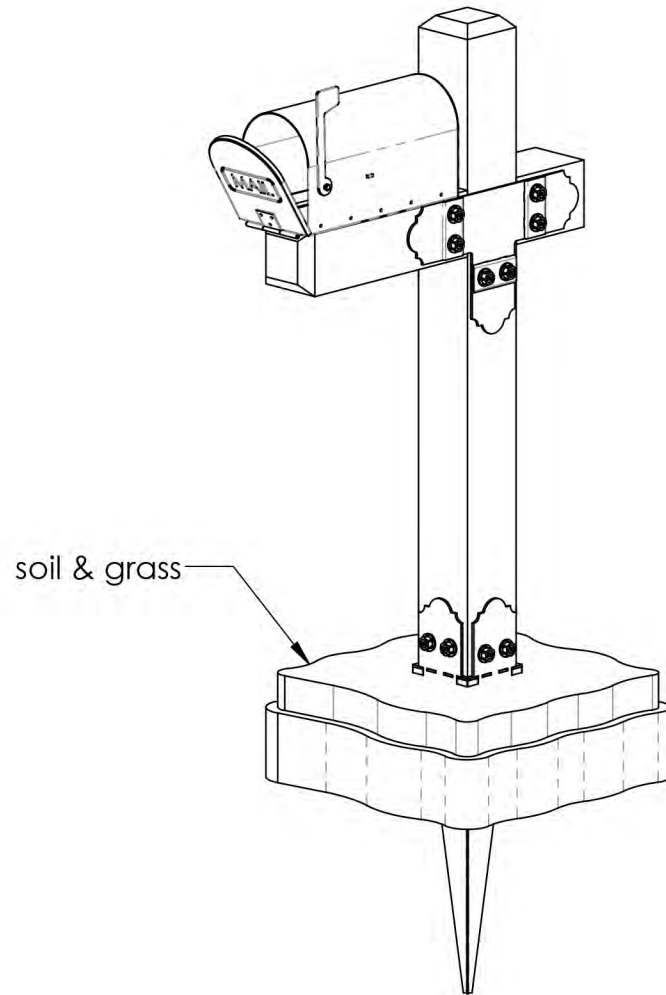

ITEM NO.	QTY.	PART NUMBER	DESCRIPTION
1	1	56633	6x6 Post Anchor Kit (6x6-OPAK-LS)
2	1	6x6 Cedar Post	6x6x56.00
3	1	6x6 Cedar Post	6x6x19.00
4	1	6x6 Cedar Post	6x6x9.00
5	1	mailbox	
6	1	56612	"T" Tie Plate (TTP)
	3	56611	Truss Accent (TA-LS)
	0.08	56625	OWT Timber Screw 1-3/4"

## Bill of Materials

OZCO Project #110 - Estate Wooden Mailbox Post Assembly

V1.00 - Installation Instructions effective May 1, 2015 and reflects information that available as of April 10, 2014. This information is updated periodically and should not be relied upon after May 1, 2015. Please visit [www.OZCOBP.com](http://www.OZCOBP.com) to get current information

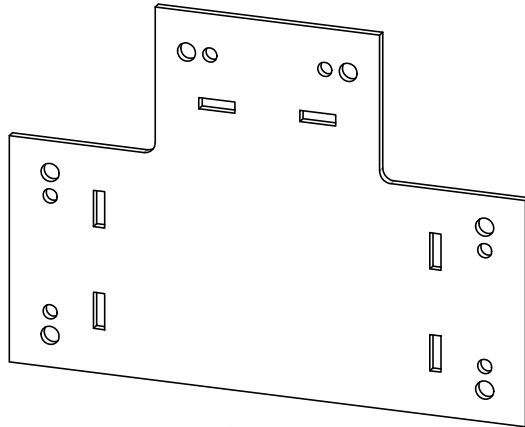

56612

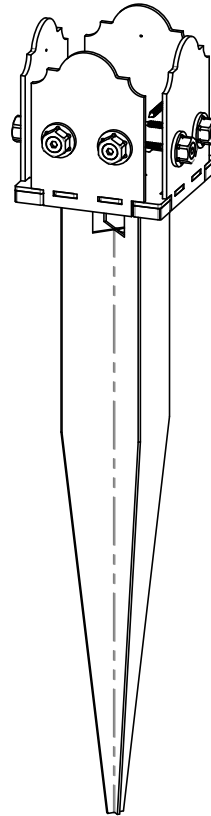

56633

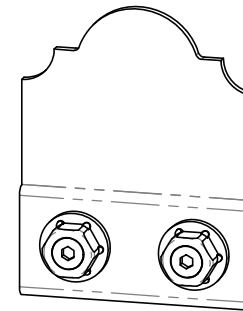

56611

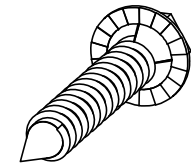

56625



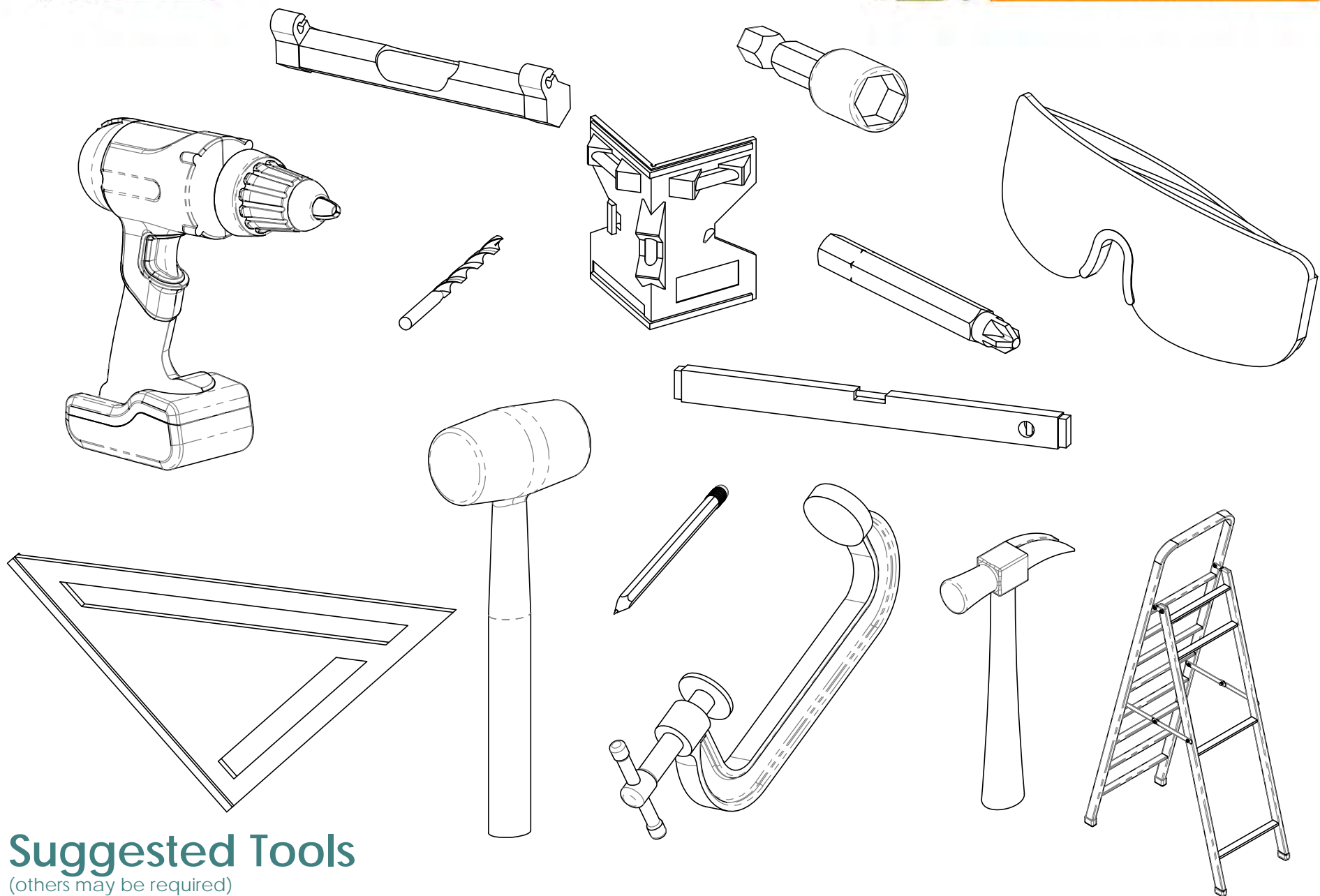

## Suggested Tools

(others may be required)

**OZCO Project #110 - Estate Wooden Mailbox Post Assembly**

V1.00 - Installation Instructions effective May 1, 2015 and reflects information that available as of April 10, 2014. This information is updated periodically and should not be relied upon after May 1, 2015. Please visit [www.OZCOBP.com](http://www.OZCOBP.com) to get current information

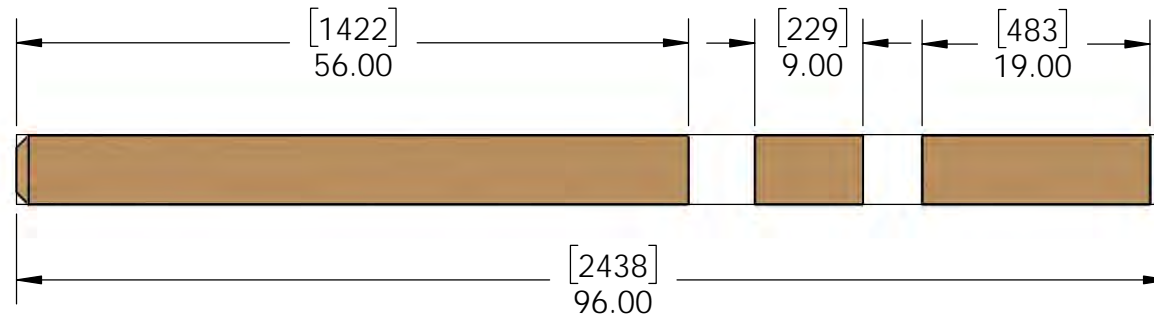

6x6x8 Post  
(cut all wood from 1 post)

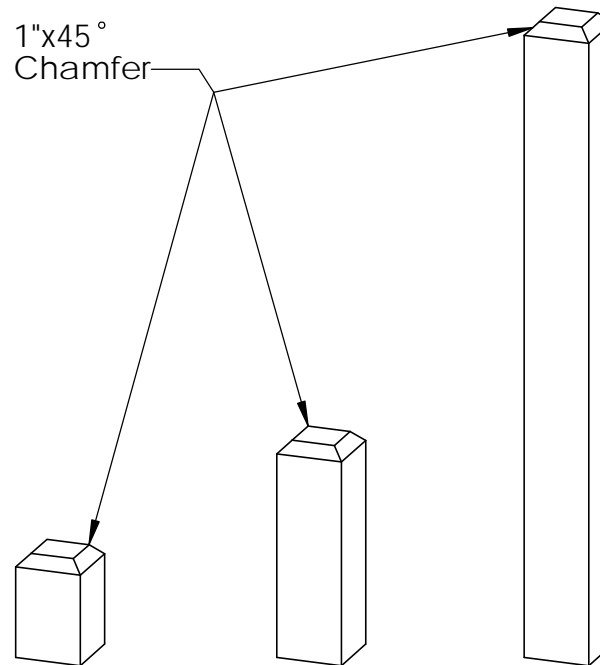

## Cutlist

OZCO Project #110 - Estate Wooden Mailbox Post Assembly

V1.00 - Installation Instructions effective May 1, 2015 and reflects information that available as of April 10, 2014. This information is updated periodically and should not be relied upon after May 1, 2015. Please visit [www.OZCOBP.com](http://www.OZCOBP.com) to get current information



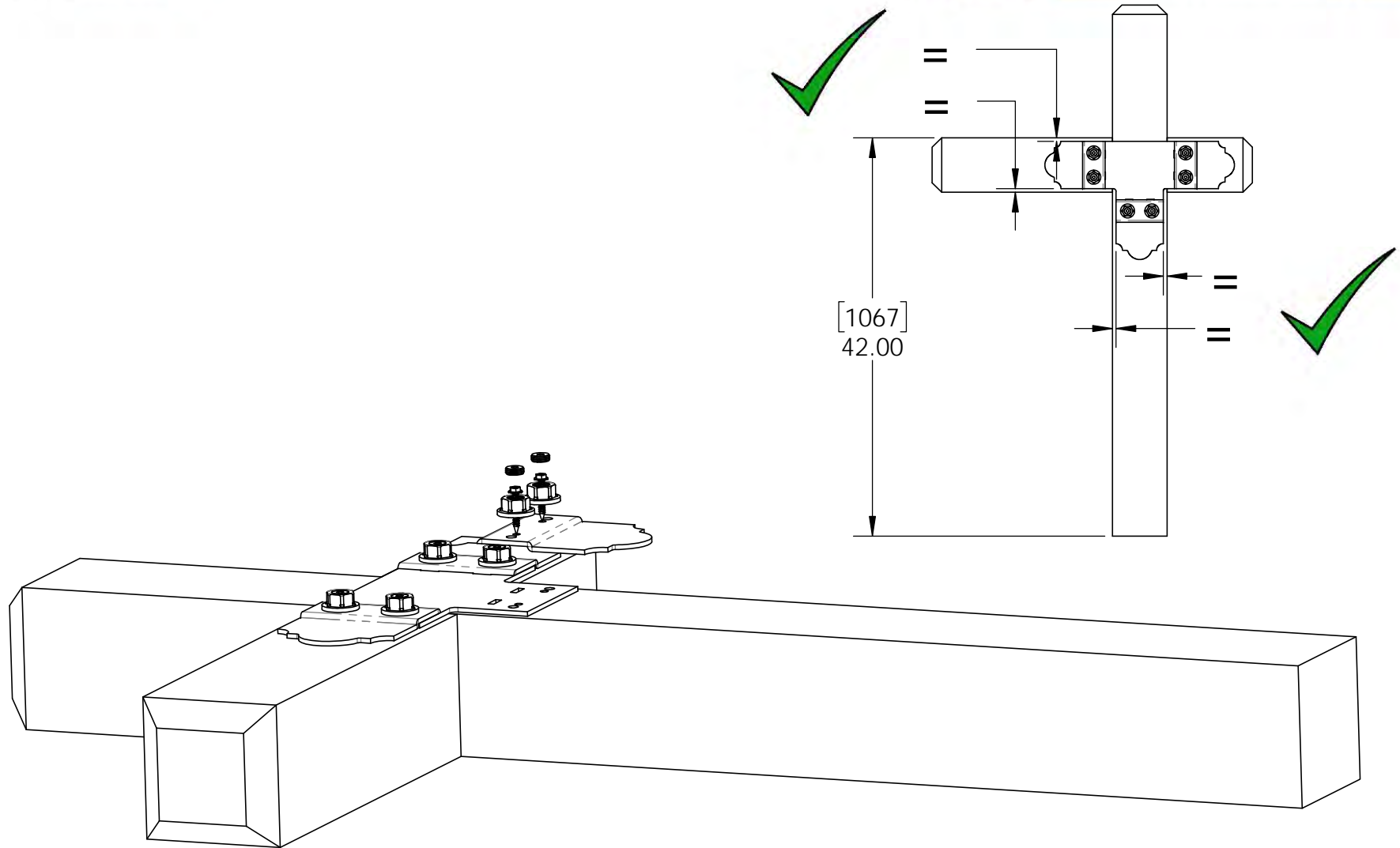

## step 1

OZCO Project #110 - Estate Wooden Mailbox Post Assembly

V1.00 - Installation Instructions effective May 1, 2015 and reflects information that available as of April 10, 2014. This information is updated periodically and should not be relied upon after May 1, 2015. Please visit [www.OZCOBP.com](http://www.OZCOBP.com) to get current information



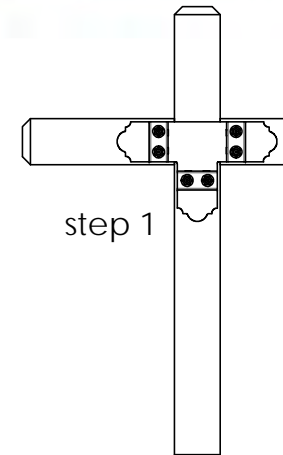
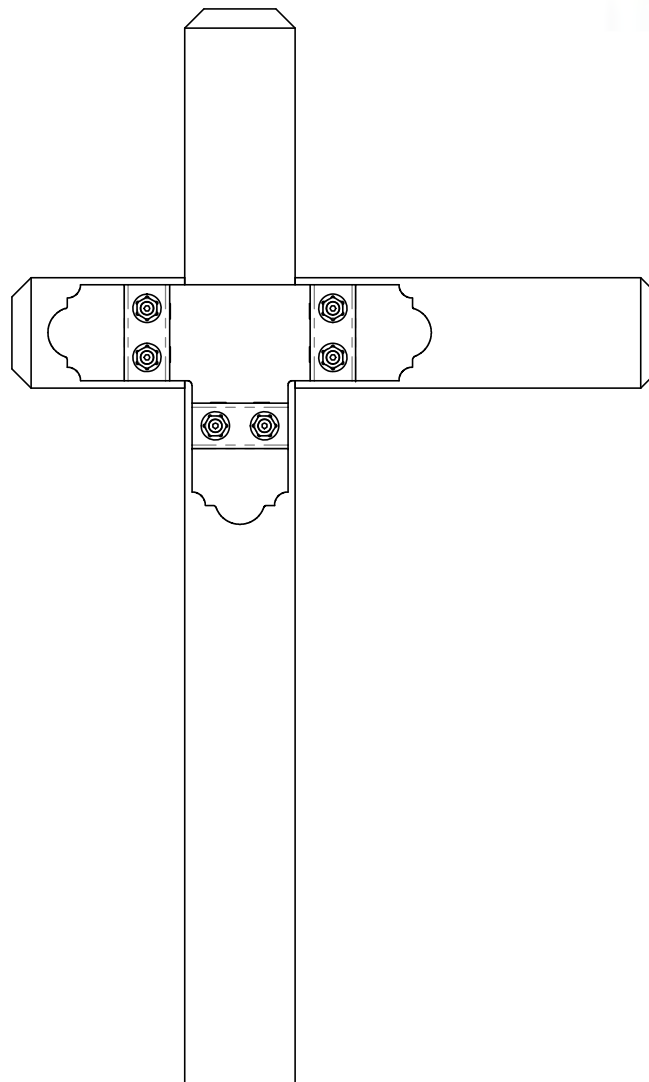

**step 2**  
repeat step 1 on opposite side

**OZCO Project #110 - Estate Wooden Mailbox Post Assembly**

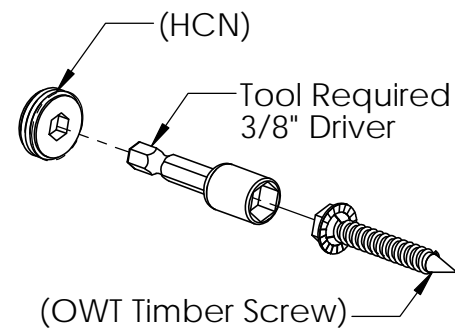
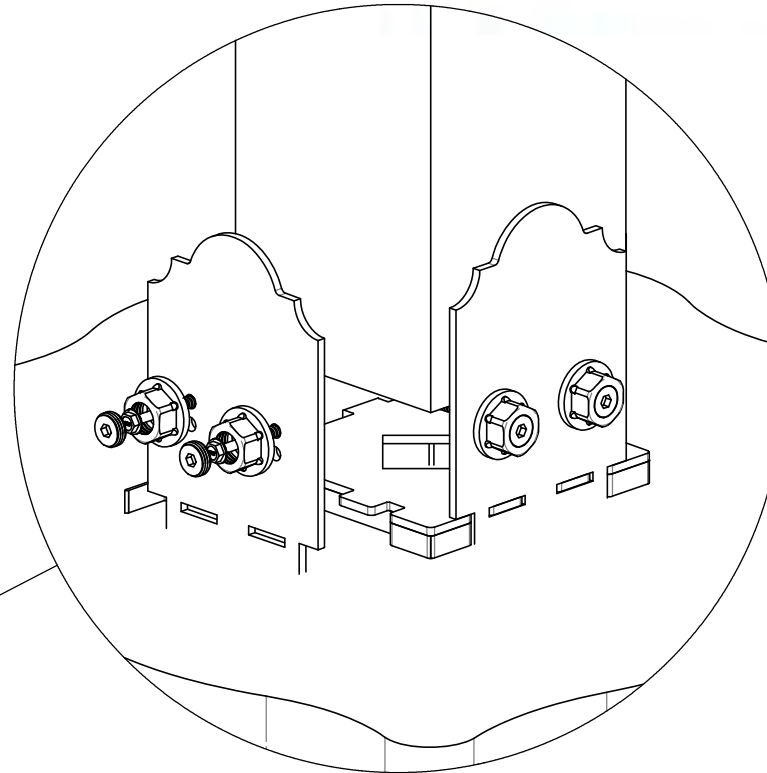
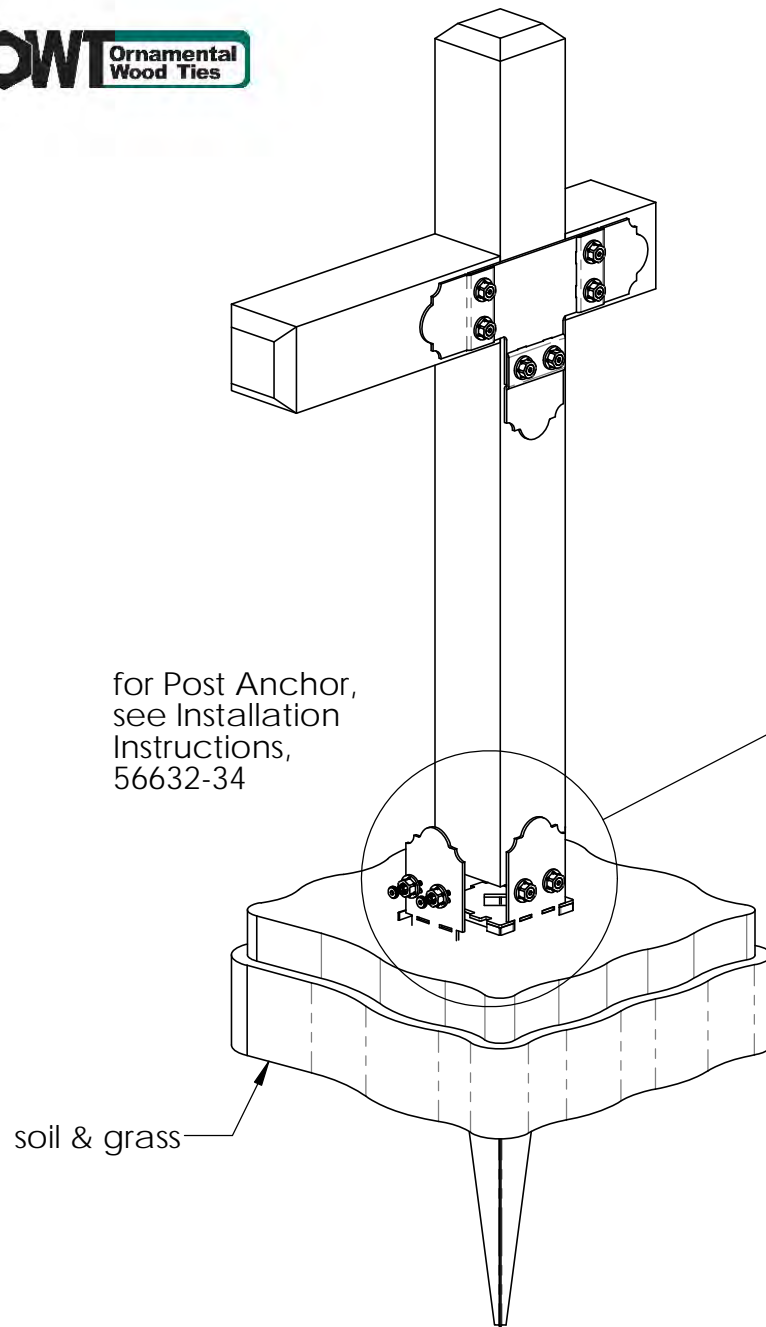

### step 3

#### OZCO Project #110 - Estate Wooden Mailbox Post Assembly

install mailbox per  
manufacturers instructions

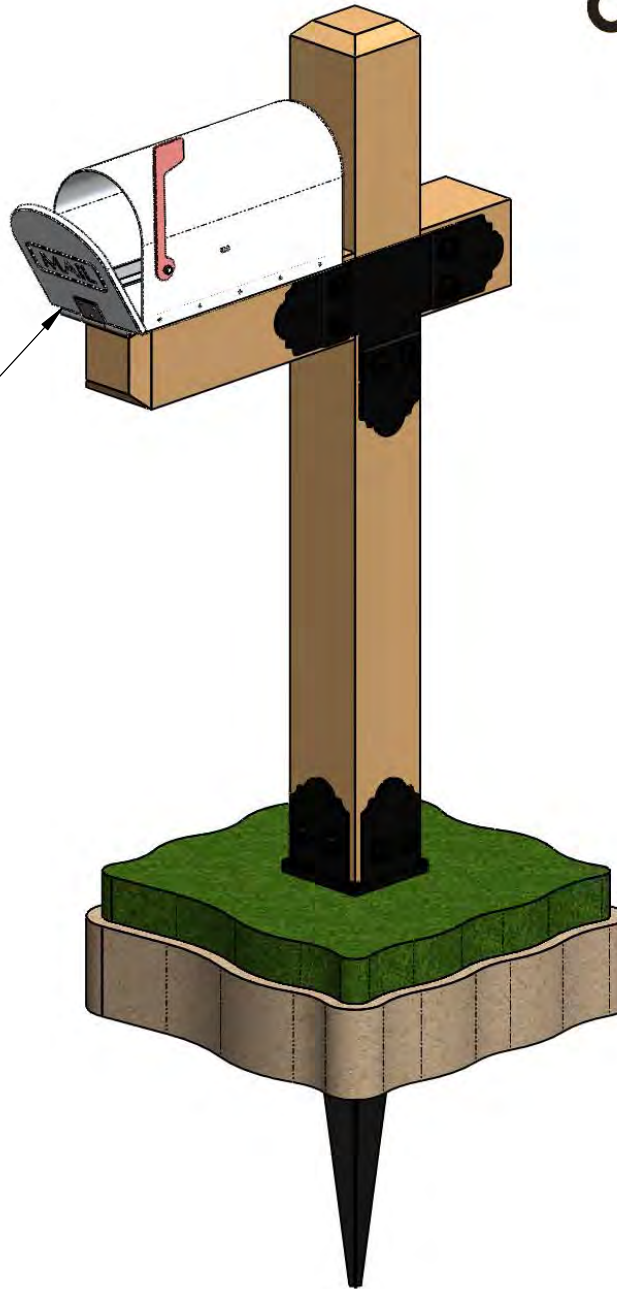

## step 4

### OZCO Project #110 - Estate Wooden Mailbox Post Assembly

V1.00 - Installation Instructions effective May 1, 2015 and reflects information that available as of April 10, 2014. This information is updated periodically and should not be relied upon after May 1, 2015. Please visit [www.OZCOBP.com](http://www.OZCOBP.com) to get current information