

**DESIGN**

**PURCHASE**

**CONSTRUCT**

**ENJOY**

## OZCO Project #770 - Modern Pergola Dropped Shade

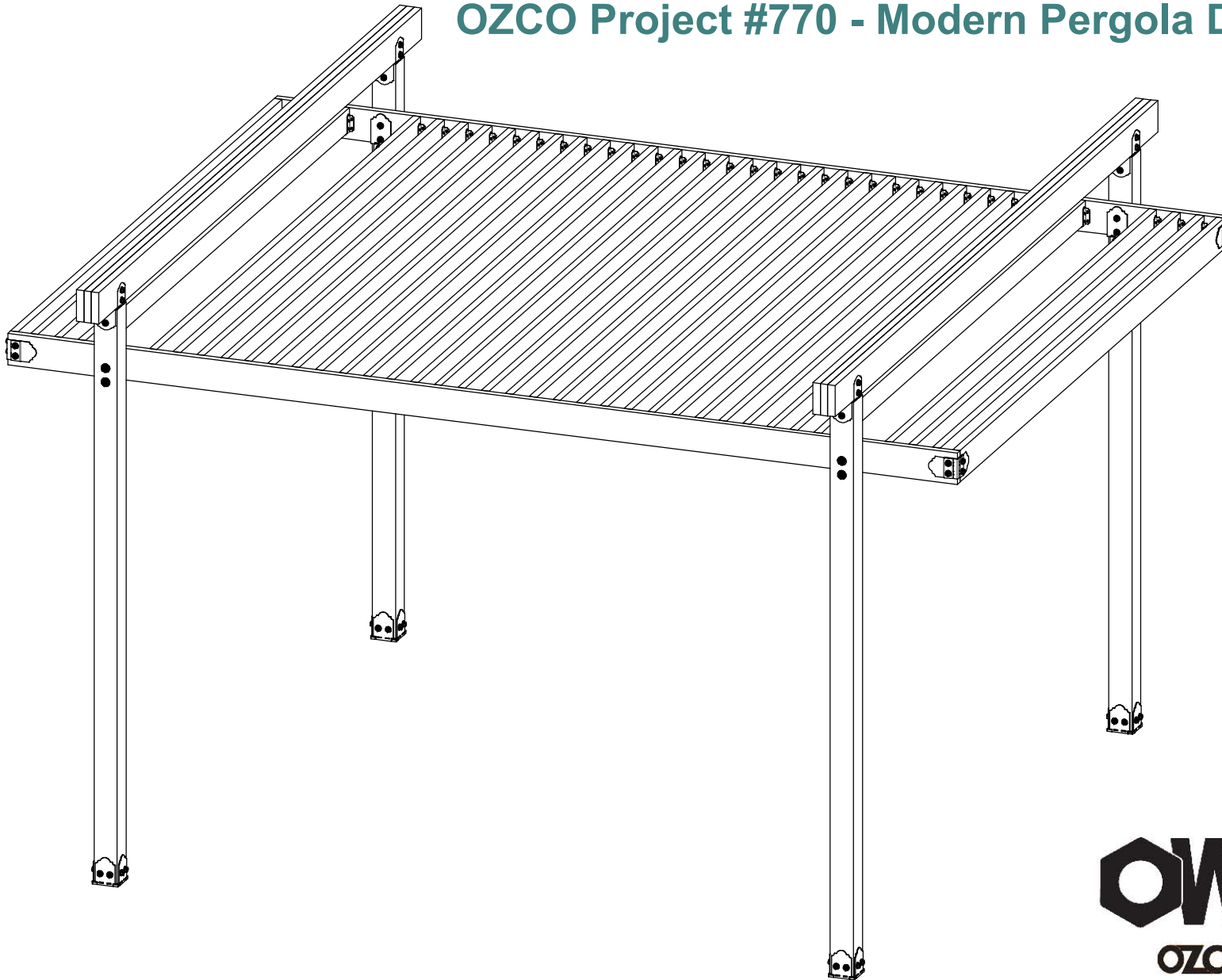

**OZCO Project #770 - Modern Pergola  
Dropped Shade**



**OZCO** BUILDING PRODUCTS ■ ■ ■

V2.00 - Installation Instructions, Specifications and Project Plans are effective 12/29/2018. This information is updated periodically and should not be relied upon after 2 years from 12/29/2018. Please visit [OZCOBP.com](http://OZCOBP.com) to get current information.



# Printing Documents from ISSUU

Unfortunately, there is currently no way to print content directly through issuu. To print a publication, you will need to download it and print it from your computer.

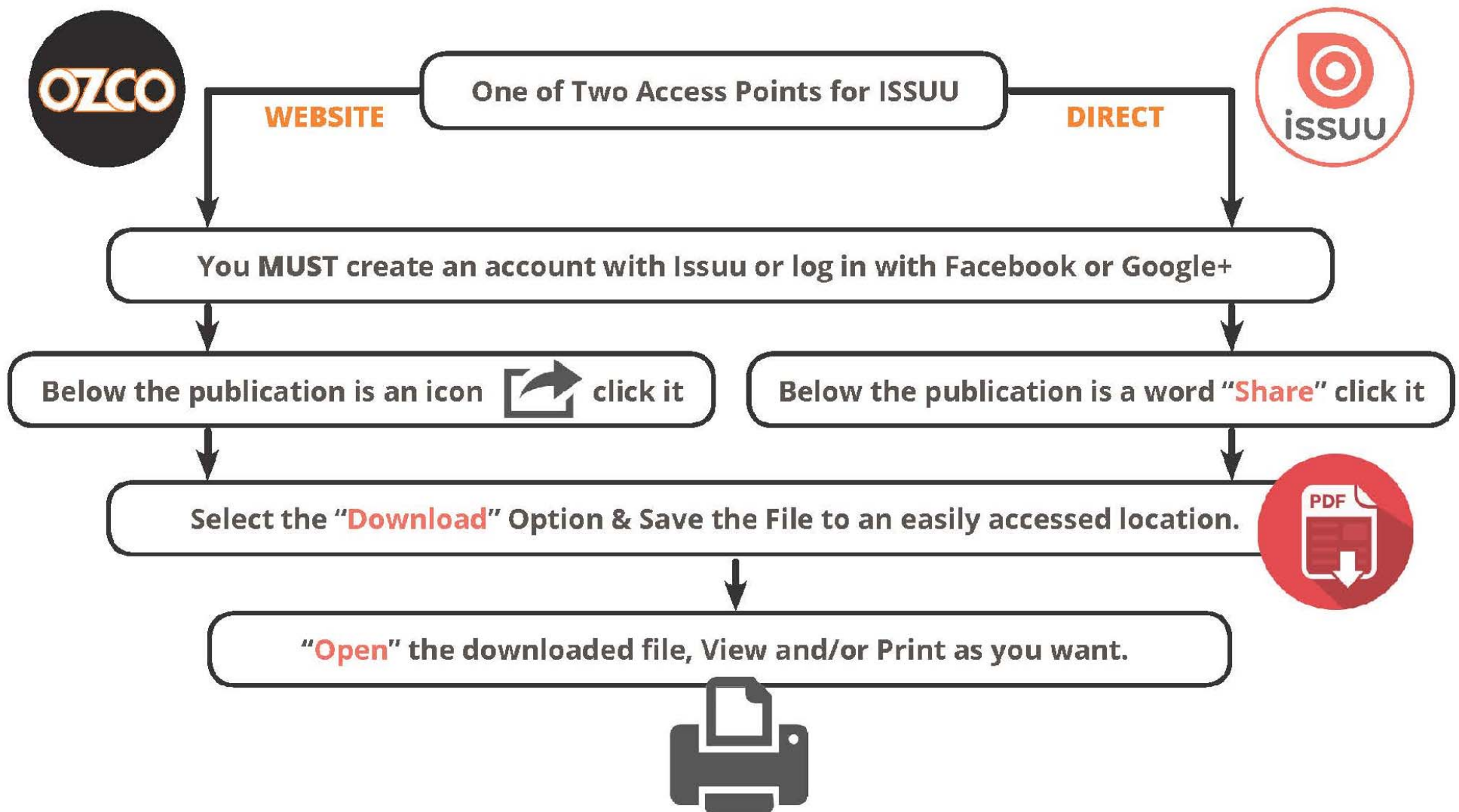

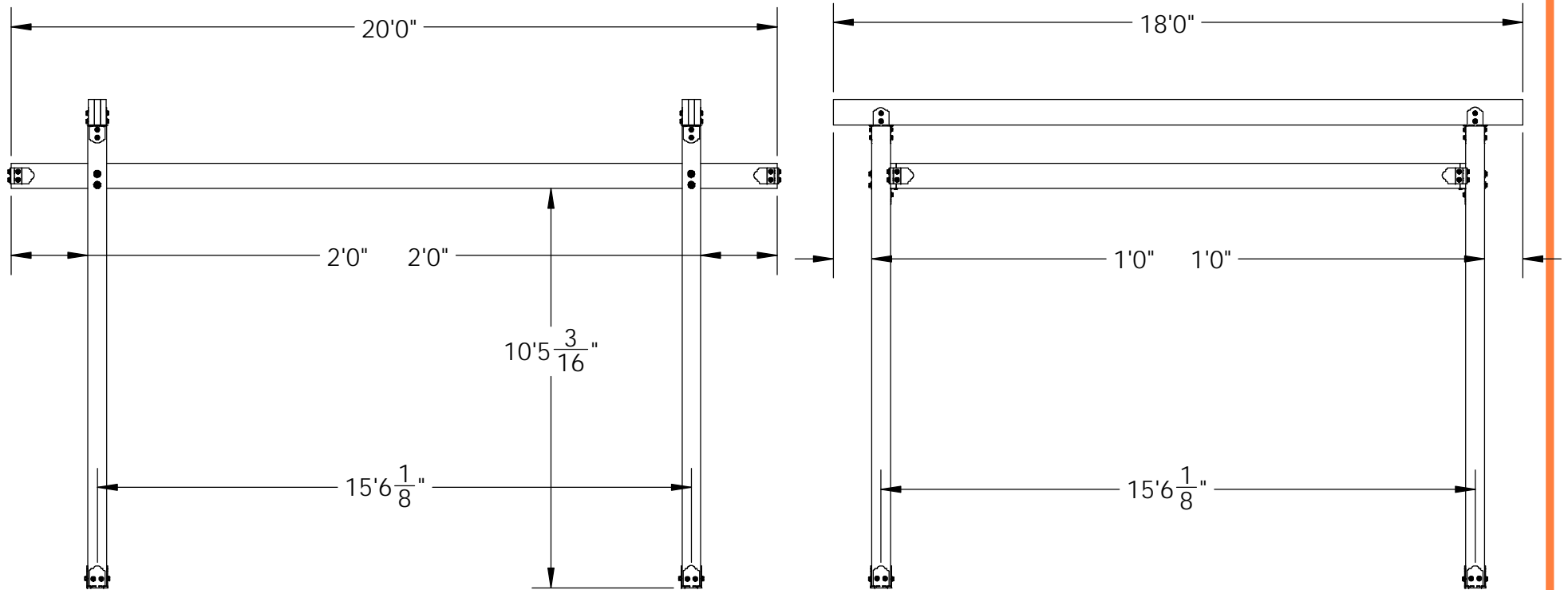

## Overview

**OZCO Project #770 - Modern Pergola  
Dropped Shade**

V2.00 - Installation Instructions, Specifications and Project Plans are effective 12/29/2018 . This information is updated periodically and should not be relied upon after 2 years from 12/29/2018 . Please visit [OZCOBP.com](http://OZCOBP.com) to get current information.

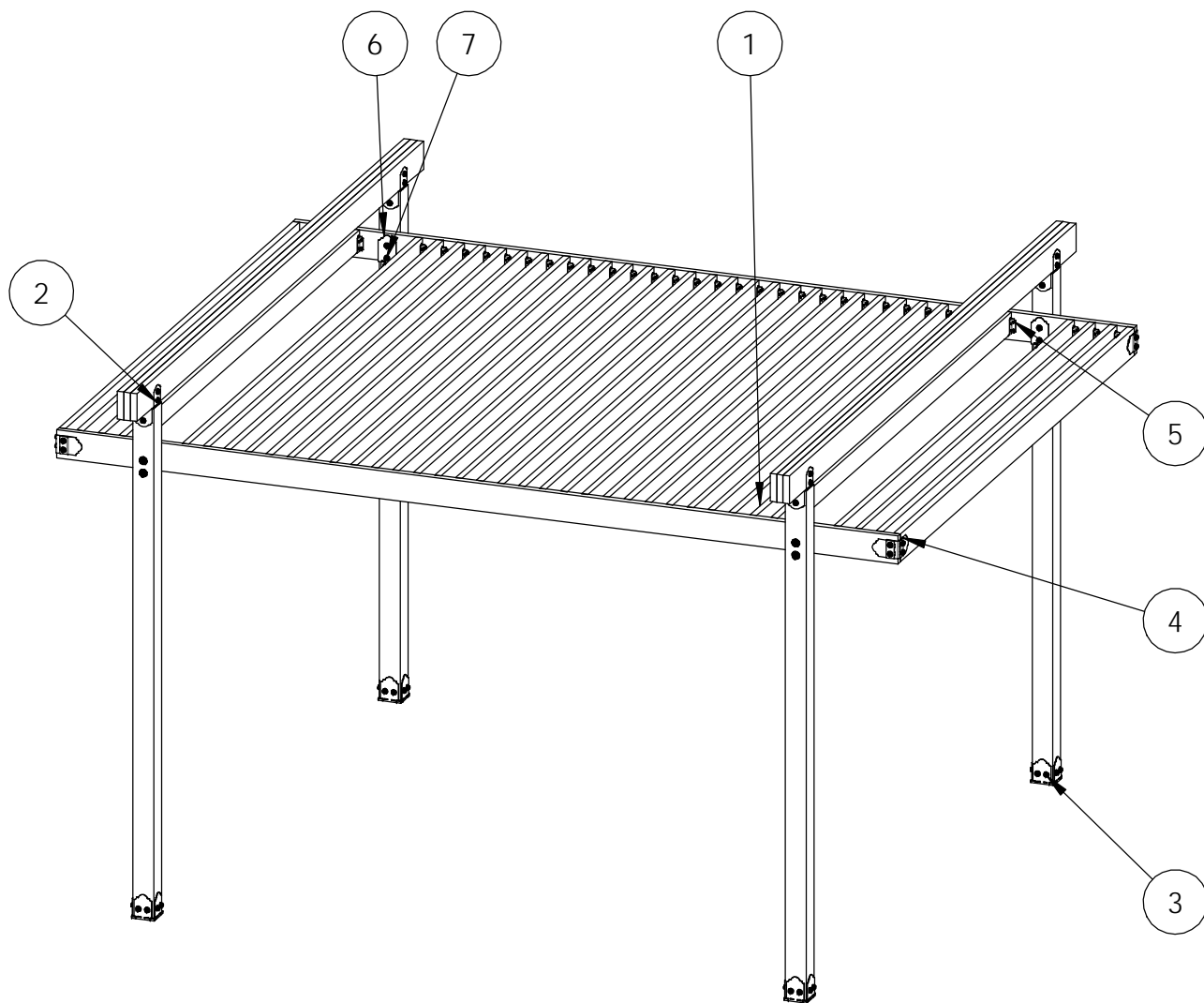

ITEM NO.	QTY.	PART NUMBER	DESCRIPTION
1	1	OZCO Project #770 - Modern Pergola Dropped Shade	see cutlist
2	4	56679	6x6 Column Cap (6X6-CAP-LS)
3	4	56608	6x6 Post Base Kit (6X6-PB-LS)
4	2	56615	Flush Inside 90 (FI-90)
	4	56611	Truss Accent (TA-LS)
	1	56625	Screw, OWT 1-3/4" (45mm) Timber
5	12	56639	6-8" Joist Hanger Flush (JHF-68-LS)
6	2	56637	Post to Beam Bolt Inline (P2B-BI-LS)
7	8	56651	OWT Timber Bolt 8-10"
	4	56680	2" Timber Bolt Heavy Duty Washer (OWT-TBW-2)

## Bill of Material

OZCO Project #770 - Modern Pergola  
Dropped Shade

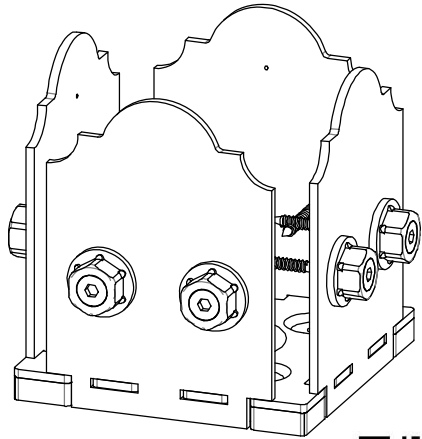

56608

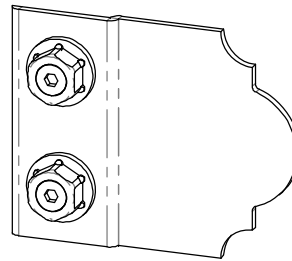

56611

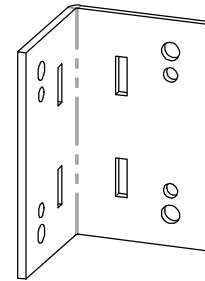

56615

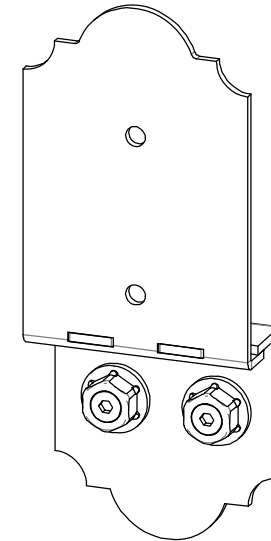

56637

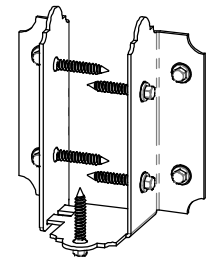

56639

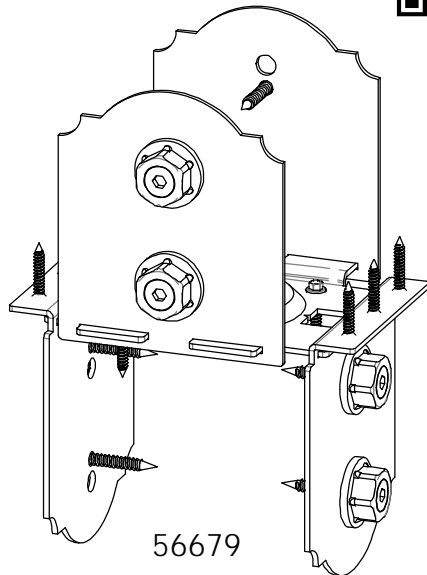

56679

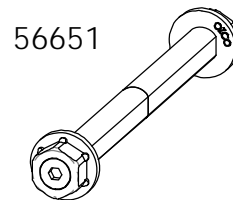

56651



56680



56625



DESIGN

PURCHASE

CONSTRUCT

ENJOY

# Laredo Sunset & Ironwood



Laredo Sunset  
(566XX series)

2 great styles  
Same functionality

choose your  
connection lifestyle

both styles available for  
most products

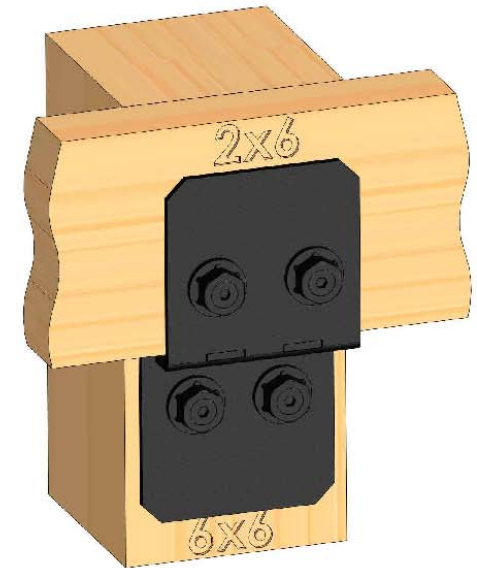

Ironwood  
(517XX series)



**OZCO** BUILDING PRODUCTS



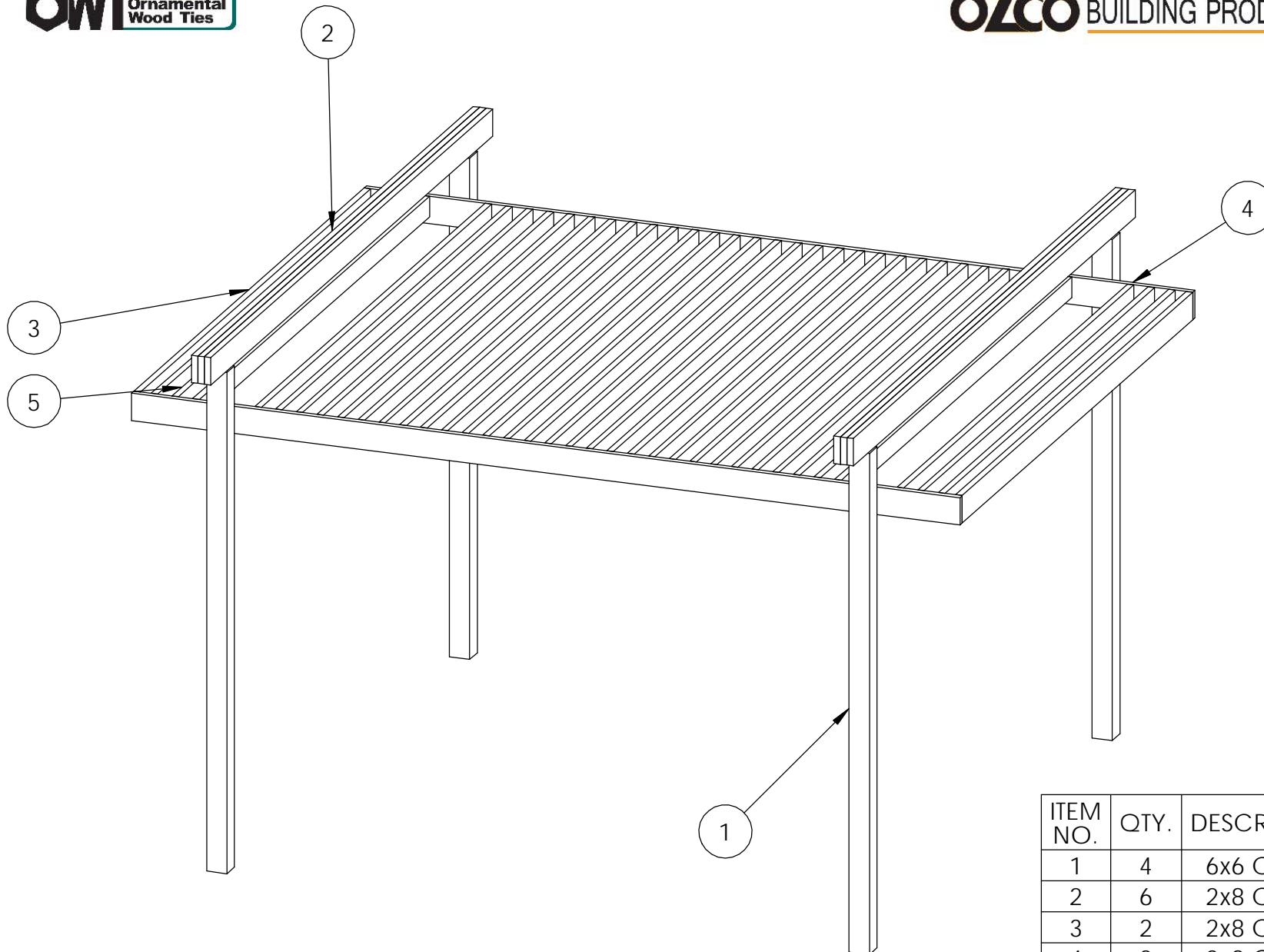

ITEM NO.	QTY.	DESCRIPTION	LENGTH
1	4	6x6 Cedar	12'
2	6	2x8 Cedar	18'
3	2	2x8 Cedar	14'8 1/2"
4	2	2x8 Cedar	20'
5	35	2x6 Cedar	14'8 1/2"

## Cutlist

**OZCO Project #770 - Modern Pergola  
Dropped Shade**

V2.00 - Installation Instructions, Specifications and Project Plans are effective 12/29/2018 . This information is updated periodically and should not be relied upon after 2 years from 12/29/2018 . Please visit [OZCOBP.com](http://OZCOBP.com) to get current information.

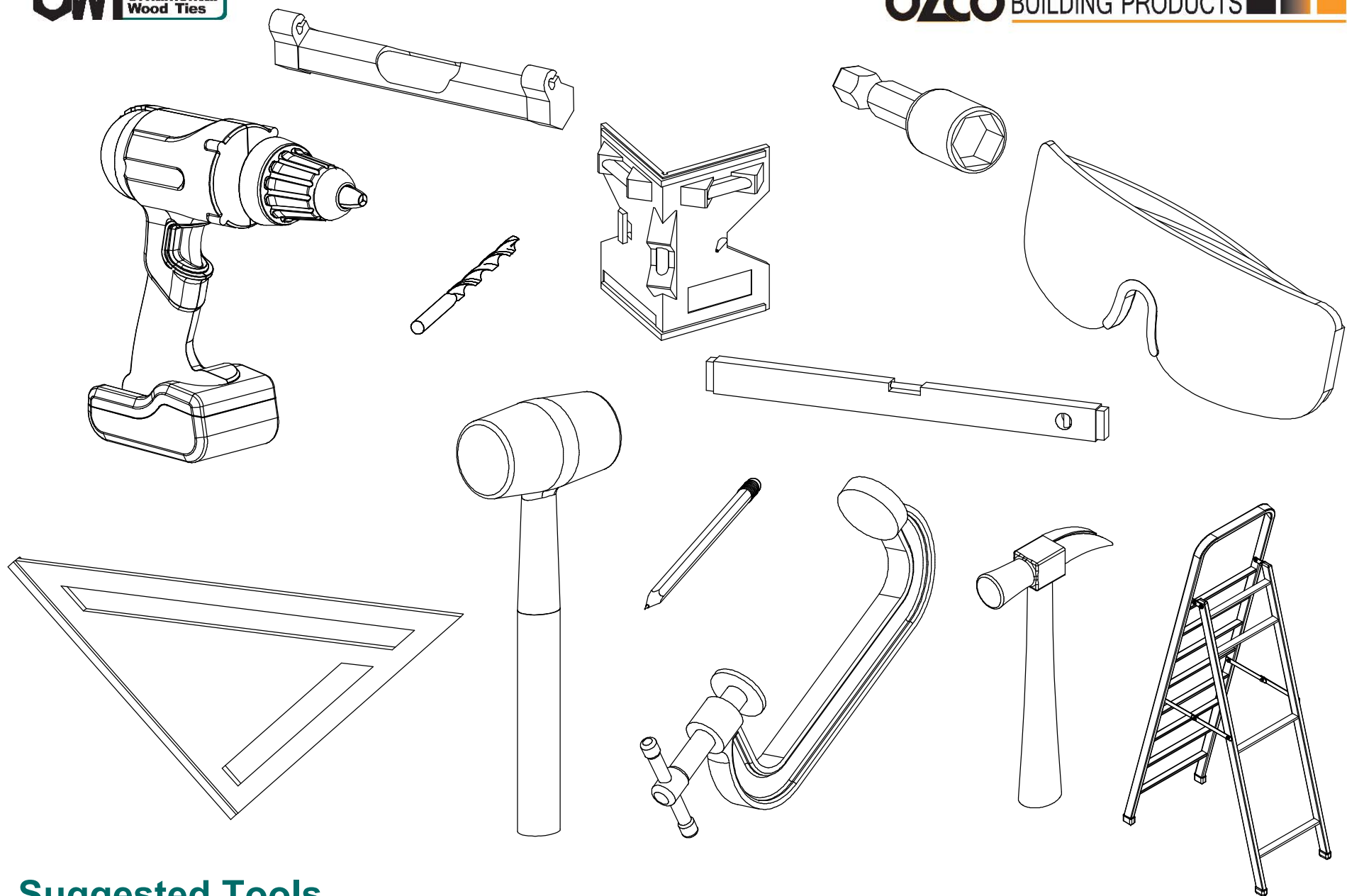

## Suggested Tools

(others may be required)

**OZCO Project #770 - Modern Pergola  
Dropped Shade**



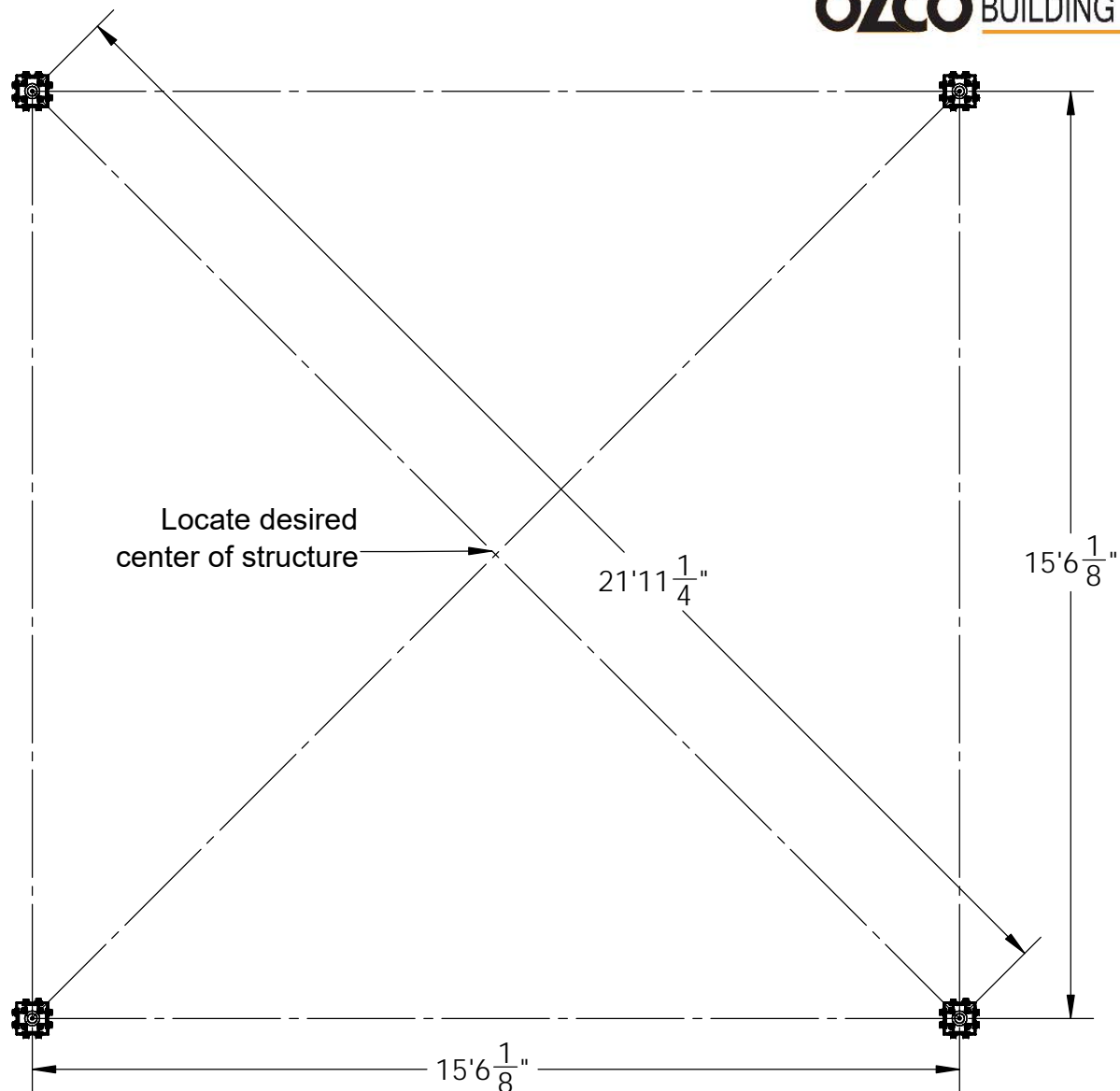

if site is not level, see Ozco Site Leveling instruction

## step 1



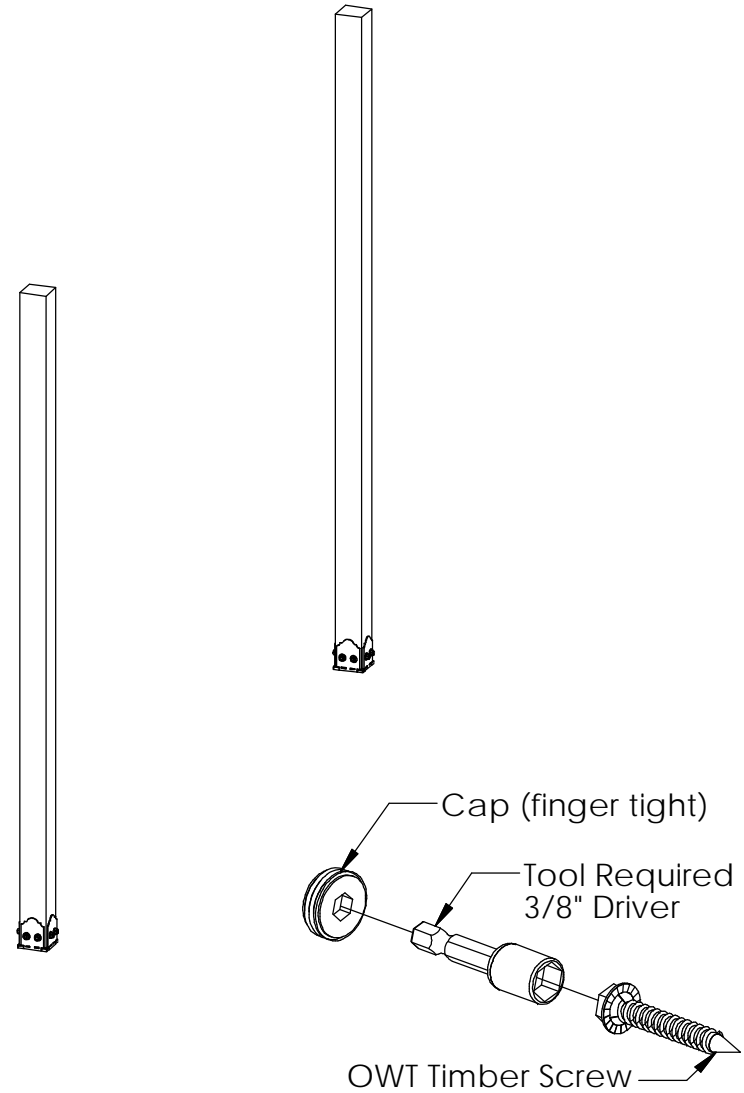
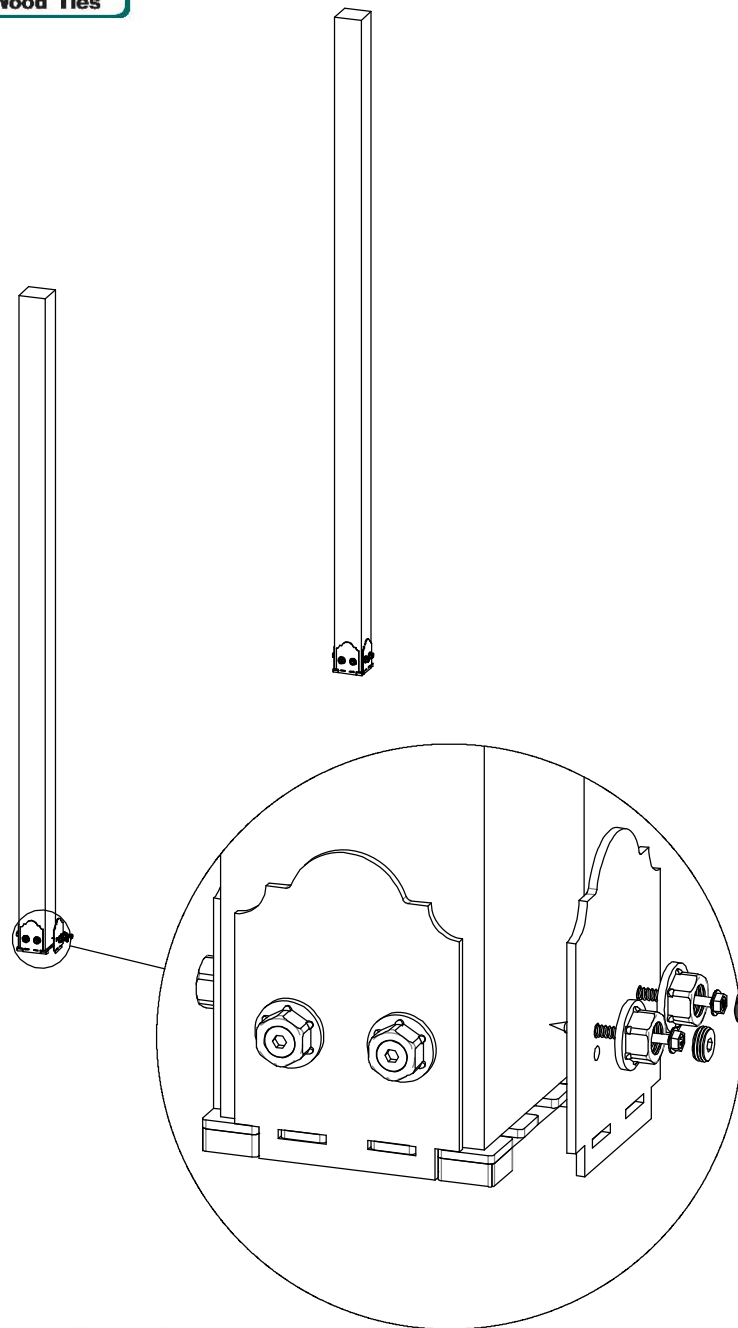

## step 2

**OZCO Project #770 - Modern Pergola  
Dropped Shade**

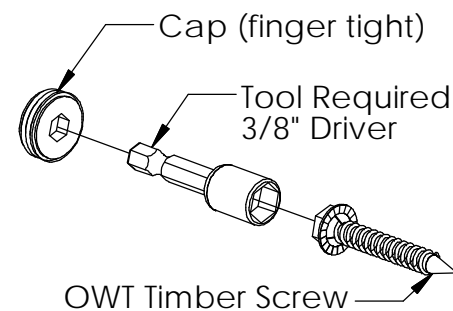
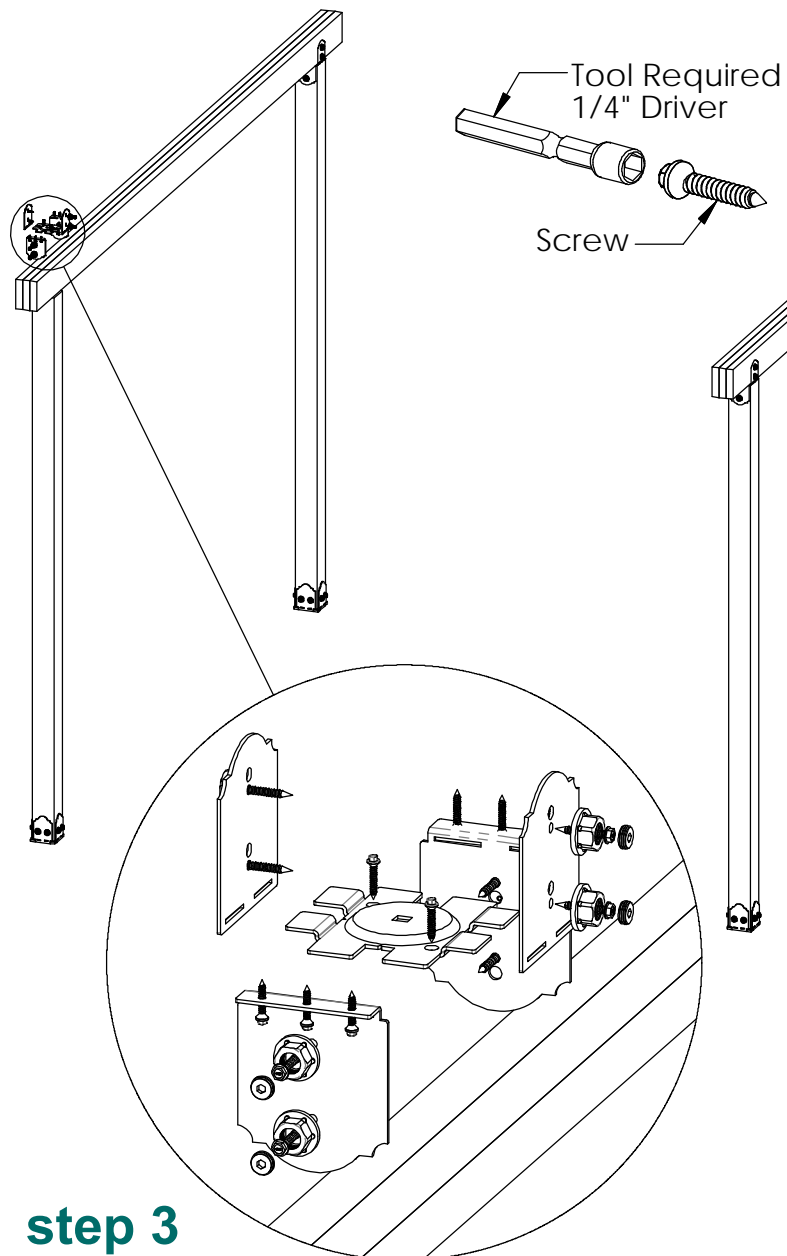

### step 3

**OZCO Project #770 - Modern Pergola  
Dropped Shade**

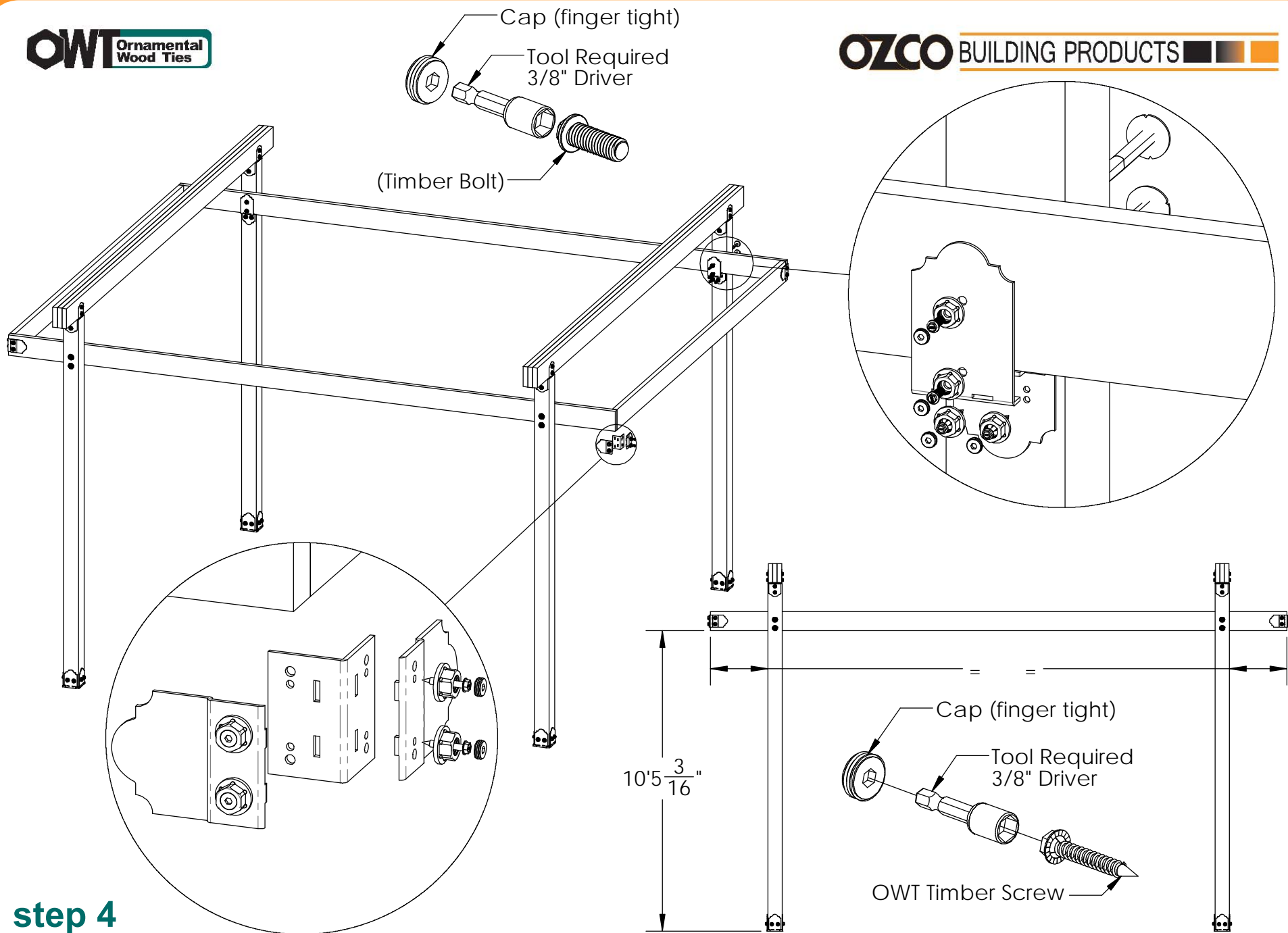

## step 4

**OZCO Project #770 - Modern Pergola  
Dropped Shade**

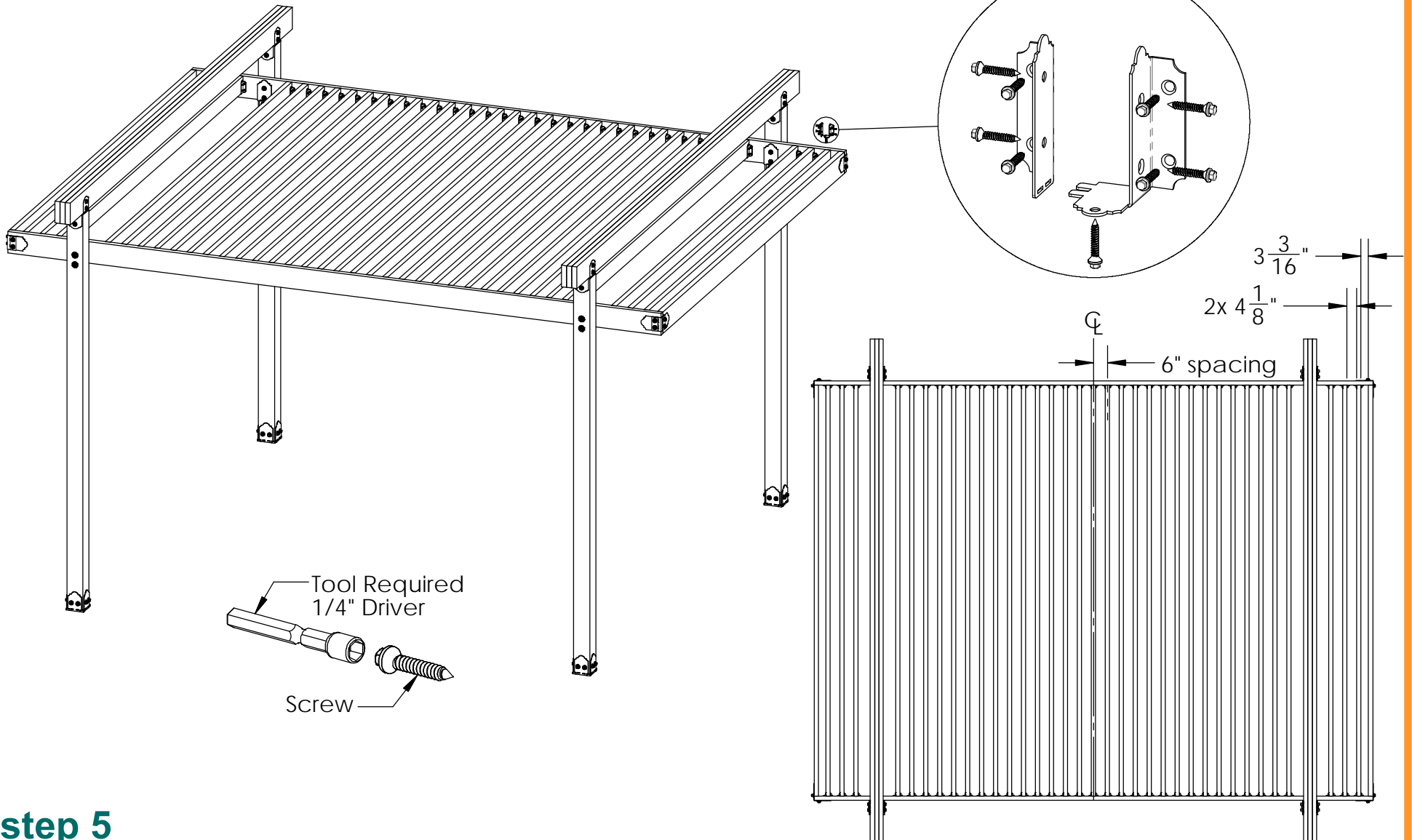

## step 5

OZCO Project #770 - Modern Pergola  
Dropped Shade



## Translucent

**OZCO Project #770 - Modern Pergola  
Dropped Shade**

V2.00 - Installation Instructions, Specifications and Project Plans are effective 12/29/2018 . This information is updated periodically and should not be relied upon after 2 years from 12/29/2018 . Please visit [OZCOBP.com](http://OZCOBP.com) to get current information.