

**DESIGN**

**PURCHASE**

**CONSTRUCT**

**ENJOY**

## OZCO Project #280 - Pergola with Overhang

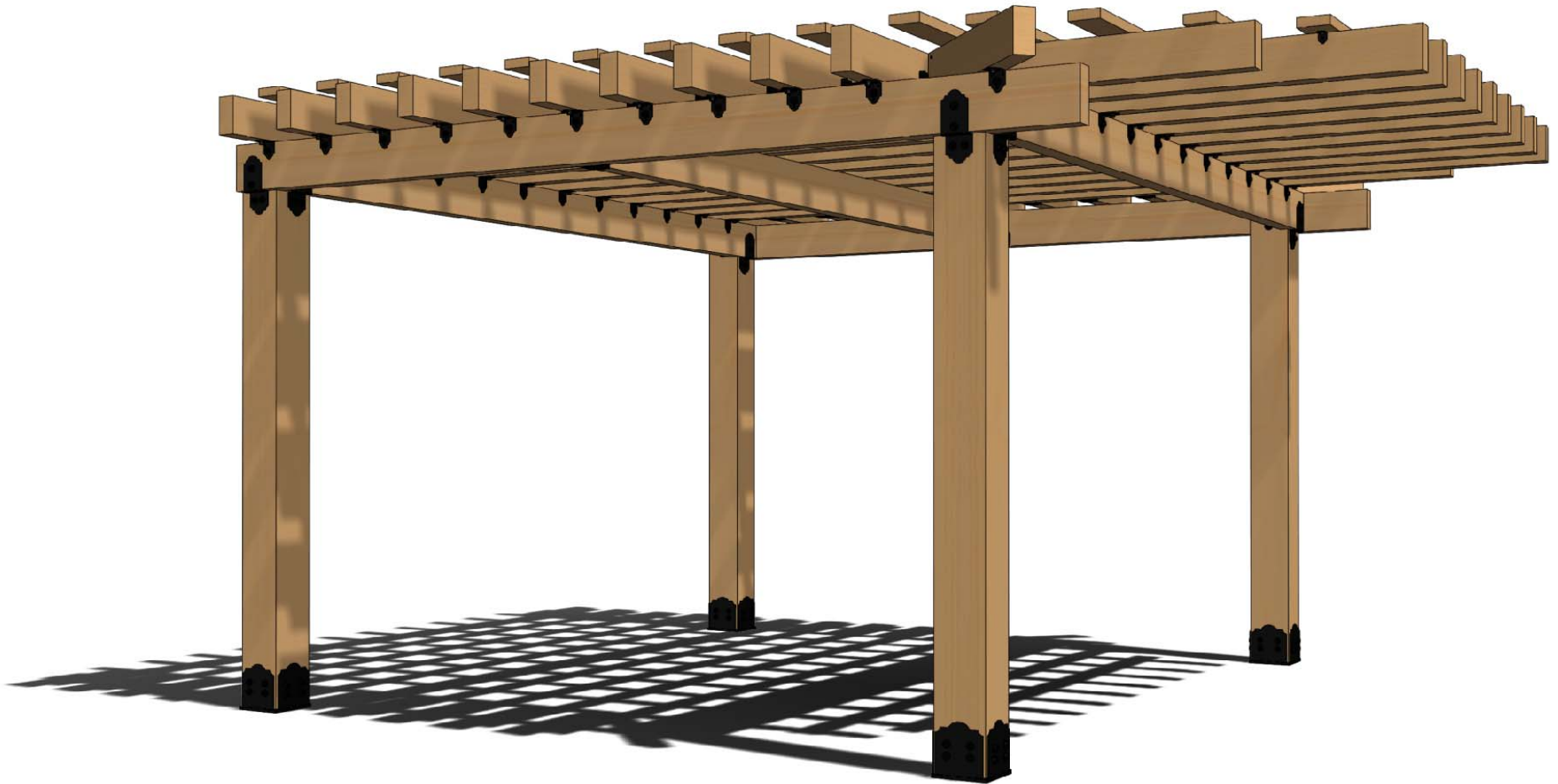

**OZCO** BUILDING PRODUCTS

OZCO Project #280 - Pergola with Overhang

V2.00 - Installation Instructions, Specifications and Project Plans are effective 3/21/2018 . This information is updated periodically 1 and should not be relied upon after 2 years from 3/21/2018 . Please visit [OZCOBP.com](http://OZCOBP.com) to get current information.



# Printing Documents from ISSUU

Unfortunately, there is currently no way to print content directly through issuu. To print a publication, you will need to download it and print it from your computer.

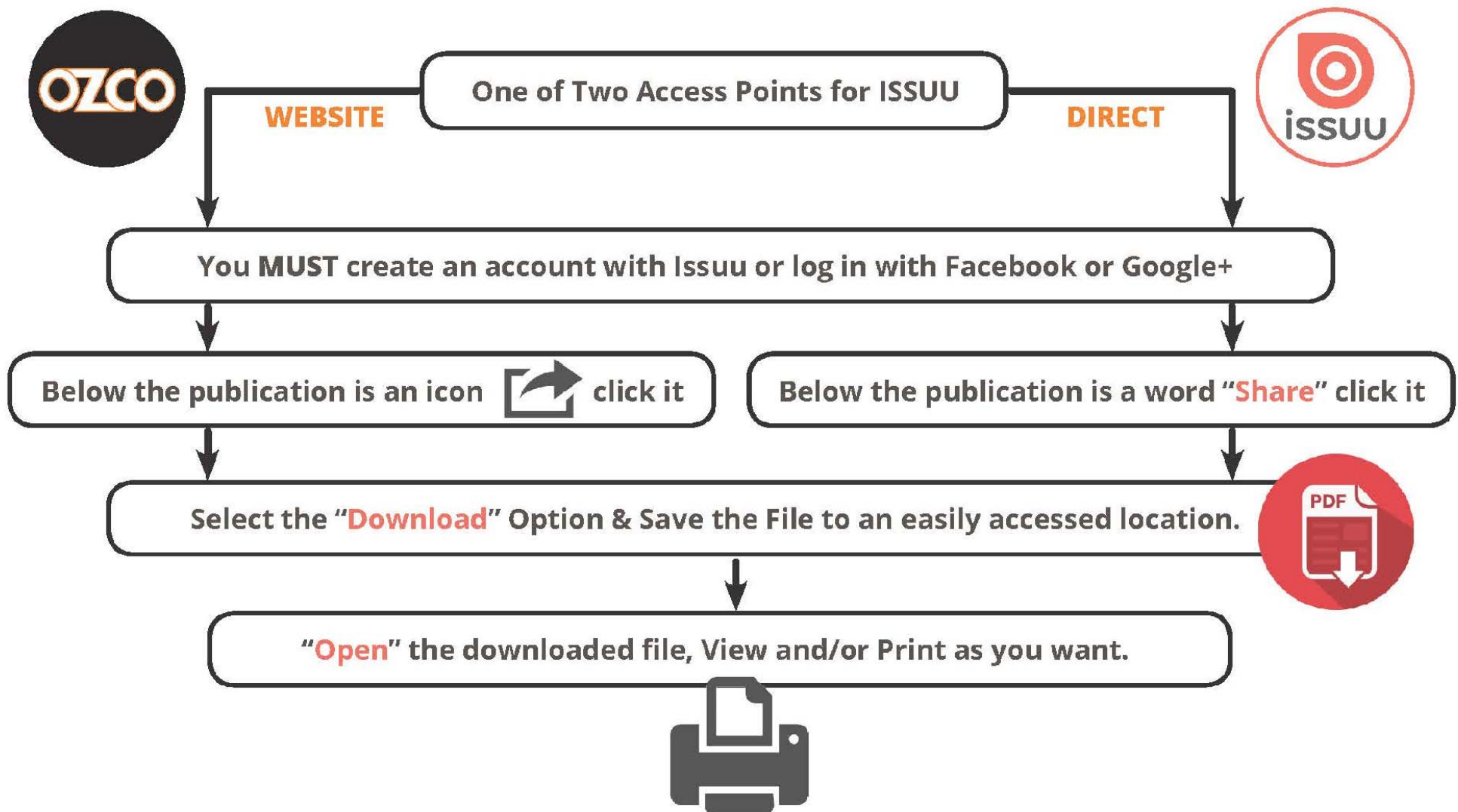

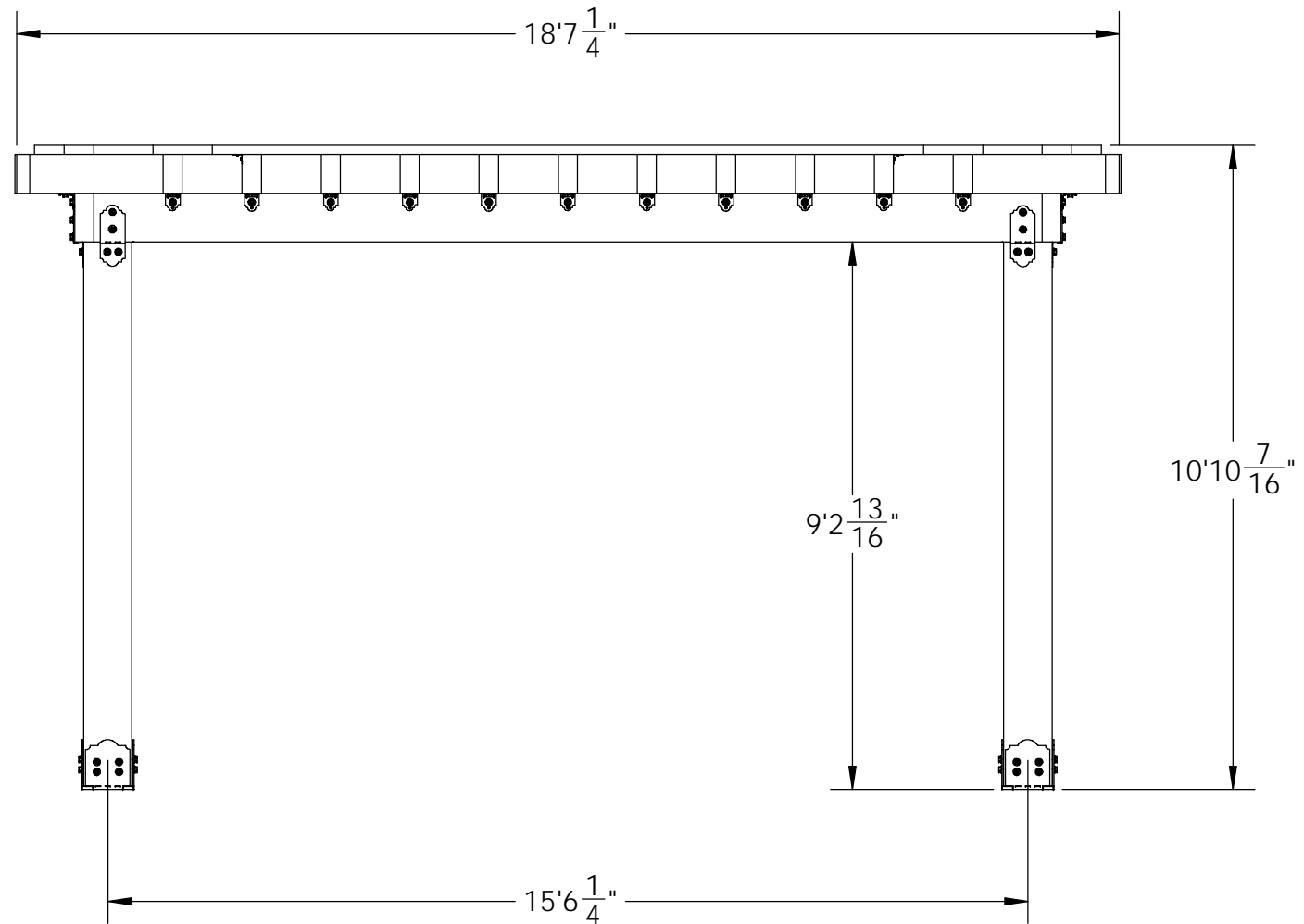

## Overview-Front

OZCO Project #280 - Pergola with Overhang

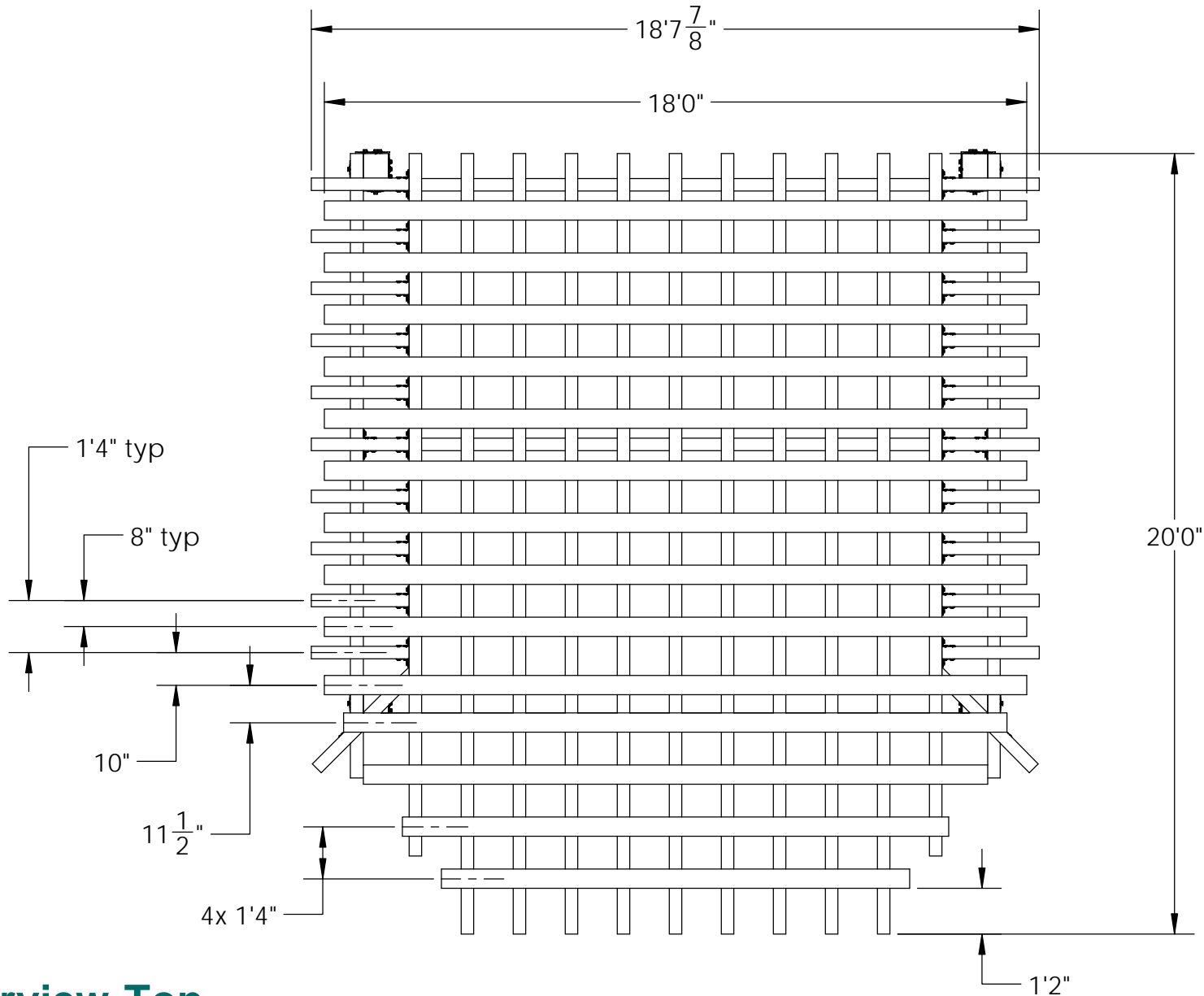

## Overview-Top

OZCO Project #280 - Pergola with Overhang

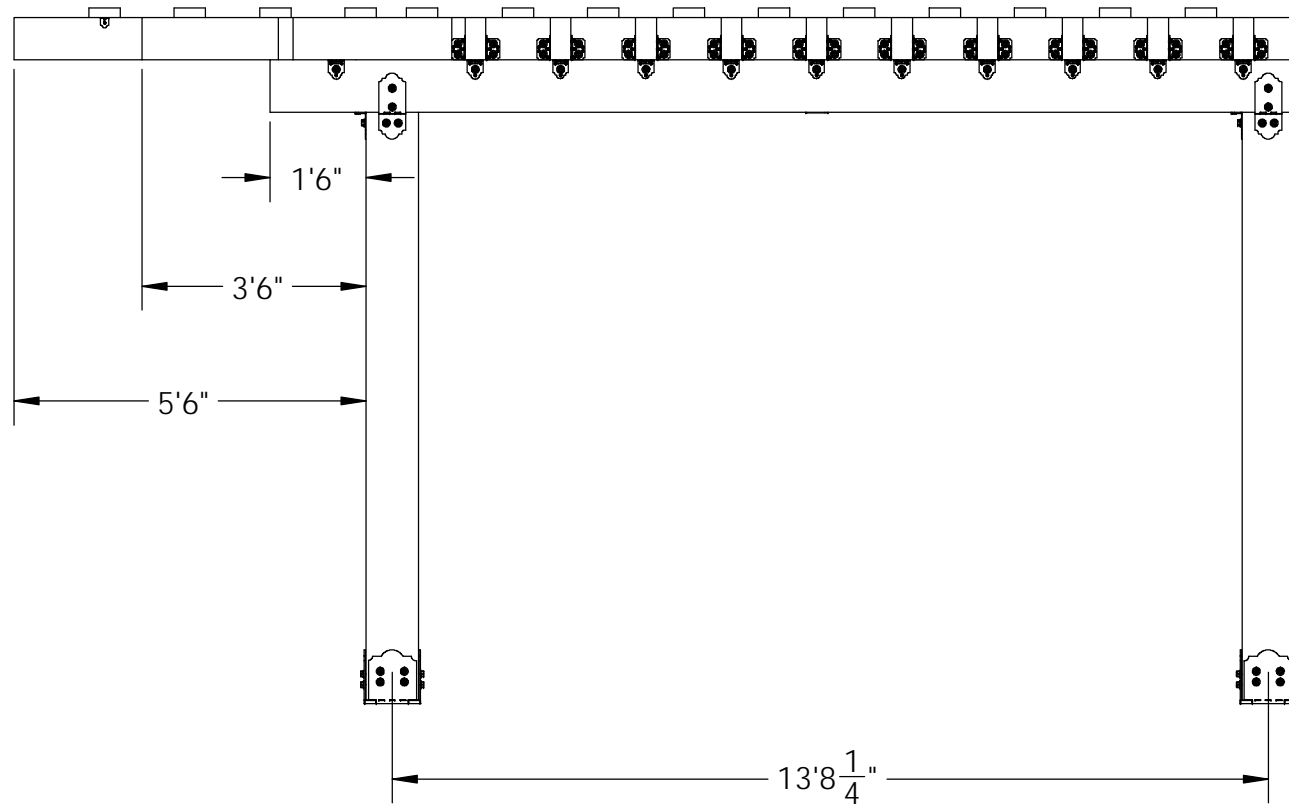

## Overview-Right

OZCO Project #280 - Pergola with Overhang

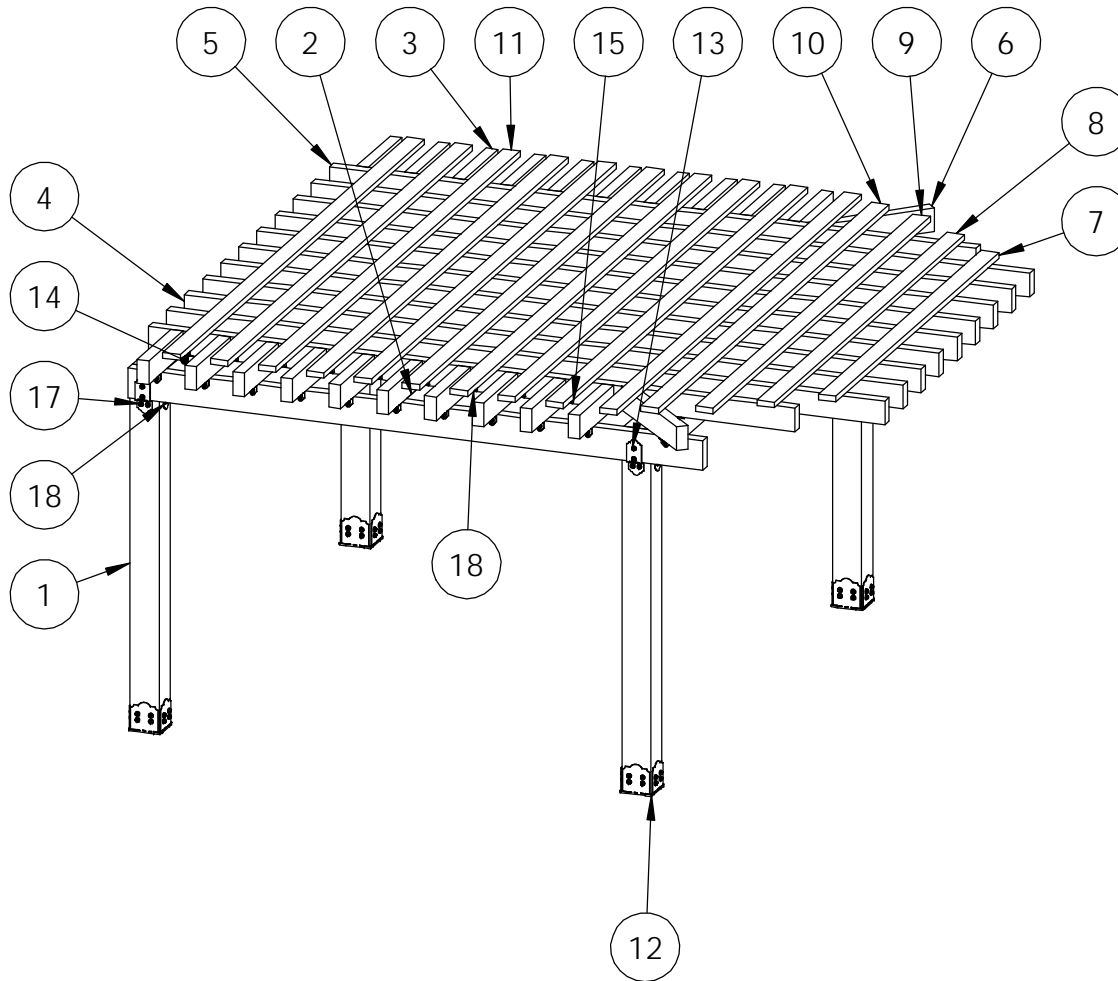

ITEM NO.	QTY.	PART NUMBER	DESCRIPTION
1	4	10x10 Cedar Post	10x10x10'0"
2	5	4x10 Cedar Board	4x10x16'0"
3	20	4x8 Cedar Board	4x8x2'6"
4	9	4x8 Cedar Board	4x8x20'0"
5	2	4x8 Cedar Board	4x8x18'0"
6	2	4x8 Cedar Board	4x8x3'6"
7	1	2x6 Cedar Board	2x6x12'0"
8	1	2x6 Cedar Board	2x6x14'0"
9	1	2x6 Cedar Board	2x6x16'0"
10	1	2x6 Cedar Board	2x6x17'0"
11	10	2x6 Cedar Board	2x6x18'0"
12	4	56605	10x10 Post Base (10x10-PB-LS)
13	8	56652	OWT Timber Bolt 10-12"
	4	56680	2" Timber Bolt Heavy Duty Washer (OWT-TBW-2)
14	5	56618	4" Standard Rafter Clips (RC-LS-4)
15	6	56669	6-8" JOIST HANGER FLUSH
16	3	56617	2" Standard Rafter Clip (RC-LS-2)
17	2	56636	Post to Beam Bolt Offset (P2B-BO-LS)
18	2	56636	Post to Beam Bolt Offset (P2B-BO-LS)

## Bill of Material

OZCO Project #280 - Pergola with Overhang

QTY.	PART NUMBER	DESCRIPTION
4	56605	10x10 Post Base (10x10-PB-LS)
4	56636	Post to Beam Bolt Offset (P2B-BO-LS)
8	56652	OWT Timber Bolt 10-12"
4	56680	2" Timber Bolt Heavy Duty Washer (OWT-TBW-2)
5	56618	4" Standard Rafter Clip (RC-LS-4)
6	56669	6-8" JOIST HANGER FLUSH
3	56617	2" Standard Rafter Clip (RC-LS-2)
4	10x10x10L	10x10x10
5	4x10X16L	4x10X16
22	4x8X16L	4x8x16
9	4x8X20L	4x8x20
2	4x8X18L	4x8x18
1	2x6X12L	2x6x12
1	2x6X14L	2x6x14
1	2x6X16L	2x6x16
11	2x6X18L	2x6x18

## Material List

OZCO Project #280 - Pergola with Overhang

V2.00 - Installation Instructions, Specifications and Project Plans are effective 3/21/2018 . This information is updated periodically and should not be relied upon after 2 years from 3/21/2018 . Please visit [OZCOBP.com](http://OZCOBP.com) to get current information. 7

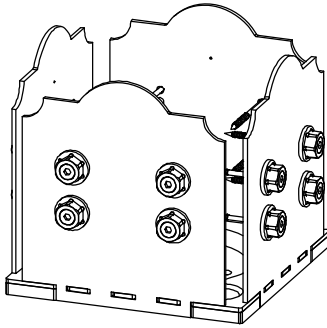

56605

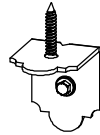

56617

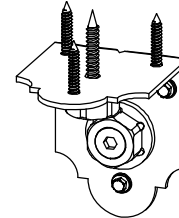

56618

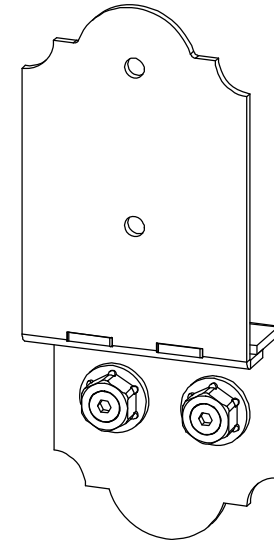

56636

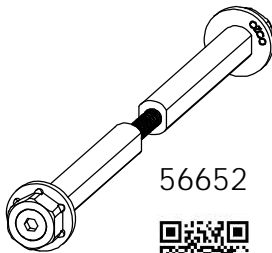

56652

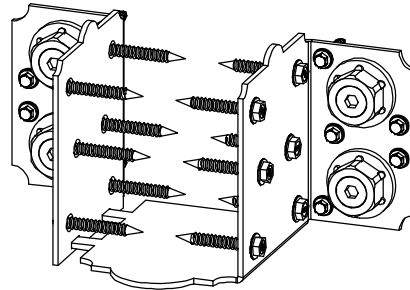

56669

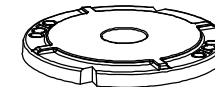

56680





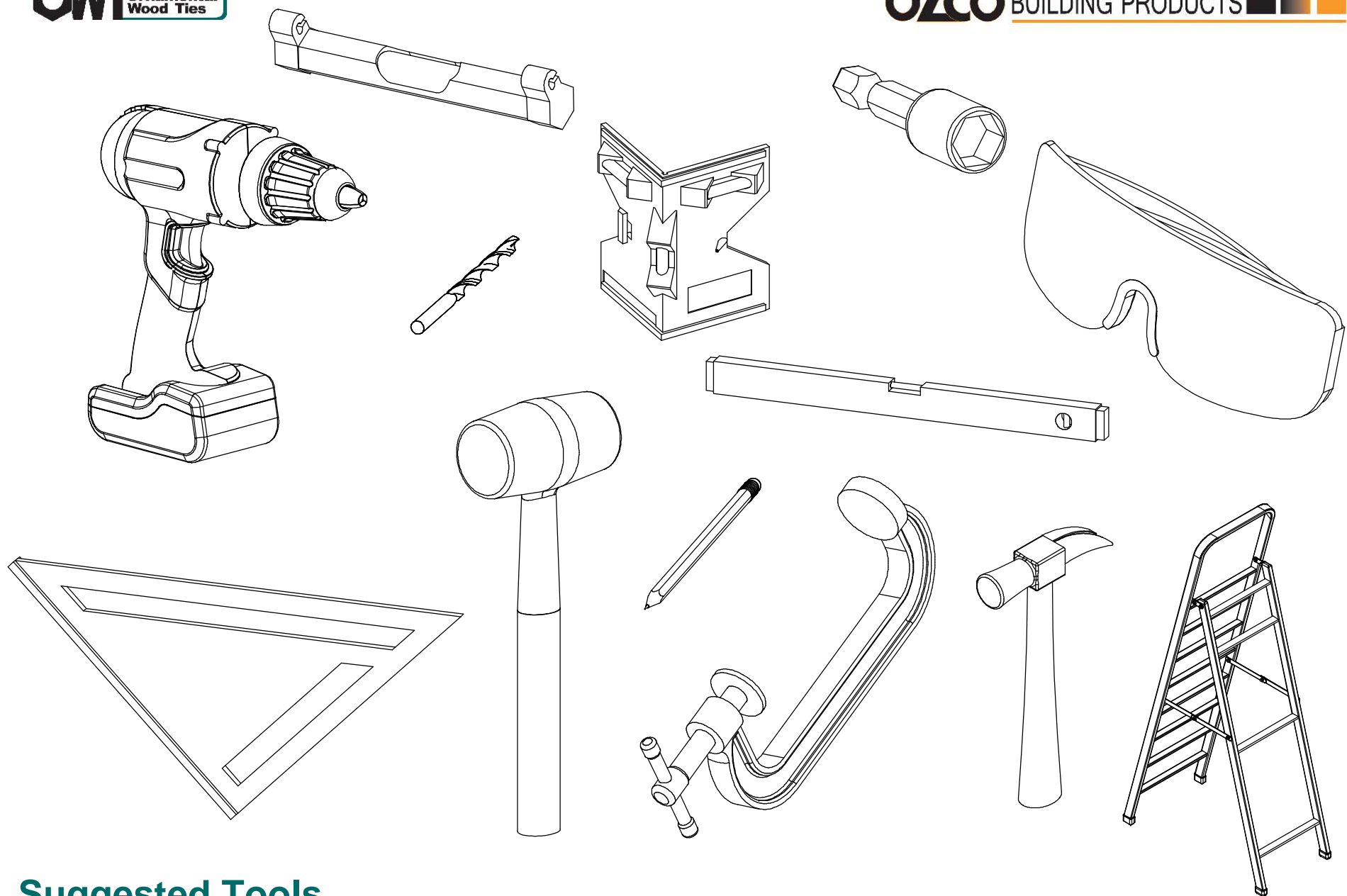

## Suggested Tools

(others may be required)

**OZCO Project #280 - Pergola with Overhang**

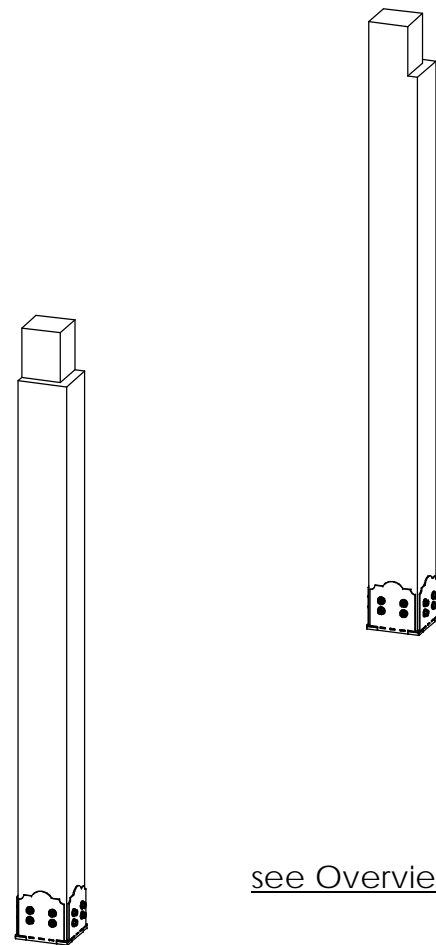

see Overview page for spacing

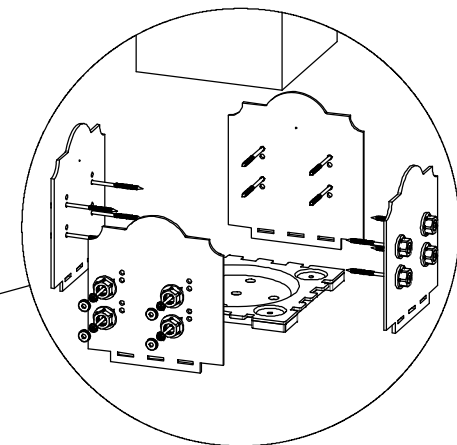
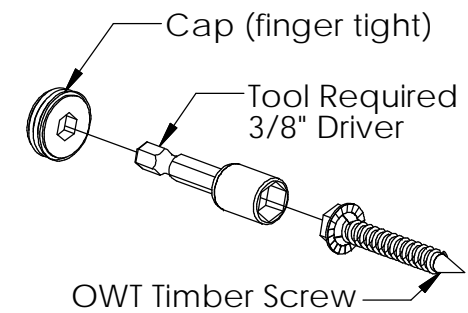
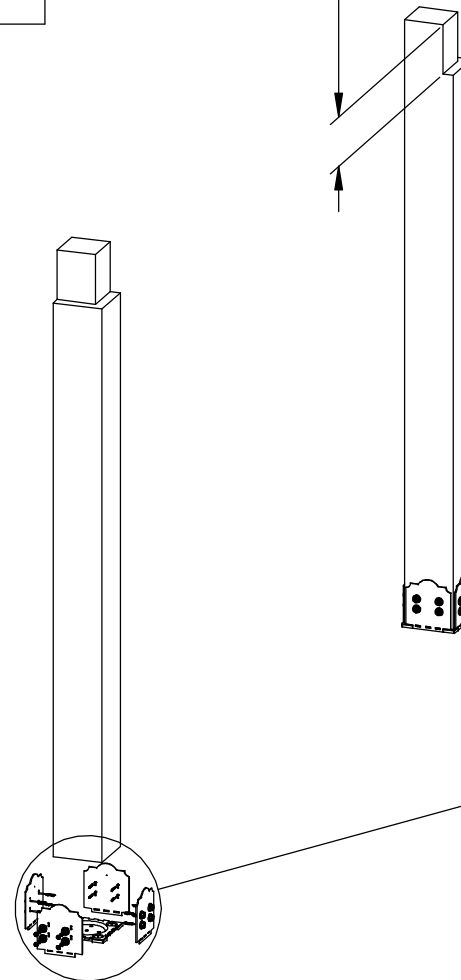
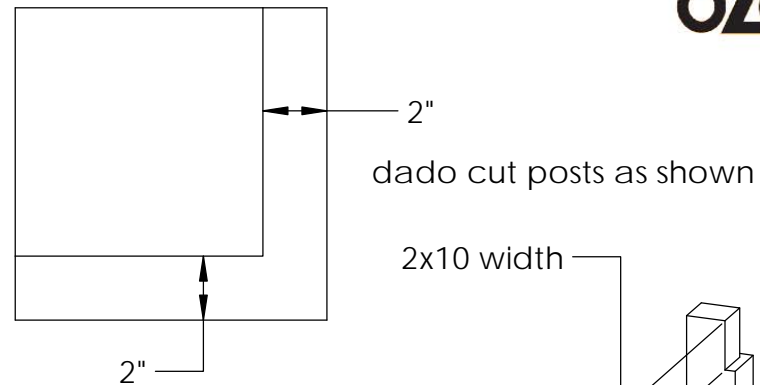

## step 1

OZCO Project #280 - Pergola with Overhang

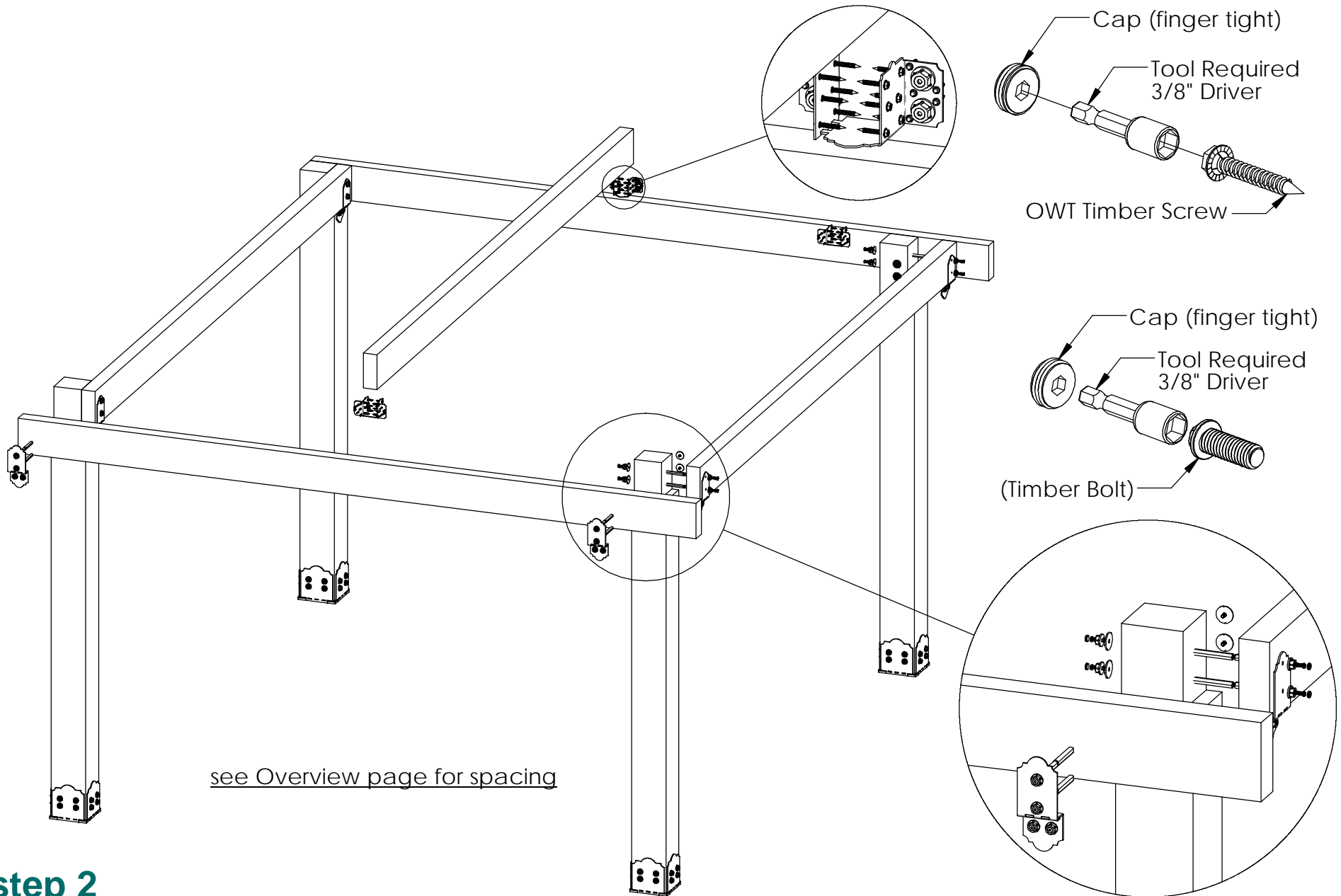

## step 2

OZCO Project #280 - Pergola with Overhang

see Overview page for spacing

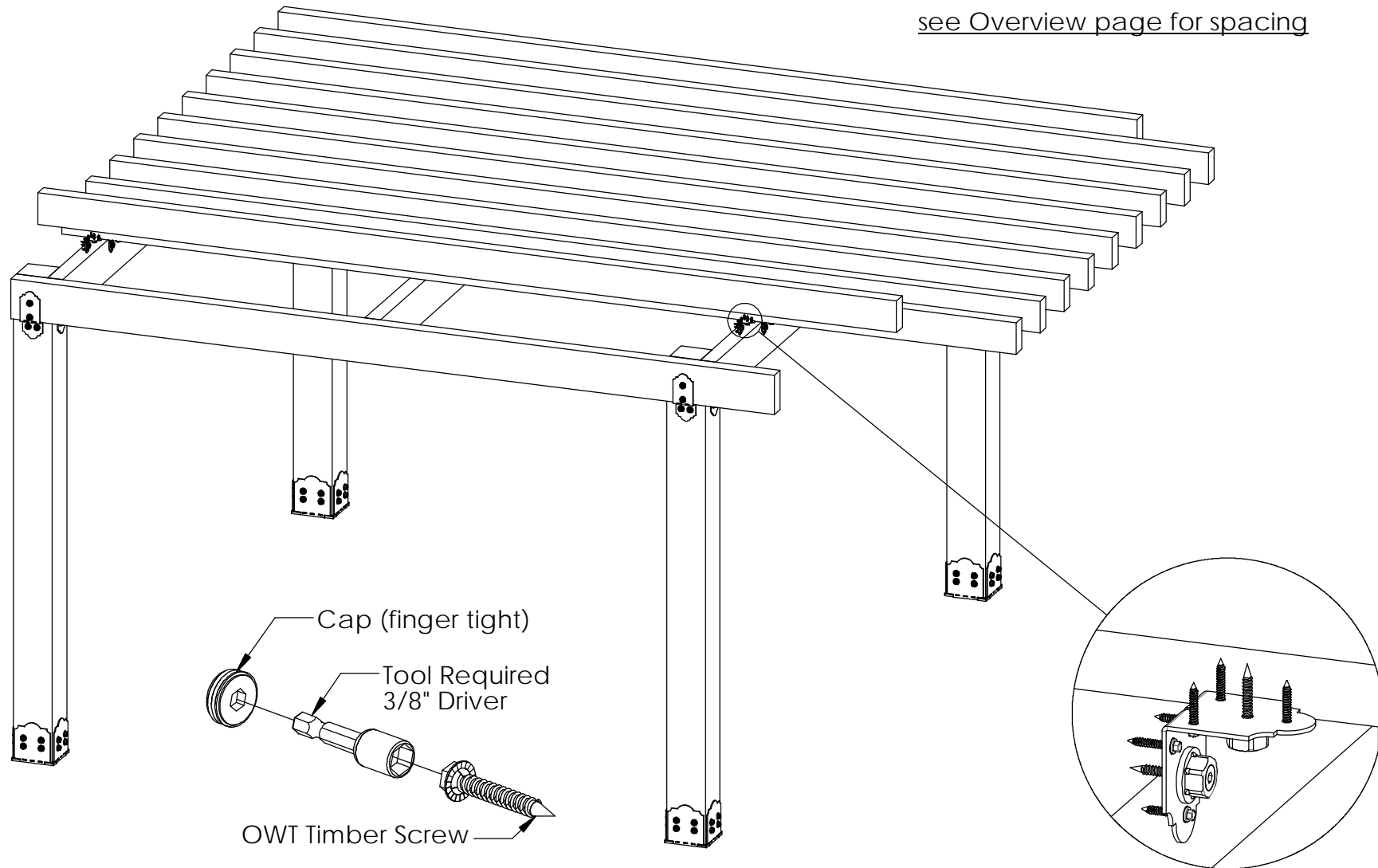

### step 3

OZCO Project #280 - Pergola with Overhang

V2.00 - Installation Instructions, Specifications and Project Plans are effective 3/21/2018 . This information is updated periodically and should not be relied upon after 2 years from 3/21/2018 . Please visit [OZCOBP.com](http://OZCOBP.com) to get current information.

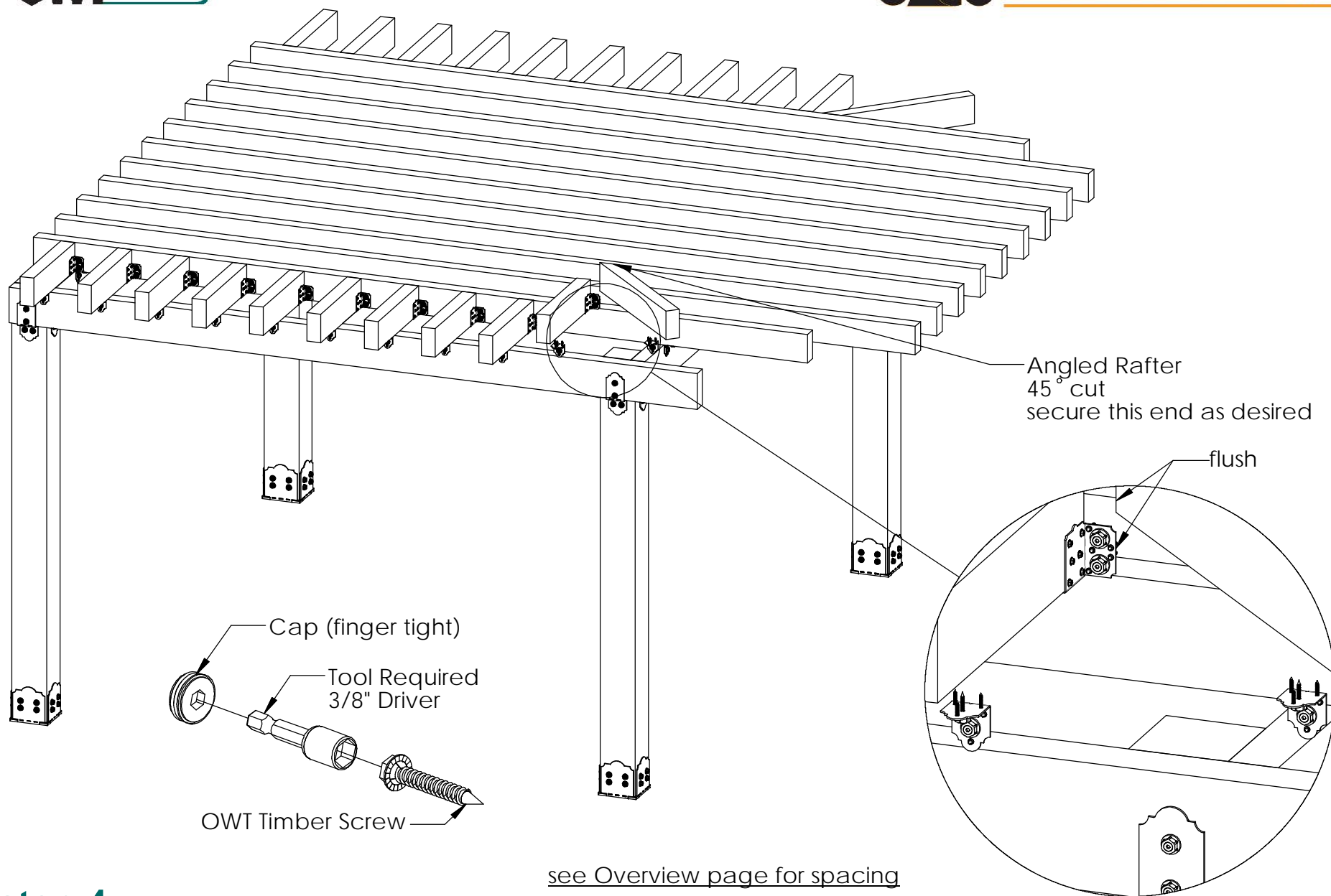

## step 4

OZCO Project #280 - Pergola with Overhang

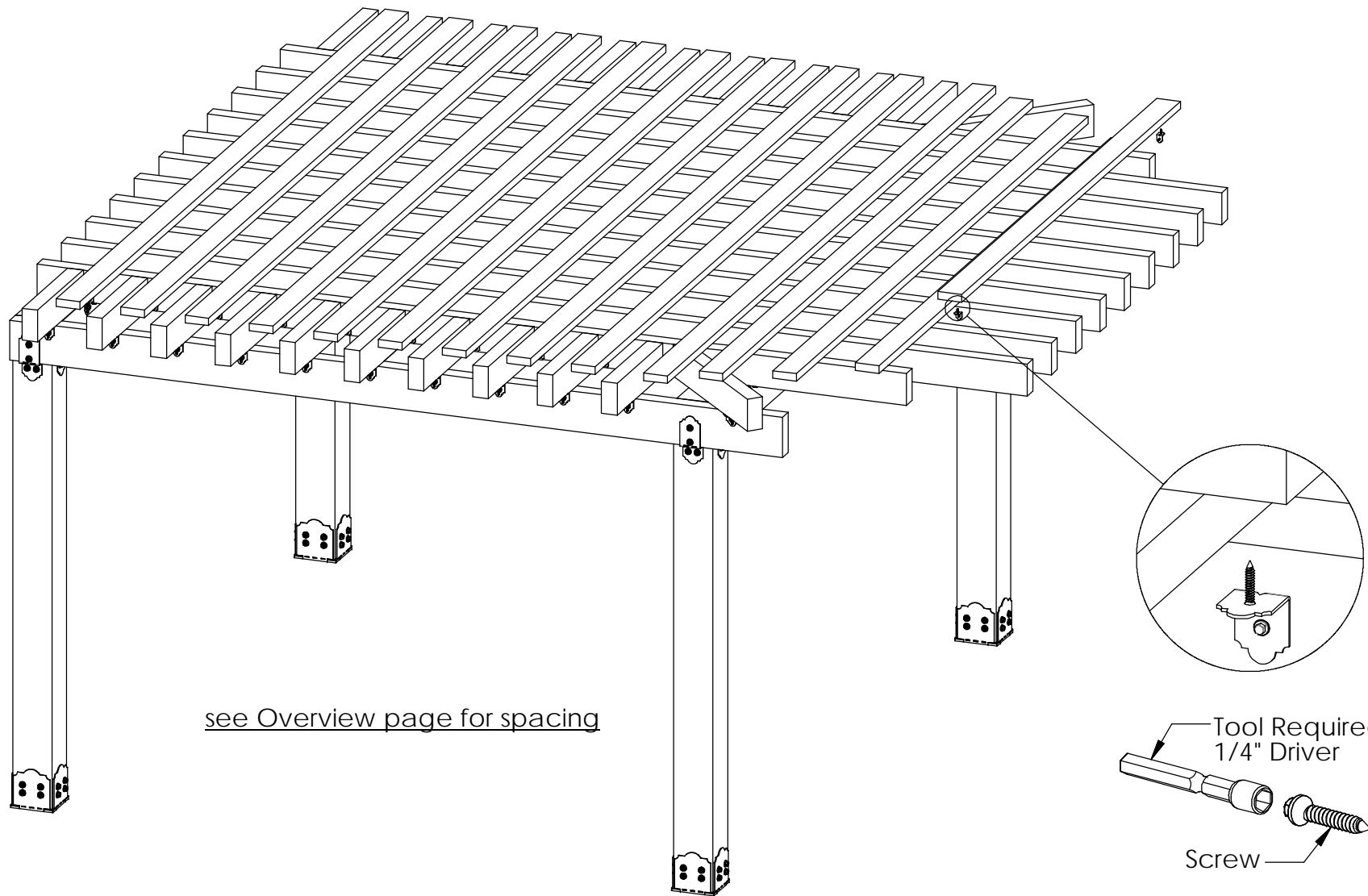

## step 5

OZCO Project #280 - Pergola with Overhang