

DESIGN

PURCHASE

CONSTRUCT

ENJOY

**OZCO Project #213 -
12x12 Pavilion
6x6 Posts**



roofing shown translucent for clarity



OZCO BUILDING PRODUCTS



Printing Documents from ISSUU

Unfortunately, there is currently no way to print content directly through issuu. To print a publication, you will need to download it and print it from your computer.

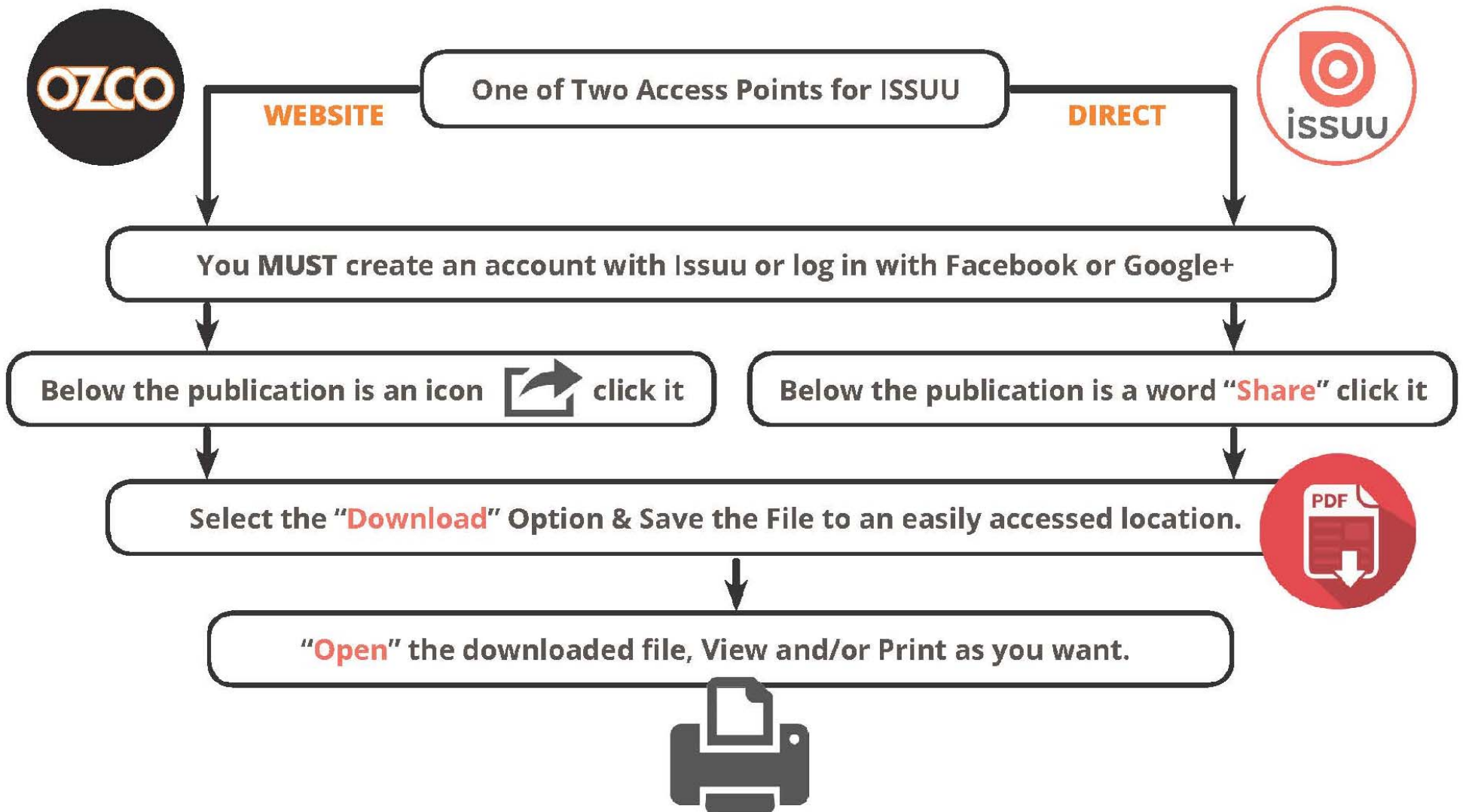

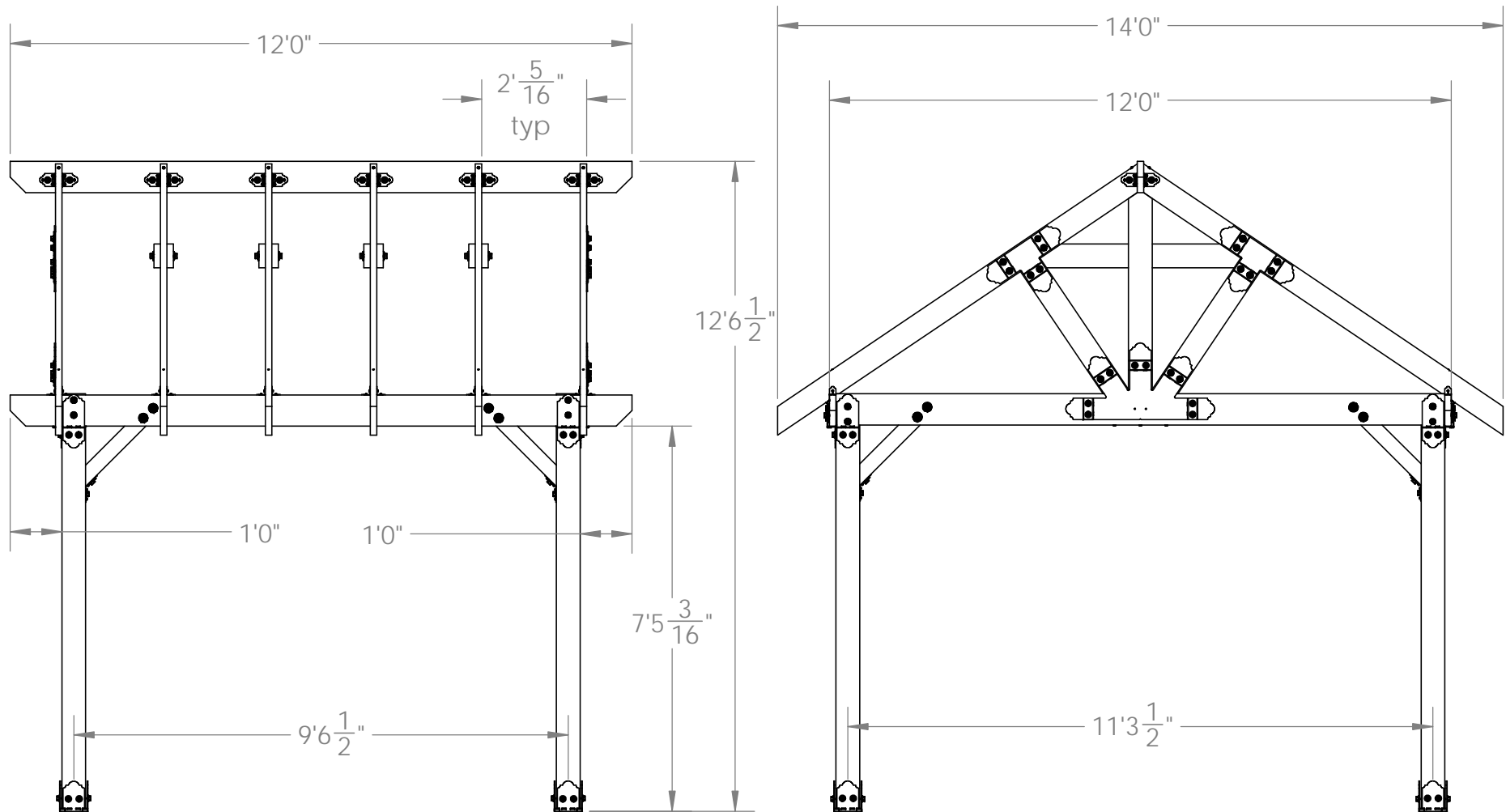

shown without roofing for clarity

OZCO Project #213 - 12x12 Pavilion w 6x6 Posts

Pavilion Overview

V2.00 - Installation Instructions, Specifications and Project Plans are effective 2/21/2017 . This information is updated periodically and should not be relied upon after 2 years from 2/21/2017 . Please visit OZCOBP.com to get current information.

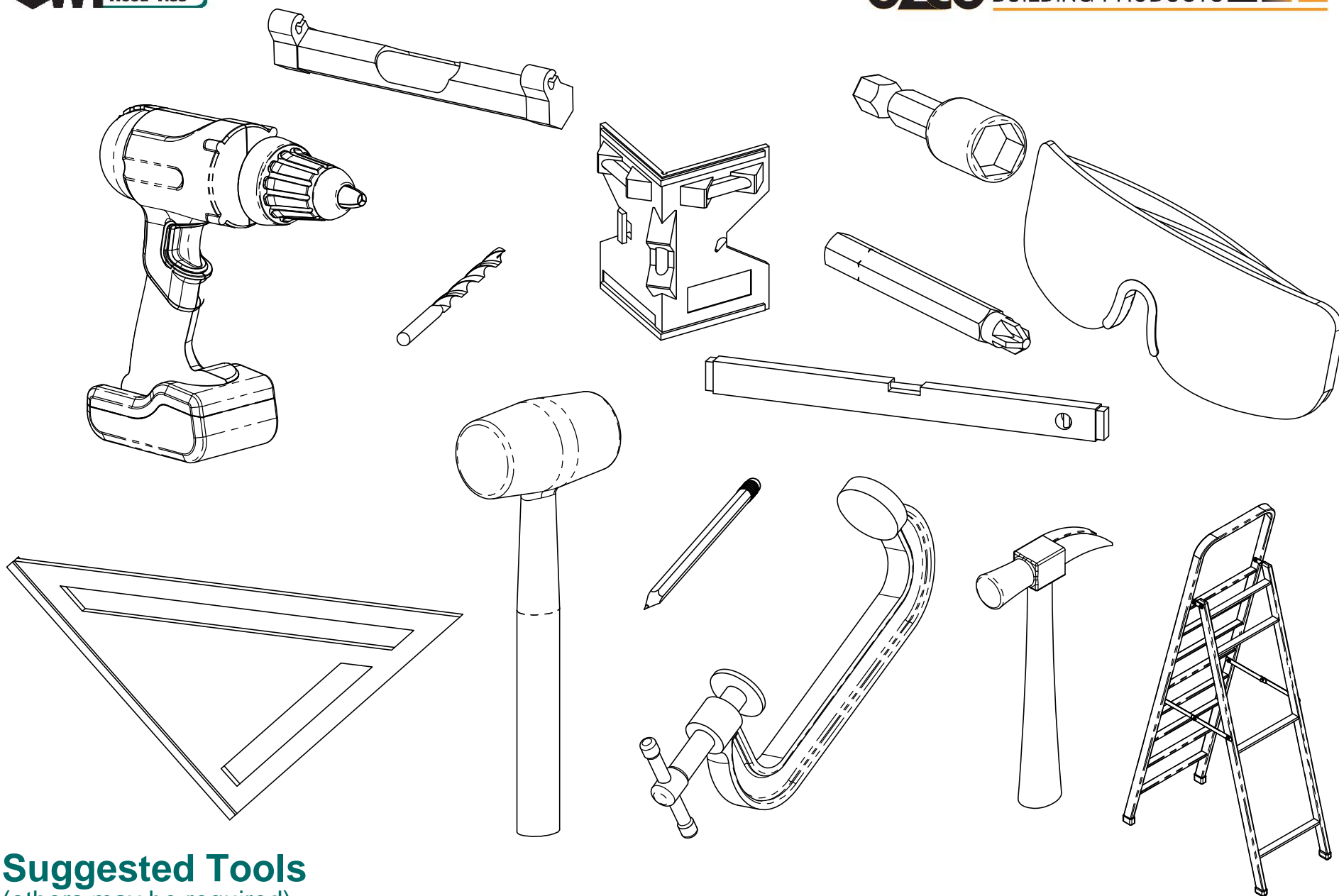

Suggested Tools

(others may be required)

QTY.	PART NUMBER	DESCRIPTION
4	56608	6x6 Post Base (6x6-PB-LS)
4	56636	Post to Beam Bolt Offset (P2B-BO-LS)
2	56668	4" Flush Inside 45 (FI45-LS-4)
16	56650	OWT Timber Bolt 6-8"
8	56680	2" Timber Bolt Heavy Duty Washer (OWT-TBW-2)
2	56619	Truss Base Fan 8:12
11	56611	Truss Accent (TA-LS)
2	56625	OWT Timber Screw 1-3/4"
2	56612	"T" Tie Plate (TTP)
4	56649	OWT Timber Bolt 4-6"
3	56617	2" Standard Rafter Clip (RC-LS-2)
3	56618	4" Standard Rafter Clip (RC-LS-4)
1	56627	OWT Timber Screw 3-3/4"
1	56647	OWT Timber Screw 10"
1	56629	OWT Timber Screw 7-1/2"
4	6x6x8L	6x6x8
2	4x4x10L	4x4x10
7	2x8x12L	2x8x12
2	2x8x10L	2x8x10
2	2x6x8L	2x6x8
1	2x6x16L	2x6x16
12	2x6x10L	2x6x10
8	2x6x6L	2x6x6

Material List

56612

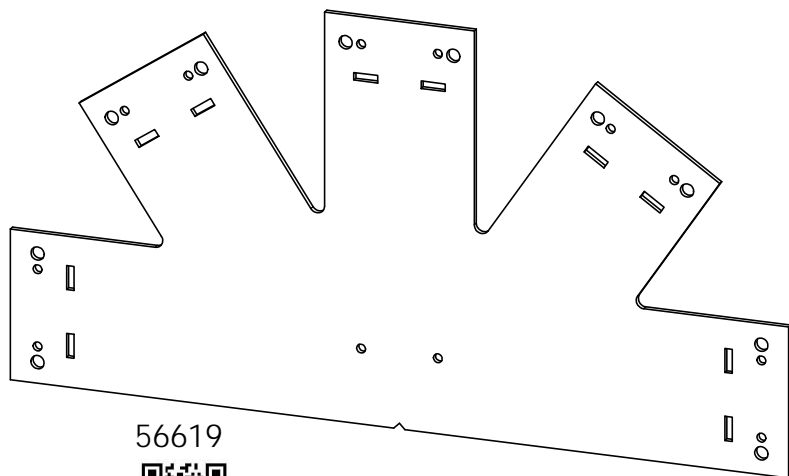

56619

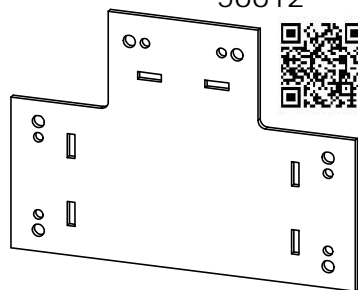

56611

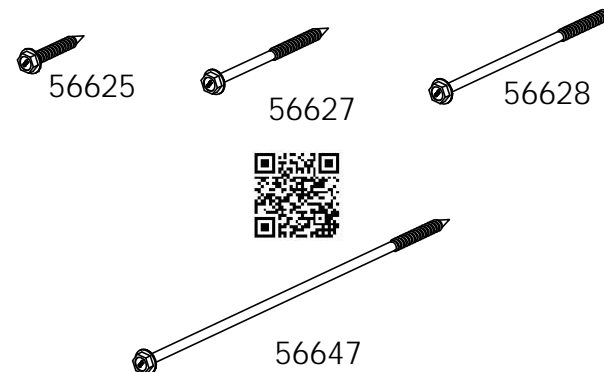
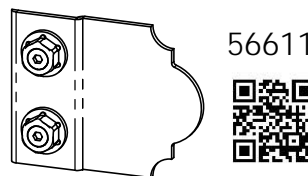

56650

56649

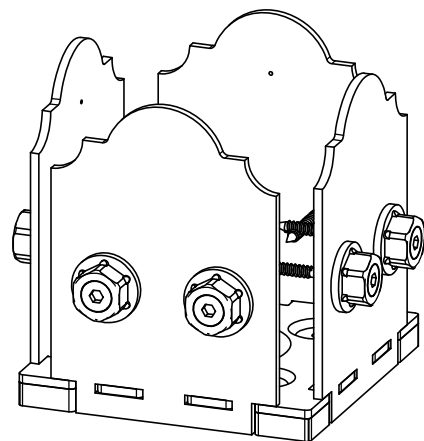
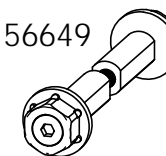
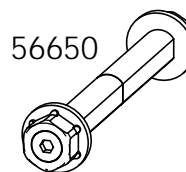

56608

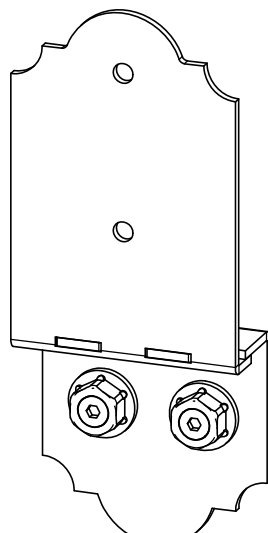

56636

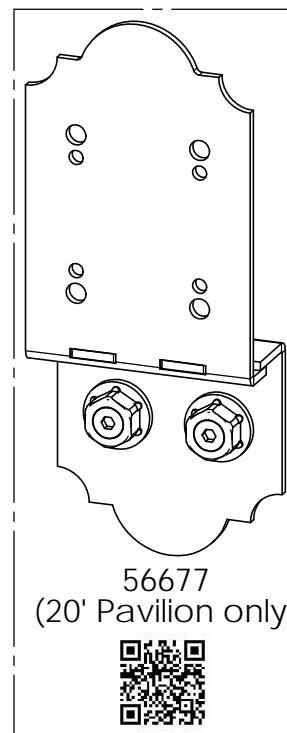

56677

(20' Pavilion only)

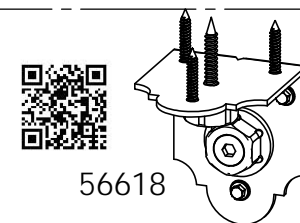

56618

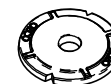

56680

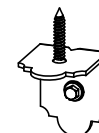

56617

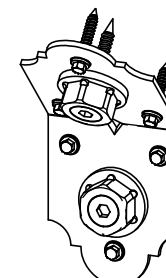

56668



OZCO

Scan QR barcode with smartphone for quick access to product installation instructions

Pavilion OZCO

V2.00 - Installation Instructions, Specifications and Project Plans are effective 2/21/2017. This information is updated periodically and should not be relied upon after 2 years from 2/21/2017. Please visit OZCOBP.com to get current information.

Laredo Sunset & Ironwood



Laredo Sunset
(566XX series)

2 great styles
Same functionality

choose your
connection lifestyle

both styles available for
most products

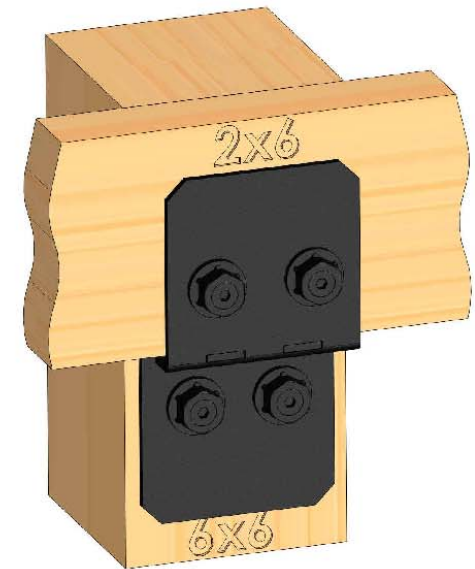

Ironwood
(517XX series)



OZCO BUILDING PRODUCTS

2x6 Board 100.13" 8:12 Rafter cut

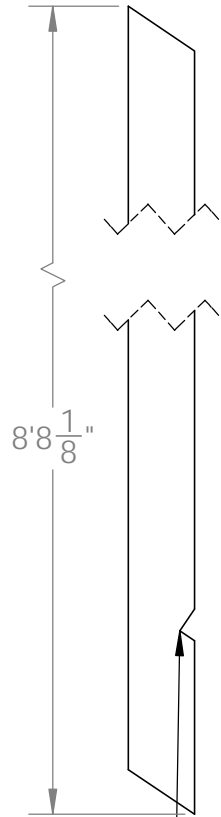

see Birds
Foot
template



4x4 Post 30" with Beauty cut removed

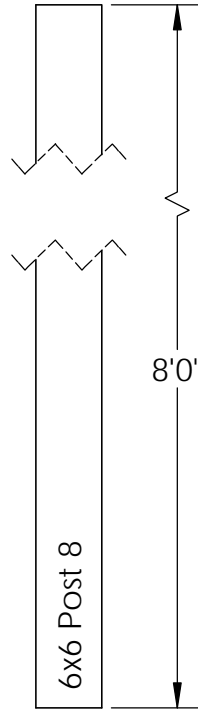

6x6 Post 8

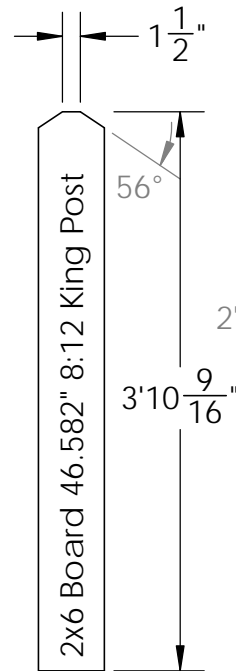

2x6 Board 46.582" 8:12 King Post

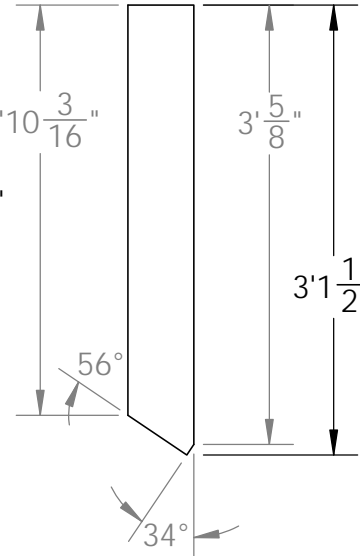

2x6 Board 37.5" 8:12 Web cut

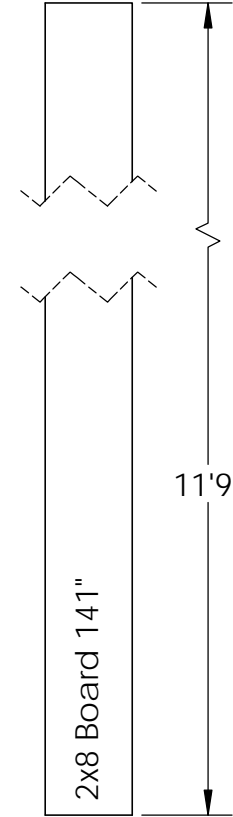

2x8 Board 141"

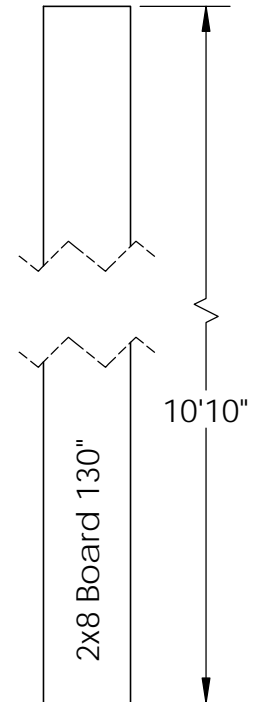

2x8 Board 130"

12x(length) Pavilion cut list: common to all 12' wide Pavilions

Pavilion Cutlist 12

V2.00 - Installation Instructions, Specifications and Project Plans are effective 2/21/2017. This information is updated periodically and should not be relied upon after 2 years from 2/21/2017. Please visit OZCOBP.com to get current information.

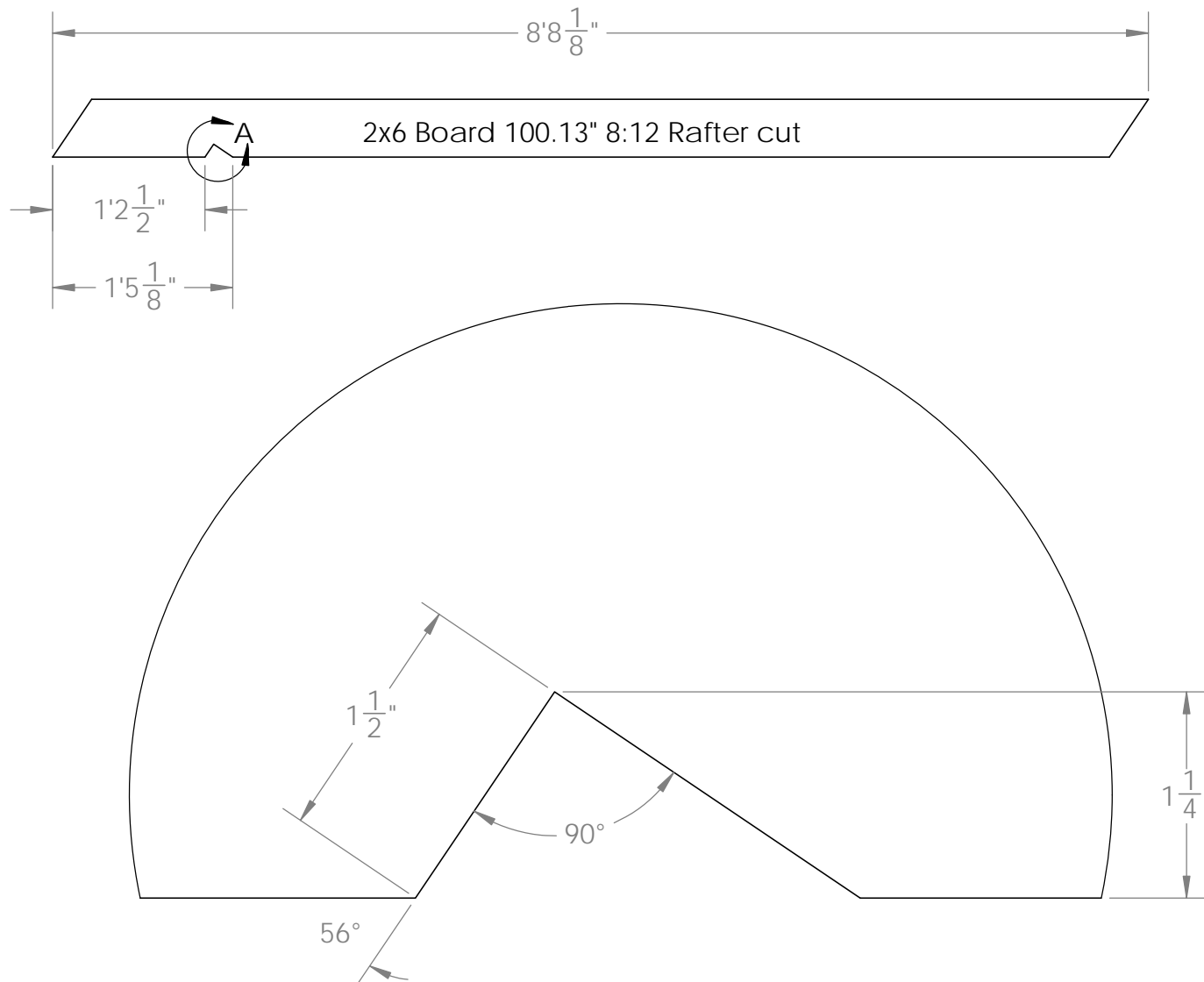

Birds Foot 1:1 template

Pavilion Cutlist 12

V2.00 - Installation Instructions, Specifications and Project Plans are effective 2/21/2017. This information is updated periodically and should not be relied upon after 2 years from 2/21/2017. Please visit OZCOBP.com to get current information.

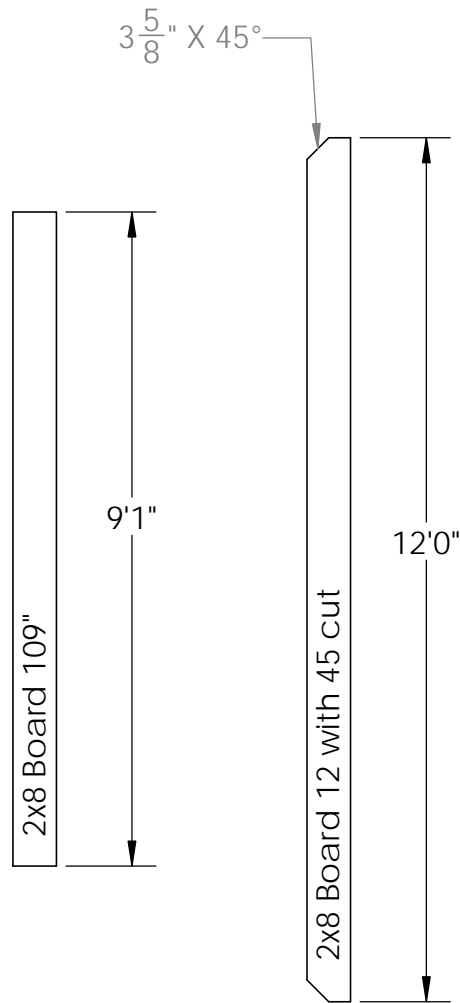

12x12

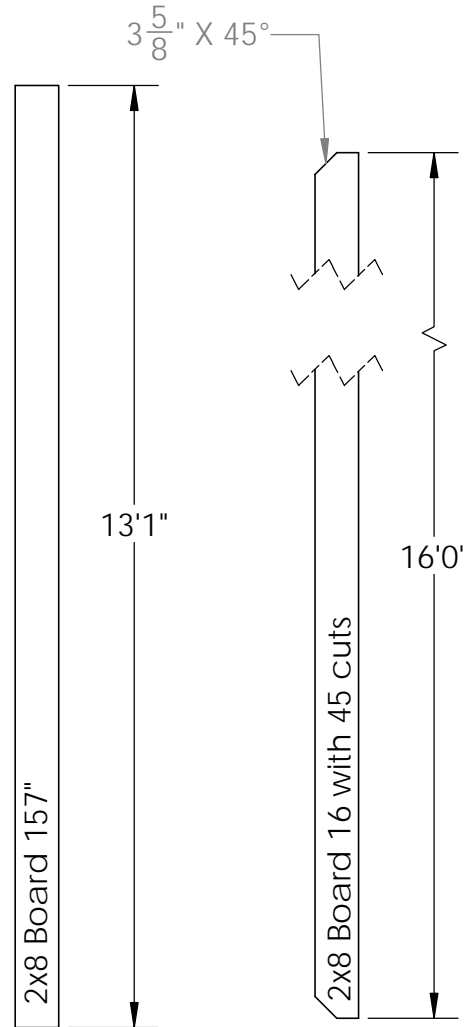

12x16

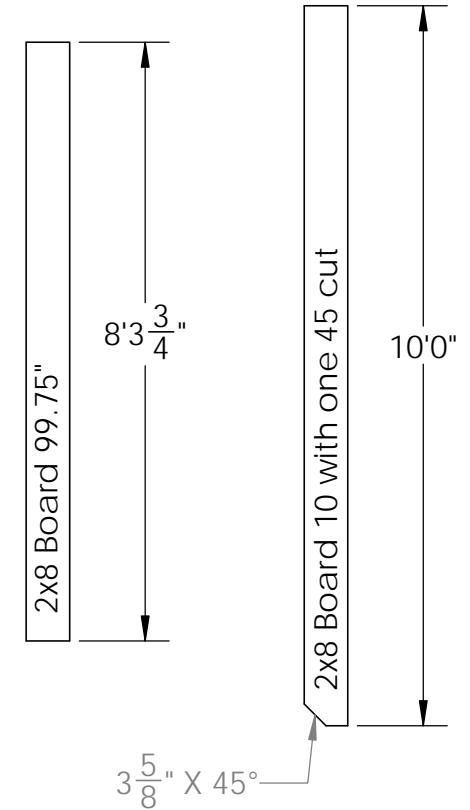

12x20

12x(length) Pavilion cut list: 2x8 length wise boards

Pavilion Cutlist 12

V2.00 - Installation Instructions, Specifications and Project Plans are effective 2/21/2017. This information is updated periodically and should not be relied upon after 2 years from 2/21/2017. Please visit OZCOBP.com to get current information.

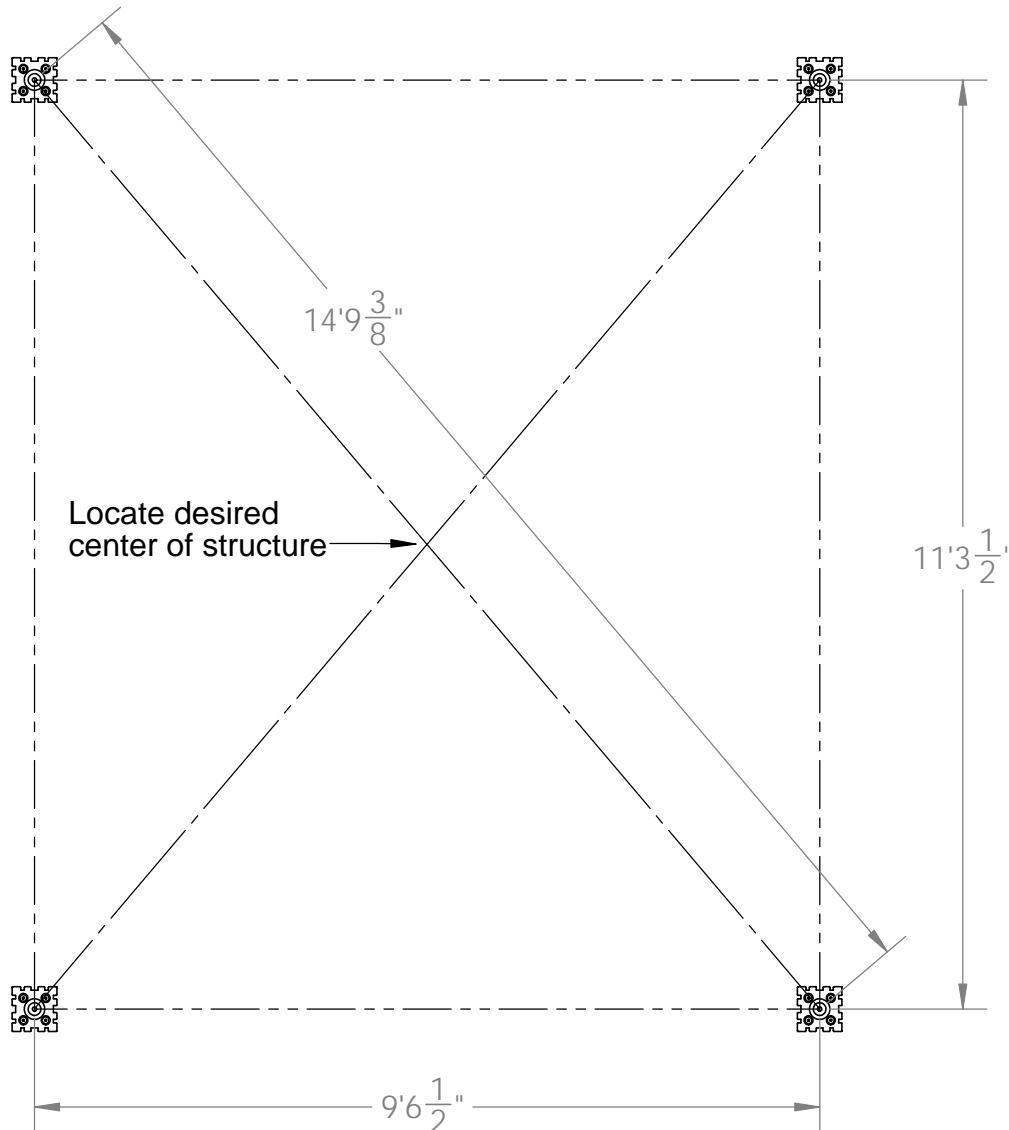

if site is not level,
see Ozco Site
Leveling
instruction



Site Plan - OZCO Project #213 - 12x12 Pavilion w 6x6 Posts

Pavilion Site Plan

V2.00 - Installation Instructions, Specifications and Project Plans are effective 2/21/2017. This information is updated periodically and should not be relied upon after 2 years from 2/21/2017. Please visit OZCOBP.com to get current information.

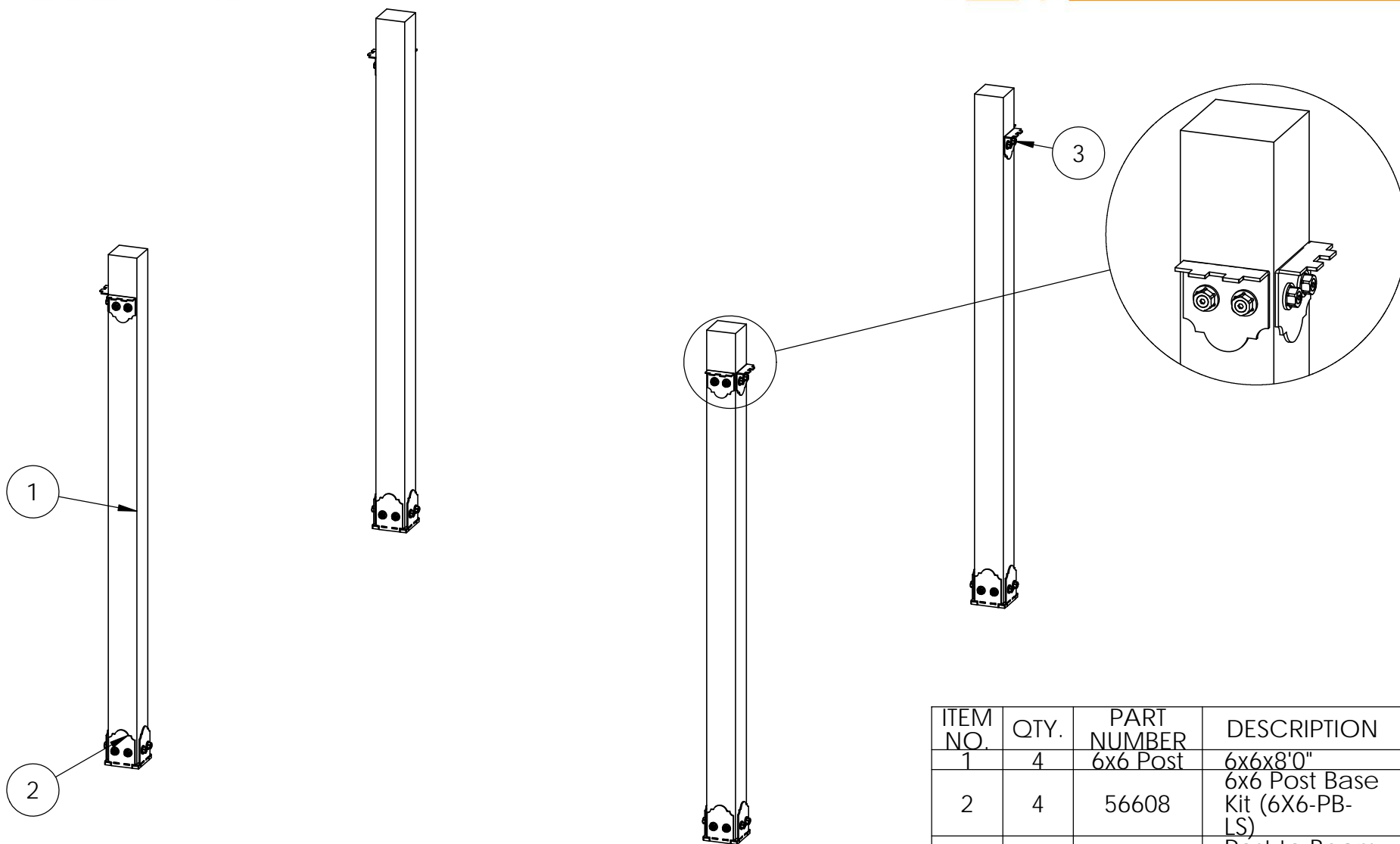

ITEM NO.	QTY.	PART NUMBER	DESCRIPTION
1	4	6x6 Post	6x6x8'0"
2	4	56608	6x6 Post Base Kit (6X6-PB-LS)
3	4	56636	Post to Beam Bolt Offset (P2B-BO-LS)

OZCO Project #213 - 12x12 Pavilion w 6x6 Posts ledge

Pavilion Base

V2.00 - Installation Instructions, Specifications and Project Plans are effective 2/21/2017 . This information is updated periodically and should not be relied upon after 2 years from 2/21/2017 . Please visit OZCOBP.com to get current information.

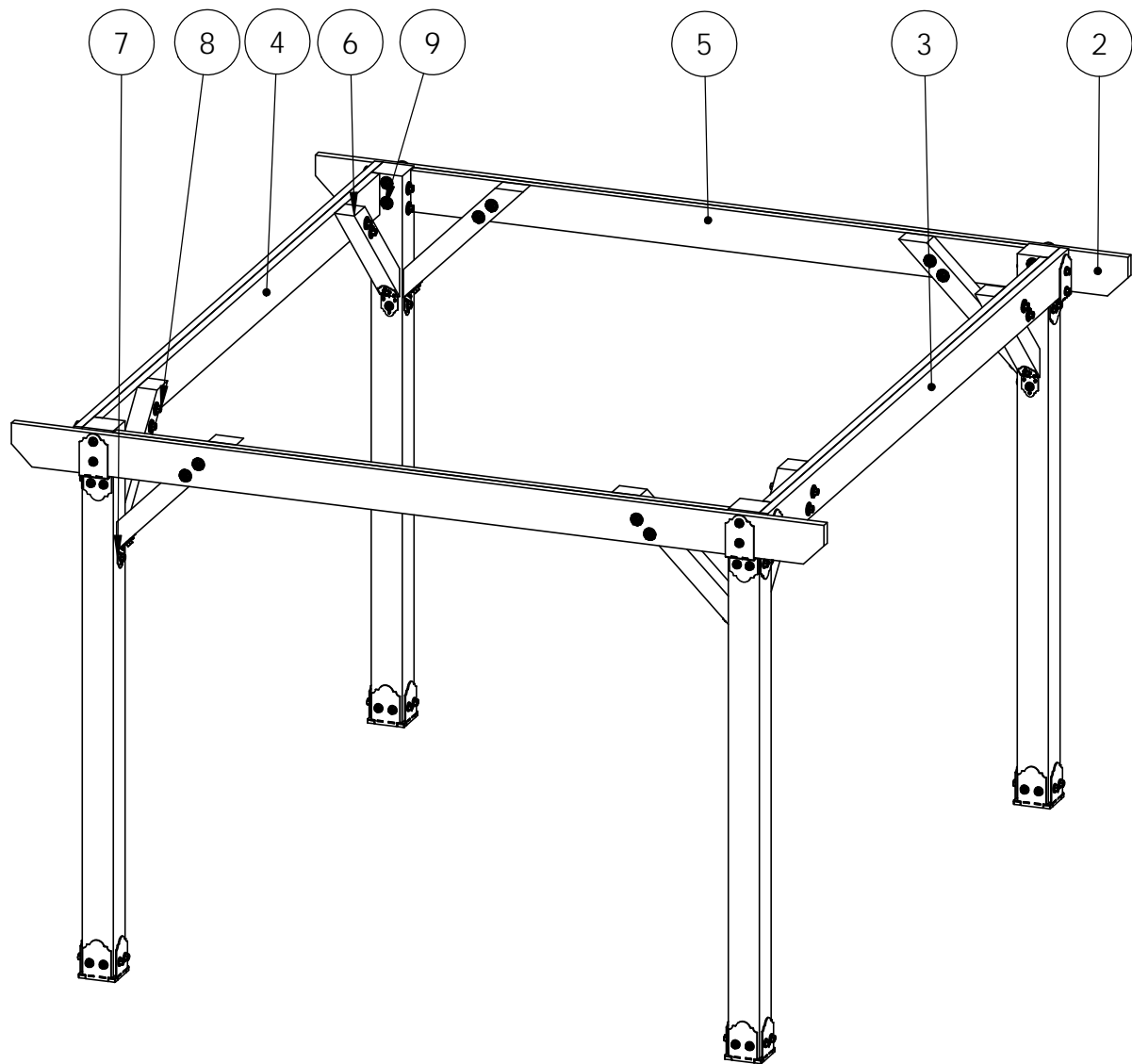

ITEM NO.	QTY.	PART NUMBER	DESCRIPTION
1	1	Pavilion Base	OZCO Project #213 - 12x12 Pavilion w 6x6 Posts
2	2	2x8 Board	2x8x12'0"
3	2	2x8 Board	2x8x11'9"
4	2	2x8 Board	2x8x10'10"
5	2	2x8 Board	2x8x9'1"
6	8	4x4 Post	4x4x2'6"
7	2	56668	4" Flush Inside 45 (FI45-LS-4)
8	8	56650	OWT Timber Bolt 6-8"
	8	56680	2" Timber Bolt Heavy Duty Washer (OWT-TBW-2)
9	8	56650	OWT Timber Bolt 6-8"
	4	56680	2" Timber Bolt Heavy Duty Washer (OWT-TBW-2)

OZCO Project #213 - 12x12 Pavilion w 6x6 Posts

Pavilion Beam & Support

V2.00 - Installation Instructions, Specifications and Project Plans are effective 2/21/2017. This information is updated periodically and should not be relied upon after 2 years from 2/21/2017. Please visit OZCOBP.com to get current information.

Building your Canopy... Simple 3 step procedure common to all size Pavilions

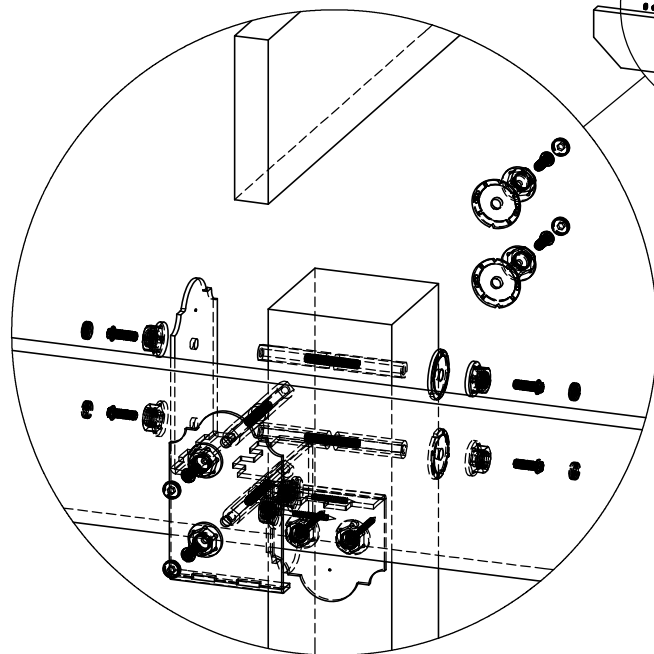

use this procedure for all
size Pavilions (10x10 shown).
same construction steps
and techniques apply

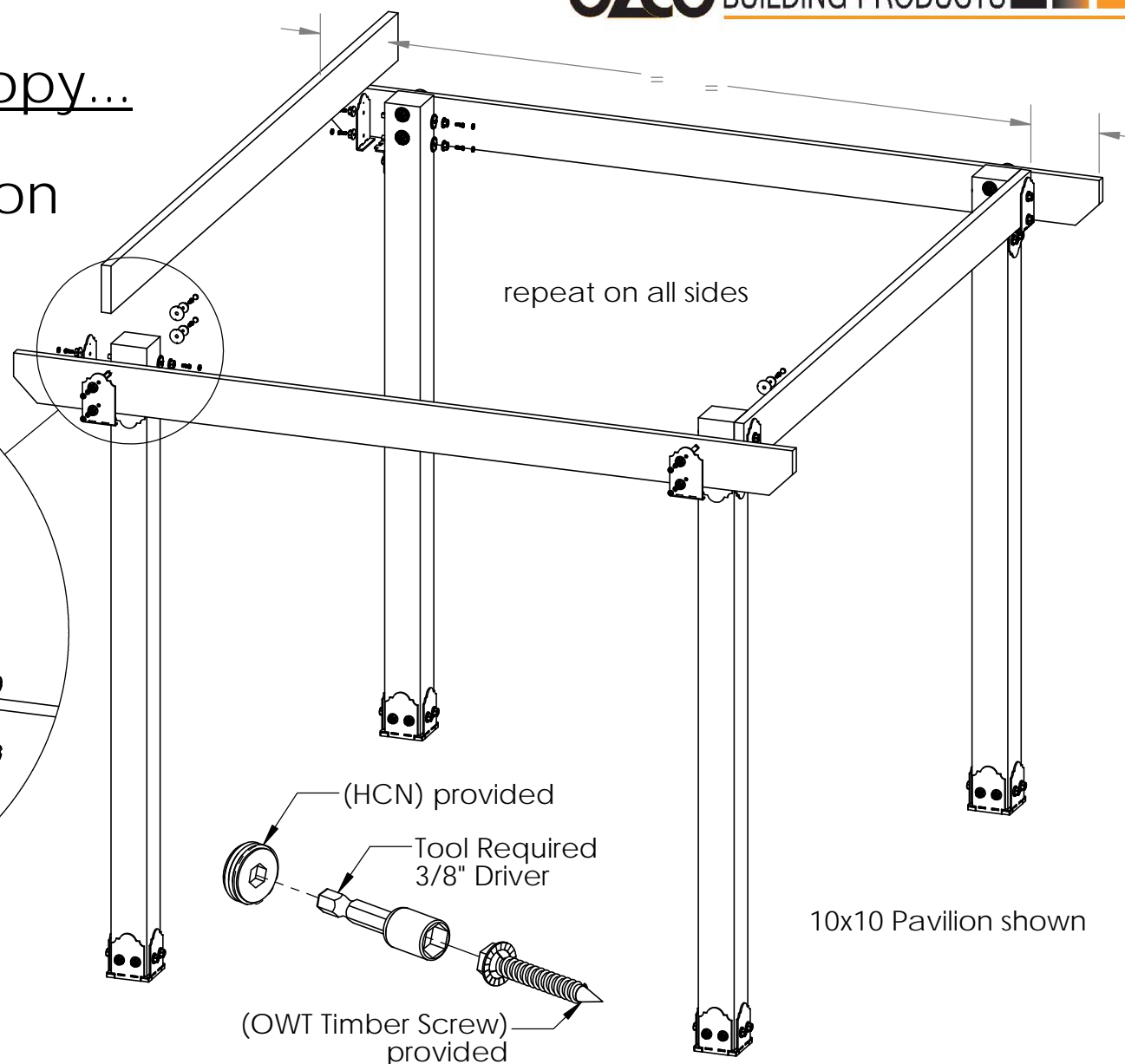

step 1 Outer Beams

Pavilion Beam & Support

Secure with nails or screws
Repeat on all sides

for additional beam rigidity
apply polyurethane adhesive
between boards

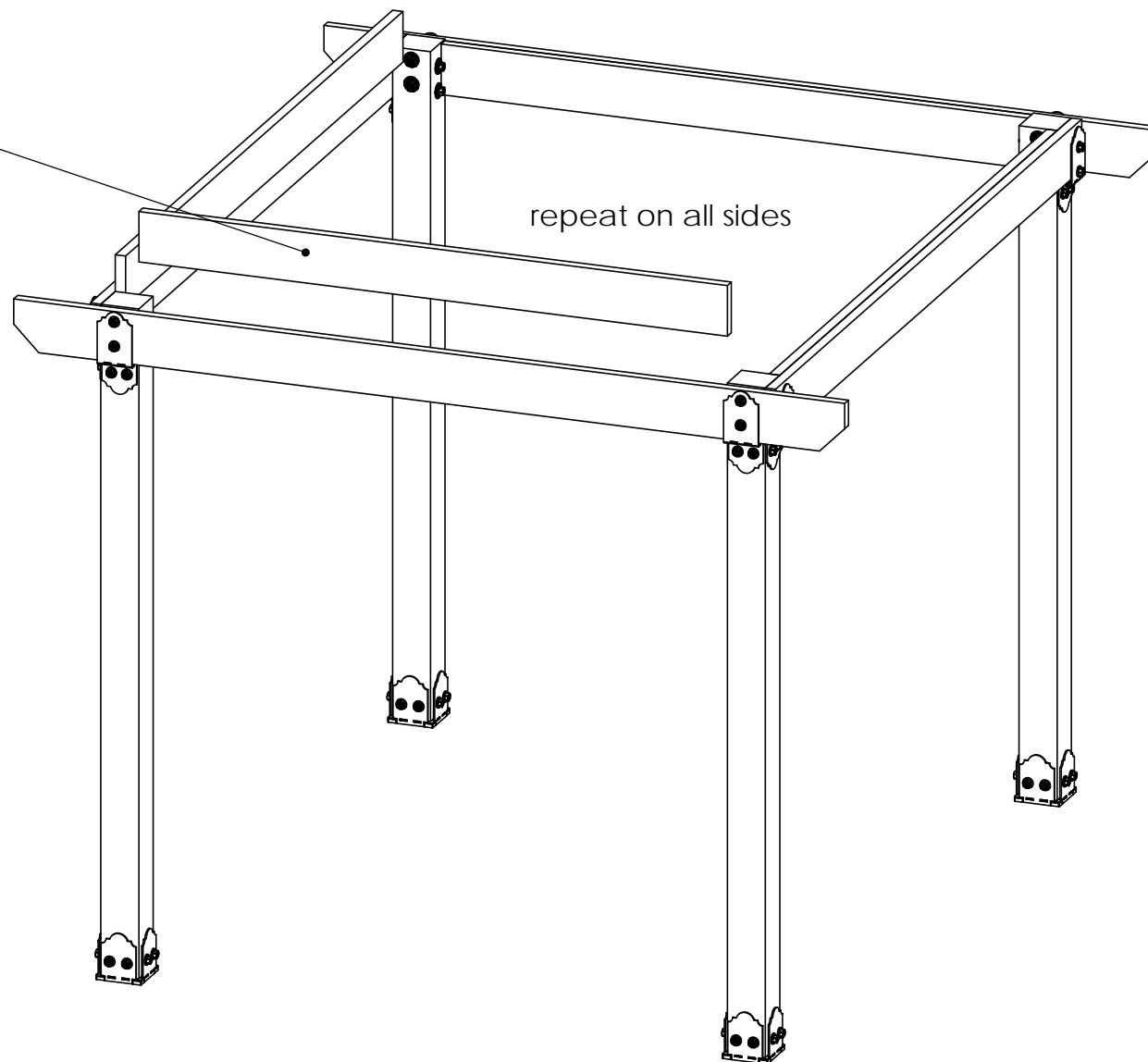

step 2 Inside Beams

Pavilion Beam & Support

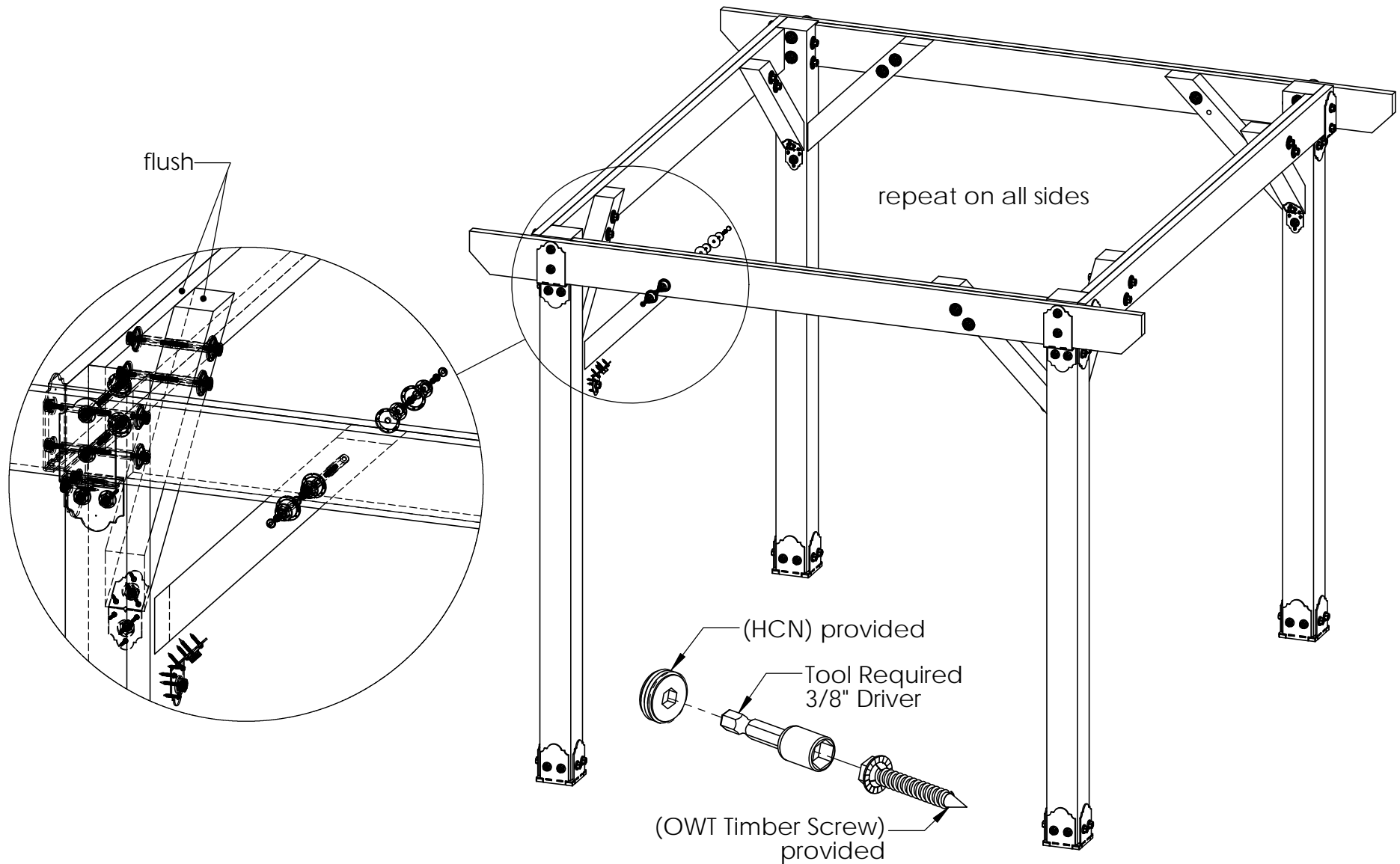

step 3 Knee Braces

Pavilion Beam & Support

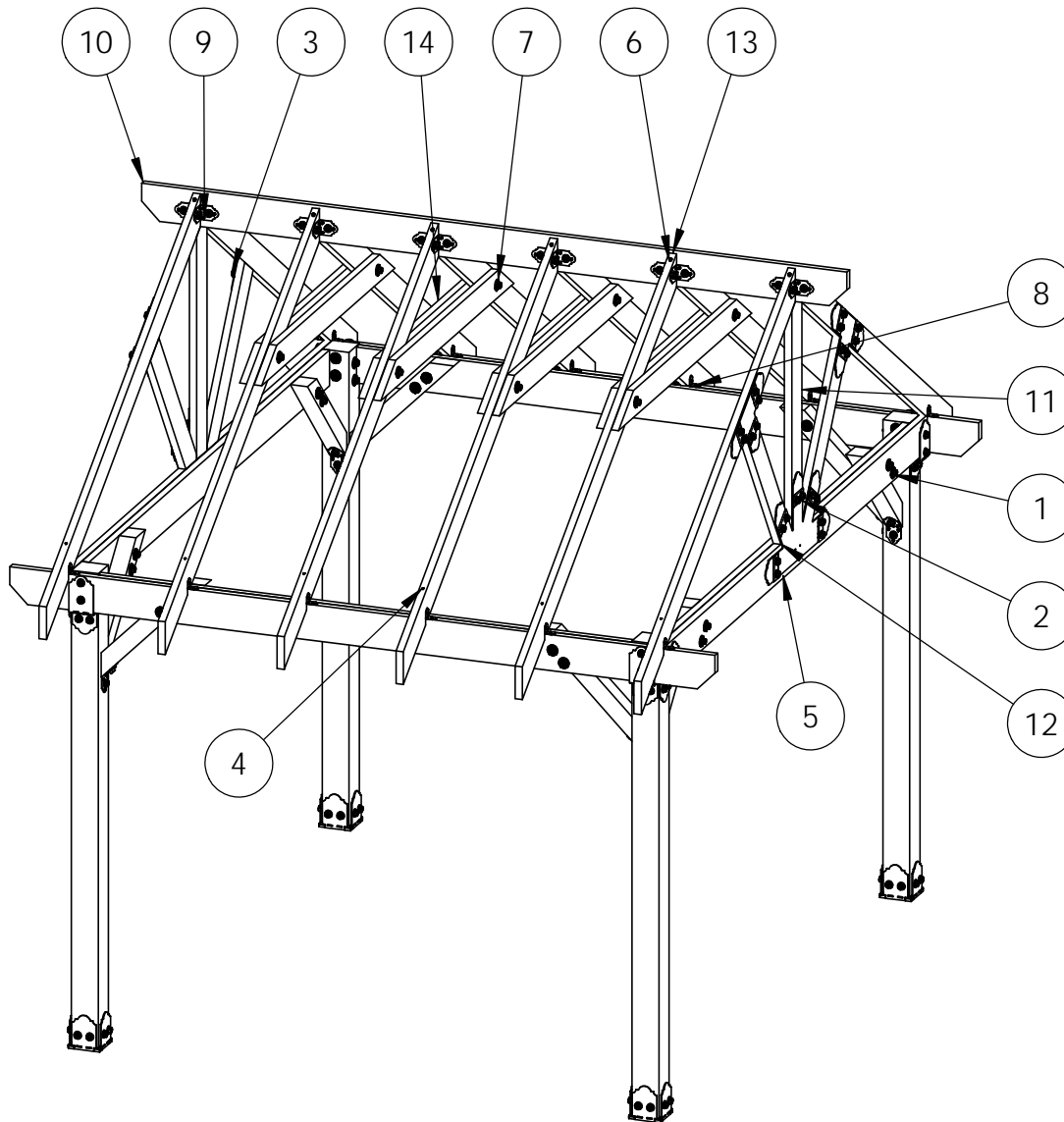

ITEM NO.	QTY.	PART NUMBER	DESCRIPTION
1	1	Pavilion Beam & Support	OZCO Project #213 - 12x12 Pavilion w 6x6 Posts
2	2	56619	Truss Base Fan 8:12
	5	56611	Truss Accent (TA-LS)
	1	56625	OWT Timber Screw 1-3/4"
3	2	56612	"T" Tie Plate (TTP)
	6	56611	Truss Accent (TA-LS)
	1	56625	OWT Timber Screw 1-3/4"
4	1	56629	OWT Timber Screw 7-1/2"
5	1	56647	OWT Timber Screw 10"
6	1	56627	OWT Timber Screw 3-3/4"
7	4	56649	OWT Timber Bolt 4-6"
	4	56680	2" Timber Bolt Heavy Duty Washer (OWT-TBW-2)
8	3	56617	2" Standard Rafter Clip (RC-LS-2)
9	3	56618	4" Standard Rafter Clips (RC-LS-4)
10	1	2x8 Board	2x8x12'0"
11	2	2x6 Board	2x6x3'10 9/16"
12	4	2x6 Board	2x6x3'1 1/2"
13	12	2x6 Board	2x6x10'0"
14	8	2x6 Board	2x6x6'0"

OZCO Project #213 - 12x12 Pavilion w 6x6 Posts

Pavilion Truss 12

V2.00 - Installation Instructions, Specifications and Project Plans are effective 2/21/2017. This information is updated periodically and should not be relied upon after 2 years from 2/21/2017. Please visit OZCOBP.com to get current information.

Building your Truss... Simple 7 step procedure common to all size Pavilions

use this procedure for all
size Pavilions (10x10 shown).
same construction steps
and techniques apply

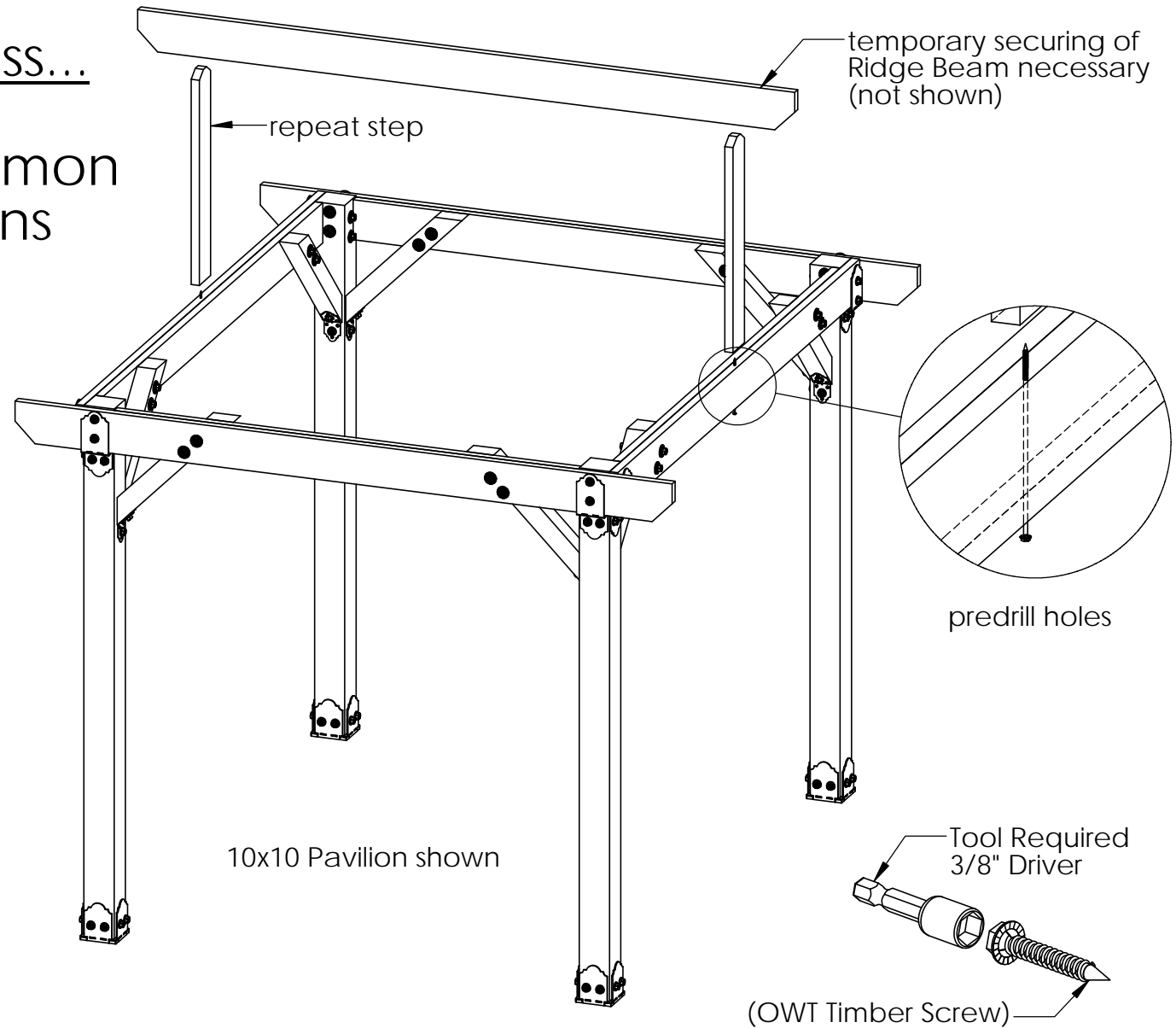

step 1

Pavilion Truss 10

repeat step

tip: rafter screw heads might interfere with roofing. secure flush/below rafter or modify roofing material as needed.

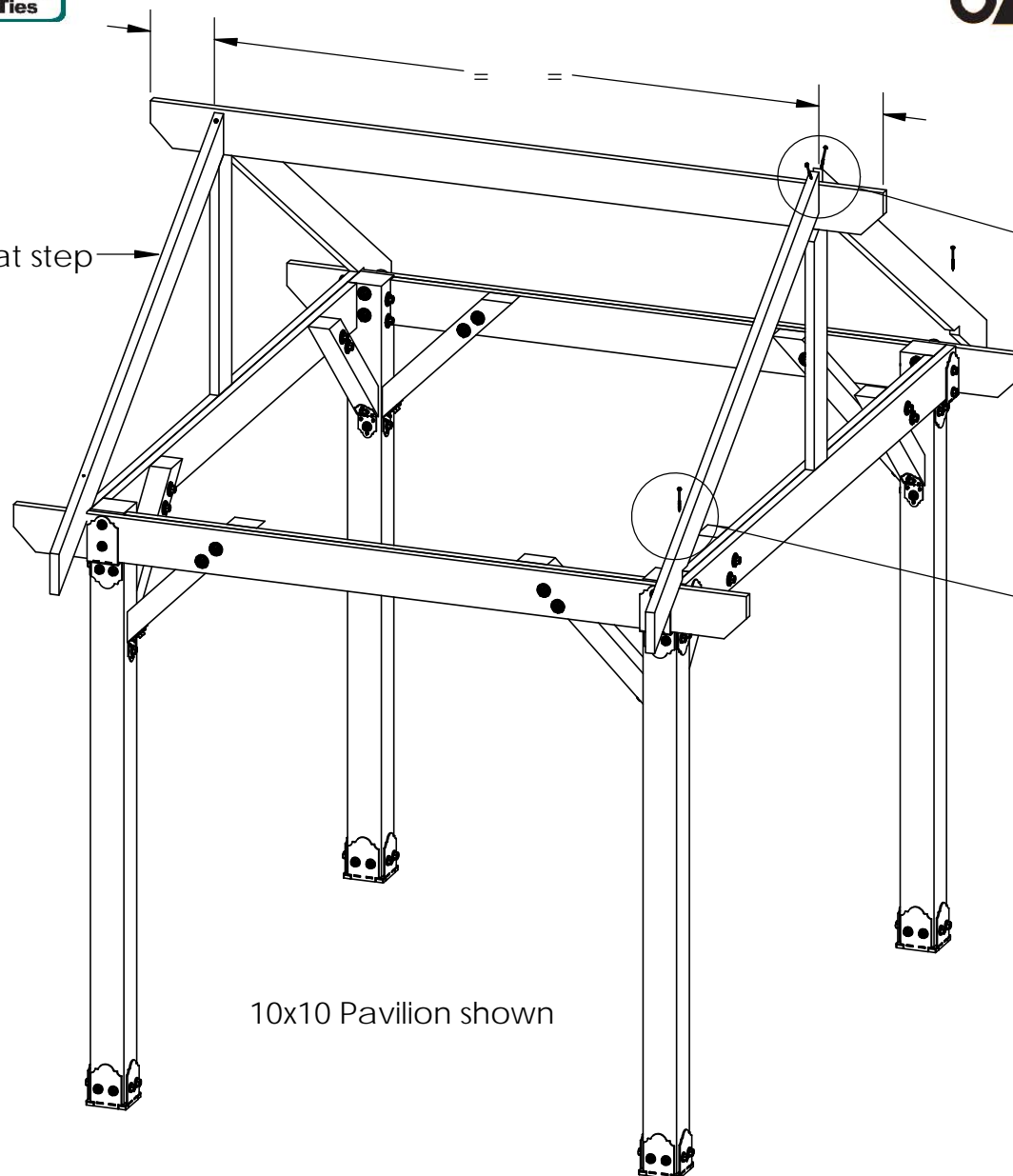

10x10 Pavilion shown

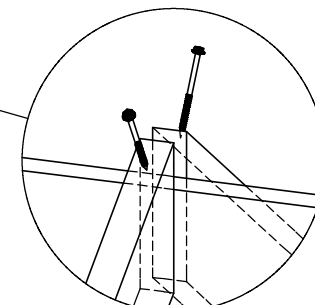

predrill holes

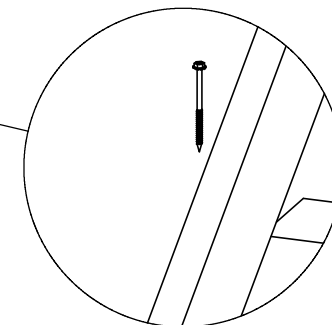

Tool Required
3/8" Driver

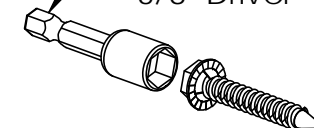

(OWT Timber Screw)

step 2

Pavilion Truss 10

repeat step 2
see overview page
for spacing and
quantity of Trusses

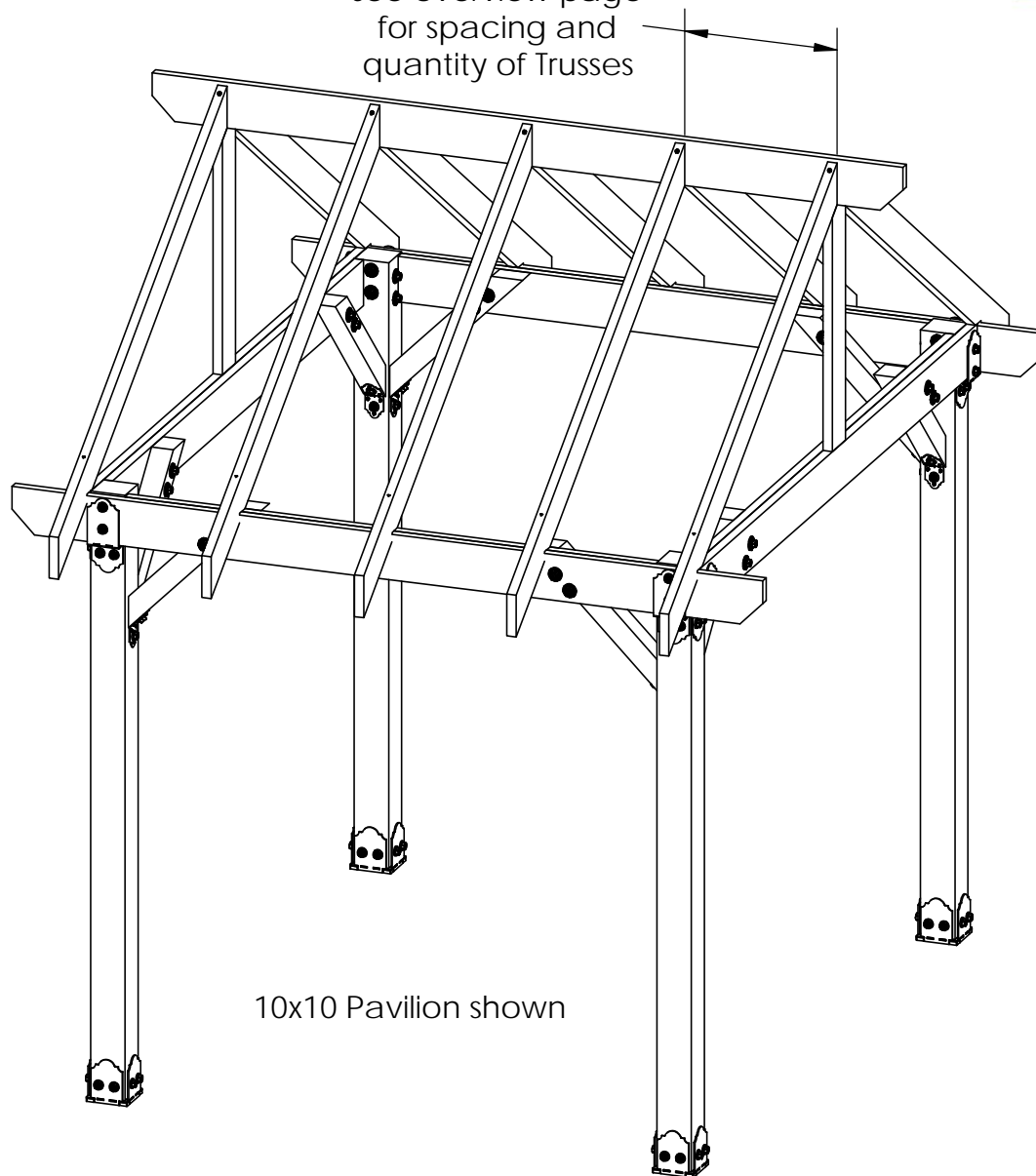

10x10 Pavilion shown

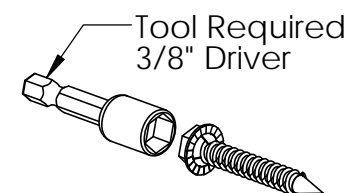

(OWT Timber Screw)

step 3

Pavilion Truss 10

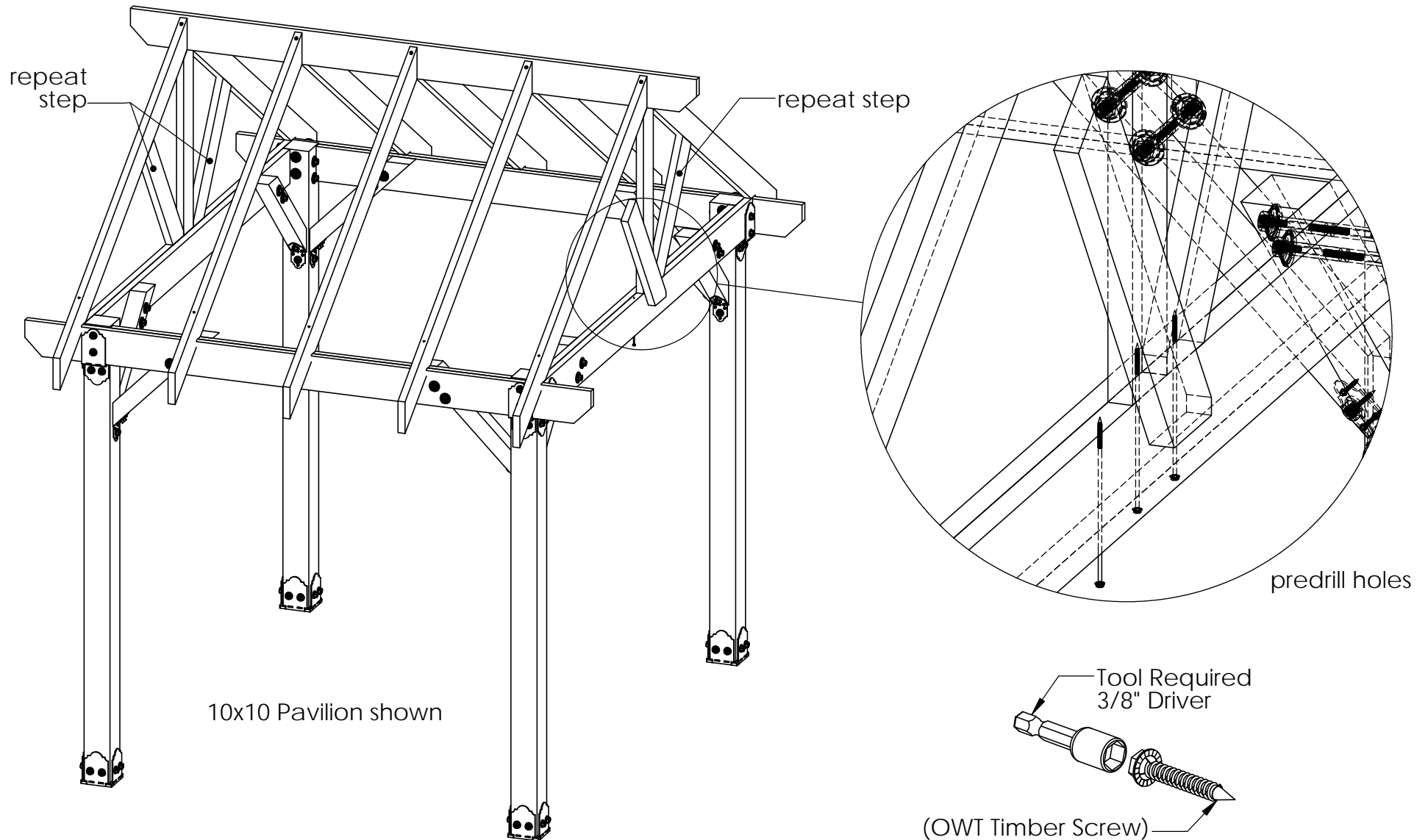

step 4

Pavilion Truss 10

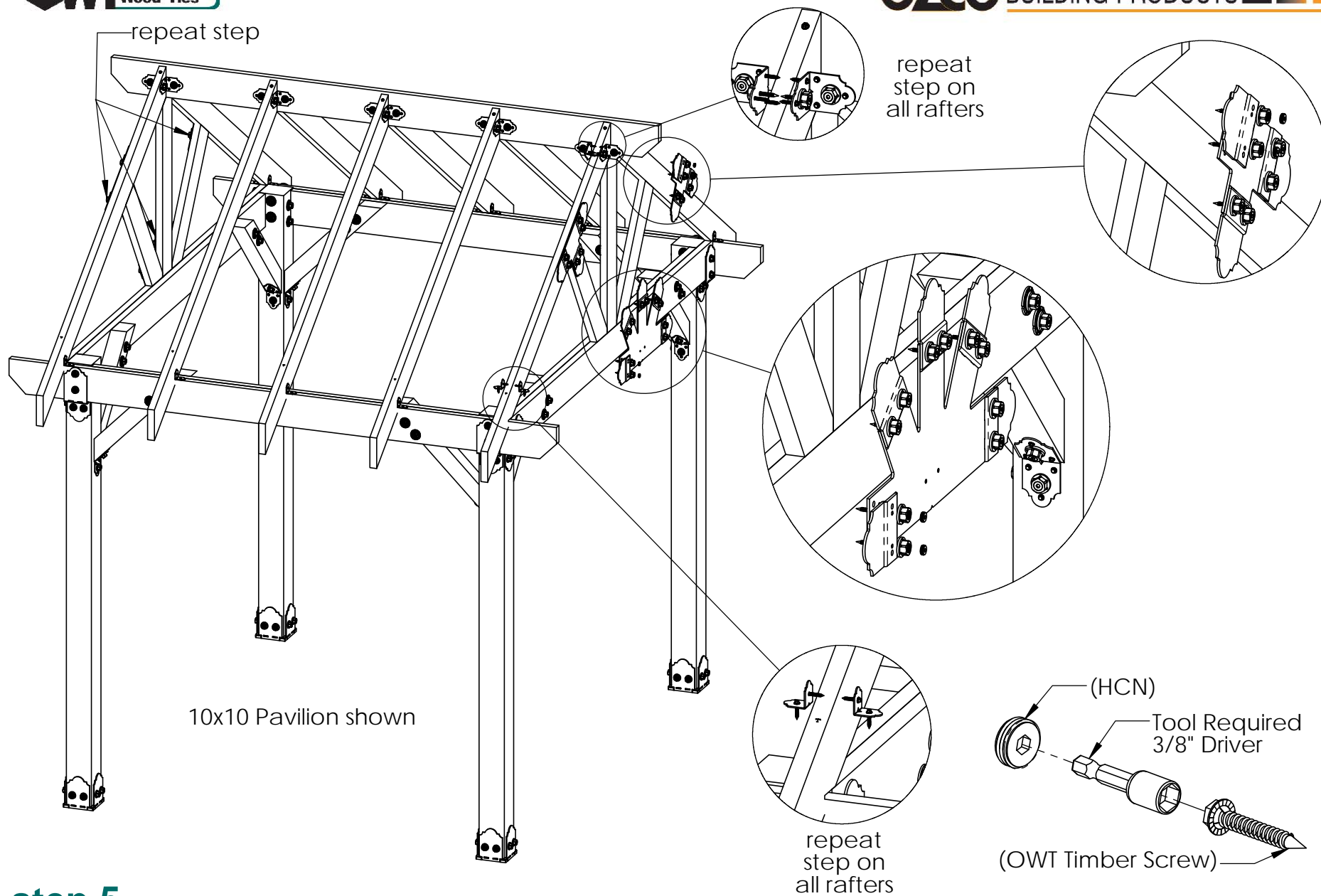

step 5

Pavilion Truss 10

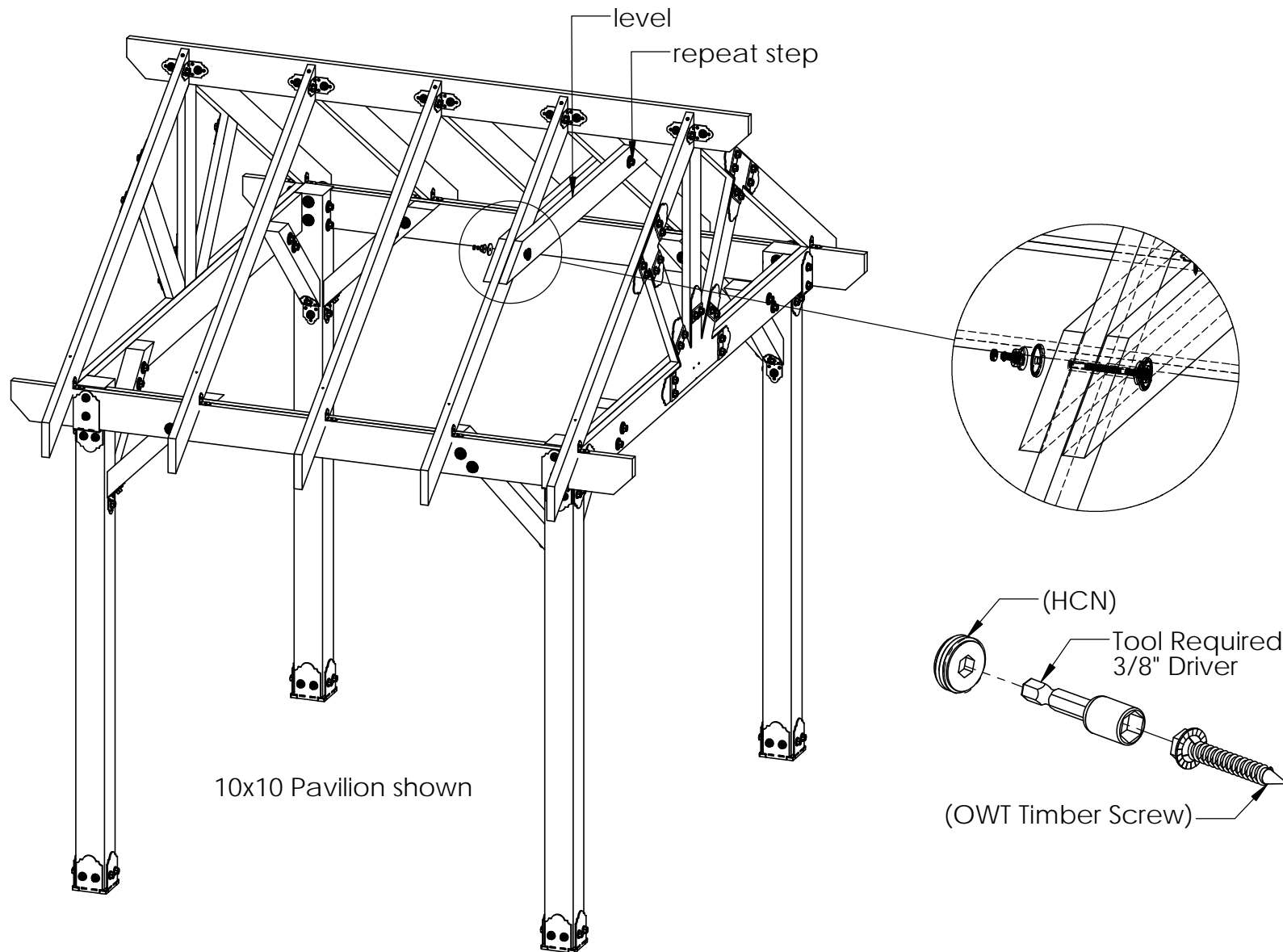

step 6

Pavilion Truss 10

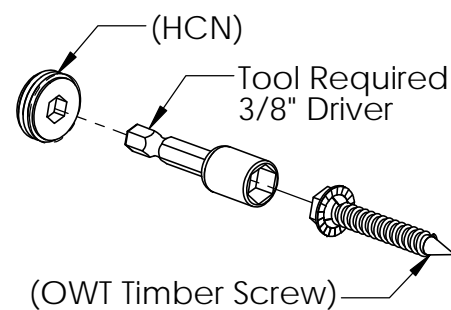
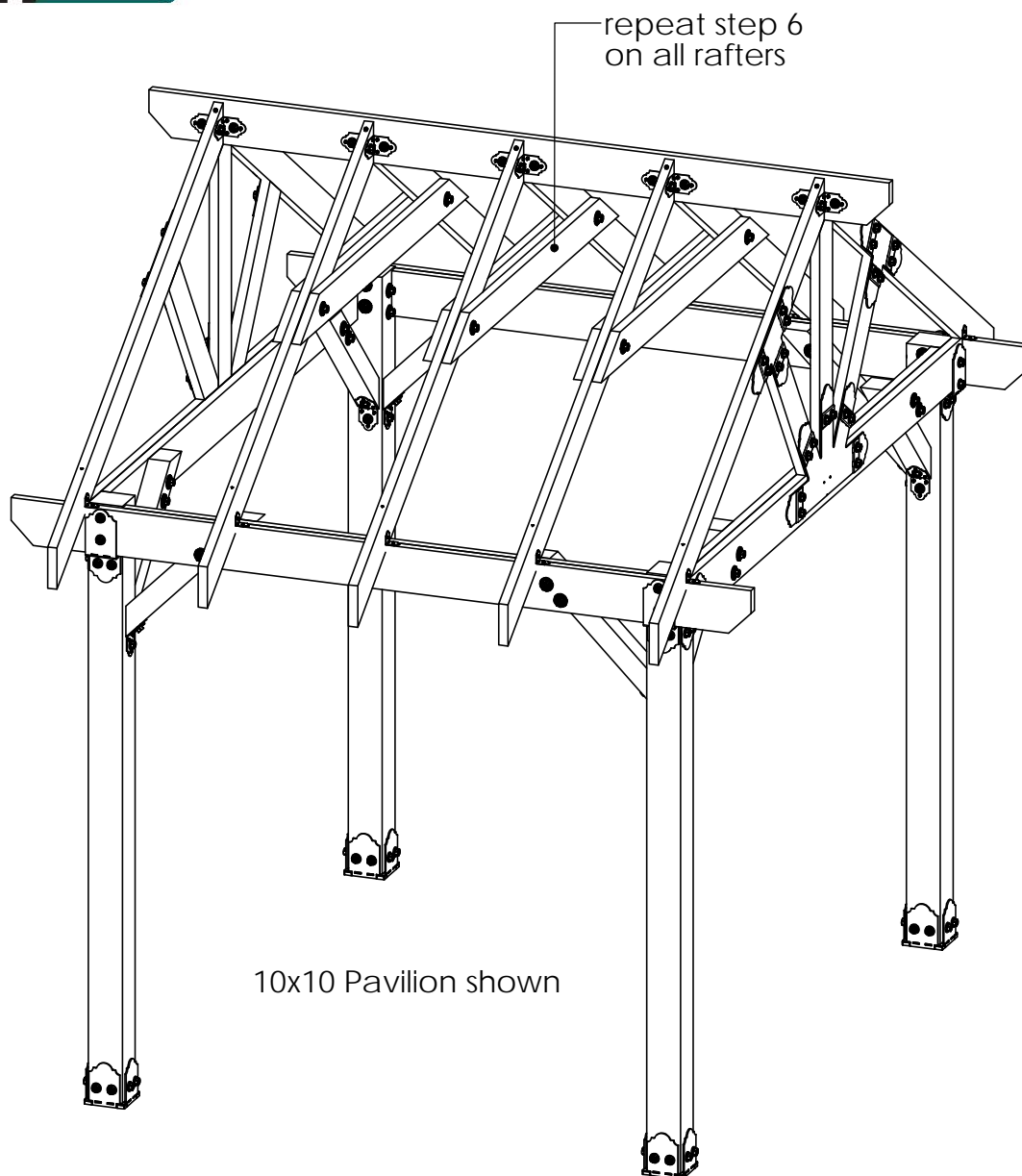

step 7

Pavilion Truss 10

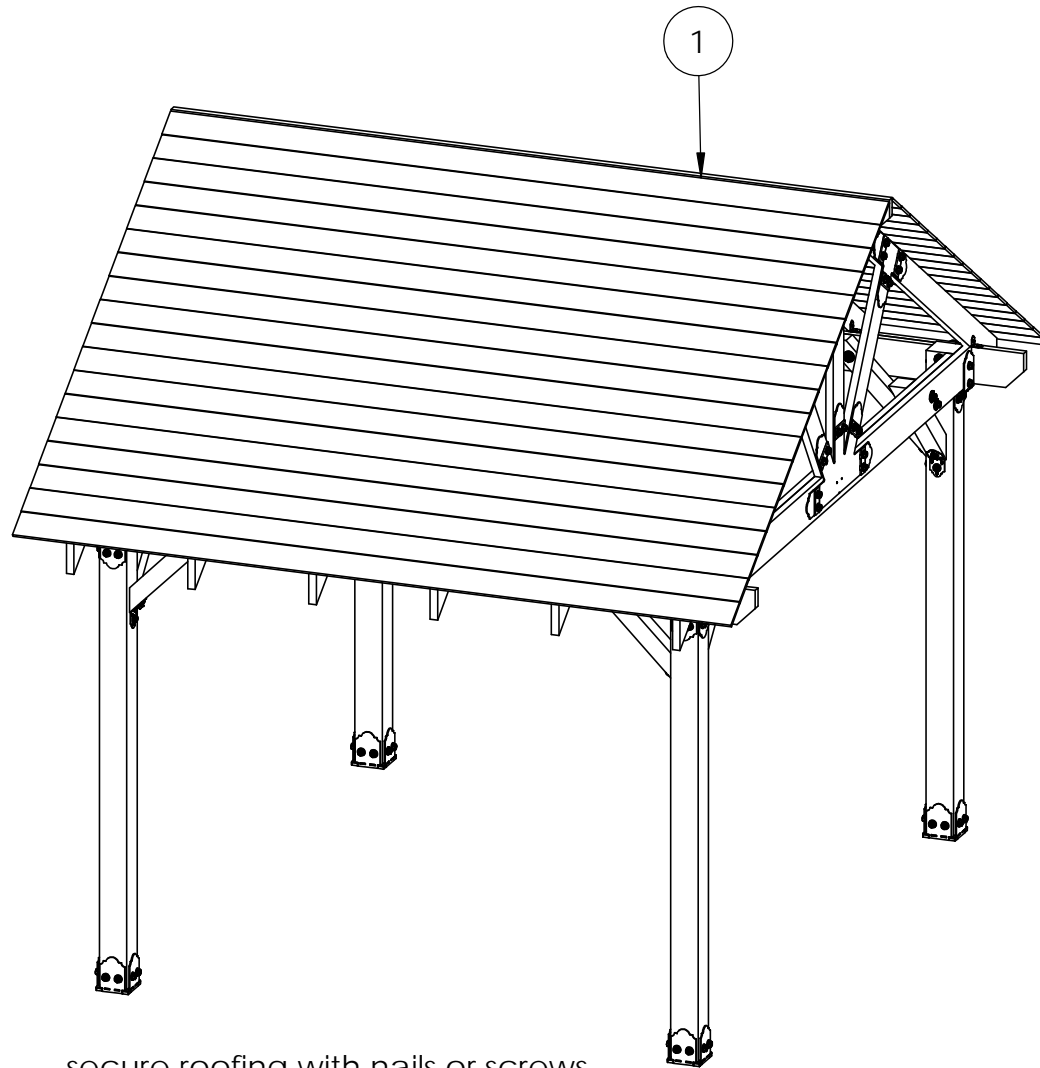

secure roofing with nails or screws

ITEM NO.	QTY.	PART NUMBER	DESCRIPTION
1	36	1x6 Board	1x6x12'0"

OZCO Project #213 - 12x12 Pavilion w 6x6 Posts Roofed

Pavilion Truss 12 Roofing

V2.00 - Installation Instructions, Specifications and Project Plans are effective 2/21/2017 . This information is updated periodically and should not be relied upon after 2 years from 2/21/2017 . Please visit OZCOBP.com to get current information.