

DESIGN

PURCHASE

CONSTRUCT

ENJOY

OZCO Project #212 IW- Pavilion Post and Beam – Free Standing



OZCO BUILDING PRODUCTS ■ ■ ■

OZCO Project #212 IW- Pavilion Post and Beam – Free Standing

V2.00 - Installation Instructions, Specifications and Project Plans are effective 3/1/2017 . This information is updated periodically and should not be relied upon after 2 years from 3/1/2017 . Please visit OZCOBP.com to get current information.



Printing Documents from ISSUU

Unfortunately, there is currently no way to print content directly through issuu. To print a publication, you will need to download it and print it from your computer.

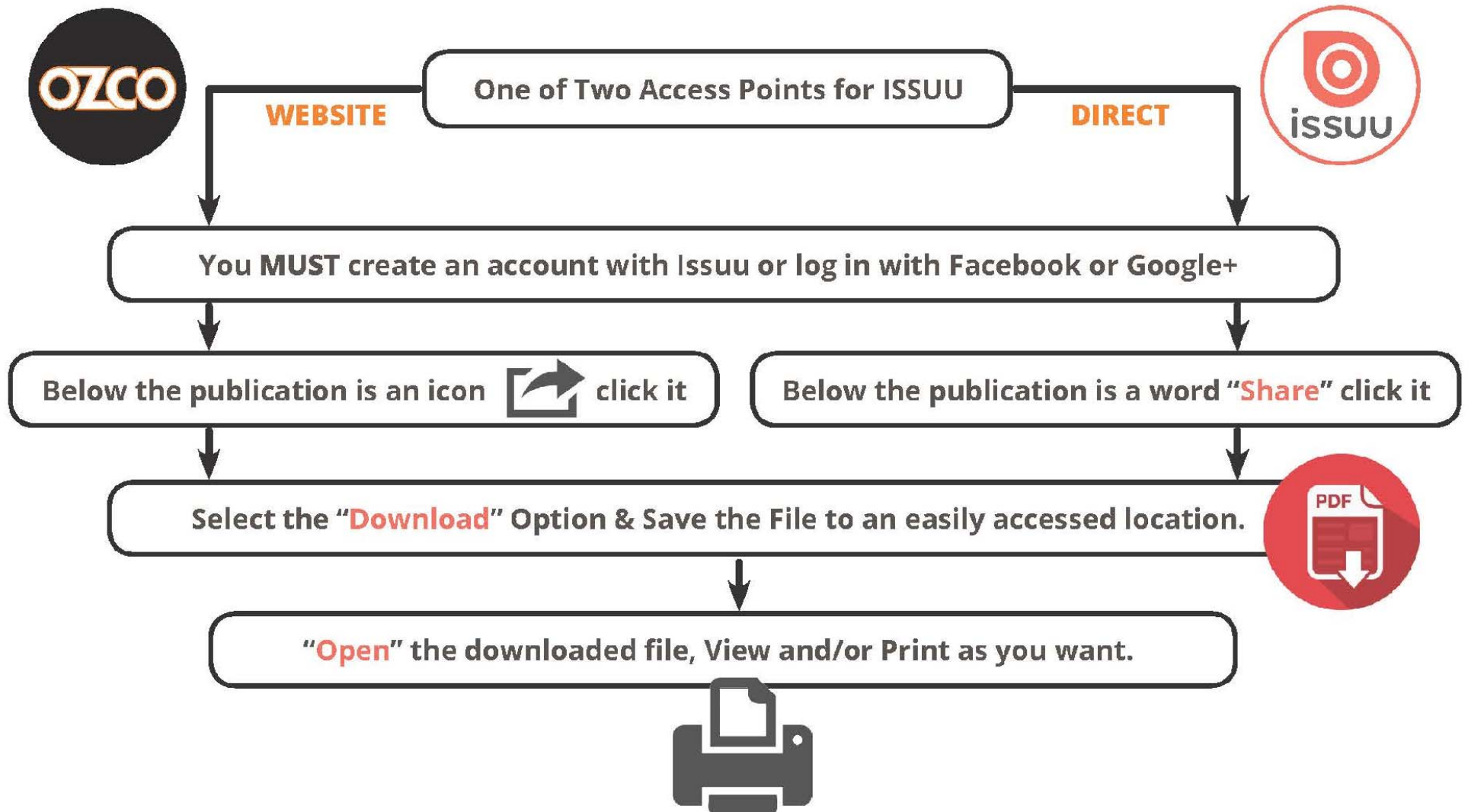

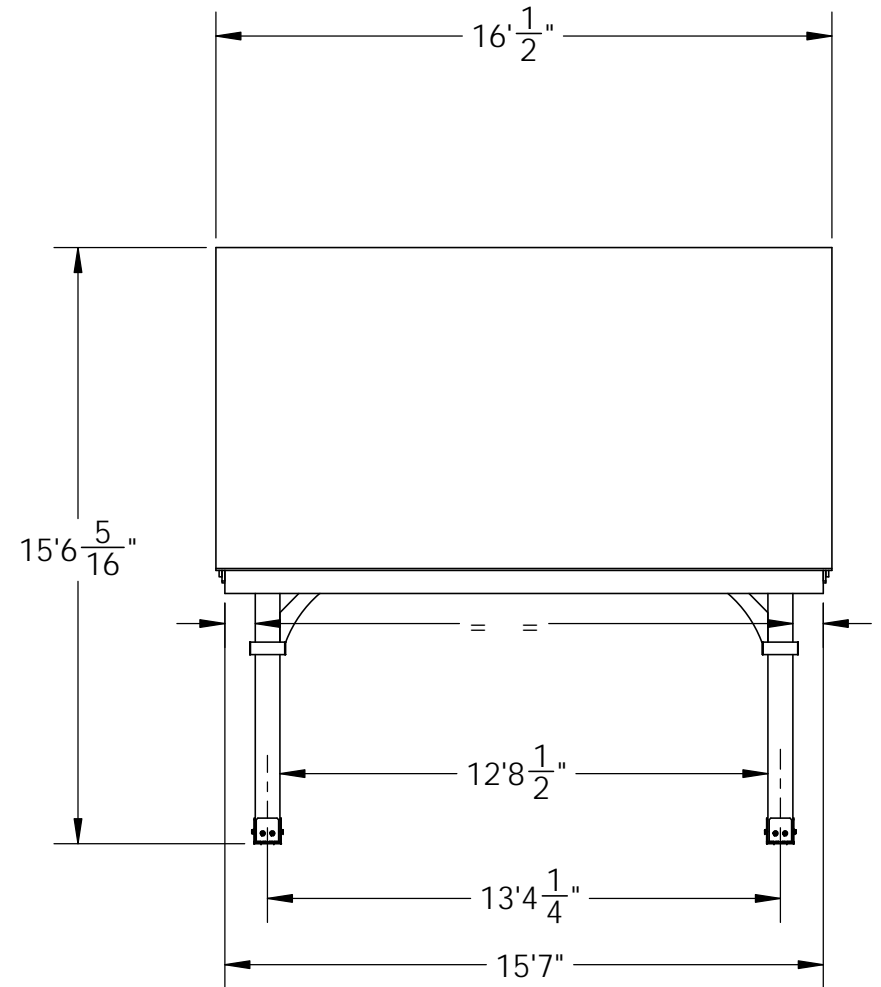
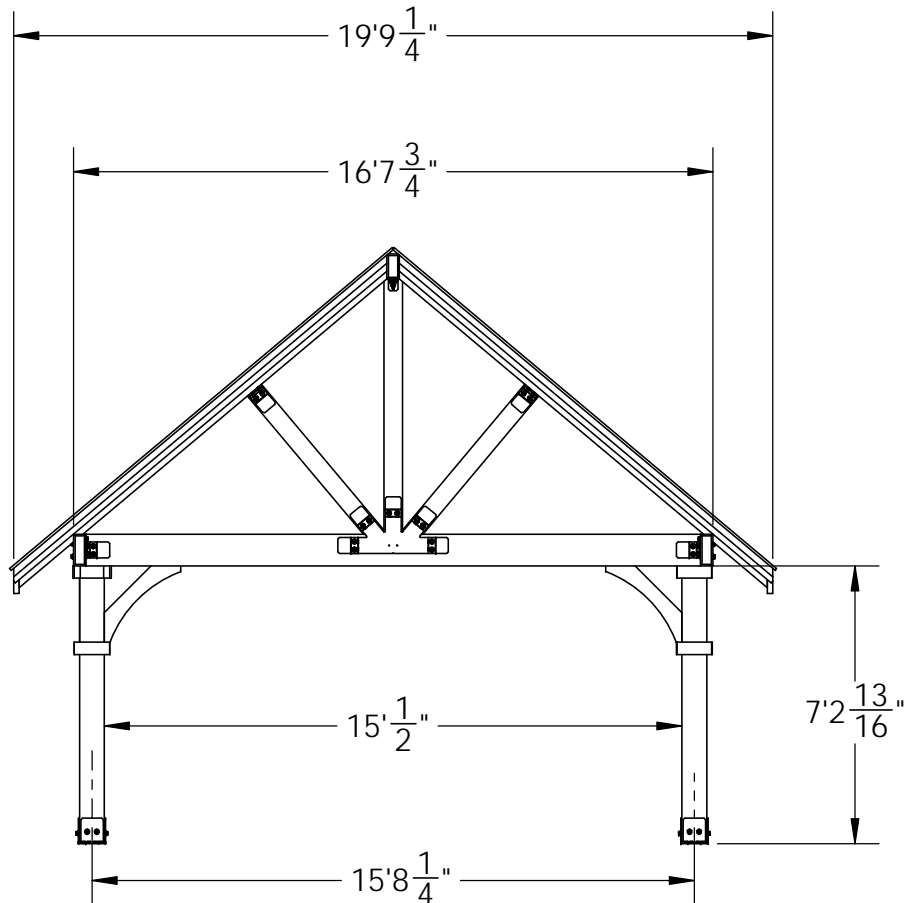

Overview

OZCO Project #212 IW- Pavilion Post and Beam – Free Standing

V2.00 - Installation Instructions, Specifications and Project Plans are effective 3/1/2017 . This information is updated periodically and should not be relied upon after 2 years from 3/1/2017 . Please visit OZCOBP.com to get current information.

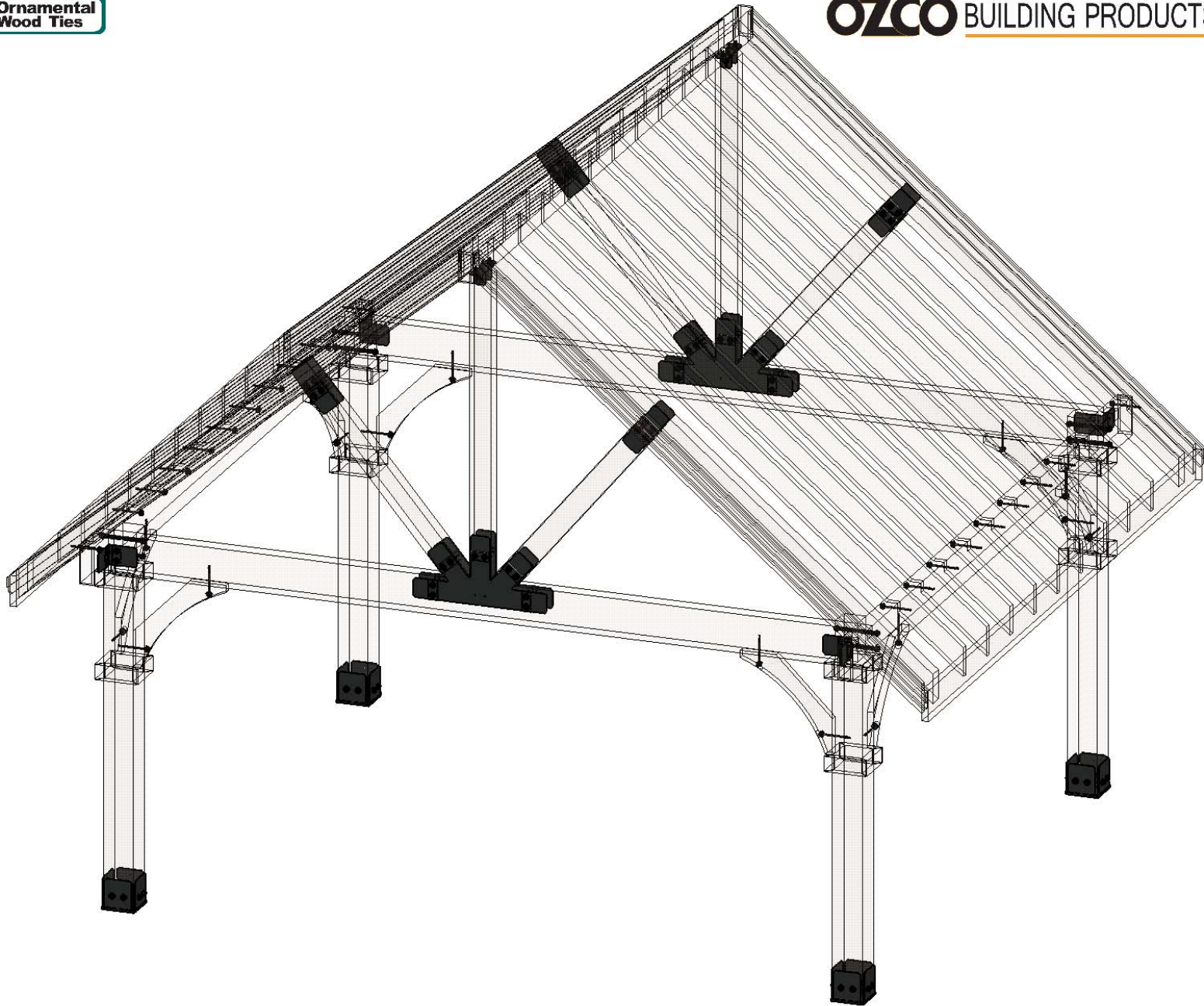

Translucent

OZCO Project #212 IW- Pavilion Post and Beam –
Free Standing

V2.00 - Installation Instructions, Specifications and Project Plans are effective 3/1/2017 . This information is updated periodically and should not be relied upon after 2 years from 3/1/2017 . Please visit OZCOBP.com to get current information.

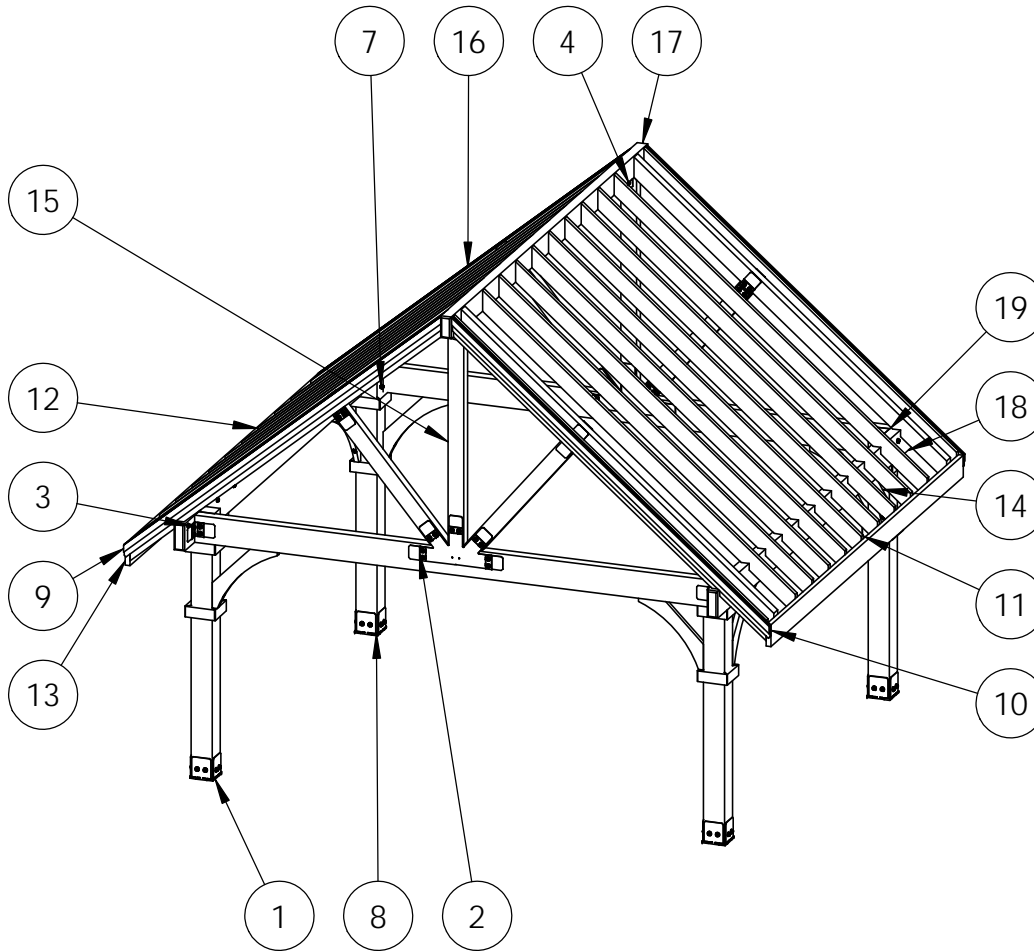

Bill of Material

(shown without roof for clarity)

OZCO Project #212 IW- Pavilion Post and Beam – Free Standing

ITEM NO.	QTY.	PART NUMBER	DESCRIPTION
1	4	51709	8x8 Post Base (8x8-PB-IW)
2	4	56620	Truss Base Fan 10:12
	10	51711	Truss Accent (TA-IW)
	1	56625	OWT Timber Screw 1-3/4"
3	2	56629	Screw, OWT 7-1/2" (190mm) Timber with HCN
	4	56621	1" Hex Cap Nut (HCN-1)
4	1	51718	4" Standard Rafter Clips (RC-IW-4)
5	2	56615	Flush Inside 90 (FI-90)
	4	51711	Truss Accent (TA-IW)
	1	56625	OWT Timber Screw 1-3/4"
6	8	56613	Butt Joint Flush (BJF)
	16	51711	Truss Accent (TA-IW)
	2	56625	OWT Timber Screw 1-3/4"
7	4	56651	OWT Timber Bolt 8-10"
8	4	8x8 Cedar Post	8x8x8'0"
9	4	1x2 Cedar Board	1x2x16'0"
10	4	1x4 Cedar Board	1x4x16'0"
11	32	2x4 Cedar Board	2x4x10 3/4"
12	22	2x6 Cedar Board	2x6x16'0"
13	2	2x8 Cedar Board	2x8x16'0"
14	8	2x8 Cedar Board	2x8x4'0"
15	6	4x6 Cedar Board	4x6x8'0"
16	4	4x6 Cedar Board	4x6x16'0"
17	1	4x8 Cedar Board	4x8x16'0"
18	2	4x10 Cedar Board	4x10x16'0"
19	2	4x10 Cedar Board	4x10x16'0"

QTY.	PART NUMBER	DESCRIPTION
4	51709	8x8 Post Base (8x8-PB-IW)
4	56620	Truss Base Fan 10:12
16	51711	Truss Accent (TA-IW)
3	56625	OWT Timber Screw 1-3/4"
2	56629	Screw, OWT 7-1/2" (190mm) Timber with HCN
4	56621	1 1/2" Hex Cap Nut (HCN)
1	51718	4" Standard Rafter Clip (RC-IW-4)
2	56615	Flush Inside 90
4	56613	Butt Joint Flush (BJF)
4	56651	OWT Timber Bolt 8-10"
4	8x8x8L	8x8x8
4	1x2x16L	1x2x16
4	1x4x16L	1x4x16
4	2x4x8L	2x4x8
22	2x6x16L	2x6x16
2	2x8x16L	2x8x16
4	2x8x8L	2x8x8
6	4x6x8L	4x6x8
4	4x6x16L	4x6x16
1	4x8x16L	4x8x16
4	4x10x16L	4x10x16

Material List

OZCO Project #212 IW- Pavilion Post and Beam – Free Standing

V2.00 - Installation Instructions, Specifications and Project Plans are effective 3/13/2018 . This information is updated periodically and should not be relied upon after 2 years from 3/13/2018 . Please visit OZCOBP.com to get current information.

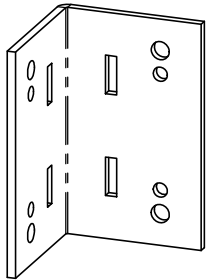

56615

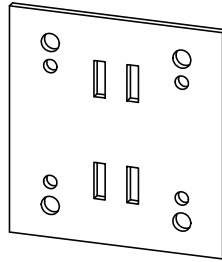

56613

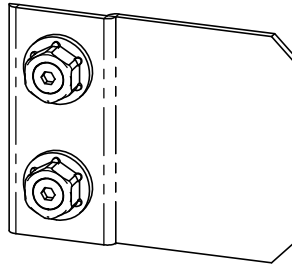

51711

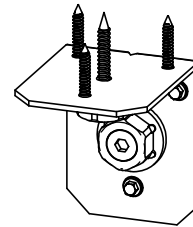

51718

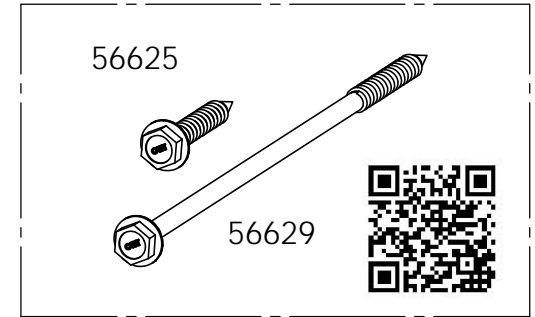

56625

56629

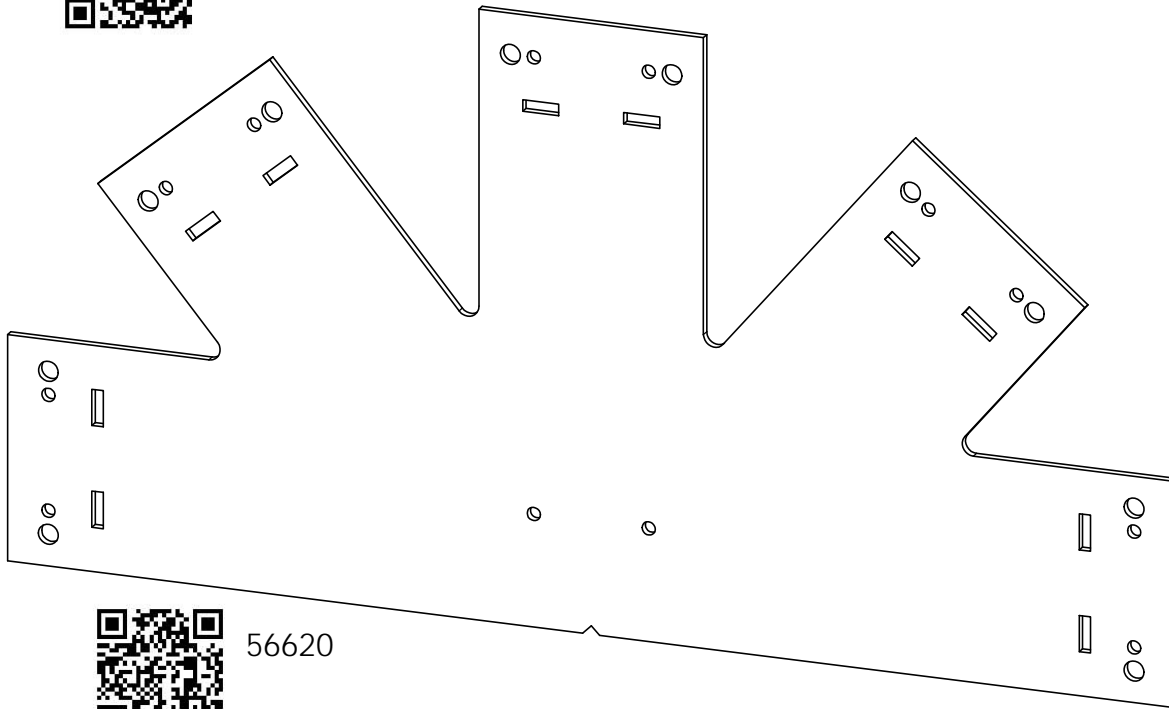

56620

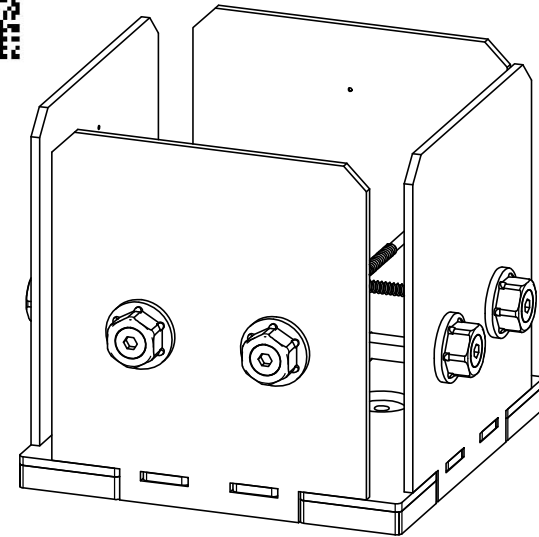

51709



56651

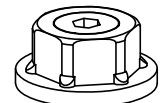

56621



OZCO

OZCO Project #212 IW- Pavilion Post and Beam – Free
Standing

V2.00 - Installation Instructions, Specifications and Project Plans are effective 3/1/2017 . This information is updated periodically and should not be relied upon after 2 years from 3/1/2017 . Please visit OZCOBP.com to get current information.



V2.00 - Installation Instructions, Specifications and Project Plans are effective 3/1/2017 . This information is updated periodically and should not be relied upon after 2 years from 3/1/2017 . Please visit OZCOBP.com to get current information.

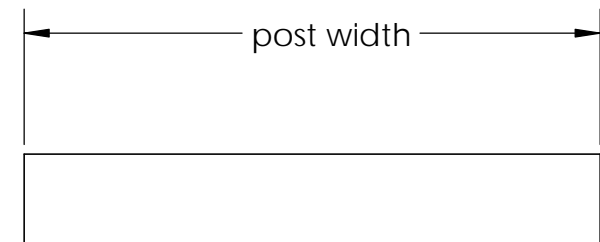
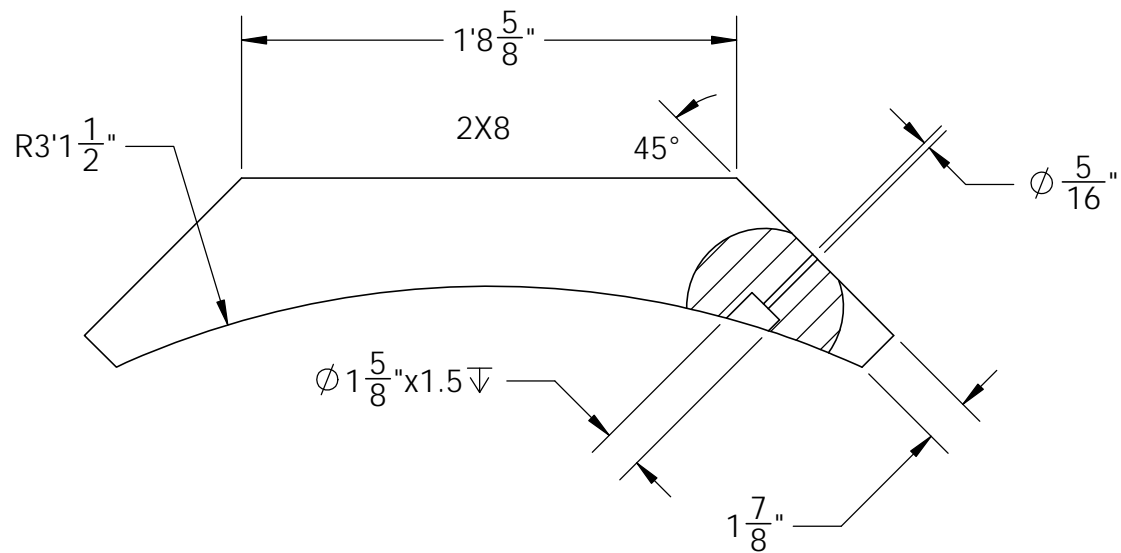

2X4

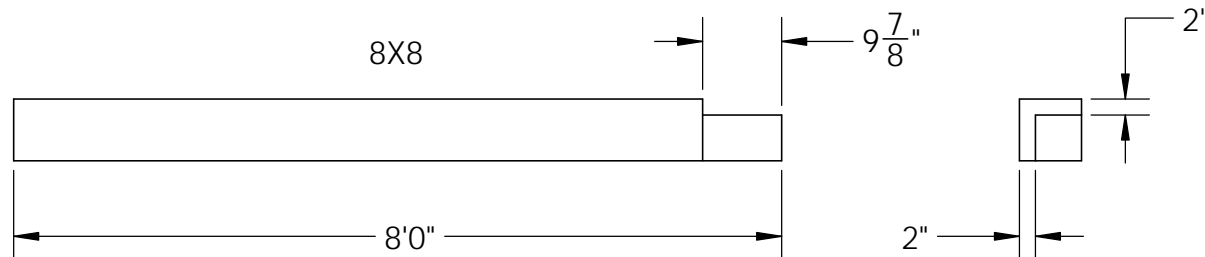

Cutlist1

OZCO Project #212 IW- Pavilion Post and Beam – Free Standing

V2.00 - Installation Instructions, Specifications and Project Plans are effective 3/1/2017 . This information is updated periodically and should not be relied upon after 2 years from 3/1/2017 . Please visit OZCOBP.com to get current information.

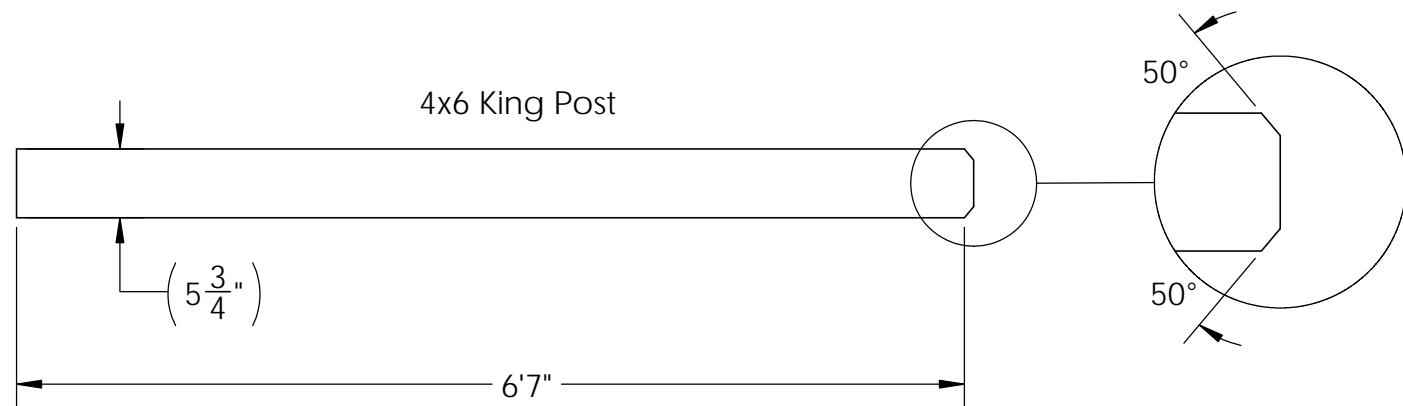
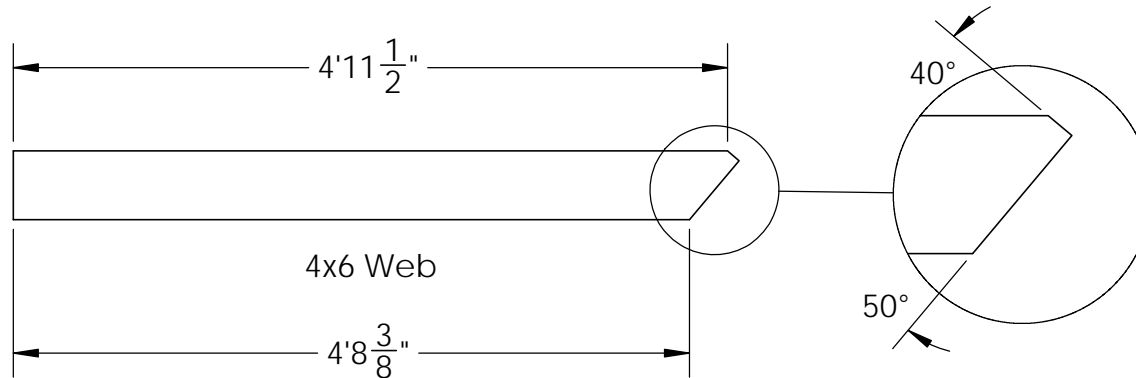
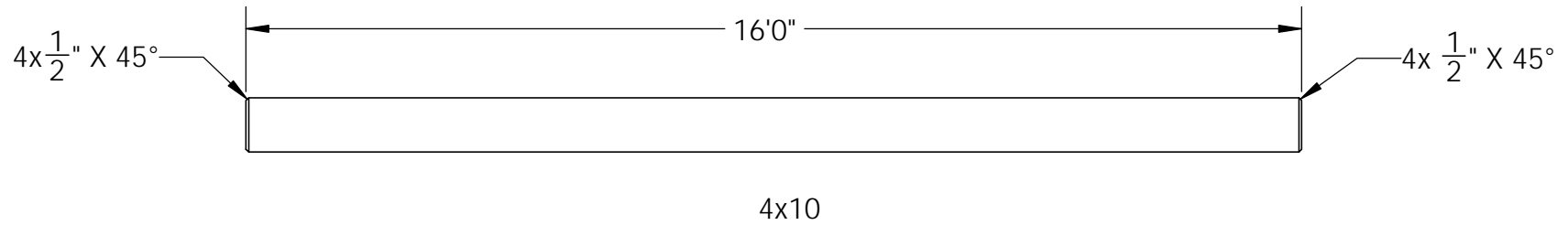

Cutlist2

OZCO Project #212 IW- Pavilion Post and Beam – Free Standing

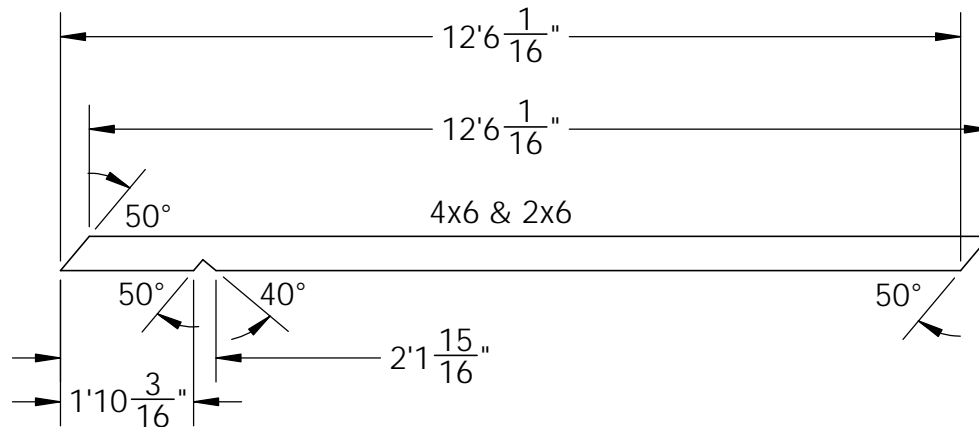
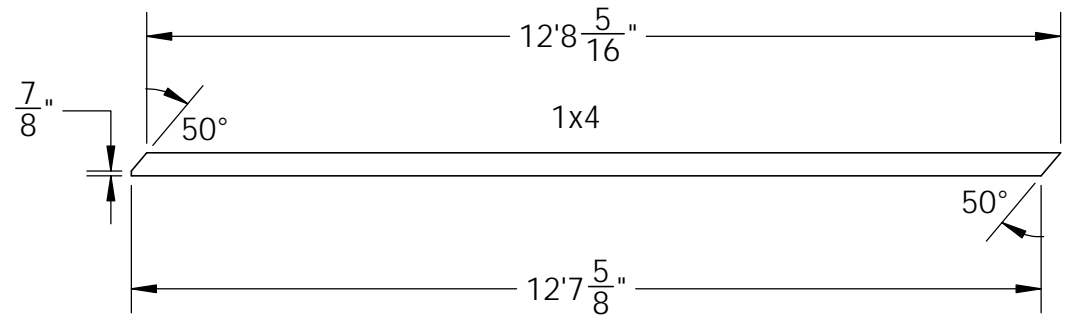
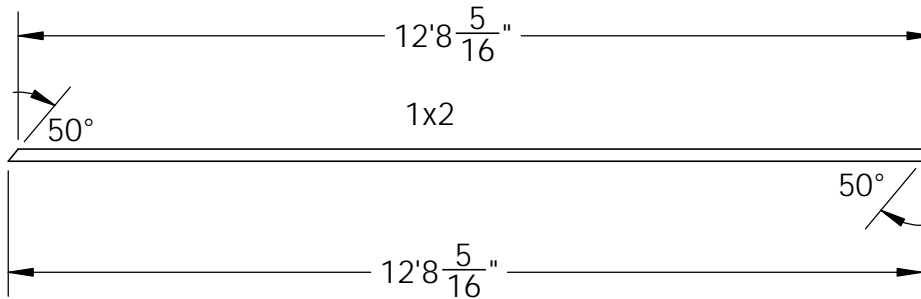

Cutlist3

OZCO Project #212 IW- Pavilion Post and Beam – Free Standing

V2.00 - Installation Instructions, Specifications and Project Plans are effective 3/1/2017 . This information is updated periodically and should not be relied upon after 2 years from 3/1/2017 . Please visit OZCOBP.com to get current information.

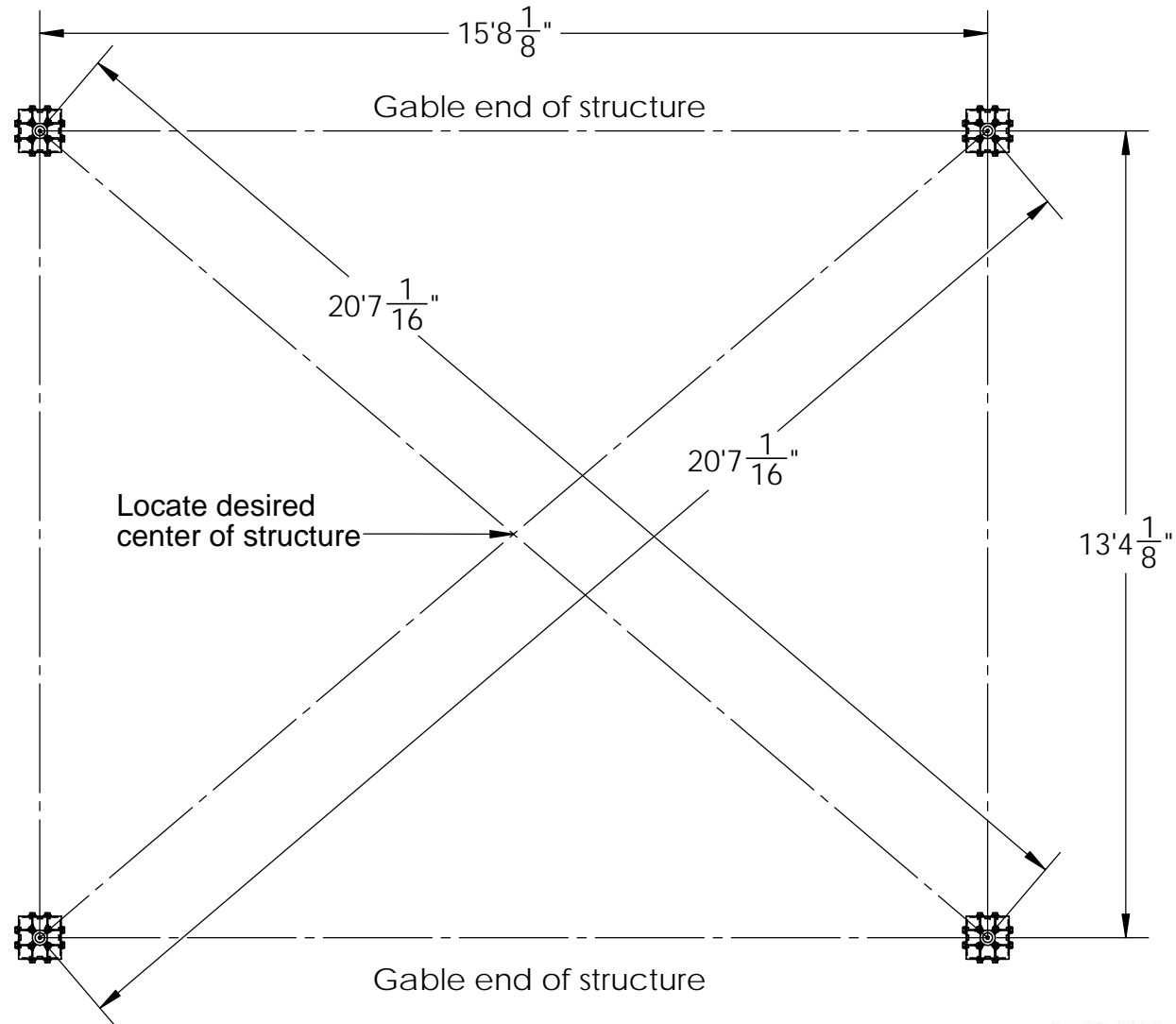

if site is not level,
see Ozco Site Leveling instruction



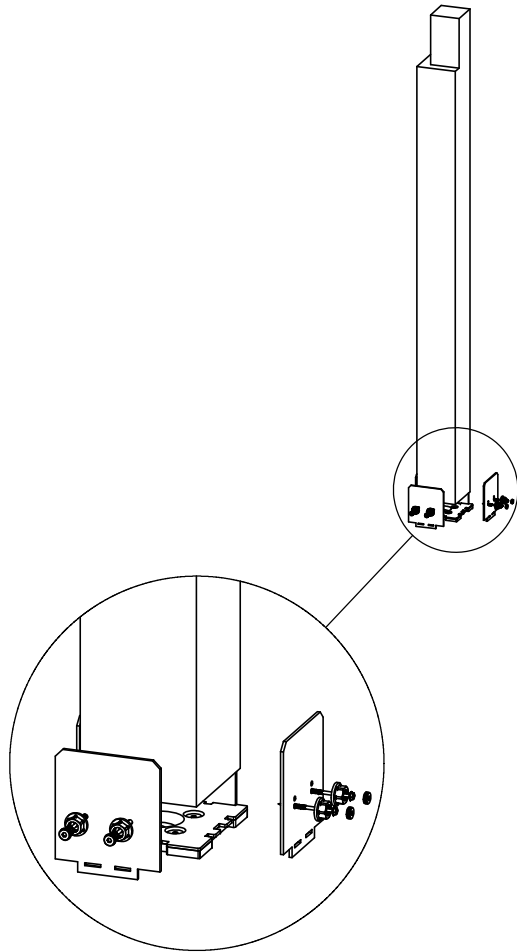

note post orientation

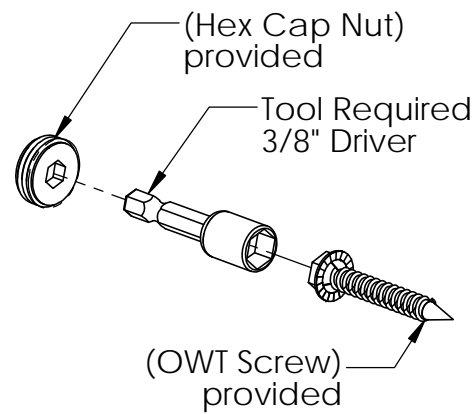

step 1

**OZCO Project #212 IW- Pavilion Post and
Beam – Free Standing**

V2.00 - Installation Instructions, Specifications and Project Plans are effective 3/1/2017 . This information is updated periodically and should not be relied upon after 2 years from 3/1/2017 . Please visit OZCOBP.com to get current information.

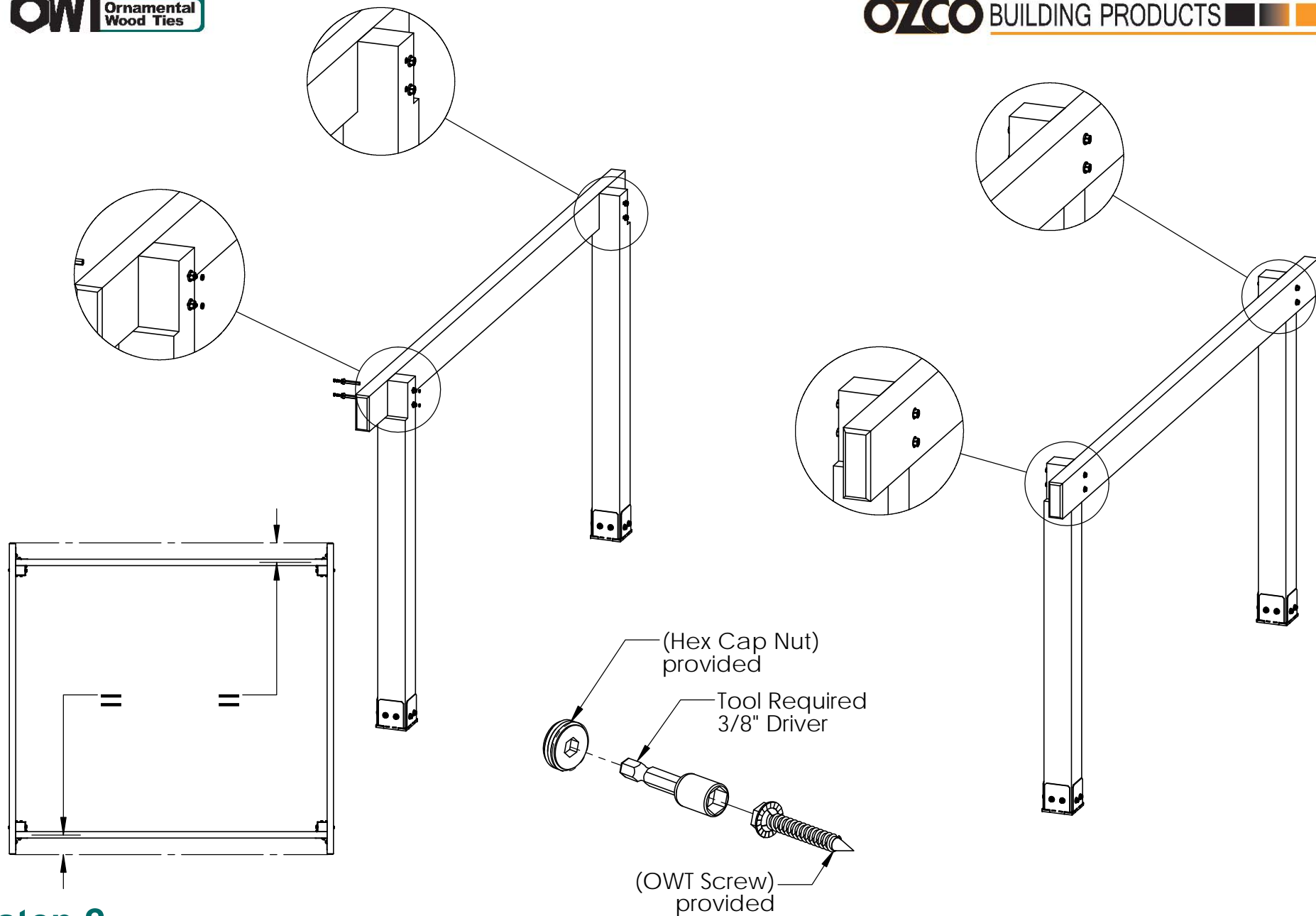

step 2

**OZCO Project #212 IW- Pavilion Post and
Beam – Free Standing**

V2.00 - Installation Instructions, Specifications and Project Plans are effective 3/1/2017 . This information is updated periodically and should not be relied upon after 2 years from 3/1/2017 . Please visit OZCOBP.com to get current information.

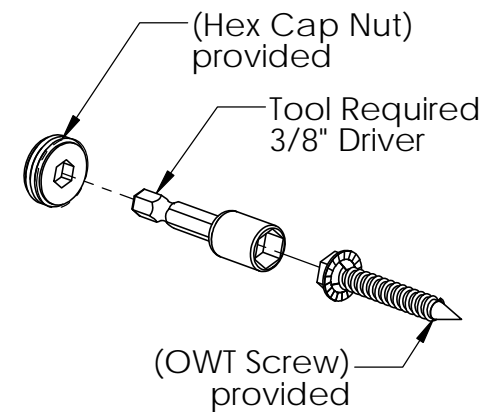
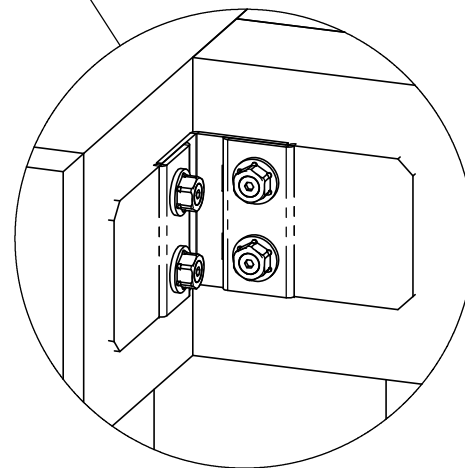
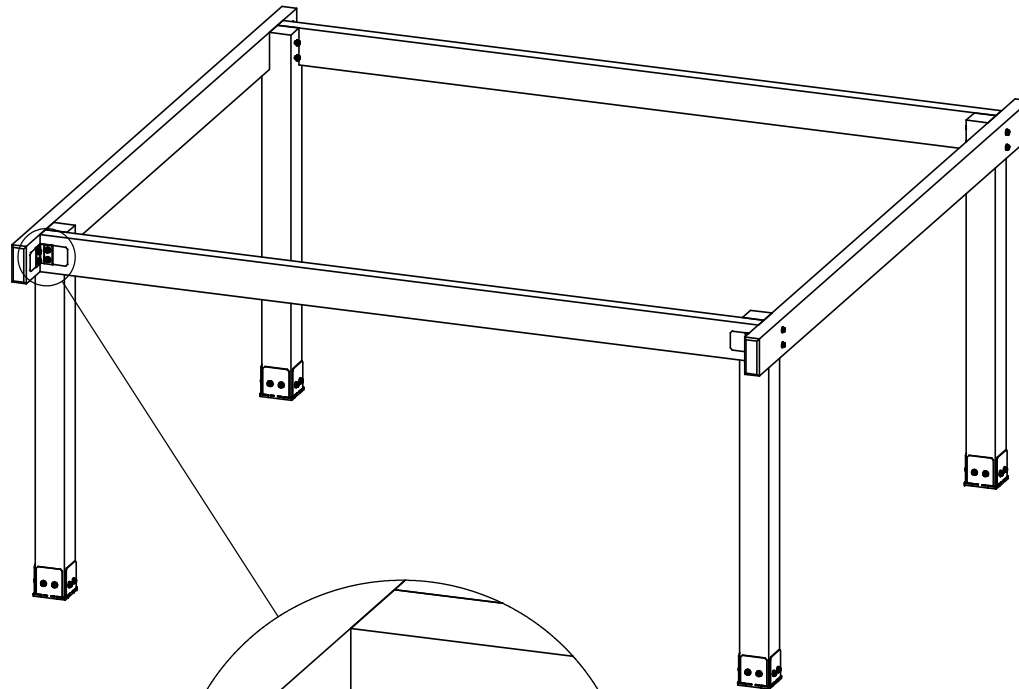

step 3

**OZCO Project #212 IW- Pavilion Post and
Beam – Free Standing**

V2.00 - Installation Instructions, Specifications and Project Plans are effective 3/1/2017 . This information is updated periodically and should not be relied upon after 2 years from 3/1/2017 . Please visit OZCOBP.com to get current information.

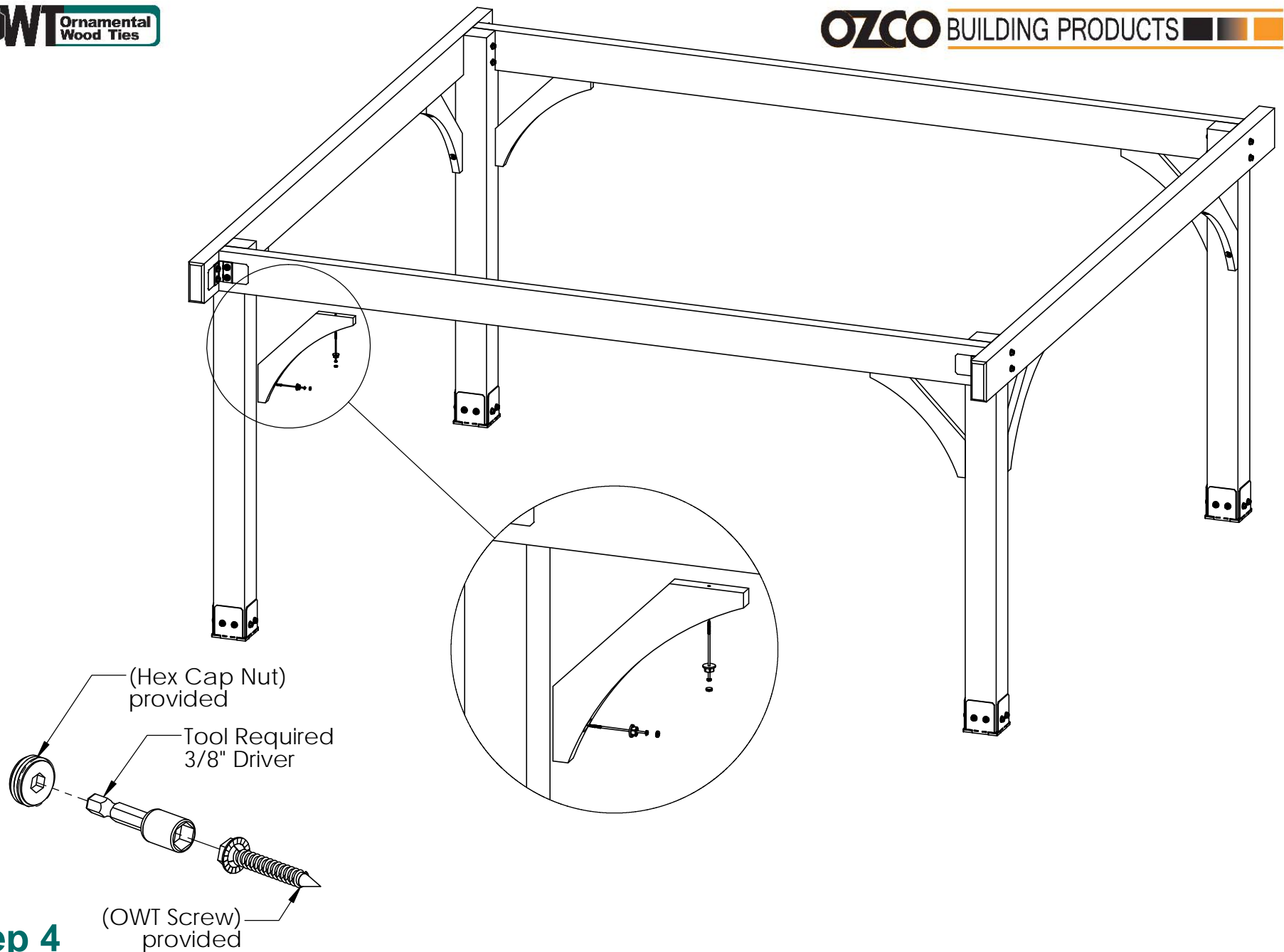

step 4

**OZCO Project #212 IW- Pavilion Post and
Beam – Free Standing**

V2.00 - Installation Instructions, Specifications and Project Plans are effective 3/1/2017 . This information is updated periodically and should not be relied upon after 2 years from 3/1/2017 . Please visit OZCOBP.com to get current information.

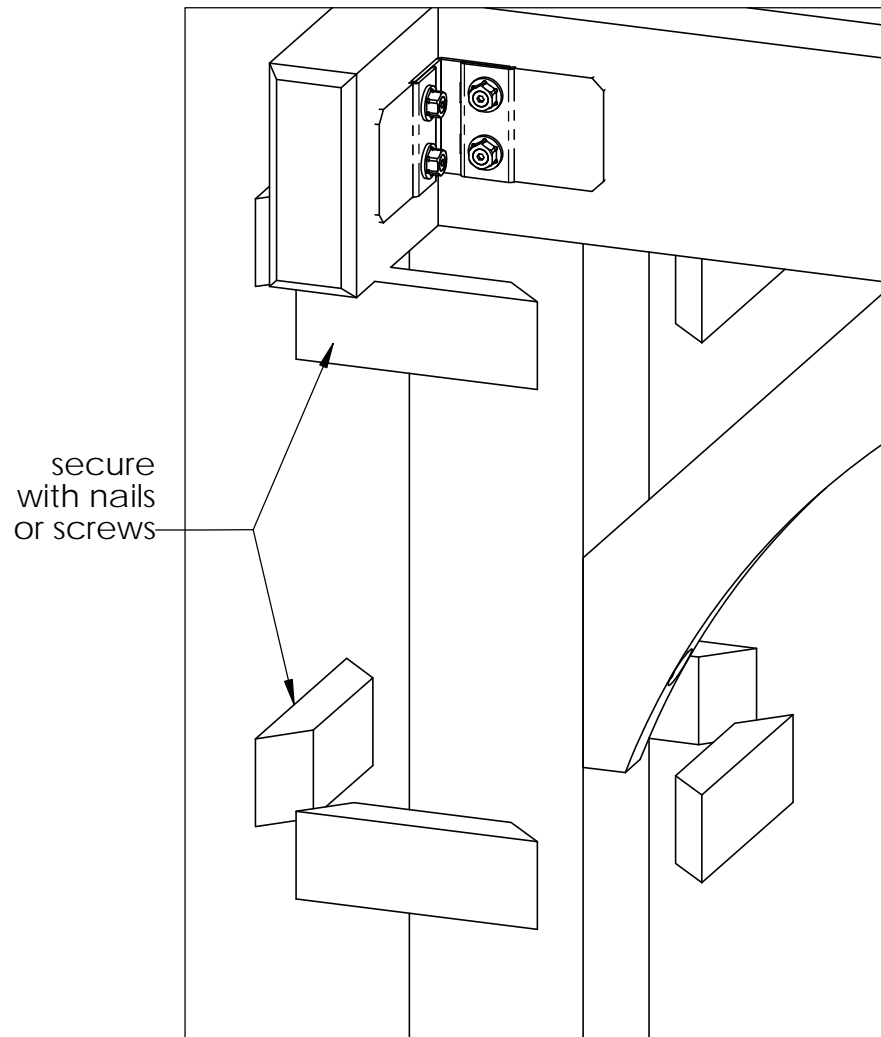

secure with nails or screws

repeat on all posts

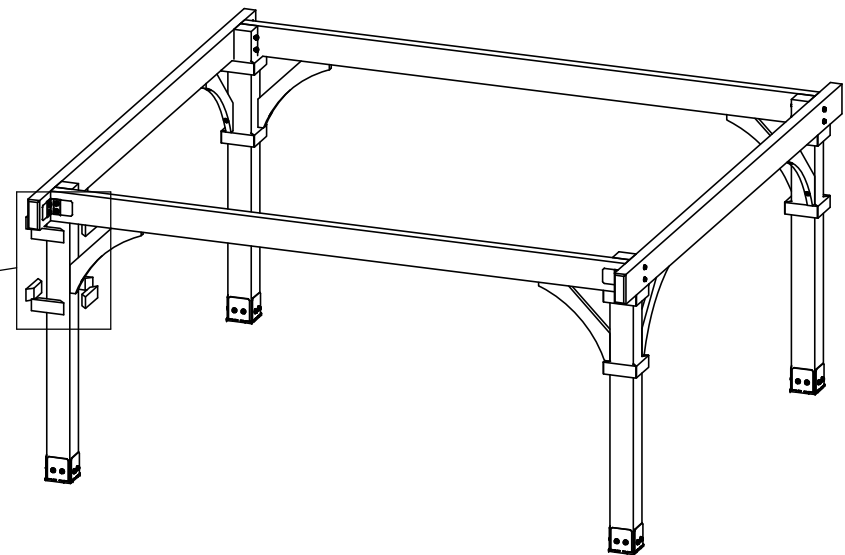

step 5

OZCO Project #212 IW- Pavilion Post and Beam – Free Standing

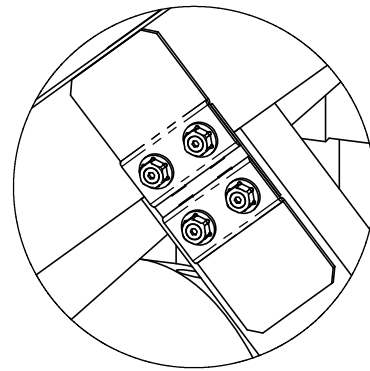

repeat connectors on
backside of Truss

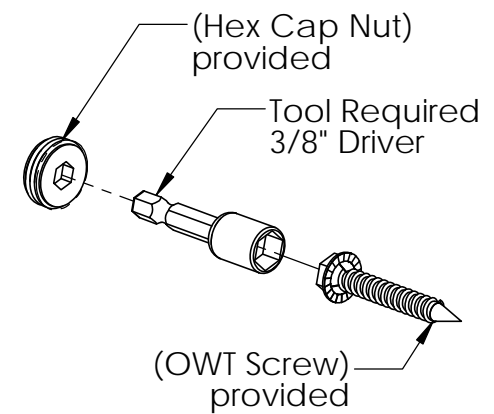
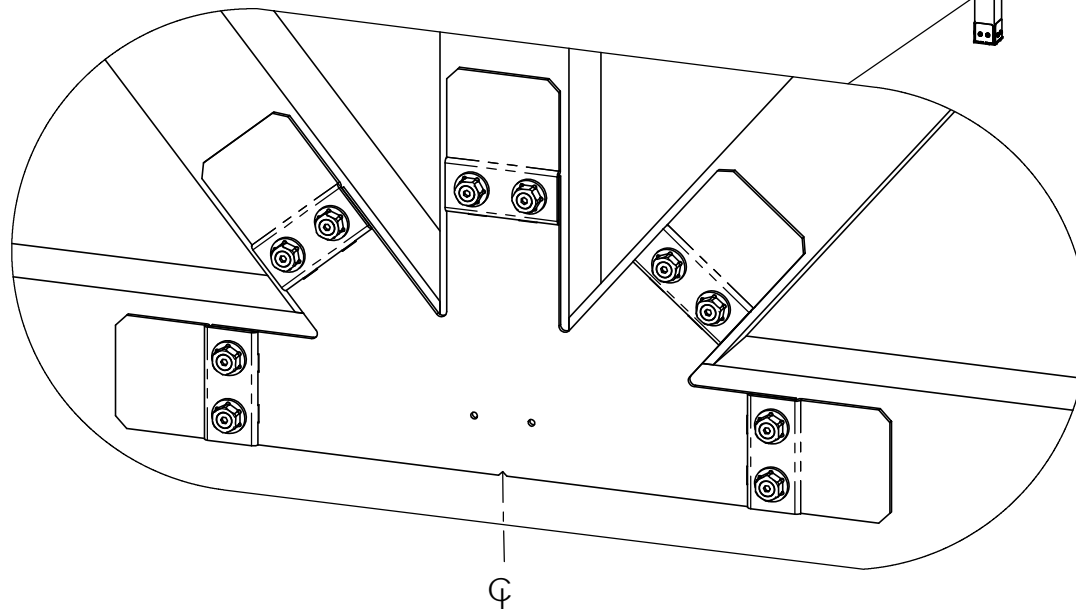
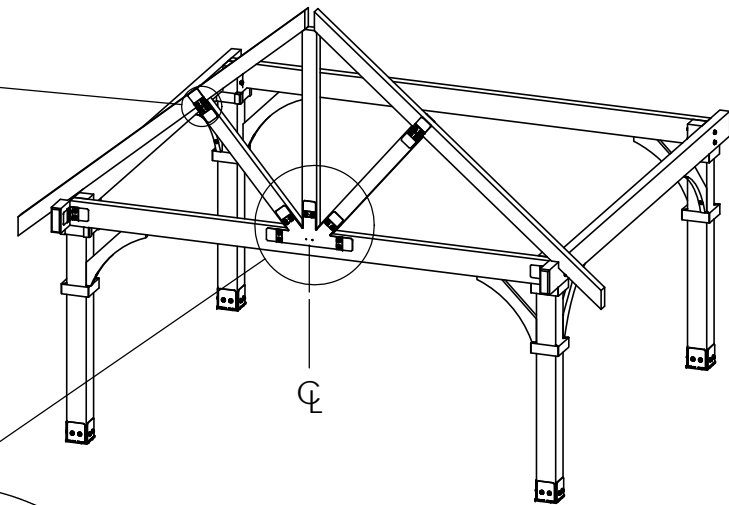

step 6

**OZCO Project #212 IW- Pavilion Post and
Beam – Free Standing**

V2.00 - Installation Instructions, Specifications and Project Plans are effective 3/1/2017 . This information is updated periodically and should not be relied upon after 2 years from 3/1/2017 . Please visit OZCOBP.com to get current information.

repeat step 6 on opposite end

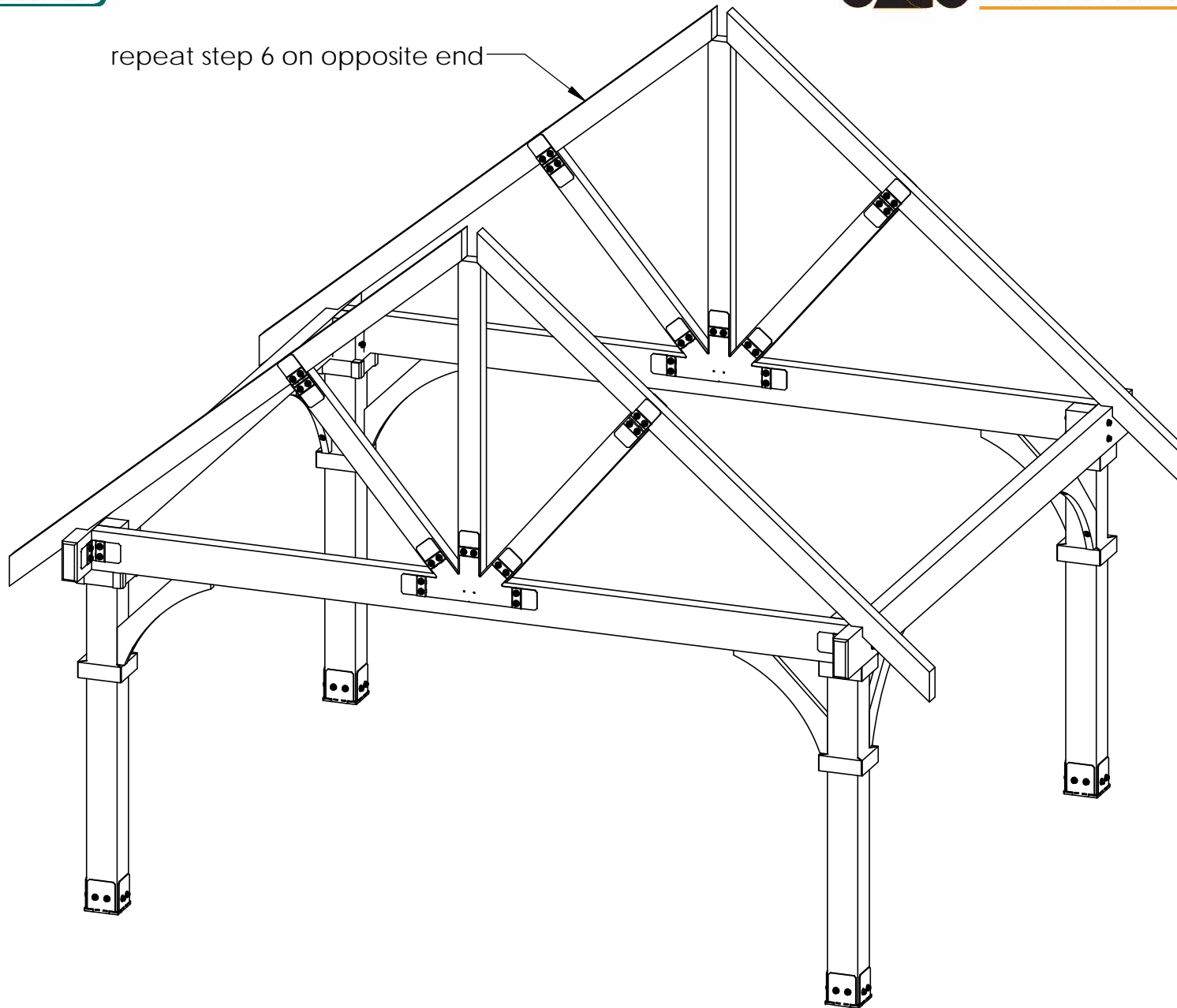

step 7

OZCO Project #212 IW- Pavilion Post and Beam – Free Standing

V2.00 - Installation Instructions, Specifications and Project Plans are effective 3/1/2017 . This information is updated periodically and should not be relied upon after 2 years from 3/1/2017 . Please visit OZCOBP.com to get current information.

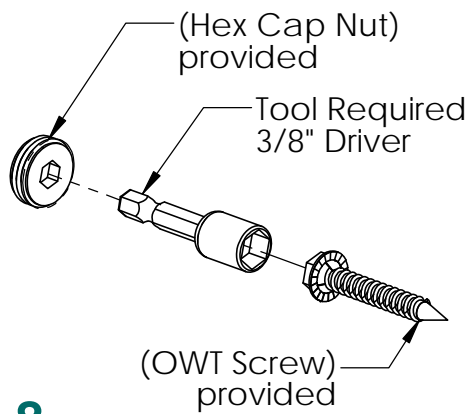
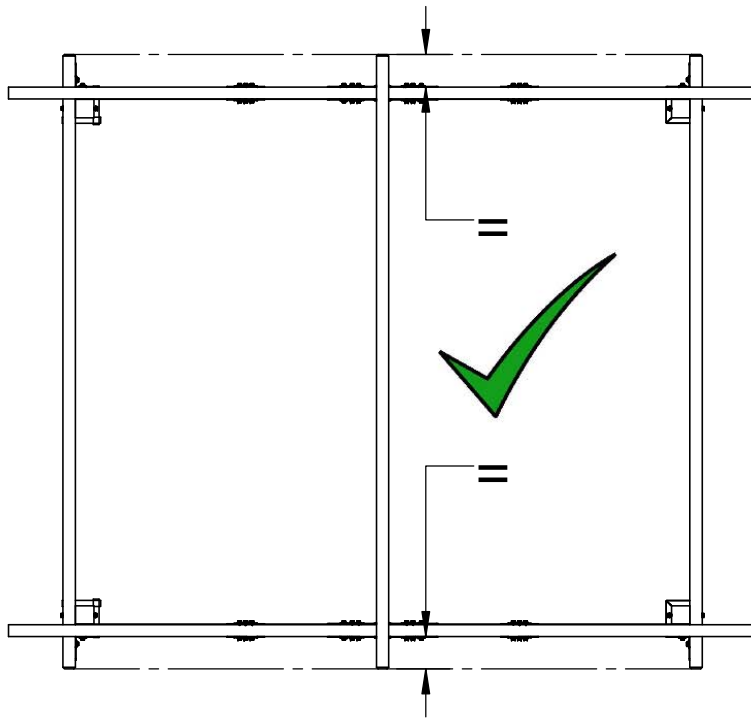

step 8

OZCO Project #212 IW- Pavilion Post and Beam – Free Standing

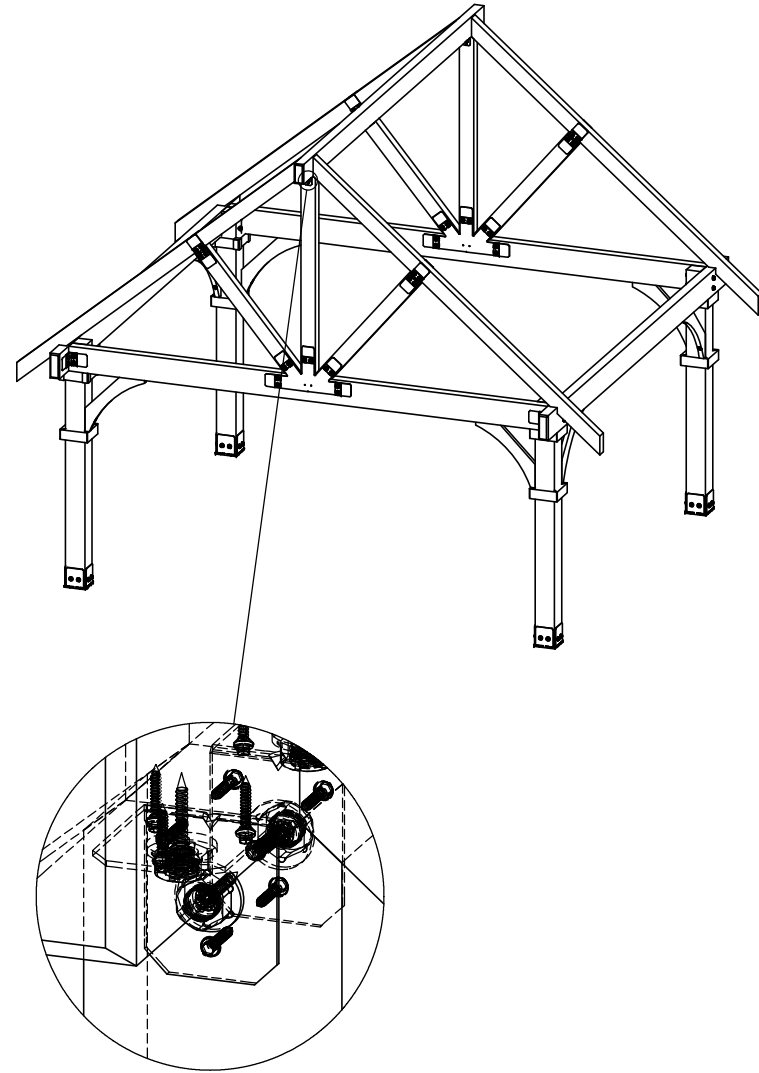

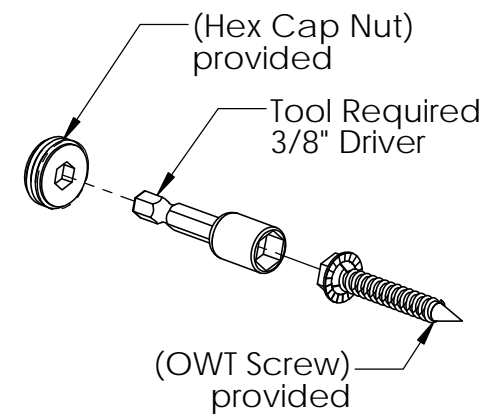
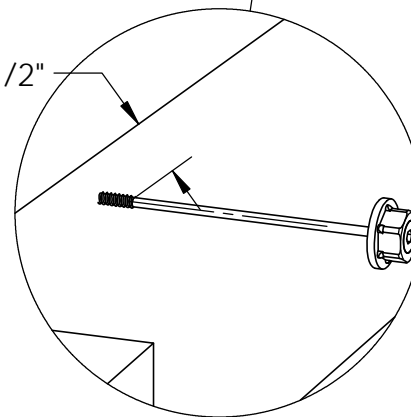
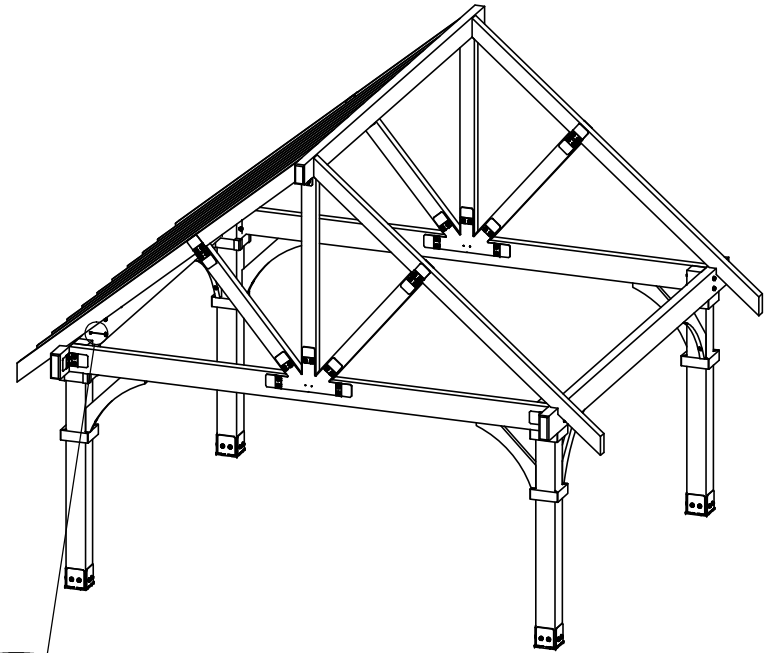
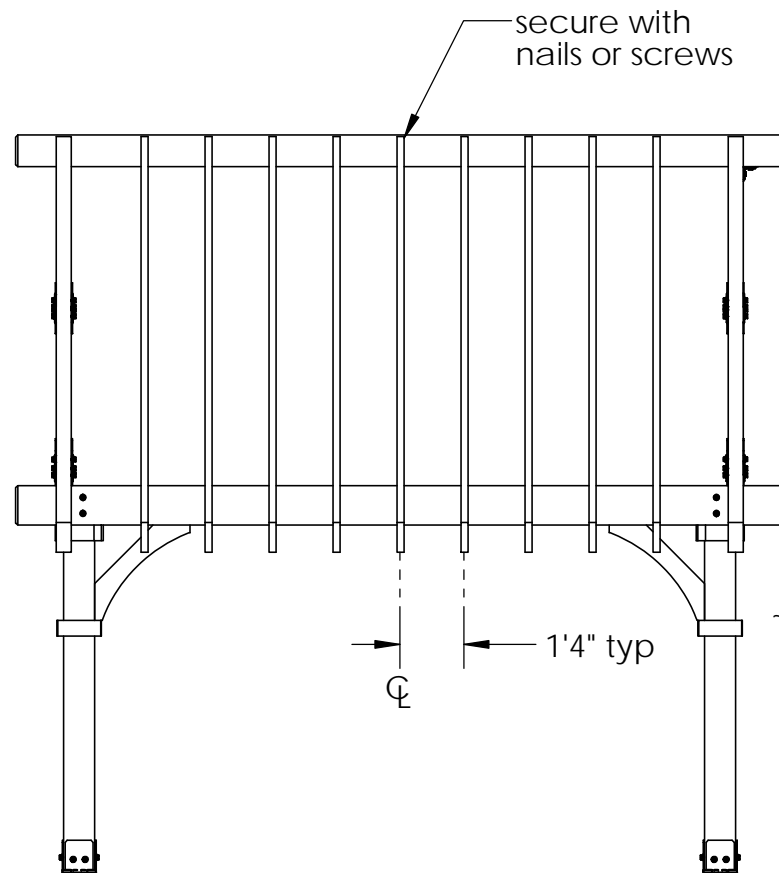

step 9

**OZCO Project #212 IW- Pavilion Post and
Beam – Free Standing**

V2.00 - Installation Instructions, Specifications and Project Plans are effective 3/1/2017 . This information is updated periodically and should not be relied upon after 2 years from 3/1/2017 . Please visit OZCOBP.com to get current information.

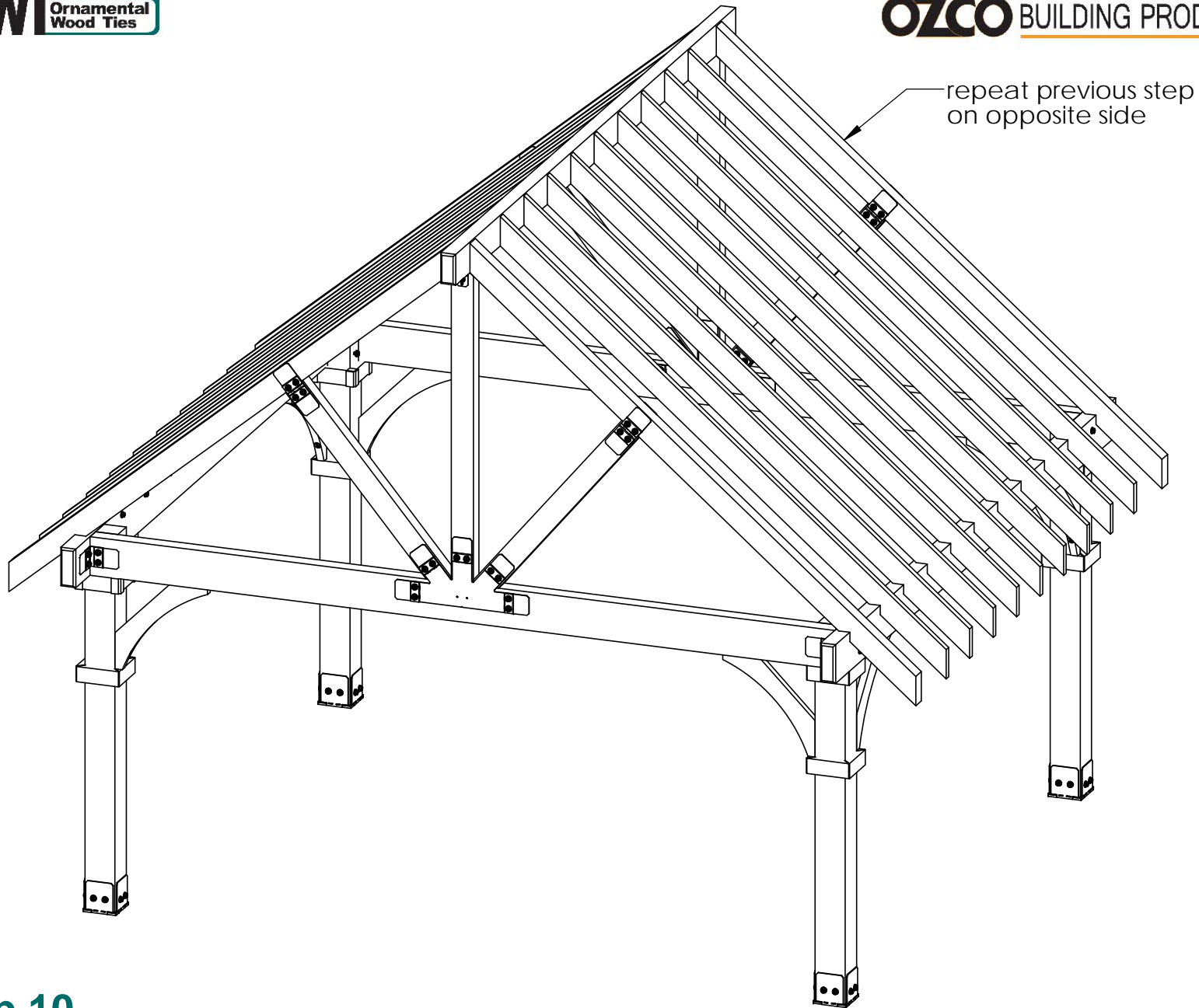

step 10

OZCO Project #212 IW- Pavilion Post and Beam – Free Standing

V2.00 - Installation Instructions, Specifications and Project Plans are effective 3/1/2017 . This information is updated periodically and should not be relied upon after 2 years from 3/1/2017 . Please visit OZCOBP.com to get current information.

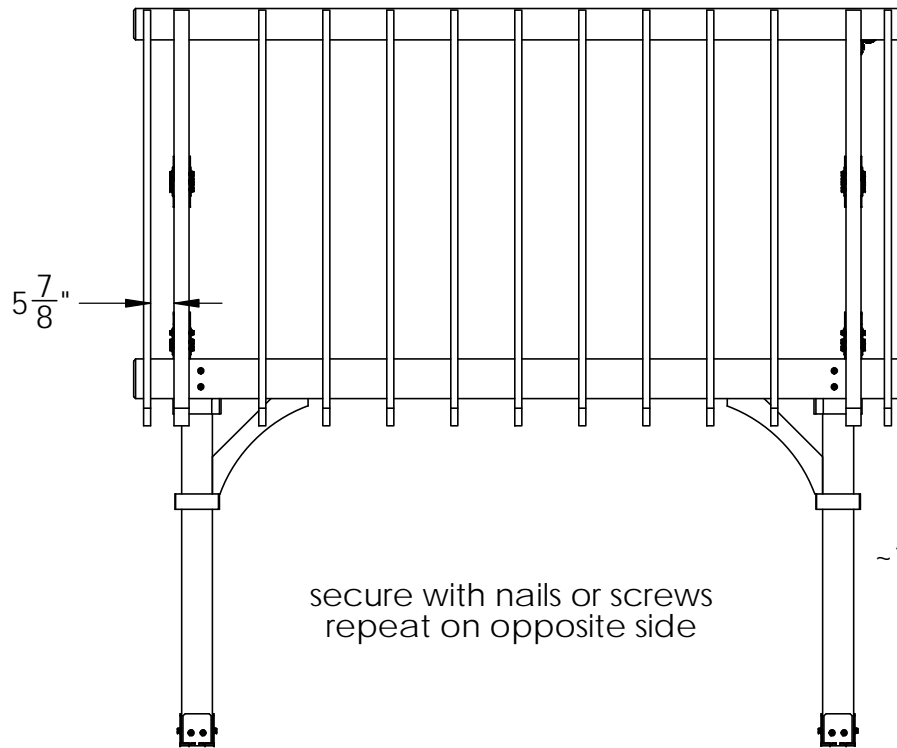

secure with nails or screws
repeat on opposite side

~1-1/2"

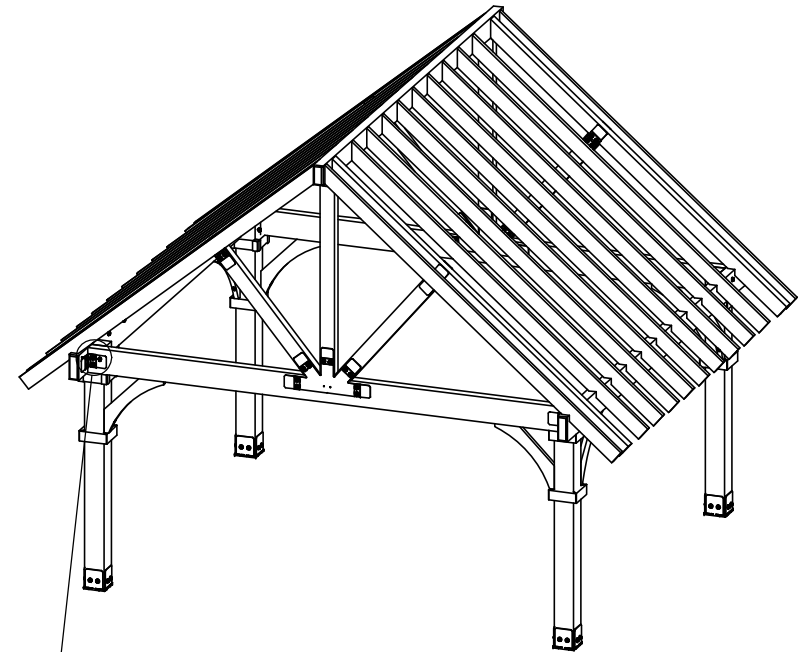
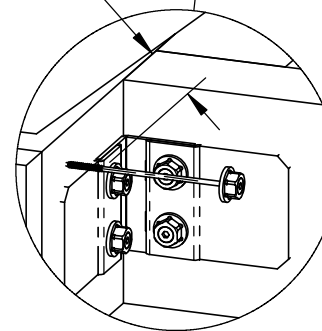

(Hex Cap Nut)
provided

Tool Required
3/8" Driver

(OWT Screw)
provided

step 11

**OZCO Project #212 IW- Pavilion Post and
Beam – Free Standing**

V2.00 - Installation Instructions, Specifications and Project Plans are effective 3/1/2017 . This information is updated periodically and should not be relied upon after 2 years from 3/1/2017 . Please visit OZCOBP.com to get current information.

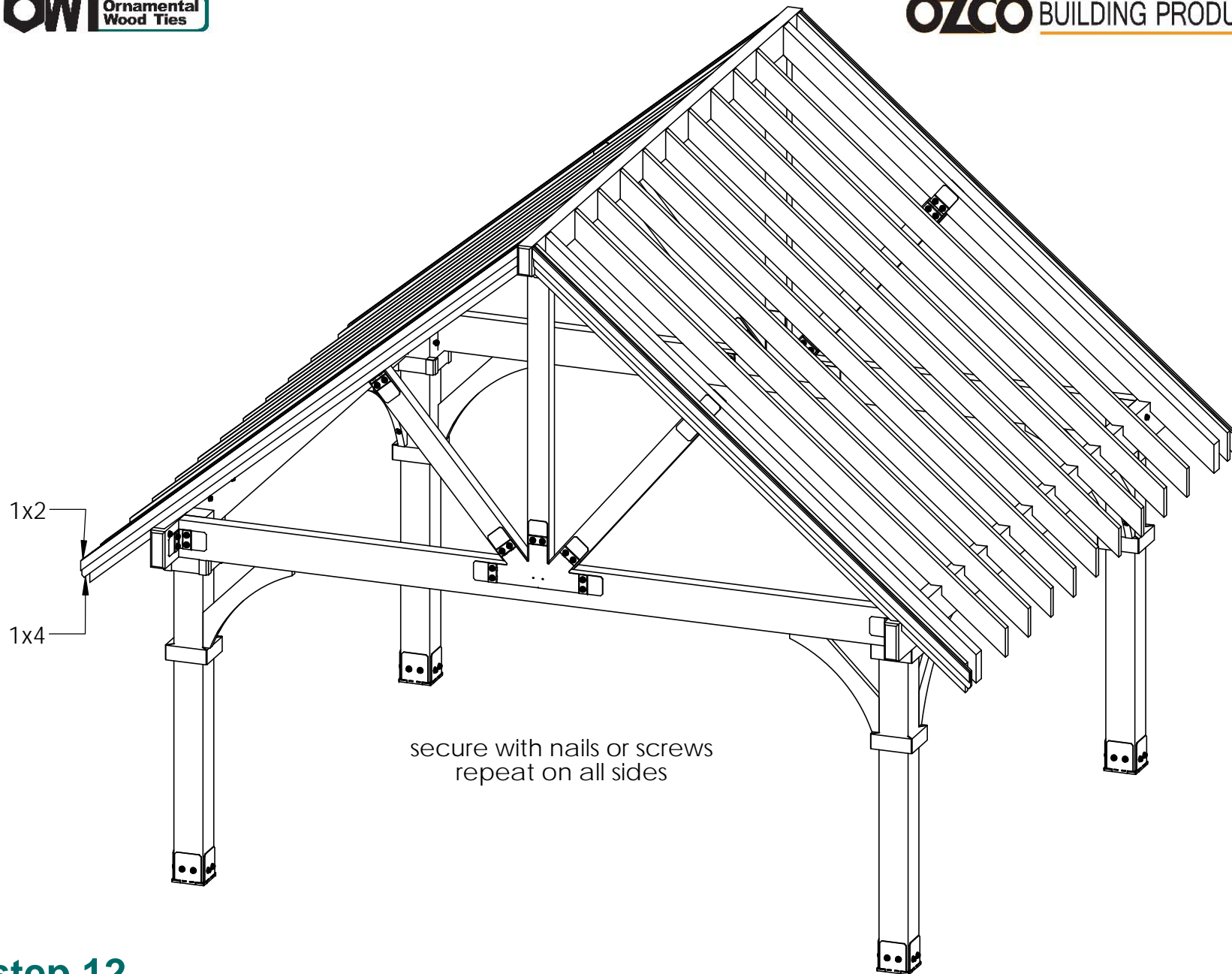

step 12

**OZCO Project #212 IW- Pavilion Post and
Beam – Free Standing**

V2.00 - Installation Instructions, Specifications and Project Plans are effective 3/1/2017 . This information is updated periodically and should not be relied upon after 2 years from 3/1/2017 . Please visit OZCOBP.com to get current information.

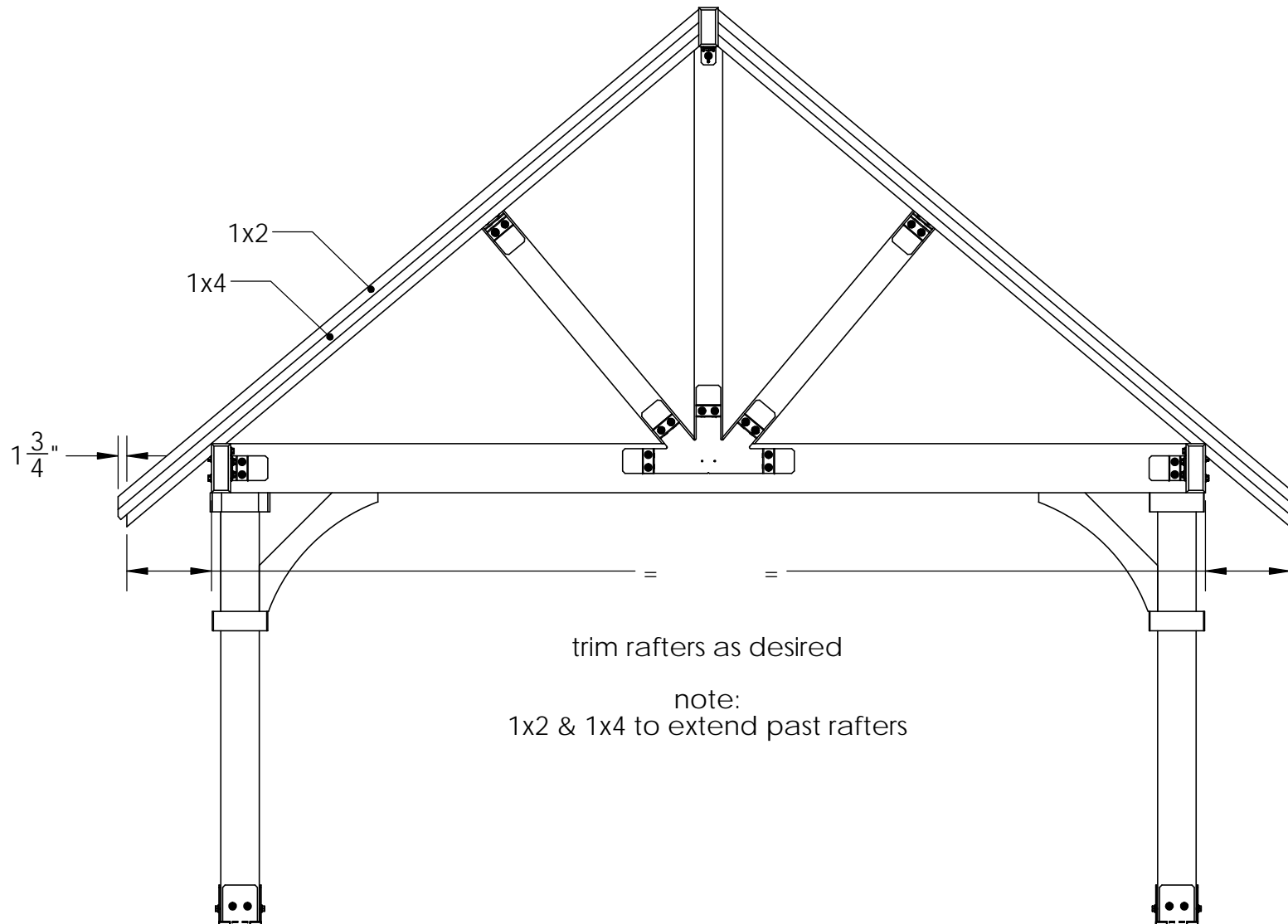

step 13

OZCO Project #212 IW- Pavilion Post and Beam – Free Standing

V2.00 - Installation Instructions, Specifications and Project Plans are effective 3/1/2017 . This information is updated periodically and should not be relied upon after 2 years from 3/1/2017 . Please visit OZCOBP.com to get current information.

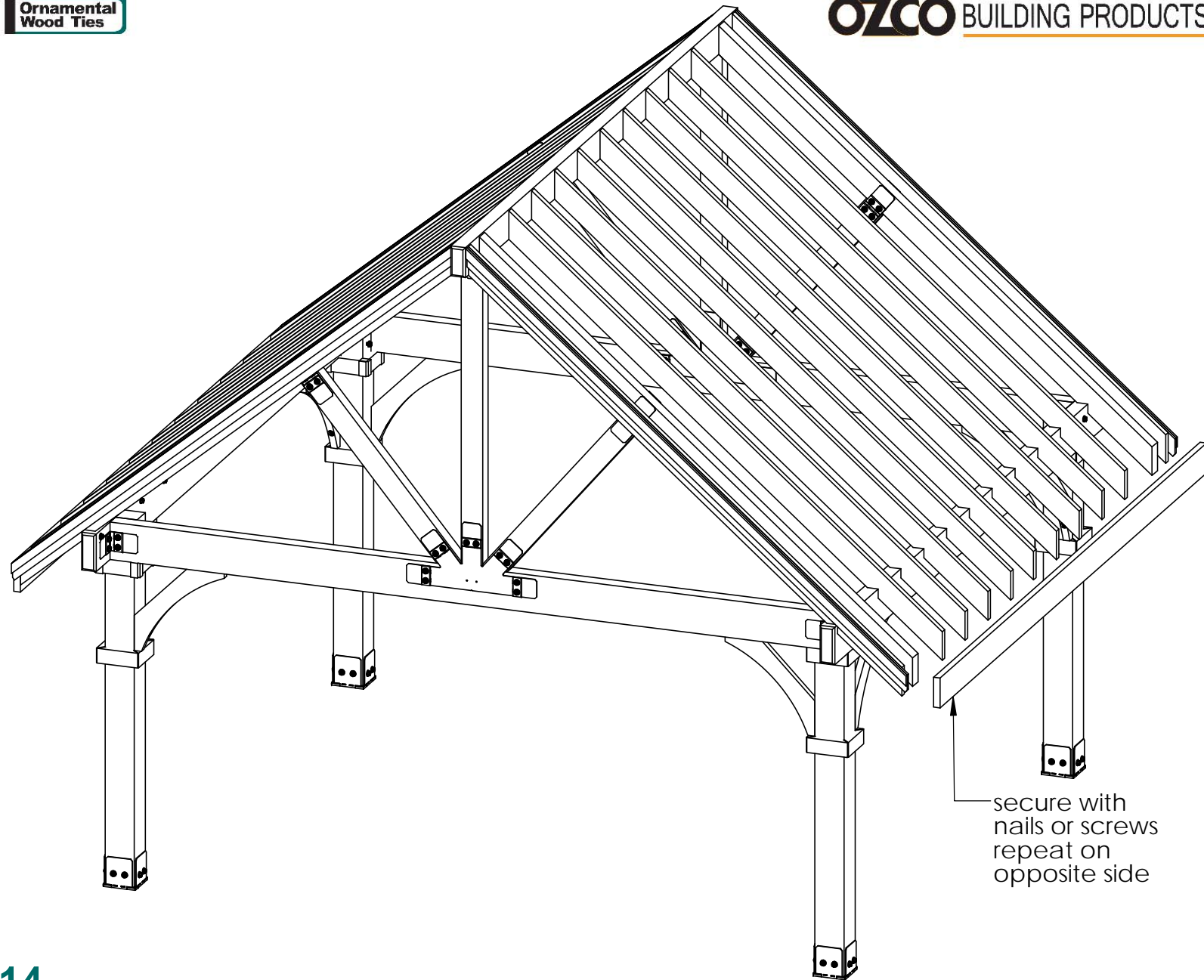

step 14

**OZCO Project #212 IW- Pavilion Post and
Beam – Free Standing**

V2.00 - Installation Instructions, Specifications and Project Plans are effective 3/1/2017 . This information is updated periodically and should not be relied upon after 2 years from 3/1/2017 . Please visit OZCOBP.com to get current information.



shown with plywood and shingle roofing option

Roofing Option

OZCO Project #212 IW- Pavilion Post and Beam – Free Standing

V2.00 - Installation Instructions, Specifications and Project Plans are effective 3/1/2017 . This information is updated periodically and should not be relied upon after 2 years from 3/1/2017 . Please visit OZCOBP.com to get current information.

Ian's Concept

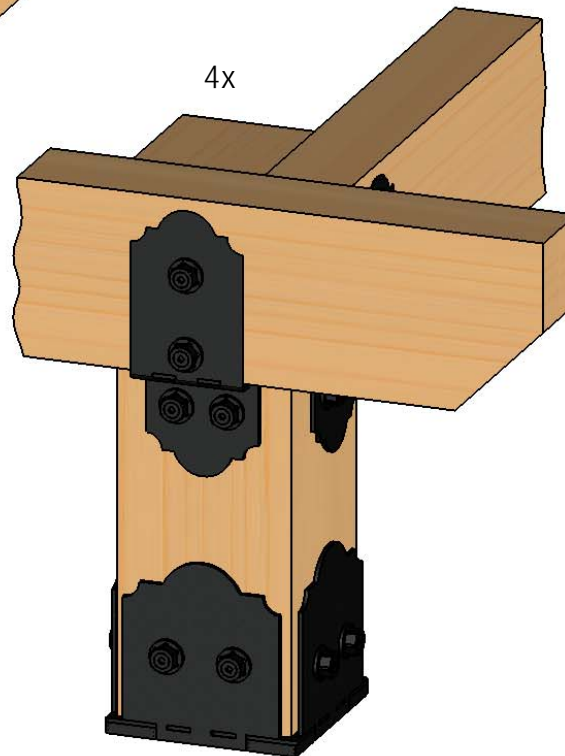
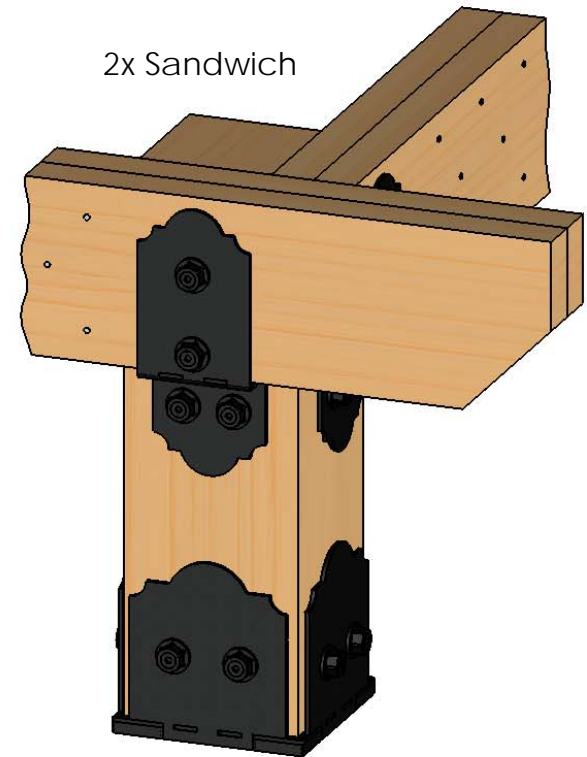
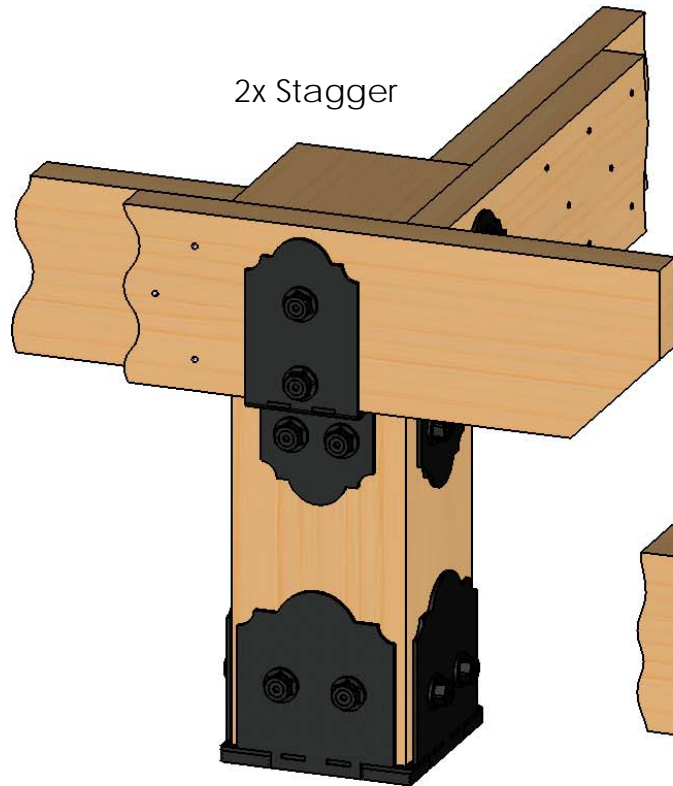
4x Beam Installation

- 3 style choices
- When 4x lumber not available or cost effective
- see subsequent pages for details on each style

see product installation instructions for hardware installation



OZCO BUILDING PRODUCTS

polyurethane adhesive, clamp & nail

no post cuts

3" nail as desired

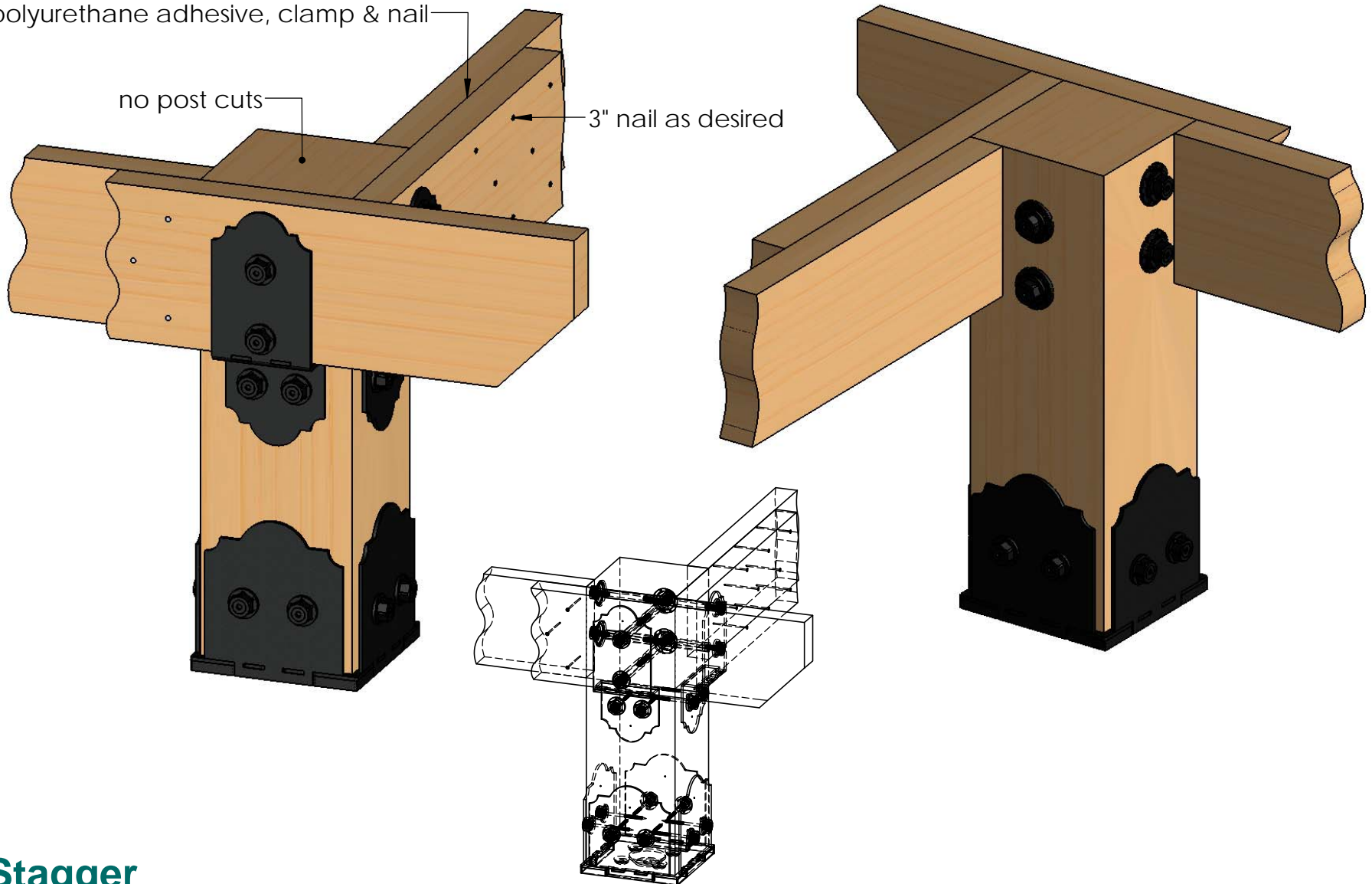

2x Stagger

Ian's Concept

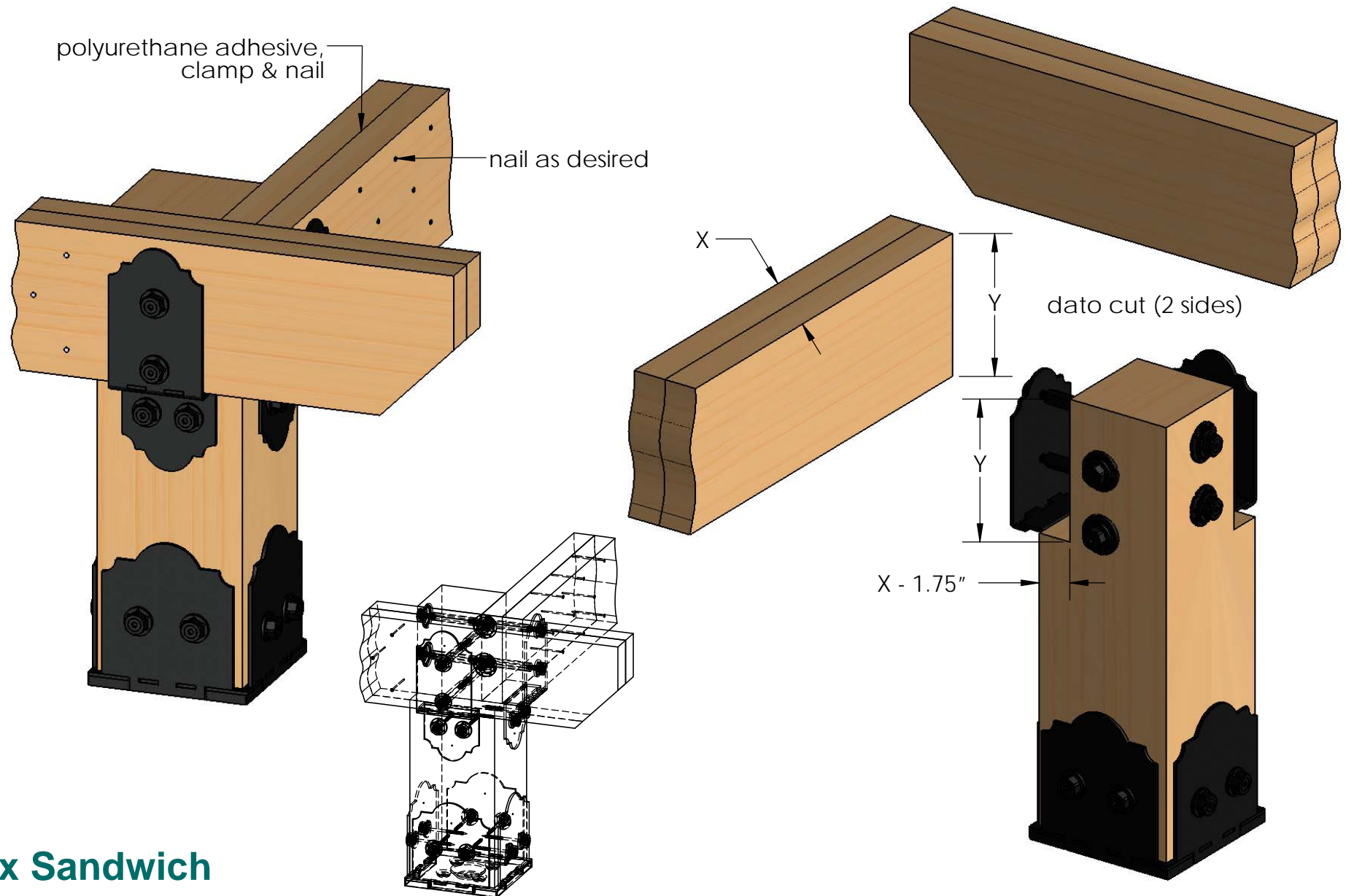

2x Sandwich

Ian's Concept

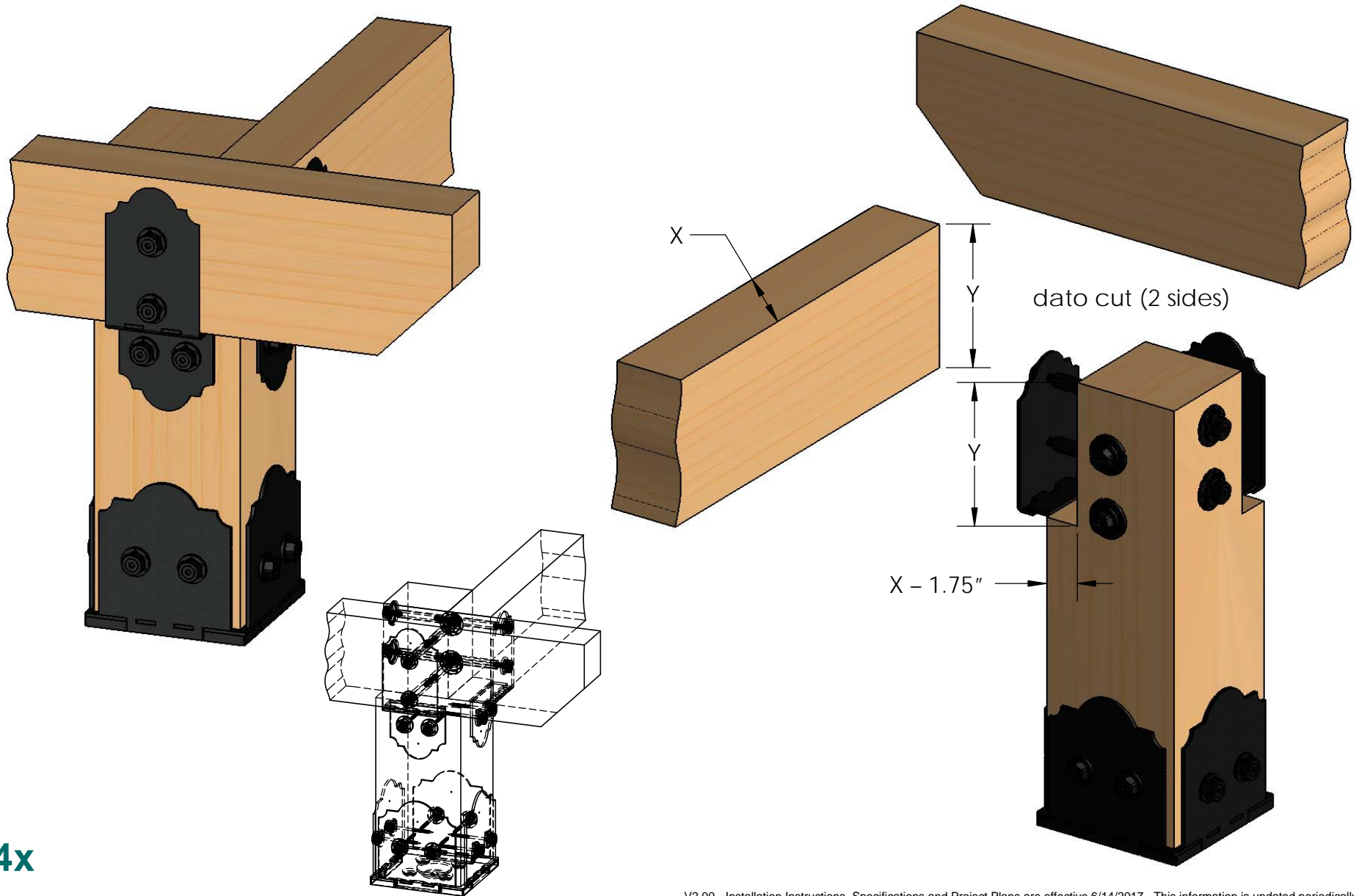

4x

Ian's Concept

mark ledge location

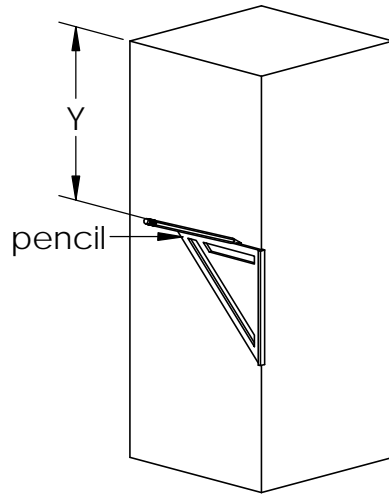

multiple cuts
approximately 1/4"
apart to mark

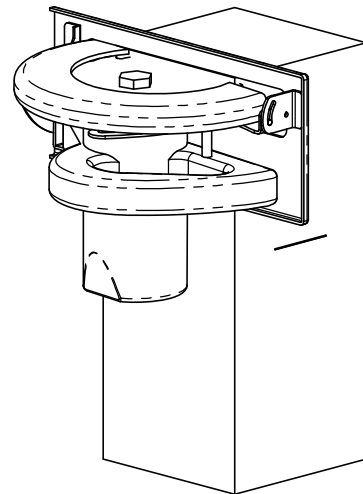
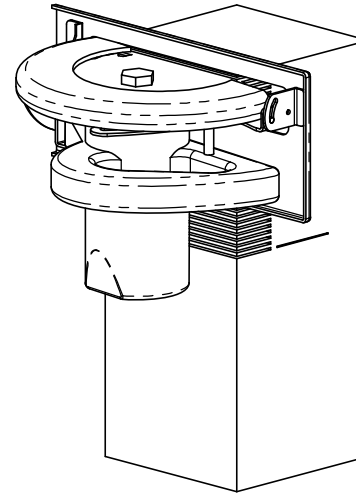

set saw cut depth;
start cuts 1/4" from top

remove pieces

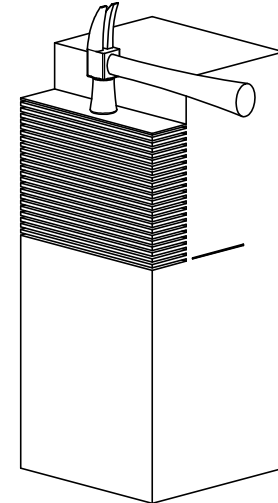

Dato cut details

Ian's Concept