

Tiger Claw[®]

Hidden Deck Fasteners

400 Middle Street, Suite J • Bristol, CT 06010-8405

Email: tigerclaw@deckfastener.com

Tech Support: 877 USE CLAW (877/873-2529) toll free

Customer Service: 800-92-TIGER (800/928-4437) toll free

Fax: 877-FAX-CLAW or 860/940-6267

GETTING STARTED

IMPORTANT! Read all instructions carefully and completely to ensure proper installation.

IMPORTANT! Always stand on the back of the Jaw when installing.

WARNING! Parts have sharp points & edges. Use extreme caution when handling & installing. Wear safety glasses at all times.

Tools & Materials Needed



16-20 oz. (500-570 g.) carpenter hammer



Power screw gun with ratcheting torque setting



Pliers

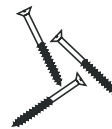

Standard deck screw (not included)



Safety Glasses

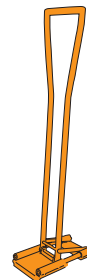

The Tiger Jaw

The Tiger Jaw

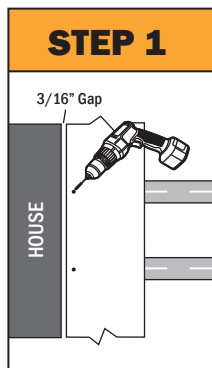
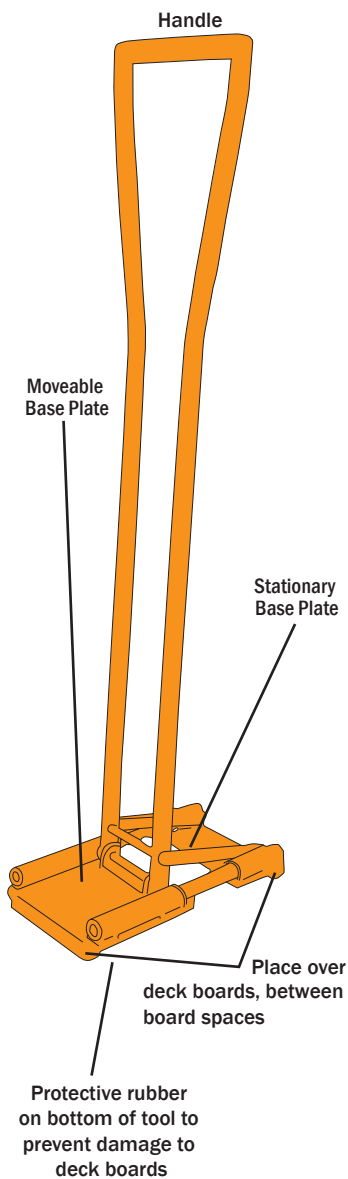

Using a standard deck screw, fasten down 1st deck board, leaving 3/16" gap between house and board edge.

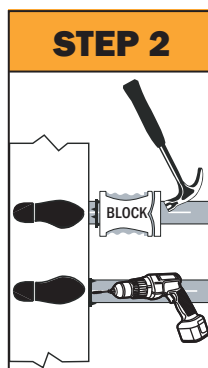

*Install TC-3, Proclip, or TC-4, and screw at each joist. To ensure even deck surface, make sure you are standing on deck board when installing with block.

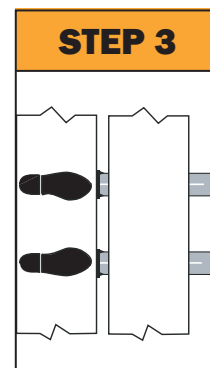

Set next deck board in position to be installed.

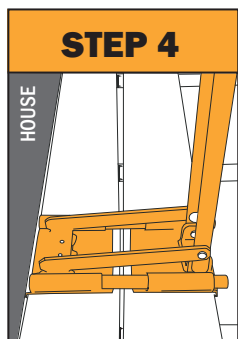

Start at one end of deck, place Jaw over the last attached deck board and the board about to be installed. Make sure the Jaw is on the inside of the 1st joist, and both base plates are laying flat on deck boards.

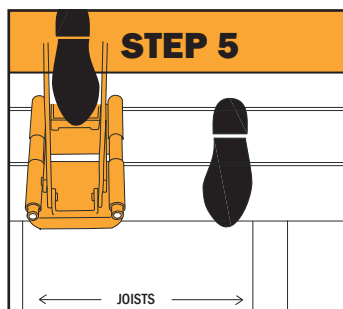

Stand firmly with one foot on the stationary base plate of the Jaw with 2nd foot placed on board being installed holding it tight to the joist.

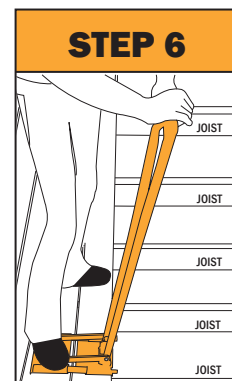

Push handle until proper gapping is attained. *With a (2) person crew, fasteners and screws can be installed as the board is being set.

Repeat at every joist until entire board is installed

IMPORTANT: Always stand on the back of the Jaw when installing.

Repeat steps 2 - 6 until deck is complete

*Refer to fastener instructions for detailed installation technique

HELPFUL HINTS

SAFETY:

- Always maintain balance when using the Tiger Jaw
- Anticipate the chance of the Jaw slipping off deck boards and possible loss of balance
- Only use enough force to secure deck board on fastener

MAINTANANCE:

- Before use check Jaw for broken welds & loose fasteners
- Lightly lubricate slide boards after each use
- Keep Tiger Jaw dry

When installing with the Jaw

- Make sure the base plates are sitting flat on deck board surfaces. This will ensure an even surface. To achieve this be sure to seat the Jaw along side of the joist, not directly above the joist.
- Placing the Jaw above the joist will not allow proper seating and may result in an uneven surface.

WARNING: Improper seating or failure to stand on the Jaw may allow the Jaw to slide off board edge when applying pressure. Loss of balance may result in installer injury.

Fig. A

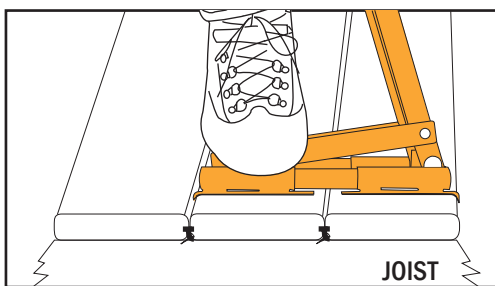
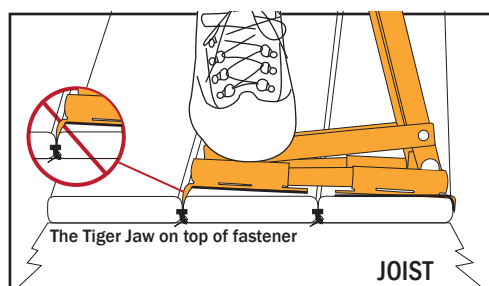

Fig. B



When using 3.5" (90mm) decking:

- When installing row #2, use a scrap block or unused deck board as the 3rd board.
- When installing row #3, placed the Jaw over the 2 previous installed deck boards and the board about to be installed.

a.

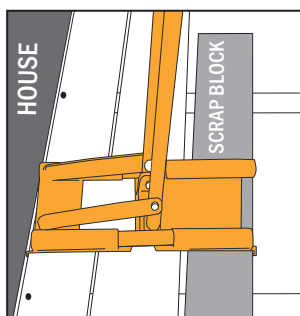

b.

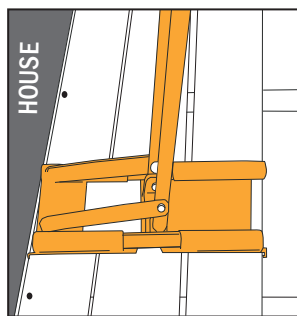

COVERAGE GUIDES

TC-1S, TC-2S, TC-3S, Proclip, TC-G, TC-120

Based on 5½" (140 mm) decking

Size of Deck sq. ft. (m²)

	100 (9.3m ²)	200 (18.6m ²)	300 (27.9m ²)	400 (37.2m ²)	500 (46.5m ²)
Support Joist Spacing (on Center)	12" (305mm)	210 (3) 441 (5) 672 (8) 882 (10) 1113 (13)			
	16" (406mm)	175 (2) 336 (4) 512 (6) 672 (8) 848 (10)			
	24" (610mm)	110 (2) 231 (3) 352 (4) 462 (6) 583 (7)			

TC-4, TC-120

Based on 3½" (90 mm) decking

Size of Deck sq. ft. (m²)

	100 (9.3m ²)	200 (18.6m ²)	300 (27.9m ²)	400 (37.2m ²)	500 (46.5m ²)
Support Joist Spacing (on Center)	12" (305mm)	336 (4) 693 (8) 1029 (12) 1386 (16) 1722 (20)			
	16" (406mm)	256 (3) 528 (6) 784 (9) 1056 (12) 1312 (15)			
	24" (610mm)	176 (3) 363 (5) 5392 (6) 1312 (15) 902 (10)			

Fasteners Needed - Parts (boxes)

Or multiply the number of support joists times the number of deck boards.

(90 fasteners covers approx. 50 sq. ft. / 4.6m²)