

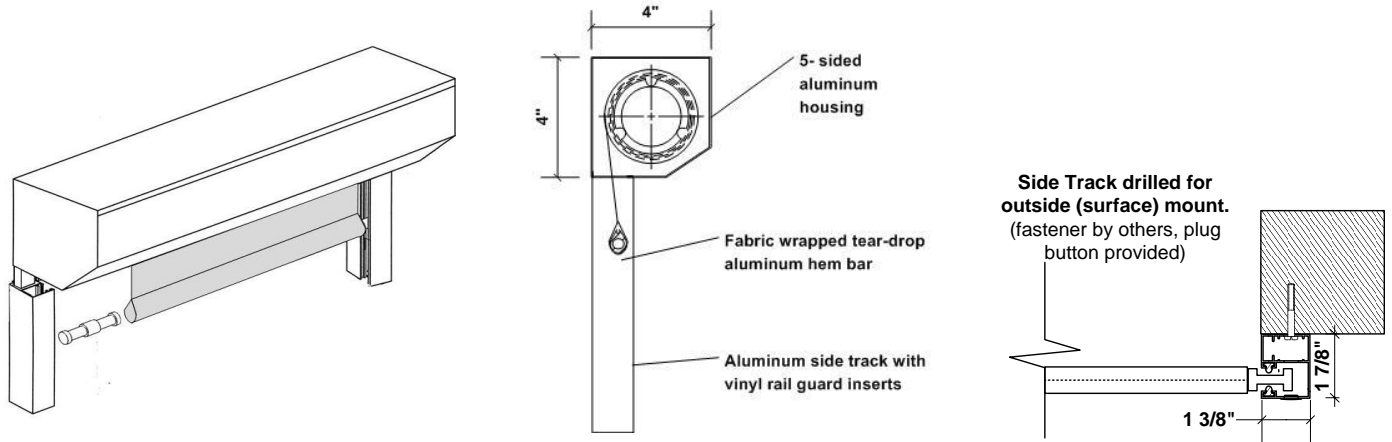

Oasis® 2700 Exterior Window Shade INSTALLATION INSTRUCTIONS

Oasis® 2700 Exterior Window Shade system is available with two guide systems (side track or cable guide). All Oasis 2700 Shades are motorized. Proceed to appropriate section for Guide type being installed.

MOTORIZED SHADE INSTALLATION WITH SIDE TRACKS



1. Mark location of side tracks on window trim.
Order width=outside track dimension. Mount side tracks with # 8 or #10 screw (not provided) at appropriate width. Notched portion of track goes at top. On inside mount installer must pre-drill side rail for mounting. Tracks must be mounted plumb and parallel. *Note: If you do not have 6 3/4" of clearance at top of side rails you will need to mount side rails and head box at the same time.



Notch at top of tracks

Side Track drilled for inside mount.

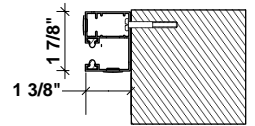

2. Remove front cover. Do not remove plastic sleeve wrapped around shade.
3. Remove shade and roller tube by compressing spring idler and removing square drive shaft from gear.
4. Remove motor retainer clip. Remove shade and roller tube by compressing spring idler and removing motor from motor mount. (Some motors utilize alternative motor retainer clip system)
5. Slide head box bracket assembly into side tracks. Make sure peg on bracket slides down into hollow cavity on side tracks. The head box is supplied with a (silver) metal reinforcement bracket, which has two holes on the top and two holes in the back. Screw brackets to wall or post with #10 x 1 1/2 " or longer pan-head screws (not provided). On wider units, secure back cover to wall between brackets with screws (not provided). Be careful not to tighten down screws too hard as this may cause damage to the head box.
6. Drill a hole either through top or back of head box to route the motor wire out of box.

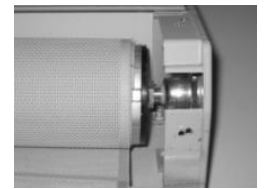
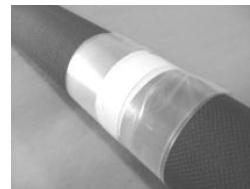

Motor Mount



Motor Retainer Clip

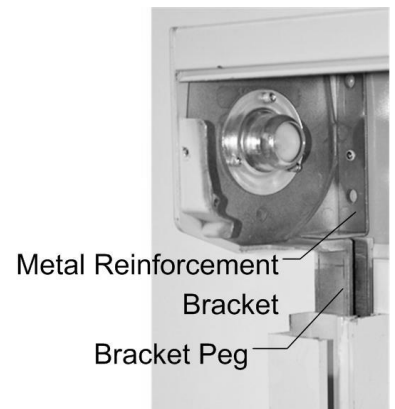

Metal Reinforcement Bracket

Bracket Peg

7. Re-install shade into head box by inserting spring idler into spring idler bracket, compress spring and insert motor back into motor mount. Re-attach motor retainer ring. Remove the plastic sleeve from around the shade. Make sure motor limits are accessible and wire does not interfere with shade operation. Using test switch, run shade down about 12".

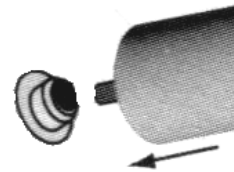

8. Insert hem bar into the hem pocket at bottom of fabric.



9. Tilt one end of hem bar and insert into sidetrack at top and let it drop down into sidetrack. Tilt the other end of hem bar up, insert into track guide, and let it drop down into sidetrack. Mount side tracks with # 8 or #10 screw (not provided) at appropriate width.

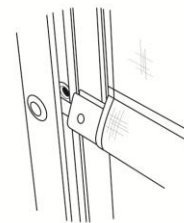

10. Set upper and lower motor limit stops. Refer to attached motor limit setting instructions. Operate shade several times to test.

11. Reinstall front cover. Install plug buttons on side rails for surface mount installations.

MOTORIZED SHADE INSTALLATION WITH CABLES

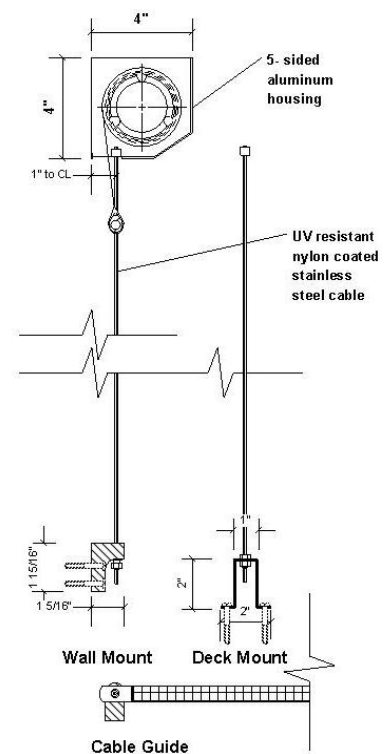
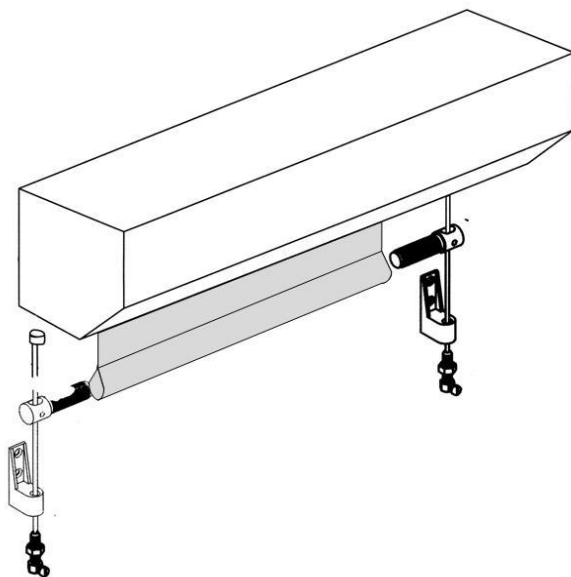

1. Remove front cover. Do not remove plastic sleeve wrapped around shade.
2. Remove shade from idler bracket by compressing spring idler.
3. Remove motor retainer clip. Remove shade and roller tube by compressing spring idler and removing motor from motor mount. (Some motors utilize alternative motor retainer clip system)
4. Mount head box at desired location through (silver) steel reinforcement bracket assembly, which has two holes on the top and two holes in the back. Screw brackets to wall or post

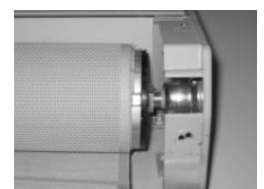
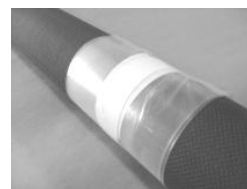

Motor Mount



Motor Retainer Clip

with #10 x 1 ½ "or longer pan-head screws (not provided). On wider units, secure back cover to wall between brackets with screws (not provided). Be careful not to tighten down screws too hard as this may cause damage to the head box.

5. Drill hole either through top or back of head box to route the motor wire out of box.
6. Feed both cables through holes in bottom of head box bracket from inside out.
7. Remove plastic sleeves from around shade. Reinstall shade back into head box by depressing idler end into idler bracket and inserting motor into motor mount. Make sure limit switches are accessible and motor wire does not interfere with shade operation.
8. Insert hem bar into the hem pocket at the bottom of the shade.
9. Run cables through holes in hem bar inserts.
10. Attach wall or deck brackets (at bottom shade location) vertically aligned with cable hole in head box bracket above - one bracket on each side of shade. The wall mount angle bracket can be installed with the mounting leg facing up or down depending upon installation variables.
11. Attach threaded cable lock assembly to wall or deck mount brackets. Remove bottom nut and insert assembly into bracket hole. Re-attach nut onto assembly making sure the copper sleeve remains seated in top of the assembly.
12. Pull cable taut beside the wall or deck mount bracket. Mark the cable approximately 2" above the copper sleeve and strip the sheathing off the cable with 12 gauge wire stripper. Insert cable through hole in cable lock assembly. Using a pair of pliers, pull cable taut and tighten 7mm bolt on cable tension lock. This screw must be completely tight to crush copper sleeve in cable lock.
13. Loosen the upper nut and tighten the lower nut to adjust cable tension. Do not over tighten. Re-tighten the upper nut. After cable is tightened, trim excess cable below cable lock with diagonal pliers, (leave a minimum of 1" of cable exposed).
14. Set upper and lower motor limit stops. Refer to attached motor limit setting instructions. Operate shade several times to test.
15. Reinstall front cover.

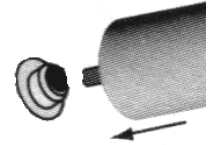
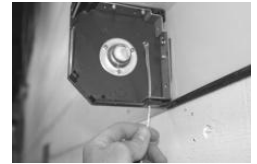

Wall Mount

Deck Mount

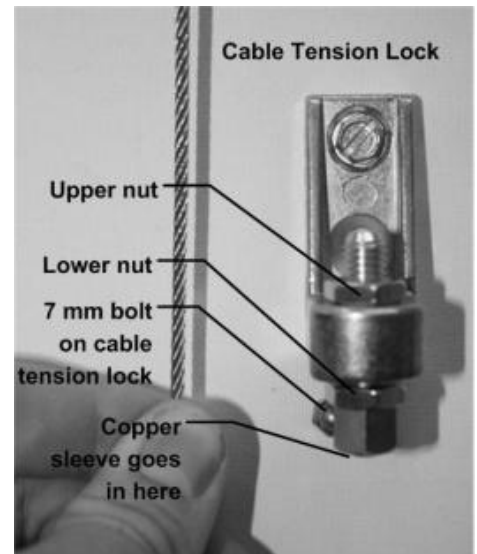

TROUBLESHOOTING – TELESCOPING SHADE ADJUSTMENT

1. To adjust shades for telescoping (excessive horizontal movement of fabric while shade rolls up on the tube), roll shade all the way down so tube is exposed (this will require adjustment of the down limit on motor).
2. Place a 4" piece of tape (2"-4" in from the end of shade) on the side of the tube opposite of the direction the fabric is moving toward.
3. Run the shade up. If shade still telescopes, repeat the process. The correct amount of tape can only be determined by trial and error.
4. Re-set the down limit after shade adjustments are made.

For more assistance, contact Insolroll, Inc.
www.insolroll.com 800-447-5534 Rev 6/13